



Jayco

Jay Flight

Serial #: 1UUBCSBN2S1790077
Model: 236TH JAY FLIGHT TT

Model Year: 2025 Dealer Name: ZOOMERS RV OF INDIANA LLC

2503 E SR 524
WABASH, IN 46992
USA



Standard Equipment
THE FOLLOWING ITEMS ARE STANDARD ON THIS MODEL
AT NO EXTRA CHARGE

Optional Equipment
OPTIONAL EQUIPMENT INSTALLED ON THIS VEHICLE
BY MANUFACTURER

STANDARD EXTERIOR EQUIPMENT

- 30 amp service
- 5/8 in. tongue-and-groove plywood floor decking
- Awning with electric, self-adjusting brakes and
- appliance
- Exterior TV mount and bracket
- Front diamond plate
- Galvalume® exterior
- Class exterior downspouts (gas grill prep)
- LP quick connect (gas grill prep)
- LP quick connect (gas grill prep)
- LP quick connect (gas grill prep)
- PVC roofing membrane (limited lifetime warranty)

STANDARD INTERIOR EQUIPMENT

- 12V refrigerator (select models)
- 4 in. thick bunk mats (select models)
- 600 lb. rated bunk beds (double bunks)
- 81 in. ceiling height
- “Soft” 7.5 lb., full-extension, steel ball-bearing drawer guides
- “J-Sleep” Jack-knife sofa with armrest and cup holders (most models)
- Plow bed platform
- Privacy curtains in bunk areas (select models)
- Queen mattress hidden cabinet door hinges
- Residential-style kitchen counter tops
- Shower curtain with curved shower track (select models)
- Shower/tub surround
- Shower/tub surround doors
- SSB changing station
- Vented bunk windows (including slide floors)
- Vinyl flooring throughout (including slide floors)
- Wooden bedroom doors (select models)

CUSTOMER VALUE PACKAGE (MANDATORY)

- 1350 BTU AC
- Backup and side view camera prep
- Bathroom medicine cabinet
- Bathroom power vent
- Black tank flush
- Detachable power cord
- Filled bed steel
- Front door with window and shade prep
- G20 dark tinted privacy windows
- Goodyear® Endurance® tires (made in the USA)
- Inverter pre-wire
- Large main entry door grab handle
- LED exterior and interior lights
- Mainline grade exterior speakers
- On-demand tankless water heater
- One-piece front fiberglass exterior wall
- Outside shower
- Overhead storage rack with glass cover
- Overhead Storage Package (150V solar panel and 30-amp digital controller)
- Power awning with LED lights
- Power tongue jack
- Rocket-Solid Stabilizer System
- Seamless kitchen countertops
- Sink cover @ entry steps (NA 380CCS)
- Spare tire with cover

OPTIONAL EQUIPMENT

- Base price 35,828.00
- USA STANDARDS 5.250.00
- CUSTOMER VALUE PACKAGE 13,500.00
- METAL SIDEWALL 0.00
- BLACK SPOKE RIMS 0.00
- 20# LP GAS BOTTLES 0.00

UNIT TOTAL 41,078.00

DEALER INSTALLED OPTIONS

Manufacturer's Suggested Retail Price \$41,078.00

TOTAL AMOUNT DOES NOT INCLUDE STATE AND LOCAL TAXES OR LICENSE FEES. THE PRICE SHOWN ABOVE MAY NOT BE REPRESENTATIVE OF THE ACTUAL SELLING PRICE OF SIMILAR RECREATIONAL VEHICLES IN YOUR AREA.

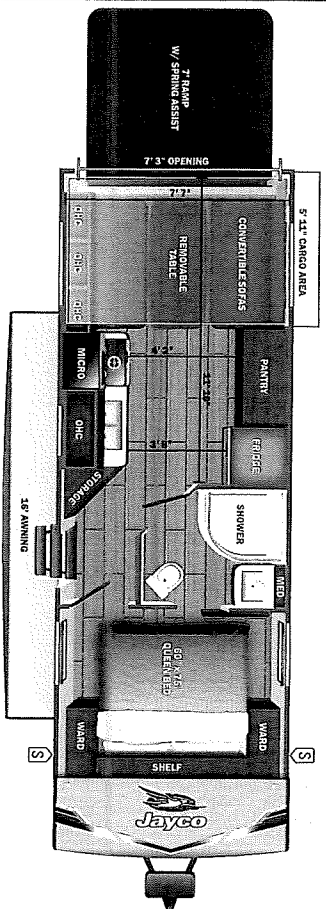

UVW 5375 lbs **Sleeps** **Length** 28' 3.63"

DIMENSIONS

Exterior height: 126.50"

Exterior width: 96.00"

WEIGHTS

GVWR: 7995

GVWR (front): 3500

GVWR (rear): 3500

Approx. Gross Cargo Carrying Capacity (GVCC): 2620

TIRES

Tire size (front): S17205/75R14D

Tire size (mid): S17205/75R14D

Tire size (rear): S17205/75R14D

Tire size (spare): S17205/75R14D

CAPACITIES

Fresh water tank (gals.): 52.00

Gray water tank (gals.): 39.00

Black water/toilet tank (gals.): 39.00

Propane (lbs.): 40

Propane (gals.): 9

Water heater (gals.): 0.00

SEATING & SLEEPING

Some dimensions may be rounded and may vary from the actual dimensions
 ****Weights may be estimated calculations and may vary from the actual weight
 - refer to the vehicle weight labels for actual weights***
 Floorslans, features and specifications are subject to change without notice.

