



Standard Equipment

THE FOLLOWING ITEMS ARE STANDARD ON THIS MODEL AT NO EXTRA CHARGE

- STANDARD EXTERIOR EQUIPMENT**
- 102 in. wide body structural steel I-beam
 - NPS - Powered by Yamaha 6,000 watt generator with built in pure sine inverter, gas/C.A.R.R. certified
 - 6-point hydraulic auto-leveling system
 - Climate Shield™ zero-degree tested weather protection.
 - PREX plumbing
 - Double door fiberglass batt insulation in ceiling and floor
 - Double sided radiant barrier insulation (roof and floor)
 - Poly enclosed and heated underbelly (geared)
 - Color stainless steel vinyl exterior graphics package
 - Detachable shore power cord
 - Digital D. meter
 - Exterior marine-grade speakers
 - Folding roof ladder
 - Fully enclosed, LED-lighted universal decking
 - Black tank flush, winterization and sanitation
 - Quick-connect outside shower
 - Sensitive prep
 - Sewer System™ (factory exclusive):
 - Directional and adjustable A/C vents
 - Jayco-exclusive insulated dual duct design
 - No exterior mounted 15,000 BTU ducted A/Cs
 - JAYS/MART™ (Safety Markers And Reverse Travel)
 - LED lighting (patented)
 - LED exterior lighting package

STANDARD INTERIOR EQUIPMENT

- 12V charging station
- 26 in. x 36 in. square lined plywood main floor decking and 36 in. x 36 in. square solid styrofoam in the roof
- Bathroom skylight
- Carbon monoxide and LP detector
- Color control center with built-in tank monitoring
- Custom interior vinyl with 16 tank monitors
- Gas-strutted under-bed storage
- Handcrafted and glazed door, drawers and trim
- Handcut safety handrail on hallway steps
- Heavy-duty 1/2 in. lift struts on steel ball-bearing drawer guides
- LED interior with electric space heater (select models)
- LED interior lighting package
- No in floor heat registers throughout the coach
- Porcelain foot flush toilet
- Presidential CP 1 sink with pull-out kitchen faucet, glass
- Residential finished dove wall jointed drawers throughout
- Residential stainless steel kitchen sink with its rise pull out
- Residential vinyl flooring (made in the USA)
- Solid hardwood cabinet doors
- Stain protected fabric on all furniture
- Toilet seat with heat, massage and LED lighting (select models)
- Vinyl flooring in slideouts (no carpet)
- Wash/dryer prep
- Washer/Hall Bath™ (14L, 18L)
- Garage Half Bath™ (14L, 18L)

Optional Equipment

- Base price 117,268.00
- USA STANDARDS N/C
- CUSTOMER VALUE PACKAGE 7,500.00
- FOUR STAR HANDLING 3,743.00
- NO OVERLANDER PACKAGE N/C
- POWERED VENT CARGO AREA TINTED SAFETY GLASS N/C
- WINDOWS N/C
- HALF BATH 893.00

OPTIONAL EQUIPMENT INSTALLED ON THIS VEHICLE BY MANUFACTURER

Seismic

Serial #: 1UJCGSCV9S18M0139
Model: 399 SEISMIC FW

Model Year: 2025 Dealer Name: ZOOMERS RV OF INDIANA LLC
2503 E SR 524
WABASH, IN 46992
USA



UNIT TOTAL

129,504.00

DEALER INSTALLED OPTIONS

Manufacturer's Suggested Retail Price \$129,504.00

TOTAL AMOUNT DOES NOT INCLUDE STATE AND LOCAL TAXES OR LICENSE FEES. THE PRICE SHOWN ABOVE MAY OR MAY NOT BE REPRESENTATIVE OF THE ACTUAL SELLING PRICE OF SIMILAR RECREATIONAL VEHICLES IN YOUR AREA.

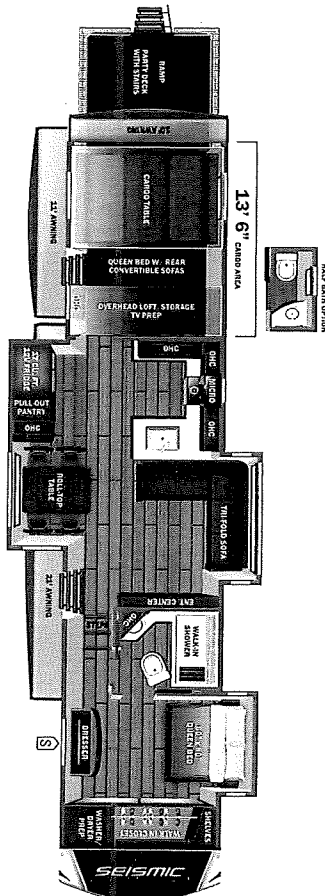

UWV 15280 lbs **Sleeps** Length 45' 9.25"

- DIMENSIONS**
- Exterior height: 160.50"
 - Exterior width: 102.00"
- WEIGHTS**
- GVRW: 20400
 - GAWR (front): 7000
 - GAWR (rear): 7000
 - Approx. Gross Cargo Carrying Capacity (GCCC): 5120
- CAPACITIES**
- Fresh water tank (gals.): 106.00
 - Gray water tank (gals.): 87.00
 - Black water/toilet tank (gals.): 87.00
 - Propane (lbs.): 60
 - Propane (gals.): 1.4
 - Water heater (gals.): 16.00
- SEATING & SLEEPING**
- TIRES**
- Tire size (front): 215/75R17.5H
 - Tire size (mid): 215/75R17.5H
 - Tire size (rear): 215/75R17.5H
 - Tire size (spare): 215/75R17.5H

Some dimensions may be rounded and may vary from the actual dimensions
 Weights may be estimated calculations and may vary from the actual weight
 - refer to the vehicle weight labels for actual weights***
 Floorplans, features and specifications are subject to change without notice.

2+3
 YEAR | YEAR
 WARRANTY