

Manufacturer's Suggested Retail Price \$58,754.00

TOTAL AMOUNT DOES NOT INCLUDE STATE AND LOCAL TAXES OR LICENSE FEES. THE PRICE SHOWN ABOVE MAY OR MAY NOT BE REPRESENTATIVE OF THE ACTUAL SELLING PRICE OF SIMILAR RECREATIONAL VEHICLES IN YOUR AREA.

Jay Flight

Serial #: 1UJBC0BT9S1730106
Model: 334RTS JAY FLIGHT TT

Model Year: 2025 Dealer Name: ZOOMERS RV OF INDIANA LLC
2503 E SR 524
WABASH, IN 46992
USA



Standard Equipment

THE FOLLOWING ITEMS ARE STANDARD ON THIS MODEL AT NO EXTRA CHARGE

- 20 lb. LP bottles with cover (2)
- 30-amp service
- 4 gal. gray plywood floor, decking
- Axles with electric, self-adjusting brakes and easy-lube hubs
- Enclosed and heated underbelly
- Front diamond plate
- Fully integrated A-frame
- Galvanized steel, impact-resistant wheel wells
- Large exterior door
- LP quick connect (outside gas grill prep)
- Magnum Truss™ Roof system with plywood decking
- PVC roofing membrane (limited lifetime warranty)

- STANDARD INTERIOR EQUIPMENT
- 11 cu. ft. 12V refrigerator
- 300 lb. rated bunk beds (select models)
- 6 in. thick bunk mats (select models)
- 6 tie-downs (double bunks)
- 81 in. ceiling height
- Heavy-duty, 75 lb., full-extension, steel ball-bearing drawer slides™
- Jack-knife sofa with armrest and cup holders (most models)
- Main bed stairs
- Plywood bed platforms
- Queen mattress in bunk areas (select models)
- Residential-style hidden cabinet door hinges
- Residential-style kitchen countertops
- Shower/lau. surround
- Solid curved shower track (select models)
- Solid hardwood cabinet doors
- USB charging station
- Vinyl flooring throughout (including slide floors)
- Window shades
- Wooden bedroom doors (select models)

- Solid hardwood cabinet doors
- Vinyl flooring throughout (including slide floors)
- Window shades
- Wooden bedroom doors (select models)

CUSTOMER VALUE PACKAGE (MANDATORY)

- 13,500 BTU AC
- AM/FM/Bluetooth® stereo
- Backup and side view camera prep
- Bath cabinet
- Bathroom power vent
- Bathroom skylight
- Back tank flush
- Battery disconnect switch
- Filled bed sheet
- Friction hinge entry door with window and shade prep
- G20 dark tinted privacy windows
- G20 dark tinted privacy windows
- Inverter pre-wire
- Keyed-Alike™ entry and baggage doors
- Large main entry door grab handle
- LED interior lights
- Marine grade exterior speakers
- Microwave oven
- On-demand tankless water heater
- Oven with front fiberglass exterior wall
- Outside shower
- Oven with 3-burner recessed cooktop with glass cover
- Overlander 1 Solar Package (1) 200W solar panel and 3-amp digital controller
- Power tongue jack
- Power tongue jack
- Range hood
- Rock-Solid Stabilizer System
- Sink cover
- Sink cover
- Solid Step® entry steps (NIA 380DOS)
- Spare tire with cover

Optional Equipment

OPTIONAL EQUIPMENT INSTALLED ON THIS VEHICLE BY MANUFACTURER

Base price	52,566.00
USA STANDARDS	n/c
CUSTOMER VALUE PACKAGE	5,250.00
15,000 BTU AC	300.00
NO 2ND AC	n/c
METAL SIDEWALL	n/c
BLACK SPOKE RIMS	n/c
20# LP GAS BOTTLES	n/c
TWIN BUNKS	n/c
TWO BUNK SOFA	n/c
QUEEN BED	638.00

UNIT TOTAL **58,754.00**

DEALER INSTALLED OPTIONS

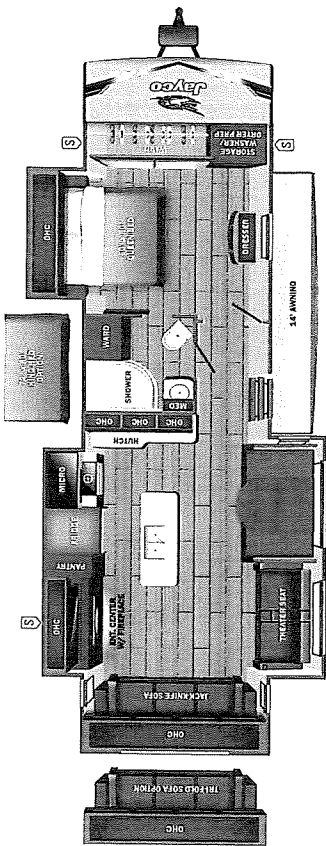

UVW
9103 lbs

Sleeps

Length
37' 11.75"

DIMENSIONS	
Exterior height:	134.75" Fresh water tank (gals.):...52.00
Exterior width:	96.00" Gray water tank (gals.):...71.50
WEIGHTS	
GVWR:	10600 Black water/toilet tank
GAWR (front):	5145 Propane (lbs.):...39.00
GAWR (rear):	5145 Propane (lbs.):...40
Approx. Gross Cargo Carrying Capacity(GCCC):	1497 Water heater (gals.):...0.25

TIRES	
Tire size (front):	ST225/75R15E
Tire size (mid):	
Tire size (rear):	ST225/75R15E
Tire size (spare):	ST225/75R15E

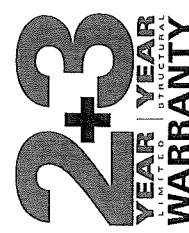

Some dimensions may be rounded and may vary from the actual dimensions
Weights may be estimated calculations and may vary from the actual weight - refer to the vehicle weight labels for actual weights
Floorplans, features and specifications are subject to change without notice.