



Jayco Flight

Serial #: 1UJBC0BS8R17M0126
Model: 294QBS JAY FLIGHT TT

Model Year: 2024 Dealer Name: ZOOMERS RV OF INDIANA LLC
2503 E SR 524
WABASH, IN 46992
USA



Manufacturer's Suggested Retail Price \$47,982.00

TOTAL AMOUNT DOES NOT INCLUDE STATE AND LOCAL TAXES OR LICENSE FEES. THE PRICE SHOWN ABOVE MAY OR MAY NOT BE REPRESENTATIVE OF THE ACTUAL SELLING PRICE OF SIMILAR RECREATIONAL VEHICLES IN YOUR AREA.

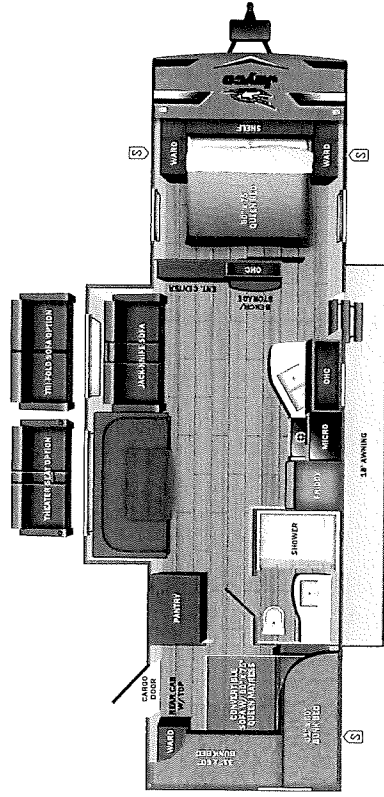

UVW 6880 lbs **Length** 35' 6.75"
Sleeps

DIMENSIONS		CAPACITIES	
Exterior height:	135.00"	Fresh water tank (gals.):	52.00
Exterior width:	96.25"	Gray water tank (gals.):	39.00
WEIGHTS		SEATING & SLEEPING	
GVWR:	8250 (gals.)	Black water/toilet tank	39.00
GAWR (front):	4400 (gals.)	Propane (lbs.):	40
GAWR (rear):	4400 (gals.)	Propane (gals.):	9
Approx. Gross Cargo Carrying Capacity (GCCC):	1370	Water heater (gals.):	0.00

TIRES	
Tire size (front):	ST225/75R15E
Tire size (mid):	ST225/75R15E
Tire size (rear):	ST225/75R15E
Tire size (spare):	ST225/75R15E



Some dimensions may be rounded and may vary from the actual dimensions
Weights may be estimated calculations and may vary from the actual weight - refer to the vehicle weight labels for actual weights
Floorplans, features and specifications are subject to change without notice.

Standard Equipment

THE FOLLOWING ITEMS ARE STANDARD ON THIS MODEL AT NO EXTRA CHARGE

- EXTERIOR**
 - 20 lb. LP bottles with cover (2)
 - Electrically operated awning
 - Advis with electric, self-adjusting brakes and easy-tube hubs
 - 1-Class™ cambered structural steel I-beams
 - Maximum tongue weight with plywood decking
 - Seamless one piece roof material
 - Large exterior downspouts
 - 30-year seal, impact-resistant wheel wells
 - Front diamond plate
 - Exterior TV mount and bracket
 - LP quick connect (outside gas grill prep)
- INTERIOR**
 - 81 in. ceiling height
 - 8 cu. ft. 12V refrigerator
 - Solid hardwood cabinet doors
 - J-Sleep™ jackknifes sofa with armrest & cup holders (most models)
 - Window covering throughout (including slide floors)
 - Residential-style kitchen countertops
 - Heavy-duty, 75 lb., full-extension, steel ball-bearing drawer slides
 - USA charging station
 - Queen mattress
 - 300 lb. bed frame
 - 600 lb. rated bunk beds (double bunks)
 - Privacy curtains in bunk areas (select models)
 - Vented bunk windows (select models)
 - Wooden bedroom doors (select models)
 - Shower curtain with curved shower track (select models)
- CUSTOMER VALUE PACKAGE (Mandatory)**
 - Black tank flush
 - Overlander 1 Solar Package: (1) 200W solar panel and 30-amp digital controller
 - 30-day trial 30-day trial
 - Solid Step™ entry step (N/A 30QDS)
 - On-demand tankless water heater
 - Goodyear® Endurance® tires (made in the USA)
 - Power tongue jack
 - Spare tire with cover
 - Power awning with LED lights
 - Keypad flip-up exterior speakers
 - Keypad flip-up interior speakers
 - Bathroom power vent
 - Bathroom skylight
 - 12V AC stereo
 - AM/FM/USB stereo
 - Backup and slide view camera prep
 - Bathroom medicine cabinet
 - Electrifiable power cord
 - Friction hinge entry door with window and shade prep
 - 620 dark tinted privacy windows
 - Interior pre-wire
 - Interior LED lights
 - Mainline grade exterior speakers
 - Microwave oven
 - One-piece front fiberglass exterior wall
 - Front bumper recessed cockpit with glass cover
 - Range hood
 - Reck-Solid Stabilizer System
 - Seamless countertops
 - Sink cover

Optional Equipment

OPTIONAL EQUIPMENT INSTALLED ON THIS VEHICLE BY MANUFACTURER

Base price	41,201.00
USA STANDARDS	n/c
CUSTOMER VALUE PACKAGE	5,250.00
15,000 BTU AC	300.00
NO 2ND AC	n/c
30 AMP SERVICE	n/c
WET BATH	n/c
BLACK SPOKE BIKES	n/c
204 LP GAS BOTTLES	n/c
ROOF LADDER	185.00
THEATER SEATING SOFA	1,043.00

UNIT TOTAL 47,982.00

DEALER INSTALLED OPTIONS