



# Eagle



Serial #: 1UJBA0BU1R1C70113  
 Model: 312BHOK EAGLE TT

Model Year: 2024 Dealer Name: ZOOMERS RV OF INDIANA LLC  
 2503 E SR 524  
 WABASH, IN 46992  
 USA

**Manufacturer's Suggested Retail Price \$89,192.00**

TOTAL AMOUNT DOES NOT INCLUDE STATE AND LOCAL TAXES OR LICENSE FEES. THE PRICE SHOWN ABOVE MAY OR MAY NOT BE REPRESENTATIVE OF THE ACTUAL SELLING PRICE OF SIMILAR RECREATIONAL VEHICLES IN YOUR AREA.

## Standard Equipment

THE FOLLOWING ITEMS ARE STANDARD ON THIS MODEL AT NO EXTRA CHARGE

- EXTERIOR**
- Stronghold VBL™ walls (laminated sidewalls, rear walls and slide out walls)
  - 5 in. Magnum Truss™ Roof System with limited lifetime warranty
  - Climate Shield™ zero-degree tested weather protection:
  - Fully enclosed and heated underbelly (ducted)
  - 35,000 BTU furnace
  - Double layer fiberglass batt insulation in ceiling and floor
  - Double sided radiant barrier insulation (roof, floor, and behind cap)
  - PEX plumbing
  - HELIX Cooling System™ (industry exclusive):
  - Jayco exclusive insulated dual duct design
  - Directional and closeable A/C vents
  - Larger return air vents with user accessible filters
  - JaySMART™ (Safety Markers And Reverse Travel) LED lighting (patented)
  - Automotive style painted front cap with max turn radius (painted on select models)
  - Auto-grade vinyl graphics
  - LED exterior lighting package
  - Dual 30 lb. LP bottles
  - Digital TV antenna with Wi-Fi prep
  - Dual channel exterior speaker
  - Black tank flush
  - Independent satellite and whole coach cable hookups
  - Battery disconnect in pass through area
  - Nitrogen filled undermount spare tire (model/option varies 15 in. or 16 in.)
  - LP quick connect for gas griddle (next to JayPort)
  - Slide topper/awning prep
  - 1.5 in fresh water drain valve
  - 50-amp detachable power cord
  - LED lighting in pass through area with 3-way switches
  - Commercial grade rubber flooring in pass through area
  - Factory installed roof ladder
  - Galvalume steel coated outside kitchens
  - Metal slam latch baggage doors
  - Nautilus 2.5 water connections
  - Overlander 1 Solar Package: (1) 200W panels, MPPT 30-amp solar controller
  - Quick connect water connections (door side hot/cold and off door side cold only)
  - LUXURY PACKAGE (Mandatory)
  - Electric leveling front legs with electric rear stabilizer jacks
  - JAYCOMMAND® "Smart RV" system (Pro tablet)
  - LED fireplace with 5,000 BTU electric space heater (select models)
  - GE 10 cu.ft. 12V refrigerator
  - Blackout roller shades with reflective side throughout
  - Washer/dryer prep (select models)
  - TPMS (Tire Pressure Monitoring System) in-stem monitoring
  - JayPort 2 in. mount (for outside accessories)
  - MORryde® Safe-T-Rail grab handle
  - Overlander 1 Solar Package (200W panel and 30-amp solar controller)
  - Residential style glass shower door
- 5 STAR HANDLING PACKAGE (Mandatory)**
- Goodyear® Endurance® tires (load range E)
  - Dexter® Axles with Nev-R-Adjust® brakes and E-Z Lube® hubs
  - MORryde® CRE-3000™ rubberized suspension
  - Wet bolt fasteners with bronze bushings
  - Dexter® ABS brake system with anit-sway

- INTERIOR**
- Solid hardwood slide fascia
  - Handcrafted and glazed door/drawer fronts (new sizes)
  - 75 lb. full extension drawer guides
  - 5/8 in. tongue-and-groove plywood flooring
  - Residential vinyl flooring throughout
  - LED lights with dimmer switches and motion activated (throughout interior)
  - Tri-fold hide-a-bed sofa with residential memory foam sleep surface (select models)
  - Theater seating (select models)
  - Stainless steel kitchen sink
  - Matte black kitchen faucet with pull-out sprayer
  - USB charging ports (multiple locations throughout)
  - Extra 120V power outlets in kitchen and slide rooms (where applicable)
  - 90 in. x 92 in. residential quilted bedspread (both queen and king mattresses)
  - Gas-strutted under-bed storage
  - Inverter pre-wire (multiple locations)
  - C.P.A.P. prepped bedroom
  - Bathroom skylight
  - LED backlit medicine cabinet with custom framed mirror
  - Porcelain foot flush toilet
  - 2 piece high gloss bathroom surround
  - Bedroom TV prep
  - Furniture cup holder tables (1 pair)
  - Residential 60 in. x 80 in. queen size mattress
- CUSTOMER VALUE PACKAGE (Mandatory)**
- MORryde® StepAbove™ entrance steps (main entrance) with blue LED light
  - 15K BTU "Whisper Quiet" A/C and bedroom A/C prep
  - 50-amp service with dual A/C ducts
  - Electric patio awning with integrated dimmable LED lights
  - 60K on-demand water heater with mixing tank
  - Custom machined aluminum rims
  - Rear 2 in. accessory receiver
  - Keyed-Alike™ lock system (single key for all doors/locks)
  - Security monitor prep (rear, sides and entrance door)
  - Hidden hinges on cabinet doors
  - Upgraded friction hinge entrance door
  - JBL® Aura Bar 12V with Bluetooth® and dual HDMI (dual zone)
  - GE black and stainless 21 in. range with edge to edge grates
  - GE 30 in. over-the-range black and stainless microwave with exhaust fan
  - Rain-proof bathroom power vent
  - 43 in. 4K Ultra LED HD Smart TV in living room

## Optional Equipment

OPTIONAL EQUIPMENT INSTALLED ON THIS VEHICLE BY MANUFACTURER

Base price	68,175.00
USA STANDARDS	n/c
CUSTOMER VALUE PACKAGE	6,263.00
LUXURY PACKAGE	7,493.00
FIVE STAR HANDLING PACKAGE	5,993.00
OVERLANDER I SOLAR PACKAGE	n/c
2ND 15,000 AC IN BEDROOM	1,043.00
STANDARD CAMPING SYSTEM	n/c
OBSERVATION SYSTEM PREP	n/c
TINTED SAFETY GLASS	n/c
WINDOWS	n/c
ELECTRIC STABILIZER JACKS (2 SETS)	n/c
DINETTE	n/c
THEATER SEATING SOFA	225.00

UNIT TOTAL **89,192.00**

DEALER INSTALLED OPTIONS

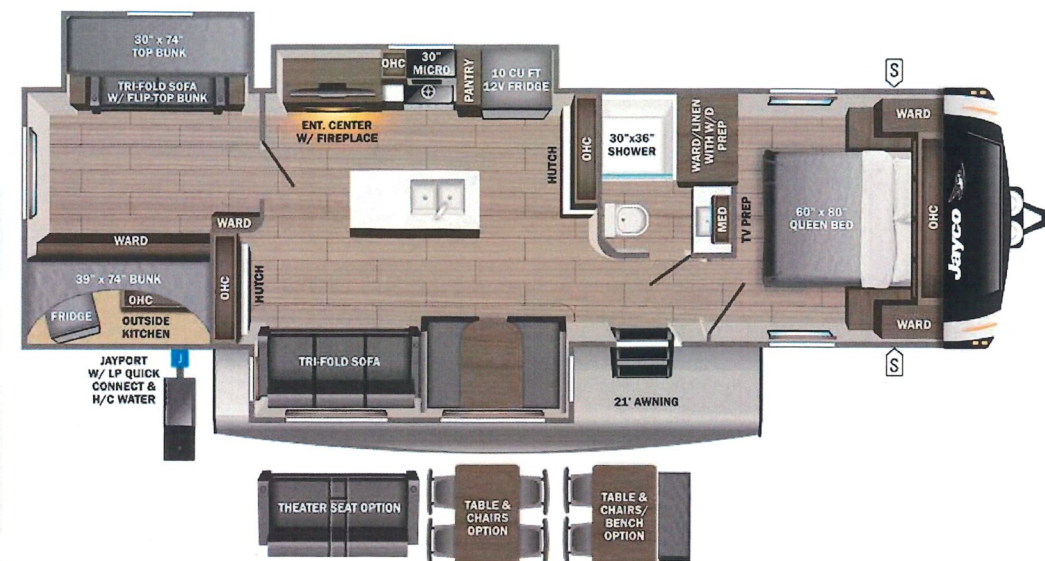

**UVW**  
 10168 lbs

**Sleeps**

**Length**  
 38' 8.88"

### DIMENSIONS

Exterior height:.....143.00"  
 Exterior width:.....97.00"  
**WEIGHTS**  
 GVWR:.....11500  
 GAWR (front):.....5800  
 GAWR (rear):.....5800  
 Approx. Gross Cargo Carrying Capacity(GCCC):.....1332

### TIRES

Tire size (front):.....ST235/85R16E  
 Tire size (mid):.....  
 Tire size (rear):.....ST235/85R16E  
 Tire size (spare):.....ST235/85R16E

### CAPACITIES

Fresh water tank (gals.):...81.00  
 Gray water tank (gals.):...74.00  
 Black water/toilet tank (gals.):.....37.00  
 Propane (lbs.):.....60  
 Propane (gals.):.....14  
 Water heater (gals.):.....0.19

### SEATING & SLEEPING

\*\*\*Some dimensions may be rounded and may vary from the actual dimensions\*\*\*  
 \*\*\*Weights may be estimated calculations and may vary from the actual weight\*\*\*  
 - refer to the vehicle weight labels for actual weights\*\*\*  
 Floorplans, features and specifications are subject to change without notice.

