



EXTREME TOWABLE

SERVICE CONTRACT

This book provides an overview of coverage. Actual contract coverage, limitations and exclusions may apply. See your Service Agreement for details.



24/7 CONCIERGE SERVICES

- RV Technical Assistance
- Repair Facility Locator Service
- ATM, Business, Historical Site, Pet Care, Shopping, Pharmacy, Emergency Care, and RV Storage Locator
- Reservations for Car Rentals, Hotels, and Restaurants
- Local Activities Calendar
- Golf Tee Time Reservations and Course Referrals
- Emergency Return Travel Arrangements
- Turn-by-Turn Directions, Traffic Reports, and Road Closings
- Campground Referrals
- Ticket Coordinations for Theaters, Movies, and Sporting Events



TRIP INTERRUPTION

\$100 PER DAY UP TO 5 DAYS PER CLAIM

Reimbursement for hotel & restaurant expenses if breakdown is more than 100 miles from home.



SUBSTITUTE TRANSPORTATION

\$40 PER DAY UP TO 8 DAYS PER CLAIM

Rental car provided for covered repairs.



SERVICE CALL

UP TO \$150 PER BREAKDOWN

Provides coverage for the expense of an on-site service call.



24/7 ROADSIDE ASSISTANCE

\$500 TOWING PER BREAKDOWN

\$100 ALL OTHER BENEFITS PER BREAK DOWN

Your service agreement includes the following sign and drive roadside benefits:

- Towing
- Key Lock-out
- Emergency Gas Delivery
- Flat Tire Change



FOOD SPOILAGE

UP TO \$50 PER OCCURRENCE

\$250 MAXIMUM BENEFIT FOR LIFE OF AGREEMENT

Provides reimbursement to replace food destroyed as the result of a covered breakdown.





Our coverage options ensure you have the protection your RV requires far beyond the original manufacturer warranty period.

COVERAGE LEVELS

SUPREME

Comprehensive coverage for your new or pre-owned towable RV. Provides exclusionary coverage for all house component groups.

SELECT

Stated component coverage for your new or pre-owned towable RV. Provides basic coverage for the house component groups.

COMMON REPAIR COSTS

PROTECT YOURSELF AGAINST COSTLY REPAIRS LIKE THESE

\$599

Leveling Jacks

\$412

Macerator Pump

\$1,015

Refrigerator/Freezer

\$623

Power Steps

\$645

Sliding Floor Motor

\$691

Slide-Out Room Motor

\$412

Television

\$793

Brake Calipers

\$488

Entertainment System

\$1,130

AC Compressor

\$857

Slide-Out Tracks

\$686

Rear Monitor Camera

\$615

Wheel Bearing

\$560

Water Heater

\$413

Temperature Control Module

\$713

Holding Tank

\$502

Awning Motor

\$562

Fireplace Burner Assembly

\$305

Keyless Entry

\$985

Inverter

\$431

Factory-Installed Radio

\$449

Microwave

\$547

Washer/Dryer

\$636

Electric Brake Magnets

Actual average repair costs obtained from NWAN, Inc.® Claims Register Summary.

COMPREHENSIVE COVERAGE FOR YOUR TOWABLE UNIT!

● SELECT

BRAKE ●

Master cylinder, wheel cylinders, calipers, electric brake magnets, and hydraulic tubing and metal fittings. Drums and rotors, when in conjunction with a covered repair.

WATER SYSTEM ●

FRESH/WASTE - Hot water tank, thermostat, thermocouple, burner assembly, gas valve, electronic ignition assembly, PC board, diesel/ electric heating system, shower assembly, toilet, sink, holding tanks, gate valves, macerator pump, water pump, faucets, traps, fittings, and water lines.

GENERATOR/POWER PLAN ●

Power plant engine block and cylinder heads, if damaged as a result of the failure of an internally lubricated part. All internally lubricated parts contained within the engine power plant, starter, alternator, voltage regulator, manually-operated switches, power converter-inverter, PC boards, fuel pump, and hour meter.

KITCHEN CENTER ●

Range/oven burner assembly, burner valves, refrigerator/freezer, microwave, convection oven, thermostat, thermocouple, burner, igniter, and PC board.

●● SUPREME

AIR CONDITIONING ●

ROOF/BASEMENT - Compressor, evaporator, condenser, relays, capacitors, thermostat, heat strips, expansion valve, control module and panel, reversing valve, blower fan and motor, PC board, and ceiling ventilation fans and motors.

HEATING SYSTEM ●

Furnace igniter, burner assembly, gas valve, gas leak detector, thermostat, thermocouple, blower motor, and PC Board.

SEALS & GASKETS ●

Seals and gaskets are covered for all listed parts (surcharge on pre-owned units).

SUSPENSION ●

Leaf and coil springs, shackles and bushings, and rubber suspension springs.

LP GAS SYSTEM ●

Gas regulators, gas tanks, gas valves, tank gauges, LP lines and fittings, emergency shut off system, gas leak detector, and carbon monoxide monitor.

WEAR & TEAR ●

Normal wear and tear for factory and dealer-installed parts.

EXTREME TOWABLE

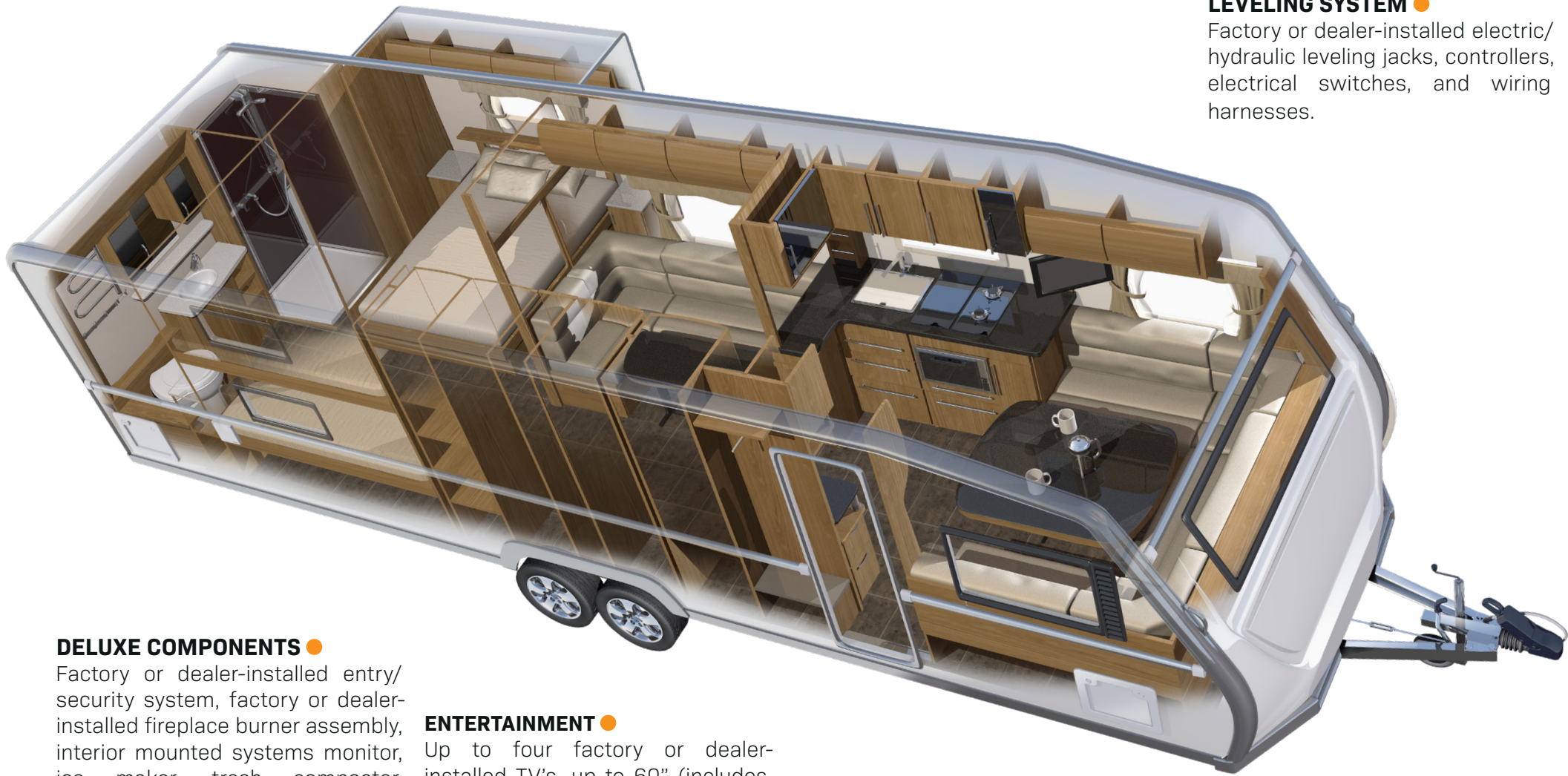

DELUXE COMPONENTS ●

Factory or dealer-installed entry/ security system, factory or dealer-installed fireplace burner assembly, interior mounted systems monitor, ice maker, trash compactor, dishwasher, built-in coffee maker, built-in food processor, in-sink disposal, central vacuum cleaner system, foldout external grill, clothes washer/dryer, ceiling fan motor, and smoke detector.

ENTERTAINMENT ●

Up to four factory or dealer-installed TV's, up to 60" (includes plasma, LED, and LCD), surround sound systems, Blu-ray™ players, digital receivers, stereo receivers, tuners, CD players, DVD players, satellite systems, and television antennas and rotators.

INTERIOR & EXTERIOR ●

Factory or dealer-installed door handles, latches and springs, door chimes, clock, power awning motor, awning mechanism (cover excluded), awning sensor, and shore power cord and retractor.

SLIDE-OUT ROOMS ●

Slide-out room motors, guides, tracks and hydraulic valves, sliding floor motors, pump/jack assemblies, electrical switches, and wiring harnesses.

LEVELING SYSTEM ●

Factory or dealer-installed electric/ hydraulic leveling jacks, controllers, electrical switches, and wiring harnesses.

POWER STEPS ●

Factory or dealer-installed power steps, lines, fittings, cylinders, worm gears, electrical switches, wiring harnesses, and entry door floor motors and mechanisms.

EXCLUSIONARY COVERAGE ●

Covers all factory and dealer-installed parts not listed in the Exclusions section.

OPTIONAL COVERAGE

SELECT ONLY

LEVELING SYSTEM

Included with Supreme Protection
Factory or dealer-installed electric/ hydraulic leveling jacks, controllers, electrical switches, and wiring harnesses.

POWER STEPS

Included with Supreme Protection
Factory or dealer-installed power steps, lines, fittings, cylinders, worm gears, electrical switches, wiring harnesses, and entry door floor motors and mechanisms.

LUXURY COMPONENT GROUP

Included with Supreme Protection
Icemaker, trash compactor, dishwasher, built-in coffee maker, built-in food processor, in-sink disposal, basement refrigerator/freezer, central vacuum cleaner system, foldout external grill, clothes washer/dryer, ceiling fan motor, carbon monoxide/smoke detector, hood latches and springs, door handles, latches, and springs, door chimes, heated seats, power seat systems and tracks, clocks, courtesy map light assemblies, intercoms, awning mechanisms (cover excluded), air horns, spotlights, automatic temperature control programmer, door actuators, remote mirror motors, keyless entry/alarm system, factory or dealer-installed security system, rear monitor camera, shift lever, glove box door hinges, factory or dealer-installed fireplace burner assembly, interior mounted systems monitor, and dash mounted instrument cluster and gauges.

PREMIER ELECTRONICS

Included with Supreme Protection
Up to four factory or dealer-installed TV's, up to 60" (includes plasma, LED, and LCD), surround sound systems, Blu-ray™ players, digital receivers, stereo receivers, tuners, CD players, DVD players, satellite systems, television antennas and rotator, compass, global positioning system (GPS), on-board communications system, GPS satellite antenna, back-up warning system, rear monitor camera, and electronic driver information display and module.

SLIDE-OUT ROOMS

Included with Supreme Protection
Slide-out room motors, guides, tracks and hydraulic valves, sliding floor motors, pump/jack assemblies, electrical switches, and wiring harnesses.

SELECT & SUPREME

SEALS & GASKETS

Included on New Units
Seals and gaskets are covered on pre-owned units for all covered parts.

BROWN OUT COVERAGE

Damage caused by a reduction in power.

CONSEQUENTIAL LOSS

In the event that a covered part causes the failure of certain non-covered parts, the non-covered part will be repaired or replaced.

BUSINESS USE

Available on New Plans Only
Designed for units used for the generation of income.

● SELECT COACH ONLY

BRAKE ●●

Master cylinder, wheel cylinders, calipers, and hydraulic tubing and metal fittings. Drums and rotors, when in conjunction with a covered repair.

WATER SYSTEM ●●

FRESH/WASTE Hot water tank, burner assembly, thermostat, thermocouple, gas valve, electronic ignition assembly, PC board, diesel/electric heating system, shower assembly, toilet, sink, holding tanks, gate valves, macerator pump, water pump, faucets, traps, fittings, and water lines.

AIR CONDITIONING ●●

ROOF/BASEMENT Compressor, relays, evaporator, condenser, capacitors, thermostat, heat strips, expansion valve, control module and panel, reversing valve, blower fan and motor, PC board, and ceiling ventilation fans and motors.

KITCHEN CENTER ●●

Range/ oven burner assembly, burner valves, refrigerator/freezer, microwave, convection oven, burner, thermostat, thermocouple, igniter, and PC board.

HEATING SYSTEM ●●

Furnace igniter, burner assembly, gas valve, gas leak detector, thermostat, thermocouple, blower motor, and PC Board.

●● SUPREME COACH ONLY

SEALS & GASKETS ●●●

Seals and gaskets are covered for all listed parts (surcharge on pre-owned units).

SUSPENSION ●●●

Leaf and coil springs, shackles and bushings, and rubber suspension springs.

LP GAS SYSTEM ●●●

Gas regulators, gas tanks, gas valves, tank gauges, LP lines and fittings, emergency shut off system, gas leak detector, and carbon monoxide monitor.

HI-TECH ●

Remote mirror motors, keyless entry/ alarm system, factory or dealer-installed entry/security system, rear monitor camera and back-up warning system, factory or dealer-installed fireplace burner assembly, interior mounted systems monitor, and dash mounted instrument cluster and gauges.

GENERATOR/POWER PLANT ●●●

Power plant engine block and cylinder heads, if damaged as a result of the failure of an internally-lubricated part. All internally-lubricated parts contained within the engine power plant, alternator, starter, manually-operated switches, voltage regulator, power converter/inverter, PC boards, fuel pump, and hour meter.

COACH ONLY

DELUXE APPLIANCES ●

Ice maker, trash compactor, dishwasher, built-in coffee maker, built-in food processor, in-sink disposal, basement refrigerator/freezer, central vacuum cleaner system, foldout external grill, clothes washer/dryer, ceiling fan motor, and smoke detector.

POWER STEPS ●

Factory or dealer-installed power steps, lines, fittings, cylinders, worm gears, electrical switches, wiring harnesses, and entry door floor motors and mechanisms.

LEVELING SYSTEM ●

Factory or dealer-installed electric/hydraulic leveling jacks, controllers, electrical switches, and wiring harnesses.

SLIDE-OUT ROOMS ●

Slide-out room motors, guides, tracks and hydraulic valves, sliding floor motors, electrical switches, pump/jack assemblies, and wiring harnesses.

WEAR & TEAR ●

Normal wear and tear for factory and dealer-installed parts.

EXCLUSIONARY COVERAGE ●

Covers all factory and dealer-installed parts not listed in the Exclusions section.

ENTERTAINMENT ●

Up to four factory or dealer-installed TV's, up to 60" (includes plasma, LED, and LCD), surround sound systems, Blu-ray™ players, digital receivers, stereo receivers, tuners, CD and DVD players, satellite systems, TV antennas and rotators, compass, global positioning system (GPS), on-board communications system, GPS satellite antenna, and electronic driver information display and module.

INTERIOR & EXTERIOR ●

Factory or dealer-installed hood latches and springs, door handles, latches, and springs, door chimes, heated seats, power seat systems and tracks, clocks, courtesy map light assemblies, power window curtain motors/shade motors, awning motors, awning mechanisms (cover excluded), awning sensors, shore power cords and retractors, intercoms, air horns, and spotlights.





WWW.NAENWAN.COM | 877-222-1645

© National Automotive Experts 18-SRC-29-00