



EXTREME MOTORIZED

SERVICE CONTRACT

This book provides an overview of coverage. Actual contract coverage, limitations and exclusions may apply. See your Service Agreement for details.

BENEFITS ALL PLANS



24/7 CONCIERGE SERVICES

- RV Technical Assistance
- Repair Facility Locator Service
- ATM, Business, Historical Site, Pet Care, Shopping, Pharmacy, Emergency Care, and RV Storage Locator
- Reservations for Car Rentals, Hotels, and Restaurants
- Local Activities Calendar
- Golf Tee Time Reservations and Course Referrals
- Emergency Return Travel Arrangements
- Turn-by-Turn Directions, Traffic Reports, and Road Closings
- Campground Referrals
- Ticket Coordinations for Theaters, Movies, and Sporting Events



TRIP INTERRUPTION

\$100 PER DAY UP TO 5 DAYS PER CLAIM

Reimbursement for hotel & restaurant expenses if breakdown is more than 100 miles from home.



SUBSTITUTE TRANSPORTATION

\$40 PER DAY UP TO 8 DAYS PER CLAIM

Rental car provided for covered repairs.



SERVICE CALL

UP TO \$150 PER BREAKDOWN

Provides coverage for the expense of an on-site service call.



24/7 ROADSIDE ASSISTANCE

\$500 TOWING PER BREAKDOWN

\$100 ALL OTHER BENEFITS PER BREAK DOWN

Your service agreement includes the following sign and drive roadside benefits:

- Towing
- Emergency Gas Delivery
- Key Lock-out
- Flat Tire Change



FOOD SPOILAGE

UP TO \$50 PER OCCURRENCE

\$250 MAXIMUM BENEFIT FOR LIFE OF AGREEMENT

Provides reimbursement to replace food destroyed as the result of a covered breakdown.

COMMON REPAIR COSTS

PROTECT YOURSELF AGAINST COSTLY REPAIRS LIKE THESE

\$11,802

Engine

\$599

Leveling Jacks

\$412

Macerator Pump

\$4,078

Camshaft

\$623

Power Steps

\$645

Sliding Floor Motor

\$1,402

Fuel Pump

\$412

Television

\$562

Fireplace Burner Assembly

\$1,130

AC Compressor

\$857

Slide-Out Tracks

\$686

Rear Monitor Camera

\$615

Wheel Bearing

\$560

Water Heater

\$413

Temperature Control Module

\$1,488

Axle Shafts

\$713

Holding Tank

\$488

Entertainment System

\$305

Keyless Entry

\$985

Inverter

\$431

Factory-Installed Radio

\$5,721

Turbocharger

\$1,689

Camshaft

\$636

Electric Brake Magnets

\$252

Door Latches

\$547

Washer/Dryer

\$1,015

Refrigerator/Freezer

\$793

Brake Calipers

\$502

Awning Motor

\$691

Slide-Out Room Motor

Actual average repair costs obtained from NWAN, Inc.® Claims Register Summary.



Our coverage options ensure you have the protection your RV requires far beyond the original manufacturer warranty period.

COVERAGE LEVELS

SUPREME CHASSIS & COACH

Comprehensive coverage for your new or pre-owned motorized RV. Provides exclusionary coverage for all chassis and house component groups.

SUPREME MANUFACTURER WRAP

Comprehensive coverage for your new motorized RV. Designed to wrap the manufacturer's powertrain warranty. Provides exclusionary coverage for all chassis and house components except engine, transmission and drive axle groups.

SUPREME COACH ONLY

Comprehensive coverage for your new or pre-owned motorized RV. Provides exclusionary coverage for all house component groups.

SELECT CHASSIS & COACH

Stated component coverage for your new or pre-owned motorized RV. Provides basic coverage for the chassis and house component groups.

SELECT MANUFACTURER WRAP

Stated component coverage for your new motorized RV. Designed to wrap the manufacturer's powertrain warranty. Provides basic coverage for the chassis and house components, except engine, transmission and drive axle groups.

SUPREME COACH ONLY

Stated component coverage for your new or pre-owned motorized RV. Provides basic coverage for the house component groups.

OPTIONAL COVERAGE

SELECT ONLY

LEVELING SYSTEM

Included with Supreme Protection

Factory or dealer-installed electric/hydraulic leveling jacks, controllers, electrical switches, and wiring harnesses.

POWER STEPS

Included with Supreme Protection

Factory or dealer-installed power steps, lines, fittings, cylinders, worm gears, electrical switches, wiring harnesses, and entry door floor motors and mechanisms.

LUXURY COMPONENT GROUP

Included with Supreme Protection

Icemaker, trash compactor, dishwasher, built-in coffee maker, built-in food processor, in-sink disposal, basement refrigerator/freezer, central vacuum cleaner system, foldout external grill, clothes washer/dryer, ceiling fan motor, carbon monoxide/smoke detector, hood latches and springs, door handles, latches, and springs, door chimes, heated seats, power seat systems and tracks, clocks, courtesy map light assemblies, intercoms, awning mechanisms (cover excluded), air horns, spotlights, automatic temperature control programmer, door actuators, remote mirror motors, keyless entry/alarm system, factory or dealer-installed security system, rear monitor camera, shift lever, glove box door hinges, factory or dealer-installed fireplace burner assembly, interior mounted systems monitor, and dash mounted instrument cluster and gauges.

PREMIER ELECTRONICS

Included with Supreme Protection

Up to four factory or dealer-installed TV's, up to 60" (includes plasma, LED, and LCD), surround sound systems, Blu-ray™ players, digital receivers, stereo receivers, tuners, CD players, DVD players, satellite systems, television antennas and rotator, compass, global positioning system (GPS), on-board communications system, GPS satellite antenna, back-up warning system, rear monitor camera, and electronic driver information display and module.

SLIDE-OUT ROOMS

Included with Supreme Protection

Slide-out room motors, guides, tracks and hydraulic valves, sliding floor motors, pump/jack assemblies, electrical switches, and wiring harnesses.

SELECT & SUPREME

SEALS & GASKETS

Included on New Units

Seals and gaskets are covered on pre-owned units for all covered parts.

BROWN OUT COVERAGE

Damage caused by a reduction in power.

CONSEQUENTIAL LOSS

In the event that a covered part causes the failure of certain non-covered parts, the non-covered part will be repaired or replaced.

BUSINESS USE

Available on New Plans Only

Designed for units used for the generation of income.

COMPREHENSIVE COVERAGE FOR YOUR MOTORIZED UNIT!

- SELECT CHASSIS & COACH
- SELECT MANUFACTURER WRAP

- SUPREME CHASSIS & COACH
- SUPREME MANUFACTURER

CHASSIS ENGINE ●●

Engine block and/or replaceable cylinder sleeves and heads, if damaged as a result of the failure of an internally-lubricated part. All internally-lubricated parts contained within the engine block, including, but not limited to, valves, valve springs, valve guides, valve covers, pistons and pins, main and rod bearings, crankshaft, camshaft, lifters, cam bearings, oil pump, rocker arms, push rods, timing chain, timing gears, timing chain tensioner, timing cover, flywheel, flywheel ring gear, flex plate, vacuum pump, engine mounts, dipstick and tube, intake manifold, oil pan, turbocharger and all internal parts, and diesel injectors and injector pump.

TRANSMISSION ●●

Transmission case, if damaged as a result of the failure of an internally-lubricated part. All internally-lubricated parts within the transmission case, torque converter, bands, clutches, gears, front pump, shafts, shift forks, synchronizers, shift solenoids, internal switches and sensors, transmission mounts, and transmission oil pan.

DRIVE AXLE ●●●●

Drive axle housing, if damaged as a result of the failure of an internally-lubricated part. All internally lubricated parts within the drive axle housing, axle shafts, axle housing, universal joints, constant velocity joints, locking hub mechanisms, wheel bearings, drive shafts, and center bearing.

ENGINE COOLING ●●●●

Water pump, radiator, cooling fan blades, fan clutch, hydraulic or electric fan motor, heater core, fan shroud, and coolant recovery tank.

STEERING ●●●●

Steering gear housing and all internally-lubricated parts, control valve, steering cylinder, rack and pinion, factory or dealer-installed steering stabilizer, internal steering column shafts, steering pump, main and intermediate shafts, and couplings.

FUEL DELIVERY ●●●●

Fuel pump, fuel tanks, metal fuel lines, fuel injection pump, fuel injectors, fuel pressure regulator, auxiliary fuel tank switch, and fuel lift pump.

AIR CONDITIONING ●●●●

CHASSIS - Compressor, compressor clutch, clutch bearing, receiver dryer, field coil, accumulator, condenser, idler pulley, evaporator, blower fan and motor, high/low cut-off switches, and pressure hose assemblies. Refrigerant, when in conjunction with a covered repair.

ELECTRICAL ●●●●

Alternator, starter, starter drive, starter solenoid, voltage regulator, distributor, manually-operated switches, ignition switch, windshield wiper motor and washer pump, power window motors, power window gears and regulators, and dual battery paralleling switch.

SUSPENSION ●●●●

Upper and lower control arms, control arm shaft and bushings, upper and lower ball joints, steering spindles and supports, leaf and coil springs, spring shackles and bushings, rubber suspension springs, and factory or dealer-installed suspension compressor, air lines, and suspension air bags.

SEALS & GASKETS ●●●●

Seals and gaskets are covered for all listed parts (*surcharge on pre-owned units*).

WATER SYSTEM ●●●●

FRESH/WASTE - Hot water tank, burner assembly, thermostat, thermocouple, gas valve, electronic ignition assembly, PC board, diesel/electric heating system, shower assembly, toilet, sink, holding tanks, gate valves, macerator pump, water pump, faucets, traps, fittings, and water lines.

KITCHEN CENTER ●●●●

Range/oven burner assembly, burner valves, refrigerator/freezer, microwave, convection oven, burner, thermostat, thermocouple, igniter, and PC board.

AIR CONDITIONING ●●●●

ROOF/BASEMENT - Compressor, relays, evaporator, condenser, capacitors, thermostat, heat strips, expansion valve, control module and panel, reversing valve, blower fan, motor, PC Board, and ceiling ventilation fans and motors.

LP GAS SYSTEM ●●●●

Gas regulators, gas tanks, gas valves, tank gauges, LP lines and fittings, emergency shut off system, gas leak detector, and carbon monoxide monitor.

BRAKE ●●●●

Master cylinder, hydraulic or vacuum brake booster, wheel cylinders, calipers, combination valve, hydraulic tubing and metal fittings, ABS pressure modulator, accumulator, air brake compressor, lines, treadle valve, compensating valve, actuator and diaphragm, and slack adjusters. Drums and rotors, when in conjunction with a covered repair.

GENERATOR/POWER PLANT ●●●●

Power plant engine block and cylinder heads, if damaged as a result of the failure of an internally-lubricated part. All internally-lubricated parts contained within the engine power plant, alternator, starter, manually-operated switches, voltage regulator, power converter-inverter, PC boards, fuel pump, and hour meter.

HEATING SYSTEM ●●●●

Furnace igniter, burner assembly, gas valve, gas leak detector, thermostat, thermocouple, blower motor, and PC board.

POWER STEPS ●●

Factory or dealer-installed power steps, lines, fittings, cylinders, worm gears, electrical switches, wiring harnesses, and entry door floor motors and mechanisms.

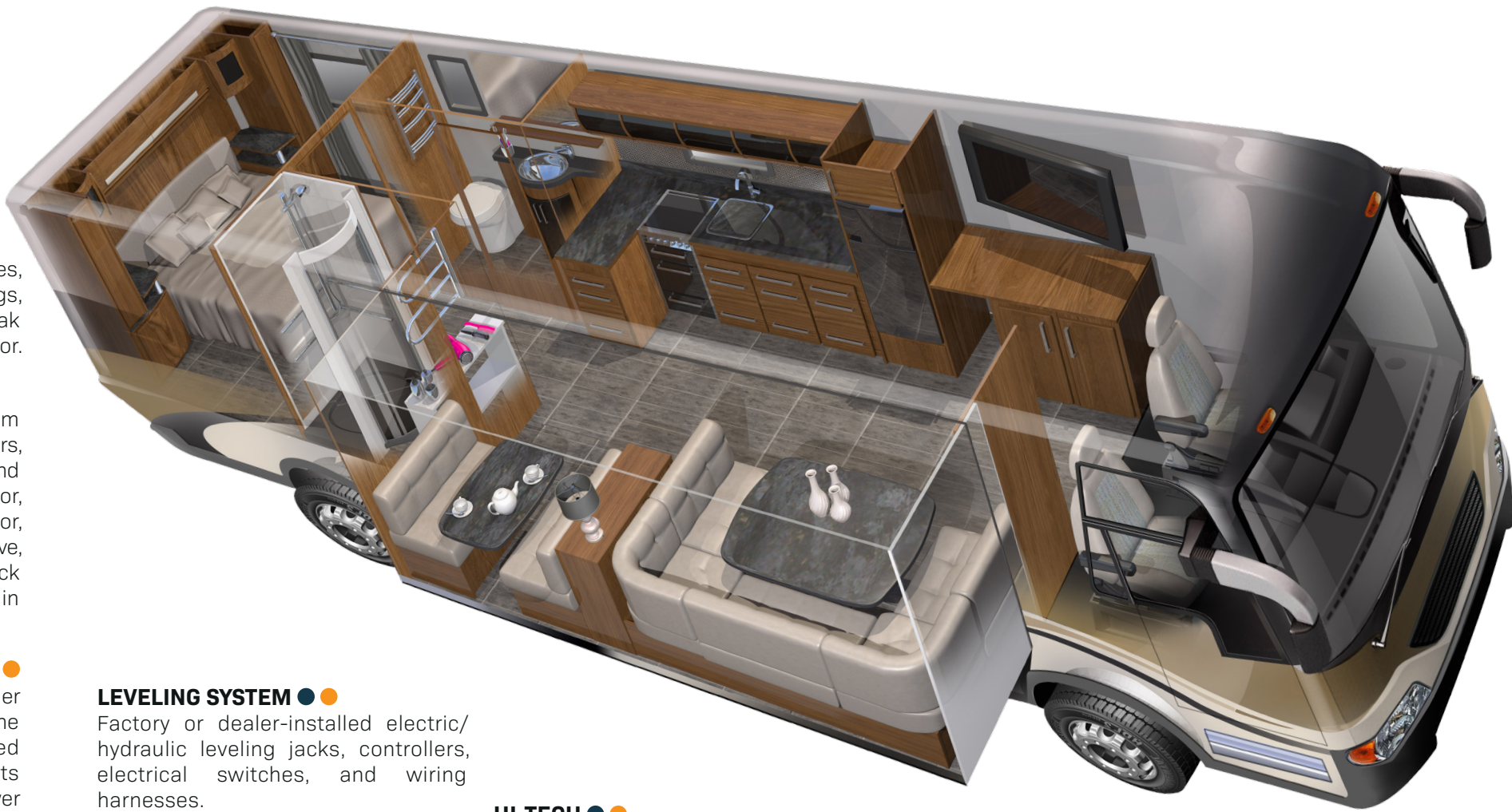

LEVELING SYSTEM ●●

Factory or dealer-installed electric/hydraulic leveling jacks, controllers, electrical switches, and wiring harnesses.

ENTERTAINMENT ●●

Up to four factory or dealer-installed TV's, up to 60" (includes plasma, LED, and LCD), surround sound systems, Blu-ray™ players, digital receivers, stereo receivers, tuners, CD players, DVD players, satellite systems, television antennas and rotator, compass, global positioning system (GPS), on-board communications system, GPS satellite antenna, and electronic driver information display and module.

WEAR & TEAR ●●

Normal wear and tear for factory and dealer-installed parts.

HI-TECH ●●

Engine control module, camshaft and crankshaft position sensors, coolant temperature sensor, knock sensor, map sensor, mass airflow sensor, throttle position sensor, electronic ignition module, ignition coil, cooling fan control module, electric block heater, transmission control module, transmission mounted parking brake, wheel speed sensors and control module, factory or dealer-installed fireplace burner assembly, interior mounted systems monitor, dash mounted instrument cluster and gauges, and rear monitor camera and back-up warning system.

DELUXE APPLIANCES ●●

Icemaker, trash compactor, dishwasher, built-in coffee maker, built-in food processor, in-sink disposal, basement refrigerator/freezer, central vacuum cleaner system, foldout external grill, clothes washer/dryer, ceiling fan motor, and smoke detector.

SLIDE-OUT ROOMS ●●

Slide-out room motors, guides, tracks and hydraulic valves, sliding floor motors, pump/jack assemblies, electrical switches, and wiring harnesses.

INTERIOR & EXTERIOR ●●

Factory or dealer-installed hood latches and springs, door handles, latches, and springs, door chimes, heated seats, power seat systems and tracks, clocks, courtesy map light assemblies, power window curtain motors/shade motors, awning motors, awning mechanisms (cover excluded), awning sensors, shore power cords and retractors, intercoms, air horns, and spotlights.

EXCLUSIONARY COVERAGE ●●

Covers all factory and dealer-installed parts not listed in the Exclusions section.

EXTREME
MOTORIZED

● SELECT COACH ONLY

BRAKE ●●

Master cylinder, wheel cylinders, calipers, and hydraulic tubing and metal fittings. Drums and rotors, when in conjunction with a covered repair.

WATER SYSTEM ●●

FRESH/WASTE Hot water tank, burner assembly, thermostat, thermocouple, gas valve, electronic ignition assembly, PC board, diesel/electric heating system, shower assembly, toilet, sink, holding tanks, gate valves, macerator pump, water pump, faucets, traps, fittings, and water lines.

AIR CONDITIONING ●●

ROOF/BASEMENT Compressor, relays, evaporator, condenser, capacitors, thermostat, heat strips, expansion valve, control module and panel, reversing valve, blower fan and motor, PC board, and ceiling ventilation fans and motors.

KITCHEN CENTER ●●

Range/ oven burner assembly, burner valves, refrigerator/freezer, microwave, convection oven, burner, thermostat, thermocouple, igniter, and PC board.

HEATING SYSTEM ●●

Furnace igniter, burner assembly, gas valve, gas leak detector, thermostat, thermocouple, blower motor, and PC Board.

●● SUPREME COACH ONLY

SEALS & GASKETS ●●●

Seals and gaskets are covered for all listed parts (surcharge on pre-owned units).

SUSPENSION ●●●

Leaf and coil springs, shackles and bushings, and rubber suspension springs.

LP GAS SYSTEM ●●●

Gas regulators, gas tanks, gas valves, tank gauges, LP lines and fittings, emergency shut off system, gas leak detector, and carbon monoxide monitor.

HI-TECH ●

Remote mirror motors, keyless entry/ alarm system, factory or dealer-installed entry/security system, rear monitor camera and back-up warning system, factory or dealer-installed fireplace burner assembly, interior mounted systems monitor, and dash mounted instrument cluster and gauges.

GENERATOR/POWER PLANT ●●●

Power plant engine block and cylinder heads, if damaged as a result of the failure of an internally-lubricated part. All internally-lubricated parts contained within the engine power plant, alternator, starter, manually-operated switches, voltage regulator, power converter/inverter, PC boards, fuel pump, and hour meter.

COACH ONLY

DELUXE APPLIANCES ●

Ice maker, trash compactor, dishwasher, built-in coffee maker, built-in food processor, in-sink disposal, basement refrigerator/freezer, central vacuum cleaner system, foldout external grill, clothes washer/dryer, ceiling fan motor, and smoke detector.

POWER STEPS ●

Factory or dealer-installed power steps, lines, fittings, cylinders, worm gears, electrical switches, wiring harnesses, and entry door floor motors and mechanisms.

LEVELING SYSTEM ●

Factory or dealer-installed electric/hydraulic leveling jacks, controllers, electrical switches, and wiring harnesses.

SLIDE-OUT ROOMS ●

Slide-out room motors, guides, tracks and hydraulic valves, sliding floor motors, electrical switches, pump/jack assemblies, and wiring harnesses.

WEAR & TEAR ●

Normal wear and tear for factory and dealer-installed parts.

EXCLUSIONARY COVERAGE ●

Covers all factory and dealer-installed parts not listed in the Exclusions section.

ENTERTAINMENT ●

Up to four factory or dealer-installed TV's, up to 60" (includes plasma, LED, and LCD), surround sound systems, Blu-ray™ players, digital receivers, stereo receivers, tuners, CD and DVD players, satellite systems, TV antennas and rotators, compass, global positioning system (GPS), on-board communications system, GPS satellite antenna, and electronic driver information display and module.

INTERIOR & EXTERIOR ●

Factory or dealer-installed hood latches and springs, door handles, latches, and springs, door chimes, heated seats, power seat systems and tracks, clocks, courtesy map light assemblies, power window curtain motors/shade motors, awning motors, awning mechanisms (cover excluded), awning sensors, shore power cords and retractors, intercoms, air horns, and spotlights.





WWW.NAENWAN.COM | 877-222-1645

© National Automotive Experts 18-SRC-28-00