

OWN THE OUTDOORS

# AIR RANGE LITE

2022 TRAVEL TRAILERS



**Highland**  
RIDGE RV







# FLOORPLANS

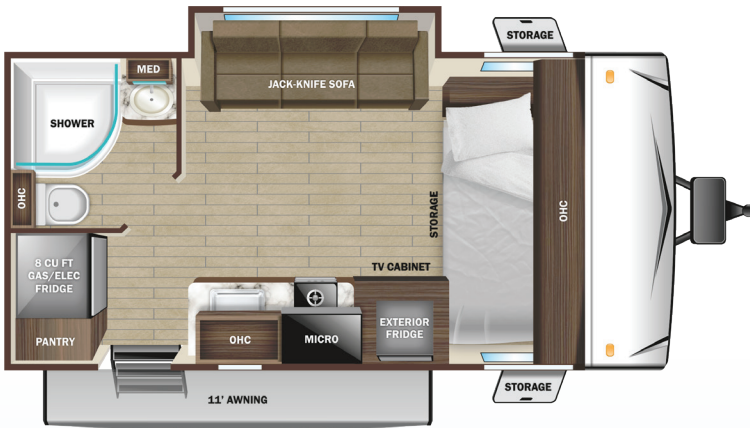

16FBS



17BH

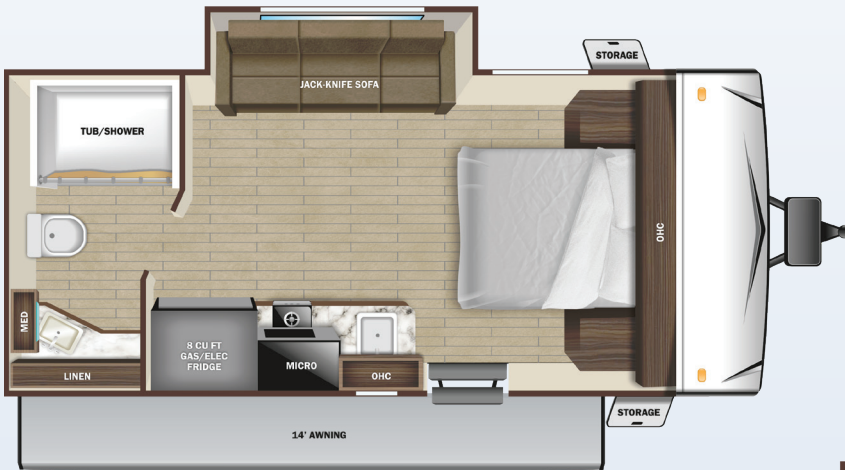

18RBS



19MBH

## STANDARD INTERIOR EQUIPMENT

- » 2-burner recessed range with flush mount glass cover
- » 75 lb. ball bearing drawer guides
- » 80" bed
- » 81" interior height
- » Bathroom skylight and roof vent
- » Cable and satellite prep
- » Convection microwave
- » Electrical outlets and USB ports in master bedroom
- » Foot flush toilet
- » Kid and pet friendly – residential vinyl flooring throughout, vinyl furniture, no floor heat registers
- » LED interior lighting
- » Rangehood
- » Residential high-rise faucet
- » Residential vinyl flooring
- » Roller blackout night shades
- » Screwed and glued hardwood cabinetry
- » Seamless pressed membrane countertops
- » Single basin stainless steel under-mount kitchen sink

## STANDARD EXTERIOR EQUIPMENT

- » 30 amp service
- » Battery disconnect
- » Dome style TV antennae with Wi-Fi prep
- » Exterior grill hookup quick connect port
- » Exterior TV prep
- » Flexible LP lines
- » Fully-walkable roof
- » Impact resistant galvanized steel wheel wells
- » Inverter pre-wire
- » Magnum Roof™ system
- » Marine grade exterior speakers (2)
- » Molded front cap with LED lighting
- » Power awning
- » PVC roofing membrane (limited lifetime warranty)
- » Rear observation camera prep
- » Rear roof access ladder
- » Single axle design

- » Solid swing-down entry steps
- » Thule® roof mount accessory rack
- » Tinted safety-glass windows throughout
- » TuffShell™ - vacuum bonded laminated construction, reinforced with heavy-duty fiberglass and welded aluminum frames

## CUSTOMER CONVENIENCE PACKAGE (MANDATORY)

- » 15" off-road radial tires with aluminum rims
- » 15,000 BTU A/C
- » 2-30 lb. LP bottles
- » 32" 12V LED TV with built in AM/FM/Bluetooth® soundbar
- » 6 gal. gas/electric DSI water heater
- » Detachable power cord
- » Power roof vent (main living area)
- » Power tongue jack
- » Roof mount solar prep
- » Rubber torsion axle with increased ground clearance adjustments
- » Side camera prep marker lights
- » Spare tire
- » Stabilizer jacks
- » Thermal Seal - enclosed, insulated, and heated underbelly and fully insulated roof with a PVC roofing membrane

## OPTIONS

- » 12V tank heat pads
- » Off-grid solar package - 180 watt panel, 30 amp controller
- » Wi-Fi router



We want you to spend less time worrying and more time owning the outdoors. That's why we're proud to back our products with a 3-Year Limited Structural Warranty, plus a 1-Year Limited Manufacturer's Warranty.

## SPECIFICATIONS

May Include Estimated Values

	16FBS	17BH	18RBS	19MBH
Unloaded Vehicle Weight (lbs.)	3,830	TBD	TBD	4,470
Dry Hitch Weight (lbs.)	440	TBD	TBD	650
Gross Vehicle Weight Rating (GVWR)	4,995	TBD	TBD	5,500
Cargo (Gross)	1,165	TBD	TBD	1,030
Exterior Length (Overall)	20' 0"	TBD	TBD	23' 6"
Exterior Height	10' 5"	TBD	TBD	10' 5"
Exterior Width	8' 4"	TBD	TBD	8' 4"
Exterior Width (Slides Out)	9' 8"	TBD	TBD	10' 10"
Interior Height	6' 6"	TBD	TBD	6' 6"
Fresh Water Capacity (Gal.)*	61	TBD	TBD	61
Gray Waste Water Capacity (Gal.)	30	TBD	TBD	30
Black Waste Water Capacity (Gal.)	30	TBD	TBD	30
LP Capacity (lbs.)	60	60	60	60
Tire Size	15"	15"	15"	15"
Awning Size	11'	12'	14'	15'

\*Includes Water Heater

TO LEARN MORE VISIT  
[highlandridgerv.com](http://highlandridgerv.com)



Highland Ridge RV – Part of the Jayco Family of Companies



Due to continual research and advances, manufacturer reserves the right to change specifications, design, price, and equipment without notice, and assumes no responsibility for any error in the literature. Some items shown are not included as standard or optional equipment.

## LOCAL DEALER INFO