

WILDWOOD 161QK FLOORPLAN

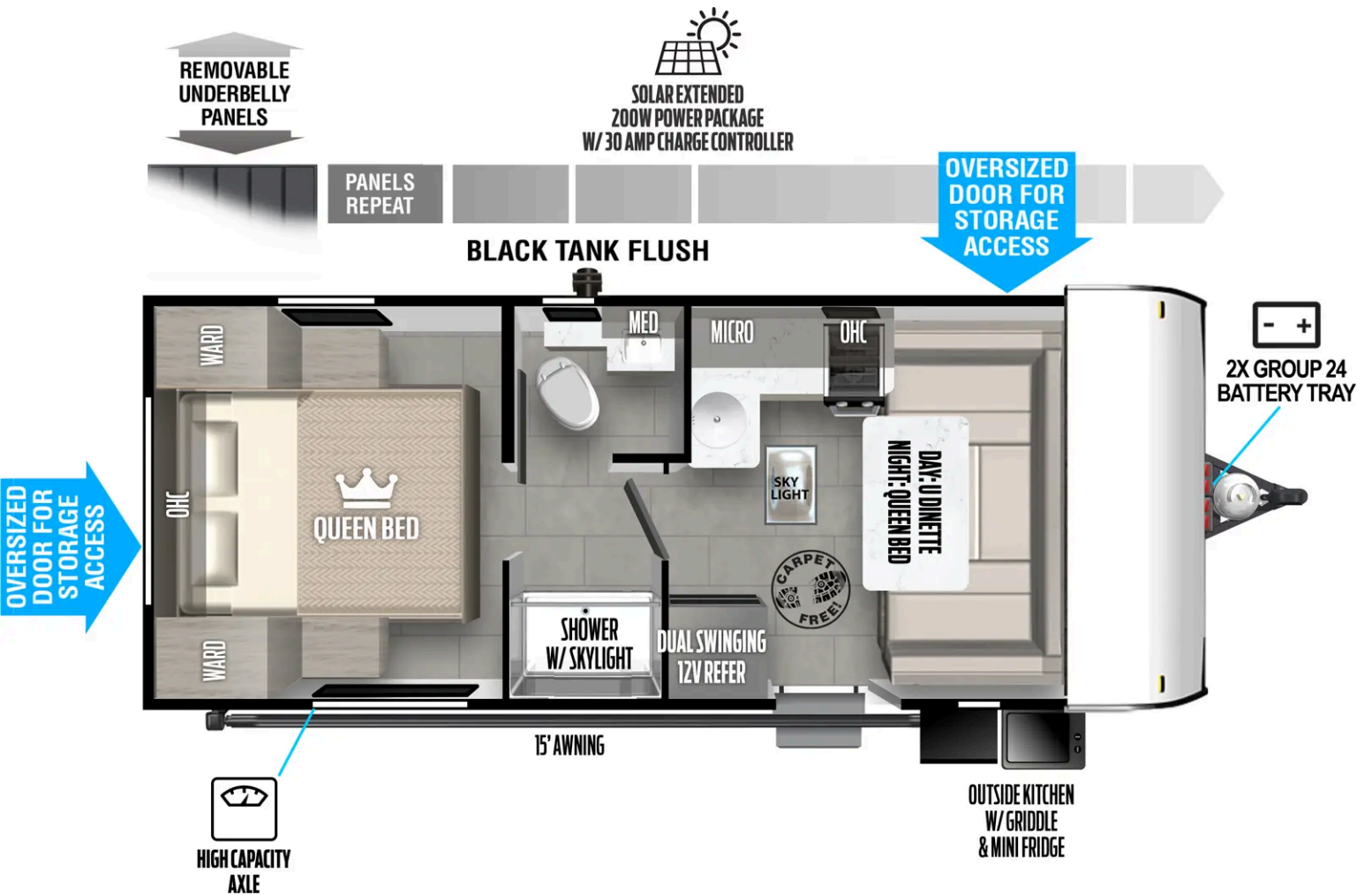

Hitch Weight	559 lb.	GVWR	4,959 lb.
UVW	3,605 lb.	CCC	1,354 lb.
Exterior Length	23' 6"	Exterior Height	10' 2"
Exterior Width	90"	Fresh Water	39 gal.
Gray Water	27 gal.	Black Water	32 gal.
Awning Size	15'		

SPECIFICATIONS DEFINITIONS

GVWR (Gross Vehicle Weight Rating) - is the maximum permissible weight of the unit when fully loaded. It includes all weights, inclusive of all fluids, cargo, optional equipment and accessories. For safety and product performance do NOT exceed the GVWR.

GCWR (Gross Combined Weight Rating) - is the maximum permissible loaded weight of your motor home and any towed trailer or towed vehicle. Actual GCWR of this vehicle may be limited by the sum of the GVWR and the installed hitch receiver maximum capacity rating; see hitch rating label for detail.

GAWR (Gross Axle Weight Rating) – is the maximum permissible weight, including cargo, fluids, optional equipment and accessories that can be safely supported by a combination of all axles.

UVW (Unloaded Vehicle Weight)* – is the typical weight of the unit as manufactured at the factory. It includes all weight at the unit's axle(s) and tongue or pin and LP Gas. The UVW does not include cargo, fresh potable water, additional optional equipment or dealer installed accessories.

*Estimated Average based on standard build optional equipment.

CCC (Cargo Carrying Capacity) ** – is the amount of weight available for fresh potable water, cargo, additional optional equipment and accessories. CCC is equal to GVWR minus UVW. Available CCC should accommodate fresh potable water (8.3 lbs per gallon). Before filling the fresh water tank, empty the black and gray tanks to provide for more cargo capacity.

**Estimated Average based on standard build optional equipment.

Each Forest River RV is weighed at the manufacturing facility prior to shipping. A label identifying the unloaded vehicle weight of the actual unit and the cargo carrying capacity is applied to every Forest River RV prior to leaving our facilities.

The load capacity of your unit is designated by weight, not by volume, so you cannot necessarily use all available space when loading your unit.

Actual towing capacity is dependent upon your particular loading and towing circumstances, which includes the GVWR, GAWR and GCWR as well as adequate trailer brakes. Please refer to the Operator's Manual of your vehicle for further towing information.

Note: Specifications are subject to change without notice.

CONSTRUCTION ADVANTAGES

- 5/8" Tongue and groove plywood floor decking
- 4" bow truss roof rafters
- Steel I-beam frame, pre-cambered for stiffer structural support
- Steel-belted, radial load range 'D' tires
- 2" wall construction, 16" (or less) on center
- Residential fiberglass insulation throughout
- 13 Ply, Cross Micro-laminated header beam above slide out
- Triple seal slide-out system for moisture barrier
- Aerodynamic front profile for easy towing
- .040 smooth aluminum front profile for added rigidity
- Diamond plate front rock guard for added protection against road debris and rock chips
- Color coded water lines
- Rotocast seamless holding tanks
- xtrmPly, one-piece, seamless PVC roof membrane

STANDARD FEATURES

- Exterior speakers
- Window valance package
- Oversized kitchen window
- Fitted sheet in bedroom with upgraded mattress
- Retractable soft shower door (most models)

- 7-way plug and safety chain holder
- Shower with surround (size varies by model)
- Cellphone, CPAP and tablet station at each side of bed (USB ports and 110V plugs)
- 30 Amp service with 13.5BTU, roof-mounted air conditioning
- Standard cable and satellite ready
- Microwave
- 60,000 BTU, on-demand tankless water heater with active freeze protection
- 3 Burner cook top
- Diamond plate front rock guard for added protection against road debris and rock chips
- Omnidirectional HD TV/FM Antenna
- Central Switch command center
- Cable/Antenna hookup on exterior
- 12V, 10' Plus Cubic Refrigerator
- Kitchen backsplash
- Light switch in bedroom, bunkroom, and living room
- Upgraded large exterior baggage doors
- Extra large Panoramic tinted safety glass windows

BEST IN CLASS VALUE PACKAGE

- 200W expandable roof mount solar panel with 30-amp charge controller
- 10' plus cubic refrigerator
- Exterior convenience package (friction hinge entry door, magnetic latches on baggage doors and XL grab handle)
- Battery disconnect
- Black tank flush

- External led strip lighting
- Green package (solar prep and led interior lighting)
- Portable Bluetooth speaker system
- Power awning with adjustable legs
- Seamless countertop
- 60,000 BTU on demand tankless water heater with active freeze protection
- Upgraded appliance package
- USB charging port package

FSX FAMILY CAMPING PACKAGE

- 13.5 BTU roof mounted Air conditioning
- Cable/Satellite prep and TV Ready
- Foot flush toilet
- Power vent fan
- Radial tires
- Spare tire and carrier
- Shower surround
- Tv antenna with booster
- Four stabilizer jacks (2 only on 175BHLE)

OPTIONS

- Exterior Camp kitchen (T161QK, T178BHSK, T179DBK, T189RSK)
- Fiberglass exterior sidewalls
- OHV Wheel package (single axles)
- OHV Wheel package (double axles)
- Enclosed holding tanks