

**DYNAMAX**

A DIVISION OF FOREST RIVER

WE'RE PERFORMANCE DRIVEN



*isata*<sup>5</sup>





36DS shown with Espresso decor.

## Isata 5 Standard Features

### Chassis

- Ram® 5500 SLT Chassis; 6.7L I6 Cummins® Turbo Diesel 325hp/750 lb.-ft. of Torque
- AISIN HD 6-Speed Automatic Transmission
- GVWR: 19,500 lbs.
- GCWR: 37,500 lbs.
- Optional: Factory 4-Wheel Drive "On The Fly" Chassis (Long Lead Time)
- Fuel Capacity: 74 Gallons (Dual Tanks)
- 8 Gallon Diesel Exhaust Fluid Tank
- B-20 Bio Diesel Capability
- Trailer Hitch (10,000 Tow lbs./1,000 Tongue lbs.) with 7-Way Round Tow Connection
- Trailer Brake Control
- Exhaust Brake
- Ram® Active Air
- Electronically Controlled Throttle
- Ram® ESC Suspension And Stability
- 4-Wheel ABS
- Cold Weather Group Package
- Dual 80AH 12V Chassis Batteries
- Emergency Start Switch
- Dual 220-Amp Alternators (440 Amps Total)
- Ram® 50KSI Chassis Construction
- Steel Frame
- Full-Coverage Rust-Prohibitive Heavy Duty Undercoating
- 4.88 Rear Axle Ratio
- Daytime Running Lights
- Running Boards
- Front and Rear Tires: 225/70R19.5G All Position Front and Rear Traction
- Front: 19.5" x 6.0" Polished Forged Aluminum Wheels
- Rear: Dual 19.5" x 6.0" Polished Forged Aluminum Wheels
- Remote Keyless Entry
- Leatherette Reclining Captains Chairs - Driver and Passenger
- ParkView™ Rear Back-Up Camera
- Radio - 8.4" LCD Touch Screen with U-Connect, Hands-Free Voice Command with Bluetooth, Sirius/XM Radio, Media Hub (SD, USB, AUX), Navigation-Capable; Six (6) Speakers
- Temperature And Compass Gauge with Traveler/Mini-Trip Computer

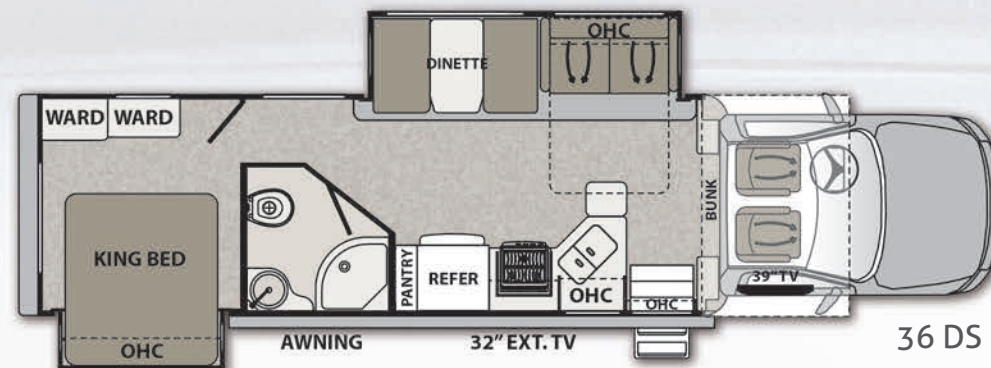
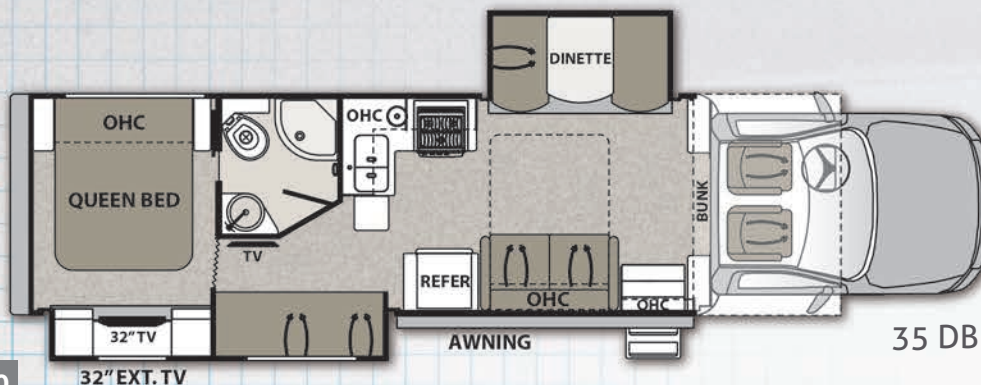



# & Options

- 12V and USB Accessory Ports
- Cruise Control
- Carpet Cab Mat
- Adjustable/Tilt Steering Wheel
- Heated/Remote Exterior Mirrors with Courtesy Lamps and Turn Signals
- Power Windows and Locks
- Three-Point Seat Belts - Driver and Passenger
- Safety Air Bags - Frontal and Side Impact
- Electronically Controlled Dash Air Conditioning
- Drink Holders

## Construction

- 2" Aluminum Framed, Laminated Sidewalls
- Gel-Coat Fiberglass Skin with Azdel Backer
- 2" Aluminum Framed Floor
- Aluminum Truss-Structured Roof
- Fiberglass Roof
- Front Fiberglass Cap and Transitions
- Stylish Rear Fiberglass Cap
- R-8 Insulated Sidewalls; R-19 Insulated Roof; R-8 Insulated Floor
- Automatic Power Hydraulic Leveling Jacks
- Dark-Tinted, Frameless Windows
- Seamless Easy-Clean Rotocast Storage Compartments
- Electric Slide System

## Exterior

- Premier Full Body Paint Package with Diamond Shield
- Side-Mounted, Armless, Dual Pitch Patio Awning with LED Lighting and Motion-Activated Retraction
- LED Exterior Patio Light
- Slideout Toppers
- Radius-Top Entry Door with Deadbolt Lock; Frameless Window with Shade
- Lighted, Acrylic Entry Grab Handle
- Exterior Power Entry Step
- Exterior Wall-Mounted Entertainment Center with 32" LED TV, AM/FM/CD/DVD Radio
- Side-Hinged, Locking Exterior Storage Doors with Paddle Latches
- Front and Rear LED Clearance and Marker Lighting



The Isata 36DS master bedroom is furnished with a comfortable king sized iCool™ mattress. In addition, USB and 110V outlets on both sides of the bed provide convenient charging for all your devices.



The contemporary, vessel bowl sink maximizes usable counter space.

## Interior

- Sofa with Fold-Over Bed
- Wrap-Around Booth Dinette
- Front Cab-Over Bunk Area with Mattress (54" x 80")
- Beauflor® Premium Vinyl Flooring
- Deluxe Carpet with Pad (Slideout)
- Soft-Touch Vinyl Ceiling
- LED Recessed Ceiling Lighting
- Coordinating Fabric Valances with Quick Change Fabric Panels
- Day and Night Roller Shades
- Cherry Vinyl-Wrapped Stile Cabinets with Hardwood Raised Panels Doors
- Hidden Hinge Cabinet Door Hardware
- Full Extension, Soft-Close Drawer Guides
- Lighted Entry with Non-Skid Rubber Steps and Risers
- Heat Shield Front Privacy Shades
- Privacy Curtain for Cab-Over Bunk
- Blu-Ray® Home Theater AM/FM/CD/DVD Sound System (Living Area)
- 39" LED TV with Full-Function Remote, Antenna, Booster and Jack (Living Area)
- Optional: Front Entertainment Center with 50" LED TV with Full-Function Remote in Cab-Over Bunk

## Kitchen

- Residential Refrigerator: Stainless Steel 16.0 cu. ft. Double-Door with Icemaker
- 3-Burner (Sealed) Gas Range with Glass Cover
- Convection Microwave Oven
- Solid Surface Galley Top

- Tile Backsplash
- Under-Mount Sink
- Solid Surface Sink Covers
- Residential Faucet
- MaxxAir® Power Vent with Rain Cover
- Kitchen Pull Out Trash Can

## Bedroom

- King Mattress (66.5" x 75") with iCool® Sleep System (Gel-Infused Memory Foam)
- Lift-Up Bed with Under-Bed Storage
- Designer Bedspread, Pillow Shams, and Pillows
- Hardwood Wardrobe Doors with Mirrors and Lighting
- LED Reading Lights
- 32" LED TV (Bedroom)
- Deluxe Carpet with Pad
- MaxxAir® Power Vent with Rain Cover
- Optional: Beauflor® Premium Vinyl Flooring in Bedroom

## Bathroom

- ABS Shower
- Shower Skylight
- Glass Shower Door
- Metal Shower Head with On/Off and Matching Faucet
- Porcelain Macerator Electronic-Flush Toilet
- Residential High-Rise Vanity Faucet with Glass Vessel Sink
- MaxxAir® Power Vent with Rain Cover

## Utilities

- Dual 12V Group 31 AGM Auxiliary Batteries
- Optional: Four (4) 12V Group 31 AGM Auxiliary Batteries

- Battery Disconnect
- 50-Amp Service
- 2000 Watt Pure Sine Wave Inverter with Charger
- Onan® 6 kW Diesel Generator with Auto Transfer Switch
- Optional: Onan® 8 kW Diesel Generator with Auto Transfer Switch
- Automatic Generator Start
- Dual Air Conditioners: Roof-Mount and Ducted 15,000 BTU with Heat-Pump
- Furnace: 42,000 BTU LP with Electronic Ignition
- Remote Thermostatically Controlled Heating and Cooling
- Tankless, On-Demand Water Heater
- Water Purification System (Whole Coach)
- 20.3 Gallon LP Tank (WC)
- LP Quick Connect
- Interior Monitor Panel with LPG/Tank/Battery Readout
- Exterior Shower (Stainless Steel Head, Hose and Valve)
- Exterior GFCI Receptacle
- Jack® Digital Antenna with LED Signal Strength Indicator
- Service Bay Cable TV/Satellite Hookup
- Prep for Roof-Mounted Satellite Dish (Backer Only)
- Black Tank Flush
- Furnace Heated Fresh and Holding Tank Compartments
- 12V High-Capacity, On-Demand Water Pump
- Carbon-Monoxide, LP Gas, and Smoke Detectors
- Fire Extinguisher
- Solar Prep
- Optional: Dual 100W Roof-Mount Solar Panels with 30-Amp Controller

Key Dimensions:	35 DB	36 DS
GVWR	19,500 lbs.	19,500 lbs.
GCWR	37,500 lbs.	37,500 lbs.
GAWR - Front	7,000 lbs.	7,000 lbs.
GAWR - Rear	13,500 lbs.	13,500 lbs.
Overall Length	35'11"	35'11"
Exterior Width	96"	96"
Wheelbase	264.5"	264.5"
Overall Exterior Height (w/15,000 BTU Roof A/C)	12'4"	12'4"
Interior Height	82"	82"
Fuel Capacity	74 Gal.	74 Gal.
Water Capacities (Gal.) Fresh/Gray/Black	95/42/42	95/42/42
LPG Capacity	20.3 Gal./86 lb.	20.3 Gal./86 lb.
Awning Length	TBD	16'

Please refer to the chart on the back cover for chart definitions.





36DS shown with Espresso decor.



### PRE-DELIVERY INSPECTION FACILITY

20,000 square feet of quality assurance. The bare essentials for a premium product. This state-of-the-art facility gives immediate daily feedback to production for quality assurance in every unit built.



Forest River, Inc. encourages our customers to purchase their Forest River products from a local dealership whenever possible for the following reasons:

- 1) Forest River, Inc. dealers are independently owned and operated businesses so priority service and scheduling is at their discretion and is often provided to customers that purchased their unit at that dealership.
- 2) Purchasing locally allows customers to establish meaningful relationships with a dealer, enhancing the RV experience through assistance with product questions, user tips or RV regulations for your state or country, and much more!
- 3) Canadian customers must meet requirements to bring an RV purchased out of the country to their home. These requirements may involve additional inspections and certifications, taxes and fees. Your local Canadian Dealer is a professional at meeting these requirements.
- 4) Scheduling timely warranty repairs and adjustments through a local dealership provides far greater flexibility and convenience to you, the customer!

It is the goal of Forest River, Inc. that all of our RV owners fully enjoy the RV experience and that customer satisfaction meets or exceeds their expectations!

At Dynamax, reaching a higher standard is not an option, it's a tradition.



**DYNAMAX**  
A DIVISION OF FOREST RIVER  
WE'RE PERFORMANCE DRIVEN

2745 Northland Dr. ■ Elkhart IN 46514  
888-295-7859 ■ [www.dynamaxcorp.com](http://www.dynamaxcorp.com)

Your Authorized Isata 5 Dealer

**GVWR (Gross Vehicle Weight Rating)** - is the maximum permissible weight of the unit when fully loaded. It includes all weights, inclusive of all fluids, occupants, cargo, optional equipment and accessories. For safety and product performance do NOT exceed the GVWR.

**GCWR (Gross Combined Weight Rating)** - Is the maximum permissible loaded weight of your motor home and any towed trailer or towed vehicle. Actual GCWR of this vehicle may be limited by the sum of the GVWR and the installed hitch receiver maximum capacity rating; see hitch rating label for detail.

**GAWR (Gross Axle Weight Rating)** - is the maximum permissible weight, including cargo, fluids, optional equipment and accessories that can be safely supported by each axle.

**UVW (Unloaded Vehicle Weight)\*** - is the typical weight of the unit as manufactured at the factory. It includes all weight at the unit's axle(s), including full fuel, all fluids and LP Gas. The UVW does not include cargo, fresh potable water, additional optional equipment or dealer installed accessories.

**CCC (Cargo Carrying Capacity)\*\*** - is the amount of weight available for fresh potable water, cargo, passengers, additional optional equipment and accessories. CCC is equal to GVWR minus UVW. Available CCC should accommodate fresh potable water (8.3 lbs. per gallon). Before filling the fresh water tank, empty the black and gray tanks to provide for more cargo capacity.

\*Estimated Average based on standard build optional equipment. \*\*Estimated average based on standard build optional equipment.

Each Forest River RV is weighed at the manufacturing facility prior to shipping. A label identifying the unloaded vehicle weight of the actual unit and the cargo carrying capacity is applied to every Forest River RV prior to leaving our facilities.

The load capacity of your unit is designated by weight, not by volume, so you cannot necessarily use all available space when loading your unit.

Actual towing capacity is dependent upon your particular loading and towing circumstances, which includes the GVWR, GAWR and GCWR as well as adequate trailer brakes. Please refer to the Operator's Manual of your vehicle for further towing information.

All information contained in this brochure is believed to be accurate at the time of publication. However, during the model year, it may be necessary to make revisions and Forest River, Inc., reserves the right to make all such changes without notice, including prices, colors, materials, equipment and specifications as well as the addition of new models and the discontinuance of models shown in this brochure. Therefore, please consult with your Forest River dealer and confirm the existence of any materials, design or specifications that are material to your purchase decision. 11/15 ©2015 Dynamax

### 24/7 EMERGENCY ROADSIDE ASSISTANCE

For a worry-free ownership experience Forest River includes one year of Coach-Net RV Technical & Roadside Assistance with each RV purchase. Whether new to the RV lifestyle or an experienced RV enthusiast, Forest River owners have 24/7 access to technical, operational and emergency road service coverage throughout the US & Canada. Coach-Net's fast, dependable service is just a phone call away.

**Coach-Net®**  
RV Technical & Roadside Assistance

**FREE MEMBERSHIP**  
to Forest River Owners' Group

[www.forestriverfrog.com](http://www.forestriverfrog.com)



**Learn More**  
Scan this barcode using a QR Reader on your smart phone to learn more about Forest River.



A Berkshire Hathaway company.