

FUZION IMPACT

FIFTH WHEEL & TRAVEL TRAILER TOY HAULERS



KEYSTONE
RV COMPANY

CAMP BETTER



KEY PERFORMANCE



2023 FUZION IMPACT SERIES | EXCEPTIONAL FEATURES

- FRAME-WELDED 5K INTERLOCK TIE-DOWN SYSTEM
- 7,000 LB. FLIPPED DEXTER® AXLES W/ ELECTRIC SELF-ADJUSTING BRAKES
- **NEW** LEAF SPRING SUSPENSION W/ WET BOLTS
- FULLY ENCLOSED, 30-GALLON FUEL PUMP STATION WITH TOUCHPAD CONTROLS
- G-RATED TIRES
- EQUALIZER™ SYSTEMS' EQ SMART LEVEL
- **NEW** KING BEDS ON ALL FIFTH WHEEL MODELS
- **NEW** GIRARD TANKLESS WATER HEATER
- EASY-ACCESS, EXTERIOR CONVENIENCE CENTER
- SPACE SAVING, SWING OUT BAR STOOLS
- HARDWOOD CABINETRY
- OMNI-CHILL™ 3/4 TON HIGH EFFICIENCY A/C
- SOLARFLEX™ 200, 400i, AND 600i-L SOLAR POWER PACKAGES W/ OPTIONAL DRAGONFLY ENERGY® LITHIUM-ION BATTERIES



"We chose the Impact 415 due to it being lightweight and very roomy for my family. The onboard fuel and generator made it ideal for on or off-grid camping. We love the large, 15 ft garage, which is not common in other makes and models. We also took a careful look at the craftsmanship of the RV and were impressed with the quality build. The Impact configuration is also easier to tow with an older truck. We love using our Impact 415."



@RYANMOOR — IMPACT 415 OWNERS

VISIT OUR WEBSITE FOR PHOTOS,
360° TOURS, AND FULL PRODUCT DETAILS



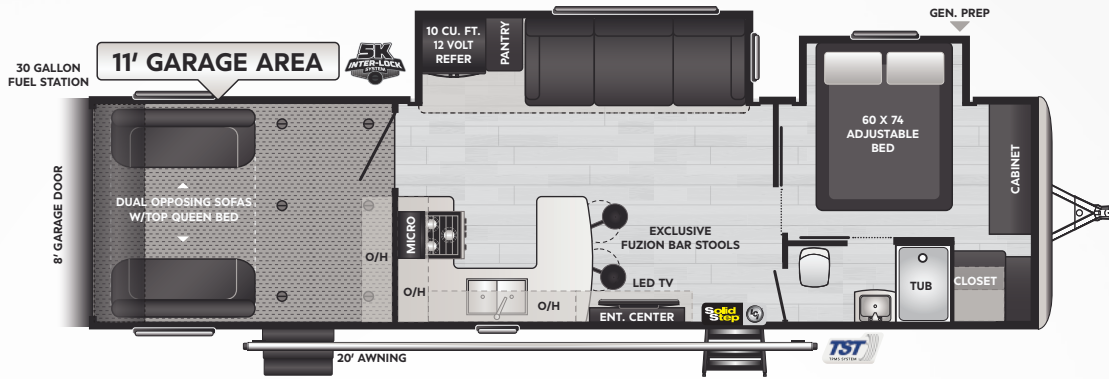

317 | WEIGHT 9700 | LENGTH 37' 6"

▪ U-SHAPED KITCHEN, SWING OUT STOOLS, TWO SLIDES, 11' GARAGE

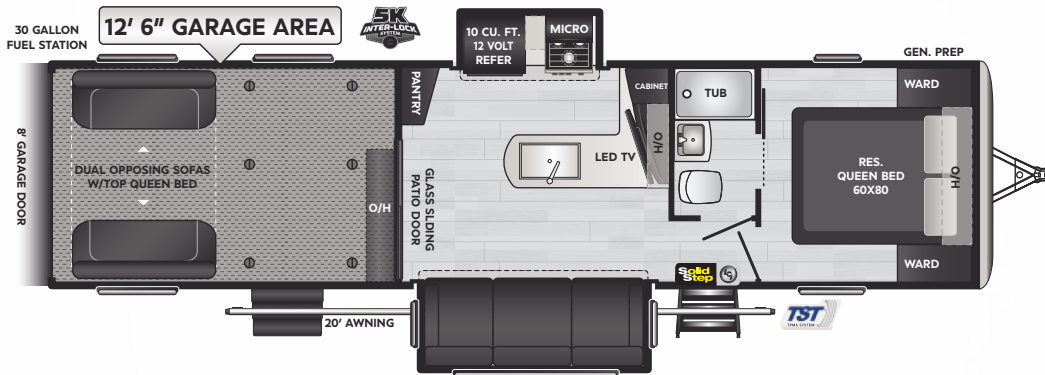

330 | WEIGHT 9786 | LENGTH 37' 6"

▪ ANGLED ENT. CENTER, TWO SLIDES, 12' 6" GARAGE

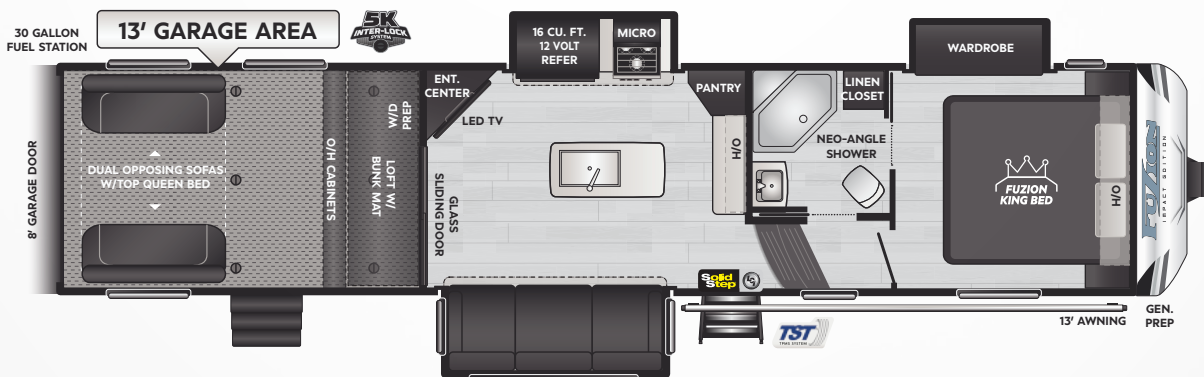

343 | WEIGHT 12694 | LENGTH 39' 0"

▪ TANDEM-AXLE, KITCHEN ISLAND, THREE SLIDES, 14' GARAGE

SALE OFFER

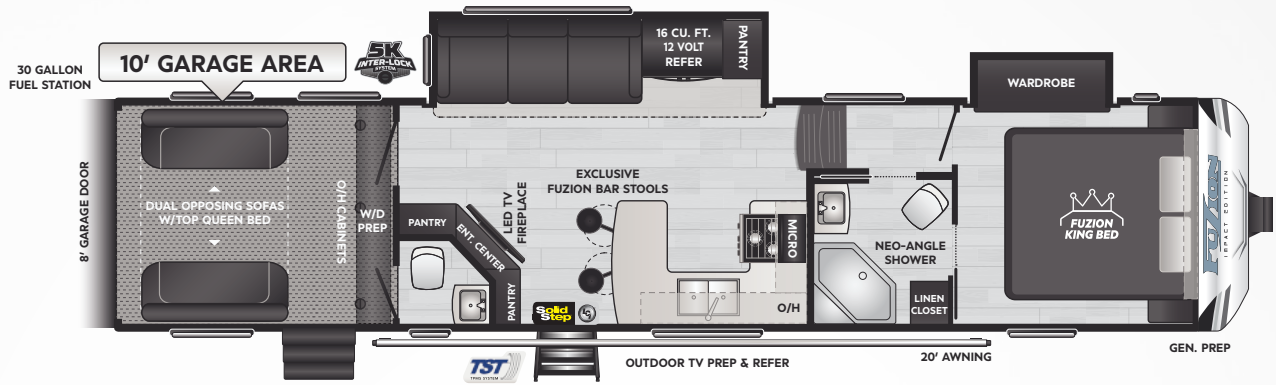

359 | WEIGHT 12915 | LENGTH 39' 0"

▪ U-SHAPED KITCHEN, TANDEM-AXLE, BATH AND A HALF, 10' GARAGE

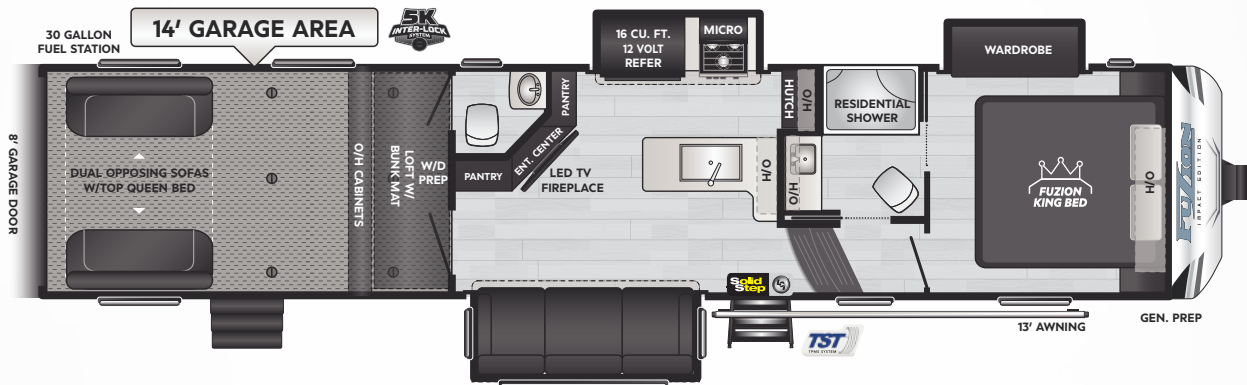

367 | WEIGHT 13269 | LENGTH 40' 2"

▪ TANDEM-AXLE, BATH AND A HALF, 12 CU. FT. REFER, 14' GARAGE

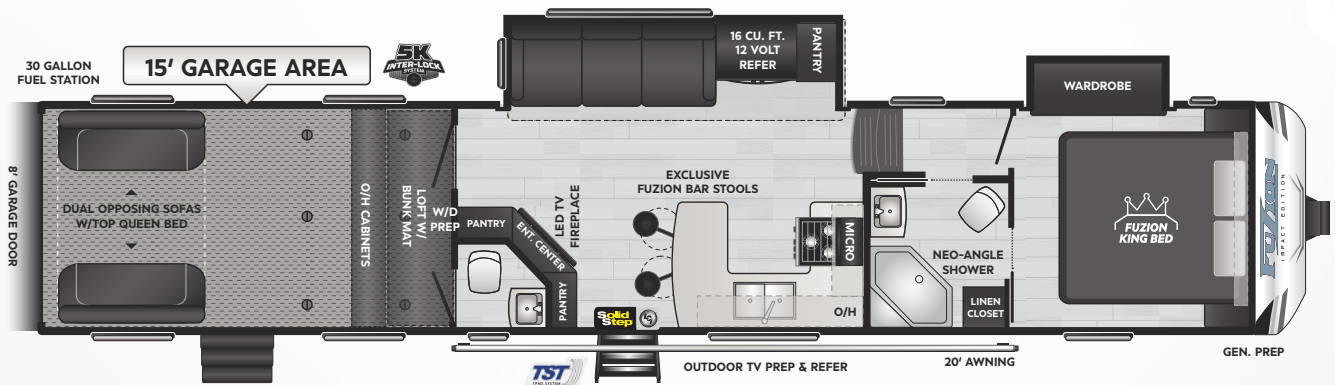

415 | WEIGHT 14154 | LENGTH 44' 0"

▪ U-SHAPED KITCHEN, TRIPLE-AXLE, BATH AND A HALF, 15' GARAGE

SALE OFFER

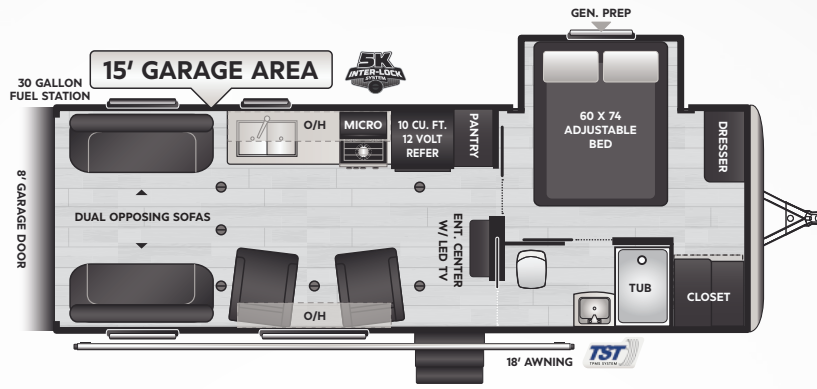

25V | WEIGHT 7219 | LENGTH 28' 10"

▪ LIGHTWEIGHT, OPEN CONCEPT, 15' GARAGE

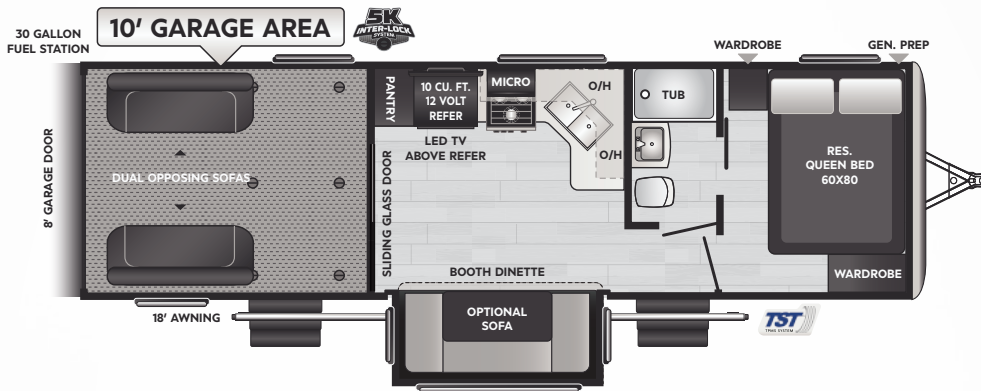

28V | WEIGHT 7772 | LENGTH 32' 8"

▪ LIGHTWEIGHT, ONE SLIDE, 10' GARAGE

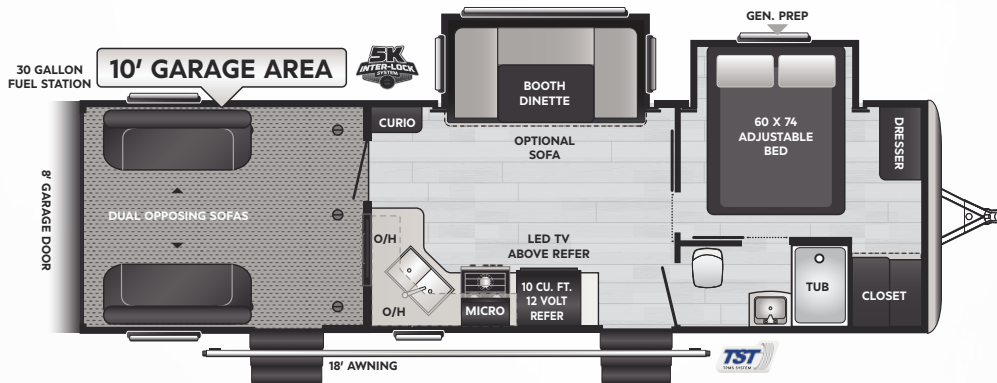

29V | WEIGHT 8328 | LENGTH 33' 10"

▪ LIGHTWEIGHT, TWO SLIDES, 10' GARAGE

MODEL	WEIGHT	CARRYING CAPACITY	HITCH WEIGHT	FRESH WATER**	WASTE WATER	GRAY WATER	LPG	LENGTH*	WIDTH	HEIGHT	AWNING
317	9700	3300	1680	94	30	60	60	37' 6"	8' 4"	12' 4"	20'
330	9786	3214	1415	94	30	60	60	37' 6"	8' 4"	12' 4"	20'/12'
343	12694	4206	2905	94	44	86	60	39' 0"	8' 4"	13' 1"	13'
359	12915	3965	2880	94	88	88	60	39' 0"	8' 4"	13' 1"	20'
367	13269	3681	2950	94	88	88	60	40' 2"	8' 4"	13' 3"	13'
415	14154	4846	3155	94	88	88	60	44' 0"	8' 4"	13' 3"	20'
25V	7219	2581	1015	54	30	30	60	28' 10"	8' 4"	12' 2"	18'
28V	7772	2228	1225	54	30	30	60	32' 8"	8' 4"	12' 2"	18'
29V	8328	1672	1225	54	30	60	60	33' 10"	8' 4"	12' 2"	18'

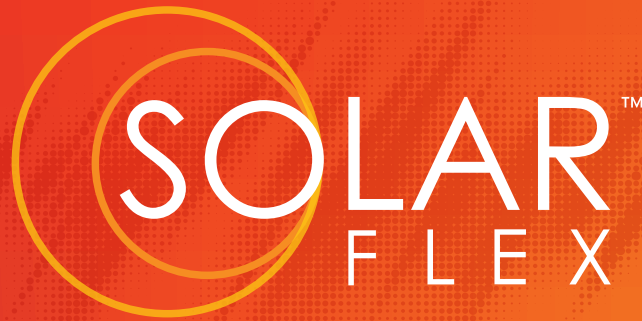

TAKE CHARGE OF HOW YOU CAMP

EXCEPTIONAL QUALITY, IMPOSSIBLY VERSATILE, SolarFlex™ IS SHATTERING CUSTOMER'S EXPECTATIONS OF FACTORY-INSTALLED SOLAR POWER. EXCLUSIVELY AVAILABLE ON ALL KEYSTONE RV MODELS.



Relieve battery anxiety with legendary Lithium-ion deep cycle batteries – the ultimate replacement for lead acid. Lightweight, reliable, and longer-lasting, Dragonfly Energy batteries are made in the USA and available exclusively from Keystone RV and authorized dealers.

MY KEYSTONE OWNER'S APP

THE ONLY APP YOU'LL NEED...

» MANUALS & QUICK START GUIDES

» HOW-TO VIDEOS



» FIRST-TIME CAMPER'S ADVICE

» ACCESS TO YOUR RV'S MOBILE APPS

Available for iOS and Android devices.



FOLLOW US FOR THE LATEST!



DISCLAIMER: Product information is as accurate as possible as of the date of publication of this brochure. All features, floor plans, and specifications in this brochure are subject to change without notice. Please also consult Keystone's web site at www.keystonerv.com for more current product information and specifications. Tow Vehicle Disclaimer. CAUTION: Owners of Keystone recreational vehicles are solely responsible for the selection and proper use of tow vehicles. All customers should consult with a motor vehicle manufacturer or their dealer concerning the purchase and use of suitable tow vehicles for Keystone products. Keystone disclaims any liability or damages suffered as a result of the selection, operation, use or misuse of a tow vehicle. KEYSTONE'S LIMITED WARRANTY DOES NOT COVER DAMAGE TO THE RECREATIONAL VEHICLE OR THE TOW VEHICLE AS A RESULT OF THE SELECTION, OPERATION, USE OR MISUSE OF THE TOW VEHICLE. *Length is defined as the distance from the centerline of hitch pin/coupler to rear bumper of trailer. ** Fresh water capacity includes water heater. Please review owner's manual prior to purchase for more information on service warranties, extended use, towing and maintenance. Owner's manuals can be found at keystonerv.com. PRINT 02.2023