

SALEM HEMISPHERE



SALEM HEMISPHERE



HYPER-LYTE TRAVEL TRAILERS

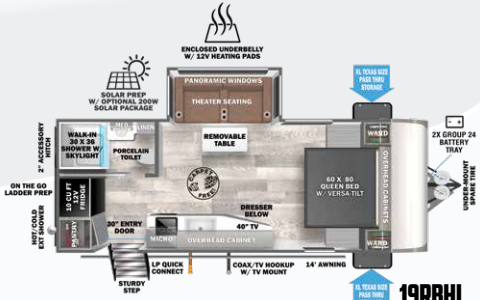

19RBHL
 UVW = 5,403 lb
 Length = 24'

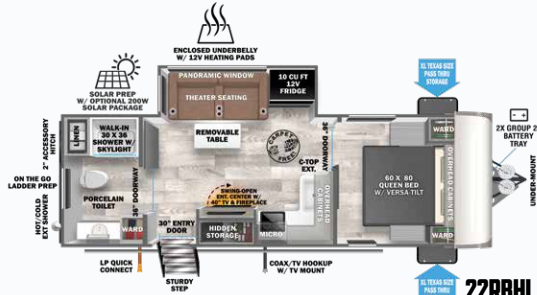

22RBHL
 UVW = 6,198 lb
 Length = 27' 6"

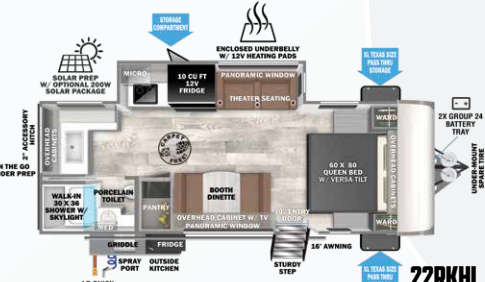

22RKHLL
 UVW = 6,128 lb
 Length = 26' 10"

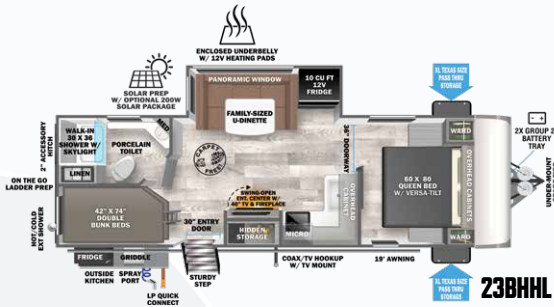

23BHHLL
 UVW = 6,478 lb
 Length = 29' 11"

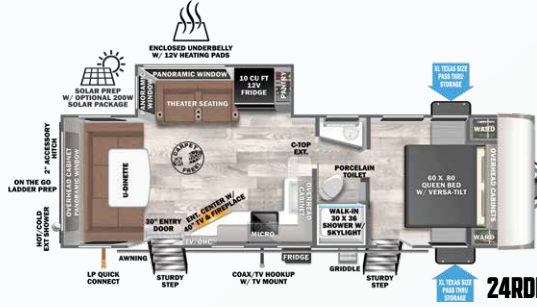

24RDHL
 UVW = 6,228 lb
 Length = 29' 11"



25BHHLL
 UVW = 7,028 lb
 Length = 33' 11"



25RBHL
 UVW = 6,678 lb
 Length = 30' 10"

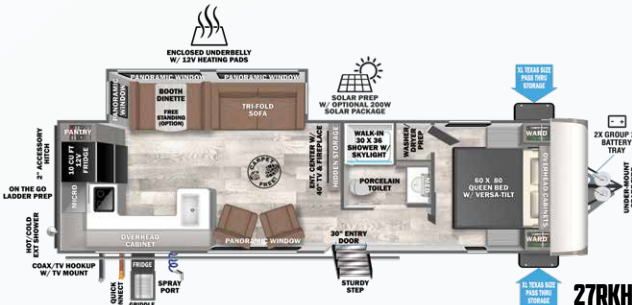

27RKHLL
 UVW = 6,758 lb
 Length = 34' 0"



29XBHL
 UVW = 7,173 lb
 Length = 36' 10"

SCAN FOR SPECS
 & MORE INFO



24RDHL

TRAVEL TRAILERS

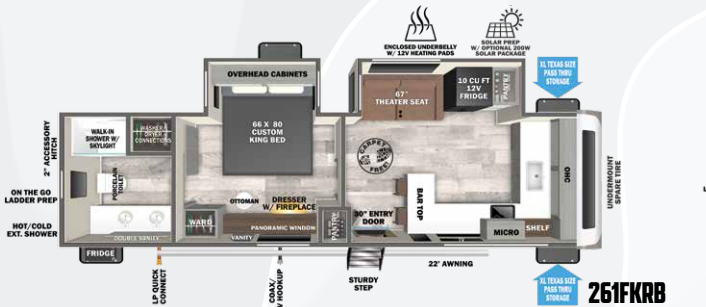

261FKRB
UVW = 7,553 lb
Length = 31' 5"

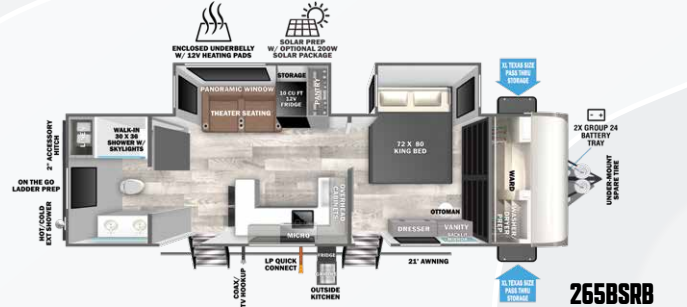

265BSRB
UVW = 7,858 lb
Length = 33' 2"

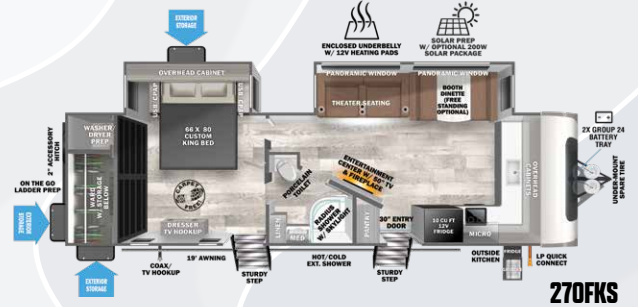

270FKS
UVW = 8,243 lb
Length = 33' 1"



271RL
UVW = 8,268 lb
Length = 33' 10"

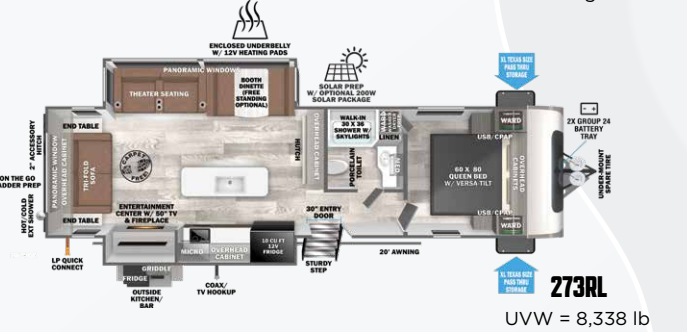

273RL
UVW = 8,338 lb
Length = 33' 10"

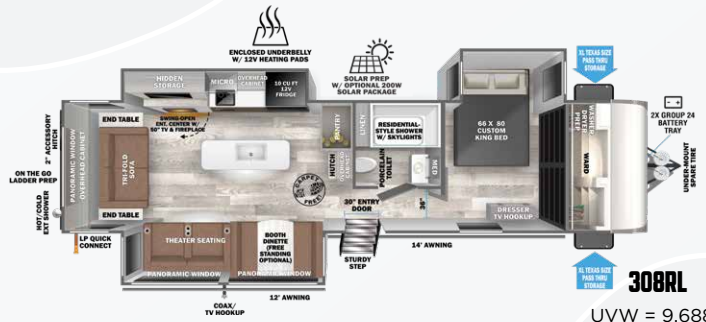

308RL
UVW = 9,688 lb
Length = 37' 11"

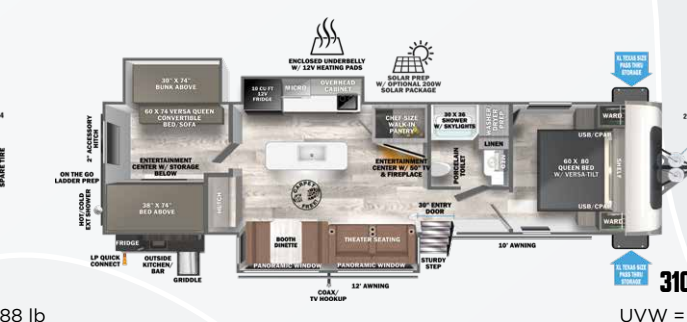

310BHI
UVW = 9,538 lb
Length = 37' 8"



314BUD
UVW = 8,873 lb
Length = 38' 9"



322VIEW
UVW = 9,309 lb
Length = 37' 10"



261FKRB

SCAN FOR SPECS & MORE INFO



FIFTH WHEELS



286RL
UVW = 9,380 lb
Length = 33' 11"

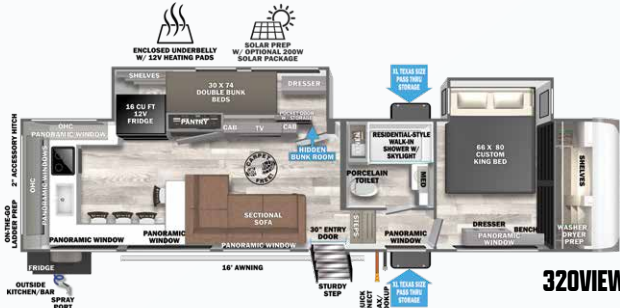

320VIEW
UVW = 10,269 lb
Length = 37' 11"

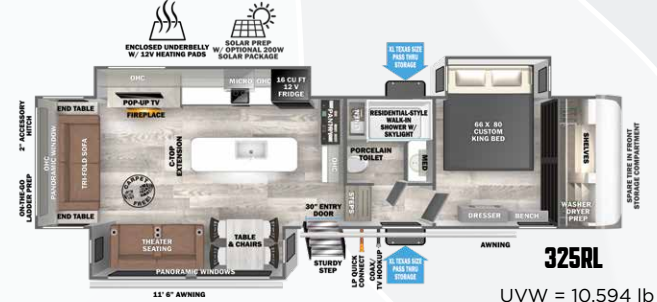

325RL
UVW = 10,594 lb
Length = 37' 8"

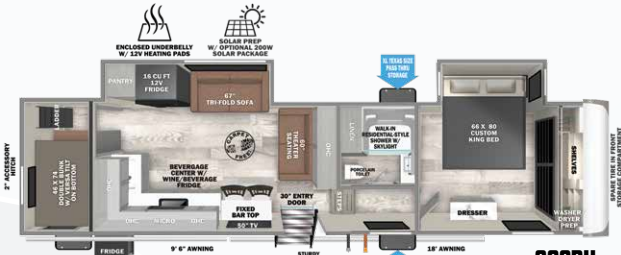

328BH
UVW = 10,064 lb
Length = 37' 10"

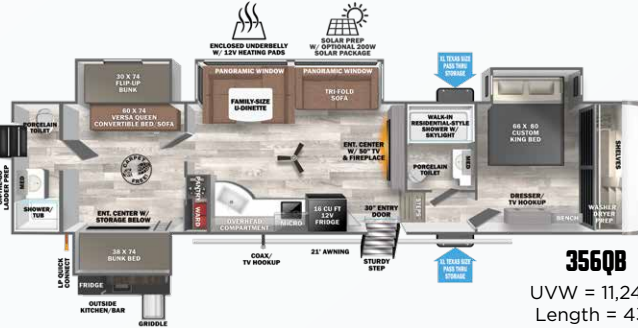

356QB
UVW = 11,249 lb
Length = 43' 0"

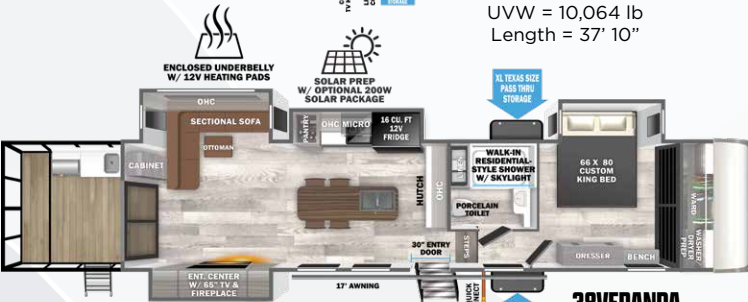

38VERANDA
UVW = 13,309 lb
Length = 43' 3"



369BL
UVW = 11,669 lb
Length = 43' 0"



375FAM
UVW = 12,904 lb
Length = 42' 9"

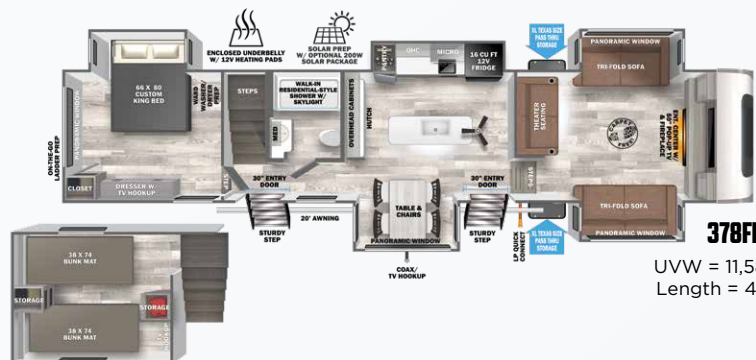

378FL
UVW = 11,589 lb
Length = 43' 6"



328BH

SCAN FOR SPECS
& MORE INFO



ELITE FIFTH WHEELS

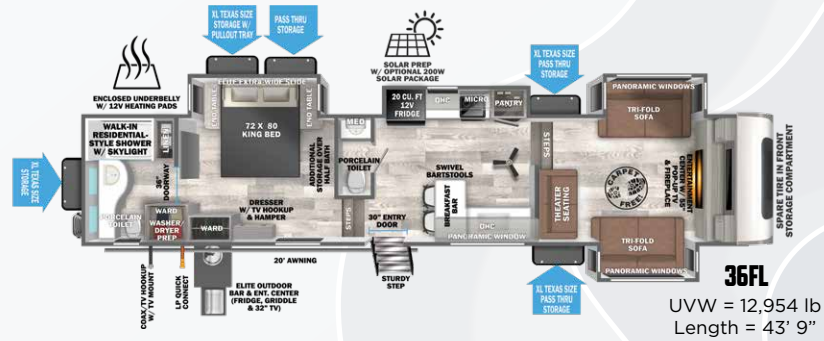
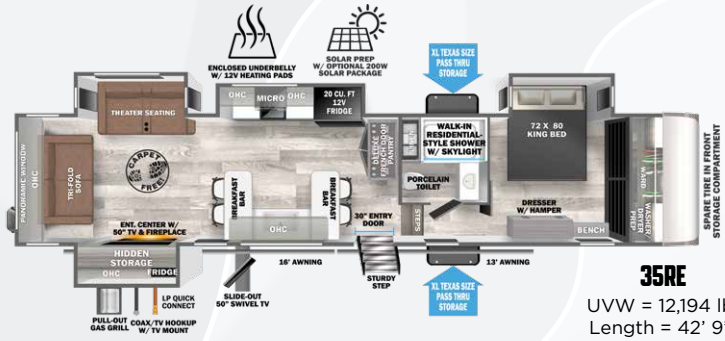

SCAN FOR SPECS
& MORE INFO



INTRODUCING . . . THE ROOST43! TWO INNOVATIVE LEVELS, ONE DISTINCTIVE FIFTH WHEEL.

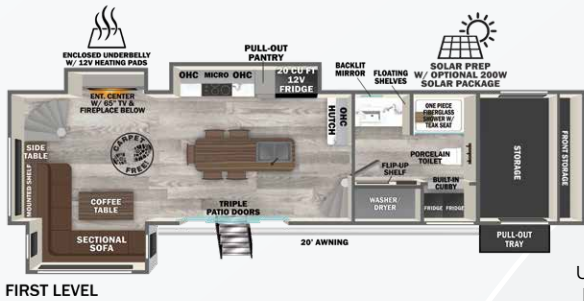

HEMISPHERE LAMINATED TRAVEL TRAILER CONSTRUCTION

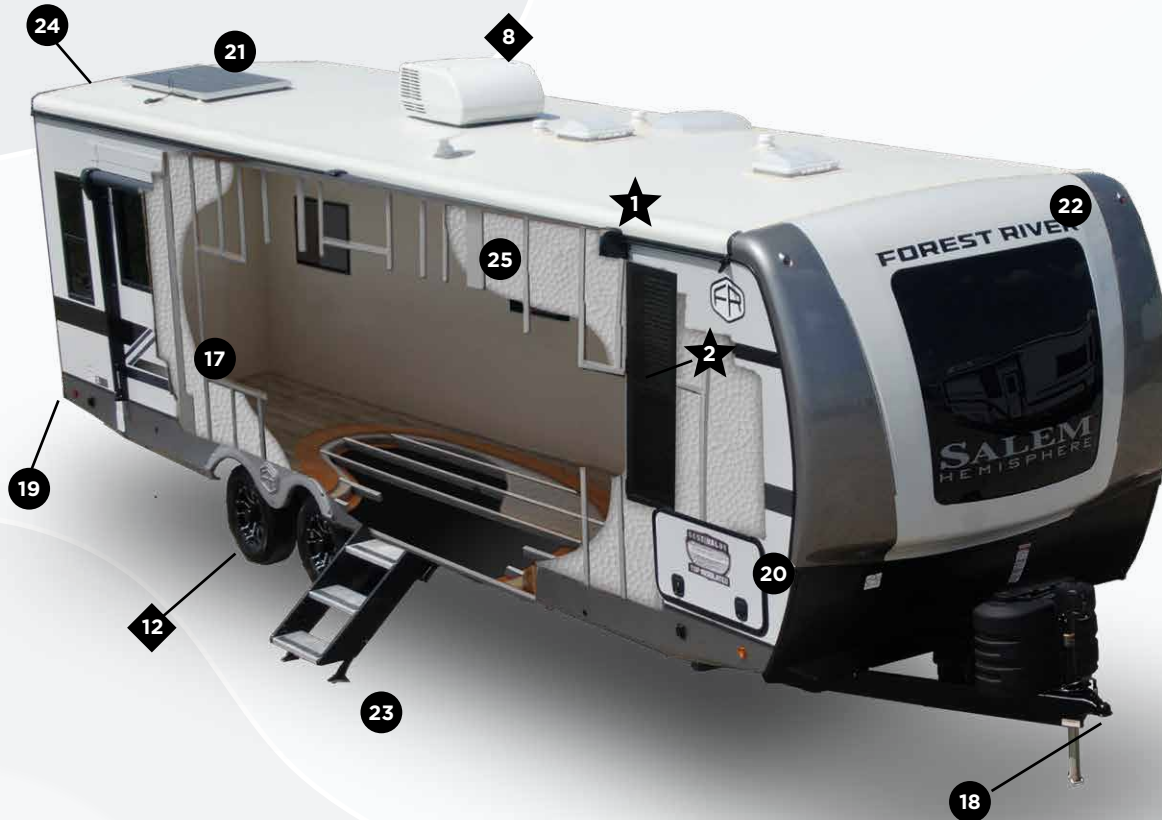

STAND OUT INTERIOR FEATURES



SQUARE TINTED WINDOWS



VERSA-TILT POWER BED



JBL SOUND SYSTEM



UPGRADED INTERIOR LIGHTING

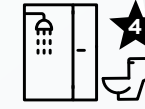

RESIDENTIAL STYLE BATHROOM

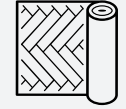

HEMISPHERE IS A CARPET-FREE RV

STAND OUT EXTERIOR FEATURES

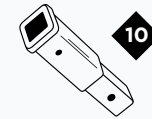

2" ACCESSORY HITCH RECEIVER



PREPPED FOR SOLAR



AUTO GRADE PAINTED FRONT CAP

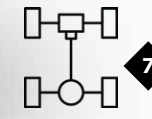

WIDE STANCE AXLES

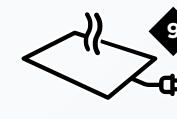

ENCLOSED UNDERBELLY WITH HEATED TANK PADS



WEATHERSHIELD FIBERGLASS ROOF

★ ELEVATED VALUE PACKAGE (INCLUDED)

1. WeatherShield one piece fiberglass roof
2. Square windows have built-in shades with reflective thermal foil backing & painted hardwood interior trim
3. Versa-Tilt power bed mechanism with appx 14.5" of additional walk-around space (N/A bed-slide models)
4. 60K BTU on-demand tankless water heater
5. JBL Sound System (head unit, interior speakers, & exterior speakers)
6. Ultimate Interior Lighting Upgrade: LED strip lighting (Main Living) & 4K LED recessed can lighting

◆ EXPEDITION PACKAGE (INCLUDED)

7. Wide stance axles (appx 42" hub to hub)
8. 15K BTU Quiet Cool A/C on race track duct system
9. Enclosed Accessibly underbelly with 12V heated tank pads
10. 2" Accessory hitch receiver
11. 4 storage bins included under bed*
12. MAXXIS radial tires with black-accented aluminum rims
13. 60" x 80" beds in all main bedrooms (72" x 80" bed in select models)*
14. Outside kitchen w/ griddle, fridge & spray port (N/A 19RBHL, 271RL, 308RL & 322VIEW)*
15. 50" LED Smart TV (40" TV in Hyper Lytes)*
16. Power stabilizer jacks (opt. on Hyper Lytes)*

● STANDARD FEATURES

17. Vacuum bonded "Aluma Frame" sidewalls
18. Power tongue jack with LED docking light
19. Outside shower with hot & cold water
20. Extra large pass through storage with slam latch baggage doors & magnetic catches
21. Solar panel & charge controller prepped (optional solar upgrade shown in image)
22. Automotive grade painted front cap with automotive grade gel coat
23. Step Above aluminum steps at main entry
24. Back-up/observation camera prep at back of unit
25. Block foam insulation
26. 10 CU FT (12V) refrigerator*

HEMISPHERE LAMINATED FIFTH WHEEL CONSTRUCTION



STAND OUT INTERIOR FEATURES

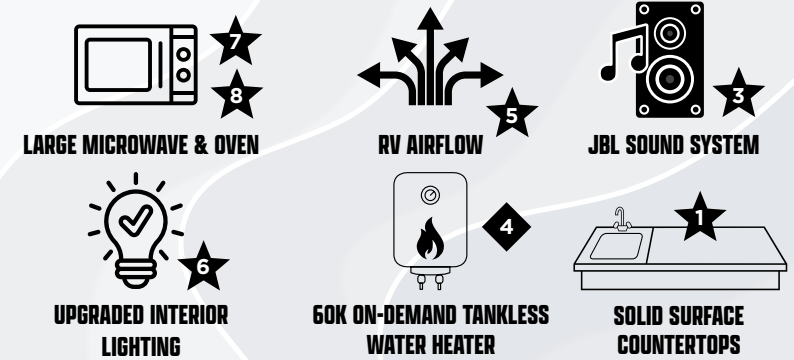

STAND OUT EXTERIOR FEATURES

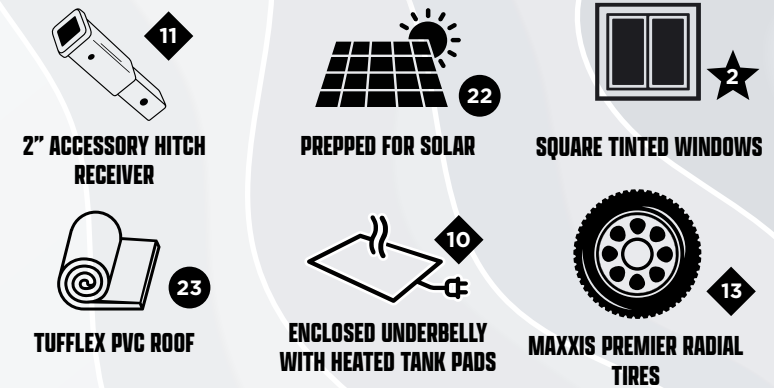

★ ELEVATED VALUE PACKAGE (INCLUDED)

- High end Solid Surface countertops
- Square windows have built-in shades with reflective thermal foil backing & painted hardwood interior trim
- JBL Sound System (head unit, interior speakers, & exterior speakers)
- 60K BTU on-demand tankless water heaters
- RV Airflow Mechanism: test results show at least 25% better airflow
- Ultimate Interior Lighting Upgrade: LED strip lighting (Main Living) & 4K LED recessed can lighting
- 1.7 cu/ft over-range 30" microwave
- Residential-styled 4-burner gas range

◆ EXPEDITION PACKAGE (INCLUDED)

- 15K BTU Quiet Cool A/C on race track duct system
- Enclosed Accessibly underbelly with 12V heated tank pads
- 2" Accessory hitch receiver (N/A 356QB, 375FAM 378FL, 38VERANDA, ROOST43 & 36FL)*
- 4 storage bins included under bed*
- MAXXIS radial tires with black-accented aluminum rims
- 50" LED Smart TV (55" in 36FL, 65" in 38VERANDA & ROOST43)*
- 30" Wide Main Entrance Door*
- Mini-Max electric fan in bathrooms*
- Outdoor Kitchen (328BH, 353BED, 356QB, 369BL, 38VERANDA & 36FL)*
- 72" x 80" King Bed in Main Bedroom (Elites & ROOST43 only)*
- In-Line Water Filtration System (Elites & ROOST43)*

● STANDARD FEATURES

- Vacuum bonded "Aluma Frame" sidewalls
- Docking station with hot and cold water*
- Prepped for solar panel & charge controller (optional solar upgrade shown in image)
- Dicor's Tufflex PVC roofing membrane
- 12V Refrigerator (16 CU FT non-Elite series; 20 CU FT Elite series and ROOST43)*
- Step Above aluminum steps (main entry doors)
- 50 AMP service with washer/dryer prep*
- Block foam insulation
- Prepped for 2nd ducted A/C (15K BTU - optional 2nd A/C upgrade shown in construction diagram)
- Full length barreled ceilings for additional head height & ~6' 5" of upper deck head room*

PACKAGES AND OPTIONS

ROOST FIFTH WHEEL

ELEVATED VALUE PACKAGE (INCLUDED)

- High-End Solid Surface & Maple-Stained Wood Countertops
- Square Windows with Built in Shades with Reflective Thermal-Foil Backing and Painted Hardwood Interior Trim
- JBL Sound System (Head Unit, Interior Speakers, Exterior Speakers & Subwoofer)
- 60K BTU On-Demand Tankless Water Heater
- (2) 15K BTU Quiet Cool Ducted Air Conditioner Units (Free 3rd A/C for Limited Time). RV Airflow System installed on all A/C's
- Side-by-Side Built-In Washer & Dryer (Free for Limited Time)
- Premium Alley Grey High-Gloss Gel Coat Fiberglass Sidewalls

EXPEDITION PACKAGE (INCLUDED)

- 20 Cubic Foot Refrigerator (12V)
- Race Track Air Conditioner Duct System (for max cooling efficiency)
- 65" LED Smart TV
- Accesibly Underbelly w/ 12V Tank Heaters on all Holding Tanks
- Triple-Paned Slider Entrance Door
- Dual Outdoor Refrigerators For Maximum Exterior Cold Storage

ADDITIONAL PHOTOS



EACH NEW FOREST RIVER PURCHASE PROVIDES:

- ✔ Pre-delivery Inspection. ✔ Digital Owner's Manual.
- ✔ Free Membership to Forest River Owners Group (FROG).
Learn more at www.forestriverfrog.com.
- ✔ A Contribution to Care Camps Foundation www.carecamps.org.
- ✔ 1 Year Free Roadside Assistance from Date of Purchase.



SPEC DEFINITIONS:

Scan on your smartphone to learn RV terminology and more!



LEARN MORE:

Scan this QR code with your mobile device to learn more about Forest River.



YOUR HEMISPHERE DEALER