

Manufacturer's Suggested Retail Price \$125,048.00

TOTAL AMOUNT DOES NOT INCLUDE STATE AND LOCAL TAXES OR LICENSE FEES. THE PRICE SHOWN ABOVE MAY OR MAY NOT BE REPRESENTATIVE OF THE ACTUAL SELLING PRICE OF SIMILAR RECREATIONAL VEHICLES IN YOUR AREA.

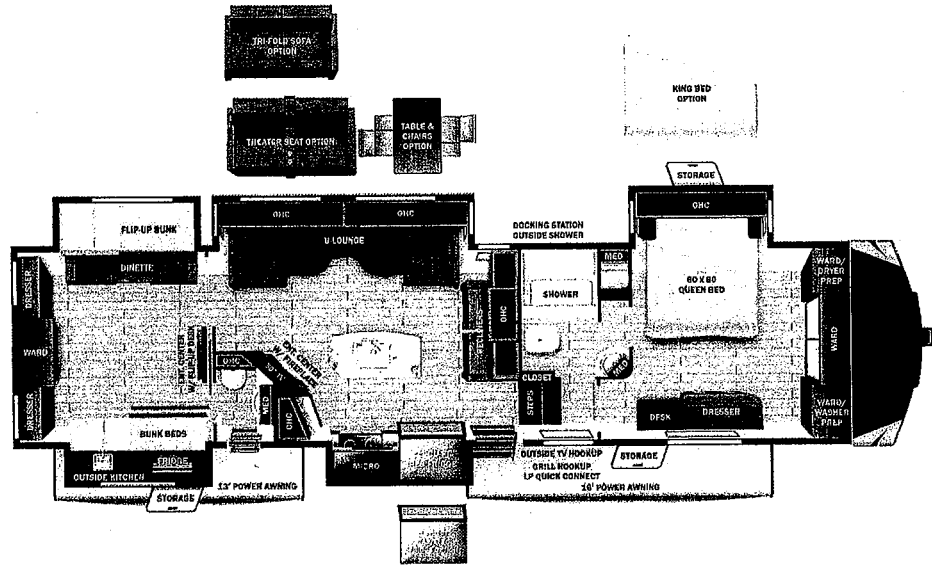

UVW
13539 lbs



Sleeps



Length
43' 7"

DIMENSIONS

Exterior height:.....155.88"
 Exterior width:.....100.00"

WEIGHTS

GVWR:.....16250
 GAWR (front):.....7000
 GAWR (rear):.....7000
 Approx. Gross Cargo Carrying Capacity (GCCC):.....2711

CAPACITIES

Fresh water tank (gals.):...75.00
 Gray water tank (gals.):...80.00
 Black water/toilet tank (gals.):.....80.00
 Propane (lbs.):.....60
 Propane (gals.):.....14
 Water heater (gals.):.....10.00

SEATING & SLEEPING

TIRES

Tire size (front):.....ST235/85R16F
 Tire size (mid):.....
 Tire size (rear):.....ST235/85R16F

Some dimensions may be rounded and may vary from the actual dimensions
 Weights may be estimated calculations and may vary from the actual weight - refer to the vehicle weight labels for actual weights
 Floorplans, features and specifications are subject to change without notice.



0
0
0
0
0
0
0
0
0
0
0
0

10

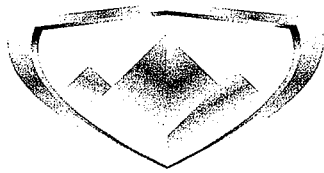

Highland

RIDGE RV

Open Range

204418



Serial #: 58TCM0BV2P3B23087
Model: 395BHS OPEN RANGE FW

Model Year: 2023 Dealer Name: ST. LOUIS RV

1080 WEST TERRA LANE
O'FALLON, MO 63366
USA

Standard Equipment

Optional Equipment

THE FOLLOWING ITEMS ARE STANDARD ON THIS MODEL AT NO EXTRA CHARGE

OPTIONAL EQUIPMENT INSTALLED ON THIS UNIT BY MANUFACTURER

EXTERIOR

- 100" wide body frame
- 1" receiver hitch
- 20 lb. LP bottles
- 30 amp service
- CCU-SLIDE™ slide system (42" deep 4-corner compression)
- Battery disconnect switch
- Mass hanger bushings with wet bolts
- Qua-Flex® axle suspension
- Exterior grill/griddle quick connect port
- Frameless windows
- Aminated block foam floor
- LevelLoc™ - 4 or 6 point automatic leveling with JT's Tong Arms®
- Marine grade exterior speakers (2)
- VC roofing membrane (limited lifetime warranty)
- Roof access ladder
- Self-adjusting electric brakes
- Spare tire
- UFFShell™ -vacuum bonded laminated construction, reinforced with heavy-duty fiberglass and welded aluminum frames

UR SEASON PACKAGE (Mandatory)

- Double insulated baggage doors
- Protected heat to underbelly with cold air return
- Enclosed cable operated gate valves
- Enclosed exterior docking station with black tank
- Heated and enclosed underbelly
- High performance furnace
- 38 reflective foil insulation in ceiling and underbelly
- 9 block foam insulation in sidewalls

INTERIOR

- 21 cu. ft. residential refrigerator
- 60" x 80" residential queen bed with storage below
- 75 lb. ball bearing drawer guides
- Cable and satellite prep
- Flush floor slides with residential vinyl flooring
- Glass shower door
- Hardwood ceiling soffit
- Hardwood slideout fascia
- Hardwood valances
- Large freestanding oven and 4-burner range
- LED interior lighting
- One-piece fiberglass shower
- Raised panel hardwood cabinet doors
- Residential convection microwave
- Roller day and night shades
- Table and chairs
- Theater seating with heat and massage
- USB ports in master bedroom
- VoiceLINK voice command system- controls lighting, heating and cooling along with TravelLINK®
- Wall controlled power vent (kitchen/living room area)
- Washer/dryer prep

EXECUTIVE PACKAGE (Mandatory)

- 13,500 BTU A/C with quiet residential return air-bedroom
- 15,000 BTU A/C with quiet residential return air-main living
- AM/FM/HDMI/USB/AUX Bluetooth® sound bar stereo with outdoor zoned speakers
- Cutting board and sink strainer
- Dome style digital TV antenna with Wi-Fi prep
- Interior convenience center light
- JBL® Aura Cube stereo with Bluetooth® and miZONE™ technology
- JBL® Premium indoor and outdoor multizone speakers
- Keyed-Unlike® entry and baggage doors
- LED HDTV
- Motion sensor lighting in bedroom and hallway
- Painted fiberglass front cap with LED lighting
- Power awning with LED lighting
- Quick recovery gas/electric water heater
- Quick release fresh water drain
- Residential high-rise faucet with pull-down sprayer
- Single basin stainless steel under-mount kitchen sink
- Solar prep
- Solid swing-down entry steps
- Solid-surface kitchen countertops
- Stainless steel appliances
- TravelLINK® - Smart RV system that allows for Bluetooth® control of awnings, lighting, slides, heating, cooling and more
- USB/12V charging port

Base price	115,6
USA Standards	
Executive Package	6,0
Four Seasons Protection Package	7
Xtend Solar II Package	1,7
Heat Pump (on Main AC)	3
21 Cu. Ft. 110 Volt Refrigerator	
No Generator Prep	
No Bedroom TV	
Windows Standard	
Power Fan Vent Wall Control	
Power Fan Vent Bathroom	
No Pin Box	
U-Lounge Sofa	
King Bed	5

UNIT TOTAL

125,04

DEALER INSTALLED OPTIONS