

R04409

# Manufacturer's Suggested Retail Price \$39,422.00

THIS PRICE IS A SUGGESTED RETAIL PRICE AND DOES NOT INCLUDE TAX, LICENSE, TITLE, AND OTHER FEES. THE PRICE SHOWN ABOVE MAY VARY FROM THE ACTUAL SELLING PRICE OF SIMILAR CREATIONAL VEHICLES IN YOUR AREA.

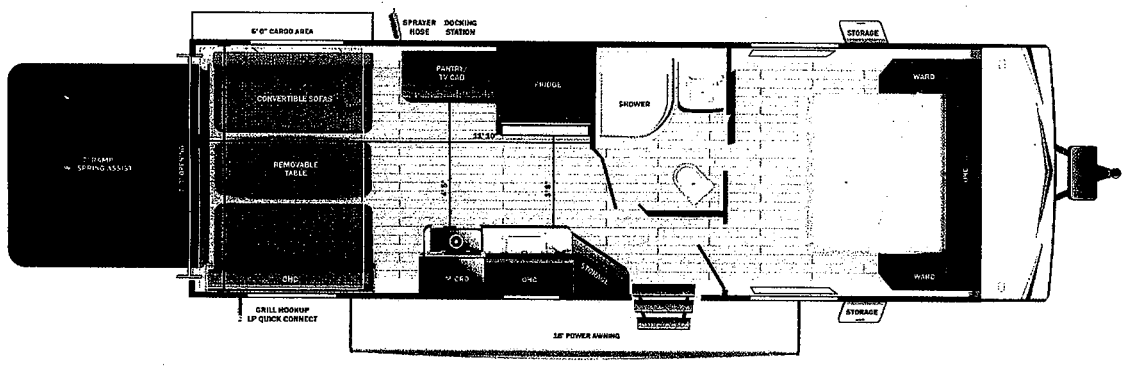

**UVW**  
5523 lbs



**Sleeps**



**Length**  
28' 4.38"

**DIMENSIONS**

Exterior height:.....125.50"  
Exterior width:.....96.00"

**WEIGHTS**

GVWR:.....7600  
GAWR (front):.....3500  
GAWR (rear):.....3500

Approx. Gross Cargo Carrying Capacity (GCCC):.....2077

**CAPACITIES**

Fresh water tank (gals.):...42.00  
Gray water tank (gals.):....39.00  
Black water/toilet tank (gals.):.....39.00  
Propane (lbs.):.....60  
Propane (gals.):.....14  
Water heater (gals.):.....6.00

**SEATING & SLEEPING**

**TIRES**

Tire size (front):.....ST205/75R14D  
Tire size (mid):.....  
Tire size (rear):.....ST205/75R14D

*Some dimensions may be rounded and may vary from the actual dimensions\*\*\*  
Weights may be estimated calculations and may vary from the actual weight  
- refer to the vehicle weight labels for actual weights\*\*\*  
Floorplans, features and specifications are subject to change without notice.*





# Highland

## RIDGE RV

# Open Range

R04409



Serial #: 58TBMSBN6P1513061  
Model: 233TH OPEN RANGE TT

Model Year: 2023 Dealer Name: ST. LOUIS RV

1080 WEST TERRA LANE  
O'FALLON, MO 63366  
USA

### Standard Equipment

### Optional Equipment

THE FOLLOWING ITEMS ARE STANDARD ON THIS MODEL AT NO EXTRA CHARGE. OPTIONAL EQUIPMENT INSTALLED BY MANUFACTURER.

#### EXTERIOR

- 120 GFCI protected receptacle
- 5/8" main floor decking
- 98" exterior width
- Black front diamond plate protection
- Exterior docking center (dual axle models)
- Detachable power cords
- Fiberglass insulation
- Flexible LP lines
- Galvanized wheel wells
- Grab handle
- In-frame battery rack
- Magnetic baggage door catches
- Magnum Roof™ system
- Marine grade exterior speakers (2)
- PVC roofing membrane (limited lifetime warranty)
- Rain gutturing with molded drip spouts
- Rear camera prep
- Safety bumper with drain hose carrier and end caps
- Self-adjusting electric brakes and E-Z Lube® axles
- Thermal Seal- enclosed, insulated, and heated underbelly and fully insulated roof with a PVC roofing membrane (dual axle models)
- Tinted safety-glass windows throughout

#### INTERIOR

- 75 lb. ball bearing drawer guides
- 81" interior height
- AM/FM/Bluetooth® radio with indoor/outdoor zoned speakers
- Closeable A/C vents
- Flush floor slides with residential vinyl flooring
- Foot flush toilet
- Hardwood cabinet doors
- LED interior lighting
- Pleated blackout night shades
- Pocket-screwed lumbercore cabinet construction
- Pressed membrane kitchen countertops
- Range hood
- Residential high-rise kitchen faucet with pull-down sprayer
- Single basin under-mount kitchen sink
- Storage below main bed

#### CUSTOMER CONVENIENCE PACKAGE (Mandatory)

- 13,500 BTU roof mounted A/C
- 17" oven (dual axle models)
- 2-burner range with glass cover (single axle models)
- 3-burner range with glass cover (dual axle models)
- Dome style digital TV antenna
- Gas/electric water heater
- Microwave
- Powered awning with LED lighting
- Powered bathroom vent
- Nitrogen filled radial tires
- Residential vinyl flooring throughout
- Solar prep
- Stabilizer jacks (4)
- Solid swing down step (main)
- Entrance door with window and shade prep
- Water heater bypass

- Base price
- CSA Standards
- Customer Convenience Package
- Xtend Solar I Package
- 15,000 BTU AC
- 8 Cu. Ft. 12v Refrigerator
- Standard Rims
- Ramp Door

UNIT TOTAL

39,

DEALER INSTALLED OPTION