

Manufacturer's Suggested Retail Price

\$46,965.00

TOTAL AMOUNT DOES NOT INCLUDE STATE AND LOCAL TAXES OR LICENSE FEES. THE PRICE SHOWN ABOVE MAY VARY FROM THE REPRESENTATIVE OF THE ACTUAL SELLING PRICE OF EQUIPMENT IN CERTAIN AREAS.

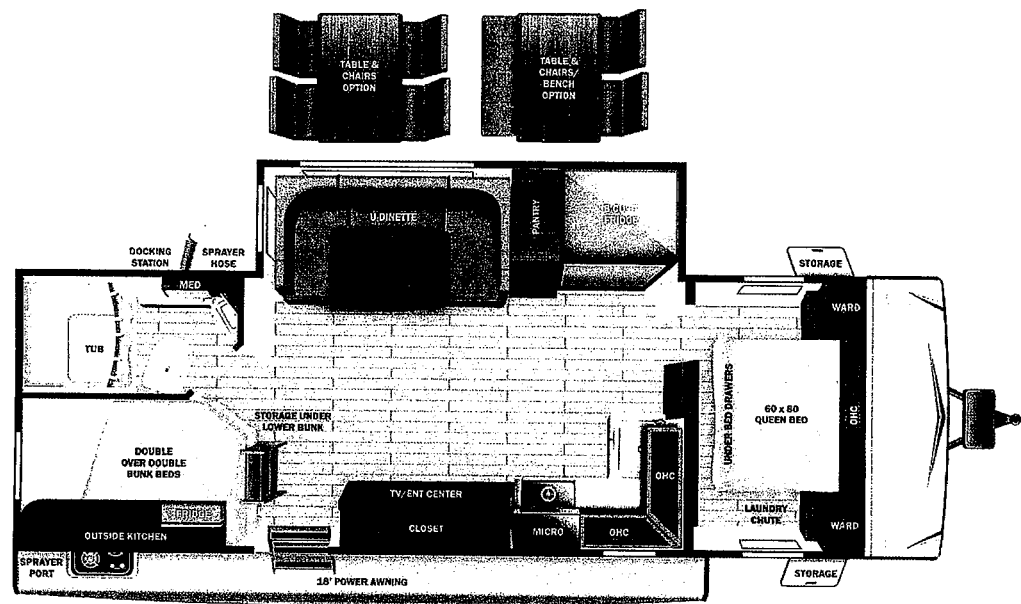

UVW
5735 lbs



Sleeps
Up to 8



Length
29' 10.5"

DIMENSIONS

Exterior height:.....132.38"
 Exterior width:.....96.75"

WEIGHTS

GVWR:.....7400
 GAWR (front):.....3500
 GAWR (rear):.....3500
 Approx. Gross Cargo Carrying Capacity(GCCC):.....1665

TIRES

Tire size (front):.....ST205/75R14D
 Tire size (mid):.....
 Tire size (rear):.....ST205/75R14D

CAPACITIES

Fresh water tank (gals.):...45.00
 Gray water tank (gals.):...58.00
 Black water/toilet tank (gals.):.....29.00
 Propane (lbs.):.....60
 Propane (gals.):.....14
 Water heater (gals.):.....6.00

SEATING & SLEEPING

Queen Bed:.....60 X 80

Some dimensions may be rounded and may vary from the actual dimensions
 Weights may be estimated calculations and may vary from the actual weight - refer to the vehicle weight labels for actual weights
 Floorplans, features and specifications are subject to change without notice.



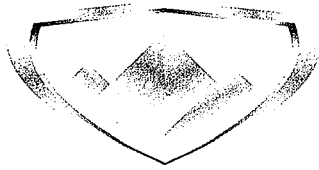

Highland

RIDGE RV

Range Lite

R04272



Serial #: 58TBH0BN3N3ED3192
Model: 241BH RANGE LITE TT

Model Year: 2022 Dealer Name: ST. LOUIS RV

1080 WEST TERRA LANE
O'FALLON, MO 63366
USA

Standard Equipment

Optional Equipment

THE FOLLOWING ITEMS ARE STANDARD ON THIS MODEL
AT NO EXTRA CHARGE

OPTIONAL EQUIPMENT INSTALLED OR
BY MANUFACTURER

- EXTERIOR**
- 5/8" main floor decking
 - Door side spray port
 - Exterior grill hookup quick connect port
 - Flexible LP lines
 - Fully-walkable roof
 - In-frame battery rack
 - Magnetic baggage door catches
 - Marine grade exterior speakers (2)
 - Oversized pass-through storage with motion lighting
 - PVC roofing membrane (lifetime limited warranty)
 - Rain gutting with molded drip spouts
 - Safety bumper with drain hose carrier and end caps
 - Self-adjusting electric brakes
 - Side camera prep marker lights
 - Solid swing-down entry steps
 - Thermal Seal - enclosed, insulated, and heated underbelly and fully insulated roof with a PVC roofing membrane
 - Tinted safety-glass windows throughout
 - TuffShell™ - vacuum bonded laminated construction, reinforced with heavy-duty fiberglass and welded aluminum frames

- INTERIOR**
- 60" X 80" queen bed with storage drawers below
 - 75 lb. ball bearing drawer guides
 - 81" interior height
 - Cable and satellite prep
 - Electrical outlets and USB ports in master bedroom
 - Flush floor slides with residential vinyl flooring
 - Hardwood cabinet doors
 - Kid and pet friendly – residential vinyl flooring throughout, vinyl furniture, no floor heat registers
 - Kitchen sink covers
 - Laundry chute in bedroom
 - LED interior lighting
 - Porcelain foot flush toilet
 - Range hood
 - Residential high-rise faucet with pull-down sprayer
 - Roller blackout night shades
 - Single basin stainless steel under-mount kitchen sink
 - Tri-fold sofa

- CUSTOMER CONVENIENCE PACKAGE (MANDATORY)**
- 15,000 BTU roof mounted A/C
 - 2-30 lb. LP bottles with cover
 - 3-burner range with 17" oven with LED lighting and flush mount glass cover
 - 8 cu. ft. refrigerator
 - AM/FM/HDMI/USB/AUX Bluetooth® sound bar stereo with indoor/outdoor zoned speakers
 - Bathroom skylight and roof vent
 - Bedspread
 - Dome style digital TV antenna with Wi-Fi prep
 - Enclosed exterior docking station with black tank flush
 - Entrance door with screen door, window and magnet door catch
 - EZ-store detachable cord
 - Foldable grab handle
 - Gas/electric DSI water heater
 - LED HDTV
 - Medicine cabinet
 - Microwave
 - Molded front cap with LED lighting and stoneguard protection
 - Porcelain foot flush toilet
 - Power awning with LED lighting
 - Power tongue jack
 - Powered 12V bathroom vent
 - Pressed membrane countertops
 - Radial tires with aluminum rims
 - Rear observation camera prep
 - Rear roof access ladder

- Base price
- USA Standards
- Customer Convenience Package
- No Solar Package
- Manual Stab Jacks
- Booth Dinette

UNIT TOTAL

46,1

DEALER INSTALLED OPTION