



## Jay Flight Bungalow



Serial #: 1UJBC0BV2S11P0172  
Model: JayLoft JAY FLIGHT BUNGALOW TT

Model Year: 2025 Dealer Name: TED'S RV LAND  
28501 STATE HIGHWAY 55  
PAYNESVILLE, MN 56362  
USA

### Standard Equipment

THE FOLLOWING ITEMS ARE STANDARD ON THIS MODEL

#### STANDARD EXTERIOR EQUIPMENT

- 102 in. wide-body construction (8' 6")
- 12 in. I-Class™ cambered structural steel I-beams
- 5/8 in. tongue-and-groove plywood floor decking
- Atrium-style front wall with integrated lights
- Axles with electric, self-adjusting brakes and easy-lube hubs
- Black tank flush sprayer
- Detachable hitch (select models)
- Electric powered slideout rooms with enclosed gear system
- Magnum Truss™ roof system
- Outside shower
- PVC roofing membrane (limited lifetime warranty)
- Radial tires with galvanized-steel, impact-resistant wheel wells

#### STANDARD INTERIOR EQUIPMENT

- 68 in. loft bedroom (40DLFT, 40LOFT, 40LSDL)
- 82 in. slideout room interior height
- 84 in. tall interior doorways
- 96 in. interior height
- Auto-ignition furnace
- Ball-bearing drawer guides, 75 lb. capacity, full-extension
- Cable/satellite prep
- Central vacuum with push button retract for easy hose storage
- Decorative dinette ceiling light
- Electric fireplace with thermostat controls
- Electrical outlets in master bedroom on each side of the bed
- Hardwood look vinyl flooring
- Hide-a-bed with tri-fold mattress
- Kitchen faucet with pull-out sprayer
- Kitchen power vent with wall control
- Living room throw pillows
- Medicine cabinet with mirror
- On-demand tankless water heater
- Pleated shades in bedroom
- Plywood bed base
- Porcelain toilet with foot flush
- Residential 12V refrigerator
- Residential-style 24 in. range and 4 burner cooktop
- Residential-style hidden cabinet door hinges
- Residential-style window treatments with wood trim
- Solid wood cabinet doors throughout
- Upgraded reading lights in master bedroom
- Vented end windows in living room and bedroom slideout rooms (select models)

#### CUSTOMER VALUE PACKAGE (MANDATORY)

- 15,000 BTU second whisper quiet A/C
- 15,000 BTU Whisper Quiet A/C
- 30 in. microwave
- 30 lb. propane bottles with cover (2)
- AM/FM/Bluetooth® stereo
- Bathroom skylight
- Ceiling fan
- Detachable power cord
- G20 dark tinted privacy windows
- LED interior and exterior lights
- Manual stabilizer jacks
- Marine grade exterior speakers
- One-piece front fiberglass wall
- Oversized side windows
- Power awning with LED light
- Power vent in bathroom
- Quilted bedspread
- Roller shades in living area
- Second A/C in loft (40DLFT and 40LOFT)
- Shower/tub surround
- Sink covers (2)
- Solid surface kitchen countertops
- Thermal Package: insulated and enclosed underbelly

### Optional Equipment

OPTIONAL EQUIPMENT INSTALLED ON THIS VEHICLE  
BY MANUFACTURER

Base price	87,218.00
USA STANDARDS	n/c
CUSTOMER VALUE PACKAGE WITH 15,000 A/C	6,300.00
RESIDENTIAL PLUMBING PACKAGE	195.00
NO 3RD AC	n/c
FIBERGLASS SIDEWALL	1,988.00
DUAL PANE TINTED SAFETY GLASS WINDOWS	2,393.00
SLIDEOUT AWNING	893.00
KING BED	90.00

UNIT TOTAL 99,077.00

DEALER INSTALLED OPTIONS

## Manufacturer's Suggested Retail Price \$99,077.00

TOTAL AMOUNT DOES NOT INCLUDE STATE AND LOCAL TAXES OR LICENSE FEES. THE PRICE SHOWN ABOVE MAY OR MAY NOT BE REPRESENTATIVE OF THE ACTUAL SELLING PRICE OF SIMILAR RECREATIONAL VEHICLES IN YOUR AREA.

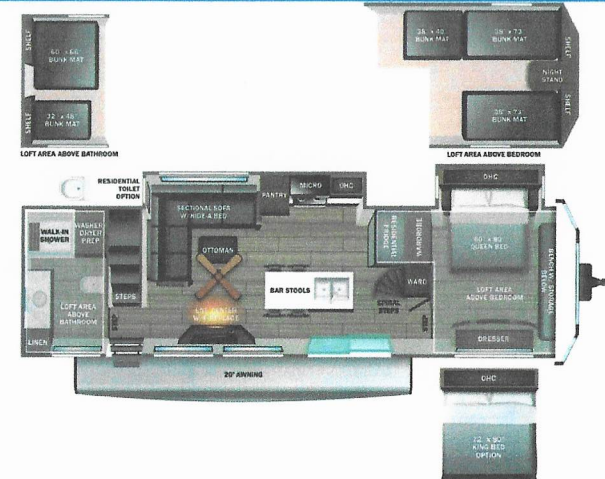

**UVW**  
12923 lbs

**Sleeps**

**Length**  
41' 11"

#### DIMENSIONS

Exterior height:.....158.00"  
Exterior width:.....102.00"

#### WEIGHTS

GVWR:.....14150  
GAWR (front):.....6400  
GAWR (rear):.....6400

Approx. Gross Cargo Carrying  
Capacity(GCCC):.....1227

#### TIRES

Tire size (front):.....ST235/80R16E  
Tire size (mid):.....  
Tire size (rear):.....ST235/80R16E  
Tire size (spare):.....

#### CAPACITIES

Fresh water tank (gals.):.....0.02  
Gray water tank (gals.):.....0.02  
Black water/toilet tank  
(gals.):.....0.02  
Propane (lbs.):.....60  
Propane (gals.):.....14  
Water heater (gals.):.....0.25

#### SEATING & SLEEPING

\*\*\*Some dimensions may be rounded and may vary from the actual dimensions\*\*\*

\*\*\*Weights may be estimated calculations and may vary from the actual weight

- refer to the vehicle weight labels for actual weights\*\*\*

Floorplans, features and specifications are subject to change without notice.

**2+3**  
YEAR | YEAR  
LIMITED STRUCTURAL  
WARRANTY