

SPRINGDALE

Eastern Edition



www.keystone-springdale.com



Springdale

(Cover Photo)

Springdale's 266RL-SSR travel trailer, shown here in Sedona Sunrise interior, truly combines livability with towability. The large 40 x 72 inch rear lounge picture window coupled with our SSR slide room design provides an open, spacious feel not common in a travel trailer at this length. With a longer overall slide room, this SSR model is able to provide an incredible 87" U-shape dinette, as well as a full size sofa. By maximizing the overall interior living space, this model is able to keep its length and weight down within the range of most properly equipped half ton tow vehicles.

Springdale gives you more for your money!



Springdale's 266RL-SSR travel trailer, shown here in Palm Canyon decor, is packed with details that will make your RV experience comfortable and convenient. This model features our new super slide room designed for greater living space. Over-sized windows provide a brighter, more open feeling while comfortable rear lounge chairs are perfect for relaxing, socializing and viewing your 26" LCD flat screen TV. You find an abundance of storage throughout the 266, including above the full sized sofa and under the super sized U-shape dinette. The LCD Television is perfectly located for viewing throughout the coach and can be rotated 180 degrees into the master bedroom. Whether you are a new or an experienced RV enthusiast, Springdale offers you the perfect combination of form and function.

Springdale was designed with one main goal—Incredible value for your dollar. With Springdale, you will find that you don't have to spend a fortune to have all the conveniences and features that you want. With our hard earned reputation for quality at an affordable price, the Springdale team takes great pride in our work. We use only high-grade building materials and we feature top brand-name appliances in creating our products. Springdale is one of the most respected names in the RV industry.

In fact, Springdale has received the DSI Quality Circle Award from the National RV Dealers Association. This prestigious award is based on the results of an industry wide dealer satisfaction survey of RVDA member dealerships and ranks dealer satisfaction in areas of vehicle design and reliability, competitive advantage, and sales and service support. We invite you to find out for yourself why customers everywhere are choosing Springdale. We appreciate your interest. See you in the great outdoors!



Springdale's 291RK-SSR travel trailer, shown here in Cranberry Mist interior, brings you richness and style previously unheard of in an RV at this moderate price point. Notice, for example, the sculpted lounge chairs, curved dinette backs, fresh window treatments and mortise and tenon cabinetry. The spacious lounge area is completed with a panoramic view through a 40 x 72 inch picture window. Springdale's 291 also excels when it comes to function, like interior cabinet storage and an abundance of counter top space. The efficient kitchen offers matching appliances, an extra large deep bowl sink with a high rise faucet, and upgraded linoleum flooring. When it's value you seek, choose Springdale.

SPRINGDALE



Travel Trailer Specifications

Travel Trailers	266 RL-SSR	267 BH-SSR	276 RB-SSR	291 RK-SSR	294 BH-SSR	296 BH-SSR	297 FK-SSR	298 BH-SSR	303 BHSSR	372 BH-GL	373 QB-GL
Shipping Weight	6257	6086	6482	6636	6974	6675	7244	6642	7645	8206	8209
Carrying Capacity	1418	1694	3118	2934	2531	2850	2756	2913	3655	2889	2836
Hitch Weight	675	780	800	770	705	730	830	755	900	910	885
Exterior Length	28' 11"	28' 11"	31' 8"	32' 8"	32' 7"	33'	32' 11"	32' 7"	34' 11"	38' 6"	38' 6"
Exterior Height	10' 11"	10' 11"	10' 11"	10' 11"	10' 11"	10' 11"	11' 3"	10' 11"	11' 3"	11' 3"	11' 3"
Fresh Water	50	50	50	50	50	50	50	50	50	50	50
Waste Water	34	30	30	30	30	30	30	30	30	34	34
Gray Water	34	64	64	64	34	34	64	34	34	64	64
LPG Capacity	60	60	60	60	60	60	60	60	60	60	60



This button, found on the Springdale web site home page, will launch an informative walk around video.

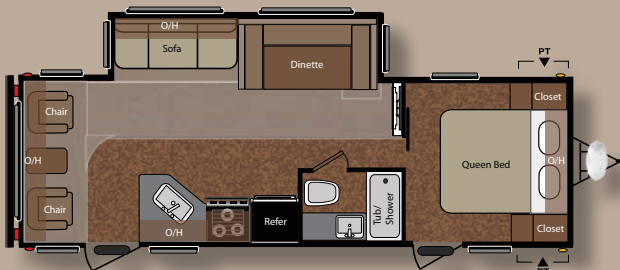

266RLSSR

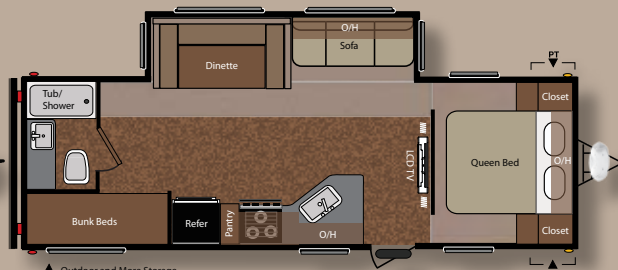

267BHSSR

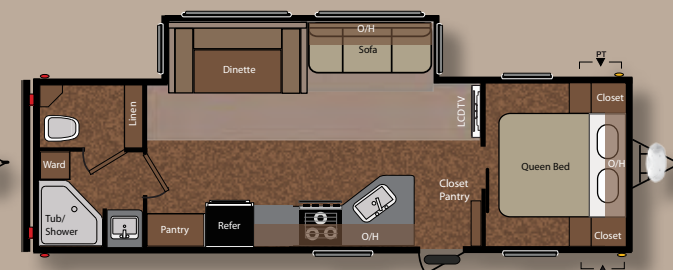

276RBSSR

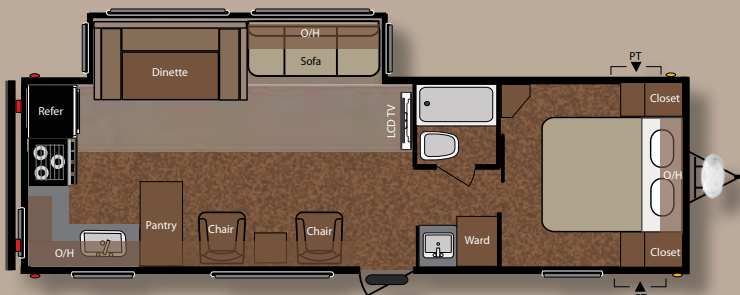

291RKSSR

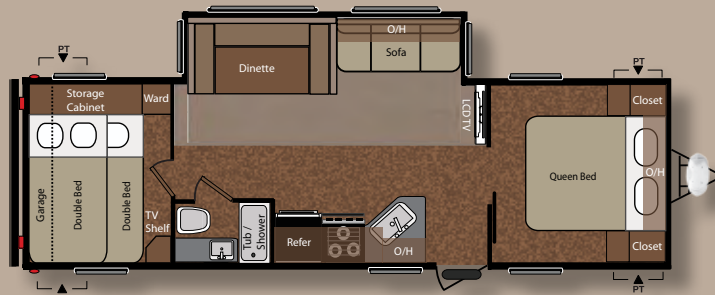

296BHSSR

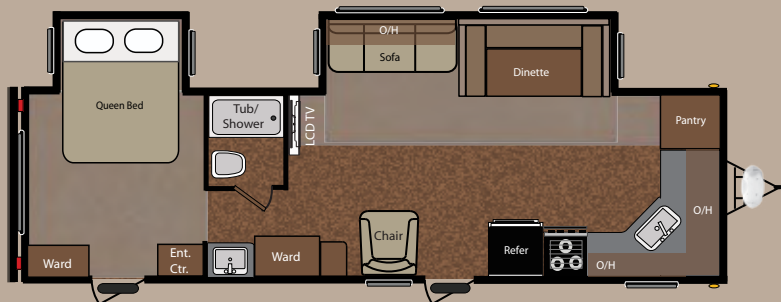

297FKSSR

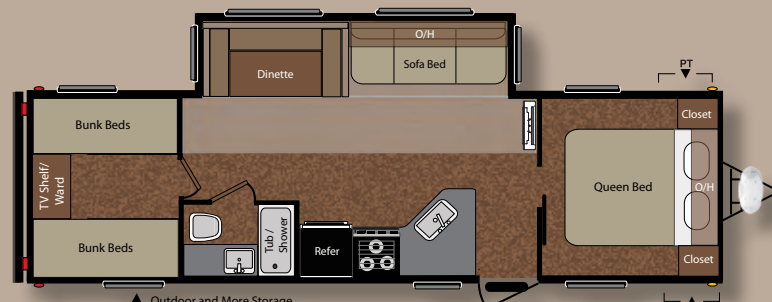

298BHSSR

Springdale



This symbol, found on the Floor Plan tab of the Springdale web site, is a link to snap shot photos of the of the floor plan interiors.

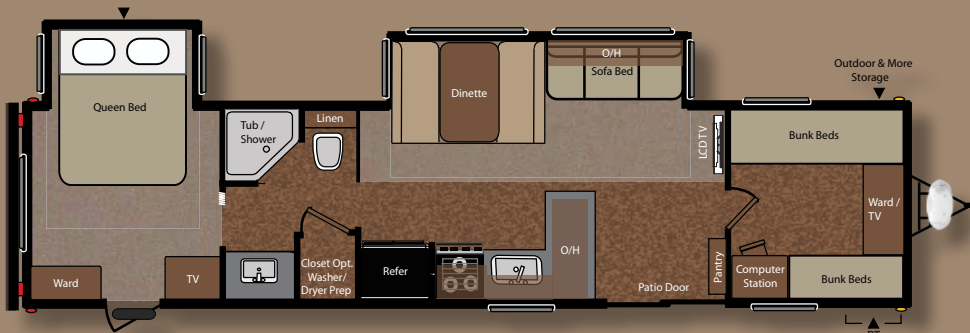

372BHGL

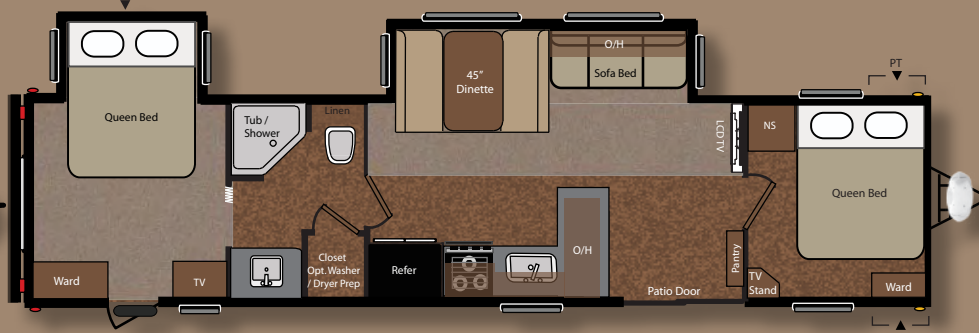

373QBGL



294BHSSR Outdoor Kitchen

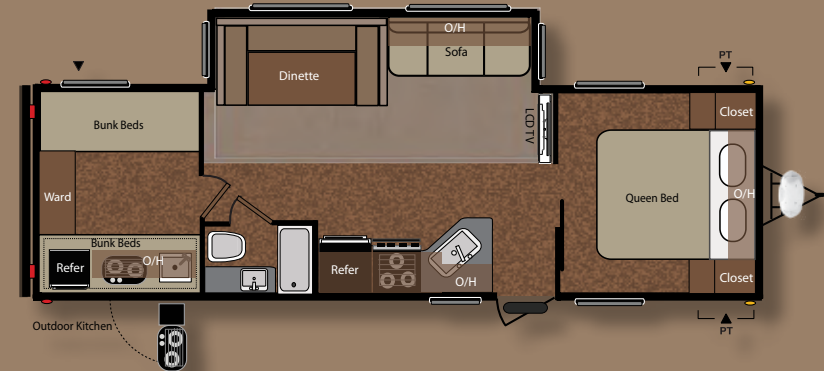

This bunk house floor plan combines all of the features of our hugely popular SSR Models with a fully functional outdoor kitchen. The outdoor kitchen comes complete with a fold away two burner gas cook top, sink with hot and cold water, large over head cabinets, plenty of counter space and a 4.3 cu. ft. refrigerator. Just another example of Springdale giving you more for your money!

Springdale's Superior Slide Out System



1 The Exterior Bulb Seal is built in, not Taped on to the Slide Room Perimeter. When the Slide Room is in, this Bulb Seal Creates a Water Barrier.



2 When the Slide Room is Extended, the Interior Slide Room Fascia and Interior Bulb Seal Creates Another Water Barrier.



3 The Exterior Wiper Provides Yet Another Water Barrier Around the Perimeter of the Slide Room.



4 The C-Channel Behind the Wiper Catches any Driving Rain that may Get Past and Directs it away from Your RV.



5 Your Slide Room is Engineered with a Sloped Roof Line. This Design also Directs Water Away from Your RV.

"One Touch Plus" Package



"One Touch"

**Power Stabilizer Jacks.
Make Stabilizing your
Unit a Snap!**



"One Touch"

**The Power Tongue Jack is
Operated by One Button.**



**"One Touch"
Electric Awning.**



"Plus"

XL Entry Assist Handle.



"Plus"

Aluminum Rims.



"One Touch"

**Air Mattress Hide-a-Bed Sofa Electric
Air Pump Rapidly Inflates or Deflates.**

Springdale

303BHSSR

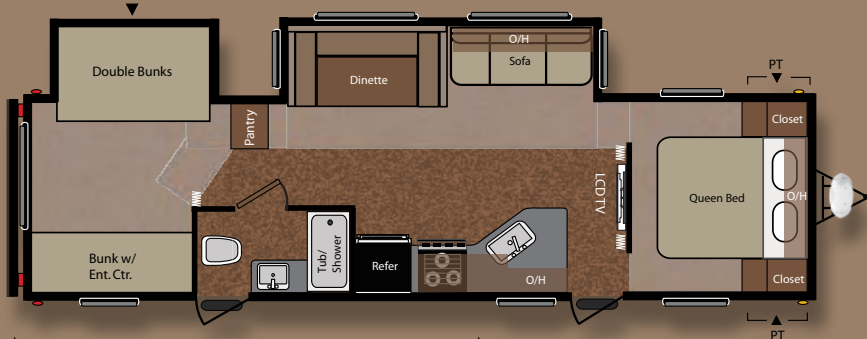

- ★ Air Mattress Hide-a-Bed Sofa
- ★ Electric Awning
- ★ Aluminum Rims
- ★ Power Stabilizer Jacks
- ★ XL Entry Assist Handle
- ★ Power Tongue Jack



This symbol, found on the Floor Plan tab of the Springdale web site, is a link to snap shot photos of the Floor plan interiors.



303BHSSR

"One Touch Plus" Features

SPRINGDALE



Fifth Wheel Specifications

Fifth Wheels	242 FWRL-SSR	249 FWBH-SSR	253 FWRL-LS	279 FWRL-SSR	280 FWIK-SSR	284 FWBH-SSR
Shipping Weight	6279	6351	7018	7373	7279	7913
Carrying Capacity	1826	1754	1197	2667	2846	2242
Hitch Weight	1105	1105	1215	1240	1185	1355
Exterior Length	26' 3"	27' 2"	29' 9"	31' 8"	31' 3"	32' 5"
Exterior Height	11' 4"	11' 4"	11' 4"	11' 11"	11' 11"	11' 11"
Fresh Water	50	50	50	50	50	50
Waste Water	34	30	34	34	34	34
Gray Water	34	64	34	64	64	64
LPG Capacity	60	60	60	60	60	60



This button found on the Springdale web site home page will launch an informative walk around video.

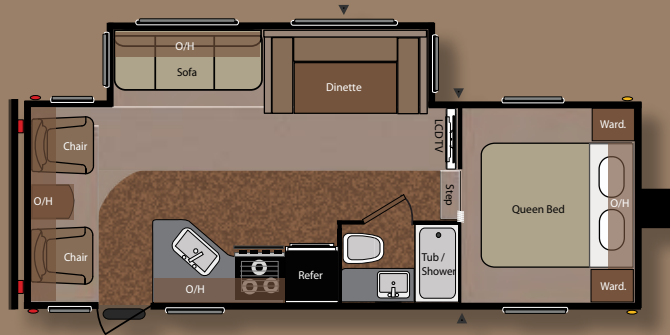

242FWRLSSR

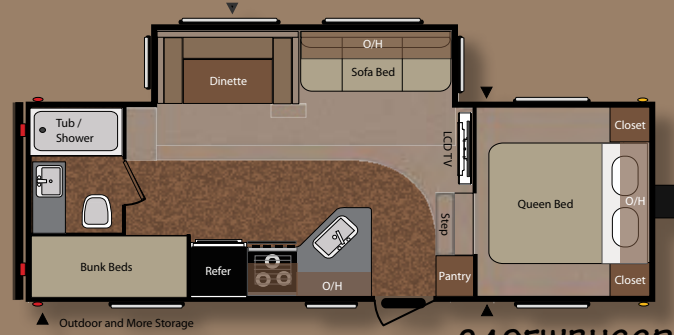

249FWBHSSR

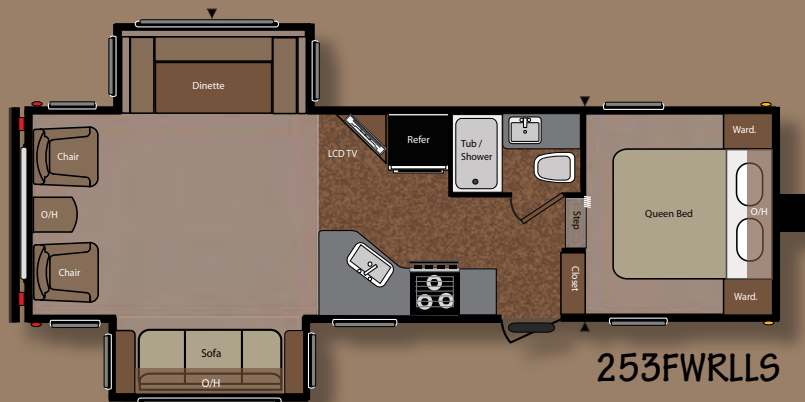

253FWRLLS

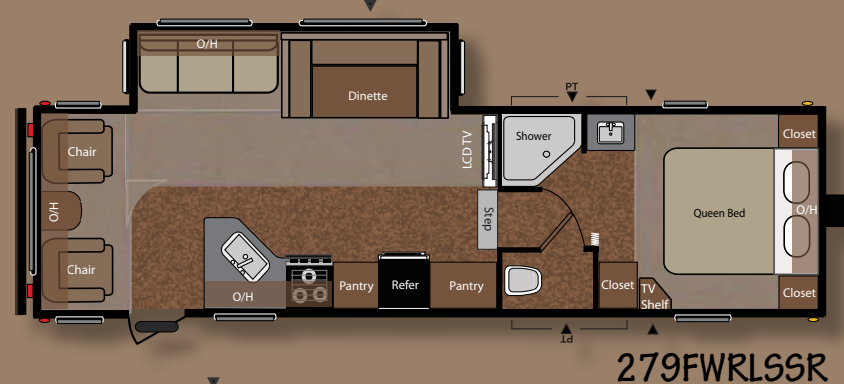

279FWRLSSR

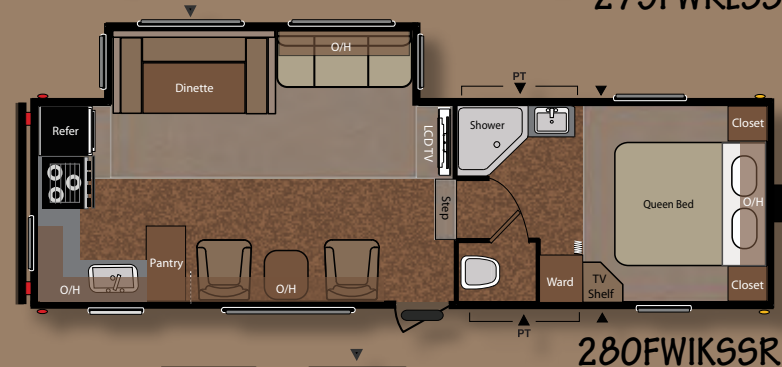

280FWIKSSR

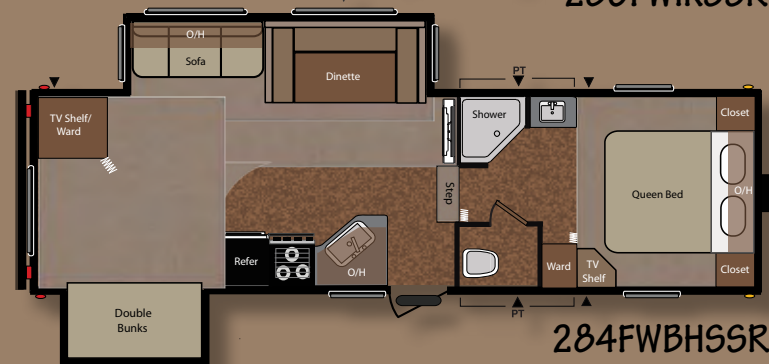

284FWBHSSR



This symbol, found on the Floor Plan tab of the Springdale web site, is a link to snap shot photos of the floor plan interiors.

Summerland Floor Plans

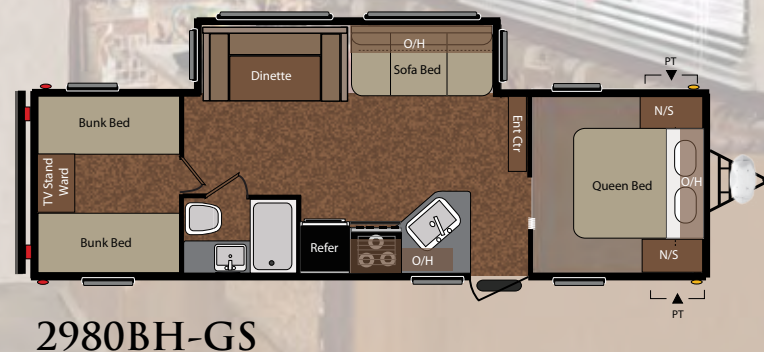
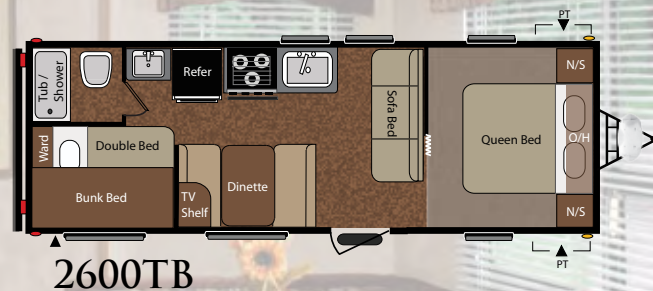
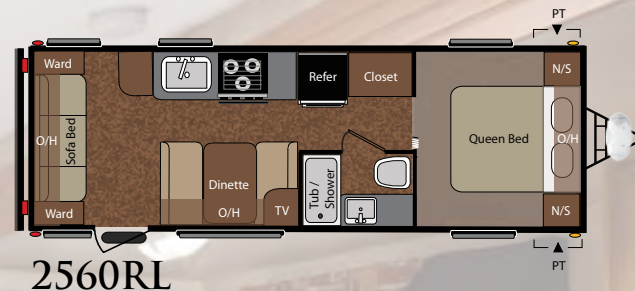
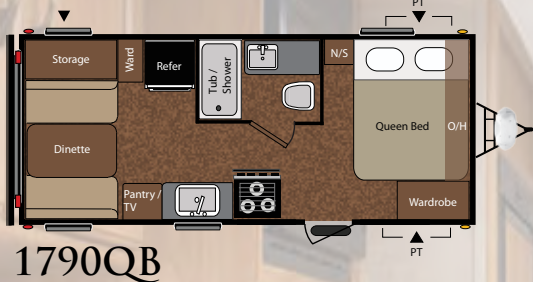

SUMMERLAND
by SPRINGDALE



This symbol, found on the Floor Plan tab of the Springdale web site, is a link to snap shots of the interiors.

Item	1790QB	1890FL	2560RL	2570RL	2600TB	2670BH-GS	2980BH-GS
Shipping Weight	3940	4137	4751	5485	4778	5740	6375
Carrying Capacity	2041	1873	2864	2120	2767	1905	3130
Hitch Weight	490	410	615	605	545	645	705
Exterior Length	20' 10"	23' 7"	27' 11"	28' 8"	28' 10"	28' 11"	32' 7"
Ext Height - Top of AC	10' 6"	10' 6"	10' 6"	10' 6"	10' 6"	10' 11"	10' 11"
Fresh Water Capacity	50	50	50	50	50	50	50
Waste Water Capability	30	34	34	34	34	30	30
Gray Water Capacity	30	30	34	64	30	34	34



Standards

Appliances and Equipment

- Double Door Refrigerator
- 13.5 Btu Non-Ducted A/C (1790, 1890, 2560, 2600)
- 13.5 Btu Ducted A/C
- Three Burner, High Output Range with Oven
- Forced Air DSI Furnace with Thermostat
- 50 Gal. Fresh Water Capacity
- Under Floor Fresh Water System
- Range Hood with 12 Volt Light and Exhaust Fan
- In Floor Rigid Heat Ducting
- Fire Extinguisher
- Carbon Monoxide Detector
- L.P. Leak Detector

Kitchen

- Residential Kitchen Sink with Deep Basin
- High Spout Faucet in the Kitchen
- Extra Large Over Head Cabinets
- Spice Rack Storage Under the Sink
- Wall Mounted Systems Monitor Panel
- Microwave

Exterior

- 8' Exterior Width
- Hose Carrier Bumper with End Caps
- Fiberglass Insulation
- Entry Assist Handle
- Radius Clamp Ring Windows
- Tinted Safety Glass
- Rubber Roof
- E-Z Open Entry Step
- Rain Gutters
- Patio Awning
- Radial Tires
- EZ Lube Axles

Interior

- Innerspring Mattress
- Bedspread
- 45" Wide Dinette Booth in all Slides
- Extra Large Over Head Cabinets
- Large Pedestal Dinette Tables
- Over Head Medicine Cabinet with Mirrored Door
- 12 Volt Power Bath Roof Exhaust Vent
- 2" x 3" Floor Joists with 5/8" Decking
- AM/FM/CD Player

Options

- * Summer Package
 - 6 Gal. Gas Water Heater with Direct Spark Ignition
 - 30# L.P. Bottles with Cover
 - Tub Surround
 - Cable TV Hook-Up
 - Exterior Shower
- * Four Stabilizer Jacks
- * Spare Tire
- * CSA



Standards and Options *SPRINGDALE*

Interior

- Slide Room Overhead Cabinet
- Cathedral-style Mortise and Tenon Jointed Cabinet Doors with Antique Brass Hardware
- Night Shade Window Coverings in Living Room
- 45" Wide Dinette Booth (GL/SSR)
- Extra Large Overhead Cabinets
- All-Wood Drawers
- Porcelain Toilet with Foot Flush
- Overhead Medicine Cabinet with Mirrored Door
- 12 volt Power Bath Roof Vent
- Skylight over Tub/Shower
- 2" x 3" Floor Joists with 5/8" Decking
- ★ Deluxe Entertainment Center (GL/SSR)
- ★ 26" Flat Screen LCD TV (GL/SSR)
- Bedspread (Double and Queen)
- Wallpaper Border
- Swivel Rocker(s) (TT 266, 291, 297/FW 242, 253, 279, 280)
- Desk Chair (372)
- Tub Surround
- Patio Door (372, 373)
- ★ Air Mattress Hide-a-Bed Sofa (GL/FW)

Appliances/Equipment

- Three-Burner, High Output Range with 22" Oven
- 30,000 Btu Forced-Air DSI Furnace with Thermostat
- In-Floor Rigid Heat Ducting
- Space Maker™ Under-Floor Fresh Water System in an Enclosed Compartment (Keystone Exclusive)
- 6 Gal. Gas/Electric DSI Water Heater
- Range Hood with 12 Volt Light and Exhaust Fan
- Fire Extinguisher
- Smoke Detector
- Carbon Monoxide Detector
- LP Leak Detector
- Water Heater Bypass
- 55 Amp Power Converter
- Gas/Electric Double Door Refrigerator
- Residential Refer (372, 373)
- Microwave
- Bedroom TV Hook Up (N/A 179,189)
- Cable TV Hook Up
- Satellite Prep
- TV Antenna and Booster
- 13.5 A/C Ducted
- ★ "One Touch Plus Package" (TT Only 266-303)

Kitchen

- Extra Large Deep Bowl Kitchen Sink with Matching High Spout Faucet
- Large Overhead Cabinets
- Spice Rack Storage Under Sink
- Wall-Mounted Systems Monitor Panel
- Do More Dinette Table

Options (Floor Plan Specific)

- Exterior Shower
- Diamond Plate
- Spare Tire Cover and Carrier
- Carpet in the Bedroom
- 15K Ducted Air Conditioner
- Sink Cover
- Range Cover

372/373 Options

- Extra Large Refer
- 10 Gallon Gas/Electric DSI Water Heater
- Washer/Dryer Prep with 50 Amp Service

Exterior

- 8' Exterior Width
- Hose Carrier Bumper with End Caps
- Entry Assist Handle
- Radius Clamp-Ring Windows
- Rubber Roof
- E-Z Open Entry Step
- Rain Gutters
- Patio Awning
- Exterior Speakers
- ★ Radial Tires
- 30 Lbs LP Bottles with auto changeover
- LP Bottle Cover (TT)
- Tinted Safety Glass
- Stabilizer Jacks 2 (FW)
- Stabilizer Jacks 4 (TT)
- Electric Front Jacks (FW)
- ★ Laminated Sidewalls with Fiberglass Exterior (FW)
- EZ Lube Axles

★ Mandatory Option.

Springdale's "Do More" Dinette Table (Available on GL/SSR Models)



A Mobile Free Standing Dinette



A Bed at the Dinette

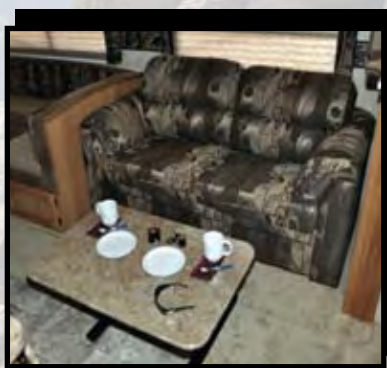

A Coffee Table at the Sofa

Dollar for Dollar, the Best Value on the Market Today!

Springdale travel trailers and fifth wheels are manufactured at our facilities in Goshen, Indiana and Pendleton, Oregon. Among our product lines, Springdale has evolved to become our greatest value in towables, especially for young families, or anyone who requires a lot of space at an economical price. We take pride in each model we deliver. Each Springdale is made with care and craftsmanship. Springdale has become one of North America's best selling lines of recreational vehicles because it offers so many features at such a good price. This quality has earned Springdale national recognition as a value leader among all products in the U.S. marketplace today. Springdale, "More for your dollar."



2642 Hackberry Drive P.O. Box 2000 Goshen, Indiana 46527-2000
(574) 535-2100 www.keystone-springdale.com

Dealer:



Product information is as accurate as possible as of the date of publication of this brochure. Features, floor plans, and specifications are subject to change without notice. Please also consult Keystone's web site at www.keystonerv.com for more current product information and specifications. Tow Vehicle disclaimer. CAUTION: Owners of Keystone recreational vehicles are solely responsible for the selection and proper use of tow vehicles. All customers should consult with a motor vehicle manufacturer or their dealer concerning the purchase and use of suitable tow vehicles for Keystone products. Keystone disclaims any liability or damages suffered as a result of the selection, operation, use or misuse of a tow vehicle. KEYSTONE'S LIMITED WARRANTY DOES NOT COVER DAMAGE TO THE RECREATIONAL VEHICLE OR THE TOW VEHICLE AS A RESULT OF THE SELECTION, OPERATION, USE OR MISUSE OF THE TOW VEHICLE. May 2010.