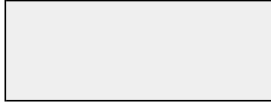

# MIDWEST

## AUTOMOTIVE DESIGNS

1826 Leer Dr. Elkhart, IN. 46516 Phone 574-522-4878 Fax: 574-522-5828

**INFORMATION***2023 Limo*

Date \_\_\_\_\_

Invoice # 10405

Sales Rep: \_\_\_\_\_

Customer \_\_\_\_\_

Customer Sig \_\_\_\_\_

Address \_\_\_\_\_

Contact \_\_\_\_\_

City \_\_\_\_\_

Cust. Phone \_\_\_\_\_

State \_\_\_\_\_ Zip \_\_\_\_\_

- ☐ 170" EXT HT 3.0L Single Rear Wheel  
☒ 170" EXT HT 3.0L Dual Rear Wheel

VIN# W1X8ED3Y4NT102517

10.25	Navigation Size
Yes	Distronic
Yes	Power Slider Door

Exterior Color	Jet Black
Seat Style	AMG
Seat Color	Sand
Seat Pipe and Thread	Black
Wall / Ceiling	Sand
Carpet Mat Color	Black
Flooring	Composite
Wood Trim	Black Denali
Floor Plan	Club J Build

**Available Options****Electronic Options**

<input type="checkbox"/>	KVH A9 Digital Satellite Directional TV System	
<input type="checkbox"/>	Additional 110 Outlets	
<input type="checkbox"/>	Shoreline Hook Up W/Charger	
<input type="checkbox"/>	300 Amps of Lithium Battery	
<input type="checkbox"/>	160 Watts of Solar Power	

**Interior Convenience Options**

<input type="checkbox"/>	SLS Seat Upgrade	
<input type="checkbox"/>	Satin Wood Finish Upgrade	
<input type="checkbox"/>	Pedestal Table with Base	
<input type="checkbox"/>	Additional Table Base	
<input type="checkbox"/>	Seat Heat (\$249) Per Seat Specify Location	
<input type="checkbox"/>	Seat Massage (\$295) Per Seat Specify Location	
<input type="checkbox"/>	Lap Table Driver Rear Facing Seat Only	
<input type="checkbox"/>	Overhead Cabinets	

**Exterior Options**

<input type="checkbox"/>	16" Aluminum Wheel Upgrade (Dual Rear Wheel)	
<input type="checkbox"/>	16" Ultra Black Wheel & Tire Upgrade (Dual Rear Wheel)	
<input type="checkbox"/>	SUMO Suspension Package (Standard on 4x4)	
<input type="checkbox"/>	18" Wheel and Tire Upgrade (Single Rear Wheel Only)	
<input type="checkbox"/>	VB Air Ride	
<input type="checkbox"/>	Ft Lower Spoiler	
<input type="checkbox"/>	4 Camera Viewing	
<input type="checkbox"/>	Exterior Lighted Grab Handles	
<input type="checkbox"/>	Power Awning	
<input type="checkbox"/>	4x4 Chassis Upgrade (Includes SUMO Suspension Package)	
<input type="checkbox"/>	Custom Re-Paint	
<input type="checkbox"/>	Rear Hitch	

**NOTES:**

10 Seat Belts  
 Black Window Shades  
 Child Tie Downs Forward Facing Seats

**170"Ext Wheel Base BC**

Total Base Price	
Total Options	
(FOB Elkhart IN) Freight	
<b>Total</b>	

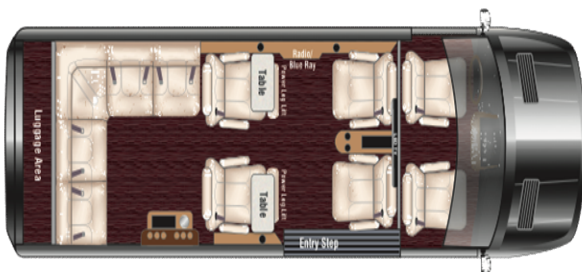

\* Midwest Automotive Designs Reserves the Right to Change any Std or Optional Features without Notice.

\*\* Photos may Not depict the Actual product.

**Interior Standard Features**

- \* Automotive Color Keyed Walls
- \* Composite Wood Grain Flooring
- \* Automotive Headliner
- \* Floor Mats w/ Non Slip Rubber Backing
- \* 110 V Outlets
- \* USB - Outlets at Each Seat Location
- \* 2 - 43" 4K UHD Smart TV
- \* Front Partition W/ Power Window
- \* Rear Partition Wall
- \* Rear Touch Screen FM Radio
- \* Complete Audio/Vid System
- \* Wall Mounted Touch screen Control Panels
- \* Dark Tinted Side and Rear Windows
- \* Custom Interior Lighting Package
- \* Complete Insulation Package
- \* Complete Privacy Shade Package
- \* Overhead and Floor Courtesy Lighting
- \* Rear JL Speaker Upgrades
- \* Wireless Headphone System
- \* HDMI Input

- \* Seat Belt Package
- \* Rear Luggage Storage Lighted
- \* Custom Rear Luxury Seating Package
- \* Rear Seating Pkg
- \* Driver and Passenger Deluxe Seating Recover
- \* Rear Air and Heat  
w/ Dual Compressor, Condenser, and Evaporator
- \* Wall Consoles W/Cup holders
- \* 2 Rear Clothes Hangers (Ceiling Mount)
- \* Coordinated Valances w/Indirect Lighting
- \* Hand Rubbed Custom Made High Gloss Burled Wood Package
- \* Custom Coordinated Door Panels
- \* Dual Battery Charging System
- \* Hands-Free Intercom
- \* Side Panel w/ Lighted grab Handles
- \* Rear Bar w/ Glassware
- \* LED Lighting Throughout
- \* Double Needle Stitched Accents
- \* In Dash Audio System
- \* Rear Audio Amp
- \* Rear Audio Sub

**Exterior Standard Features**

- \* Fiberglass Running Board with Step (Color Keyed to Chassis)
- \* Color Keyed Bumpers
- \* Color Keyed Body Moldings

- \* Egress Window
- \* Back Up Camera
- \* Wheel Covers

**Additional Standard Features**

- |                                     |   |
|-------------------------------------|---|
| * 2 - 43" 4K UHD Smart TV           | * Apple TV                              |
| * 2 Power Leg Lifts (club J Only)   | * Slide Drawer Refrigerator             |
| * Large Dr Pass Front Floor Console | * Maybach Lighted Center Beam           |
| * HD Amplified Antenna              | * Black Floor Mats, Black Window Shades |
| * Wireless Internet Router          | * 2 Lap Top Tables (Club J Plan Only)   |