

# HIDEOUT

TRAVEL TRAILERS



KEYSTONE  
RV COMPANY

CAMP BETTER



HIDEOUT 29DFS



HIDEOUT 29DFS

## 2023 HIDEOUT | EXCEPTIONAL FEATURES

- SOLARFLEX™ 200 SOLAR POWER SYSTEM W/OPTIONAL DRAGONFLY ENERGY LITHIUM-ION BATTERY
- **NEW** GIRARD TANKLESS WATER HEATER
- CENTRAL VACUUM (N/A ON SPORT)
- BLADE™ HIGH-PERFORMANCE AIR FLOW SYSTEM (N/A ON SPORT)
- TINTED WINDOWS (N/A ON SPORT)
- PORCELAIN TOILET (N/A ON SPORT)
- **NEW** MEDICINE CABINET ABOVE BATHROOM SINK
- **NEW** RESILIENT VINYL FLOORING IN SLIDE ROOMS
- SEAMLESS KITCHEN COUNTERTOPS
- **NEW**.040" SMOOTH METAL FRONT (N/A ON SPORT)
- SOLIDSTEP® AT MAIN ENTRY DOOR (N/A 38s)
- EXTRA-LARGE GRAB HANDLE
- WINEGARD™ AIR 360+ OMNIDIRECTIONAL ANTENNA WITH WI-FI/4G LTE
- POWER STABILIZER JACKS (N/A ON SPORT & 38s)
- POWER TONGUE JACK (N/A ON SPORT & 38s)

MODEL	WEIGHT	CARRYING CAPACITY	HITCH WEIGHT	FRESH WATER**	WASTE WATER	GRAY WATER	LPG	LENGTH*	WIDTH	HEIGHT	AWNING
174RK	4085	1115	525	21	30	30	20	21' 5"	8'	10' 2"	10'
175BH	3428	972	485	21	30	30	20	21' 5"	8'	10' 2"	14'
176BH	3810	690	520	21	30	30	20	21' 5"	8'	10' 2"	10'
177RD	3397	1003	540	21	30	30	20	21' 5"	8'	10' 2"	10'
179RB	3753	727	480	21	32	30	20	21' 5"	8'	10' 2"	10'
181BH	4435	765	595	21	30	60	20	22' 9"	8'	10' 4"	15'
186SS	4291	709	610	21	30	30	20	22' 10"	8'	10' 4"	14'
201BH	4265	1735	550	21	30	30	20/30 opt	22' 9"	8'	10' 5"	15'
20RDN (202RD)	4586	2614	540	37	39	39	40	24' 11"	8'	10' 3"	12'
22MLS	5576	2144	730	37	39	39	40	26' 4"	8'	11' 1"	16'
24RBS	6310	1350	665	37	39	69	40	28' 11"	8'	11' 1"	16'
25BHN (262BH)	5091	2509	645	37	30	39	40	29' 3"	8'	11' 3"	12'
25BHS	6430	1270	730	37	30	69	40	29' 11"	8'	11' 1"	16'
25RDS	6173	1427	745	37	30	39	40	29' 7"	8'	11' 1"	18'
26BHS (272BH)	6260	1540	855	37	30	30	40	30' 8"	8'	11' 1"	16'
28RKS	7012	2648	860	37	39	78	40	32' 11"	8'	11' 1"	18'
29DFS	7016	2664	920	37	30	78	40	33' 11"	8'	11' 1"	16'
29QBS (290QB)	6683	2817	830	37	39	39	40	33' 3"	8'	11' 1"	18'
31BRD (318BR)	7751	1849	870	37	39	69	40	35' 11"	8'	11' 2"	18'
32LBH	7452	2348	1045	37	30	69	40	36' 6"	8'	11' 0"	18'
34FKDS	8394	1506	1100	37	39	78	40	38' 11"	8'	11' 2"	18'
38BHDS	8306	1664	1170	37	39	39	60	39' 11"	8'	11' 2"	18'
38FDDS	8376	1624	1205	37	39	39	60	39' 11"	8'	11' 2"	18'
38FKTS	9183	1817	1200	37	39	78	60	39' 11"	8'	11' 4"	18'
38FQTS	9246	2114	1200	37	78	78	60	39' 11"	8'	11' 4"	18'



# HIDEOUT

Keystone Hideout RVs make it incredibly easy to become a camper. Choose from a wide selection of floorplans from sport travel trailer models to bunkhouses roomy enough for the entire family (and a few neighbor kids)! You'll fall in love with Hideout's airy interiors and dialed-in features – all at affordable price points.



"The layout of our unit is perfect for us. We are retirees with two small dogs. The dinette slideout gives us and the puppies plenty of floor space. The countertop space is great and gives us room for our small TV and food prep. The Murphy bed with the couch is also a big plus. Pulling this small RV with my half-ton is also easy."

— HIDEOUT 174RK OWNER

VISIT OUR WEBSITE FOR PHOTOS,  
360° TOURS, AND FULL PRODUCT DETAILS



**NEW TO CAMPING?** Keystone RV's Matt Ardent & Bart Taylor walk you through everything you need to know from your pre-travel checklist to full campsite set-up. You can find this series on Keystone's YouTube channel or follow this QR code to our website.

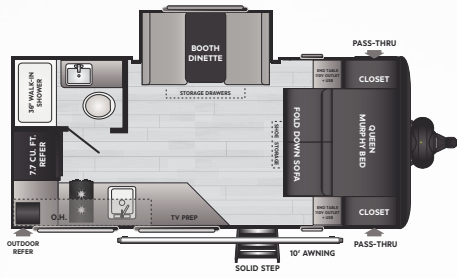

**174RK** | WEIGHT 4085 | LENGTH 21' 5"

**SPORT** ▪ REAR KITCHEN SLIDE, BOOTH DINETTE, MURPHY BED

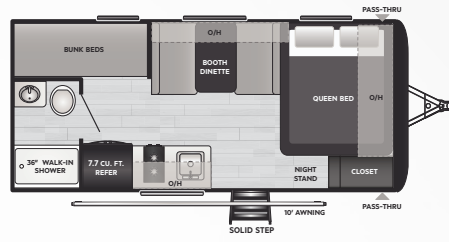

**175BH** | WEIGHT 3428 | LENGTH 21' 5"

**SPORT** ▪ NON-SLIDE, SINGLE BUNKS

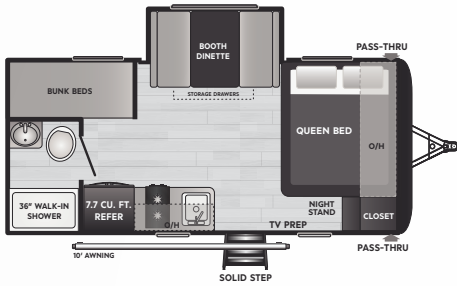

**176BH** | WEIGHT 3810 | LENGTH 21' 5"

**SPORT** ▪ BOOTH DINETTE SLIDE, SINGLE BUNKS

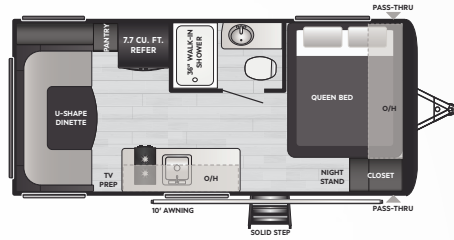

**177RD** | WEIGHT 3397 | LENGTH 21' 5"

**SPORT** ▪ NON-SLIDE, REAR DINETTE

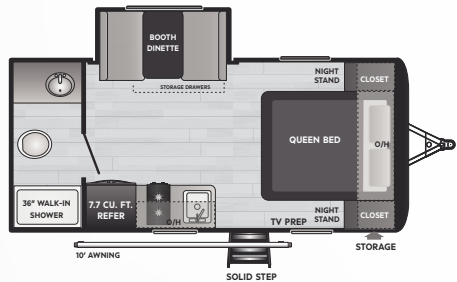

**179RB** | WEIGHT 3753 | LENGTH 21' 5"

**SPORT** ▪ BOOTH DINETTE SLIDE, REAR BATHROOM

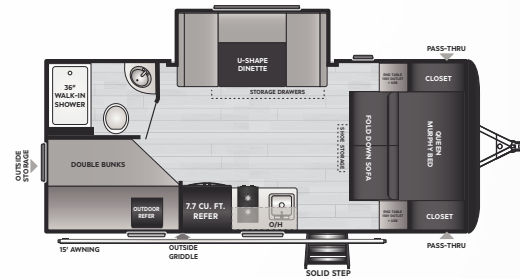

**NEW!** **181BH** | WEIGHT 4435 | LENGTH 22' 9"

**SPORT** ▪ U-SHAPE DINETTE SLIDE, DOUBLE BUNKS, MURPHY BED

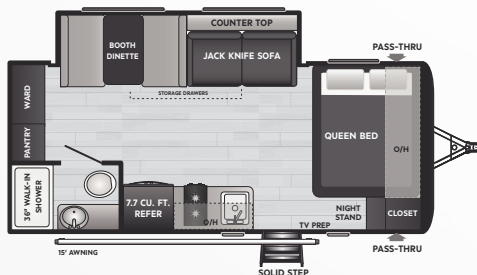

**186SS** | WEIGHT 4291 | LENGTH 22' 10"

**SPORT** ▪ SUPER SLIDE, REAR PANTRY/WARDROBE

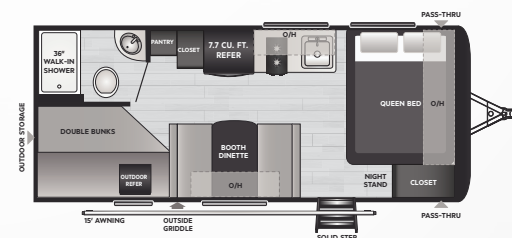

**NEW!** **201BH** | WEIGHT 4265 | LENGTH 22' 9"

**SPORT** ▪ NON-SLIDE, DOUBLE BUNKS

NEW! 174RK 175BH 176BH 177RD 179RB 181BH 186SS 201BH



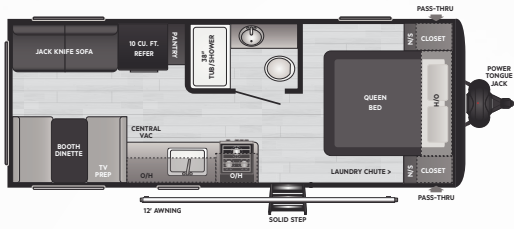

**20RDN** | WEIGHT 4586 | LENGTH 24' 11"

- NON-SLIDE, REAR DINETTE, LARGE REAR WINDOWS

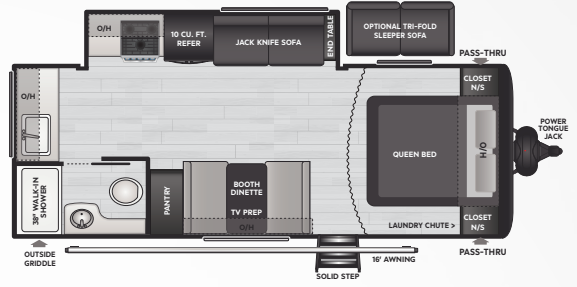

**NEW!** 22MLS | WEIGHT 5576 | LENGTH 26' 4"

- COMBO SLIDE, MIDDLE LIVING, OPEN CONCEPT

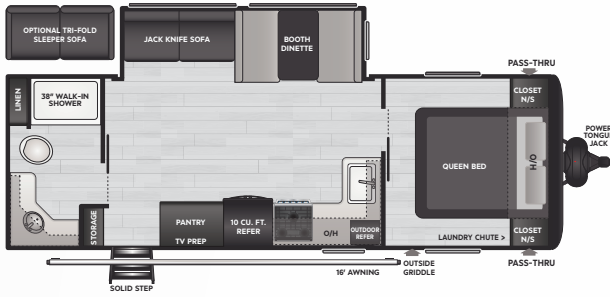

**NEW!** 24RBS | WEIGHT 6310 | LENGTH 28' 11"

- SUPER SLIDE, REAR BATH, OUTDOOR KITCHEN

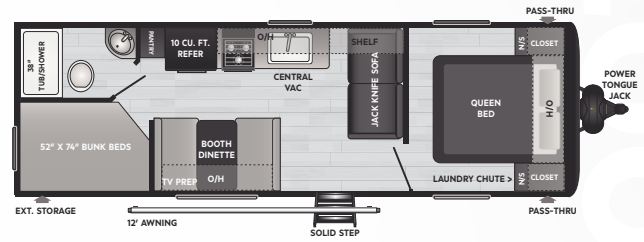

**25BHN** | WEIGHT 5091 | LENGTH 29' 3"

- NON-SLIDE, DOUBLE BUNKS, PRIVATE BEDROOM

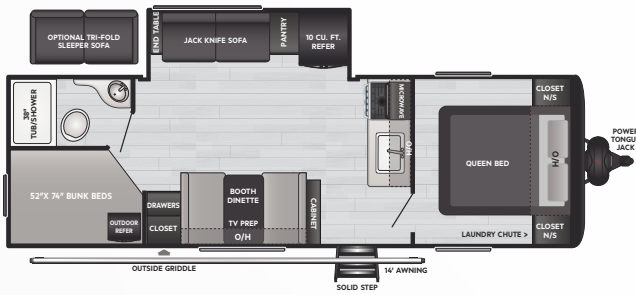

**NEW!** 25BHS | WEIGHT 6430 | LENGTH 29' 11"

- COMBO SLIDE, DOUBLE BUNKS, OUTDOOR KITCHEN

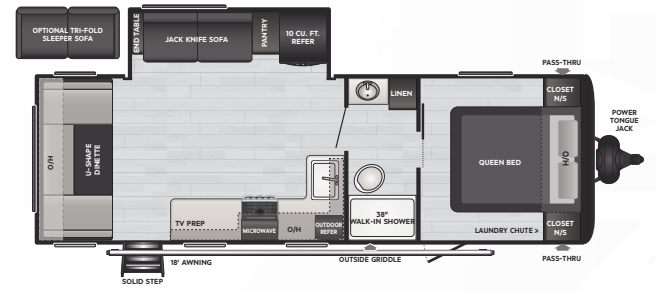

**NEW!** 25RDS | WEIGHT 6173 | LENGTH 29' 7"

- COMBO SLIDE, REAR DINETTE, OUTDOOR KITCHEN

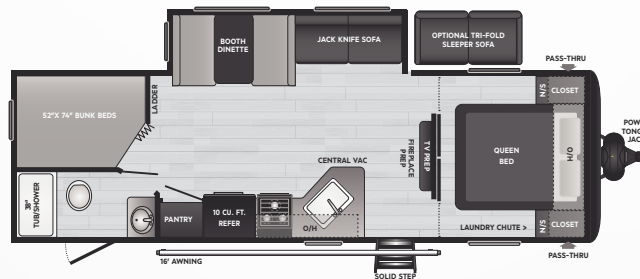

**26BHS** | WEIGHT 6260 | LENGTH 30' 8"

- SUPER SLIDE, DOUBLE BUNKS, DOUBLE ENTRY

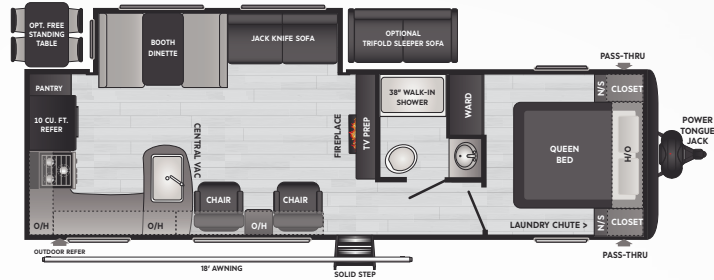

**28RKS** | WEIGHT 7012 | LENGTH 32' 11"

- SUPER SLIDE, REAR KITCHEN, OUTSIDE KITCHEN

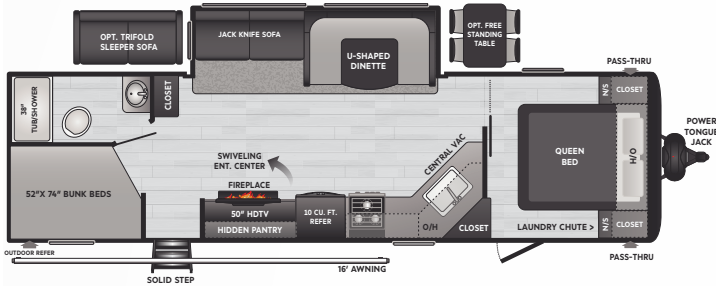

**29DFS** | WEIGHT 7016 | LENGTH 33' 11"

- SUPER SLIDE, DOUBLE BUNKS, HIDDEN PANTRY

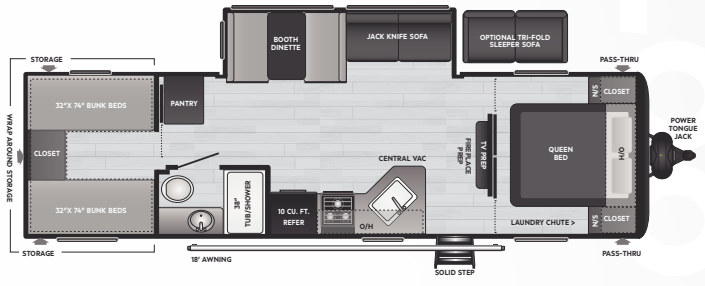

**29QBS** | WEIGHT 6683 | LENGTH 33' 3"

- SUPER SLIDE, FOUR SINGLE BUNKS, LARGE WRAP AROUND EXTERIOR STORAGE

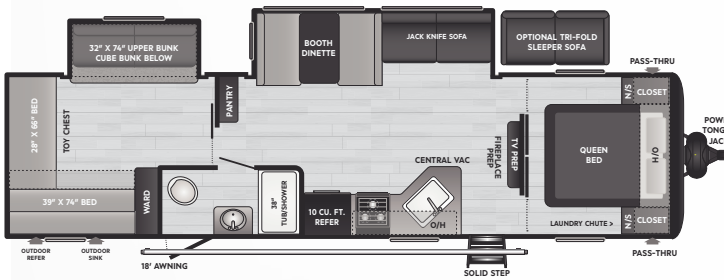

**31BRD** | WEIGHT 7751 | LENGTH 35' 11"

- DOUBLE SLIDE, BUNKROOM W/ SLIDE, LARGE OUTSIDE KITCHEN

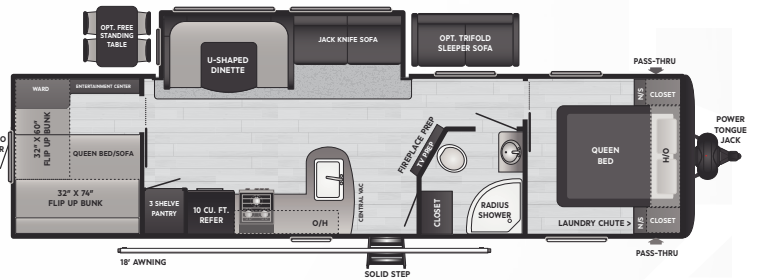

**32LBH** | WEIGHT 7452 | LENGTH 36' 6"

- SUPER SLIDE, BUNKROOM, BIKE DOOR

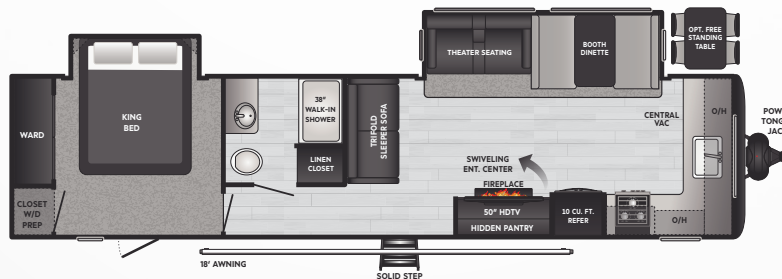

**34FKDS** | WEIGHT 8394 | LENGTH 38' 11"

- DOUBLE SLIDE, KING BED SLIDE, WASHER/DRYER PREP

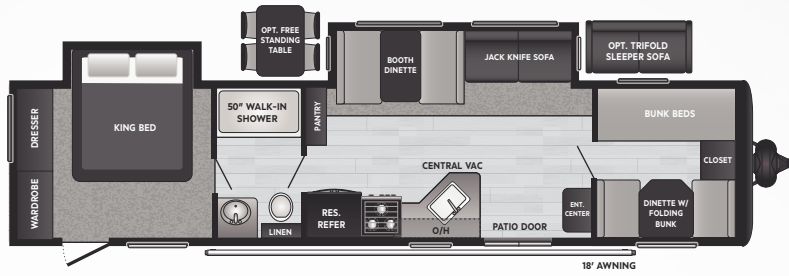

**38BHDS** | WEIGHT 8306 | LENGTH 39' 11"

▪ DOUBLE SLIDE, KING BED SLIDE, FRONT BUNKROOM

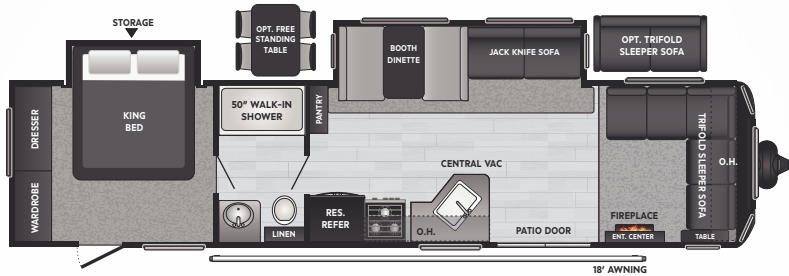

**38FDDS** | WEIGHT 8376 | LENGTH 39' 11"

▪ DOUBLE SLIDE, KING BED SLIDE, FRONT SECTIONAL

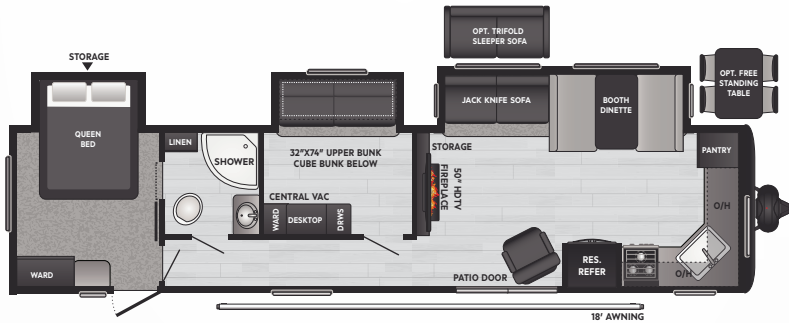

**38FKTS** | WEIGHT 9183 | LENGTH 39' 11"

▪ TRIPLE SLIDE, QUEEN BED SLIDE, MID-BUNKROOM W/ SLIDE

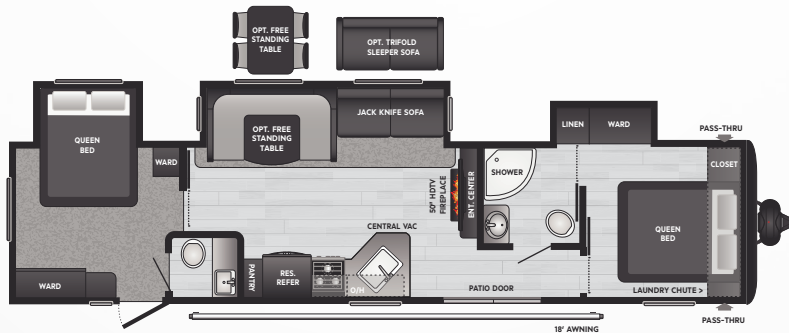

**38FQTS** | WEIGHT 9246 | LENGTH 39' 11"

▪ TRIPLE SLIDE, QUEEN BED SLIDE, FRONT QUEEN W/ WARDROBE SLIDE

AVAILABLE COLORS



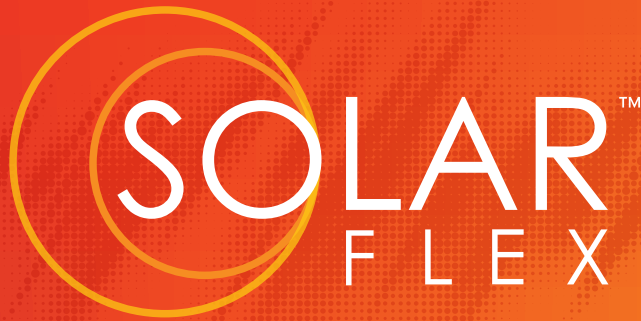

# TAKE CHARGE OF HOW YOU CAMP

EXCEPTIONAL QUALITY, IMPOSSIBLY VERSATILE, SolarFlex™ IS SHATTERING CUSTOMER'S EXPECTATIONS OF FACTORY-INSTALLED SOLAR POWER. EXCLUSIVELY AVAILABLE ON ALL KEYSTONE RV MODELS.



Relieve battery anxiety with legendary Lithium-ion deep cycle batteries – the ultimate replacement for lead acid. Lightweight, reliable, and longer-lasting, Dragonfly Energy batteries are made in the USA and available exclusively from Keystone RV and authorized dealers.

## MY KEYSTONE OWNER'S APP

THE ONLY APP YOU'LL NEED...

» MANUALS & QUICK START GUIDES

» HOW-TO VIDEOS

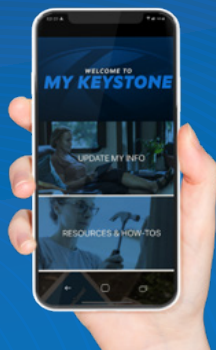

» FIRST-TIME CAMPER'S ADVICE

» ACCESS TO YOUR RV'S MOBILE APPS

Available for iOS and Android devices.



FOLLOW US FOR THE LATEST!



DISCLAIMER: Product information is as accurate as possible as of the date of publication of this brochure. All features, floor plans, and specifications in this brochure are subject to change without notice. Please also consult Keystone's web site at [www.keystonerv.com](http://www.keystonerv.com) for more current product information and specifications. Tow Vehicle Disclaimer. CAUTION: Owners of Keystone recreational vehicles are solely responsible for the selection and proper use of tow vehicles. All customers should consult with a motor vehicle manufacturer or their dealer concerning the purchase and use of suitable tow vehicles for Keystone products. Keystone disclaims any liability or damages suffered as a result of the selection, operation, use or misuse of a tow vehicle. KEYSTONE'S LIMITED WARRANTY DOES NOT COVER DAMAGE TO THE RECREATIONAL VEHICLE OR THE TOW VEHICLE AS A RESULT OF THE SELECTION, OPERATION, USE OR MISUSE OF THE TOW VEHICLE. \*Length is defined as the distance from the centerline of hitch pin/coupler to rear bumper of trailer. \*\* Fresh water capacity includes water heater. Please review owner's manual prior to purchase for more information on service warranties, extended use, towing and maintenance. Owner's manuals can be found at [keystonerv.com](http://keystonerv.com). PRINT 02.2023