

# APEX

ULTRALITE, NANO & REMOTE TRAVEL TRAILERS

SOLAR STANDARD  
ON ALL UNITS



**Emerald Rated**



# APEX

ULTRALITE, NANO & REMOTE TRAVEL TRAILERS

SOLAR STANDARD  
ON ALL UNITS



**Emerald Rated**



**Coachmen**  
Recreational Vehicles

A division of Forest River, Inc.



208 BHS

# APEX

NANO

**HIT THE ROAD TO ADVENTURE WITH APEX'S  
ULTRALITE TOWABLE RVS**



201 RBS / 203 RBK / 208 BHS



201 RBS / 203 RBK / 208 BHS



208 BHS

## LIGHTWEIGHT ADVENTURE

Travel is easy with Apex style and comfort. These Ultralites are ideal for towing with half ton trucks and most smaller SUVs, with weights ranging from under 3,000 lbs. up to 6,800 lbs. All Apex floor plans are designed with rich, warm interiors, full-sized bathrooms, contemporary cabinetry, fabrics and flooring.

The 208 BHS, 201 RBS, and 203 RBK come standard with a 60" x 80" queen bed, or you can add an optional Murphy Bed with Jack Knife sofa, shown at right.



201 RBS

*The lower double bunk in 208 BHS flips up to access a large storage area.*





**HIT THE ROAD TO ADVENTURE WITH APEX'S  
ULTRALITE TOWABLE RVS**



**208 BHS**



**201 RBS / 203 RBK / 208 BHS**



**201 RBS / 203 RBK / 208 BHS**



**208 BHS**

### **LIGHTWEIGHT ADVENTURE**

Travel is easy with Apex style and comfort. These Ultralites are ideal for towing with half ton trucks and most smaller SUVs, with weights ranging from under 3,000 lbs. up to 6,800 lbs. All Apex floor plans are designed with rich, warm interiors, full-sized bathrooms, contemporary cabinetry, fabrics and flooring.

The 208 BHS, 201 RBS, and 203 RBK come standard with a 60" x 80" queen bed, or you can add an optional Murphy Bed with Jack Knife sofa, shown at right.



**201 RBS**

*The lower double bunk in 208 BHS flips up to access a large storage area.*



## APEX STAR-GAZER

The all new Star-Gazer allows you to bring in more natural light and greater air flow. For those wanting to keep out insects or sleep in on the weekends, the Star-Gazer will also feature a screen and blackout shade that are very user friendly. (Optional on Nano floorplans. N/A 185 BH)



17 TH



17 TH



17 TH

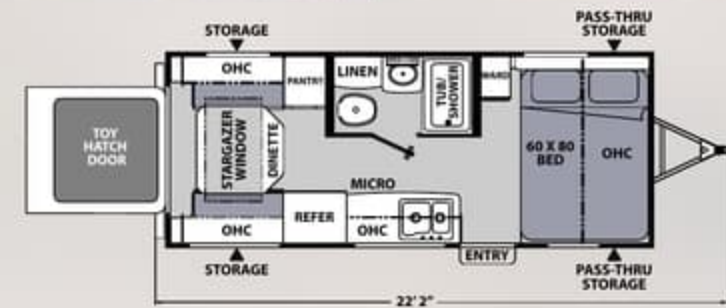

17 TH

**NEW FLOORPLAN!**



## APEX STAR-GAZER

The all new Star-Gazer allows you to bring in more natural light and greater air flow. For those wanting to keep out insects or sleep in on the weekends, the Star-Gazer will also feature a screen and blackout shade that are very user friendly. (Optional on Nano floorplans. N/A 185 BH)

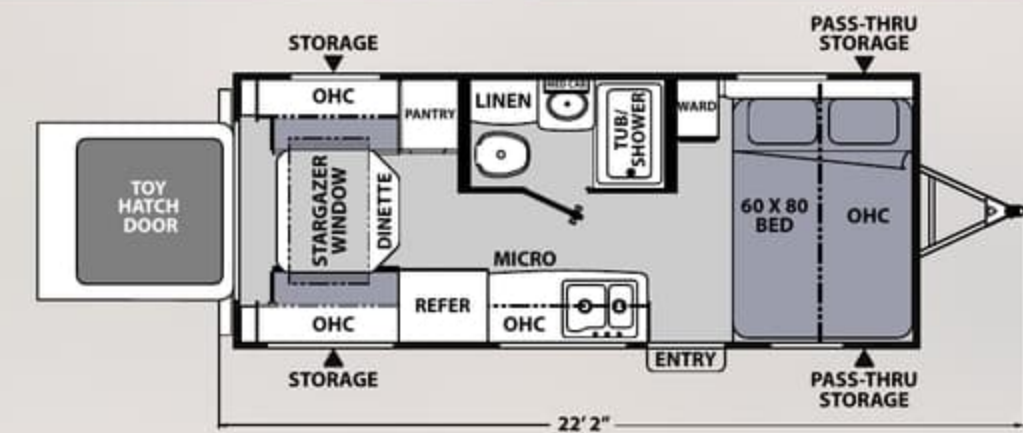

17 TH

**NEW FLOORPLAN!**



# NANO TRAVEL TRAILERS

**LIGHTWEIGHT.  
EASY TO TOW.**

These smaller, easy to tow models deliver many of the amenities of a larger travel trailer.

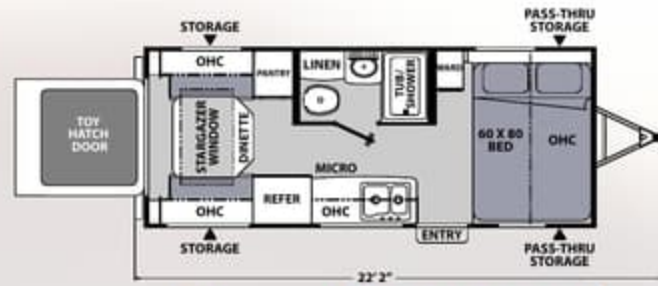

**17 TH** **NEW FLOORPLAN!**

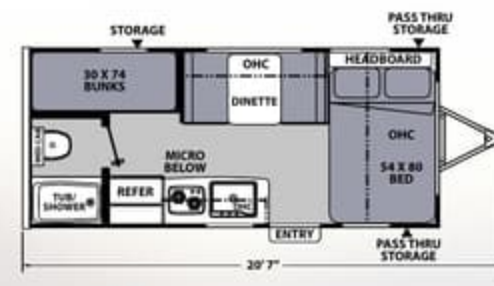

**185 BH**

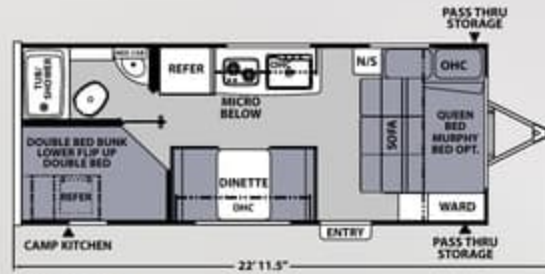

**186 BH**

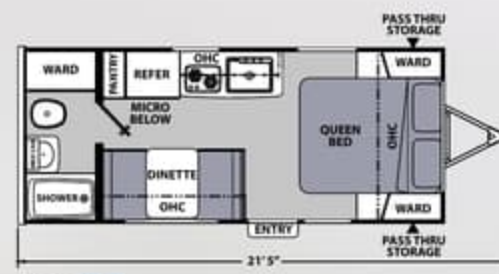

**187 RB**

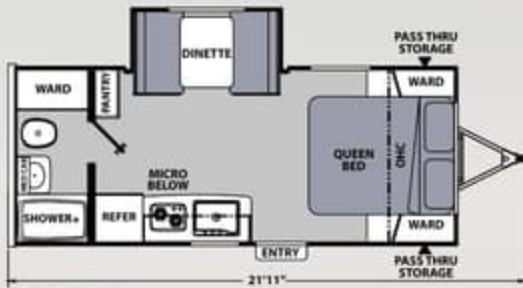

**191 RBS**

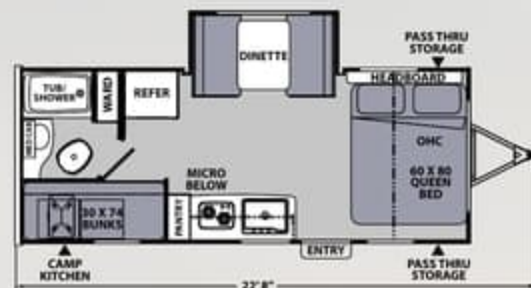

**194 BHS**

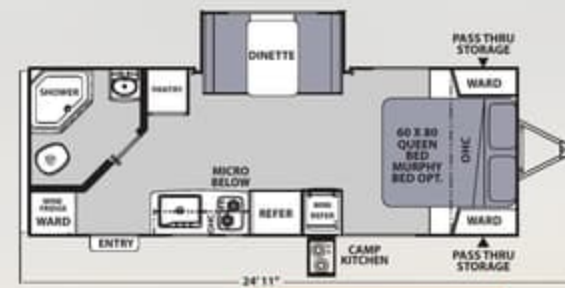

**201 RBS** **NEW FLOORPLAN!**

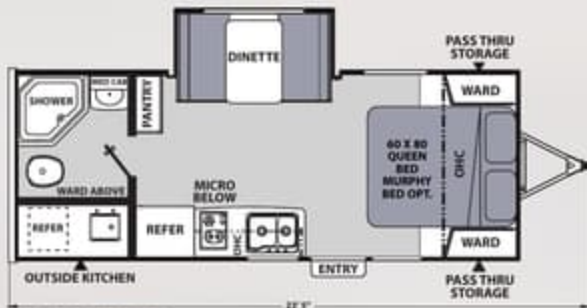

**203 RBK**

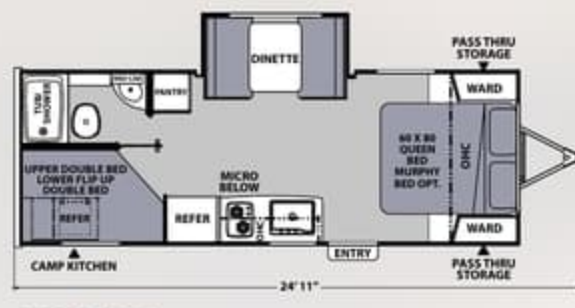

**208 BHS**

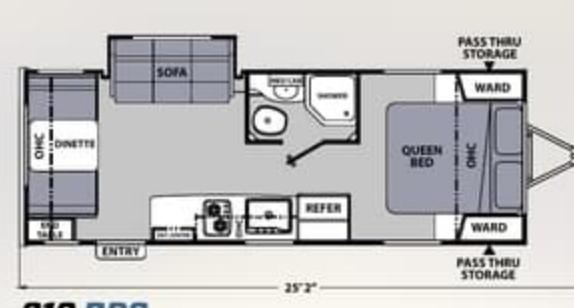

**213 RDS**

Apex Nano	17 TH	185 BH	186 BH	187 RB	191 RBS	194 BHS	201 RBS	203 RBK	208 BHS	213 RDS
Hitch Weight	478	400	472	462	482	492	550	478	526	540
Carrying Capacity	1,120	1,234	1,074	1,342	1,114	910	1,952	2,084	1,712	1,806
UVW	3,542	3,466	3,626	3,358	3,586	3,890	4,048	3,916	4,288	4,194
GVWR	4700	4,700	4,700	4,700	4,700	4,800	6,000	6,000	6,000	6,000
Ext. Length (Incl. Bumper to Hitch)	22' 2"	20' 7"	22' 11.5"	21' 5"	21' 11"	22' 8"	24' 11"	23' 5"	24' 11"	25' 2"
Ext. Height (Incl. A/C)	9' 10"	9' 10"	9' 9"	9' 10"	9' 10"	9' 10"	9' 11"	9' 11"	9' 11"	9' 11"
Int. Height (Coach)	77"	77"	77"	77"	77"	77"	77"	77"	77"	77"
Awning Length	14'	12'	15'	12'	12'	14'	16'	15'	14'	15'
Fresh Water Capacity (gal.)	37	52	52	52	52	52	52	52	52	52
Grey Water Capacity (gal.)	27	27	27	27	27	27	35	35	35	35
Waste Water Capacity (gal.)	27	27	27	27	27	27	35	35	35	35

Refer to chart descriptions on back cover.

# APEX

NANO • OFF GRID

Mandatory option. Nano models only.

## Dual LP Tanks with Cover

- (2) 20 lb. Tanks with Cover for Longer Camping Time



## 12 Volt Outlets & USB Charger

- Pass-thru, Outside Kitchen and Bedside



## High Volume Power Roof Vent

- 3-Speeds
- Quiet Operation
- 9.3 CFM Air Circulation



## 200 Watt Solar Panel with 30 AMP Control Charger to Battery

- High Efficiency Solar Cells
- 30 AMP Solar Charge Controller



**15" All-Terrain Tires**  
Optional on Nano only.



# NANO TRAVEL TRAILERS

**LIGHTWEIGHT.  
EASY TO TOW.**

These smaller, easy to tow models deliver many of the amenities of a larger travel trailer.

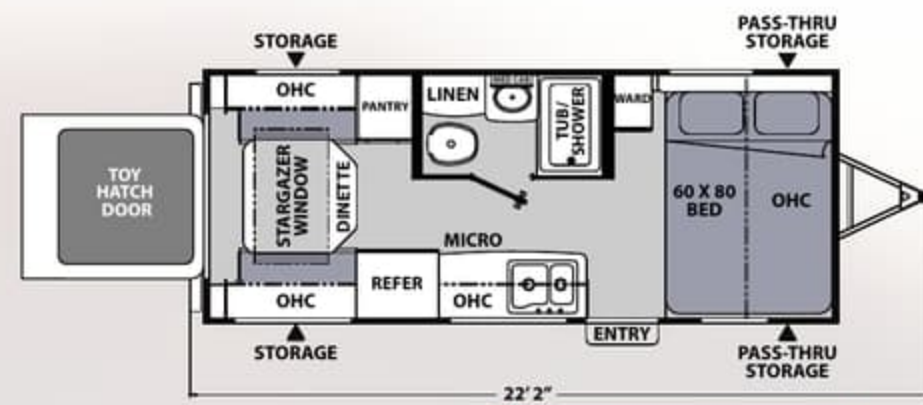

**17 TH** **NEW FLOORPLAN!**

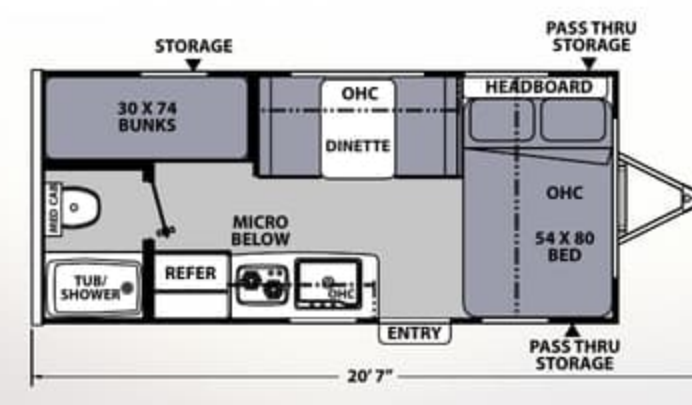

**185 BH**

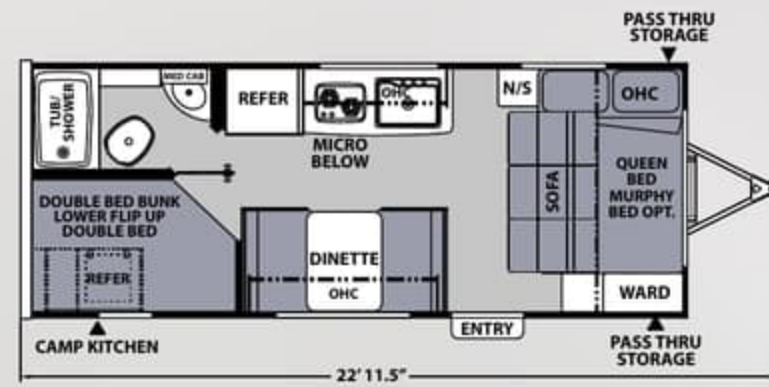

**186 BH**

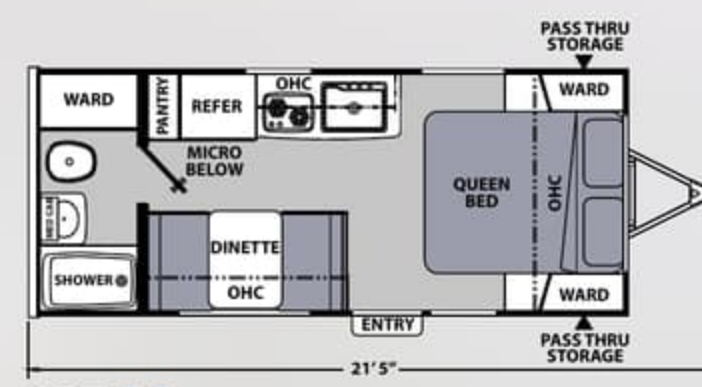

**187 RB**

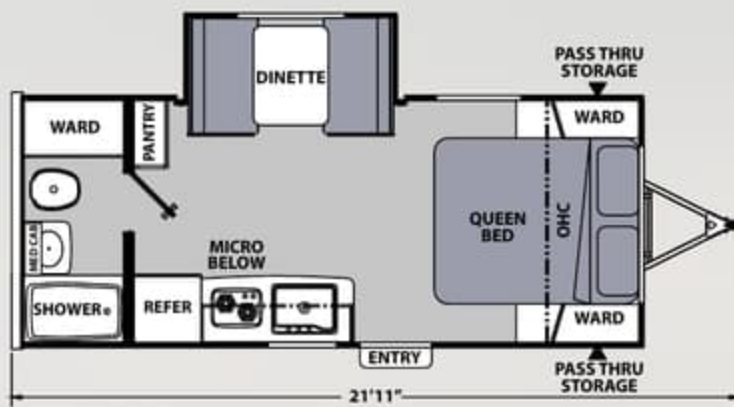

**191 RBS**

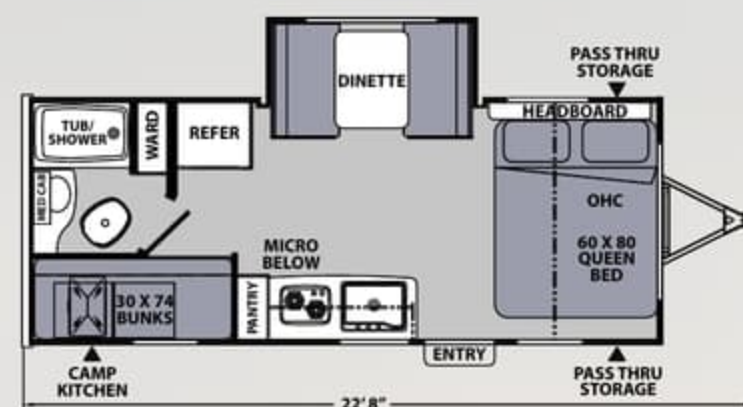

**194 BHS**

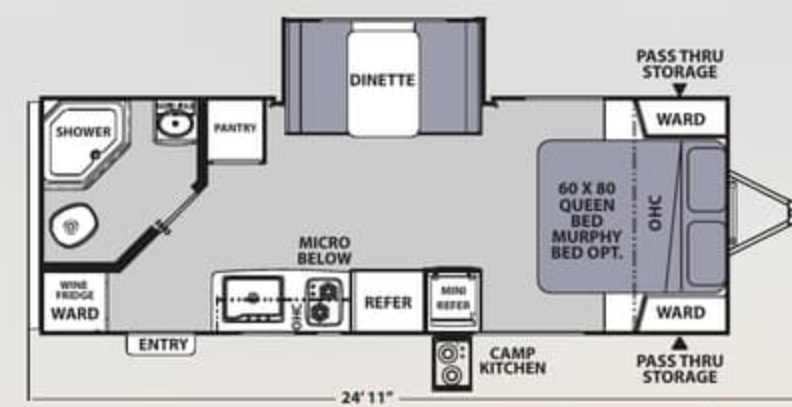

**201 RBS** **NEW FLOORPLAN!**

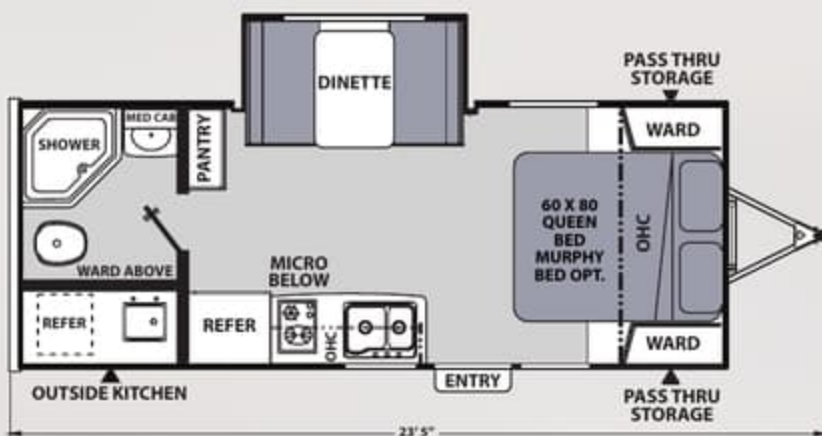

**203 RBK**

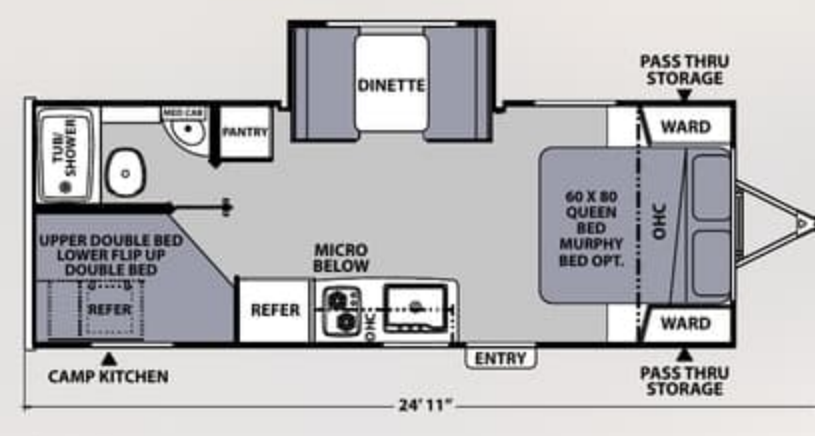

**208 BHS**

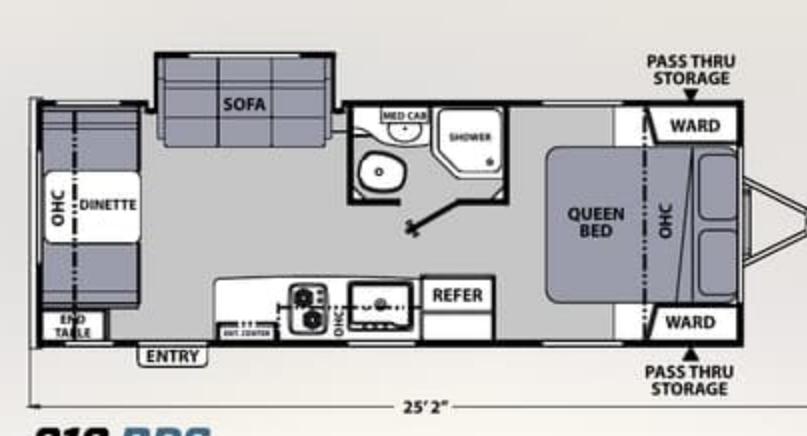

**213 RDS**

Apex Nano	17 TH	185 BH	186 BH	187 RB	191 RBS	194 BHS	201 RBS	203 RBK	208 BHS	213 RDS
Hitch Weight	478	400	472	462	482	492	550	478	526	540
Carrying Capacity	1,120	1,234	1,074	1,342	1,114	910	1,952	2,084	1,712	1,806
UVW	3,542	3,466	3,626	3,358	3,586	3,890	4,048	3,916	4,288	4,194
GVWR	4700	4,700	4,700	4,700	4,700	4,800	6,000	6,000	6,000	6,000
Ext. Length (Incl. Bumper to Hitch)	22' 2"	20' 7"	22' 11.5"	21' 5"	21' 11"	22' 8"	24' 11"	23' 5"	24' 11"	25' 2"
Ext. Height (Incl. A/C)	9' 10"	9' 10"	9' 9"	9' 10"	9' 10"	9' 10"	9' 11"	9' 11"	9' 11"	9' 11"
Int. Height (Coach)	77"	77"	77"	77"	77"	77"	77"	77"	77"	77"
Awning Length	14'	12'	15'	12'	12'	14'	16'	15'	14'	15'
Fresh Water Capacity (gal.)	37	52	52	52	52	52	52	52	52	52
Grey Water Capacity (gal.)	27	27	27	27	27	27	35	35	35	35
Waste Water Capacity (gal.)	27	27	27	27	27	27	35	35	35	35

Refer to chart descriptions on back cover.

# APEX

NANO • OFF GRID

Mandatory option. Nano models only.

## Dual LP Tanks with Cover

- (2) 20 lb. Tanks with Cover for Longer Camping Time



## 12 Volt Outlets & USB Charger

- Pass-thru, Outside Kitchen and Bedside



## High Volume Power Roof Vent

- 3-Speeds
- Quiet Operation
- 9.3 CFM Air Circulation



## 200 Watt Solar Panel with 30 AMP Control Charger to Battery

- High Efficiency Solar Cells
- 30 AMP Solar Charge Controller



## 15" All-Terrain Tires

Optional on Nano only.



# NANO STANDARD FEATURES AND OPTIONS

## NANO PACKAGE (MANDATORY)

- Vacuum-bonded Laminated Azdel Fiberglass Side Walls
- Vacuum-bonded Laminated Azdel Fiberglass Rear Wall
- Vacuum-bonded Laminated Crowned Roof
- Laminated Aluminum Framed Floor
- Fiberglass Front Cap w/LED Lighting and Window [N/A Remote]
- Alumina-cage Construction
- Two-Tone White and Grey Fiberglass Exterior Sidewalls
- Front Stone Guard
- Enclosed Underbelly w/Forced Air Heat [Double axle models] [N/A Remote]
- Spare Tire
- Outside Speakers
- Stabilizer Jacks (4)
- LP Port
- DSI Gas/Electric Water Heater

- Hot/Cold Outside Shower
- Black Tank Flush
- Swing Away Assist Handle
- Friction Hinge Entrance Door
- Solid Step
- Magnetic Baggage Door Catches
- Hard Valances w/Night Shades Throughout
- LED Interior Lighting Throughout
- Microwave
- Flush-mount 2-Burner Cooktop
- 8 Cu. Ft. 12 V. Refrigerator
- Stainless Steel Single Bowl Sink w/ Flush-mount Cover
- Access Doors Under Dinette
- AM/FM Stereo w/Bluetooth
- Digital TV Antenna w/Cable Hook-ups and WiFi Capability
- Tub Surround
- Skylight in Bath
- Mattress with Cover

## INTERIOR AND DÉCOR

- Prestige Poplar Cabinetry
- Shaker Cabinet Door Frames
- Stile and Rail Cabinet Front Construction
- One-Piece Seamless Edge Countertops
- Congoleum DiamondFlor Flooring
- Overhead Bedroom Cabinets w/Side Wardrobes
- Collapsible Bin
- Hard Valances w/Night Shades Throughout
- Pedestal Dinette Table
- Foldable Table [17 TH only]
- Large Oversized Booth Dinette
- LP Leak Alarm
- Fire Extinguisher
- Smoke Alarm
- Carbon Monoxide Detector

## ELECTRICAL/HEATING/AC

- Direct Vent Furnace
- 13.5K BTU A/C
- 35 Amp Power Center with Auto-detect, Lithium-compatible
- Outside Receptacle GFI
- Detachable Marine Style Power Cord
- USB Chargers

## GALLEY

- 8 Cu. Ft. 12 V. Refrigerator
- Flush-mount 2-Burner Cooktop
- Microwave
- Stainless Steel Single Bowl Sink w/Flush-mount Cover
- One-Piece Seamless Edge Countertops
- Matte Black Hardware

## BATH AND WATER

- 6 Gal. Gas/Electric DSI Hot Water Heater

- Power Bath Vent
- Water Heater Bypass Valve
- On-demand Water Pump
- Below Floor Low Point Drains
- Foot Flush Toilet
- Tub Surround
- Hand-crafted Wood Medicine Cabinet
- Bathroom Organizer

## EXTERIOR/CONSTRUCTION

- Alumina-Cage Construction
- Vacuum-bonded, Aluminum Trussed Roof w/Dicor Crossflex Roof Membrane
- Vacuum-bonded Azdel Fiberglass Sidewalls [R-11]
- Vacuum-bonded Azdel Fiberglass Rear Wall
- Laminated Aluminum Framed Floor [R-11]
- Corrosion Resistant Powder Coated Frame

- I-beam Chassis Construction [Double Axle Models]
- Box Tube Chassis Construction [Single Axle Models]
- Heated and Enclosed Underbelly w/ Forced Air [Double Axle Only]
- Gutter Rail
- [2] 20 Lb. LP Tanks
- Dual Battery Tray
- Solid Step
- Tinted Safety Glass Radius Windows
- Radius Entrance Door w/Window and Friction Hinge
- Deadbolt Lock
- Radius Thumb Latch Baggage Doors
- Break Away Switch
- Dexter® E-Z Lube® Axles
- Radial Tires

## COMFORT PACKAGE (MANDATORY)

- Direct Vent Furnace

- Power Awning w/LED Lighting
- 13.5k BTU A/C
- Spare Tire and Carrier

## OFF-GRID PACKAGE(MANDATORY)

- [2] 20 Lb. LP Tanks w/Cover
- High Velocity 10" Power Roof Vent
- 200 Watt Solar Panel w/30 Amp Dual Control Charger to Battery
- 12V Outlet & USB Charger [Pass-thru, Outside Kitchen, and Bedside]

## OPTIONS

- Murphy Bed [186 BH, 201 RBS, 203 RBK, 208 BHS Only]
- 12V Tank Heater Pads
- 15K BTU A/C Upgrade
- 15" All-Terrain Tires
- Aluminum Rims
- Star-Gazer



Remote comes fully loaded with the Wilderness Package (Shown)

## DESIGNED TO LEAVE THE WORLD BEHIND.

Adventure awaits in this 7' wide, easy to tow trailer with big amenities. This mighty little camper boasts the same solid construction as other Apex models, and includes a full bath with shower and toilet, a 8 cu. ft. 12v refrigerator and a 54" x 80" bed.



## REMOTE WILDERNESS PACKAGE (MANDATORY)

- 15" All-Terrain Tires
- Aluminum Rims
- Front Bike Rack
- Toy Lock
- [2] 20 Lb. LP Tanks w/Cover
- 200 Watt Solar Panel w/30 AMP Control Charger
- 13.5 BTU A/C
- 12V Heat Pads for Black, Grey and Fresh Water Tanks

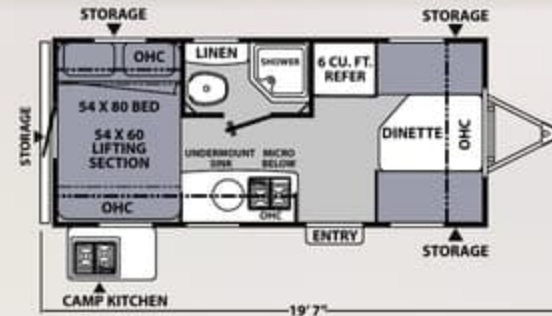

16 R

Apex Remote	16 R
Hitch Weight	330
Carrying Capacity	940
UVW	2,860
GVWR	3,800
Ext. Length (Incl. Bumper to Hitch)	19' 7"
Ext. Height (Incl. A/C)	9' 10"
Int. Height (Coach)	77"
Awning Length	12'
Fresh Water Capacity (gal.)	52
Grey Water Capacity (gal.)	35
Waste Water Capacity (gal.)	35

Refer to chart descriptions on back cover.

# NANO STANDARD FEATURES AND OPTIONS

## NANO PACKAGE (MANDATORY)

- Vacuum-bonded Laminated Azdel Fiberglass Side Walls
- Vacuum-bonded Laminated Azdel Fiberglass Rear Wall
- Vacuum-bonded Laminated Crowned Roof
- Laminated Aluminum Framed Floor
- Fiberglass Front Cap w/LED Lighting and Window [N/A Remote]
- Alumina-cage Construction
- Two-Tone White and Grey Fiberglass Exterior Sidewalls
- Front Stone Guard
- Enclosed Underbelly w/Forced Air Heat [Double axle models] [N/A Remote]
- Spare Tire
- Outside Speakers
- Stabilizer Jacks [4]
- LP Port
- DSI Gas/Electric Water Heater

- Hot/Cold Outside Shower
- Black Tank Flush
- Swing Away Assist Handle
- Friction Hinge Entrance Door
- Solid Step
- Magnetic Baggage Door Catches
- Hard Valances w/Night Shades Throughout
- LED Interior Lighting Throughout
- Microwave
- Flush-mount 2-Burner Cooktop
- 8 Cu. Ft. 12 V. Refrigerator
- Stainless Steel Single Bowl Sink w/ Flush-mount Cover
- Access Doors Under Dinette
- AM/FM Stereo w/Bluetooth
- Digital TV Antenna w/Cable Hook-ups and WiFi Capability
- Tub Surround
- Skylight in Bath
- Mattress with Cover

## INTERIOR AND DÉCOR

- Prestige Poplar Cabinetry
- Shaker Cabinet Door Frames
- Stile and Rail Cabinet Front Construction
- One-Piece Seamless Edge Countertops
- Congoleum DiamondFlor Flooring
- Overhead Bedroom Cabinets w/Side Wardrobes
- Collapsible Bin
- Hard Valances w/Night Shades Throughout
- Pedestal Dinette Table
- Foldable Table [17 TH only]
- Large Oversized Booth Dinette
- LP Leak Alarm
- Fire Extinguisher
- Smoke Alarm
- Carbon Monoxide Detector

## ELECTRICAL/HEATING/AC

- Direct Vent Furnace
- 13.5K BTU A/C
- 35 Amp Power Center with Auto-detect, Lithium-compatible
- Outside Receptacle GFI
- Detachable Marine Style Power Cord
- USB Chargers

## GALLEY

- 8 Cu. Ft. 12 V. Refrigerator
- Flush-mount 2-Burner Cooktop
- Microwave
- Stainless Steel Single Bowl Sink w/Flush-mount Cover
- One-Piece Seamless Edge Countertops
- Matte Black Hardware

## BATH AND WATER

- 6 Gal. Gas/Electric DSI Hot Water Heater

- Power Bath Vent
- Water Heater Bypass Valve
- On-demand Water Pump
- Below Floor Low Point Drains
- Foot Flush Toilet
- Tub Surround
- Hand-crafted Wood Medicine Cabinet
- Bathroom Organizer

## EXTERIOR/CONSTRUCTION

- Alumina-Cage Construction
- Vacuum-bonded, Aluminum Trussed Roof w/Dicor Crossflex Roof Membrane
- Vacuum-bonded Azdel Fiberglass Sidewalls [R-11]
- Vacuum-bonded Azdel Fiberglass Rear Wall
- Laminated Aluminum Framed Floor [R-11]
- Corrosion Resistant Powder Coated Frame

- I-beam Chassis Construction [Double Axle Models]
- Box Tube Chassis Construction [Single Axle Models]
- Heated and Enclosed Underbelly w/ Forced Air [Double Axle Only]
- Gutter Rail
- [2] 20 Lb. LP Tanks
- Dual Battery Tray
- Solid Step
- Tinted Safety Glass Radius Windows
- Radius Entrance Door w/Window and Friction Hinge
- Deadbolt Lock
- Radius Thumb Latch Baggage Doors
- Break Away Switch
- Dexter® E-Z Lube® Axles
- Radial Tires

## COMFORT PACKAGE (MANDATORY)

- Direct Vent Furnace

- Power Awning w/LED Lighting
- 13.5k BTU A/C
- Spare Tire and Carrier

## OFF-GRID PACKAGE(MANDATORY)

- [2] 20 Lb. LP Tanks w/Cover
- High Velocity 10" Power Roof Vent
- 200 Watt Solar Panel w/30 Amp Dual Control Charger to Battery
- 12V Outlet & USB Charger [Pass-thru, Outside Kitchen, and Bedside]

## OPTIONS

- Murphy Bed [186 BH, 201 RBS, 203 RBK, 208 BHS Only]
- 12V Tank Heater Pads
- 15K BTU A/C Upgrade
- 15" All-Terrain Tires
- Aluminum Rims
- Star-Gazer



Remote comes fully loaded with the Wilderness Package (Shown)

## DESIGNED TO LEAVE THE WORLD BEHIND.

Adventure awaits in this 7' wide, easy to tow trailer with big amenities. This mighty little camper boasts the same solid construction as other Apex models, and includes a full bath with shower and toilet, a 8 cu. ft. 12v refrigerator and a 54" x 80" bed.



## REMOTE WILDERNESS PACKAGE (MANDATORY)

- 15" All-Terrain Tires
- Aluminum Rims
- Front Bike Rack
- Toy Lock
- [2] 20 Lb. LP Tanks w/Cover
- 200 Watt Solar Panel w/30 AMP Control Charger
- 13.5 BTU A/C
- 12V Heat Pads for Black, Grey and Fresh Water Tanks

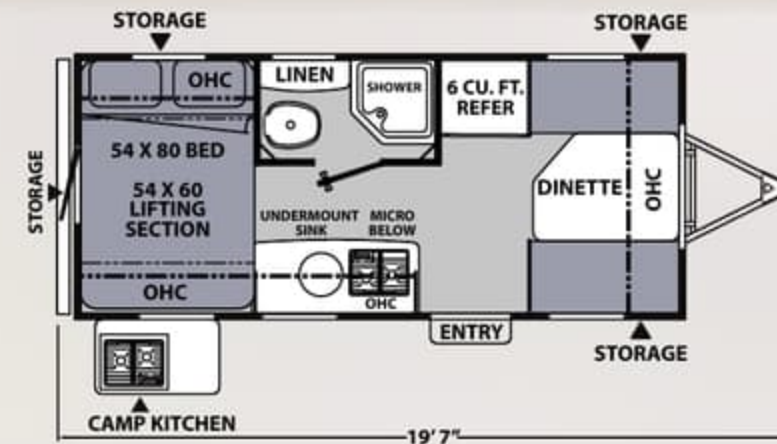

16 R

Apex Remote	16 R
Hitch Weight	330
Carrying Capacity	940
UVW	2,860
GVWR	3,800
Ext. Length [Incl. Bumper to Hitch]	19' 7"
Ext. Height [Incl. A/C]	9' 10"
Int. Height [Coach]	77"
Awning Length	12'
Fresh Water Capacity [gal.]	52
Grey Water Capacity [gal.]	35
Waste Water Capacity [gal.]	35

Refer to chart descriptions on back cover.

# APEX

ULTRALITE

An Apex Travel Trailer does not just start off as a frame, walls and roof... it begins with an idea! Our belief is that getting the little things right is a BIG THING! The Apex UltraLite is not like other lightweight trailers. It is much smarter because we set new, higher standards for this innovative, truly lightweight trailer.



243 FKS



243 FKS



243 FKS

**OUR MODERN INTERIORS ARE BEAUTIFULLY PAIRED WITH INNOVATIVE USE OF SPACE TO MAKE CAMPING COMFORTABLE AND EASY.**

Super Bed Storage in the 243 FKS keeps gear and extras organized for easy access, creating a walk-in storage area. (On select models) Collapsible storage bins are available on all Apex.

# APEX

ULTRALITE

An Apex Travel Trailer does not just start off as a frame, walls and roof... it begins with an idea! Our belief is that getting the little things right is a BIG THING! The Apex UltraLite is not like other lightweight trailers. It is much smarter because we set new, higher standards for this innovative, truly lightweight trailer.



243 FKS



243 FKS



243 FKS

**OUR MODERN INTERIORS ARE BEAUTIFULLY PAIRED WITH INNOVATIVE USE OF SPACE TO MAKE CAMPING COMFORTABLE AND EASY.**

Super Bed Storage in the 243 FKS keeps gear and extras organized for easy access, creating a walk-in storage area. (On select models) Collapsible storage bins are available on all Apex.



The 243 FKS is perfect for couples who like to kick back and relax with all the amenities of home. It's open concept living at its finest, with comfortable seating located directly across from the TV for a great view, and a booth dinette for those game nights. The 243 FKS is standard equipped with a Hide-A-Bed sofa with optional theater seats.



The 243 FKS is perfect for couples who like to kick back and relax with all the amenities of home. It's open concept living at its finest, with comfortable seating located directly across from the TV for a great view, and a booth dinette for those game nights. The 243 FKS is standard equipped with a Hide-A-Bed sofa with optional theater seats.

This spacious 290BHS has it all from a large U-shaped dinette, which is great for game night or comfortable dining to the entertainment center with fireplace directly across from the Hide-A-Bed sofa (theatre seating optional) and the double over double bunks. This is a true family coach!



## ULTRALITE STANDARD FEATURES AND OPTIONS

### VALUE PACKAGE (MANDATORY)

- Vacuum-bonded Laminated Azdel Fiberglass Side Walls
- Vacuum-bonded Laminated Azdel Fiberglass Rear Wall
- Vacuum-bonded Laminated Crowned Roof
- Laminated Aluminum Framed Floor
- Fiberglass Front Cap w/LED Lighting and Window
- Aluma-cage Construction
- Two-Tone White and Grey Fiberglass Exterior Sidewalls
- Front Stone Guard
- Enclosed Underbelly w/Forced Air Heat
- Aluminum Wheels
- Spare Tire
- Slide Topper Prep
- Back-up Camera Mount
- Power Tongue Jack
- Outside Speakers
- Stabilizer Jacks (4)
- LP Port
- 200 Watt Solar Panel w/ 30 AMP Control Charger
- 13.5 BTU A/C (Ducted on 8' wide)

- Ducted/Direct Vent Furnace (Floor Plan Specific)
- DSI Gas/Electric Water Heater
- Hot/Cold Outside Shower
- Black Tank Flush Kit
- Power Awning w/Lighting
- Swing Away Assist Handle
- Friction Hinge Entrance Door
- Solid Step
- Slam Latch Baggage Door Catches
- LED Motion Sensor Light in Exterior Storage Area
- Hard Valances w/Night Shades Throughout
- LED Interior Lighting Throughout
- Microwave
- Lighted, Flush-mount, 3-Burner High Output Range w/Oven
- 8 Cu. Ft. 12V Refrigerator
- Stainless Steel Single Bowl Sink w/Flush-mount Cover
- Access Doors Under Dinette (Some models)
- Interior Convenience Center
- AM/FM Stereo w/Bluetooth
- Digital TV Antenna w/Cable Hook-ups and WiFi Capability
- USB Charging Station

- LED TV
- Hide-A-Bed Sofa (Deep slides only)
- Tub Surround
- Skylight in Bath
- Mattress with Cover

### INTERIOR AND DÉCOR

- Prestige Poplar Cabinetry
- Shaker Cabinet Door Frames
- Stile and Rail Cabinet Front Construction
- One-Piece Seamless Edge Countertops
- Congoleum DiamondFlor Flooring
- Overhead Bedroom Cabinets w/Side Wardrobes
- Collapsible Bin
- Hard Valances w/Night Shades Throughout
- Pedestal Dinette Table (Fold Up Table on 211RBS)
- Large Oversized Booth or U-shaped Dinette w/Sliding Door Storage Access
- 68" Residential Sofa (Most models)
- LED TV
- LP Leak Alarm

- Fire Extinguisher
- Smoke Alarm
- Carbon Monoxide Detector

### ELECTRICAL / HEATING/AC

- Furnace - Forced Air/Ducts Per Floorplan
- 13.5 BTU A/C (Ducted on 8' wide)
- 55 Amp Power Center with Auto-detect, Lithium-compatible
- Outside Receptacle GFI
- 200 Watt Solar Panel w/ 30 AMP Control Charger
- Detachable Marine Style Power Cord
- USB Chargers

### GALLEY

- 8 Cu. Ft. 12V Refrigerator
- Flush-mount 3-Burner Stovetop w/Oven
- Power LED Lighted Range Hood
- Microwave
- Stainless Steel Single Bowl Sink w/Flush-mount Cover
- One-Piece Seamless Edge Countertops
- Matte Black Hardware

### BATH AND WATER

- 6 Gal. Gas/Electric DSI Hot Water Heater
- Power Bath Vent
- Water Heater Bypass Valve
- On-Demand Water Pump
- Below Floor Low Point Drains
- Foot Flush Toilet
- Tub Surround
- Glass Shower Door - 34" Neo-angle Showers
- Hand-crafted Wood Medicine Cabinet
- Bathroom Organizer

### EXTERIOR/ CONSTRUCTION

- Aluma-Cage Construction
- Vacuum-bonded, Aluminum Trussed Roof w/Dicor Crossflex Roof Membrane (R-11 - 7½' wide, R-14 - 8' wide)
- Vacuum-bonded Laminated Azdel Fiberglass Sidewalls (R-11)
- Vacuum-bonded Azdel Fiberglass Rear Wall
- Laminated Aluminum Framed Floor (R-11)
- Corrosion Resistant Powder Coated Frame

- I-beam Chassis Construction
- Heated and Enclosed Underbelly w/Forced Air
- Gutter Rail
- Dual 20 Lb. LP Tanks w/Cover
- Dual Battery Tray
- Solid Step
- Tinted Safety Glass Radius Windows
- Radius Entrance Door w/Window and Friction Hinge
- Dead Bolt Lock
- Radius Slam Latch Baggage Doors
- Break Away Switch
- SuperLube Axles by Lippert
- Radial Tires

### OPTIONS

- Frameless Dark Tint Windows
- 15K BTU A/C Upgrade
- 50 Amp Service w/Second (Forced) 13.5K BTU A/C
- Theater Seating



Flip-up double bunk provides easy access to the rear wall storage door.



Private bedroom models offer plenty of storage, and are prepped for a TV.

This spacious 290BHS has it all from a large U-shaped dinette, which is great for game night or comfortable dining to the entertainment center with fireplace directly across from the Hide-A-Bed sofa (theatre seating optional) and the double over double bunks. This is a true family coach!



## ULTRALITE STANDARD FEATURES AND OPTIONS

### VALUE PACKAGE (MANDATORY)

- Vacuum-bonded Laminated Azdel Fiberglass Side Walls
- Vacuum-bonded Laminated Azdel Fiberglass Rear Wall
- Vacuum-bonded Laminated Crowned Roof
- Laminated Aluminum Framed Floor
- Fiberglass Front Cap w/LED Lighting and Window
- Alumacage Construction
- Two-Tone White and Grey Fiberglass Exterior Sidewalls
- Front Stone Guard
- Enclosed Underbelly w/Forced Air Heat
- Aluminum Wheels
- Spare Tire
- Slide Topper Prep
- Back-up Camera Mount
- Power Tongue Jack
- Outside Speakers
- Stabilizer Jacks [4]
- LP Port
- 200 Watt Solar Panel w/ 30 AMP Control Charger
- 13.5 BTU A/C [Ducted on 8' wide]

- Ducted/Direct Vent Furnace [Floor Plan Specific]
- DSI Gas/Electric Water Heater
- Hot/Cold Outside Shower
- Black Tank Flush Kit
- Power Awning w/Lighting
- Swing Away Assist Handle
- Friction Hinge Entrance Door
- Solid Step
- Slam Latch Baggage Door Catches
- LED Motion Sensor Light in Exterior Storage Area
- Hard Valances w/Night Shades Throughout
- LED Interior Lighting Throughout
- Microwave
- Lighted, Flush-mount, 3-Burner High Output Range w/Oven
- 8 Cu. Ft. 12V Refrigerator
- Stainless Steel Single Bowl Sink w/Flush-mount Cover
- Access Doors Under Dinette [Some models]
- Interior Convenience Center
- AM/FM Stereo w/Bluetooth
- Digital TV Antenna w/Cable Hook-ups and WiFi Capability
- USB Charging Station

- LED TV
- Hide-A-Bed Sofa [Deep slides only]
- Tub Surround
- Skylight in Bath
- Mattress with Cover

### INTERIOR AND DÉCOR

- Prestige Poplar Cabinetry
- Shaker Cabinet Door Frames
- Stile and Rail Cabinet Front Construction
- One-Piece Seamless Edge Countertops
- Congoleum DiamondFlor Flooring
- Overhead Bedroom Cabinets w/Side Wardrobes
- Collapsible Bin
- Hard Valances w/Night Shades Throughout
- Pedestal Dinette Table [Fold Up Table on 211RBS]
- Large Oversized Booth or U-shaped Dinette w/Sliding Door Storage Access
- 68" Residential Sofa [Most models]
- LED TV
- LP Leak Alarm

- Fire Extinguisher
- Smoke Alarm
- Carbon Monoxide Detector

### ELECTRICAL / HEATING/AC

- Furnace - Forced Air/Ducts Per Floorplan
- 13.5 BTU A/C [Ducted on 8' wide]
- 55 Amp Power Center with Auto-detect, Lithium-compatible
- Outside Receptacle GFI
- 200 Watt Solar Panel w/ 30 AMP Control Charger
- Detachable Marine Style Power Cord
- USB Chargers

### GALLEY

- 8 Cu. Ft. 12V Refrigerator
- Flush-mount 3-Burner Stovetop w/Oven
- Power LED Lighted Range Hood
- Microwave
- Stainless Steel Single Bowl Sink w/Flush-mount Cover
- One-Piece Seamless Edge Countertops
- Matte Black Hardware

### BATH AND WATER

- 6 Gal. Gas/Electric DSI Hot Water Heater
- Power Bath Vent
- Water Heater Bypass Valve
- On-Demand Water Pump
- Below Floor Low Point Drains
- Foot Flush Toilet
- Tub Surround
- Glass Shower Door - 34" Neo-angle Showers
- Hand-crafted Wood Medicine Cabinet
- Bathroom Organizer

### EXTERIOR/ CONSTRUCTION

- Alumacage Construction
- Vacuum-bonded, Aluminum Trussed Roof w/Dicor Crossflex Roof Membrane [R-11 - 7½' wide, R-14 - 8' wide]
- Vacuum-bonded Laminated Azdel Fiberglass Sidewalls [R-11]
- Vacuum-bonded Azdel Fiberglass Rear Wall
- Laminated Aluminum Framed Floor [R-11]
- Corrosion Resistant Powder Coated Frame

- I-beam Chassis Construction
- Heated and Enclosed Underbelly w/Forced Air
- Gutter Rail
- Dual 20 Lb. LP Tanks w/Cover
- Dual Battery Tray
- Solid Step
- Tinted Safety Glass Radius Windows
- Radius Entrance Door w/Window and Friction Hinge
- Dead Bolt Lock
- Radius Slam Latch Baggage Doors
- Break Away Switch
- SuperLube Axles by Lippert
- Radial Tires

### OPTIONS

- Frameless Dark Tint Windows
- 15K BTU A/C Upgrade
- 50 Amp Service w/Second [Forced] 13.5K BTU A/C
- Theater Seating



Flip-up double bunk provides easy access to the rear wall storage door.



Private bedroom models offer plenty of storage, and are prepped for a TV.



# ULTRALITE TRAVEL TRAILERS

Apex Ultralites are ideal for towing with half ton trucks and most smaller SUVs. Weights range from just over 4000 lbs. up to 6500 lbs. Apex floor plans have rich, warm interiors, full-sized bathrooms, contemporary cabinetry, fabrics and flooring. These lightweight, durable, travel trailers are constructed with a vacuum-bonded, aluminum framed roof, double laminated Azdel composite sidewalls, laminated rear wall, and a laminated, insulated floor.

## 7-1/2' WIDE



215 RBK

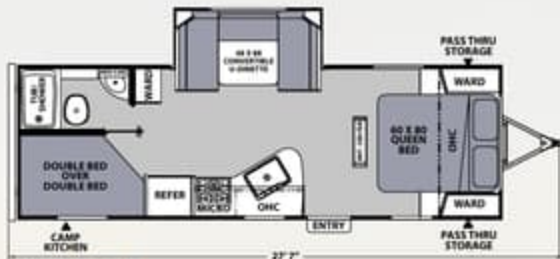

245 BHS

## 8' WIDE



211 RBS

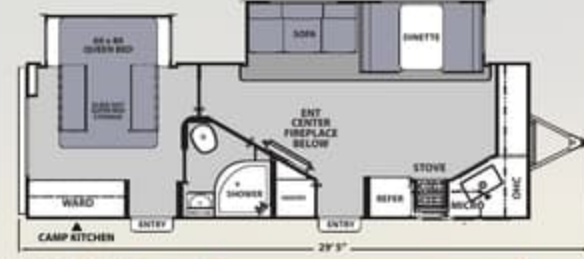

243 FKS

**NEW FLOORPLAN!**



251 RBK



256 BHS

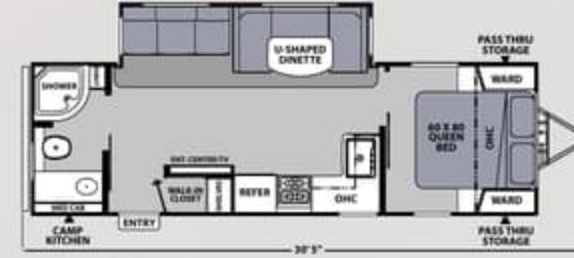

265 RBSS

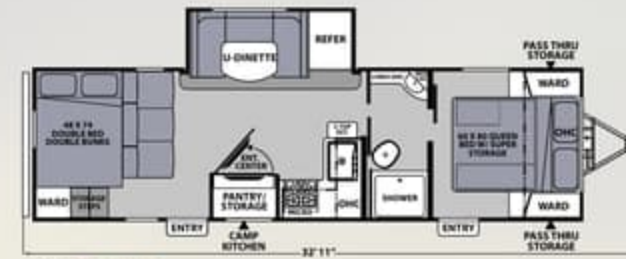

266 BHS



284 BHSS

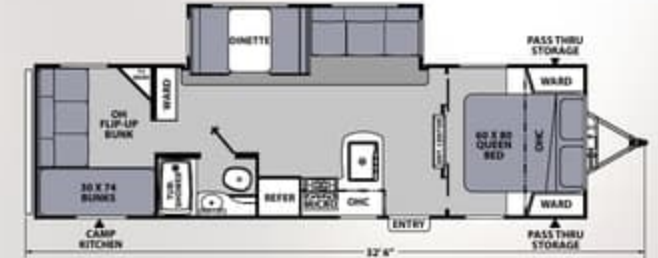

289 TBSS

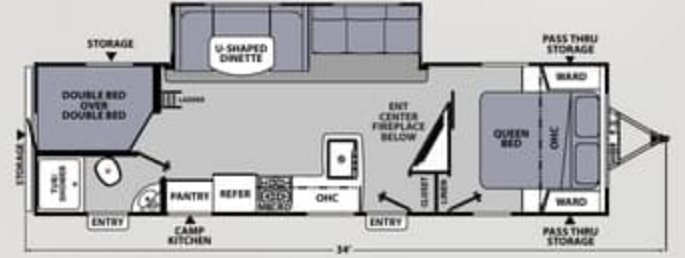

290 BHS

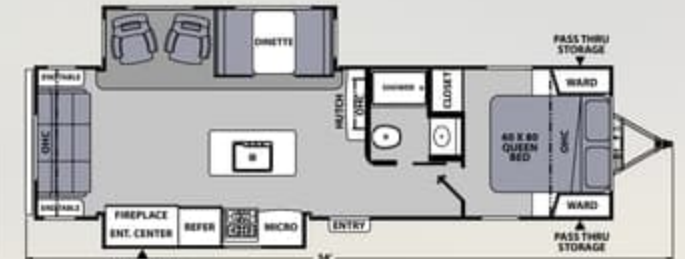

293 RLDS



300 BHS

**EXTENDED CAMPING**  
**HEATED & ENCLOSED UNDERBELLY**

Double axle floor plans only.

Apex 7.5' WIDES	215 RBK	245 BHS	Apex 8' WIDES	211 RBS	243 FKS	251 RBK	256 BHS	265 RBSS	266 BHS	284 BHSS	289 TBSS	290 BHS	293 RLDS	300 BHS
Hitch Weight	446	578	Hitch Weight	630	810	570	694	734	934	810	715	758	832	672
Carrying Capacity	2,135	1,914	Carrying Capacity	1,938	1,654	2,016	2,128	1,948	1,520	1,578	1,882	1,432	1,360	1,625
UVW	4,365	4,586	UVW	5,062	5,906	4,984	5,472	5,652	6,080	6,022	5,718	6,168	6,440	5,975
GVWR	6,500	6,500	GVWR	7,000	7,600	7,000	7,600	7,600	7,600	7,600	7,600	7,600	7,800	7,600
Ext. Length (Incl. Bumper to Hitch)	25' 6"	27' 7"	Ext. Length (Incl. Bumper to Hitch)	26' 2"	29' 5"	29'	30' 1"	30' 5"	32' 11"	32' 7"	32' 6"	34'	34'	34' 5"
Ext. Height (Incl. A/C)	10' 2"	10' 2"	Ext. Height (Incl. A/C)	10' 5"	10' 7"	10' 1"	10' 5"	10' 6"	10' 5"	10' 7"	10' 6"	10' 7"	10' 7"	10' 1"
Int. Height (Coach)	78"	78"	Int. Height (Coach)	78"	78"	78"	78"	78"	78"	78"	78"	78"	78"	78"
Awning Length	13'	18'	Awning Length	15'	20'	16'	16'	18'	20'	18'	18'	20'	18'	18'
Fresh Water Capacity (gal.)	52	52	Fresh Water Capacity (gal.)	50	50	50	50	50	50	50	50	50	50	50
Grey Water Capacity (gal.)	35	35	Grey Water Capacity (gal.)	35	70	35	70	70	35	70	35	35	70	35
Waste Water Capacity (gal.)	35	35	Waste Water Capacity (gal.)	35	35	35	35	35	35	35	35	35	35	35

# ULTRALITE TRAVEL TRAILERS

Apex Ultralites are ideal for towing with half ton trucks and most smaller SUVs. Weights range from just over 4000 lbs. up to 6500 lbs. Apex floor plans have rich, warm interiors, full-sized bathrooms, contemporary cabinetry, fabrics and flooring. These lightweight, durable, travel trailers are constructed with a vacuum-bonded, aluminum framed roof, double laminated Azdel composite sidewalls, laminated rear wall, and a laminated, insulated floor.

## 7-1/2' WIDE

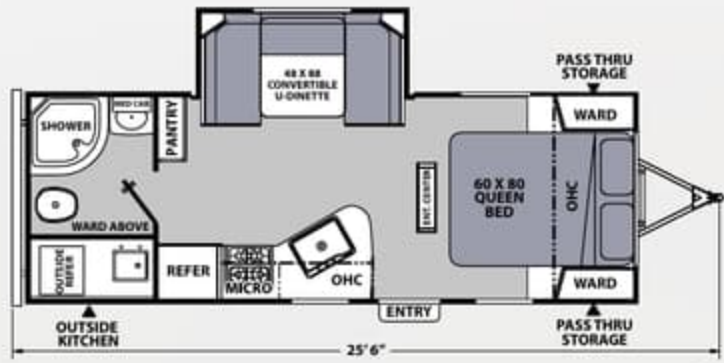

**215 RBK**

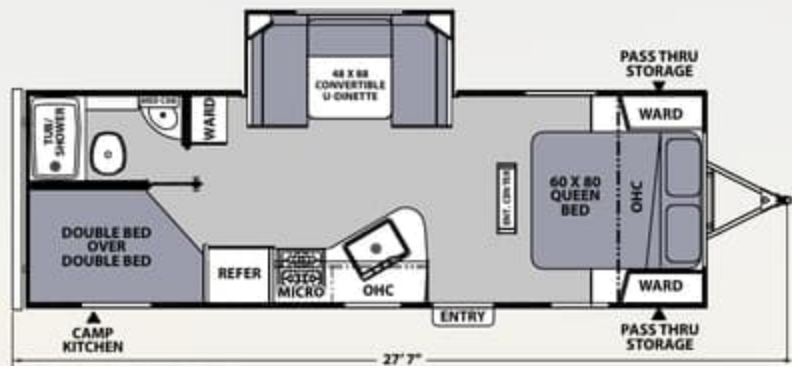

**245 BHS**

## 8' WIDE

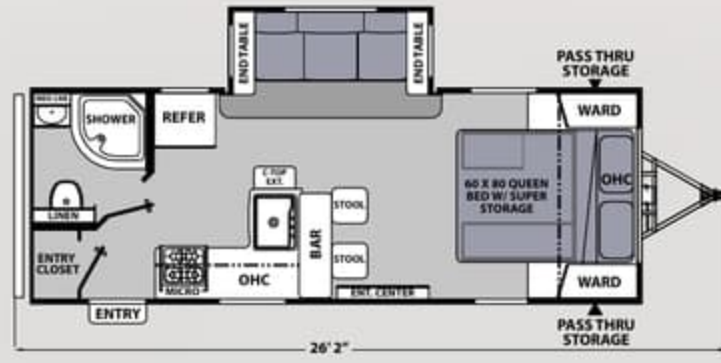

**211 RBS**

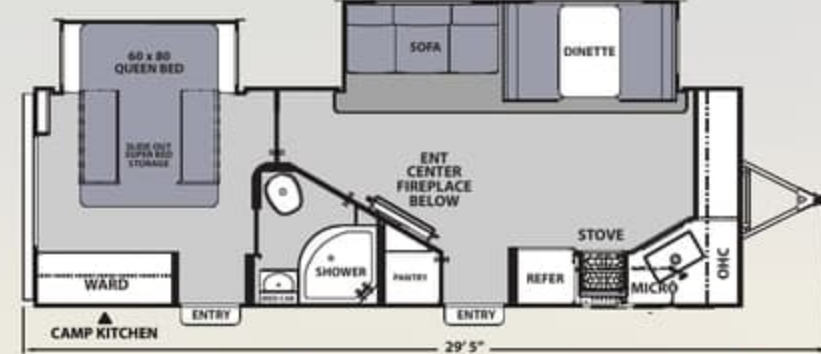

**243 FKS**

**NEW FLOORPLAN!**

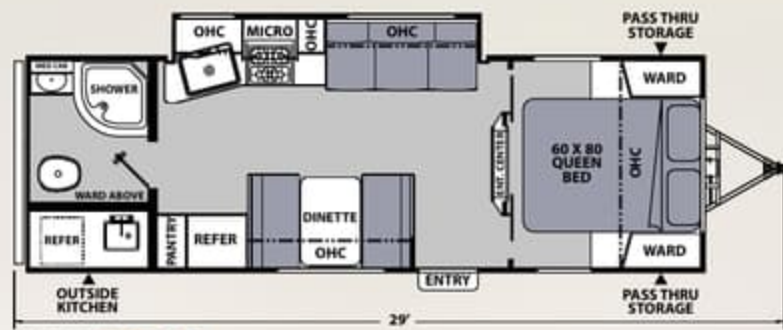

**251 RBK**



**256 BHS**

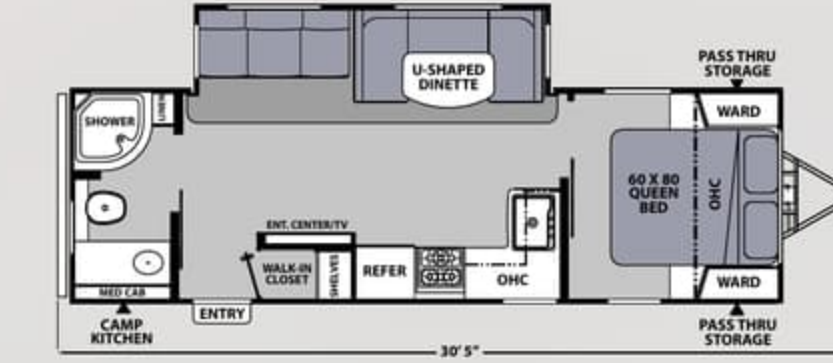

**265 RBSS**

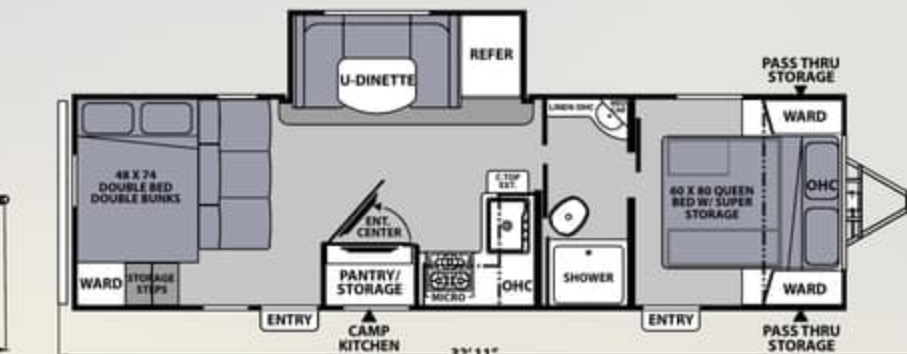

**266 BHS**

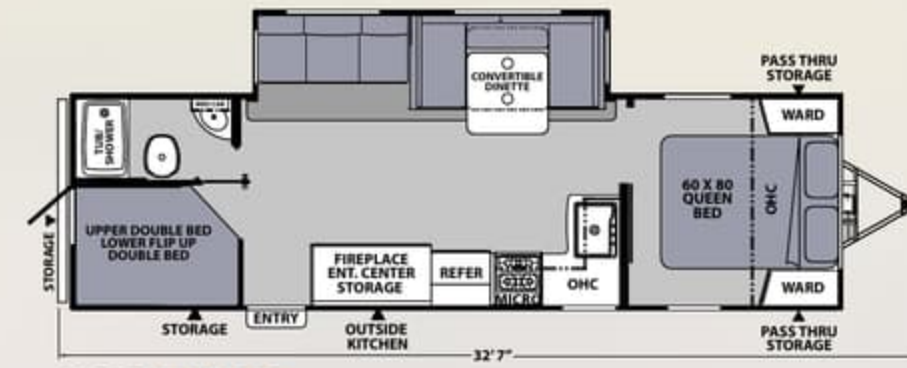

**284 BHSS**

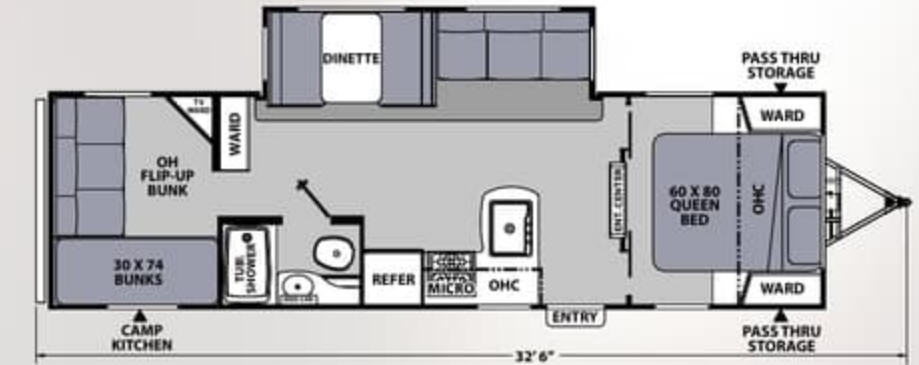

**289 TBSS**

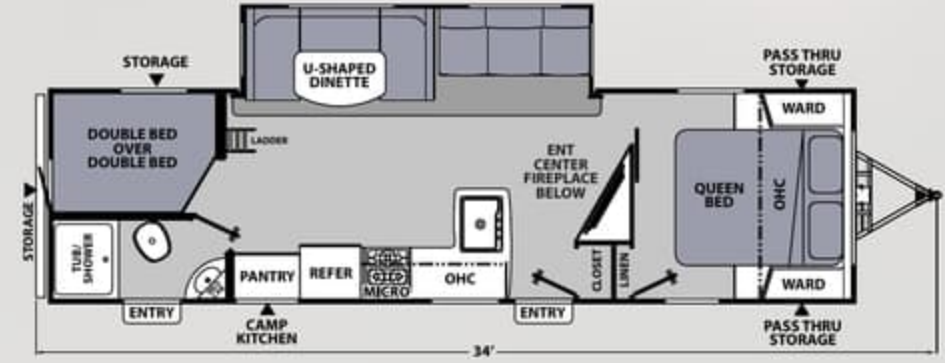

**290 BHS**

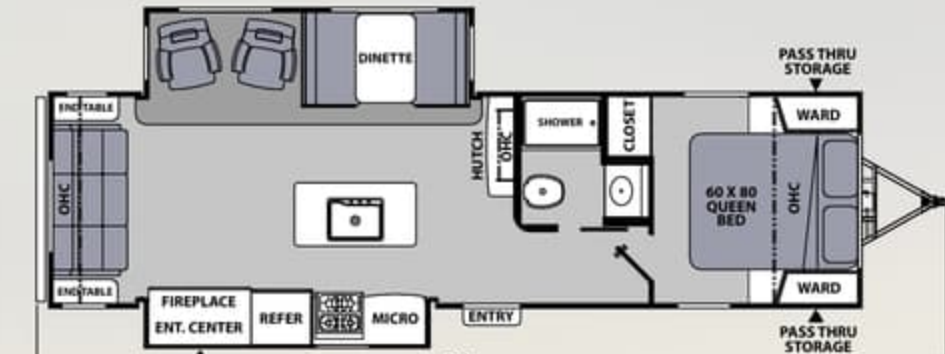

**293 RLDS**

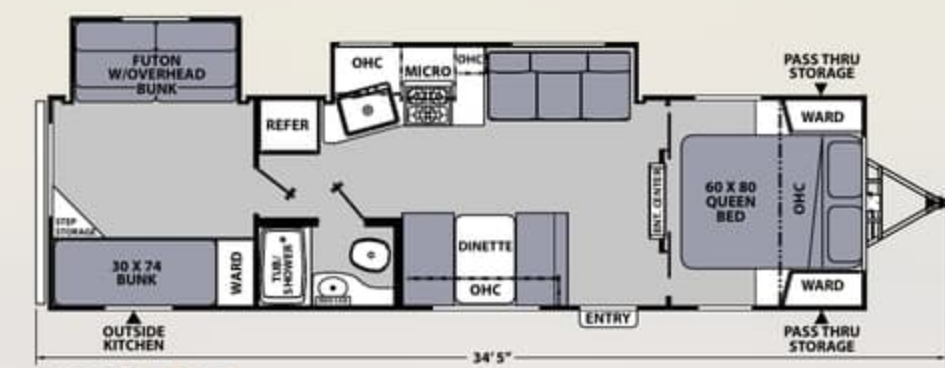

**300 BHS**

**EXTENDED CAMPING HEATED & ENCLOSED UNDERBELLY**

Double axle floor plans only.

Apex 7.5' WIDES	215 RBK	245 BHS	Apex 8' WIDES	211 RBS	243 FKS	251 RBK	256 BHS	265 RBSS	266 BHS	284 BHSS	289 TBSS	290 BHS	293 RLDS	300 BHS
Hitch Weight	446	578	Hitch Weight	630	810	570	694	734	934	810	715	758	832	672
Carrying Capacity	2,135	1,914	Carrying Capacity	1,938	1,654	2,016	2,128	1,948	1,520	1,578	1,882	1,432	1,360	1,625
UVW	4,365	4,586	UVW	5,062	5,906	4,984	5,472	5,652	6,080	6,022	5,718	6,168	6,440	5,975
GVWR	6,500	6,500	GVWR	7,000	7,600	7,000	7,600	7,600	7,600	7,600	7,600	7,600	7,800	7,600
Ext. Length (Incl. Bumper to Hitch)	25' 6"	27' 7"	Ext. Length (Incl. Bumper to Hitch)	26' 2"	29' 5"	29'	30' 1"	30' 5"	32' 11"	32' 7"	32' 6"	34'	34'	34' 5"
Ext. Height (Incl. A/C)	10' 2"	10' 2"	Ext. Height (Incl. A/C)	10' 5"	10' 7"	10' 1"	10' 5"	10' 6"	10' 5"	10' 7"	10' 6"	10' 7"	10' 7"	10' 1"
Int. Height (Coach)	78"	78"	Int. Height (Coach)	78"	78"	78"	78"	78"	78"	78"	78"	78"	78"	78"
Awning Length	13'	18'	Awning Length	15'	20'	16'	16'	18'	20'	18'	18'	20'	18'	18'
Fresh Water Capacity (gal.)	52	52	Fresh Water Capacity (gal.)	50	50	50	50	50	50	50	50	50	50	50
Grey Water Capacity (gal.)	35	35	Grey Water Capacity (gal.)	35	70	35	70	70	35	70	35	35	70	35
Waste Water Capacity (gal.)	35	35	Waste Water Capacity (gal.)	35	35	35	35	35	35	35	35	35	35	35

# APEX CONSTRUCTION

## Construction Features

1. 3M Breathable graphics
2. Tinted, safety glass windows
3. Welded aluminum structure, vacuum-bonded sidewalls and rear wall, laminated floor
4. Aluminum reinforced vacuum-bonded roof
5. Dicor Crossflex roofing membrane
6. Azdel composite exterior/interior sidewall and rear wall panels
7. Aerodynamic front profile with fiberglass front cap and integrated window
8. (2) 20 lb. LP tanks
9. Insulated slam latch doors with magnetic hold-ups (N/A Nanos)
10. Smooth exterior fiberglass skin
11. Aluminum framed openings
12. Fully enclosed, heated underbelly (Double axle models)
13. Fully welded tubular aluminum floor structure
14. Slide system
15. Congoleum® DiamondFlor flooring
16. Powder E-coated, welded I-beam frame with full-depth crossmembers
17. Dexter® E-Z Lube® axle hubs (Nano) SuperLube axles by Lippert (Ultralite)
18. Radial tires

Apex features the combination of environmentally friendly Azdel wall boards inside, and Azdel composite panels outside, plus Alumaticage Construction to maximize. These Ultralite Travel Trailers are designed for towing by today's half-ton trucks, and SUVs. From 18' to 34'. All units are available under 6,800 lbs.



## Fiberglass Front Cap

- ¾ Front fiberglass cap for superior strength
- Automotive glass front window with superior UV protection
- Front stone guard
- Integrated LED accent lights
- Vacuum Bonded Sidewalls and Roof
- Stronger construction
- Lighter weight



**Apex is proud to be one of three products to receive the Emerald Level Certification, the highest rated level possible.**

As a Certified Green RV, APEX utilizes effective production techniques in combination with healthy materials, plus efficient usage of energy and water to produce a high quality RV with less environmental impact.

Check us out at:  
[coachmenrv.com/travel-trailers/apex](http://coachmenrv.com/travel-trailers/apex)

**LIGHTWEIGHT DURABILITY**



Double axle floor plans only.



Lower Center of Gravity for Better Towability



## Welded Aluminum Framing

Durable, lightweight aluminum cage – individually framed cut-outs to make for stronger sidewalls and reduce water leaks.



## Aluminum Reinforced Vacuum-bonded Roof

The aluminum framed, laminated roof is lighter than the competition, rigid and fully walkable.

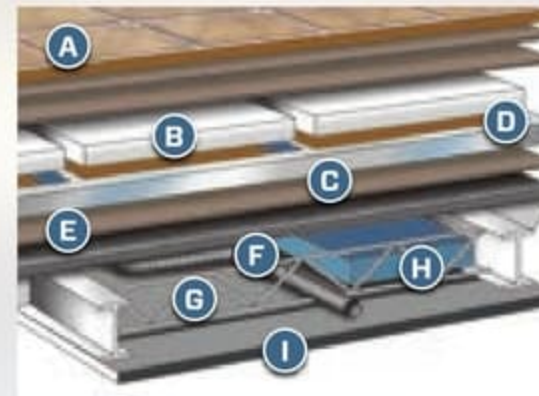

## Six Layer Laminated Floor

- A Residential durable insulated floor covering
- B Double layer Luan plywood top decking
- C Welded aluminum frame
- D Block foam structural insulation
- E Luan plywood bottom decking
- F Darco waterproof floor wrap
- G Cross member support
- H Holding tanks
- I Heated and enclosed underbelly (Double axle models)

# APEX CONSTRUCTION

## Construction Features

1. 3M Breathable graphics
2. Tinted, safety glass windows
3. Welded aluminum structure, vacuum-bonded sidewalls and rear wall, laminated floor
4. Aluminum reinforced vacuum-bonded roof
5. Dicor Crossflex roofing membrane
6. Azdel composite exterior/interior sidewall and rear wall panels
7. Aerodynamic front profile with fiberglass front cap and integrated window
8. (2) 20 lb. LP tanks
9. Insulated slam latch doors with magnetic hold-ups (N/A Nanos)
10. Smooth exterior fiberglass skin
11. Aluminum framed openings
12. Fully enclosed, heated underbelly (Double axle models)
13. Fully welded tubular aluminum floor structure
14. Slide system
15. Congoleum® DiamondFlor flooring
16. Powder E-coated, welded I-beam frame with full-depth crossmembers
17. Dexter® E-Z Lube® axle hubs (Nano) SuperLube axles by Lippert (Ultralite)
18. Radial tires

Apex features the combination of environmentally friendly Azdel wall boards inside, and Azdel composite panels outside, plus Alumicage Construction to maximize. These Ultralite Travel Trailers are designed for towing by today's half-ton trucks, and SUVs. From 18' to 34'. All units are available under 6,800 lbs.



## Fiberglass Front Cap

- ¾ Front fiberglass cap for superior strength
- Automotive glass front window with superior UV protection
- Front stone guard
- Integrated LED accent lights
- Vacuum Bonded Sidewalls and Roof
- Stronger construction
- Lighter weight



Apex is proud to be one of three products to receive the **Emerald Level Certification**, the highest rated level possible.

As a Certified Green RV, APEX utilizes effective production techniques in combination with healthy materials, plus efficient usage of energy and water to produce a high quality RV with less environmental impact.

Check us out at:  
[coachmenrv.com/travel-trailers/apex](http://coachmenrv.com/travel-trailers/apex)

**LIGHTWEIGHT DURABILITY**



Double axle floor plans only.



Lower Center of Gravity for Better Towability



## Welded Aluminum Framing

Durable, lightweight aluminum cage - individually framed cut-outs to make for stronger sidewalls and reduce water leaks.



## Aluminum Reinforced Vacuum-bonded Roof

The aluminum framed, laminated roof is lighter than the competition, rigid and fully walkable.

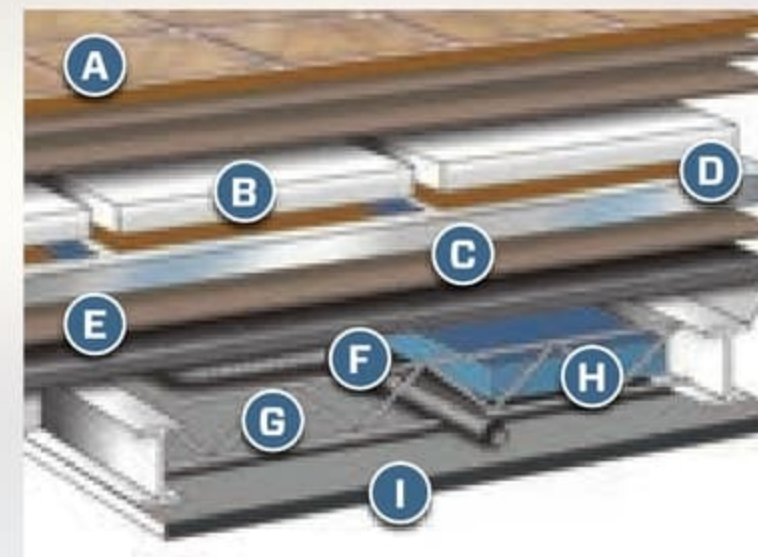

## Six Layer Laminated Floor

- A Residential durable insulated floor covering
- B Double layer Luan plywood top decking
- C Welded aluminum frame
- D Block foam structural insulation
- E Luan plywood bottom decking
- F Darco waterproof floor wrap
- G Cross member support
- H Holding tanks
- I Heated and enclosed underbelly (Double axle models)

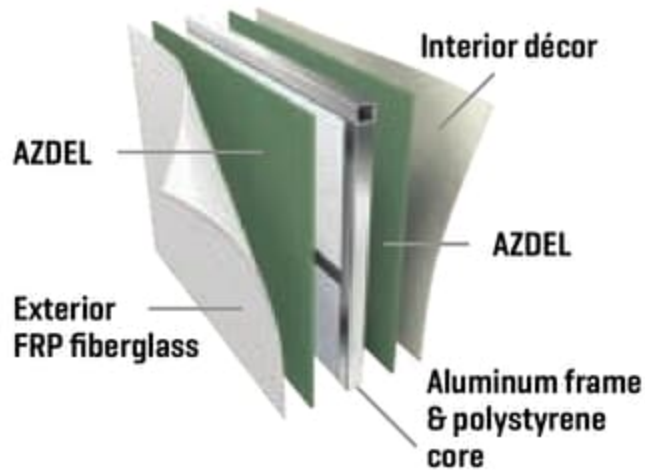

**Double the AZDEL, Double the Benefits:**

By using AZDEL for both the exterior and interior panels, we have doubled our benefits for overall weight reduction, temperature control, sound absorption, longevity, and low VOCs. Azdel composite panels are produced using a patented blend of polypropylene and fiberglass to create a durable, lightweight, water and temperature resistant, odorless and eco-friendly wall that will increase the life of your RV.



Weight matters  
50% Lighter  
than wood



Let it rain –  
no mold, rot,  
mildew, warping or  
delamination



Unaffected by  
changes in  
temperature  
& humidity



Twice the  
thermal  
insulation of  
plywood



Free of  
formaldehyde,  
toxic odors  
and chemicals



Longer  
RV life



Quieter  
RVs



No  
deforestation

**Knock on Wood. Traditional Luan Sidewall Panels:**

- Absorb and retain water
- Affected by humidity and temperature changes
- Susceptible to mold, rot, warpage and delamination
- Imported
- Heavier
- Inferior thermal insulation and noise blocking



**Avoid Costly Water Damage**

- Water and wood don't mix
- Water can cause rot, mold and delamination of wood sidewall panels causing thousands of dollars in damage



**Soak Test**

- 60 Day soak test
- Wood has visible mold and decay requiring wall repair
- AZDEL was 100% unaffected

**APEX STANDARD FEATURES**



**Entertainment Center with Fireplace**

Includes an AM/FM stereo with Bluetooth, LED TV and upgraded stereo speakers. (Available on 243 FKS, 284 BHSS, 290 BHS and 293 RLDS.)



**Bathroom Organizer**

Keep all your bathroom items organized and within arms reach hung over the door.



**Collapsible Laundry Bin**

Tucked neatly inside each Apex, this collapsible bin makes laundry day feel more like home.



**200 Watt Solar Power**

All Apex come equipped with a high-efficiency 200 watt solar panel. Connecting through a 30 AMP control charger, the battery power provides off-grid capability for dry camping.



**Mini Fridge**

Camp kitchens are equipped with mini refrigerator. (Available on 186 BH, 194 BHS, 208 BHS, 245 BHS, 256 BHS, 265 RBSS, 266 BHS, 289 TBSS, 290 BHS, 293 RLDS - floorplan specific.)



**Camp Kitchen**

Camp kitchens are equipped with either a grill or a 2-burner cooktop, and a refrigerator. (Available on 186 BH, 194 BHS, 208 BHS, 245 BHS, 256 BHS, 265 RBSS, 266 BHS, 289 TBSS, 290 BHS, 293 RLDS - floorplan specific.)



**Outside Kitchen**

Includes a grill or two-burner cooktop, large refrigerator, plumbed sink, gooseneck faucet and additional storage. (Available on 203 RBK, 215 RBK, 251 RBK, 284 BHSS and 300 BHS - floorplan specific.)



Scan the QR code to see more Apex features that make camping with us easier!

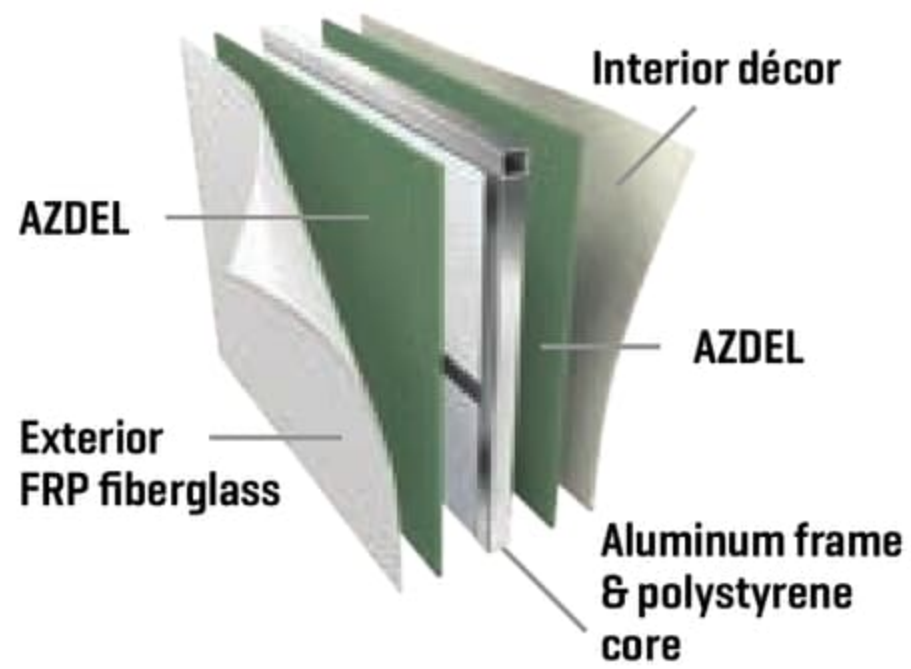

**Double the AZDEL, Double the Benefits:**

By using AZDEL for both the exterior and interior panels, we have doubled our benefits for overall weight reduction, temperature control, sound absorption, longevity, and low VOCs. Azdel composite panels are produced using a patented blend of polypropylene and fiberglass to create a durable, lightweight, water and temperature resistant, odorless and eco-friendly wall that will increase the life of your RV.



Weight matters  
50% Lighter  
than wood



Let it rain –  
no mold, rot,  
mildew, warping or  
delamination



Unaffected by  
changes in  
temperature  
& humidity



Twice the  
thermal  
insulation of  
plywood



Free of  
formaldehyde,  
toxic odors  
and chemicals



Longer  
RV life



Quieter  
RVs



No  
deforestation

**Knock on Wood. Traditional Lauan Sidewall Panels:**

- Absorb and retain water
- Affected by humidity and temperature changes
- Susceptible to mold, rot, warpage and delamination
- Imported
- Heavier
- Inferior thermal insulation and noise blocking



**Avoid Costly Water Damage**

- Water and wood don't mix
- Water can cause rot, mold and delamination of wood sidewall panels causing thousands of dollars in damage



**Soak Test**

- 60 Day soak test
- Wood has visible mold and decay requiring wall repair
- AZDEL was 100% unaffected

**APEX STANDARD FEATURES**



**Entertainment Center with Fireplace**

Includes an AM/FM stereo with Bluetooth, LED TV and upgraded stereo speakers. [Available on 243 FKS, 284 BHSS, 290 BHS and 293 RLDS.]



**Bathroom Organizer**

Keep all your bathroom items organized and within arms reach hung over the door.



**Collapsible Laundry Bin**

Tucked neatly inside each Apex, this collapsible bin makes laundry day feel more like home.



**200 Watt Solar Power**

All Apex come equipped with a high-efficiency 200 watt solar panel. Connecting through a 30 AMP control charger, the battery power provides off-grid capability for dry camping.



**Mini Fridge**

Camp kitchens are equipped with mini refrigerator. [Available on 186 BH, 194 BHS, 208 BHS, 245 BHS, 256 BHS, 265 RBSS, 266 BHS, 289 TBSS, 290 BHS, 293 RLDS – floorplan specific.]



**Camp Kitchen**

Camp kitchens are equipped with either a grill or a 2-burner cooktop, and a refrigerator. [Available on 186 BH, 194 BHS, 208 BHS, 245 BHS, 256 BHS, 265 RBSS, 266 BHS, 289 TBSS, 290 BHS, 293 RLDS – floorplan specific.]



**Outside Kitchen**

Includes a grill or two-burner cooktop, large refrigerator, plumbed sink, gooseneck faucet and additional storage. [Available on 203 RBK, 215 RBK, 251 RBK, 284 BHSS and 300 BHS – floorplan specific.]



Scan the QR code to see more Apex features that make camping with us easier!

# EXPERIENCE YOUR OWN **ULTRALITE ADVENTURE**

Versatile Apex Travel Trailers provide a perfect home base, wherever the road leads.



**APEX'S FULL LINE OF ULTRALITES ARE PERFECT FOR SMALLER TOW VEHICLES**



423 N. Main Street · P.O. Box 30 · Middlebury, IN 46540

To learn more about Coachmen RV and our products and see how Coachmen is making the easy life easier, visit <https://coachmenrv.com/travel-trailers/apex-ultra-lite>.



### Coachmen Interactive Mobile Manuals

Download your Coachmen mobile app or visit our dynamic online manual to enhance your ownership experience. These interactive options provide incredible ease and insight into use, maintenance and enjoyment of your Coachmen product. Ranging from "How-To" videos, pictures and illustrations of various components, systems and features to fully searchable content and downloadable PDFs for individual component owner's manuals, answers are always just a click away.

**YOUR APEX DEALER**



**24/7 EMERGENCY  
ROADSIDE ASSISTANCE  
WITH VEHICLE PURCHASE\***

TOWING JUMP-STARTS TIRE CHANGES FLUID DELIVERY LOCKOUT SERVICE	WINCH-OUT MOBILE MECHANIC TECHNICAL SUPPORT DEALER LOCATOR SERVICES
---	--

**SAFERIDER RV  
MOTOR CLUB**

\*VALID FOR 1 YEAR FROM DATE OF PURCHASE

**GVWR (Gross Vehicle Weight Rating)** - is the maximum permissible weight of the unit when fully loaded. It includes all weights, inclusive of all fluids, cargo, optional equipment and accessories. For safety and product performance do NOT exceed the GVWR.

**GAWR (Gross Axle Weight Rating)** - is the maximum permissible weight, including cargo, fluids, optional equipment and accessories that can be safely supported by a combination of all axles.

**UVW (Unloaded Vehicle Weight)\*** - is the typical weight of the unit as manufactured at the factory. It includes all weight at the unit's axle(s) and tongue or pin and LP Gas. The UVW does not include cargo, fresh potable water, additional optional equipment or dealer installed accessories. \*Estimated average based on standard build optional equipment.

**CCC (Cargo Carrying Capacity)\*\*** - is the amount of weight available for fresh potable water, cargo, additional optional equipment and accessories. CCC is equal to GVWR minus UVW. Available CCC should accommodate fresh potable water (8.3 lbs per gallon). Before filling the fresh water tank, empty the black and grey tanks to provide for more cargo capacity. \*\*Estimated average based on standard build optional equipment.

Each Forest River RV is weighed at the manufacturing facility prior to shipping. A label identifying the unloaded vehicle weight of the actual unit and the cargo carrying capacity is applied to every Forest River RV prior to leaving our facilities. The load capacity of your unit is designated by weight, not by volume, so you cannot necessarily use all available space when loading your unit. All information contained in this brochure is believed to be accurate at the time of publication. However, during the model year, it may be necessary to make revisions and Forest River, Inc., reserves the right to make all such changes without notice, including prices, colors, materials, equipment and specifications as well as the addition of new models and the discontinuance of models shown in this brochure. Therefore, please consult with your Forest River dealer and confirm the existence of any materials, design or specifications that are material to your purchase decision. ©2021 Apex by Coachmen RV, a Division of Forest River, Inc., a Berkshire Hathaway company. All rights reserved. 11/22 CHM 1969



Learn More  
Scan this barcode using a QR Reader on your smart phone to learn more about Forest River.



# EXPERIENCE YOUR OWN ULTRALITE ADVENTURE

Versatile Apex Travel Trailers provide a perfect home base, wherever the road leads.



APEX'S FULL LINE OF ULTRALITES ARE PERFECT FOR SMALLER TOW VEHICLES



423 N. Main Street · P.O. Box 30 · Middlebury, IN 46540

To learn more about Coachmen RV and our products and see how Coachmen is making the easy life easier, visit <https://coachmenrv.com/travel-trailers/apex-ultra-lite>.



### Coachmen Interactive Mobile Manuals

Download your Coachmen mobile app or visit our dynamic online manual to enhance your ownership experience. These interactive options provide incredible ease and insight into use, maintenance and enjoyment of your Coachmen product. Ranging from "How-To" videos, pictures and illustrations of various components, systems and features to fully searchable content and downloadable PDFs for individual component owner's manuals, answers are always just a click away.



**YOUR APEX DEALER**



**24/7 EMERGENCY  
ROADSIDE ASSISTANCE  
WITH VEHICLE PURCHASE\***

<p>TOWING JUMP-STARTS TIRE CHANGES FLUID DELIVERY LOCKOUT SERVICE</p>	<p>WINCH-OUT MOBILE MECHANIC TECHNICAL SUPPORT DEALER LOCATOR SERVICES</p>
---	--

**SAFERIDERV  
MOTOR CLUB**

\*VALID FOR 1 YEAR FROM DATE OF PURCHASE

**GVWR (Gross Vehicle Weight Rating)** - is the maximum permissible weight of the unit when fully loaded. It includes all weights, inclusive of all fluids, cargo, optional equipment and accessories. For safety and product performance do NOT exceed the GVWR.

**GAWR (Gross Axle Weight Rating)** - is the maximum permissible weight, including cargo, fluids, optional equipment and accessories that can be safely supported by a combination of all axles.

**UVW (Unloaded Vehicle Weight)\*** - is the typical weight of the unit as manufactured at the factory. It includes all weight at the unit's axle(s) and tongue or pin and LP Gas. The UVW does not include cargo, fresh potable water, additional optional equipment or dealer installed accessories. \*Estimated average based on standard build optional equipment.

**CCC (Cargo Carrying Capacity)\*\*** - is the amount of weight available for fresh potable water, cargo, additional optional equipment and accessories. CCC is equal to GVWR minus UVW. Available CCC should accommodate fresh potable water (8.3 lbs per gallon). Before filling the fresh water tank, empty the black and grey tanks to provide for more cargo capacity. \*\*Estimated average based on standard build optional equipment.

Each Forest River RV is weighed at the manufacturing facility prior to shipping. A label identifying the unloaded vehicle weight of the actual unit and the cargo carrying capacity is applied to every Forest River RV prior to leaving our facilities. The load capacity of your unit is designated by weight, not by volume, so you cannot necessarily use all available space when loading your unit. All information contained in this brochure is believed to be accurate at the time of publication. However, during the model year, it may be necessary to make revisions and Forest River, Inc., reserves the right to make all such changes without notice, including prices, colors, materials, equipment and specifications as well as the addition of new models and the discontinuance of models shown in this brochure. Therefore, please consult with your Forest River dealer and confirm the existence of any materials, design or specifications that are material to your purchase decision. ©2021 Apex by Coachmen RV, a Division of Forest River, Inc., a Berkshire Hathaway company. All rights reserved. 11/22 CHM 1969



**Learn More**  
Scan this barcode using a QR Reader on your smart phone to learn more about Forest River.

