

SALEM HEMISPHERE

TRAVEL TRAILERS + FIFTH WHEELS

BEGIN YOUR OUTDOOR
ADVENTURES WITH A
TRUSTED BRAND



SALEM HEMISPHERE HYPER-LYTE

TRAVEL TRAILERS



FREE 2019 HYPER-LYTE VIP PACKAGE \$3,915 VALUE

- + Extra Large Max Tint Panoramic Window Package in Main Slide
- + High Rise Faucet with Pull Out Sprayer
- + Recessed Glass Stove Top Cover
- + Stainless Steel Range Hood
- + Stainless Steel Microwave
- + Back up Camera Prep
- + Solar Panel Prep
- + Solid-Step, Aluminum Entry Steps (Main Entry Door)
- + Jensen 32" LED TV with Bluetooth CD/DVD/FM/USB Player and Bar Speakers
- + 10.7 Cu. Ft. 12 Volt "Everchill" Refrigerator
- + Flip down Bike/Storage Rack
- + Friction Door Hinge, Baggage Door Magnets, Slam Latches
- + LED Awning Light
- + Power Tongue Jack with LED Docking Light
- + Denver 9" Pillow Top Mattress



NATURAL LIGHT, SKYLIGHT STANDARD IN ALL KITCHENS

40" TV OPTIONAL ON SELECT MODELS

32" FIREPLACE STANDARD ON SELECT MODELS

OVEN WITH LED LIT KNOBS

LARGE POT AND PAN DRAWER BELOW OVEN (MOST MODELS)

LARGE ENTRYWAYS INTO BATHROOMS AND BEDROOMS

SHAW® RESIDENTIAL LINOLEUM

XL PANORAMIC WINDOW PACKAGE

DECORATIVE VALANCE WITH RESIDENTIAL ROLLER SHADES

TRI-FOLD SOFAS STANDARD (WHERE APPLICABLE)

10.7 CU. FT. RESIDENTIAL 12V REFER

SHOWN IN DOVE DECOR



WIDE STANCE AXLES FOR IMPROVED TOWABILITY



TEXAS SIZE PASS-THRU STORAGE



HUGE CAPACITY 10.7 CU. FT. 12V REFER

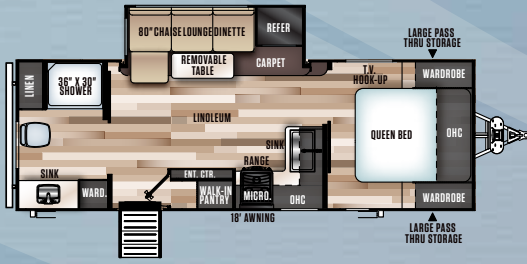

22RBHL

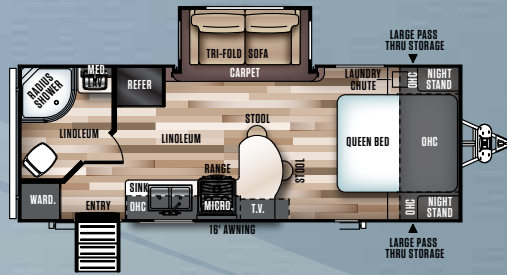

23RBHL



23BHHL

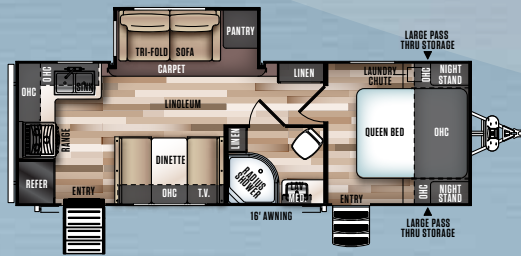

24RKHL

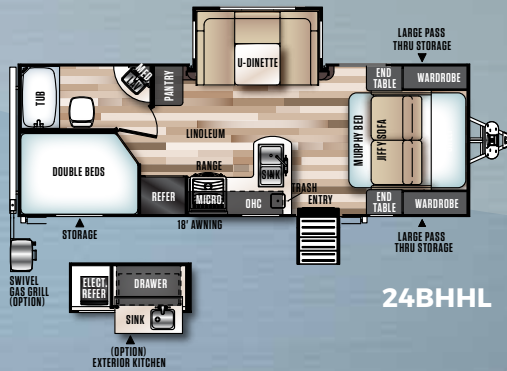

24BHHL



26BHHL

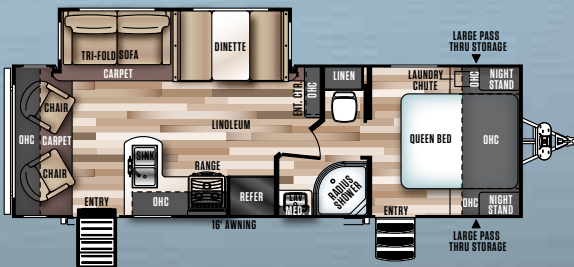

26RLHL



29BHHL

HYPER-LYTE

SPECIFICATIONS

TRAVEL TRAILERS

| MODEL | 22RBHL | 23RBHL | 23BHHL | 24RKHL | 24BHHL | 26BHHL | 26RLHL | 29BHHL |
|------------------------|---------|---------|---------|---------|---------|---------|---------|---------|
| HITCH WEIGHT (lbs) | 570 | 520 | 575 | 565 | 510 | TBD | 625 | 645 |
| AXLE WEIGHT | 4805 | 4210 | 5420 | 4740 | 4570 | TBD | 5065 | 5590 |
| UVW | 5413 | 4768 | 5984 | 5363 | 5118 | TBD | 5728 | 6273 |
| CCC (cargo cap) | 2157 | 2752 | 1542 | 2222 | 2392 | TBD | 1897 | 3172 |
| EXT LENGTH | 27' 0" | 25' 11" | 30' 2" | 28' 7" | 27' 0" | 33' 6" | 30' 1" | 32' 7" |
| EXT HEIGHT | 10' 10" | 10' 10" | 10' 10" | 10' 10" | 10' 10" | 10' 11" | 10' 10" | 10' 11" |
| FRESH WATER CAP (gal)* | 48 | 64 | 48 | 48 | 48 | 48 | 48 | 48 |
| BLACK WATER CAP (gal) | 32 | 32 | 32 | 32 | 32 | 27 | 32 | 27 |
| GREY WATER CAP (gal) | 64 | 32 | 54 | 64 | 32 | 54 | 32 | 54 |
| TIRE SIZE (in) | 15" | 15" | 15" | 15" | 15" | 15" | 15" | 15" |
| AWNING SIZE (ft) | 18' | 16' | 21' | 16' | 18' | 20' | 16' | 16' |

SALEM HEMISPHERE GLX

TRAVEL TRAILERS



2-TONE PAINTED FULL FIBERGLASS FRONT CAP

FREE 2019 GLX VIP PACKAGE \$5,075 VALUE

- + Extra Large Max Tint Panoramic Window Package in Main Slide
- + Stainless Steel Single Bowl Undermount Sink w/ Roll Up Sink Cover
- + Recessed Glass Stove Top Cover
- + Stainless Steel Range Hood
- + Stainless Steel Microwave
- + Back up Camera Prep
- + Solar Panel Prep
- + Solid-Step, Aluminum Entry Steps (Main Entry Door)
- + Jensen Bluetooth CD/DVD/FM/USB Player & Bar Speakers
- + 10.7 Cu. Ft. 12 Volt "Everchill" Refrigerator
- + Denver 9" Pillowtop Mattress
- + Friction Door Hinge, Baggage Door Magnets, Slam Latches,
- + LED Awning Light
- + Power Tongue Jack w/LED Docking Light



SHOWN IN BRADFORD DECOR

XL PANORAMIC WINDOW PACKAGE IN MAIN SLIDE

DECORATIVE VALANCE WITH RESIDENTIAL ROLLER SHADES

U-SHAPED DINETTE ON SELECT BUNK MODELS

TRI-FOLD SOFA STANDARD WHERE APPLICABLE

50" TV ON SELECT TRAVEL TRAILER MODELS

NATURAL LIGHT, SKYLIGHT STANDARD IN ALL KITCHENS

RESIDENTIAL VAULTED CEILINGS



JENSEN® SPEAKERS, BLUETOOTH STEREO AND DVD PLAYER

HIGH RISE FAUCET W/ PULL DOWN SPRAYER

RANGE W/ GLASS STOVE TOP COVER

32" LINEAR CRYSTAL FIREPLACE

LED LIT RESIDENTIAL OVEN

LARGE POT AND PAN DRAWER BELOW OVEN ON MOST MODELS

SHAW RESIDENTIAL LINOLEUM



WARDROBE STORAGE TO ACTUALLY ACCOMMODATE HANGING CLOTHES!





269RL

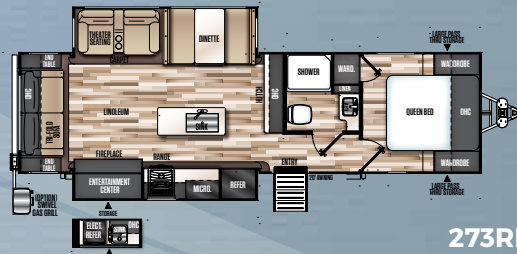

273RL



283RK

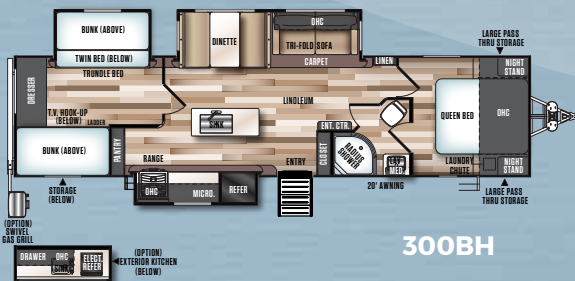

300BH



309BOK



314BUD



322BH



326RL

HEMISPHERE GLX

SPECIFICATIONS

TRAVEL TRAILERS

| MODEL | 269RL | 273RL | 283RK | 300BH | 309BOK | 314BUD | 322BH | 326RL |
|------------------------|--------|--------|--------|--------|---------|--------|--------|---------|
| HITCH WEIGHT (lbs) | 730 | 845 | 700 | 880 | 800 | 960 | 990 | 977 |
| AXLE WEIGHT | 5390 | 6390 | 6040 | 7500 | 6160 | 7335 | 7025 | 7168 |
| UVW | 6179 | 7294 | 6799 | 8439 | 7019 | 8354 | 7986 | 8204 |
| CCC (cargo cap) | 3351 | 2351 | 2701 | 1401 | 2581 | 1566 | 1876 | 1733 |
| EXT LENGTH | 33' 3" | 34' 4" | 35' 0" | 37' 5" | 35' 10" | 39' 0" | 37' 4" | 37' 10" |
| EXT HEIGHT | 11' 1" | 11' 1" | 11' 4" | 11' 2" | 11' 2" | 11' 2" | 11' 2" | 11' 2" |
| FRESH WATER CAP (gal)* | 48 | 48 | 48 | 48 | 48 | 48 | 48 | 48 |
| BLACK WATER CAP (gal) | 30 | 30 | 27 | 32 | 32 | 64 | 64 | 27 |
| GREY WATER CAP (gal) | 60 | 48 | 54 | 96 | 59 | 77 | 64 | 32 |
| TIRE SIZE (in) | 15" | 15" | 15" | 15" | 15" | 15" | 15" | 15" |
| AWNING SIZE (ft) | 20' | 20' | 21' | 20' | 20' | 18' | 20' | 12' |

SALEM HEMISPHERE GLX

FIFTH WHEELS

FREE 2019 GLX VIP PACKAGE \$5,075 VALUE

- + Extra Large Max Tint Panoramic Window Package in Main Slide
- + Stainless Steel Single Bowl Undermount Sink w/ Roll Up Sink Cover
- + Recessed Glass Stove Top Cover
- + Stainless Steel Range Hood
- + Stainless Steel Microwave
- + Back up Camera Prep
- + Solar Panel Prep
- + Solid-Step, Aluminum Entry Steps (Main Entry Door)
- + Jensen Bluetooth CD/DVD/FM/USB Player & Bar Speakers
- + 10.7 Cu. Ft. 12 Volt "Everchill" Refrigerator
- + Denver 9" Pillowtop Mattress
- + Friction Door Hinge, Baggage Door Magnets, Slam Latches,
- + LED Awning Light



SHOWN IN DOVE DECOR



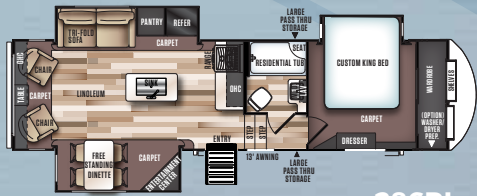

286RL

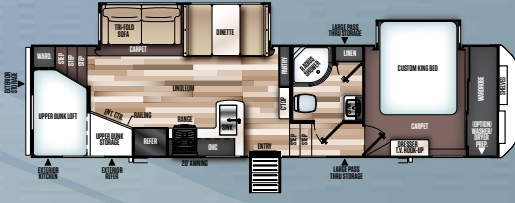

295BH

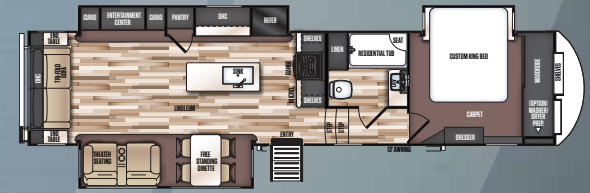

338BAR



356QB

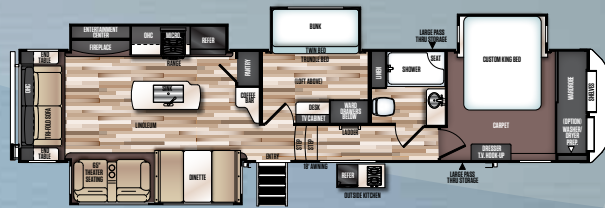

369BL

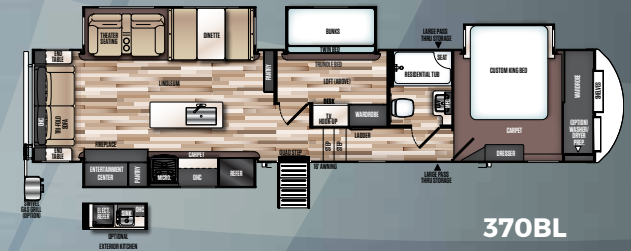

370BL

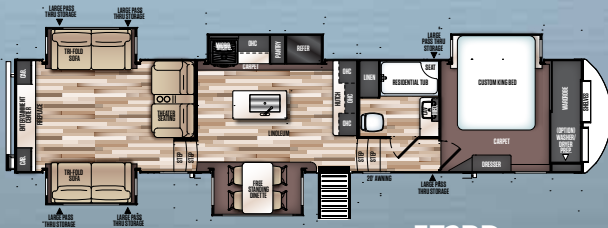

372RD

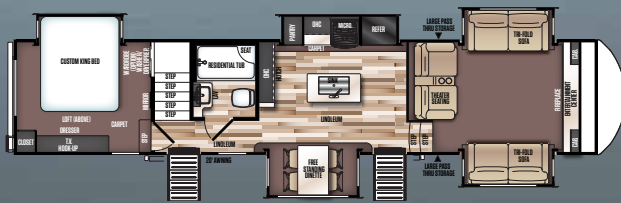

378FL



HEMISPHERE GLX

SPECIFICATIONS

FIFTH WHEELS

| MODEL | 286RL | 295BH | 338BAR | 356QB | 369BL | 370BL | 372RD | 378FL |
|------------------------|--------|--------|--------|--------|--------|--------|--------|--------|
| HITCH WEIGHT (lbs) | 1625 | 1985 | 2135 | 1790 | TBD | 2275 | 2125 | 2140 |
| AXLE WEIGHT | 6815 | 7290 | 8070 | 9400 | TBD | 9190 | 8965 | 9390 |
| UVW | 8499 | 9334 | 10264 | 11249 | TBD | 11524 | 11149 | 11589 |
| CCC (cargo cap) | 2086 | 2851 | 2071 | 2541 | TBD | 2751 | 2976 | 2551 |
| EXT LENGTH | 34' 1" | 36' 0" | 38' 6" | 42' 3" | 43' 1" | 41' 6" | 42' 8" | 43' 5" |
| EXT HEIGHT | 12' 7" | 12' 7" | 13' 2" | 13' 2" | 13' 1" | 13' 1" | 13' 3" | 13' 6" |
| FRESH WATER CAP (gal)* | 48 | 48 | 48 | 48 | 48 | 48 | 48 | 48 |
| BLACK WATER CAP (gal) | 30 | 30 | 30 | 60 | 30 | 30 | 30 | 27 |
| GREY WATER CAP (gal) | 62 | 80 | 62 | 57 | 62 | 80 | 60 | 57 |
| TIRE SIZE (in) | 15" | 16" | 16" | 16" | 16" | 16" | 16" | 16" |
| AWNING SIZE (ft) | 13' | 20' | 13' | 21' | 18' | 16' | 20' | 20' |

SALEM HEMISPHERE

Elite Series

FIFTH WHEELS

Elite (noun): A select part of a group that is superior to the rest in terms of ability, rank, skill set and qualities.

Elite Series by Hemisphere is the answer to a High Profile Luxury Fifth Wheel affordable to America's Working Class. Loaded with features you've asked for and the amazing value you have come to know in the Hemisphere Brand, America's Trusted Brand.



SHOWN IN DOVE DECOR



EDISON STYLE
DINETTE
AND PENDANT
LIGHTS

PANORAMIC
TINTED WINDOWS
THROUGHOUT

DECORATIVE
VALANCE WITH
RESIDENTIAL
ROLLER SHADES

YACHT TRIM
CEILING
BATTENS

KICK 'EM UP
OTTOMAN
WITH
STORAGE

DISTRESSED
DINETTE
TABLETOP

SHAW
RESIDENTIAL
LINOLEUM

POWER
FANTASTIC
FAN

55" LED TV
STANDARD



HUGE
PANTRY W/
MOTION
SENSING
LIGHT

LG 1.7 CU. FT.
STAINLESS
STEEL
MICROWAVE

HI-MACS
SOLID SURFACE
COUNTERTOPS

FURRION
RESIDENTIAL
RANGE WITH
OVEN

FREE 2019 ELITE SERIES VIP PACKAGE \$5,365 VALUE

- + Power Fantastic Fan in Kitchen
- + LG® Hi-Macs Genova Luxurious Kitchen Countertops 
- + Upgraded Bedding Package and Headboard
- + 1.7 Cu. Ft. OTR 30" Stainless Steel Microwave
- + Panoramic Tinted Safety Glass Windows Throughout
- + Stainless Steel Gas Cooktop with Built-in Oven w/ LED Lit Knobs
- + King Wifi Router/Range Extender 
- + Denver 72" x 80" King Pillowtop Mattress 
- + Kick 'em Up Ottoman with Huge Storage in Living Room

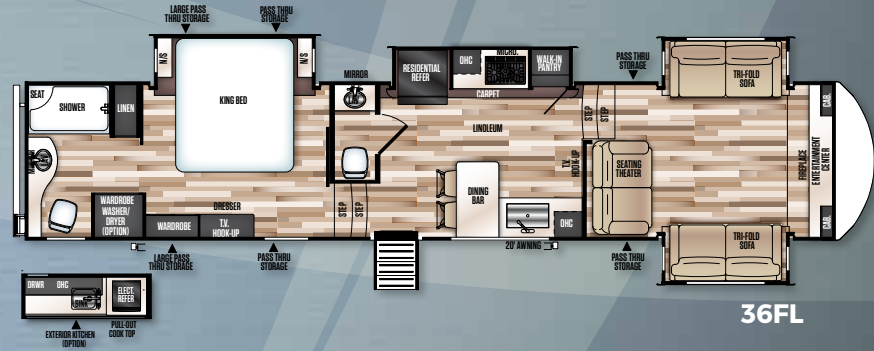
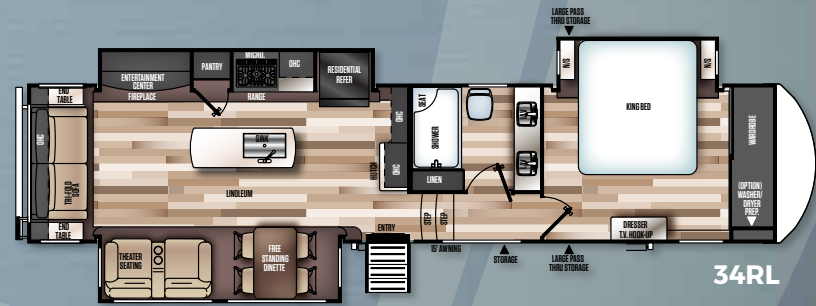

FOR A MORE COMPREHENSIVE LOOK AT OUR FLOORPLANS AND 360° TOURS PLEASE VISIT WWW.FORESTRIVERINC.COM

ELITE SERIES FIFTH WHEELS

SPECIFICATIONS

| MODEL | 34RL | 36FL |
|------------------------|--------|--------|
| HITCH WEIGHT (lbs) | 2005 | TBD |
| AXLE WEIGHT | 9065 | TBD |
| UVW | 11129 | TBD |
| CCC (cargo cap) | 2876 | TBD |
| EXT LENGTH | 39' 4" | TBD |
| EXT HEIGHT | 13' 2" | 13' 4" |
| FRESH WATER CAP (gal)* | 48 | 48 |
| BLACK WATER CAP (gal) | 52 | TBD |
| GREY WATER CAP (gal) | 79 | TBD |
| TIRE SIZE (in) | 16" | 16" |
| AWNING SIZE (ft) | 16' | 20' |



STANDARDS AND OPTIONS

S - STANDARD O - OPTION P - VIP PACKAGE

| CONSTRUCTION AND EQUIPMENT | HL | GLX TT | GLX FW | ELITE | | HL | GLX TT | GLX FW | ELITE |
|---|----|--------|--------|-------|--|-----------|---------------|---------------|--------------|
| Dexter Axles w/15" Radial Tires (16" Select Models) & Aluminum Wheels | S | S | S | S | One Piece Seamless Roof (12 yr. Warranty) | S | S | S | S |
| Full Wrap Around Aerodynamic Front Cap w/ Led Light Strip (TT's & FW) | | S | S | S | Tinted Safety Glass Windows | S | S | S | S |
| 2-Tone Painted Fiberglass Front Cap | | S | S | S | Black Tank Flush | S | S | S | S |
| Wide Track Suspension | S | S | | | Fold Down Bike Rack | P | | | |
| Aluminum-Framed Vacuum-Bonded Construction | S | S | S | S | Spare Tire | S | S | S | S |
| Gel Coated Fiberglass Exterior | S | S | S | S | Outside Shower | S | S | S | S |
| Laminated Sidewalls | S | S | S | S | Enclosed & Heated Under Belly w/ Radiant Heated Tanks | S | S | S | S |
| Laminated Aluminum Framed Floor | S | S | S | S | Heated Holding Tanks (Heat Pads) | | | | S |
| 6'5" Full Walk-In 5th Wheel Slide-Outs (N/A Bed Slides) | | | S | S | 15K A/C | O | S | S | S |
| One Level, Full Stand-Up Height 5th Wheel Upper Decks | | | S | S | 50 AMP Service w/ Wire Brace for 2nd A/C & Washer/Dryer Prep | | | S | S |
| Solid Step Main Entry Steps (Main Entry Door) | P | P | P | P | Ceiling Fan | | | S | S |
| 30" Smooth Fiberglass Radius Main Entry Door w/ Friction Hinge | S | S | S | S | 10 Gal. Gas/Elec DSI Water Heater | | | S | S |
| Swing Arm Entry Assist Handle | S | S | S | S | KITCHEN | HL | GLX TT | GLX FW | ELITE |
| Extra Large Full Pass-Thru Storage w/ Slam latches (per floorplan) | S | S | S | S | Stainless Steel Everchill 12V Residential Refrigerator | P | P | P | |
| One Touch Electric Awning w/ Adjustable Legs (1 year warranty) | S | S | S | S | One Piece Solid Surface Beveled Countertop | S | S | S | S |
| Marine Grade Exterior Speakers w/ Blue LED Light | S | S | S | S | Large Deep Bowl Residential Sink | S | S | S | S |
| Exterior TV Bracket w/ Cable and Power Outlet | S | S | S | S | Decorative Midnight Metal Subway Style Backsplash | S | S | S | S |
| Upgraded ABS Fender Skirts | S | S | S | S | Stainless Steel Roll up Sink Cover | S | S | S | |
| Interior Grab Handle at Entry Door | S | S | S | S | Microwave w/ Carousel (1 Year Warranty) | S | S | S | S |
| Powder Coated I-Beam Frame | S | S | S | S | High Arc Pull down Sprayer Kitchen Faucet | S | S | S | S |
| Cambered Chassis | S | S | S | S | Vented Range Hood w/ Light | S | S | S | |
| Water Heater By-Pass | S | S | S | S | Shaw Guardian Hickory Way Linoleum | S | S | S | S |
| 5th Wheel Docking Station | | | S | S | Solid Wood Drawer Fronts w/ Full Extension Ball Bearing Guides | S | S | S | S |
| Norco Cable Slide Out Systems | S | | | | Solid Wood Framed Shaker Style Cabinet Doors w/ Hidden Hinges | S | S | S | S |
| Rack & Pinion Power Flush Floor Slide-Out Systems | | S | S | S | Larger Overhead Cabinets (Per Floorplan) | S | S | S | S |
| 16 Gal. per Hour G/E Quick Recovery DSI Water Heater (2 yr. Warranty) | S | S | S | S | Wall-Mounted Systems Monitor Panel | S | S | S | S |
| Stabilizer Jacks | S | S | S | S | Brushed Nickel Hardware | S | S | S | S |
| Backer For Rear Ladder | | S | S | S | Pots and Pans Drawer Below Oven (Per Floorplan) | S | S | S | S |
| Full Walk-on Roof | S | S | S | S | Skylight in Kitchen (Most Floorplans) | S | S | S | S |
| Power Front Landing Gear (5th Wheels) | | | S | S | 22 Cu. Ft. SS French Door Refer w/ Ice Maker | | | | S |
| | | | | | Solid Surface Sink Covers | | | | S |
| | | | | | Large Residential Pantry (Per Floorplan) | S | S | S | S |

LIVING ROOM

| | HL | GLX TT | GLX FW | ELITE |
|---|----|--------|--------|-------|
| Shaw® Residential Stain Resistant Carpet | S | S | S | S |
| Residential Roller Shades with Decorative Valance | S | S | S | S |
| Deluxe Dinette Tabletop | S | S | S | S |
| Solid Wood Drawer Fronts | S | S | S | S |
| Extra Large Opening Windows in Slideout | S | S | S | S |
| Winegard TV Antenna | S | S | S | S |
| Cable TV and Satellite Prep | S | S | S | S |
| 30K or 35K BTU Furnace (2 Yr. Warranty) w/ Digital Thermostat | S | S | S | S |
| Tri-Fold Hide-a-Bed Sofa w/ Storage | S | S | S | S |
| Push Back Recliners (Per Floorplan) | S | S | S | |
| Large U-Shaped Dinette w/ 62" Sofa (Per Floorplan) | S | S | S | S |
| LED Lit Theatre Seating w/ Built-In Recliners (Per Floorplan) | S | S | S | S |
| Large LED HDTV w/ Jensen CD/DVD Bluetooth Stereo w/ 2 Speaker | S | S | S | S |
| Multiple 110 Outlets & Dual USB Ports Throughout | S | S | S | S |
| Electric Fireplace (Per Floorplan) | S | S | S | S |

BEDROOM

| | HL | GLX TT | GLX FW | ELITE |
|--|----|--------|--------|-------|
| Strut Lifted Storage Area Under Bed | S | S | S | S |
| Load-N-Go Collapsible Storage Bins Under Bed (Per Floorplan) | S | S | | |
| Oversized Bunks (Per Floorplan) | S | S | S | S |
| Solid Bedroom Privacy Doors | S | S | S | S |
| Tall Mirrored Wardrobes w/ 4 overhead Cabinets (Travel Trailers) | S | S | | |
| 110 Outlets and Dual USB Ports on Both Sides of Bed | S | S | S | S |
| 72" x 80" Denver 9" Pillowtop Mattress | | | | P |
| 66" x 80" Denver 9" Pillowtop Mattress (Bedslides) | | | P | |
| 60" x 74" Denver 9" Pillowtop Mattress (Non-Bedslides) | P | P | | |
| Tall Window on Awning Slide | | | S | S |
| Wall Mounted TV Bracket Facing Bed | | | S | S |
| Tall Window on Awning Slide | | | S | S |
| Tall 3 Drawer Dresser (5th Wheel Bedrooms) | | | S | S |
| Night Shelf On End Of Bed Slide Out | | | S | S |

BATHROOM

| | HL | GLX TT | GLX FW | ELITE |
|---|----|--------|--------|-------|
| 12-Volt Power Bath Roof Exhaust Fan | S | S | S | S |
| Huge Residential Shower (Most Models) | S | S | S | S |
| Dometic Foot Flush Toilet | S | S | | |
| Dometic Porcelain Foot Flush Toilet | | | S | S |
| Vinyl Tub Surround | S | S | S | S |
| 30" x 50" Walk-In Shower w/ Sliding Glass Door (5th Wheels) | | | S | S |
| Stainless Steel Lavatory Sinks | | | S | S |

SECURITY AND SAFETY

| | HL | GLX TT | GLX FW | ELITE |
|--|----|--------|--------|-------|
| LP Leak Detector | S | S | S | S |
| Smoke Detector | S | S | S | S |
| Carbon Monoxide Detector | S | S | S | S |
| Fire Extinguisher | S | S | S | S |
| LED Hitch Light | S | S | S | S |
| Battery Disconnect | S | S | S | S |
| Welded Heavy Duty Safety Chains (Travel Trailers) | S | S | | |
| Electric Brakes (All Wheels) | S | S | S | S |
| GFI Receptacles | S | S | S | S |
| ANSI 119.2 | S | S | S | S |
| LED Marker, Brake & Tail Lights | S | S | S | S |
| Certified to Meet National Highway Traffic Safety Administration Specs | S | S | S | S |

OPTIONS

| | HL | GLX TT | GLX FW | ELITE |
|---|----|--------|--------|-------|
| Free-Standing Dinette w/ 4 Chairs | O | O | O | S |
| 3/4 White Gel Coat Fiberglass Front Cap (Hyper-Lytes) | O | | | |
| Extreme Weather Package (Calc. @ R38 Floor, Front Cap and Roof) | | O | O | S |
| Second 15K A/C in Bedroom | | O | O | O |
| Washer/Dryer Prep w/ 50 Amp Service & Wire/Brace for Second A/C | | | S | S |
| Exterior Kitchen/Bar | O | O | O | O |
| 4 Point & 6 Point Electric Auto Leveling (5th Wheels) | | | O | O |
| Extra Large Double Door RV Refrigerator | O | O | O | |
| 50 AMP Service | | O | | |
| 12 cu. Ft. 4 Door G/E Refer | | | | O |
| 14.7 110V French Door Refer | | | O | |

FOREST RIVER HEMISPHERE



GVWR (Gross Vehicle Weight Rating) - is the maximum permissible weight of the unit when fully loaded. It includes all weights, inclusive of all fluids, cargo, optional equipment and accessories. For safety and product performance do NOT exceed the GVWR.

GAWR (Gross Axle Weight Rating) - is the maximum permissible weight, including cargo, fluids, optional equipment and accessories that can be safely supported by a combination of all axles.

UVW (Unloaded Vehicle Weight)* - is the typical weight of the unit as manufactured at the factory. It includes all weight at the unit's axle(s) and tongue or pin and LP Gas. The UVW does not include cargo, fresh potable water, additional optional equipment or dealer installed accessories.

*Estimated Average based on standard build optional equipment.

CCC (Cargo Carrying Capacity)** - is the amount of weight available for fresh potable water, cargo, additional optional equipment and accessories. CCC is equal to GVWR minus UVW. Available CCC should accommodate fresh potable water (8.3 lbs per gallon). Before filling the fresh water tank, empty the black and gray tanks to provide for more cargo capacity.

** Estimated average based on standard build optional equipment

Each Forest River RV is weighed at the manufacturing facility prior to shipping. A label identifying the unloaded vehicle weight of the actual unit and the cargo carrying capacity is applied to every Forest River RV prior to leaving our facilities.

The load capacity of your unit is designated by weight, not by volume, so you cannot necessarily use all available space when loading your unit.

All information contained in this brochure is believed to be accurate at the time of publication. However, during the model year, it may be necessary to make revisions and Forest River, Inc., reserves the right to make all such changes without notice, including prices, colors, materials, equipment and specifications as well as the addition of new models and the discontinuance of models shown in this brochure. Therefore, please consult with your Forest River dealer and confirm the existence of any materials, design or specifications that are material to your purchase

**24/7 EMERGENCY
ROADSIDE ASSISTANCE
WITH VEHICLE PURCHASE***

| | |
|---|--|
| <p>TOWING JUMP-STARTS TIRE CHANGES FLUID DELIVERY LOCKOUT SERVICE</p> | <p>WINCH-OUT MOBILE MECHANIC TECHNICAL SUPPORT DEALER LOCATOR SERVICES</p> |
|---|--|



*VALID FOR 1 YEAR FROM DATE OF PURCHASE



www.ForestRiverBuyLocal.com



PRE-DELIVERY INSPECTION FACILITY

20,000 square feet of quality assurance. The bare essentials for a premium product. This state-of-the-art facility gives immediate daily feedback to production for quality assurance in every unit built.

FREE MEMBERSHIP
to Forest River Owners' Group

www.forestriverfrog.com



Learn More

Scan this barcode using a QR Reader on your smart phone to learn more about Forest River.



A Berkshire Hathaway company.

Forest River, Inc.
55470 C.R. 1, Elkhart, IN 46515
(574) 389-4600
www.forestriverinc.com/Hemisphere
www.forestriveraccessories.com

YOUR LOCAL HEMISPHERE DEALER