

WILDWOOD SPORT

Welcome to the new Wildwood "SPORT" Toy Hauler, America's most versatile camper. These models were not only engineered as serious Toy Haulers, they are also carefully designed for the family campers who want to take some extra FUN on their outdoor adventures. Designed with a lot of "ATTITUDE" and built as "TUFF AS NAILS", take a look at why America is making Wildwood it's #1 choice in today's Sport Haulers market.

**XL LITE WIDE BODY GEARED
FOR TODAY'S 1/2 TON TRUCKS
AND SUVs (23FLSRV-SHOWN)**



**XL FIFTH WHEELS, 12' BOX, WIDE BODY,
TRIPLE AXLES, WITH GELCOAT FIBERGLASS
EXTERIOR (376SRVBS-SHOWN)**



WILDWOOD XL LITE TOY HAULERS

XL LITE STANDARDS

- Wide body (102")
- Fantastic™ fan in bathroom
- Swing arm entry assist handle
- Black frame tinted windows
- 13.5k air conditioning
- 6 gal. gas/electric water heater
- Generator prep (FW)
- One piece nickel tread cargo area
- Diamond plate rolled side metal
- Fluorescent lighting
- Dual electric queen beds in cargo area
- 26" LCD/HD flatscreen TV
- AM/FM stereo with CD/DVD & MP3
- E-Track tie-down system

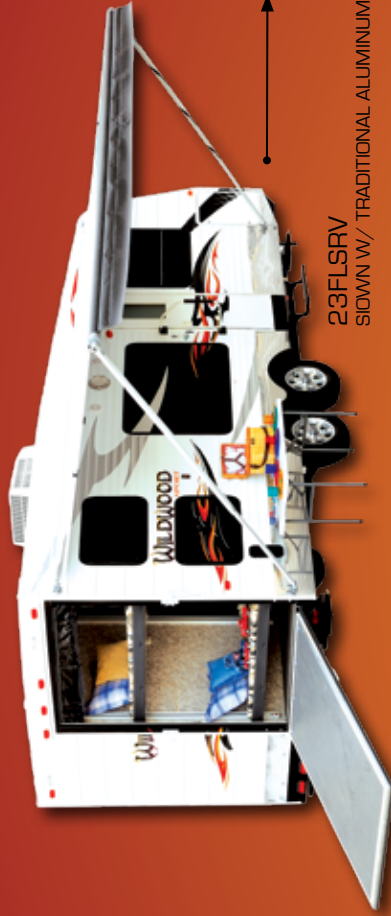

23FLSRV
SLOWN W/ TRADITIONAL ALUMINUM EXTERIOR



XL LITE FLOORPLANS



T23FLSRV

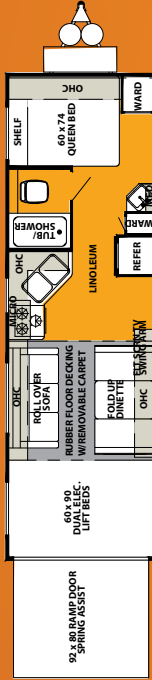

T27FBSRV

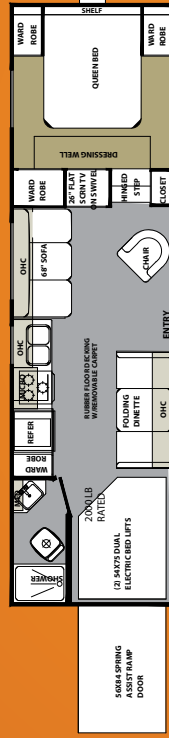

F266FLSRV

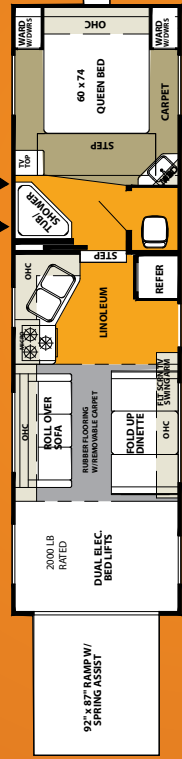

F286FBSRV

XL LITE SPECS

	T23FLSRV	T27FBSRV	F266FLSRV	F286FBSRV
Hitch Weight (lb)	655	845	1380	TBA
Axle Weight	5365	5894	6385	TBA
Dry Ship Weight	6220	6739	7765	TBA
GVMR	10815	11005	11540	TBA
CCC (Cargo Capacity)	3353	3345	3316	TBA
Exc Length	27'10"	32'0"	30'1"	TBA
Exc Height	11'1"	11'1"	12'0"	12'0"
Int Height	80"	80"	84"	84"
Fresh Water Cap (gal)	80	80	80	80
Black Water Cap (gal)	32	32	32	32
Grey Water Cap (gal)	32	62	62	62
Tire Size (in)	15"	15"	15"	15"
Awning Size (ft)	20'	20'	20'	20'

* Add Approximately 350 Lbs. for Fiberglass Exterior

XL LITE OPTIONS

- 15K BTU A/C IPO 13.5
- Deluxe gel-coat fiberglass exterior
- 4.0 kw Onan gas generator
- Thermostatically controlled heated tanks
- Night shades
- Carefree add-a-wall iPod docking station
- Exterior speakers
- Front electric jacks
- Optional fuel station
- Washdown kit w/ quick disconnect



XL LITE 23FLSRV SHOWN WITH ONYX INTERIOR



XL LITE 23FLSRV-ONYX INTERIOR

WILDWOOD XL FIFTH WHEELS

XL STANDARDS

- Deluxe gel-coat fiberglass exterior
- Wide body (102")
- 12' box in cargo area
- 26" LCD TV
- AM/FM CD stereo w/ DVD player
- 15" aluminum rims
- 50 amp electrical service
- Triple axle
- Water filter system
- (10,000 gal.)
- Fantastic fan in bathroom
- Swing arm entry assist handle
- Slate linoleum
- Black frame tinted windows
- 13.5k ducted air
- Shower surround w/ glass door
- 6 gal. gas/ electric water heater
- Generator box w/ wire
- Optional fuel station (gasoline)
- E-Track tie-down bars
- Dove tail cargo area
- Vapor barrier wall
- One piece diamond tuff deck cargo area
- Diamond plate tolled side metal (ext.)
- Diamond tuff deck ramp threshold
- Minimum 84" ceiling heights

XL OPTIONS

- 10 gallon G/E water heater
- 15K BTU A/C IPO 13.5
- 5.5 kw onan gas generator
- Dual electric queen beds in cargo area
- Free standing table and chairs
- Thermostatically controlled heated tanks
- Day/night shades
- Carefree add-a-wall
- Double hide-a-bed
- iPod docking station
- Exterior speakers

XL376SRVBS



DIAMOND TUFF DECK
SKID RESISTANT FLOOR (STD.)

XL FLOORPLANS

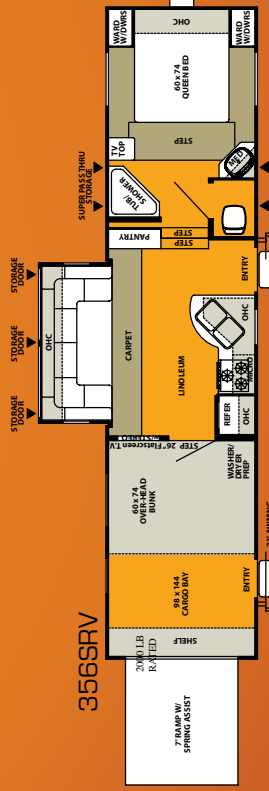

356SRV

XL SPECS

	356SRV	376SRV	376SRVBS
Hitch Weight (lb)	2400	2550	2640
Axle Weight	8995	9590	10815
Dry Ship Weight	11395	12140	13455
GWR	17000	17790	17880
CCC (Cargo Capacity)	4662	5650	4425
Ext. Length	36'5"	38'8"	41'8"
Ext. Height	12'2"	12'2"	12'2"
Int. Height	84"	84"	84"
Fresh Water Cap (gal)	84	84	84
Black Water Cap (gal)	32	32	32
Grey Water Cap (gal)	64	64	64
Tire Size (in)	15"	15"	15"
Awning Size (ft)	21'	21'	21'

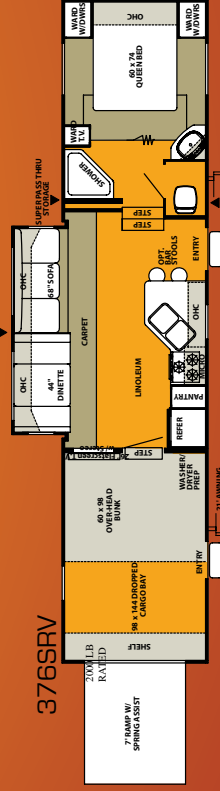

376SRV

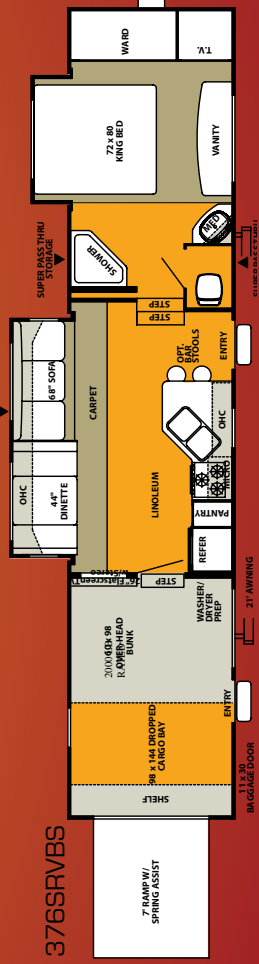

376SRVBS



