



Highland RIDGE RV

Mesa Ridge



Serial #: 58TCH0BV9N3F23066
Model: 395BHS MESA RIDGE FW

Model Year: 2022 Dealer Name: RV STATION, LTD
11020 US HIGHWAY 69 NORTH
TYLER, TX 75706
USA

Standard Equipment

Optional Equipment

THE FOLLOWING ITEMS ARE STANDARD ON THIS MODEL
AT NO EXTRA CHARGE

OPTIONAL EQUIPMENT INSTALLED ON THIS VEHICLE
BY MANUFACTURER

- EXTERIOR**
- 100" wide body frame
 - 2" receiver hitch
 - 320 lb LP bottles
 - 50 amp service
 - ACCU SLIDE™ slide system (42" deep 4-corner compression)
 - Battery disconnect switch
 - Brass hanger bushings with wet bolts
 - Equi-Flex® axle suspension
 - Exterior grill hook-up quick connect port
 - Frameless windows
 - Laminated block foam floor
 - LevelLoc™ 4 pt 6 point automatic leveling with JT's Strong Arms®
 - Marine grade exterior speakers (2)
 - PVC roofing membrane (limited lifetime warranty)
 - Rear roof access ladder
 - Self-adjusting electric brakes
 - Spare tire
 - TuffShell™ - vacuum bonded laminated construction, reinforced with heavy-duty fiberglass and welded aluminum frames

- EXECUTIVE PACKAGE**
- 13,500 BTU A/C with quiet residential return air - bedroom
 - 15,000 BTU A/C with quiet residential return air - main living
 - 76" X 28" entrance door with euro latch and swing shot screen door
 - AM/FM/HD/USB/ALX Bluetooth® sound bar stereo with outdoor zoned speakers
 - Cutting board and sink strainer
 - Digital TV antenna
 - Interior convenience center light
 - Keyed Alike® entry and baggage doors
 - LED HDTV
 - Motion sensor lighting in bedroom and hallway
 - Painted fiberglass front cap with LED lighting
 - Power awning with LED lighting
 - Quick recovery gas/electric water heater
 - Quick release fresh water drain
 - Residential high-rise faucet with pull-down sprayer
 - Single basin stainless steel under-mount kitchen sink
 - Solar prep
 - Solid swing-down entry steps
 - Solid surface kitchen countertops
 - Stainless steel appliances
 - TravelINK™ - Smart RV system that allows for Bluetooth® control of awnings, lighting, slides, heating, cooling, auto-levelers and more
 - USB/12V charging port

- INTERIOR**
- 75 lb. ball bearing drawer guides
 - 60" X 80" residential size queen bed
 - Cable and satellite prep
 - Flush floor slides with residential vinyl flooring
 - Glass shower door
 - Hardwood ceiling soffit
 - Hardwood sidecut fascia
 - Hardwood valances
 - Large freestanding oven and 4-burner range
 - LED interior lighting
 - Observation camera prep
 - One piece fiberglass shower
 - Raised panel hardwood cabinet doors
 - Residential convection microwave
 - Roller day and night shades
 - Table and chairs
 - Theater seating with heat and massage
 - USB ports in master bedroom
 - Wall controlled power vent (kitchen/living room area)
 - Washer/dryer prep
 - Wi-Fi ready

- FOUR SEASON PACKAGE**
- Double insulated baggage doors
 - Ducted heat to underbelly with cold air return
 - Enclosed cable operated gate valves
 - Enclosed exterior docking station with black tank flush
 - Heated and enclosed underbelly
 - High performance furnace
 - R-38 reflective foil insulation in ceiling and underbelly
 - R-9 block foam insulation in sidewalls

- Base price 115,118.00
- USA Standards n/c
- Executive Package 6,000.00
- Four Seasons Protection Package 750.00
- 21 Cu. Ft. Refrigerator 135.00
- No Generator Prep 2,393.00
- No Bedroom TV n/c
- Windows Standard n/c
- Power Fan Vent Wall n/c
- Control (Bathroom) 375.00
- BBQ Grill 203.00
- No Pin Box n/c
- U-Lounge Sofa n/c
- King Bed 525.00

UNIT TOTAL 125,499.00

DEALER INSTALLED OPTIONS:

Manufacturer's Suggested Retail Price \$125,499.00

TOTAL AMOUNT DOES NOT INCLUDE STATE AND LOCAL TAXES OR LICENSE FEES. THE PRICE SHOWN ABOVE MAY OR MAY NOT BE REPRESENTATIVE OF THE ACTUAL SELLING PRICE OF SIMILAR RECREATIONAL VEHICLES IN YOUR AREA.

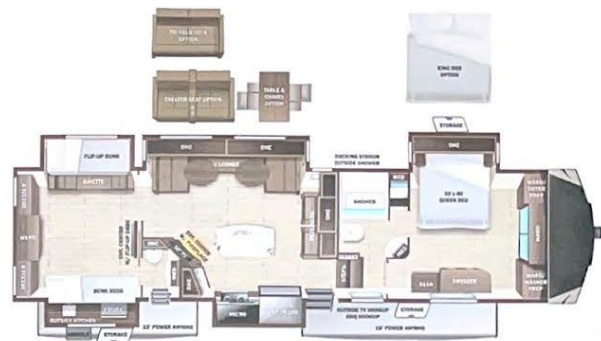

UVW
13614 lbs

Sleeps

Length
43' 7"

DIMENSIONS

Exterior height: 156.00"
Exterior width: 100.00"

WEIGHTS

GVWR: 16250
GAWR (front): 7000
GAWR (rear): 7000
Approx. Gross Cargo Carrying Capacity (GCCC): 2636

TIRES

Tire size (front): ST235/85R16F
Tire size (mid):
Tire size (rear): ST235/85R16F

CAPACITIES

Fresh water tank (gals.): 75.00
Gray water tank (gals.): 80.00
Black water/toilet tank (gals.): 80.00
Propane (lbs.): 60
Water heater (gals.): 14
Water heater (gals.): 10.00

SEATING & SLEEPING

Queen Bed: 60 X 80

Some dimensions may be rounded and may vary from the actual dimensions

***Weights may be estimated calculations and may vary from the actual weight

- refer to the vehicle weight labels for actual weights***

Floorplans, features and specifications are subject to change without notice.

