

PALOMINO

SINCE 1968

PUMA 32BHFS FLOORPLAN

This bunk house travel trailer has four slide outs. Three on the same side and provide plenty of space for entertaining and all of your family/guests. The front bedroom with a slideout contains a queen bed, a very large closet, and washer/dryer prep. The whole layout of this camper contains no shortness of sleeping arrangements due to the bunk house in the rear as well. This bunk house will grant you three bunks and a fold down sofa for everyone to enjoy their stay comfortably.

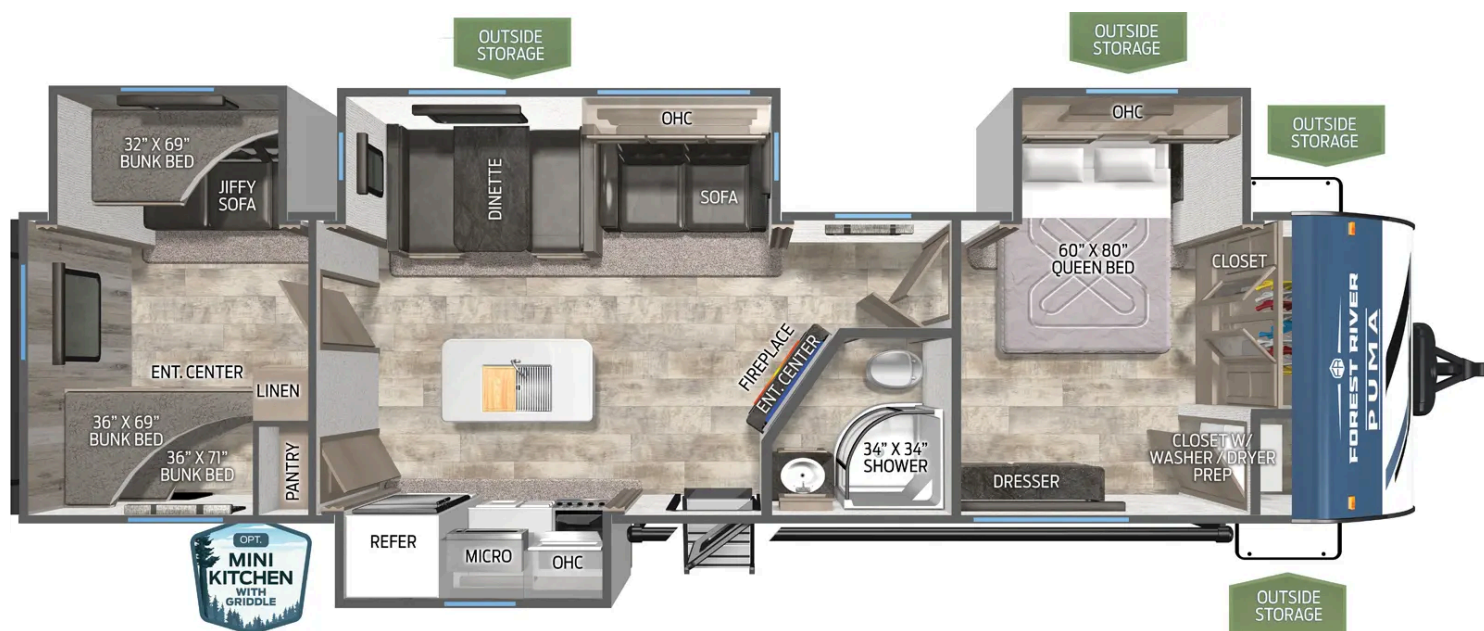

Hitch Weight	1,175 lb.	GVWR	11,308 lb.
UVW	9,608 lb.	CCC	1,700 lb.
Exterior Length	38' 9"	Exterior Height	11' 1"
Exterior Width	96"	Fresh Water	43 gal.
Gray Water	70 gal.	Black Water	35 gal.
Awning Size	21'		

SPECIFICATIONS DEFINITIONS

GVWR (Gross Vehicle Weight Rating) – is the maximum permissible weight of the unit when fully loaded. It includes all weights, inclusive of all fluids, cargo, optional equipment and accessories. For safety and product performance do NOT exceed the GVWR.

GCWR (Gross Combined Weight Rating) – is the maximum permissible loaded weight of your motor home and any towed trailer or towed vehicle. Actual GCWR of this vehicle may be limited by the sum of the GVWR and the installed hitch receiver maximum capacity rating; see hitch rating label for detail.

GAWR (Gross Axle Weight Rating) – is the maximum permissible weight, including cargo, fluids, optional equipment and accessories that can be safely supported by a combination of all axles.

UVW (Unloaded Vehicle Weight)* – is the typical weight of the unit as manufactured at the factory. It includes all weight at the unit's axle(s) and tongue or pin and LP Gas. The UVW does not include cargo, fresh potable water, additional optional equipment or dealer installed accessories.

*Estimated Average based on standard build optional equipment.

CCC (Cargo Carrying Capacity) ** – is the amount of weight available for fresh potable water, cargo, additional optional equipment and accessories. CCC is equal to GVWR minus UVW. Available CCC should accommodate fresh potable water (8.3 lbs per gallon). Before filling the fresh water tank, empty the black and gray tanks to provide for more cargo capacity.

**Estimated Average based on standard build optional equipment.

Each Forest River RV is weighed at the manufacturing facility prior to shipping. A label identifying the unloaded vehicle weight of the actual unit and the cargo carrying capacity is applied to every Forest River RV prior to leaving our facilities.

The load capacity of your unit is designated by weight, not by volume, so you cannot necessarily use all available space when loading your unit.

Actual towing capacity is dependent upon your particular loading and towing circumstances, which includes the GVWR, GAWR and GCWR as well as adequate trailer brakes. Please refer to the Operator's Manual of your vehicle for further towing information.

Note: Specifications are subject to change without notice.

VALUE SHOPPER PACKAGE (REQUIRED)

- 13,500 BTU Ducted A/C
- ABS Tub Surround
- AM/FM/Bluetooth Stereo
- Bedroom TV Hook-up
- Bedspread & Shams
- Congoleum®; Linoleum w/ 3-Year Cold Crack Warranty
- Electric Awning w/LED Light Strip
- Glass Range Cover
- Jack Knife Sofa w/Pull-Down Drink Tray & Storage Underneath
- LED Lighting
- Roof & Side Mount Solar Prep
- TV Antenna w/Booster & Cable Hook-up
- Undermount Sink w/Cover
- WiFi Prep

ADVANTAGE PACKAGE (REQUIRED)

- 1.3 cu. ft. Stainless Steel Microwave
- 21" Stainless Steel Oven & Range Hood
- 11 cu. ft. (12V) Black Glass Faced Refrigerator Doors are Dual Swing & Scratch Resistant
- 6 Gallon Gas/Electric Water Heater
- (2) Outside Speakers
- Bath Skylight
- Enclosed Darco Wrapped Underbelly
- Folding Grab Handle
- Night Roller Shades
- Outside Shower
- Spare Tire
- Upgrade Faucet w/Pull Down Sprayer

LIMITED EDITION PACKAGE (REQUIRED)

- 15,000 BTU Ducted A/C IPO 13,500 BTU
- 5,100 BTU Electric Fireplace
- 50 Amp Service, Second A/C prep (Includes bedroom roof vent)
- Aluminum Solid Triple Step
- Black Tank Flush
- Roof Ladder