



BY: DISCOVER CANADA RV

**2010  
SPECIAL  
PREVIEW**

**LONG WEEKEND**

**WILD BEAR**

**EXPEDITION**

**GRAND TOURING**



Featherlite towability from the Canadian Rockies to the Atlantic Shores



TLX-160BH



TLX-170T

**6 side laminated**  
**Towable by small SUV or mini-van**



TLX-180T



TLX-190T

TLX-189QB



- Black ring tinted safety glass windows std.
- Equi-flex option
- Price, weight and appeal

Travel Trailers	TLX-160BH	TLX-170T	TLX-180T	TLX-190T	TLX-189QB	TLX-185BH TAILGATER
Length	17'6"	18'	19'2"	21'2"	19'2"	21'7"
Width (w/o Awning)	87"	87"	87"	87"	87"	96"
Height (lbs)	170	197	318	259	318	403
Axle Weight (lbs)	2124	1992	2042	2682	2042	2524
GVWR	3670	3697	3818	5859	3818	6003
Total Dry Weight (lbs)	2294	2189	2360	2941	2360	2927
Load Capacity	1376	1508	1458	2918	1458	3076
Tire Size	205/75/148	205/75/148	205/75/148	205/75/148	205/75/148	205/75/148
Fresh Water Tank Cap.	30	30	30	30	30	30
Grey Water Cap.	30	30	30	30	30	30
Black Water Cap.	30	30	30	30	30	30
Unit Height with A/C	9'8"	9'8"	9'8"	9'8"	9'8"	9'8"

### TAILGATER MODEL



TLX-185BH





TLX-210QB



TLX-230BH

Travel Trailers	TLX-210QB	TLX-230BH
Length	22' 10"	24' 10"
Width (w/o Awning)	87"	87"
Height (lbs)	281	281
Axle Weight (lbs)	2566	2566
GVWR	5881	5881
Total Dry Weight (lbs)	2847	2847
Load Capacity	3034	3034
Tire Size	205/75/14B	205/75/14B
Fresh Water Tank Cap.	30	30
Grey Water Cap.	30	30
Black Water Cap.	30	30
Unit Height with A/C	9'8"	9'8"

- All floor plans dry weight under 3,200 lbs.
- 3 expandable floor plans
- 16 to 23 ft., 7.5' wide
- Tailgater floor plan
- 6" structural I-beam chassis frame

### Standards Structure:

- 6" Steel I-beam frame for rough Canadian Roads
- Leaf spring axle(s) (single 18' & below)
- Laminated floor w/aluminum frame
- Laminated sidewall w/aluminum framing
- Laminated front wall w/aluminum framing
- Laminated rear wall
- Front & rear expandable bunk ends (TLX-180T)
- Rear stab jacks
- (2) 20# LP tanks
- Porch/security light (#2)

### Interior:

- Night shades (mini-blind at kitchen window)
- 20 Mil. vinyl flooring
- Won't crack in Canadian cold weather
- Laminate counter tops w/edge

### Appliances:

- 2-Burner cook top only (no oven available)
- 6 Gal. water heater
- Front discharge furnace
- Single door refrigerator
- Range hood w/fan
- 55 Amp converter
- CO2/Smoke/LPG detectors

### Options :

- 2-Door refrigerator (available on TLX-189QB, TLX-190T, TLX-210QB, TLX230BH, TLX-185BH)
- AM/FM/CD player w/2 exterior speakers
- Awning
- Front expandable queen bed (TLX-170T only)
- Front stab jacks (std. on expandable)
- Microwave
- Monitor panel
- Outside shower
- Safety glass windows
- Spare tire
- Stereo prep
- TV antenna
- Equa-Flex™ suspension
- A/C 13,500 BTU (non-ducted)

- RVQ grill-freestanding
- 15" LCD/DVD T V
- DSI water heater
- Electric tongue jack

### General Warranty Information\*

Rubber Roof.....	12 Years
Fiberglass Skin.....	2 Years
Powder Coated Chassis...1 Year	
Structure.....	2 Years
Norcold Appliances.....	3 Years
Atwood Appliances.....	2 Years
General Camper Coverage..	1 Year

\* Refer to specific written warranty statement



www.discovercanadarv.com

the Canadian way, eh!

TS17E



TS18E



TS21E

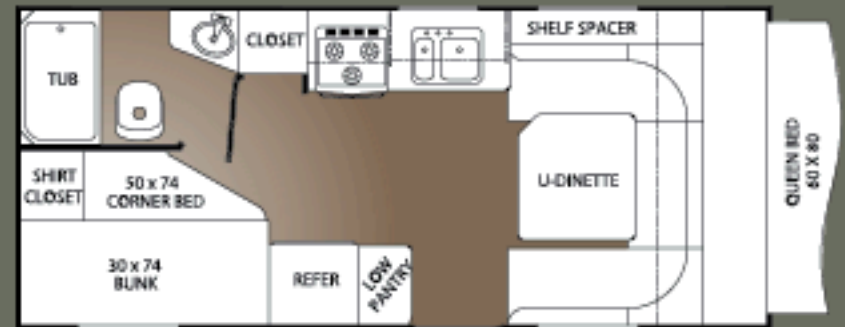

TS19E



TS23E



**#1**  
**volume models**  
**All floor plans**  
**under**  
**4,300 lbs.**

- 3 new expandable floor plans
- 17 to 30 ft.
- 6 side laminated

Travel Trailers	TS17E	TS18E	TS19E	TS21E	TS23E
Length	21'10"	TBD	21'10"	22'5"	TBD
Width (w/o Awning)	96"	TBD	96"	96"	TBD
Height (w/AC)	9'9"	TBD	9'9"	9'9"	TBD
Load Cap.	2888	TBD	2888	3028	TBD
*Hitch Dry Wt. (Appr.)	381	TBD	381	393	TBD
*Axle Dry Wt. (Appr.)	2712	TBD	2712	2572	TBD
*Total Dry Wt.	3093	TBD	3093	2965	TBD
GVWR	5981	TBD	5981	5993	TBD
Fresh Water Tank Cap.	30	TBD	30	30	TBD
Grey Water Cap.	30	TBD	30	30	TBD
Black Water Cap.	30	TBD	30	30	TBD
Tire Size	ST05/75/R14	ST05/75/R14	ST05/75/R14	ST05/75/R14	ST05/75/R14



### TS19FS



**New Graphics & Interior Package**  
**New 42" x 22" dinette windows**

Travel Trailers	TS19FS	TS20RD
Length	TBD	22'11"
Width (w/o Awning)	TBD	96"
Height (w/AC)	TBD	9'9"
Load Cap.	TBD	TBD
*Hitch Dry Wt. (Appr.)	TBD	TBD
*Axle Dry Wt. (Appr.)	TBD	TBD
*Total Dry Wt.	TBD	TBD
GVWR	TBD	TBD
Fresh Water Tank Cap.	TBD	30
Grey Water Cap.	TBD	30
Black Water Cap.	TBD	30
Tire Size	ST205/75R14	ST205/75R14

### TS20RD



### TS21RBH

- New ABS wheel well cover & LP tank cover
- Black ring tinted safety glass windows std.

### TS22QB



### TS23FDS



### TS24BH



Travel Trailers	TS21RBH	TS22QB	TS23FDS	TS24BH
Length	22'5"	24'10"	24'4"	25'6"
Width (w/o Awning)	96"	96"	96"	96"
Height (w/AC)	9'9"	9'9"	9'9"	9'9"
Load Cap.	3048	2840	2690	2664
*Hitch Dry Wt. (Appr.)	351	420	140	321
*Axle Dry Wt. (Appr.)	2552	2760	2910	2936
*Total Dry Wt.	2903	3180	3320	3257
GVWR	5951	5999	6010	5921
Fresh Water Tank Cap.	30	30	30	30
Grey Water Cap.	30	30	30	30
Black Water Cap.	30	30	30	30
Tire Size	ST205/75R14	ST205/75R14	ST205/75R14	ST205/75R14

TS25S



TS27QBSS



TS29BHSS



Travel Trailers	TS25S	TS27QBSS	TS29BHSS
Length	27'10"	31'8"	32'4"
Width (w/o Awning)	96"	96"	96"
Height (w/AC)	9'9"	9'9"	9'9"
Load Cap.	2332	1792	1796
*Hitch Dry Wt. (Appr.)	280	393	362
*Axle Dry Wt. (Appr.)	3268	3808	3804
*Total Dry Wt.	3548	4201	4166
GVWR	5880	5993	5962
Fresh Water Tank Cap.	30	30	30
Grey Water Cap.	30	30	30
Black Water Cap.	30	30	30
Tire Size	ST205/75R14	ST205/75R14	ST205/75R14

### Appliances/Equipment

- 3 Burner Range Top
- Power Range Hood with Light
- Six Gallon Gas Water Heater
- 20,000 BTU Furnace
- Demand Water Pump
- Laminated Countertops
- Double Bowl Kitchen Sink
- Water Heater Bypass Kit Electrical
- Patio Light with Amber Lens
- Ceiling Lights
- 120 Volt GFI Protected Circuit(s)
- 120 Volt Breaker Panel
- Outside 120 Volt Receptacle
- 55 Amp Converter with Charger
- Battery Rack
- Pre-Wired for Microwave
- Detachable 30 Amp Power Cord

### Interior

- Galley Window
- Vinyl Back Dinette and Bunk Cushions
- Bath Sky Lights
- Valances
- Mini Blinds
- No-Wax Vinyl Flooring
- Roof Vent in Living Area (Deleted with Optional Air Conditioning Some Models)
- Power Roof Vent in Bath
- Interior Lighting Switch Bed Ends
- Tent (Attached Inside C-channel to Prevent Water Entry)
- Continuous Piano Hinge for Added Strength
- Key Locked for Security
- Compression Clamps Ensure Tight Bond of Bunk Seals
- 6" Bunk End Cushions for Comfort
- Pre-Wired for Bunk Lights Running Gear
- 14" Trailer Tires
- White Spoked Wheels
- Tandem Axles
- 10" Electric Brakes, All Wheels
- Galvanized Wheel Wells
- E-Z Lube Hubs

### Safety

- Break-A-Way Switch
- Fire Extinguisher
- Smoke Detector
- LP Detector
- Safety Chains
- Ground Fault Protected Circuit(s)
- Dead Bolt Door Lock

### Exterior

- Powder Coated Chassis
- Radius Windows
- Radius Entry Door with Window, Deadbolt Lock and Screen Door
- Outside Storage Compartment
- Self-Storage Step
- Rotocast Holding Tanks
- Rotocast Fresh Water Tank
- 20# LP Tanks
- 2-5/16" Coupler
- Radius Baggage Door
- 6" Steel I-beam frame for rough Canadian Roads

TC17



TC18



**New Interior Package**  
**New 42" x 22" dinette windows**

TC19



Travel Trailers	TC17	TC18	TC19	TC21E	TC23E
Length	22'11"	TBD	21'1"	TBD	TBD
Width (w/o Awning)	96"	TBD	96"	TBD	TBD
*Hitch Dry Wt. (Appr.)	TBD	TBD	TBD	TBD	TBD
*Axle Dry Wt. (Appr.)	TBD	TBD	TBD	TBD	TBD
GVWR	TBD	TBD	TBD	TBD	TBD
*Total Dry Wt.	2572	TBD	3316	TBD	TBD
Load Capacity	TBD	TBD	TBD	TBD	TBD
Tire Size	ST05/75/R14	ST05/75/R14	ST05/75/R14	ST05/75/R14	ST05/75/R14
Fresh Water Tank Cap.	30	TBD	30	TBD	TBD
Grey Water Cap.	30	TBD	30	TBD	TBD
Black Water Cap.	30	TBD	30	TBD	TBD

TC21E



TC23E



TC19QB



TC22DB

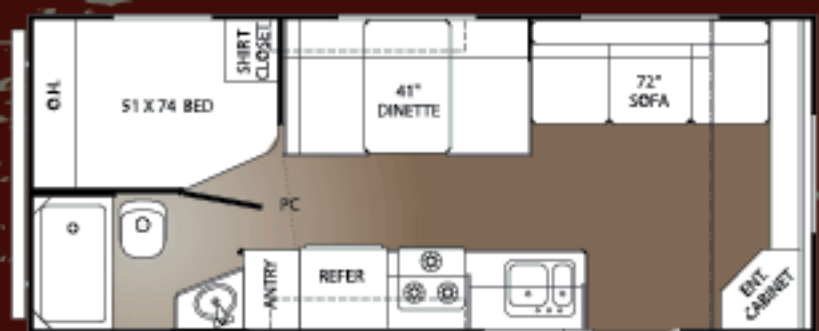

**Aluminum wheels**  
**Electric awning**  
**New outside galley**

- 4 new floor plans
- 8" structural I-beam chassis frame
- Heated enclosed underbelly
- 2,500 - 5,100 lbs.

Travel Trailers	TC19QB	TC22DB
Length	TBD	TBD
Width (w/o Awning)	TBD	TBD
*Hitch Dry Wt. (Appr.)	TBD	TBD
*Axle Dry Wt. (Appr.)	TBD	TBD
GVWR	TBD	TBD
*Total Dry Wt.	TBD	TBD
Load Capacity	TBD	TBD
Tire Size	ST05/75/R14	ST05/75/R14
Fresh Water Tank Cap.	TBD	TBD
Grey Water Cap.	TBD	TBD
Black Water Cap.	TBD	TBD



TC21RB (Bunk Option)



TC24RS



TC25BH

Travel Trailers	TC21RB	TC24RS	TC25BH	TC28RL
Length	TBD	TBD	TBD	31' 8"
Width (w/o Awning)	TBD	TBD	TBD	96"
*Hitch Dry Wt. (Appr.)	TBD	TBD	TBD	576
*Axle Dry Wt. (Appr.)	TBD	TBD	TBD	4064
GVWR	TBD	TBD	TBD	7576
*Total Dry Wt.	TBD	TBD	TBD	4640
Load Capacity	TBD	TBD	TBD	2936
Tire Size	ST05/75/R14	ST05/75/R14	ST05/75/R14	ST05/75/R14
Fresh Water Tank Cap.	TBD	TBD	TBD	30
Grey Water Cap.	TBD	TBD	TBD	30
Black Water Cap.	TBD	TBD	TBD	30



TC28RL

- Black ring tinted safety glass windows std.
- 42" x 22" dinette windows

(OPT. DOOR)



TC29BH



[www.discovercanadarv.com](http://www.discovercanadarv.com)

*the Canadian way, eh!*



TC30QBH

Travel Trailers	TC29BH	TC30QBH
Length	32' 3"	32' 11"
Width (w/o Awning)	96"	96"
*Hitch Dry Wt. (Appr.)	417	407
*Axle Dry Wt. (Appr.)	4672	4668
GVWR	7417	7407
*Total Dry Wt.	5089	5075
Load Capacity	2328	2332
Tire Size	ST05/75/R14	ST05/75/R14
Fresh Water Tank Cap.	30	30
Grey Water Cap.	30	30
Black Water Cap.	30	30



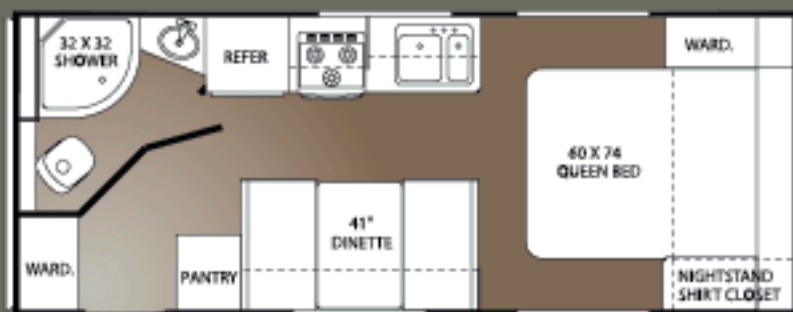

TC23QB



TC25QB

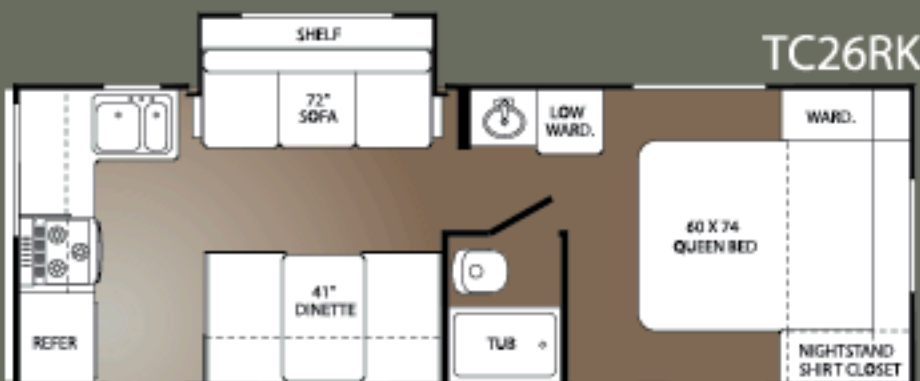

TC26RK

(OPT. DOOR)

Travel Trailers	TC23QB	TC25QB	TC26RK
Length	23' 9"	27' 10"	27' 7"
Width (w/o Awning)	96"	96"	96"
*Hitch Dry Wt. (Appr.)	341	280	576
*Axle Dry Wt. (Appr.)	3396	2332	4064
GVWR	5941	5880	7576
*Total Dry Wt.	3737	3548	4640
Load Capacity	2204	3268	2936
Tire Size	ST05/75/R14	ST05/75/R14	ST05/75/R14
Fresh Water Tank Cap.	30	30	30
Grey Water Cap.	30	30	30
Black Water Cap.	30	30	30

## EXPEDITION

## SPECIFICATIONS

### Exterior Construction and Features

- 6" Steel I-beam frame for rough Canadian Roads
- Enclosed Underbelly
- 2" Laminated Floor w/Aluminum Framing
- 2" Laminated Sidewalls w/Aluminum Framing
- 1.5" Laminated Sidewalls w/Aluminum Framing
- Ducted A/C
- Rubber Roof
- Radius Tinted Windows
- Automotive "D" Seal on all Windows
- Radius Baggage Doors
- Porch/Security Light
- Outside Doorside Cable Hookup

### Appliances and Electrical

- 3-Burner Range Top
- Power Range Hood w/Light
- Monitor Panel
- Six Gallon Gas Water Heater
- 20,000 BTU Furnace
- Laminated Countertops
- Copper LP Gas Lines
- Color Coded Water Lines
- Water Heater By Pass Kit
- Detachable Power Cord
- 55 Amp Converter

### Interior Features

- Large Galley Window
- 5" High Density Dinette Cushions
- 5" Foam Bunk and Bed Mattresses
- Mortise and Tenon Solid Wood Cabinet Doors
- Hard Valances w/Lambrequins in Living Area
- Bedsprad/Headboard and Pillow Shams
- Wall Border
- Radius Slide-Out Headers
- ABS Tub Surround
- Skylight Over Tub
- Two Door Refrigerator (N/A C17U)
- Pre-Wired for Microwave
- Outside 120 Volt Receptacle
- Expandable Bunk Ends
- 60 x 80 Front and Rear Beds
- Key Locked for Security
- Continuous Piano Hinge for Added Strength
- Compression Clamps Ensure Tight Seal
- Cable Supports Bunk Instead of Poles
- Tent Attached Inside C-Channel to Prevent Leaks

### Options

- Aluminum Wheels
- Electric Awning
- Roof Ladder
- Exterior Storage Drawer
- Oven
- Microwave
- 5.1 Surround Sound Home Theatre
- 19" LCD TV
- RVQ Grill
- Safety Glass
- Fantastic Fan
- A/C 13.5 BTU
- A/C 15 BTU



TL27RK



TL30BH

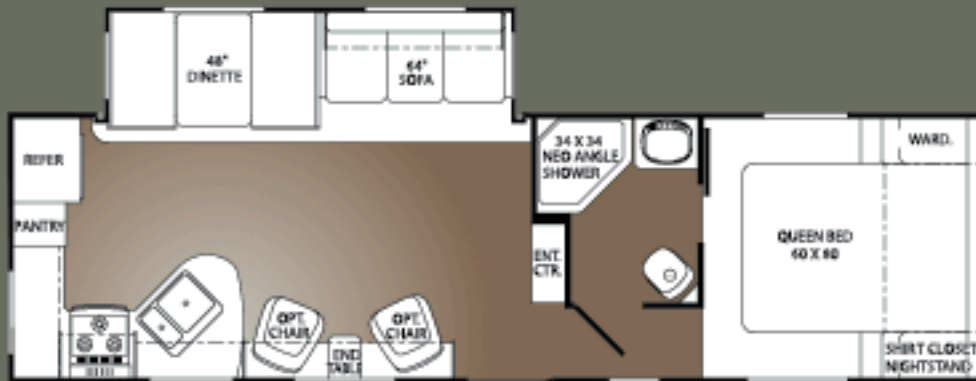

TL30RK

Travel Trailers	TC27RK	TL30BH	TC30RK
Length	28' 6"	31' 11"	32' 5"
Width (w/o Awning)	96"	96"	96"
Height (w/AC)	10' 8"	10' 8"	10' 8"
*Hitch Dry Wt. (Appr.)	565	668	685
*Axle Dry Wt. (Appr.)	4816	5106	5190
GVWR	8565	8668	7685
*Total Dry Wt.	5381	5774	5875
Load Capacity	3184	2894	2800
Tire Size	ST225/75/15D	ST225/75/15D	ST225/75/15D
Fresh Water Tank Cap.	40	40	40
Grey Water Cap.	40	40	40
Black Water Cap.	40	40	40



TL28RB



TL29FL



TL29RL

Travel Trailers	TC28RB	TC29FL	TC29RL
Length	30' 5"	33' 0"	31' 11"
Width (w/o Awning)	96"	96"	96"
Height (w/AC)	10' 8"	10' 8"	10' 8"
*Hitch Dry Wt. (Appr.)	602	969	610
*Axle Dry Wt. (Appr.)	5036	4918	5412
GVWR	8602	8969	8610
*Total Dry Wt.	5638	5887	5910
Load Capacity	2964	3082	2580
Tire Size	ST225/75/15D	ST225/75/15D	ST225/75/15D
Fresh Water Tank Cap.	40	40	40
Grey Water Cap.	40	40	40
Black Water Cap.	40	40	40

- Electric awning option
- Black ring safety glass windows standard
- Roller drawer glides
- New outside galley

### Appliances/Equipment

- 2 Door Flush Mount Refrigerator
- 3 Burner Range Top
- Power Range Hood w/Light
- Six Gallon Gas Elect. DSI Water Heater
- Furnace 30,000 BTU
- Air Conditioner Ready
- Water Heater Bypass Kit
- Demand Water Pump
- Copper LP Gas Lines
- P.E.X. Water Lines
- Monitor Panel

### Bath

- Fiberglass Reinforced Tub
- Shower Curtain w/Valance
- Thetford Toilet
- Medicine Cabinet w/Mirror
- Towel Bar, Toothbrush Holder and Tissue Holder
- Power Roof Vent
- Light w/Wall Switch
- Large Bath Sink
- Skylight

### Electrical

- Patio Light w/Amber Lens
- Ceiling Lights w/Wall Switches
- 120 Volt GFI Protected Circuits
- 120 Volt Fuse Panel
- Outside 120 Volt Recept
- 30 Amp, 28' Power Cord (Detachable)
- 55 Amp, Whisper Quiet Converter w/Charger
- Battery Box w/Positive Ventilation
- Pre-Wired for Microwave

### Exterior

- Rubber Roof
- Tinted Jalousie Windows
- Aerodynamic Front Profile
- 30" Main Entry Door(s) w/Radius Corners, Window, Screen Door, and Flush Mount Latch
- Locking Baggage Doors
- Triple Self-Storage Step(s)
- Large Front Storage Compartment
- 30# LP Tanks w/ABS Cover
- 2-5/16" Coupler
- Break-away Switch
- Enclosed, Heated Underbelly
- Easy Access Dump Valves
- 6" Steel I-beam frame for rough Canadian Roads

### Interior

- 2 Bar Stools (Certain Models)
- Panoramic Galley Window
- Reversible Dinette Cushions
- Mini Blinds
- No-wax Vinyl Flooring
- Mortise and Tenon Cabinet Doors
- Hidden Plumbing and Wiring
- High Pressure, Laminated Plywood Countertops w/Euro Style Faucet
- 80" Queen Bed w/Bedsread
- Light/Air Roof Vent(s)
- Fire Extinguisher, Smoke Detector, LP Detector
- Bedroom Carpet
- 2 Interior Decors (Slate Blue & Beachwood)
- Designer Radiused Window Treatmen
- Under Bed Storage w/Struts

### Running Gear

- 15" Radial Trailer Tires
- E-Z Lube Hubs
- Leaf Spring Suspension System
- Welded I-Beam, Steel Frame
- Stabilizer Jacks

### Options

- Air Conditioning, 13,500 BTU
- Air Conditioning, 15,000 BTU
- AM/FM CD DVD Player w/Ext Speakers
- 5.1 Surround Sound Home Theatre
- Electric Awning
- Swivel Rocker Chair
- Microwave
- Oven
- Spare Tire & Wheel
- TV Antenna/Cable
- Roof Ladder
- Outside Grill
- Outside Shower
- Sink Cover
- Stove Cover
- Tub Surround (Models 30BH & 32BH)
- Chrome Trim Rings w/Cap
- Fan-Tastic Fan
- Living Room Carpet
- Equal Flex Suspension
- Power Tongue Jack
- Day/Night Shades

## Construction Features



### Sidewall Laminate

1. Fiberglass Skin - dent resistant, low maintenance
2. Luan
3. Aluminum Frame & Foam
4. Wallboard



### Floor Laminate

1. Luan
2. Luan
3. Aluminum Frame & Foam
4. Luan
5. Darco

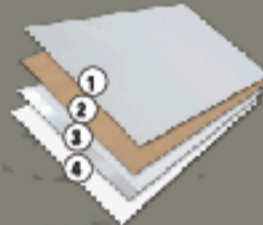

### Roof Laminate

1. Rubber Roof
2. Luan
3. Aluminum Frame & Foam
4. Ceiling Board

### Cobalt Trail Exclusive

Free Standing  
RVQ Grill





TL32BH



TL31BHDS

- New Graphics package
- Rich interiors
- Galley soffit lighting
- 1 piece shower surrounds
- Aluminum wheels

Travel Trailers	TC32BH	TL31BHDS
Length	33' 9"	33' 9"
Width (w/o Awning)	96"	96"
Height (w/AC)	10' 8"	10' 8"
*Hitch Dry Wt. (Appr.)	791	685
*Axle Dry Wt. (Appr.)	5348	5190
GVWR	8791	7685
*Total Dry Wt.	6139	5875
Load Capacity	2652	2800
Tire Size	ST225/75/15D	ST225/75/15D
Fresh Water Tank Cap.	40	40
Grey Water Cap.	40	40
Black Water Cap.	40	40

Where you purchase your recreational vehicle is ultimately your decision but Discover Canada RV urges you to consider buying at your local dealer. Dealers are part of your community, providing jobs and contributing to your local economy. These dealers are under obligation to provide warranty service for products they sell, but are not legally required to service products purchased from other dealers. At some point, you may need to return to the dealer you buy from - why not stay close to home?

### **BENEFITS OF PURCHASING YOUR RV LOCALLY:**

- You enjoy valuable relationship building with Dealer Representatives, close to your home, who will explain the features and benefits of the product.
- You receive a full product orientation prior to delivery, which includes hands on directions for many of the coach's systems and functions. You are also introduced to the Dealership's Service/ Parts/ Warranty personnel who are at the ready to help you with any issues you may encounter, now and in the future.
- You enjoy customer PRIORITY. Dealerships generally service their purchasing customers first - others may experience long delays and miss opportunities to use their RV.

What is it worth for you to have a dealership's full attention and motivation to satisfy you when you need service - in a timely manner.

- Valuable TAX dollars and jobs stay in YOUR community which pays for your roads, schools, police and fire departments.

**FOR CANADIAN RESIDENTS:** If you purchase an RV out-of-country, there are additional fees, taxes and inspections that must be met before bringing your product home. Your local Canadian dealers are experts in these provisions

*Your Dealer*



www.discovercanadarv.com

*the Canadian way, eh!*

As Discover Canada RV constantly strives to improve our product, all specifications listed in this informative brochure are subject to change without notice or obligation. Photos may show optional equipment which is not included in the purchase price of the unit. Review a current model on your dealer lot today.