



Jay Flight SLX



Serial #: 1UJBC0AJ1R7ZE0170  
Model: 183RBW JAY FLIGHT SLX TT

Model Year: 2024 Dealer Name: RV COUNTRY  
261293 US-101  
SEQUIM, WA 98382  
USA

Standard Equipment

Optional Equipment

THE FOLLOWING ITEMS ARE STANDARD ON THIS MODEL  
AT NO EXTRA CHARGE

OPTIONAL EQUIPMENT INSTALLED ON THIS VEHICLE  
BY MANUFACTURER

- EXTERIOR**
- Axles with electric, self-adjusting brakes and easy-lube hubs
  - Fully-integrated A-frame
  - Galvanized-steel, impact resistant wheel wells
  - Magnum Truss™ Roof System
  - Seamless one piece roof material
  - Large exterior downspouts
  - 30-amp service
  - Exterior cable TV hookup
  - LP quick connect (outside grill prep)
  - 5,000 BTU wall mount A/C (single axle models)
  - Nitrogen filled radial tires

- BAJA PACKAGE**
- 30 lb. LP bottle
  - Wide-stance axle
  - Goodyear® off-road tires
  - Enclosed underbelly
  - Double entry step
  - Stabilizer jacks (4)
  - Deluxe graphics package
  - Powder coated wheel fenders

- INTERIOR**
- Solid hardwood cabinet doors with screwed stile construction and hidden hinges
  - Vinyl flooring throughout
  - Digital TV antenna
  - Residential-style kitchen countertops
  - High rise kitchen faucet
  - Heavy-duty, 75 lb., full-extension, steel ball-bearing drawer guides
  - Plywood bed platforms
  - Queen mattress (select models)
  - 300 lb. rated single bunk beds
  - 600 lb. rated double bunk beds
  - Marine-grade toilet with foot flush
  - Shower curtain with curved shower track (select models)
  - Wood-trimmed mirror in bathroom

- CUSTOMER VALUE PACKAGE (Mandatory)**
- Solid Step® entry steps
  - On-demand tankless water heater
  - Power awning with LED lights
  - Marine grade exterior stereo speakers
  - Stabilizer jacks
  - Spare tire with cover
  - Keyed-Alike™ entry and baggage doors
  - Large folding entry door grab handle
  - Window shades
  - Range hood
  - 8 cu. ft. 12V refrigerator
  - Microwave oven
  - Fitted bed sheet (N/A 154BH)
  - Bathroom skylight
  - Tub/shower surround
  - AM/FM/Bluetooth® stereo
  - Backup camera prep
  - Detachable power cord
  - Bathroom vent
  - Entry door with window and shade prep
  - G20 dark tinted privacy windows
  - LED interior and exterior lights

Base price	27,210.00
USA STANDARDS	n/c
CUSTOMER VALUE PACKAGE	5,250.00
BAJA EDITION	1,943.00
OVERLANDER SOLAR PACKAGE	593.00
13,500 BTU ROOF MOUNTED AC	593.00
FIBERGLASS SIDEWALL	1,199.00
J-STEEL JACK KNIFE SOFA	893.00

UNIT TOTAL	37,681.00
DEALER INSTALLED OPTIONS	
FREIGHT	5,900.00
TOTAL MSRP	43,581.00

Manufacturer's Suggested Retail Price \$37,681.00

TOTAL AMOUNT DOES NOT INCLUDE STATE AND LOCAL TAXES OR LICENSE FEES. THE PRICE SHOWN ABOVE MAY OR MAY NOT BE REPRESENTATIVE OF THE ACTUAL SELLING PRICE OF SIMILAR RECREATIONAL VEHICLES IN YOUR AREA.

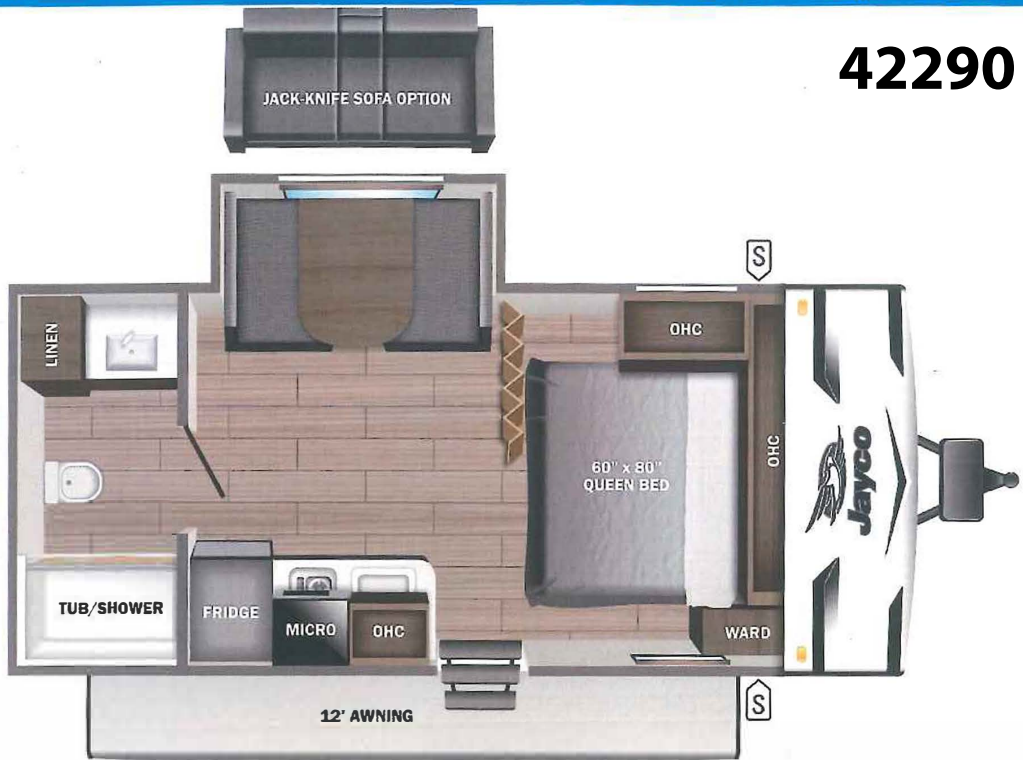

42290

**UVW**  
3699 lbs

**Sleeps**

**Length**  
21' 1.38"

DIMENSIONS

Exterior height:.....124.50"  
Exterior width:.....85.00"

WEIGHTS

GVWR:.....4350  
GAWR (front):.....4400  
GAWR (rear):.....0  
Approx. Gross Cargo Carrying Capacity(GCCC):.....651

TIRES

Tire size (front):.....LT225/75R16E  
Tire size (mid):.....  
Tire size (rear):.....  
Tire size (spare):.....LT225/75R16E

CAPACITIES

Fresh water tank (gals.):...30.00  
Gray water tank (gals.):...19.90  
Black water/toilet tank (gals.):...19.90  
Propane (lbs.):.....10  
Propane (gals.):.....2  
Water heater (gals.):.....0.00

SEATING & SLEEPING

\*\*\*Some dimensions may be rounded and may vary from the actual dimensions\*\*\*  
\*\*\*Weights may be estimated calculations and may vary from the actual weight - refer to the vehicle weight labels for actual weights\*\*\*  
Floorplans, features and specifications are subject to change without notice.

