



Jay Flight



Serial #: 1UJBC0BP9R75W0078
 Model: 267BHSW JAY FLIGHT TT

Model Year: 2024 Dealer Name: RV COUNTRY INC.
 3633 SOUTH MAPLE
 FRESNO, CA 93725
 USA

Manufacturer's Suggested Retail Price \$46,835.00

TOTAL AMOUNT DOES NOT INCLUDE STATE AND LOCAL TAXES OR LICENSE FEES. THE PRICE SHOWN ABOVE MAY OR MAY NOT BE REPRESENTATIVE OF THE ACTUAL SELLING PRICE OF SIMILAR RECREATIONAL VEHICLES IN YOUR AREA.

41630

Standard Equipment

Optional Equipment

THE FOLLOWING ITEMS ARE STANDARD ON THIS MODEL AT NO EXTRA CHARGE

OPTIONAL EQUIPMENT INSTALLED ON THIS VEHICLE BY MANUFACTURER

- EXTERIOR**
- 20 lb. LP Bottles with Cover (2)
 - Enclosed underbelly
 - Axles with electric, self-adjusting brakes and easy-lube hubs
 - I-Class™ cambered structural steel I-beams
 - Fully integrated A-frame
 - 5/8 in. tongue-and-groove plywood floor decking
 - Magnum Truss™ Roof system with plywood decking
 - Seamless one piece roof material
 - Large exterior downspouts
 - Galvanized steel, impact-resistant wheel wells
 - 30-amp service
 - Exterior TV mount and bracket
 - LP quick connect (outside gas grill prep)

- BAJA EDITION**
- (2) 30 lb. LP bottles
 - Flipped Axle
 - 16" Goodyear® Off-Road Tires
 - Triple Steps

- INTERIOR**
- 81 in. ceiling height
 - Shower/tub surround
 - Solid hardwood cabinet doors
 - J-Steel™ jackknife sofa with armrest & cup holders (most models)
 - Vinyl flooring throughout (including slide floors)
 - Window shades
 - Smoked-glass cabinet door inserts (select models)
 - Residential-style kitchen countertops
 - Heavy-duty, 75 lb., full-extension, steel ball-bearing drawer guides
 - USB charging station
 - Queen mattress
 - Plywood bed platforms
 - Main bed struts
 - 300 lb. rated bunk beds (select models)
 - 600 lb. rated bunk beds (double bunks)
 - Privacy curtains in bunk areas (select models)
 - Vented bunk windows (select models)
 - 4 in. thick bunk mats (select models)
 - Wooden bedroom doors (select models)
 - Shower curtain with curved shower track (select models)

- CUSTOMER VALUE PACKAGE (Mandatory)**
- Goodyear® Endurance® tires (made in the USA)
 - On-demand tankless water heater
 - Keyed-Alike™ entry and baggage doors
 - Outside shower
 - Power awning with LED lights
 - Marine-grade exterior speakers
 - Black tank flush
 - Spare tire with cover
 - Rock Solid stabilizer system
 - Overlander 1 Solar Package: (1) 200W solar panel and 30-amp digital controller
 - Large main entry door grab handle
 - Power tongue jack
 - Range hood
 - Oven with 3-burner recessed cooktop with glass cover
 - Microwave oven
 - Fitted bed sheet
 - Bathroom skylight
 - Sink cover
 - Bathroom medicine cabinet
 - Solid Step® entry steps (N/A 380DQS)
 - 13.5K BTU A/C
 - AM/FM/Bluetooth® stereo
 - Backup and side view camera prep
 - Bathroom power vent
 - Detachable power cord
 - G20 dark tinted privacy windows
 - Inverter pre-wire
 - Friction hinge entry door with window and shade prep
 - LED exterior and interior lights
 - One-piece front fiberglass exterior wall
 - Seamless countertops

Base price	39,498.00
USA STANDARDS	n/c
CUSTOMER VALUE PACKAGE	5,250.00
NO BAJA EDITION	n/c
15,000 BTU AC	300.00
32" LED SMART TV	488.00
METAL SIDEWALL	n/c
ALUMINUM RIMS (14")	593.00
30# LP GAS BOTTLES	113.00
ROOF LADDER (STD)	n/c
DINETTE	n/c
HIDE-A-BED SOFA	593.00

UNIT TOTAL	46,835.00
DEALER INSTALLED OPTIONS	
FREIGHT	1,942.20
TOTAL MSRP	48,777.20

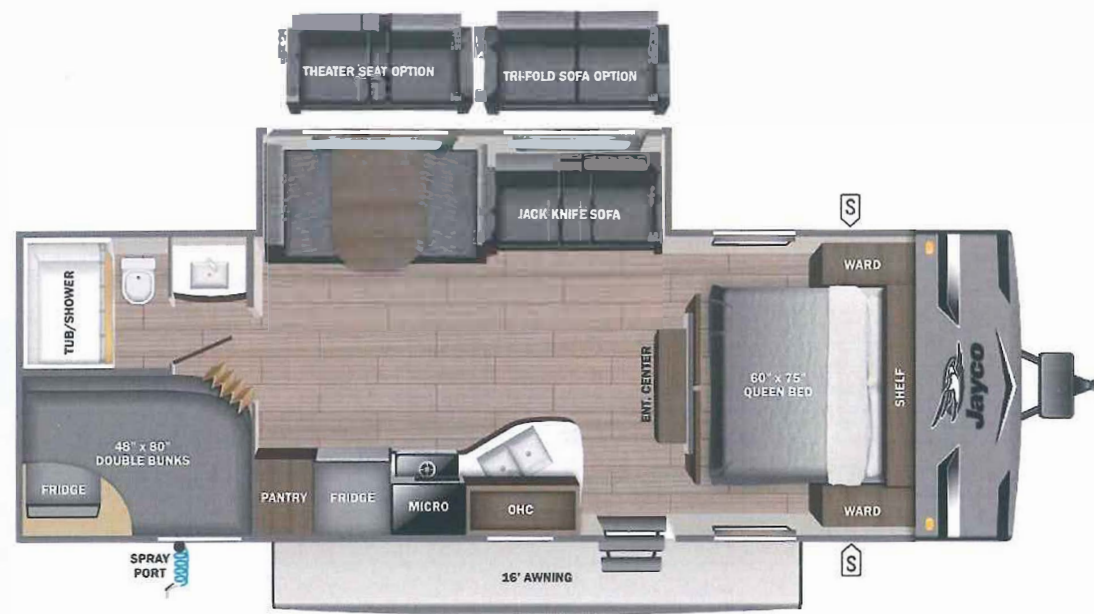

UVW
6110 lbs



Sleeps



Length
30' 3.63"

DIMENSIONS

Exterior height:	134.50"
Exterior width:	96.00"
WEIGHTS	
GVWR:	7600
GAWR (front):	3500
GAWR (rear):	3500
Approx. Gross Cargo Carrying Capacity (GCCC):	1490

CAPACITIES

Fresh water tank (gals.):	76.00
Gray water tank (gals.):	39.00
Black water/toilet tank (gals.):	39.00
Propane (lbs.):	60
Propane (gals.):	14
Water heater (gals.):	0.00

TIRES

Tire size (front):	ST205/75R14D
Tire size (mid):	
Tire size (rear):	ST205/75R14D
Tire size (spare):	ST205/75R14D

SEATING & SLEEPING

Some dimensions may be rounded and may vary from the actual dimensions
 Weights may be estimated calculations and may vary from the actual weight - refer to the vehicle weight labels for actual weights
 Floorplans, features and specifications are subject to change without notice.

