

EVO

BY FOREST RIVER



A BUNKHOUSE THAT CAN CONVERT TO A GARAGE.

ELECTRIC BUNK SYSTEM. *The 2700 features a full size triple bunk with an electric bed lift system. Rear beds are on an electric lift with a large access door for loading bikes, kennels, or whatever equips your trip.*



2700

All EVO's have LED lights in the interior which ensures highly efficient battery use.



KITCHEN

MASTER BEDROOM & KITCHEN

Most Master Bedrooms have walk around queen beds with easy light up storage and large closets. Our Kitchens are loaded with extra storage, including the half barrel storage pantry underneath the counter.



BEDROOM



WALK OUT BATH (PER FLOORPLAN)

BATHROOMS

Always large! This makes changing, showering, and cleaning easy with full tub surround and spacious layout.



Showing the very popular 2460 model with standard Jackknife sofa and oversized pull out storage drawer. (Reclining Chair Option Available)

2460

A MIX OF
EVERYTHING
YOU LOVE.

**BAY WINDOWS
& RECLINERS**

Enjoy the view through the wall to wall picturesque rear window. Let the natural light in when you want it, as you relax in the deluxe optional recliners.



KITCHEN



BAY WINDOW & CHAIRS

KITCHEN

The 2460 kitchen has all the storage you would want while camping, with oversized overhead cabinets and convenient spice rack.



BATHROOM

BATHROOM

With modern style bathrooms, most floorplans offer the glass shower door which is not only beautiful but practical.

EVO Standards

PRODUCT FEATURES

2000-lb. Tongue Jack
3,500-lb. EZ Lube Axles (5200# on 3250)
8" Rust Resistant Powder Coated I-Beam Chassis
6" Rust Resistant Powder Coated I-Beam Chassis Non Slides
4-wheel Electric Self Adjusting Brakes
14" or 15" Radial Trailer Special Tires (Per Floorplan)
4" Steel Rear Bumper/Sewer Hose Storage w/end caps
Frame Mounted Dual Battery Rack
Schwintec Electric Slide-out Operating System, Flush Floor per Floor Plan
Full through Chassis Electric Slide Room Support System (Super Slides)
5/8" One-piece Promax OSB waterproof slide-out floor decking
Slide-out exterior end walls are high-gloss gel coat fiberglass
R-7 Johns Mansville Fiberglass Insulation Roof/Floor/Walls/End Caps
Full Walk-On Roof with One-piece Superflex Polyolefin Roofing Membrane
Large Water and Up to 115 gal. Holding Tank Capacity (See Specs for Detail)

EXTERIOR

Front Pass-through Storage with LED Light
Crowned Roof for Water Drainage

Truss Rafter on Slide Models
Black Frame Safety Glass Windows
30-amp. 110v Power Cord
City Water Connection
Cable TV Hook-up
Exterior LED Utility Light
110V Exterior Plug
Two 12v/USB Charging Stations
Radius Entry Door with Window
Radius Compartment Storage Doors
Entry Assist Handle
Dometic Awning w/Retractor Assist Springs
Aerodynamic Aluminum Front Cap
Omni Digital TV Antenna w/Booster
LPG Tank Cover with Easy Access
Exterior Speakers
Extended Rain Gutter Spouts
6-gal. Suburban Gas/Electric DSI Water Heater w/16-gal/hr. recovery
Water Heater By-Pass for Cold Storage
Hot & Cold Low Drain Points
Front Lower Gravel Guard
Compartment Door Holding Latches

INTERIOR

Vintage Timber Craftsmen Cabinets
Stained Wood Cabinet Doors
Wood Drawer Fronts
Deluxe Ball Bearing Drawer Guides
Home Style Brushed Nickel Cabinet Hardware
Convenient Storage Areas

Galley Lighting
System Monitor Panel
Systems Control Panel
Laminate Counter Top
Full Access Kitchen Sink w/Sink Covers
Hi-Rise Sink Faucet Brushed Nickel
U-Shaped Dinette Per FP
Dometic Foot Flush Toilet
Full Wall Tub/Shower Surround
Power Vent in Bathroom
Medicine Cabinet with Mirror
Full Length Bedroom Wardrobes
Lift Up Bed for Storage Per FP
Pillow Top Inner Spring Mattress (Front Bedrooms)
Bedspread and Pillow Shams
110V Electric outlets on both sides of main bed
20K or 30K BTU Suburban Furnace per Floor Plan
48" Pull Out Storage Drawer under Jack Knife Sofa
Shoe Storage under Entertainment Center
Escape Windows in Sleeping Areas
Knife Holder Behind Range
Solid Doors at Bedroom Entry (Per FP)
Laundry Chutes (Per FP)

APPLIANCES

Suburban 3-Burner Range with 17" oven
Range Hood with 12-volt light and Exhaust Fan

Range Cover with Exhaust Fan
Dometic 6-cu.ft. Double Door Refrigerator Wood Grain inserts
Microwave w/Carousel Hi-Point
Suburban 6-gal. Gas Water Heater w/ DSI
Dometic 13,500 BTU Air Conditioning
Floor Ducted Heat per Floor Plan
Suburban 20K or 30K BTU Furnace per Floor Plan
Flush Mounted Speakers in Ceiling
AM/FM/CD/ Stereo System Interior/
Exterior Speakers

OPTIONAL FEATURES

12-volt Power Tongue Jack w/Light
LED Lighting Throughout
Solid Surface Countertop in Kitchen W/
Undermount Sink.
Pre-Wired for Solar
Power Stabilizer Jacks upgrade
Power Awning with LED Lighting
Night Shades IPO Mini Blinds
DVD System w/MP3/AM/FM/ w/Remote Control
Remote Control (Slide/Awning/
Stabilizers/Porch Light)
Ducted Air Conditioning Roof Vents
15,000 BTU Air Conditioner
Jensen HD LED Television with Wall Bracket
Black Tank Sani Flush
LPG Quick Connect Frame Mount

Bumper Mounted Radial Spare Tire W/
Forest River Spare Tire Cover
Deluxe Aluminum Wheels per Model
30# LPG Tanks
4 Stabilizer Jacks
200W GO Power Solar Charging Package
Glass Enclosure (Showers)
Outside Shower
Roof Ladder
Large Swing-Out Entry Assist Handle
Large Bunk Access Door (2550/2700)
Large Skylight over Shower
Two Deluxe Recliners (2460)
Stainless Steel Appliance Upgrade w/
Refer Front
LPG Under Frame Mount BBQ Quick Disconnect
Tankless Water Heater

CLIMATE PACKAGE

Enclosed Tanks w/Radiant Foil (R-38 Roof/Floor)

EVO Product Highlights



9 PLY BIRCH WITH STEEL BALL BEARING DRAWER GUIDES



EXTRA DEEP SINK



KITCHEN SINK COVERS



EXTRA LARGE PANTRY (PER FLOORPLAN)



EXTRA KITCHEN STORAGE



SHOE NOOK

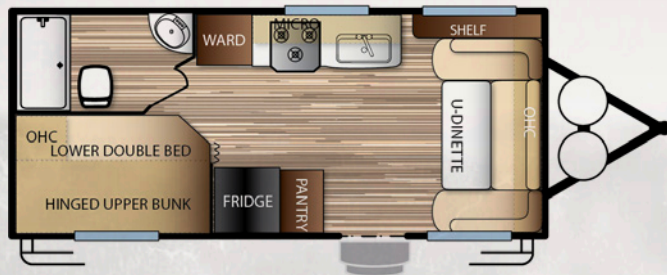

T1860



T2250

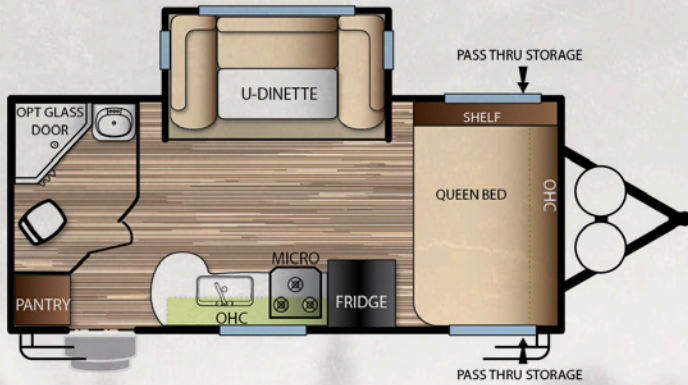

T1850

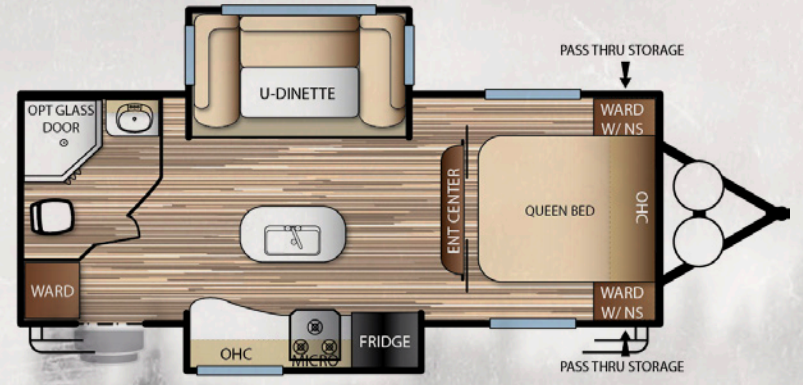

T2050

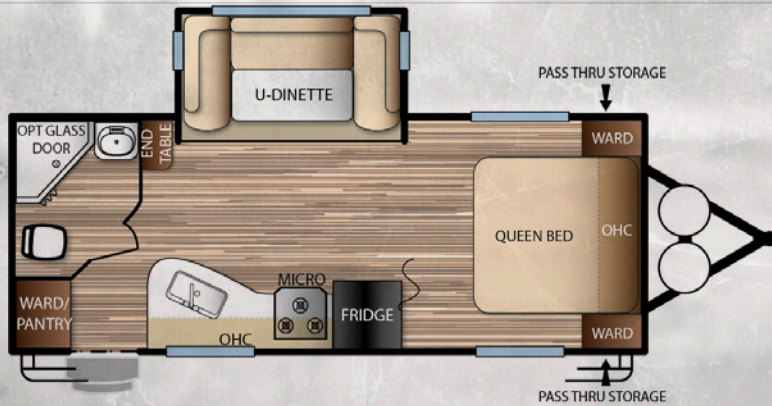

T2160

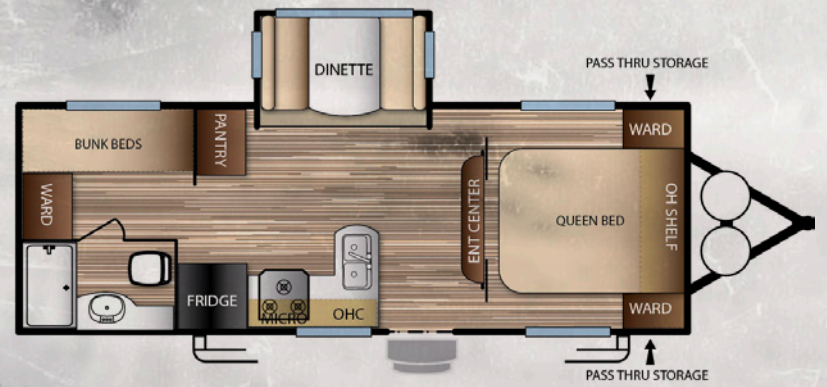

T2300

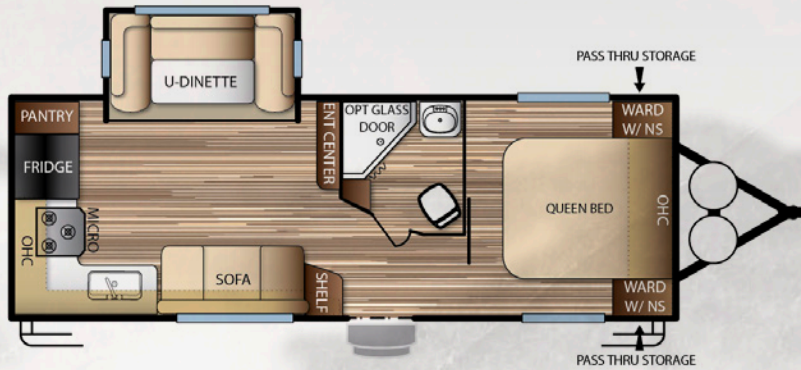

T2360

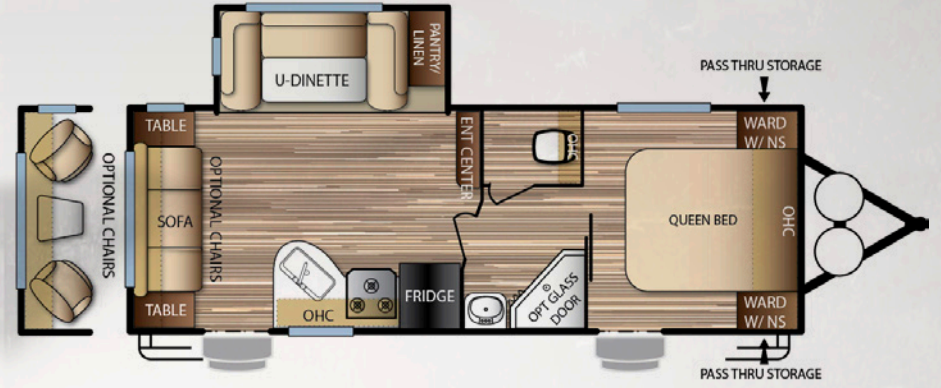

T2460

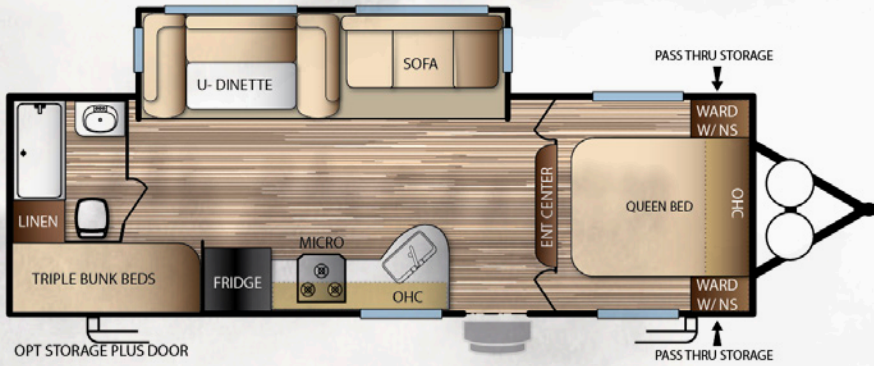

T2550

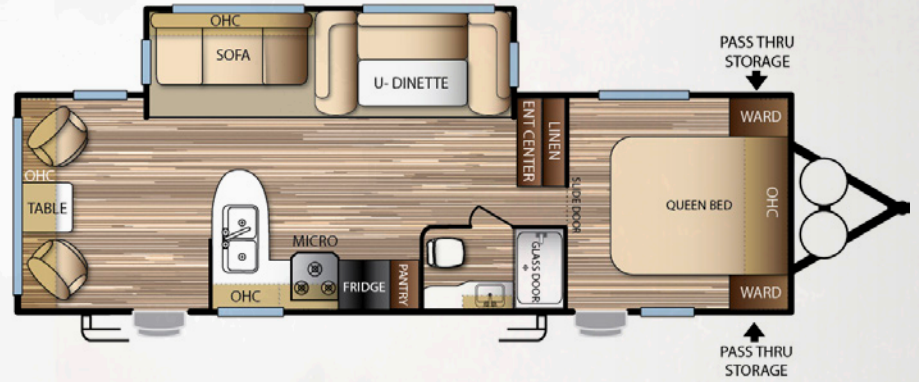

T2600



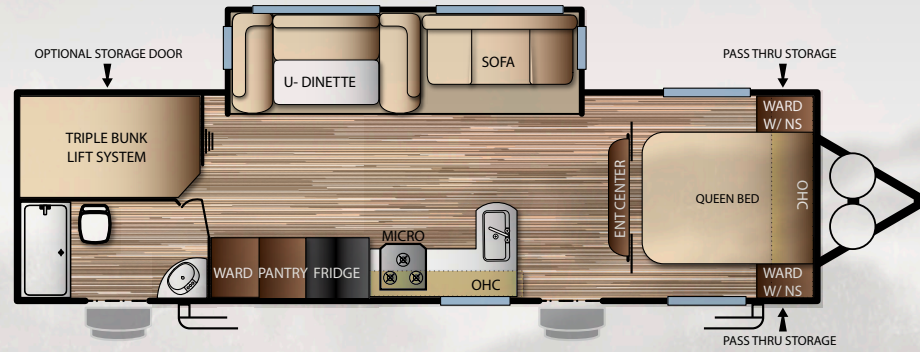

T2700

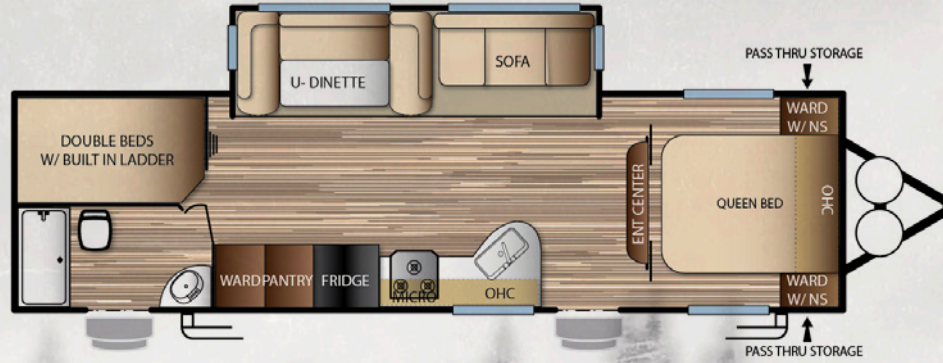

T2850



T3250



YOUR EVO DEALER

FREE MEMBERSHIP
to Forest River Owners' Group

www.forestriverfrog.com



Learn More
Scan this barcode using a QR Reader on your smart phone to learn more about Forest River.



A Berkshire Hathaway company.

Forest River, Inc. 255 S. Pepper Ave., Rialto, CA 92376
www.forestriverinc.com/Evo | www.forestriveraccessories.com

All illustrations and specifications contained in this literature are based on the latest product information at time of publication. Forest River reserves the right to make changes in prices, colors, materials, equipment and specifications at anytime without notice and assumes no responsibility for any error in this literature. All units are shipped F.O.B. Goshen, Indiana. CONSULT YOUR LOCAL DEALER FOR WARRANTY INFORMATION. LITHO: U.S.A. FOR 1223 P & W: 2015.29.05

Specification Definitions

GVWR (Gross Vehicle Weight Rating) - is the maximum permissible weight of the unit when fully loaded. It includes all weights, inclusive of all fluids, cargo, optional equipment and accessories. For safety and product performance do NOT exceed the GVWR.

GAWR (Gross Axle Weight Rating) - is the maximum permissible weight, including cargo, fluids, optional equipment and accessories that can be safely supported by a combination of all axles.

UVW (Unloaded Vehicle Weight)* - is the typical weight of the unit as manufactured at the factory. It includes all weight at the unit's axle(s) and tongue or pin and LP Gas. The UVW does not include cargo, fresh potable water, additional optional equipment or dealer installed accessories.

*Estimated average based on standard build optional equipment.

CCC (Cargo Carrying Capacity)** - is the amount of weight available for fresh potable water, cargo, additional optional equipment and accessories. CCC is equal to GVWR minus UVW. Available CCC should accommodate fresh potable water (8.3 lbs per gallon). Before filling the fresh water tank, empty the black and gray tanks to provide for more cargo capacity.

** Estimated average based on standard build optional equipment

Each Forest River RV is weighed at the manufacturing facility prior to shipping. A label identifying the unloaded vehicle weight of the actual unit and the cargo carrying capacity is applied to every Forest River RV prior to leaving our facilities.

The load capacity of your unit is designated by weight, not by volume, so you cannot necessarily use all available space when loading your unit.



Forest River, Inc. encourages our customers to purchase their Forest River products from a local dealership whenever possible for the following reasons:

- 1) Forest River, Inc. dealers are independently owned and operated businesses so priority service and scheduling is at their discretion and is often provided to customers that purchased their unit at that dealership.
- 2) Purchasing locally allows customers to establish meaningful relationships with a dealer, enhancing the RV experience through assistance with product questions, user tips or RV regulations for your state or country, and much more!
- 3) Canadian customers must meet requirements to bring an RV purchased out of the country to their home. These requirements may involve additional inspections and certifications, taxes and fees. Your local Canadian Dealer is a professional at meeting these requirements.
- 4) Scheduling timely warranty repairs and adjustments through a local dealership provides far greater flexibility and convenience to you, the customer!

It is the goal of Forest River, Inc. that all of our RV owners fully enjoy the RV experience and that customer satisfaction meets or exceeds their expectations!

24/7 EMERGENCY ROADSIDE ASSISTANCE

For a worry-free ownership experience

Forest River includes one

year of Coach-Net RV Technical & Roadside

Assistance with each RV purchase. Whether

new to the RV lifestyle or an experienced RV enthusiast,

Forest River owners have 24/7 access to technical,

operational and emergency road service

coverage throughout the US & Canada.

Coach-Net's fast, dependable

service is just a phone

call away.

Coach-Net®

RV Technical & Roadside Assistance



NEW TO THE LINEUP



T2010

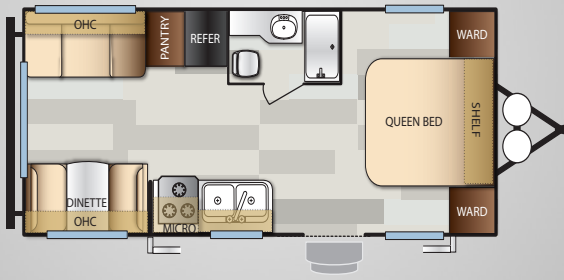

T2490

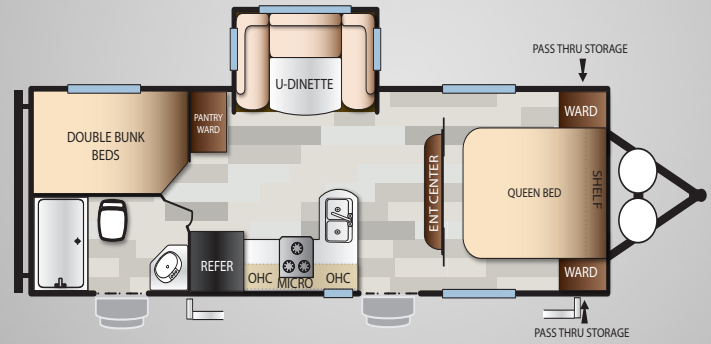

T2790

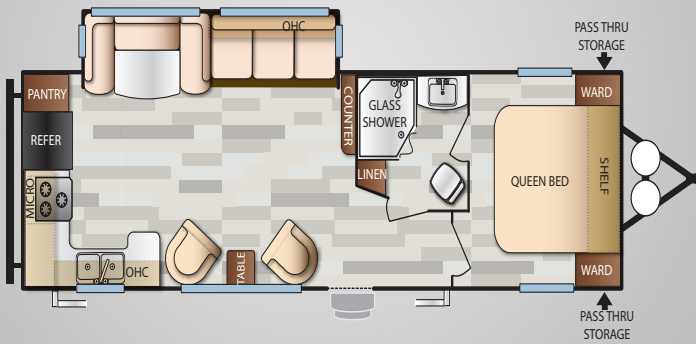

T2990

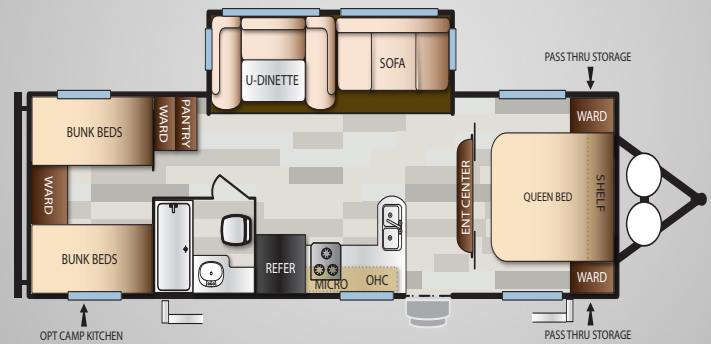

	T2010	T2490	T2790	T2990
HITCH WEIGHT	670 lbs.	820 lbs.	720 lbs.	923 lbs.
UVW	5038 lbs.	5970 lbs.	6355 lbs.	7,295 lbs.
GVWR	7670 lbs.	7820 lbs.	7720 lbs.	11203 lbs.
CCC	2632 lbs.	1850 lbs.	1365 lbs.	3908 lbs.
EXT LENGTH	26' 11"	29' 4"	33' 3"	34' 9"
EXT HEIGHT	10' 5"	11' 2"	11' 2"	11' 3"
EXT WIDTH	96"	96"	96"	96"
FRESH WATER	56 gal.	56 gal.	56 gal.	56 gal.
GREY WATER	40 gal.	35 gal.	40 gal.	40 gal.
BLACK WATER	30 gal.	30 gal.	35 gal.	35 gal.
AWNING SIZE	14 ft.	16 ft.	16 ft.	18 ft.

