

# PARADIGM 380MP

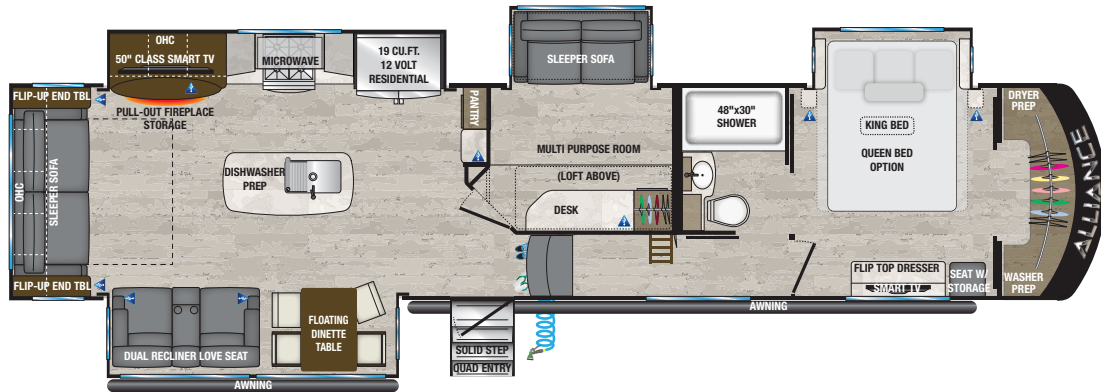

40'-11"  
LENGTH

13'-6"  
HEIGHT

14,025 Lbs  
DRY WEIGHT

16,800 Lbs  
GVWR

2,854 Lbs  
HITCH WEIGHT

98/106/53 Gal  
FRESH/GRAY/BLACK



## CUSTOMER DRIVEN FEATURES

### Privately Owned Company

Customer Obsessed Mission "Do The Right Thing"

### Cooler Fifth Wheel In the Industry

3 A/C Units Standard \*40K BTU Ultra Quiet High Efficiency\*

### Camp Ready Performance Audit

- Comprehensive Inspection

### Performance Running Gear

- Heavy Duty 4K Springs VS Industry 3.5K
- Super G-Range 14-PLY Tires (4,400 Lb. Rated VS. 4,080 Lb.)
- MorRyde CRE-3000 Suspension System
- Disc Brake (Option)
- Spring Hangers With V-Bracket Reinforcement
- 2" Torsion Tube Welded To The I-Beam For Strength and Rigidity
- MorRyde Heavy Duty 1/2 Inch Thick Shackles and Wet Bolt Kit

### Innovative Storage Solutions

Flip Up Storage in End Tables, Bed-room Dresser and Pull Out Storage In Fireplace

### Flush Floor Kitchen Slide Out

Eliminates Awkward Lip in Kitchen Slide

### Benchmark Chassis

Stronger Design + Flush Upper Deck - Smarter Chassis / Space Saver

### High Gloss Sidewalls with AZDEL Composite Substrate

Mold and Rot Resistant

### Huge Residential Shower with Flip Down Teak Seat

### Designer Accent Lighting Throughout

Kitchen Sink Surround, Crown Molding and Kitchen Soffit

### Color Coded & Numbered Wires with Guide at Converter Box

Easier Serviceability and Diagnostic

# PARADIGM

The Benchmark for Luxury Fifth Wheels



Alliance Recreational Vehicles  
301 Benchmark Drive  
Elkhart, Indiana 46516  
Office: (574) 218-7165  
Customer Service: (574) 226-0140