



# NO BOUNDARIES

**10 SERIES**  
(under 2,000 LBS)



**16 SERIES**  
(under 3,500 LBS)



**19 SERIES**  
(under 5,000 LBS)





## WHAT IF THERE WERE NO BOUNDARIES?

Designed for those who push limits, the versatile and exceptionally light weight No Boundaries (**NOBO**) travel trailer is rugged enough for any outdoor enthusiast. It's innovative and durable rooftop Rhino-Rack offers adaptable storage for Kayaks, mountain bikes, snowboards, fishing equipment, or just simply extra luggage. Towable by both 4- and 6-cylinder vehicles, **NOBO** is ready when you are.



## FEATURES



**JBL PORTABLE  
BLUETOOTH SPEAKER**



**MORRYDE STEPS  
W/LED ENTRY STEP LIGHT**



**BEVERAGE OPENER  
(STANDARD)**



**BATWING CANOPY  
270° COVERAGE**



**WHEEL STEP/SEAT  
(STANDARD IN OVERLANDER PACKAGE)**



**OUTDOOR KITCHEN  
(STANDARD ON 10.5/10.6)**



**SEAMLESS PANORAMIC FRONT WINDOW  
60" X 22" TEMPERED GLASS. FRONT CAP STANDARD WITH  
BACK COUNTRY PACKAGE ON 19 SERIES, OPTIONAL ON 16 SERIES**



## WHEN YOU LIVE LIFE BY A COMPASS, NOT A CLOCK.

With industry-leading ground clearance, larger diameter tires and a nimble suspension system, you'll be able to explore and set up camp in places that would otherwise be inaccessible. Additionally, the upscale interior focuses on thoughtful, useful design with ample storage and an ergonomic and refreshing living space.

**NO•BO** is attractively equipped with both familiar standard equipment as well as fresh features for a truly unforgettable adventure.



NB10.6

## SPECIFICATIONS

MODEL	NB10.5	NB10.6
Unloaded Vehicle Weight	1570	1606
Hitch Weight (lbs.)	210	198
Cargo Carrying Capacity	2140	1992
Roof Capacity (lbs.)	500	500
Exterior Length	13' 10"	13' 9"
Exterior Width	88"	88"
Exterior Height (w/ A/C)	7' 5"	7' 5"
Fresh Water (gal.)	30	30
Grey Water (gal.)	N/A	N/A
Black Water (gal.)	N/A	N/A

**NOTE** - Definitions for specifications can be found on the back page of this brochure.

## KEY FEATURES

- **10.6 can haul a full-size ATV**
- **Standard Enclosed Underbelly**
- **30 gal. Fresh Water Capacity**

## FLOORPLANS

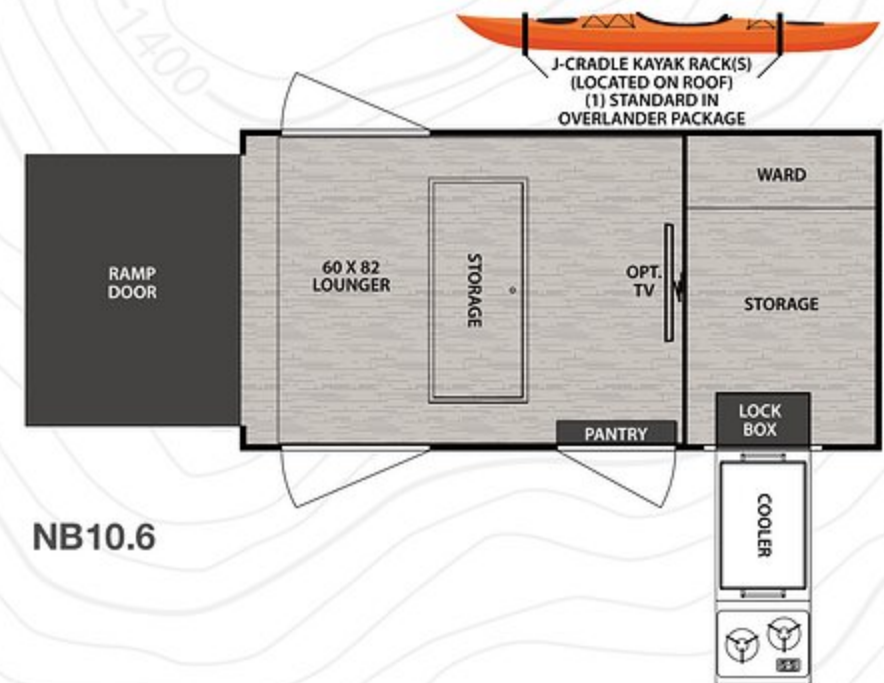
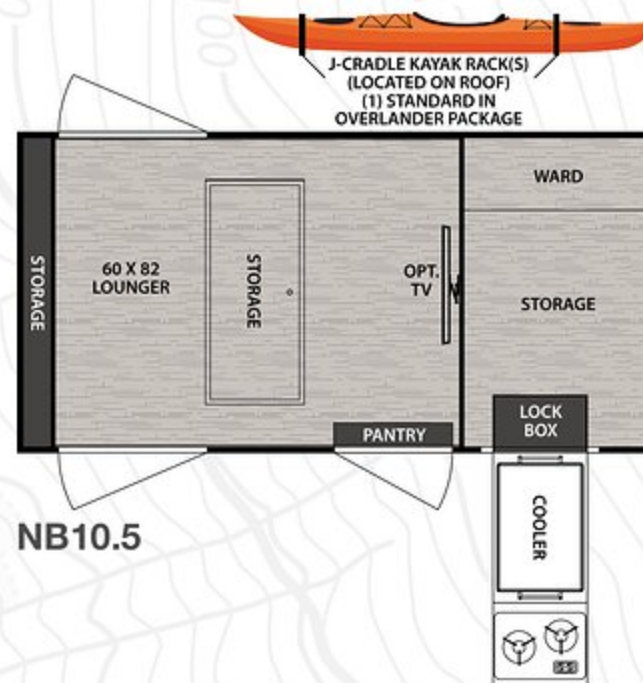



## 10 SERIES STANDARDS/OPTIONS

### DISCOVERER PACKAGE

#### KEY STANDARD EQUIPMENT

JBL Portable Bluetooth Speaker

---

Complete Interior/Exterior LED Lighting PKG

---

LED Entry Step Light

---

1000 Lumen Amber/White Scare Light

---

Metropolitan Grey Lightweight-Ply Countertops

---

Stainless Steel Utility Hooks

---

Bottle Opener

---

Black Satin Faucet/Door Pulls (where applicable)

---

High Performance Vinyl Furniture

---

2-Burner Glass Recessed Cook Top

---

Black Stainless Steel Sink (where applicable)

---

Pleated Shades

---

USB Charging Station

---

Lamilux 1000 Fiberglass Exterior

---

Featuring Satin Matte Graphics

---

(Some Features N/A 10 Series)

### OVERLANDER PACKAGE

Standard RVT Track (Rhino Rack #RTV148)

---

Two Vortex Bars (Rhino Rack #VA180B)

---

J-Cradle Kayak Holder (Rhino Rack #S510)

---

Wheel Step/Seat (Rhino Rack #RWS)

---

Satin Matte Finish 6-Lug Wheels

---

Wrapped in All Terrain Tires

### OPTIONAL EQUIPMENT

13.5 BTU Low Profile Air Conditioning

---

5500 BTU Heat Strip  
(applicable only with A/C equipped)

---

28" LED Flat Screen 12V TV

---

Power Tongue Jack w/LED Light

---

Cold Weather Package

---

Pioneer Platform  
(IPO Vortex Bars and J-Cradle Kayak Rack)

---

Hybrid Single Bike Carrier  
(Rhino Rack #RBC050)

---

Snowboard/Ski/Fishing Rod/Paddle Holder  
(Rhino Rack #573)

---

J-Cradle Kayak Holder (Rhino Rack #S510)

---

One Standard Kayak Holder in Overlander PKG

---

Batwing Awning

---

Dinette Package

---

Ramp Door Screen Door (n/a 10.5)

---

NOBO Nest - Roof Top Tent



LOAD.



LOUNGE.



DINE.



RELAX.



REST.

REPEAT.



## WHEN YOUR NEXT PATH IS OFF THE GRID.

Count on **NO•BO** to take you into uncharted territory. Escape the crowds into the remote rugged wilderness and take your gear with you. Whether in search of a big catch or a big wave, you don't have to leave amenities behind. Explore, get dirty, then return to home base to clean up, relax and recharge.



NB16.8

## SPECIFICATIONS

MODEL	NB16.2	NB16.6	NB16.8
Unloaded Vehicle Weight	3284	3346	3264
Hitch Weight (lbs.)	440	382	270
Cargo Carrying Capacity	1556	1417	1406
Roof Capacity (lbs.)	500	500	500
Exterior Length w/o Spare Tire	21' 8"	21' 8"	20' 1"
Exterior Width	96"	96"	96"
Exterior Height (w/ A/C)	9' 11"	9' 11"	9' 11"
Interior Height	78"	78"	78"
Box Width	6' 6"	6' 6"	6' 6"
Fresh Water (gal.)	30	30	30
Grey Water (gal.)	30	30	30
Black Water (gal.)	30	30	30

**NOTE** - Definitions for specifications can be found on the back page of this brochure.

## FLOORPLANS

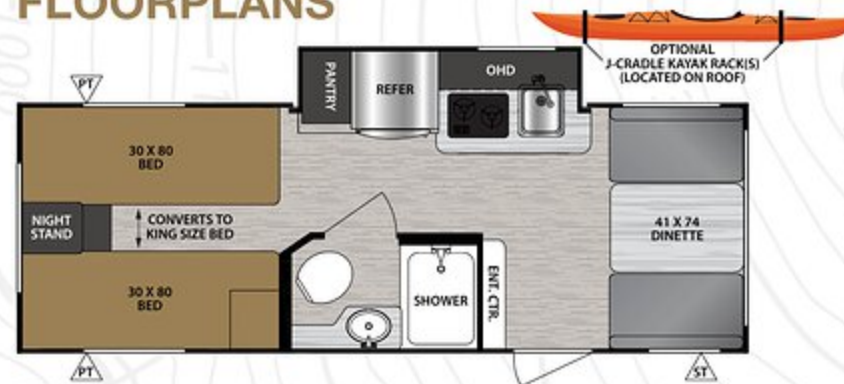

NB16.2

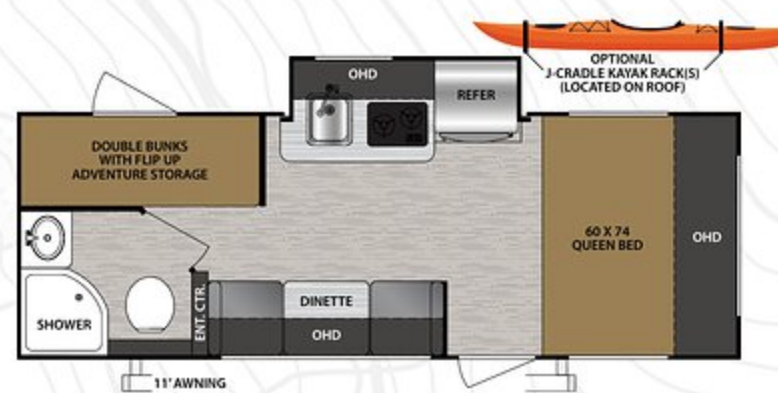

NB16.6

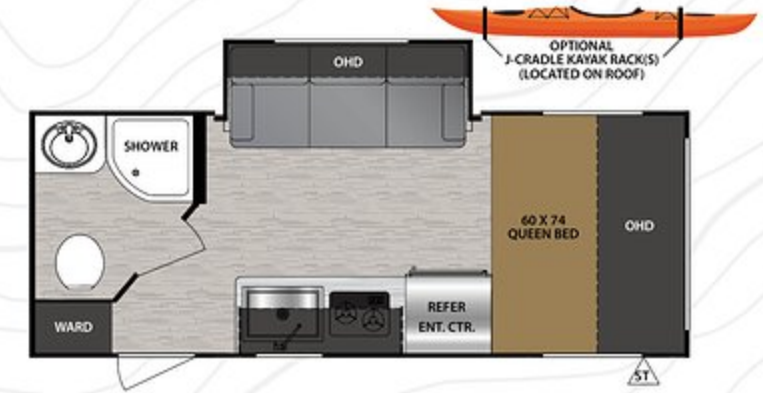

NB16.8

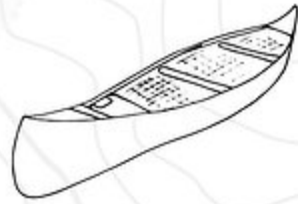

## 16 SERIES OPTIONS

### OVERLANDER PACKAGE

Standard RVT Track (Rhino Rack #RTV148)  
 Two Vortex Bars (Rhino Rack #VA180B)  
 J-Cradle Kayak Holder (Rhino Rack #S510)  
 Wheel Step/Seat (Rhino Rack #RWS)  
 Satin Matte Finish 6-Lug Wheels  
 Wrapped in All Terrain Tires

### OPTIONAL EQUIPMENT

Stainless Steel Convection Microwave Oven  
 28" LED Flat Screen 12V TV  
 Power Tongue Jack w/LED Light  
 Cold Weather Package  
 Custom Front Fiberglass Protective Shell  
 JBL Bluetooth Speaker and Quick Release Mount  
 Central Vacuum System  
 Solar Package (110 Watt Panel/  
 Digital Controller/1000 Watt Inverter  
 15K A/C IPO 13.5K A/C



NB16.8



NB16.8



NB16.8



## WHEN YOU THRIVE ON PUSHING THE LIMITS.

**NO•BO** 19 Series delivers a true 7' wide box to align perfectly with smaller tow vehicles. Combine this with our enclosed underbelly and gate valves, panoramic front window, and torsion axle suspension system to offer you the most versatile, capable, and affordable towable on the market. Each **NO•BO** 19 series also features factory installed RVT tracks on the roof, ready to accept and integrate your personalized Rhino Rack Roof System!



NB19.1

## SPECIFICATIONS

MODEL	NB19.1	NB19.2	NB19.3	NB19.5	NB19.6	NB19.7	NB19.8
Unloaded Vehicle Weight	4264	3502	4122	3456	4284	3809	3789
Hitch Weight (lbs.)	720	414	550	365	490	388	395
Cargo Carrying Capacity	3456	1293	3351	1309	3206	979	1006
Roof Capacity (lbs.)	500	500	500	500	500	500	500
Exterior Length w/o Spare Tire	24' 11"	21' 6"	24' 4"	22' 8"	24' 4"	23' 8"	22' 8"
Exterior Width	88"	88"	88"	88"	88"	88"	88"
Exterior Height (w/ A/C)	9' 11"	9' 11"	9' 11"	9' 11"	9' 11"	9' 11"	9' 11"
Interior Height	78"	78"	78"	78"	78"	78"	78"
Fresh Water (gal.)	30	30	30	30	30	30	30
Grey Water (gal.)	30	30	30	30	30	30	30
Black Water (gal.)	30	30	30	30	30	30	30

**NOTE** - Definitions for specifications can be found on the back page of this brochure.

## FLOORPLANS

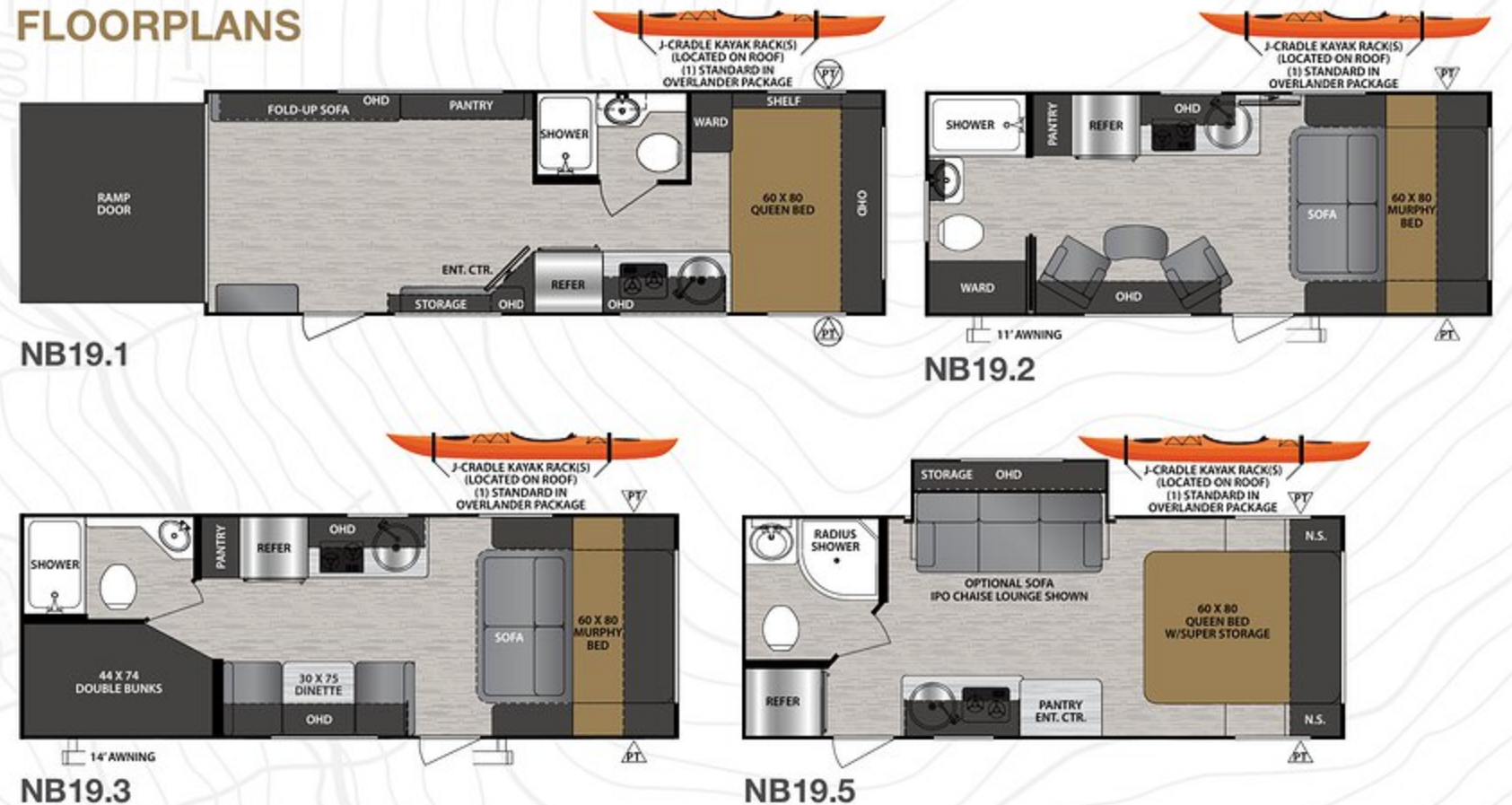





**NOBO**  
NO BOUNDARIES



## 19 SERIES STANDARDS/OPTIONS

### DISCOVERER PACKAGE

#### KEY STANDARD EQUIPMENT

- JBL Portable Bluetooth Speaker
- Complete Interior/Exterior LED Lighting PKG
- LED Entry Step Light
- 1000 Lumen Amber/White Scare Light
- Metropolitan Grey Lightweight-Ply Countertops
- Stainless Steel Utility Hooks
- Bottle Opener
- Black Satin Faucet/Door Pulls (where applicable)
- High Performance Vinyl Furniture
- 2-Burner Glass Recessed Cook Top
- Black Stainless Steel Sink (where applicable)
- Pleated Shades
- USB Charging Station
- Lamilux 1000 Fiberglass Exterior
- Featuring Satin Matte Graphics
- (Some Features N/A 19 Series)

### OVERLANDER PACKAGE

- Standard RVT Track (Rhino Rack #RTV148)
- Two Vortex Bars (Rhino Rack #VA180B)
- J-Cradle Kayak Holder (Rhino Rack #S510)
- Wheel Step/Seat (Rhino Rack #RWS)
- Satin Matte Finish 6-Lug Wheels
- Wrapped in All Terrain Tires

### BACK COUNTRY PACKAGE

- Custom Front Fiberglass Protective Shell
- Featuring Tempered Seamless Panoramic Window
- Roof Mounted Solar Prep
- 13.5 BTU Low Profile Air Conditioning
- Power Awning
- Rear Ladder
- Azdel Exterior Construction

### OPTIONAL EQUIPMENT

- Stainless Steel Convection Microwave Oven
- 28" LED Flat Screen 12V TV
- Power Tongue Jack w/LED Light
- Cold Weather Package
- Central Vacuum System
- Hybrid Single Bike Carrier (Rhino Rack #RBC050)
- Snowboard/Ski/Fishing Rod/Paddle Holder (Rhino Rack #573)
- J-Cradle Kayak Holder (Rhino Rack #S510)
- One Standard Kayak Holder in Overlander PKG
- Solar Package (110 Watt Panel/  
Digital Controller/1000 Watt Inverter)
- 15K A/C IPO 13.5K A/C
- Sofa IPO Gaucho (19.5/19.8 only)

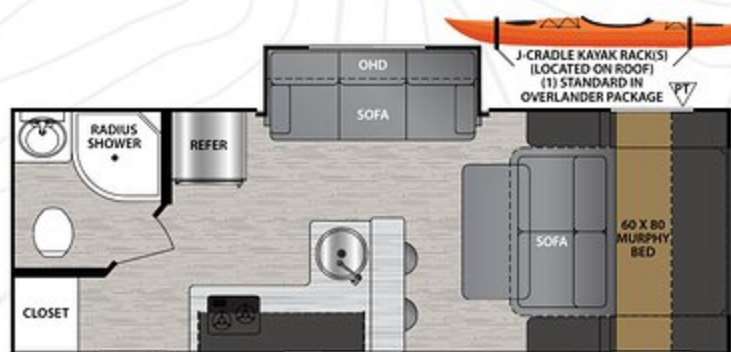

NB19.6

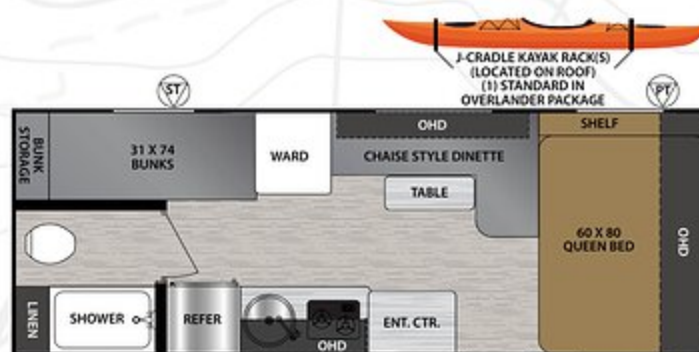

NB19.7

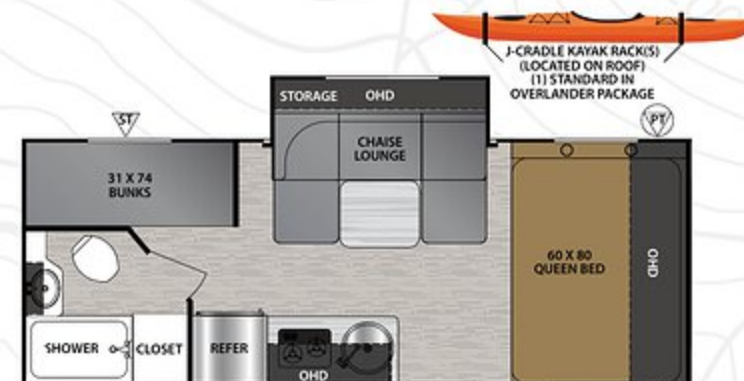

NB19.8





NB19.1



NB19.1



TO THOSE WITH  
NO BOUNDARIES



Peter H.  
Salmon River, ID



Andrew J.  
Raymond, ME



Jason K.  
Flagstaff, AZ



Juan A.  
Padre Island



Jessie S.  
Mountain Lake, VA



Geoff R.  
Nordegg, AB Canada



Chris C.  
Lavender Lake, WA

**GVWR (Gross Vehicle Weight Rating)** - is the maximum permissible weight of the unit when fully loaded. It includes all weights, inclusive of all fluids, cargo, optional equipment and accessories. For safety and product performance do NOT exceed the GVWR.

**GAWR (Gross Axle Weight Rating)** - is the maximum permissible weight, including cargo, fluids, optional equipment and accessories that can be safely supported by a combination of all axles.

**UVW (Unloaded Vehicle Weight)\*** - is the typical weight of the unit as manufactured at the factory. It includes all weight at the unit's axle(s) and tongue or pin and LP Gas. The UVW does not include cargo, fresh potable water, additional optional equipment or dealer installed accessories.

\*Estimated Average based on standard build optional equipment.

**CCC (Cargo Carrying Capacity)\*\*** - is the amount of weight available for fresh potable water, cargo, additional optional equipment and accessories. CCC is equal to GVWR minus UVW. Available CCC should accommodate fresh potable water (8.3 lbs per gallon). Before filling the fresh water tank, empty the black and gray tanks to provide for more cargo capacity.

\*\* Estimated average based on standard build optional equipment.

Each Forest River RV is weighed at the manufacturing facility prior to shipping. A label identifying the unloaded vehicle weight of the actual unit and the cargo carrying capacity is applied to every Forest River RV prior to leaving our facilities. The load capacity of your unit is designated by weight, not by volume, so you cannot necessarily use all available space when loading your unit.



### PRE-DELIVERY INSPECTION FACILITY

20,000 square feet of quality assurance. The bare essentials for a premium product. This state-of-the-art facility gives immediate daily feedback to production for quality assurance in every unit built.

**FREE MEMBERSHIP**  
to Forest River Owners' Group



www.forestriverfrog.com

**CUSTOMER SATISFACTION**

**FOREST RIVER**  
encourages you to

**BUY LOCAL**



**PREFERENTIAL SERVICE**      **PRODUCT INFORMATION**

www.Forest River Buy Local.com

**24/7 EMERGENCY  
ROADSIDE ASSISTANCE  
WITH VEHICLE PURCHASE\***

TOWING	WINCH-OUT
JUMP-STARTS	MOBILE MECHANIC
TIRE CHANGES	TECHNICAL
FLUID DELIVERY	SUPPORT
LOCKOUT SERVICE	DEALER LOCATOR SERVICES



\*VALID FOR 1 YEAR FROM DATE OF PURCHASE

Your local **NOBO** dealer



**Forest River Owner "Digital Kit" App**  
Now you can have your Owner's Manual with you wherever you are. Download our FREE App from the App Store or Google Play and you'll have the information right at your fingertips.

 Find us on  
**Facebook**

No Boundaries Division  
Forest River, Inc.  
1702 Century Dr.  
Goshen, IN 46528  
(574) 642.3119

www.forestriverinc.com/nobo  
www.forestriveraccessories.com



Learn More  
Scan this barcode using a QR Reader on your smart phone to learn more about Forest River.



A Berkshire Hathaway company.

All information contained in this brochure is believed to be accurate at the time of publication. However, during the model year, it may be necessary to make revisions and Forest River, Inc., reserves the right to make all such changes without notice, including prices, colors, materials, equipment and specifications as well as the addition of new models and the discontinuance of models shown in this brochure. Therefore, please consult with your Forest River dealer and confirm the existence of any materials, design or specifications that are material to your purchase decision. 12/19

©Copyright 2019 Forest River Inc - All Rights Reserved.