

Sea Breeze EX

Fabrics



CHEYENNE



LAGOON

Woods



OAK

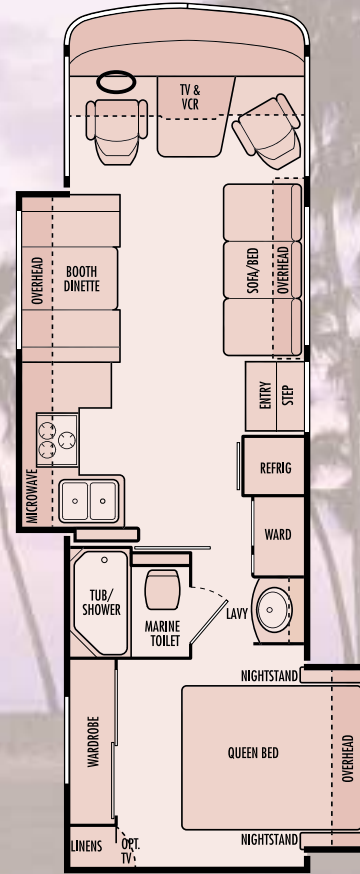

8311

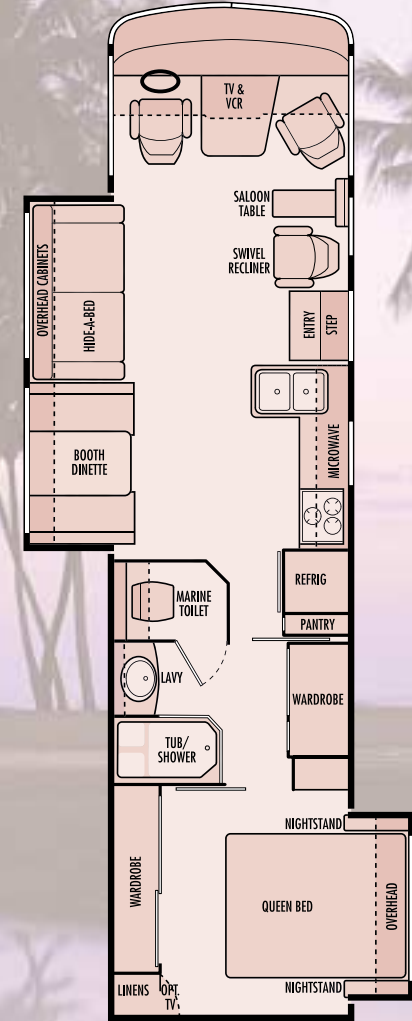

8341



Due to continued product improvement, National R. V., Inc. reserves the right to change materials, colors, specifications and prices at any time without notification. Copyright © 2001 by National R. V., Inc. 12/01

SEA BREEZE LX FEATURES & SPECIFICATIONS

BODY CONSTRUCTION

Duraframe® patented steel sub floor construction
 Steel framed laminated floor
 Steel framed crowned laminated fiberglass roof
 Steel framed laminated fiberglass high gloss walls
 Front and rear molded fiberglass caps
 High impact Centrex® front and rear bumpers
 Full panoramic tinted windshield
 Soft fabric ceiling material
 Electric slide-out room with overhead cabinets
 (flush floor on lounge slide models only)
 High impact Centrex® exterior storage compartment
 doors with integrated latches and gas struts
 One-piece rotocast polyethylene storage compartments
 Lighted storage compartments and service area
 Exterior assist handle
 Aluminum rear ladder
 Awning rail/rain gutter with drip spouts
 Spare tire and wheel
 Automotive undercoating
 Custom vinyl exterior graphics

COCKPIT FEATURES

AM/FM stereo and CD with four speakers
 Driver and passenger map light with switch on dash
 Custom dash with full gauge package
 Convenience tray
 Audible turn signals
 Pantographic windshield wipers
 Power steering
 Cruise control
 Tilt steering wheel
 Rear vision system with built-in microphone
 Overhead dash fans (two speed)
 Power heated rear view mirrors with convex
 Driver and passenger recliner seats
 Passenger work station with 12V/120V receptacle and
 telephone jack in console
 Aviation style sun visors
 Hydraulic leveling jacks with dash mounted controls
 Generator hour meter and auxiliary switch on dash
 Wraparound privacy curtain with easy reach wand

APPLIANCES & ACCESSORIES

8 cu. ft. double door refer
 Three burner cook top with flush mount Corian®
 range cover
 Over-the-counter microwave oven with built-in range
 hood, lights and fan
 Systems monitor panel
 Cable TV hook-up and telephone jack
 TV antenna and booster
 19" color TV with remote control in living area
 and bedroom
 Video control box
 Hair dryer with nightlight (mounted in bathroom)

INTERIORS

Throughout Coach

Solid oak cabinet doors and drawer fronts
 Telestrut hardware on overhead doors and positive
 catches on others
 Ball bearing roller drawer guides

Living Area

74" Wonder-Bed sleeper sofa (8311) or
 68" hide-a-bed sofa (8341)
 Deluxe rocker recliner with swivel base (8341)
 Booth dinette with slide-out storage drawers
 Deluxe nylon carpet and pad
 Day/night shades with designer valances
 Solid oak raised panel cabinet doors in overheads

Kitchen Area

Corian® kitchen countertop with Corian® flush mount
 stove cover
 Sink cover (wood cutting block)
 Porcelain sink with single lever faucet
 Waste basket
 Armstrong® vinyl flooring
 Venetian mini-blinds and valances (8341)

Bath Area

Armstrong® vinyl flooring
 Decorative opaque shower glass etching
 Flat panel doors
 Laminate bathroom lavy top with woodgrain edge
 Medicine cabinet
 Towel bars

Bedroom Area

Deluxe nylon carpet and pad
 Venetian mini-blinds and valances
 Flat panel doors
 Wardrobe with mirrored sliding doors
 Color coordinated bedspread, pillows and shams
 Radius padded headboard
 Slide-out queen bed with under bed storage bay
 Laminate top nightstands with woodgrain edge

ELECTRICAL SYSTEMS & LIGHTS

50 Amp MagneTek® power converter and charger
 50 Amp 120V distribution panel and cord
 Generac® 5.5 kW generator
 Two 6V deep cycle house batteries (217 amp/hour)
 Battery disconnect switch for house batteries
 Porch light with interior switch
 110V patio receptacle
 Incandescent lights in ceiling
 Adjustable reading lights
 Designer lights in living and bedroom areas
 Cosmetic light in bathroom
 GFI protected electrical circuit
 Entry step light

PLUMBING & LPG SYSTEMS

Coach Exterior

Heated systems compartment with easy access to hook-ups
 Demand water system and water pump
 Holding tank rinse system (black tank only)
 Winterization antifreeze inlet to pump
 Outside shower
 Water heater by-pass valve
 Pressurized water fill
 Six gallon LPG water heater with electric ignition (DSI)

Kitchen Area

Decorative kitchen and bath faucets

Bath Area

One-piece fiberglass tub/shower
 Glass shower door and enclosure

SAFETY FEATURES

Extra large double convex rear view mirrors
 Driver and passenger three point lap and shoulder seatbelts
 Deadbolt lock on entry door
 Fire extinguisher
 Smoke, carbon monoxide (CO) and LPG detectors
 Egress window(s)

WINDOWS, DOORS & AWNINGS

Radius tinted safety glass windows (sliding windows
 in living area and jalousie windows in kitchen
 and bedroom)
 Radius entrance door with clear glass, shade and
 screen door
 Electric double entry step with light
 Slide-out rooms topper awnings*
 Tinted skylight in bathroom (8341)

HEATING, VENTS & AIR CONDITIONING

Thermostatically controlled dual 13,500 BTU ducted
 roof A/Cs
 35,000 BTU electronic ignition furnace
 Ducted heating system
 12V Fan-Tastic® Vent with wall thermostat and rain
 sensor in galley/living area
 12V roof exhaust fan in bathroom
 Dash automotive heating and A/C system with
 defroster

OPTIONAL FEATURES

Coach Exterior

Dual pane windows
 Patio awning with metal cover*

Cockpit Area

JVC® VCR with remote control
 JVC® DVD player (replaces VCR)
 Ten disc CD changer

Living Area

Dining table with two wooden and two folding
 chairs (8341)

Kitchen Area

21" high output three-burner range with oven
 (surface mounted)
 Convection microwave oven with carousel, built-in light
 and fan
 12V Fan-Tastic® Vent with wall thermostat and rain
 sensor in galley/living area

CHASSIS SPECIFICATIONS

FORD

Chassis	Ford® Super Duty (22,000 GWR)	
Tires	Goodyear® RV 245/70R 19.5F	
Wheels	19.5X6, 8-lug steel, SS liner	
Brakes	Hydro-Boost, 4-wheel disc ABS	
Drive Axle gear Ratio	5.38:1	
Alternator	115 Amp	
Chassis Batteries	(1) 750 CCA	
Shock Absorbers	Tuned Bilstein®	
Fuel Capacity	75 gallon	
Hitch Capacity	5,000 lb. Class III	
Chassis Warranty	3 years/36,000 miles	
Engine	Ford® Triton V-10	
Displacement	6.8 liters (415 cu. in.)	
Peak Horsepower	310 HP @ 4,250 RPM	
Peak Torque	425 lb.-ft. @ 3,250 RPM	
Engine Warranty	3 year/36,000 miles	
Transmission	Ford® 4R100	
Transmission Type	4-speed automatic overdrive	
Transmission Warranty	3 years/36,000 miles	

WEIGHTS (POUNDS)	8311	8341
Gross Vehicle Weight Rating	22,000 lbs.	22,000 lbs.
Gross Combined Weight Rating	26,000 lbs.	26,000 lbs.
Front Gross Axle Weight Rating	7,000 lbs.	7,000 lbs.
Rear Gross Axle Weight Rating	15,000 lbs.	15,000 lbs.
Unloaded Vehicle Weight	15,840 lbs.	16,820 lbs.
Maximum Carrying Capacity	6,160 lbs.	5,180 lbs.
Cargo Carrying Capacity	4,851 lbs.	3,680 lbs.
MEASUREMENTS	8311	8341
Overall Length	31' 8"	34' 11"
Overall Height (Road Height)	11' 8"	11' 8"
Interior Height	79½"	79½"
Interior Width	98½"	98½"
Exterior Width	102"	102"
Wheelbase	208"	228"
TANK CAPACITIES	8311	8341
Water Heater (Gas/Electric)	6 gal.	6 gal.
Gray Tank	60 gal.	60 gal.
Black Tank	50 gal.	50 gal.
Fresh Water Tank(s)	100 gal.	100 gal.
LPG Tank (Volume W.C.)	24.2 gal.	24.2 gal.

*Not available on CSA units