



RIVERSIDE RV



# EXPLORER

Unlock Your Wanderlust

[GORIVERSIDERV.COM](http://GORIVERSIDERV.COM)



Specifications	Riverside Explorer												
	511	135	135FD	165	171DRD	179	185RK	190BH	210	211	240BH	245RB	290BH
Model	511	135	135FD	165	171DRD	179	185RK	190BH	210	211	240BH	245RB	290BH
Length	12'8"	15'9"	15'9"	16'4"	21'8"	20'3"	21'6"	20'6"	22' 11"	24' 1"	27'5"	24'11"	31'11"
Total Dry Weight (LBS)	1540	2780	2500	2860	3,545	3220	3300	3415	4540	3700	5020	4980	5380
Hitch Weight (LBS)	160	160	200	340	420	440	440	420	380	440	420	560	700
CCC (LBS)	1040	880	1000	980	985	1200	1140	1005	2840	3740	2400	2580	2320
Width	88"	90"	90"	90"	96"	96"	96"	96"	96"	96"	96"	96"	96"
Height Including A/C RETRO	8'2"	10'1"	10'1"	10'1"	10'1"	10'1"	10'1"	10'1"	10'10"	10'10"	10'10"	10'10"	10'10"
Interior Height	4'10"	6' 3"	6'5"	6' 3"	6'5"	6'5"	6'5"	6'5"	6'5"	6'5"	6'5"	6'5"	6'5"
# of Axles	1	1	1	1	1	1	1	1	2	2	2	2	2
Axle Weight Rating	2500	3500	3500	3500	4000	4000	4000	4000	3500	3500	3500	3500	3500
Tire Size	15"	15"	15"	15"	15"	15"	15"	15"	15"	15"	15"	15"	15"
Awning Length	6'	6'	6'	6'	11'	11'	15'	11'	11'	11'	17'	17'	16'
Furnace (BTU)	20K	20 K	20 K	20 K	20K	20 K	20 K	20 K	30 K	30 K	30 K	30 K	30 K
A/C (BTU)	15K	15K	15K	15K	15K	15K	15K	15K	15K	15K	15K	15K	15K
Fresh Water (GAL)	17	36	36	36	36	36	36	36	36	36	36	36	36
Gray Water (GAL)	N/A	30	30	30	36	36	36	36	36	36	36	36	36
Black Water (GAL)	N/A	30	30	30	30	30	30	30	30	30	30	30	30
Bed Size	44"x72"	60 X 76	44 X 80	60X76	60 X 76	60X76	60X76	60X76	60X77	60X76	60X76	60X76	60X76
ESTIMATED	GVWR= AXLE(S) + HITCH				DRY WEIGHT=TARE WEIGHT				CCC= GVWR-TARE WEIGHT				

# STANDARDS & FEATURES

\* Indicates the item was added in late model year 2023 or new for 2024

## Xplorer Package (Mandatory)

Azdel Vacuum Bonded Laminated Walls  
Off-Road Tires  
Upgraded Aluminum Wheels  
Xplorer Graphics Package  
Gran Oak Interior Color  
Enclosed Underbelly (Dbl Axle Only)  
Hide-A-Bed Sleeper Sofa (where available)  
Solar Power (100w on 511, 190w all other models)

## Value-Added Standards

- \* GE 15k Rooftop Air Conditioner
- \* Electric Fireplace (Dbl Axle Models - n/a 211)
- \* Friction Hinge Entry Door
- \* Indratech High Performance Mattress
- \* Kolding Gray Décor
- \* Hardwood Gran Oak Cabinet Doors
- \* Roller Blinds
- \* Upgrade Black Faucets
- \* Gas Quick Disconnect
- \* Full Overhead Cabs w/ Doors over Bed ipo Shelf
- \* Increased Under Bed Storage Area (select models)
- \* Standard GE Appliances
- 12v Refer, Gas Range (where available), Microwave
- \* Black Interior Door and Cabinet Hardware
- \* Sink Covers
- \* Enlarged Cargo Doors

- \* Slam Latch on Cargo Doors
- \* Magnetic Latch Catches on Cargo Doors
- \* A-Frame Side Mount for Spare Tire (511, 135 and 135FD only)
- \* 78" Sidewall Height on all models except 511
- \* Optional Rear Awning (135 and 135FD)

## Convenience Package (Mandatory)

Aluminum Side, Front and Rear Wall Construction  
Powder Coated Chassis  
12v Power Converter  
Tinted Safety Glass Windows  
Alpha Super Flex Roof System with Limited Lifetime Warranty  
Outside Shower  
Diamond Plate Rock Guard  
Radial Tires  
Interior and Exterior LED Lighting  
FM/Bluetooth Stereo  
High Speed Bath Fan  
USB Ports  
Solar Plugin  
Backup Camera Prep  
Front and Rear Stabilizer Jacks  
Inside and Outside Speakers  
HD TV Antenna  
Smoke Detector  
C/O Detector  
2 - 20# LP Tanks w/Cover (n/a 511, 135, 135FD)

1 - 20# LP Tank (511, 135, 135FD)  
Range Hood w/Light and Fan  
Electric Brakes  
Cable/Satellite Hook-Up  
GE Microwave  
Black Tank Flush (n/a 511)  
3-Burner Range w/Oven (Select Models)  
\* Solid Flip-Down Steps (N/A 511)  
Residential Backsplash  
Roof Rack/Entry Step (511 Only)

## Additional Standards & Features

Fully Integrated A-Frame  
15" Tires  
Dexter Axles  
Reinforced Galvanized Steel Wheel Well  
5/8" T&G Plywood Floor  
3/8" Decking for Full Walk-On Roof  
Seamless Countertops  
Power Awning w/LED Light  
Power Tongue Jack (n/a 511)  
Medicine Cabinet (select models)  
30amp Service  
Outside Kitchen (select models)  
Foot Flush Toilets (n/a 511)  
6gal Gas/Electric Water Heater  
Gas Furnace  
Entry Door Grab Handle  
Bathroom Skylight (n/a 511)  
Bed, Bunks & Dinettes - 3/8" OSB w/Supports

## Xplorer 511

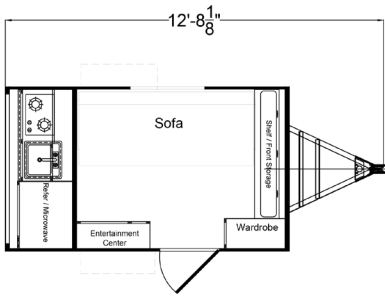

## Xplorer 135

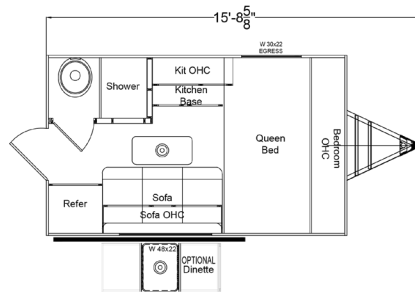

## Xplorer 135FD

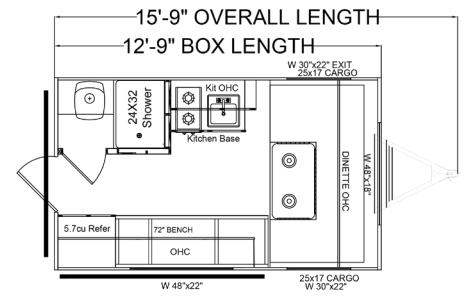

## Xplorer 165

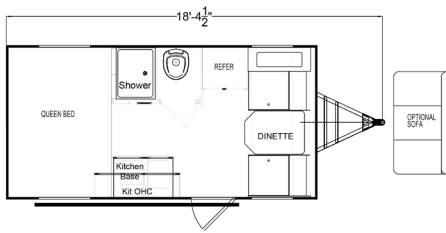

## Xplorer 171RD

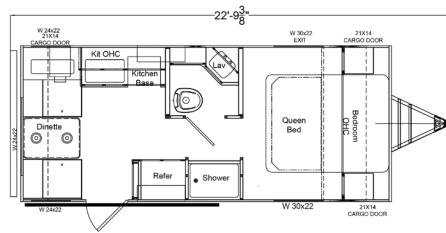

## Xplorer 179

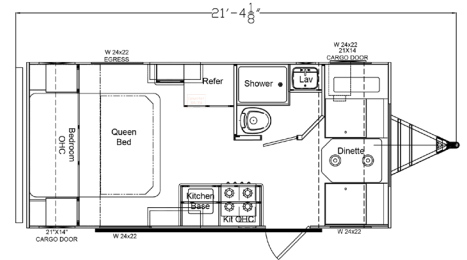

## Xplorer 185RK

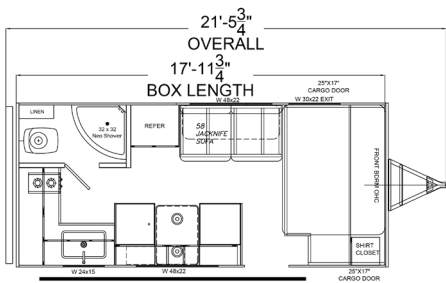

## Xplorer 190BH

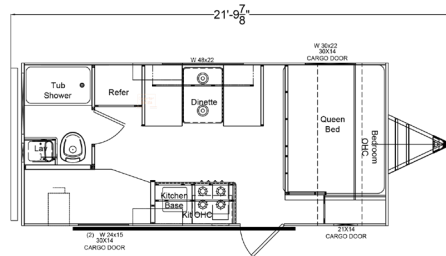

## Xplorer 210

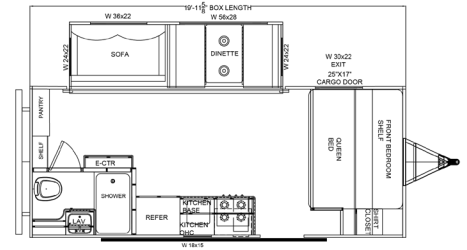

## Xplorer 211

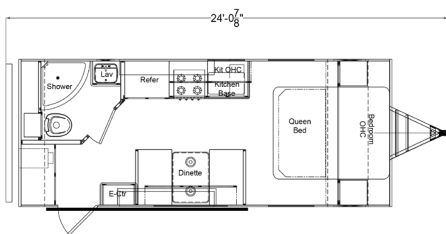

## Xplorer 240BH

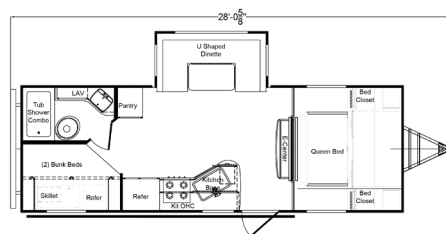

## Xplorer 245RB

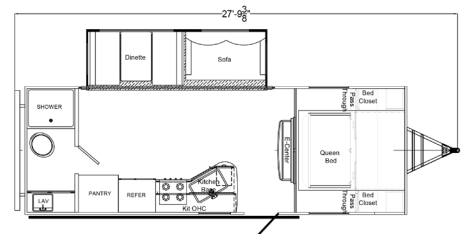

## Xplorer 290BH

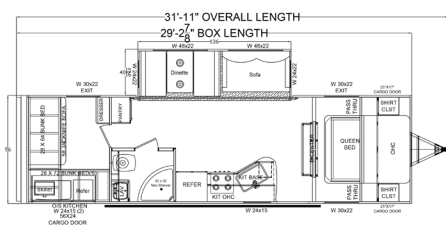

goriversiderv.com  
(260) 499-4578