

# LANCE







## QUALITY TAKES TIME

The word *quality* is thrown around a lot these days. We know because we have been in business since 1965. Many things have changed over the years and while we certainly have evolved, we have always focused on maintaining our values.

The culmination of our 55-year journey is reflected in our current ultra-light Travel Trailer line featuring our computer designed and cut automated manufacturing process with composite construction materials and an emphasis on green manufacturing.

*We've put in the time... so you can spend quality time.*







**2465** shown in *Mystic Shores*





**2075** shown in Royal





**2075** with optional exterior rear kitchen and mountain scene graphics.





**2445** Flush mounted speaker and reading light



**2445**



**2445**





2445 shown in Java



2445





**1985** shown in *ROADSTER*



**1685** shown in *PASSAGE*

# MAPLE

1685 | 1985 | 1995 | 2185  
2285 | 2295 | 2375 | 2465



**2375** shown in *MYSTIC SHORES*



# DRIFTWOOD

1475 | 1575 | 2075 | 2445



**1575** shown in *ROYAL*



**1475** shown in *PLATINUM*



**2445** shown in *JAVA*



## AVAILABLE AMENITIES



60" X 80" Residential Queen Beds



Exterior Kitchens



Comfortable Chairs



Bunk Beds

## SPECIFICATIONS, STANDARDS & OPTIONS

	1475	1575	1685	1985	1995	2075	2185	2285	2295	2375	2445	2465
Floor Length	14' 10"	15' 9"	16' 6"	18' 9"	19' 2"	20' 3"	21' 2"	22' 6"	22' 6"	23' 6"	24' 11"	24' 11"
Overall Length	20' 4"	21' 1"	21' 0"	23' 3"	23' 8"	24' 9"	25' 8"	27' 0"	27' 0"	28' 0"	29' 5"	29' 5"
Overall Length w/Optional Ladder	N/A	N/A	21' 5"	23' 8"	24' 1"	25' 2"	26' 1"	27' 5"	27' 5"	28' 5"	29' 10"	29' 10"
Width (Exterior)	84 3/8"	84 3/8"	96 3/8"	96 3/8"	96 3/8"	96 3/8"	96 3/8"	96 3/8"	96 3/8"	96 3/8"	96 3/8"	96 3/8"
Height (Exterior) w/Optional A/C	9' 10"	9' 10"	10' 1"	10' 2"	10' 2"	10' 2"	10' 2"	10' 2"	10' 2"	10' 2"	10' 4"	10' 4"
Height (Interior)	78"	78"	78"	78"	78"	78"	78"	78"	78"	78"	78"	78"
Dry Weight* – Overall Weight	2600	2775	3980	4245	4265	4450*	4565	4930	4840	5030	5525	5875*
Axle Weight* – Towed Weight	2350	2530	3555	3695	3875	4010*	3810	4295	4160	4430	4970	5210*
Hitch Weight* – Hauled Weight	250	245	425	550	390	440*	755	635	680	600	555	665*
Cargo Capacity* – Gear	1100	925	1520	1455	1435	1450*	1435	1470	1560	2370	2075	1925*
Available Axle Capacity**	1150	970	2245	2105	1925	1790*	2390	1905	2040	3370	2830	2590*
GAWR (Per Axle)	3500	3500	2900	2900	2900	2900	3100	3100	3100	3900	3900	3900
GVWR	3700	3700	5500	5700	5700	5900	6000	6400	6400	7400	7600	7800
Fresh Tank (Gal)	26	26	45	45	45	45	45	45	45	45	45	45
Gray Tank (Gal)	26	26	45	45	45	45	45	2/45	45	45	2/45	45
Black Tank (Gal)	26	26	45	45	45	45	45	45	45	45	45	45
Propane Tank (#/Gal)	1/5	1/5	2/5	2/5	2/5	2/5	2/5	2/5	2/5	2/5	2/5	2/5
Sleeping Capacity (Min./Opt. Max.)	2/3	4	5	4	4	4	7	4/6	4	4/5	8	5
Convertible Dinette Bed	Opt. 36" x 59"	46" x 78"	54" x 78"	54" x 78"	54" x 78"	40" x 80"	54" x 78"	54" x 78"	54" x 78"	42" x 78"	42" x 78"	42" x 70"

\* Estimates

\*\* When looking at cargo capacity you must consider the hitch weight of the trailer and axle capacity. Hitch weight is actually being hauled while the remaining Trailer weight on the axle(s) is being towed. Example if a trailer has a total weight of 4000 pounds with a 400 pound hitch weight that would mean 3600 pounds is on the axle(s). If the axle weight rating is 5200 for this unit you will have 1600 of axle capacity for cargo



Optional Sofa Bed





1995



2075



2185



2285



2295



2375



2445

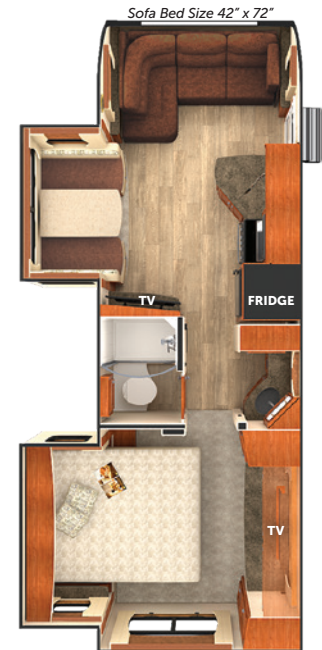

2465



# SPECIFICATIONS, STANDARDS & OPTIONS

	1475	1575	1685	1985	1995	2075	2185	2285	2295	2375	2445	2465	Weight (lbs.)
<b>EXTERIOR</b>													
Mountain Scene Graphics	0	0	0	0	0	0	0	0	0	0	0	0	
Laminated Fiberglass Bonded Exterior w/Azdel Substrate	•	•	•	•	•	•	•	•	•	•	•	•	
Manual Tongue Jack	•	•	•	•	•	•	•	•	•	•	•	•	
Manual Stabilizer Jacks w/Foot Pad	•	•	•	•	•	•	•	•	•	•	•	•	
Electric Stabilizer Jacks w/Foot Pad			0	0	0	0	0	0	0	0	0	0	20
Electric Tongue Jack (Smart Jack)	0	0	0	0	0	0	0	0	0	0	0	0	24
Lift Kit (2 5/8")	0	0	0	0	0	0	0	0	0	0	0	0	13/26
Aluminum Wheels w/Goodyear Radial Tires	14"	14"	15"	15"	15"	15"	15"	15"	15"	15"	15"	15"	
Spare Tire Carrier w/Wheel Lug Wrench	•	•	•	•	•	•	•	•	•	•	•	•	
Car Cord/Safety Chain Storage Holder	•	•	•	•	•	•	•	•	•	•	•	•	
Spare Tire	0	0	0	0	0	0	0	0	0	0	0	0	42-47
Double Step - 24" (*2 ea.)	•	•	•	•	•	•	•	•	•	•	•	•	
Slow-Step Revolution - 25"	0	0	0	0	0	0	0	0	0	0	0	0	17
Courtesy Entry Step Well Lighting - LED	•	•	•	•	•	•	•	•	•	•	•	•	
Aerodynamic Front Section Profile	•	•	•	•	•	•	•	•	•	•	•	•	
Fiberglass Front Wrap w/Formed TPO Lower Gravel Guard and LP Tank Cover	•	•	•	•	•	•	•	•	•	•	•	•	
Formed Jewel LED Docking Lights	•	•	•	•	•	•	•	•	•	•	•	•	
Rear TPO Eyebrow w/Formed Vertical Side Pillars and Integrated LED Lighting	•	•	•	•	•	•	•	•	•	•	•	•	
Radius "Full Torque" Frameless Tinted Insulated Dualpane Windows (Tempered)	•	•	•	•	•	•	•	•	•	•	•	•	
Radius Acrylic Tinted Thermopane Euro Windows	•	•				•							
Large Curved Tinted Front Picture Window (Laminated)													•
Large Curved Acrylic Tinted Thermopane Front Euro Window	•	•	•	•	•	•	•	•	•	•	•	•	
Slide-Out End Wall Window(s)			•	•	•	•	•	•	•	•	•	•	
Ladder		0	0	0	0	0	0	0	0	0	0	0	10
Roof Rack System		0	0	0	0	0	0	0	0	0	0	0	35
LED Tail Lights	•	•	•	•	•	•	•	•	•	•	•	•	
LED License Plate Light w/Holder	•	•	•	•	•	•	•	•	•	•	•	•	
Radius Cornered Storage Compartment Doors	•	•	•	•	•	•	•	•	•	•	•	•	
Slam Latch on Pass-Thru Storage Compartment Door	•	•	•	•	•	•	•	•	•	•	•	•	
Keyed-Alike Entry and Storage Compartment Doors	•	•	•	•	•	•	•	•	•	•	•	•	
Radius Entry Door w/Tinted Insulated Dualpane Window and Strut Hinge	•	•	•	•	•	•	•	•	•	•	•	•	
Keyless Entry	0	0	0	0	0	0	0	0	0	0	0	0	
Roof Vent in Bed Area	•	•	•	•	•	•	•	•	•	•	•	•	
Roof Vent in Living Area	•	•	•	•	•	•	•	•	•	•	•	•	
Skylight in Galley/Dinette Area	•	•	•	•	•	•	•	•	•	•	•	•	
Exterior Wash Station	•	•	•	•	•	•	•	•	•	•	•	•	
Exterior Kitchen					0						0		TBD
Exterior Propane Connection	•	•	•	•	•	•	•	•	•	•	•	•	
48" Portable Folding Table w/Built-In Exterior Storage Feature	•	•	•	•	•	•	•	•	•	•	•	•	
Exterior LCD Mounting Puck w/Removable LCD Bracket	•	•	•	•	•	•	•	•	•	•	•	•	
Utility Receiver (1 1/4") (130lb Limit)		0	0	0	0	0	0	0	0	0	0	0	25
Swing-Out Entry Assist Handle	0	0	•	•	•	•	•/2	•/2	•	•/2	•	•	1
Pull-Out Storage Tray	0	0	0	0	0	0	0	0	0	0	0	0	34
Awning Slide-Out Cover		0	0	0	0	0	0	0	0	0	0	0	16-32
Electric Awning 12' 0" w/LED Lighting	0	0											48
Electric Awning 13' 0" w/LED Lighting			0										50
Electric Awning 16' 0" w/LED Lighting				0	0	0							55
Electric Awning 16' 0" / 6' 2" OTD (Over the Door) w/LED Lighting												0	85
Electric Awning 18' 0" w/LED Lighting							0						58
Electric Awning 19' 0" w/LED Lighting								0	0				60
Electric Awning 20' 0" w/LED Lighting										0	0		62
Backup Camera w/Wireless Monitor	0	0	0	0	0	0	0	0	0	0	0	0	2

## CONSTRUCTION/INSULATION

	1475	1575	1685	1985	1995	2075	2185	2285	2295	2375	2445	2465	Weight (lbs.)
One-Piece Roof	•	•	•	•	•	•	•	•	•	•	•	•	
Tapered Exterior Roof Design	•	•	•	•	•	•	•	•	•	•	•	•	
Laminated, Insulated Floor and Ceiling	•	•	•	•	•	•	•	•	•	•	•	•	
Block Foam Insulation Throughout	•	•	•	•	•	•	•	•	•	•	•	•	
Aluminum Framed Sidewalls	•	•	•	•	•	•	•	•	•	•	•	•	
Aluminum Framed Floor and Ceiling	•	•	•	•	•	•	•	•	•	•	•	•	
Azdel Interior Panel Walls	•	•	•	•	•	•	•	•	•	•	•	•	
All Weather Package	0	0	0	0	0	0	0	0	0	0	0	0	32-40
-Enclosed, Insulated and Heated Holding Tanks													
-Insulated Hatch Covers													
-Water Heater Bypass and Winterizing Valve (*WH Bypass Valve)	*	*				*							

## INTERIOR/DECOR

Interior - Passage			0	0	0		0	0	0	0		0	
Interior - Roadster		0	0	0			0	0	0	0		0	
Interior - Mystic Shores			0	0	0		0	0	0	0		0	
Interior - Platinum		0	0			0						0	
Interior - Java		0	0			0						0	
Interior - Royal		0	0			0						0	
Sofa Bed w/Kick Out Foot Rests								•					
Sofa Bed (Slide-Out)		0											185
J-Lounge										0			98
Swivel Rockers (1 Swivel Rocker / 1 Swivel Only - 1475 Model)	•/2						0/2			•/2			20
Surf-X Pseudo Solid Surface Lightweight Countertops and Tables	•	•	•	•	•	•	•	•	•	•	•	•	
Hardwood Framed Flat Panel Cabinet Doors (Shaker Styling)	•	•	•	•	•	•	•	•	•	•	•	•	
Decorative Pull Cabinet Hardware	•	•	•	•	•	•	•	•	•	•	•	•	
Euro-Ply Cabinet Construction	•	•	•	•	•	•	•	•	•	•	•	•	
Valance Boxes w/Lambrequins			•	•	•	•	•	•	•	•	•	•	
Valances Attached to Interior Window Treatment	•	•				•							
Mini-Blind(s) in Galley							•	•	•	•	•	•	
Day/Night Shades in Dinette and Bedroom w/Slow-Rise Feature				•	•	•	•	•	•	•	•	•	
Combo Screen/Shade on Windows	•	•											
Entry Door Pull Shade			•	•	•	•	•	•	•	•	•	•	
Hidden Trash Can Compartment									•	•	•	•	
Wall Clock	•	•	•	•	•	•	•	•	•	•	•	•	
Key Hanger	•	•	•	•	•	•	•	•	•	•	•	•	

## GALLEY/APPLIANCES & EQUIPMENT

"Flush Mount" Stainless Steel 3-Burner Range w/Black Glass Cover	•	•	•	•	•	•	•	•	•	•	•	•	
"Flush Mount" Stainless Steel 3-Burner Range w/Oven - 21" Oven	0	0	0	0	0		0	0	0	0	0	0	44
"Flush Mount" 2-Burner Stainless Steel Euro Cooktop w/Glass Cover							•						
Stainless Steel "Flat Bed" Microwave Oven	0	0	0	0	0	0	0	0	0	0	0	0	40
Refrigerator (Cu Ft) 2-Way Double Door (Dometic = 7 Cu. Ft. / Norcold = 6 Cu. Ft.)		7	7	7	7	7	7	7	7	6	7	7	
Refrigerator (Cu Ft) 3-Way Double Door	5	5											
Matte Black Refrigerator Door Panels			•	•	•	•	•	•	•	•	•	•	
Furnace BTU	14.3K	14.3K	25K	25K	25K	14.3K	25K	25K	25K	25K	25K	25K	
Tri-Five Propane Tank (Third 5 Gal. Tank w/Holddown)		0	0	0	0	0	0	0	0	0	0	0	41
Stainless Steel Range Hood w/Light & Fan	•	•	•	•	•	•	•	•	•	•	•	•	
"Euro" Overhead Cabinetry Design w/Accent Puck LED Lighting	•	•	•	•	•	•	•	•	•	•	•	•	
Backsplash	•	•	•	•	•	•	•	•	•	•	•	•	
Folding Galley Extension				•				•					



	1475	1575	1685	1985	1995	2075	2185	2285	2295	2375	2445	2465	Weight (lbs.)
Single Stainless Steel Sink (Round)						•							
Single "Undermount" Sink (Round)	•	•											
Residential "Undermount" Large Single Sink			•	•	•		•	•	•	•	•	•	
Residential Single Lever Galley Faucet w/Pull-Out Sprayer	•	•	•	•	•	•	•	•	•	•	•	•	
Sink Cover(s)	•	•	•	•	•	•	•	•	•	•	•	•	
Magazine and Spice Racks			•	•	•	•	•	•	•	•	•	•	

### FRESH AND WASTE WATER SYSTEMS

Water Pump w/In-Line Filter	•	•	•	•	•	•	•	•	•	•	•	•	
Water Heater Gas/Electric/DSI			•	•	•	•	•	•	•	•	•	•	
Water Heater Gas/Electric w/Boost Mode Feature (Truma Combi Eco)	•	•				•							
Tankless Water Heater			0	0	0		0	0	0	0	0	0	
Enclosed, Insulated and Heated Fresh Water Tank	•	•	•	•	•	•	•	•	•	•	•	•	

### BATHROOM

Marine Toilet - Foot Pedal - Porcelain			•	•	•	•	•	•	•	•	•	•	
Marine Toilet - Foot Pedal - Plastic			•										
Marine Toilet - Hand - Plastic	•												
Black Tank Flush	•	•	•	•	•	•	•	•	•	•	•	•	
Residential "Undermount" Oval Lavy Sink	•	•	•	•	•	•	•	•	•	•	•	•	
Residential "Vessel" Lavy Sink						•						•	
High Rise Single Lever Faucet			•	•	•	•	•	•	•	•	•	•	
Tub			•										
Shower Pan	•	•	•	•	•	•	•	•	•	•	•	•	
Adjustable Slide Bar Shower Head Assembly		•	•	•	•	•	•	•	•	•	•	•	
Medicine Cabinet w/Mirror Door	•	•	•	•	•	•	•	•	•	•	•	•	
Mirror on Bath Door	•	•	•	•	•	•	•	•	•	•	•	•	
Folding Lavy Extension						•	•						
Towel Rod on Wall	•	•	•	•	•	•	•	•	•	•	•	•	
Towel Ring			•	•	•	•	•	•	•	•	•	•	
Residential Radius "Glass" Shower Door Enclosure												•	
Residential Radius "Soft" Shower Door Enclosure				•	•	•	•	•	•	•	•	•	
Soft Radius Panel Shower Enclosure	•	•	•	•	•								
Shower Curtain w/Tieback		•											
Skylight - Dual Pane	•	•	•	•	•	•	•	•	•	•	•	•	
Ducted Heat	•	•	•	•	•	•	•	•	•	•	•	•	

### DINETTE

Dinette w/Locking Pull-Out Storage Drawers			•	•	•	•	•	•	•	•	•	•	
U-Shaped Dinette w/Euro Telescoping/360 Degree Adjusting Table Top						•							
Roll-Out Storage Drawers	0												19

### BEDROOM

Deluxe Queen Innerspring Mattress w/Pillow Top	•	•	•	•	•	•	•	•	•	•	•	•	
Deluxe King Innerspring Mattress w/Pillow Top													•
Bedsread w/Throw Pillows	•	•	•	•	•	•	•	•	•	•	•	•	
Convertible Sofa/Queen Bed			0	0		0							72
Bunk Beds (250 lbs. weight limit)						•/3					•/2		
Bedmaid	0	0	0	0	0	0	0	0	0	0	0	0	14
Overhead Cabinet Bunk			•										
Fold-Up Bunk Bed(s)						•					•		
LED Reading Lights	•	•	•	•	•	•	•	•	•	•	•	•	

	1475	1575	1685	1985	1995	2075	2185	2285	2295	2375	2445	2465	Weight (lbs.)
LED Mood Lighting				•	•	•	•	•	•	•	•	•	
Privacy Curtain			•	•	•	•	•	•	•	•	•	•	
Privacy Divider Door(s)						•			•	•	•	•	

### ELECTRICAL

iN-Command						•						•	
Systems Monitor Panel	•	•	•	•	•	•	•	•	•	•	•	•	
12V/USB Charging Port(s)	•	•	•	•	•	•	•	•	•	•	•	•	
Battery Condition Indicator - LED	•	•	•	•	•	•	•	•	•	•	•	•	
Lithium Battery (Up to 2)	0	0	0	0	0	0	0	0	0	0	0	0	34 ea.
Battery Controller					0							0	
1500W Inverter					0						0		TBD
60 Amp Converter/Loadcenter			•	•	•	•	•	•	•	•	•	•	
45 Amp Converter/Loadcenter	•	•											
LED Interior Lighting - Ceiling	•	•	•	•	•	•	•	•	•	•	•	•	
LED Interior Lighting - Under Overheads	•	•	•	•	•	•	•	•	•	•	•	•	
Decorative LED Lighting - S/O Ceiling			•	•	•	•	•	•	•	•	•	•	
Storage Compartment Lighting	•	•	•	•	•	•	•	•	•	•	•	•	
Single Battery Compartment	•	•											
Locking Dual Battery Compartment			•									•	
Locking Dual Battery Compartment w/Sliding Tray				•	•	•	•	•	•	•	•	•	
Battery Disconnect - Manual	•	•	•	•	•	•	•	•	•	•	•	•	
Wall Switched Lighting	•	•	•	•	•	•	•	•	•	•	•	•	
LED Vanity Lighting Over Medicine Cabinet	•	•	•	•	•	•	•	•	•	•	•	•	
Pre-Wired for Roof A/C													
A/C - Dometic 10K Low Profile w/Wall Control	0	0	0	0	0	0	0	0	0	0	0	0	98
A/C - Coleman 13.5K w/Wall Control	0	0	0	0	0	0	0	0	0	0	0	0	98
A/C - Coleman 13.5K w/Wall Control (Dual A/C)												0	196
A/C - Coleman 15K w/Wall Control	0	0	0	0	0	0	0	0	0	0	0	0	98
Wall Thermostat	•	•	•	•	•	•	•	•	•	•	•	•	
Pre-Wired for Fantastic Vent	•	•	•	•	•	•	•	•	•	•	•	•	
Fantastic Roof Vent w/Remote	0	0	0	0	0	0	0	0	0	0	0	0	10
Power Roof Vent in Bath	•	•	•	•	•	•	•	•	•	•	•	•	
Pre-Wired for TV Ant/Park/Sat Cable	•	•	•	•	•	•	•	•	•	•	•	•	
TV Antenna HD	•	•	•	•	•	•	•	•	•	•	•	•	
AM/FM/DVD Stereo w/Bluetooth App	•	•	•	•	•	•	•	•	•	•	•	•	
Portable Bluetooth Speaker	•	•										•	
TV 24" (12 Volt) - Main Area							0						14
TV 28" (12 Volt) - Main Area	0	0	0			0							16
TV 32" (12 Volt) - Main Area				0			0	0	0	0	0	0	20
TV 40" (12 Volt) - Main Area												0	25
TV 19" (12 Volt) - Bedroom							0						12
TV 24" (12 Volt) - Bedroom												0	14
TV 28" (12 Volt) - Bedroom								0		0			16
TV 40" (12 Volt) - Bedroom												0	40
Electric Fireplace								0		0	0	0	26
LED Patio Light - Switched	•	•	•	•	•	•	•	•	•	•	•	•	
LED Hitch Light - Switched	•	•	•	•	•	•	•	•	•	•	•	•	
Solar on the Side Pre-Wire (Receptacle)	•	•	•	•	•	•	•	•	•	•	•	•	
Solar Panel Pre-Wire	0	0	0	0	0	0	0	0	0	0	0	0	2
Solar Panel/ 190W (Up to 2)	0	0	0	0	0	0	0	0	0	0	0	0	25 ea.
Exterior 12V/120V Patio Outlet and Entertainment Coax Cable Receptacle	•	•	•	•	•	•	•	•	•	•	•	•	

Option Weights – All weights are estimates and may vary. • = Standard Option 0 = Optional Feature



# STANDARD FEATURES



Rear bumper storage compartment provides space for your sewer hose or camp chairs. 2075



Portable Bluetooth speaker keeps the tunes rolling in or out of the trailer. (1475, 1575, 2075, 2445)

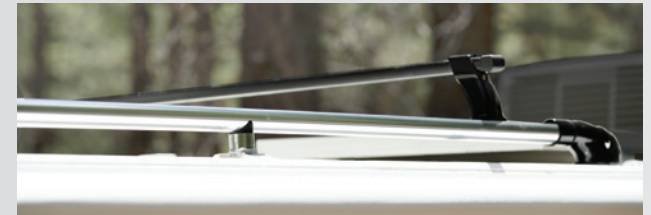

Exclusive Lance Load roof rack system safely stores your canoe, kayak, paddle boards...etc. - NA 1475 & 1575



iN-Command brings smart home technology to your RV by connecting you with many of the systems through an app. (2075, 2445)



Exterior kitchen w/dual burners & sink take cooking duties outside. - 2295



Lance Life 4' exterior table. We all need one & this one doesn't waste space. N/A 1475, 1575, 2465



Dometic Penguin II 10K low profile a/c runs on 2,200w generator allowing for off the grid cooling.



Walk on roof allows for worry free maintenance. N/A 1475 & 1575



100% LED lighting brightens your trailer and is easy on your power supply.



Electric cord and chain caddy. Keep these items off the ground.



Electric fireplace provides ambiance & radiant heat. - 2295, 2445, 2465



Battery digital display monitors battery statistics like amp-hours consumed, state of charge, and voltage.



Large lockable dinette storage drawers utilize residential dovetail construction for strength. - N/A 1475, 1575, 2075



Magnetic exterior latches stay in place for hands free access.



Aluminum wheels & nitrogen filled USA manufactured Goodyear radial tires keep the good times rolling.



Convertible sofa bed turns your 60"x80" queen size bed into a comfortable couch. - Available 1985, 1995, 2075, 2185



# OPTIONAL FEATURES



Latitude power awning provides unobstructed shade with direct response wind sensor & LED light bar.



Pull out front storage tray organizes & provides easy access to your gear. - N/A 2465



Mountain Scene graphics give you a fresh look inspired by adventure.



Electric stabilizer jacks with foot pads make set up & teardown sweat free, keeping your trailer rock solid while parked. - N/A 1475 & 1575



Backup camera w/color display and sound makes backing up a safer, one-person job.

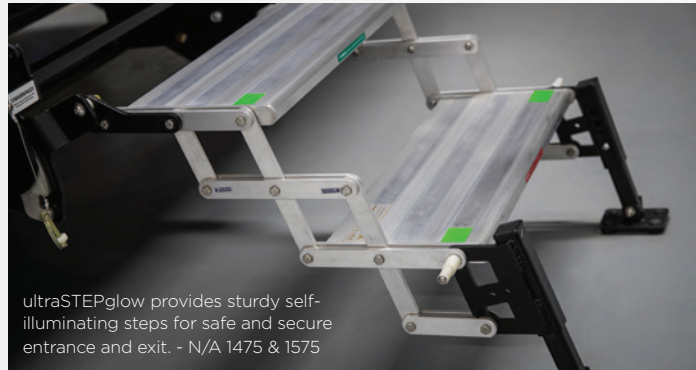

ultraSTEPglow provides sturdy self-illuminating steps for safe and secure entrance and exit. - N/A 1475 & 1575



1 1/4" receiver gives you another area to haul your gear including bikes, skis, snowboards, etc. - Limit 130 lbs. - N/A 1475 & 1575



Tri-Five LP tanks allows extended off the grid use while an aerodynamic cover protects & conceals. - N/A 1475 & 1575



Keyless entry lets you adventure out without having to worry about your keys when you enter your trailer using a personalized code.



Lance exclusive Bed-Maid System with removable sheets & summer/winter sides provide a warm laundry friendly bedding alternative.



# DESIGN & CONSTRUCTION

- A.** The roof is made of energy-star rated Polyvinyl Chloride (PVC) material with vents that clamp in place, eliminating screws and potential leaks. Integrated rain gutters and drip spouts prevent the sides of your trailer from streaking.
- B.** Rigid block foam insulation yields maximum "R" value and promotes structural strength.
- C.** Interior walls and cabinetry are constructed of Euro-Ply. This superior product is lighter, formaldehyde free and stronger. Providing both beauty and durability.
- D.** Keeping it all together are stainless steel fasteners. Unlike our competitors, this expensive hardware resists corrosion making for a lasting investment.
- E.** High gloss TPO lower front gravel guard with jewel LED lighting is both beautiful and resilient to the abuses of the road while protecting this section of the chassis.
- F.** All seals use an anti-wicking material to prevent moisture from transferring to the laminate walls.
- G.** Lance uses more expensive Azdel™ in place of Luan wood, virtually eliminating mold and mildew. It's also lighter, carcinogen and formaldehyde free and has better "R" value for superior insulation.
- H.** Lance's aluminum framed superstructure provides for an extremely solid trailer that is also lightweight.
- I.** Heavy duty rubber torsion-bar suspension axles allow for independent articulation, providing a better towing experience off-road in addition to featuring EX-lube bearing and self-adjusting brakes for easy maintenance.
- J.** Engineered super lightweight, powder coated, tempered steel custom chassis Huck bolt construction eliminates weak and rust-prone welds.
- K.** Slideout rooms feature smooth, dependable operation. Lighter in weight than other mechanisms, they're also smaller, allowing for more living space.
- L.** The slick, high gloss fiberglass exterior walls are laminated under intense pressure with heat-setting adhesives for years of trouble-free service.

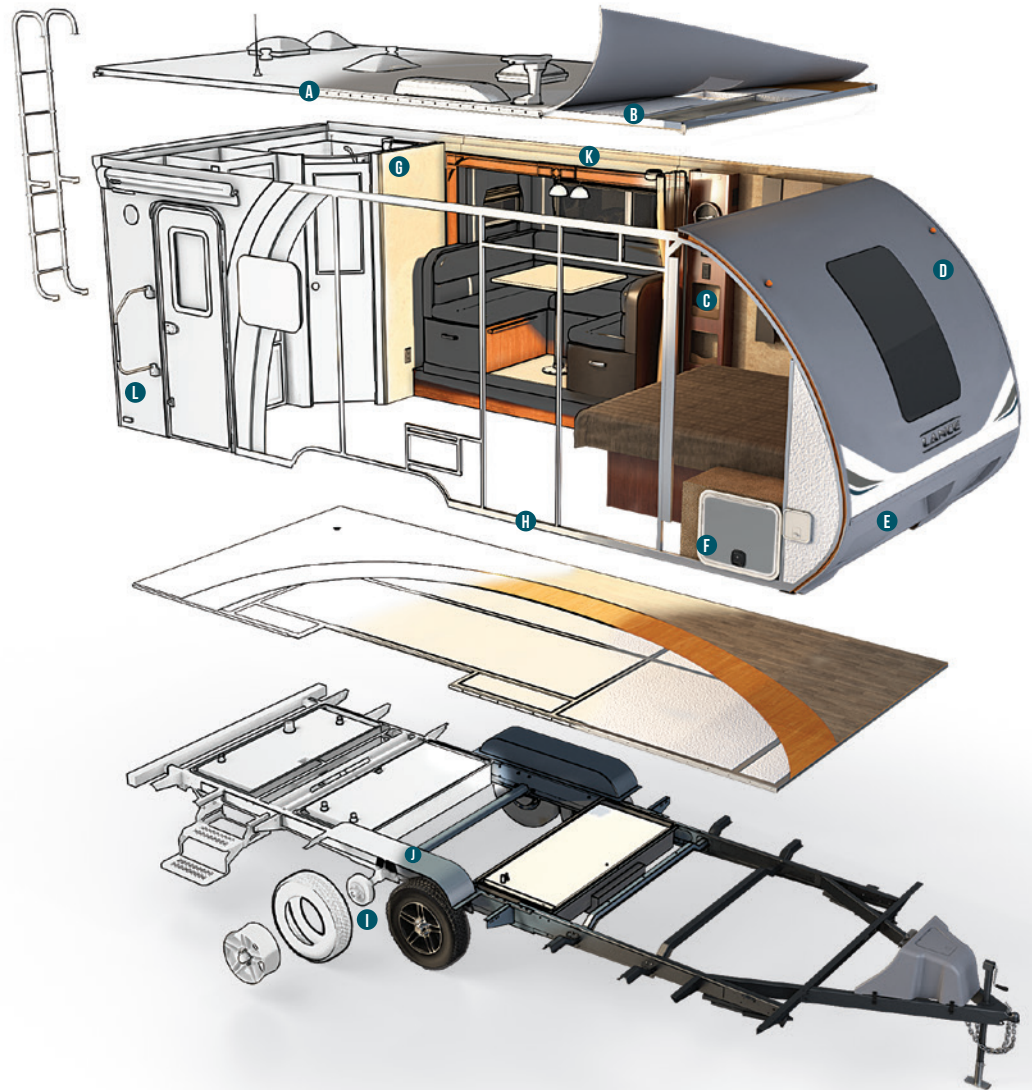

# AWARDS



# ECO-SMART RV CONSTRUCTION

Lance RVs are certified green based on an evaluation of our RV manufacturing facility, procedures and practices. Measured against criteria based on national consensus standards including resource efficiency, energy efficiency, water efficiency & indoor air quality.

**CERTIFIEDGREENRVS.COM**



# BOONDOCKING & OFF GRID CAMPING



Optional 2 5/8" lift kit offers additional ground clearance for your off the pavement adventures.



Optional 190w roof mounted solar panel (up to 2) keeps you and your accessories charged.



Standard torsion axle provides independent articulation of each tire allowing for a smoother ride.



Standard Solar on the Side SAE port accepts external aftermarket solar panels to keep your 12v system charged.



Optional lithium battery (up to 2) brings cutting edge battery technology to your RV.



Optional 1500w inverter allows your battery-based system to run conventional appliances by inverting 12V DC to create 120V AC output. (2075, 2445)



Standard HSLA e-coated frame protected against the mud, dirt and elements.

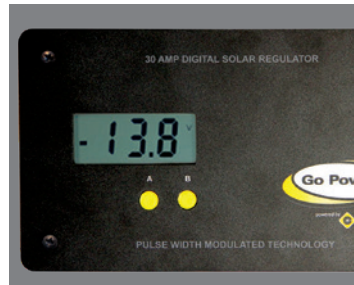

Optional solar panel charge monitor and automatic controller keep you informed. -Included with panel(s).



Portable generator storage compartment complete with tie down strap.



# 4 SEASONS CERTIFIED ALL WEATHER PACKAGE (OPTIONAL)

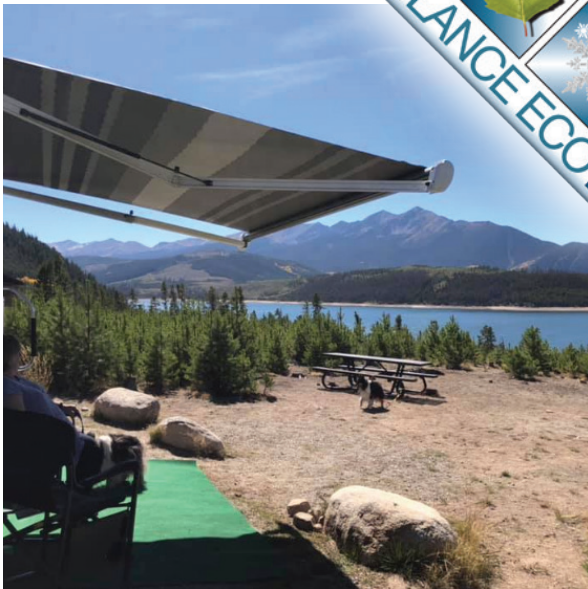
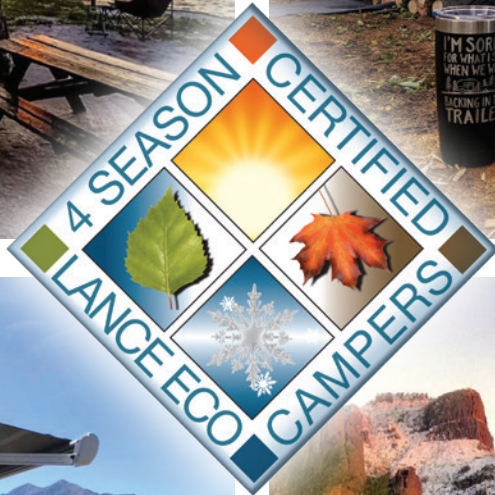

## KEY FEATURES

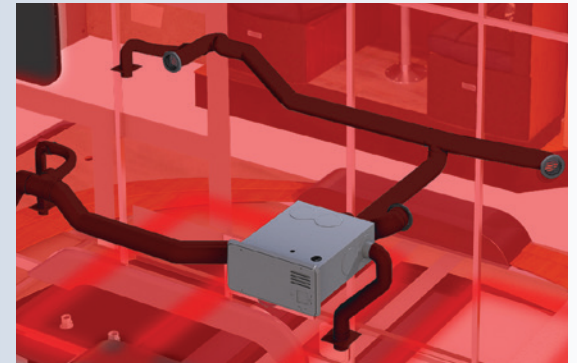

**Ducted heat** is routed into individually insulated holding tanks to keep them, the valves and PEX lines warm.



**Water heater bypass & winterizing valves** make draining the system for winter storage a breeze.



**Insulated hatch covers** add an additional layer of insulation to vents and sky lights.



# CALCULATING TOWED WEIGHT AND CARRYING CAPACITY

These are general guidelines to use when matching a trailer to your tow vehicle, assuming standard equipment on your trailer. Whether any travel trailer can be used with your vehicle and its capacities for carrying and/or towing is affected by how much optional equipment is added to the trailer, and the weight of passengers and all other items you carry in your tow vehicle and trailer.

To get an approximate weight of the model of your choice equipped with the optional features you are considering, the “Build Yours” feature at lancecamper.com is a great resource. Because we’re unfamiliar with your tow vehicle, Lance makes no warranties or representation – expressed or implied – as to performance or reliability of your tow vehicle with a Lance trailer. For professional guidance, always consult with your Factory Authorized Lance Dealer. They’re trained in calculating proper matches between tow vehicles and trailers.

## 3,500 POUND TOW RATING



Models: 1475, 1575

## 6,000 POUND TOW RATING



Models: 1475, 1575, 1685, 1985, 1995, 2075, 2185, 2285, 2295

## 5,000 POUND TOW RATING



Models: 1475, 1575, 1685, 1985, 1995

## 7,000 POUND TOW RATING



Models: 1475, 1575, 1685, 1985, 1995, 2075, 2185, 2285, 2295, 2375, 2445, 2465

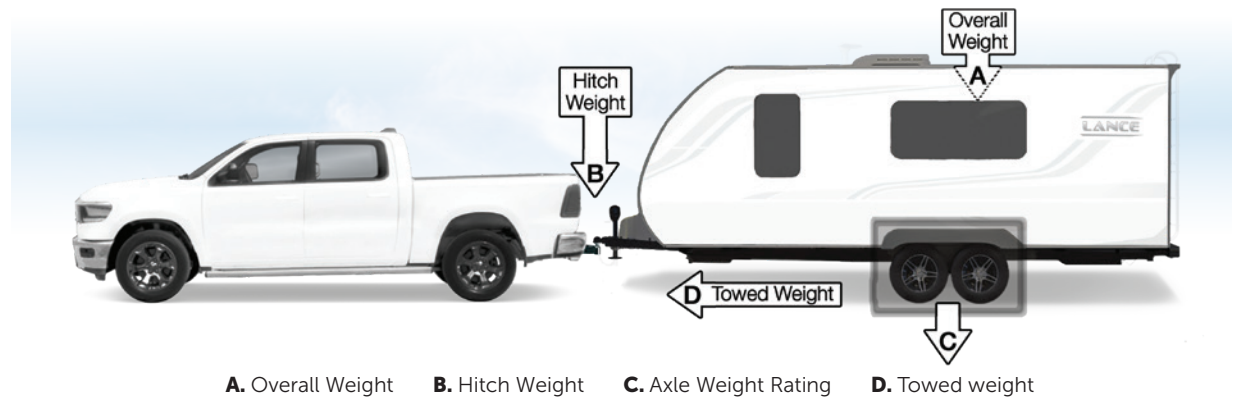

Hitch weight is actually being **hauling** while the remaining trailer weight is being **towed**.

Cargo capacity must also consider hitch weight as well as axle weight rating.

### A - B = D

**Ex:** If a trailer has an overall weight of 4k lbs. with 400 lbs. of hitch weight that would mean 3600 lbs. is on the axles and being towed. (4,000 – 400 = 3,600 or **D. Towed Weight**)

### C - D = Cargo Capacity

**Ex.** If the axle weight rating is 5200 (2600 each x 2) for this unit you will have 1600 lbs. of axle capacity for cargo. (5,200 – 3,600 = 1,600 or **Cargo Capacity**)





2020 LANCE TRAVEL TRAILER BROCHURE ©2019 Lance Camper Mfg. Corp. (LCMC). All rights reserved. Lance, the Lance logomark, the Lance logomark with chevron, The Lance Lock, Lance Custom Design, Bed-Maid, LanceLock, ultraDECKplus, ultraSTEPplus, ultraSTEPglow, Discover The Lance Difference, Skyview, Lance Load, Lance Life, LIVE. LANCE. LIFE., REV Group® and other exclusive Lance product names, marks or designations are trademarks, service marks or registered trademarks of LCMC. All other marks are property of their respective owners. **All product data, graphics and photography, illustrations and/or renderings in this book were as accurate as possible at press time. Subsequent refinements during the model year may be evident in the actual product. LCMC reserves the right to change prices, colors, materials, equipment and specifications without notice – as well as to add, modify or discontinue models shown in promotion materials and/or on its websites.** All weights, fuel and liquid capacities are approximate and dimensions are nominal. It is the owner's sole responsibility to select the proper Lance model, tow vehicle and tow equipment for safe operation. Your Factory Authorized Lance Dealer can advise you of the operating parameters for your particular configuration, and can confirm prices and product specifications material prior to making your purchase decision. See website for full warranty information. GVWR (Gross Vehicle Weight Rating) is the maximum permissible weight of this fully loaded RV. Axle Rating is the maximum permissible loaded weight a specific axle is designed to carry. Overall length is measured from tip of the hitch to rear bumper (excludes accessories). Excludes safety equipment and awnings. Actual propane capacity is 80% of water listing as required by the safety code. Brochure printed in the USA on FSM paper. 20K, 12/19, Rev. 2.5.

**2**YEAR  
STRUCTURAL LIMITED  
WARRANTY

**12**YEAR  
ROOF LIMITED  
WARRANTY

Please see [lancecamper.com/](http://lancecamper.com/)  
warranty for details.

The information provided in this brochure applies to all product manufactured after September 2019.