

**DSI**  
Annual RVDA DEALER  
SATISFACTION INDEX  
AWARD WINNER  
8 YEARS IN A ROW

# Cougar *Lite*



**TRAVEL TRAILERS AND FIFTH WHEELS**



 **Keystone RV  
Company**



# Cougar *by Keystone* **Lite**

At the heart of Cougars philosophy is the belief that if we listen to our customers, and execute accordingly, the crucial combination of quality, design, weight, luxury and price, is to offer an unparalleled product. A product that will provide the finest means for families, both young and old, to create memories year after year! From growing families, to full timers, Cougar vows to provide the top travel trailer and fifth wheel floor plans and features to suit each dynamic, and maximize their unique camping experience. Growing with Cougar from a mid-level travel trailer, to a 38 foot fifth wheel, is our forte! By avoiding fads and trends, we have been able to focus more on innovation, quality, style and affordability. These attributes are what our customers rely on, and appreciate, and are the hallmarks of America's #1 selling brand. Cougar is the choice of yesterday, today and tomorrow!

Cougar remains focused on the growing popularity of lightweight luxury vehicles, and the ease of tow ability. We have ongoing commitment to create a stress free journey for all who choose to explore with us. We make it our goal that our current customers choose us for each of their subsequent voyages. *Come grow with us and explore the country in a Cougar RV! Where you are always a step ahead, and luxury and lightweight meet!*



*Since 1998,  
Cougar has been the pinnacle of excellence in the RV industry,  
earning the DSI award for 8 consecutive years. Come find out why...*

THE DSI (DEALER SATISFACTION INDEX) AWARD RATES THE LEVEL OF SATISFACTION THE DEALERS HAVE IN A MANUFACTURER. IT RATES MANUFACTURERS IN MANY AREAS SUCH AS: PRODUCT DESIGN, PRODUCT RELIABILITY & QUALITY, WARRANTY SUPPORT, AND PARTS SUPPORT.





## **COUGAR X-LITE TRAVEL TRAILERS**

---

Continuing to grow in floorplans and features, X-Lite travel trailers are engineered to give you more for your money while focusing on staying lightweight and budget friendly.



**PAGES 6-11**



## **COUGAR X-LITE FIFTH WHEELS**

---

Taking the quality of a Cougar and matching it with the size and weight your vehicle can tow! X-Lite Cougar offers multiple 1/2 ton towable fifth wheel floorplans.



**PAGES 12-19**





# *Lite* EXECUTIVE PACKAGE

The Cougar X-Lite Executive Package includes solid surface countertops and frameless windows.

*Available on all X-Lite travel trailers and fifth wheels.*

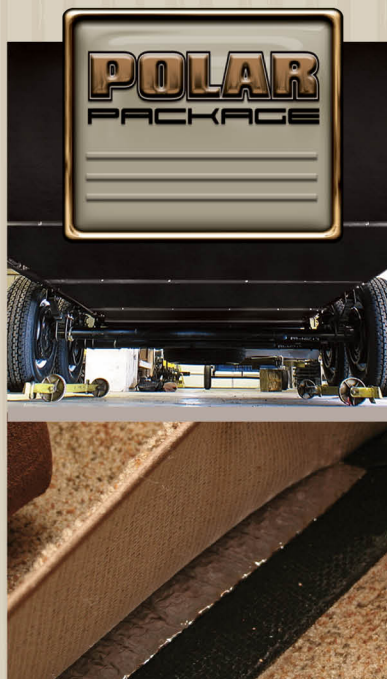

## **POLAR PACKAGE**

The Cougar X-Lite Polar Package expands your camping season with an enclosed and heated underbelly. Not only will you have improved aerodynamics, but your valves, tanks and water lines are all protected.

We also add upgraded insulation to our slide-out floors to control the hot and cold exchange.



### **COUGAR HAS EARNED THE DSI AWARD AN UNPRECEDENTED 8 YEARS IN A ROW!**

THE DSI (DEALER SATISFACTION INDEX) AWARD RATES THE LEVEL OF SATISFACTION THE DEALERS HAVE IN A MANUFACTURER. IT RATES MANUFACTURERS IN MANY AREAS SUCH AS: PRODUCT DESIGN, PRODUCT RELIABILITY & QUALITY, WARRANTY SUPPORT, AND PARTS SUPPORT.





**Cougar Platinum Series Ortho-Pedic Sleep System**



**The X-Lite docking station provides a convenient location for many of your set-up needs.**



**Cougar slam baggage doors offer added security and convenience while providing better insulation.**



**X-Lite vaulted ceiling add more head room without effecting overall unit height (TT only).**

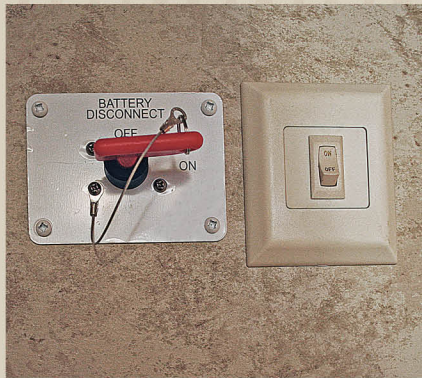

**BATTERY DISCONNECT**



**LED lighting throughout**



**OPTIONAL FIREPLACE (28SGS, 29RLI, 29RET, 30RLI, 33RES)**



**Raised panel hardwood cabinet doors**



**Cougar X-Lite comes outfitted with a black tank flush hook-up. This feature keeps the black tank clean and trouble free.**



**BLUETOOTH STEREO. Also includes: AM/FM, MP3, AUX INPUT, USB PORT, DVD/CD PLAYER**

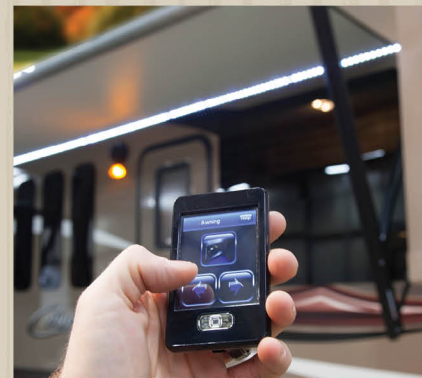

**Setting up and taking down your awning is easier than ever with the all new Cougar adjustable LED lighted awning.**



**The multi-functional pop-up dinette table offers ease of use both inside and outside.**



*Cougar*  
by Keystone  
**Lite**

COUGAR X-LITE TRAVEL TRAILERS



## **TRAVEL TRAILERS**

Continuing to grow in floorplans and features, X-Lite travel trailers are engineered to give you more for your money while focusing on staying lightweight and budget friendly.

6



26RBI SHOWN IN PLATINUM DECOR



26RBI SHOWN IN PLATINUM DECOR





**OPTIONAL FREE-STANDING DINETTE**



**8 CU. FT.  
FRIDGE  
ON ALL  
MODELS**

**PLENTY OF REFRIGERATOR STORAGE**



**STAINLESS STEEL SINK**



**28RLS SHOWN IN PLATINUM DECOR**



**26RBI ENTERTAINMENT CENTER**

**COUGAR X-LITE TRAVEL TRAILERS**





## X-LITE DURABLE CONSTRUCTION

- |   |                                      |
|---|--------------------------------------|
| 1 Gel Coated Filon Exterior                       | 13 Moisture Barrier Wrap             |
| 2 Luan Layer                                      | 14 Step Light on Frame               |
| 3 Hi-Density Block Foam Insulation (Sidewall R-7) | 15 Underbelly Heat Duct              |
| 4 Interior Wallboard                              | 16 PACO I-Beam Frame                 |
| 5 5 Side Welded Aluminum Super Structure          | 17 One Piece T.P.O. Roof             |
| 6 BeauFlor® Flooring                              | 18 Roof Decking                      |
| 7 Carpet Padding                                  | 19 R-14 Fiberglass Batten Insulation |
| 8 1st Layer Floor Decking                         | 20 5" Crowned / Stamped Roof Trusses |
| 9 2nd Layer Floor Decking with Staggered Seams    | 21 Sloped Slide Roof                 |
| 10 Hi-Density Block Foam Insulation (Floor R-9)   | 22 Wiper Seals                       |
| 11 Aluminum Floor Studs                           | 23 Bulb Seal in T-Track              |
| 12 3rd Layer Floor Decking                        | 24 Aerodynamic Painted Front Cap     |
|   | 25 EZ Lube Axles                     |
|   | 26 Radius Entry Steps                |

## FLOOR (R-9)

- Aluminum Studded Laminated Floor
- 3" Large Capacity Insulated Heat within Floor
- Heated and Enclosed Underbelly
- 1/4 Polypropylene Underbelly Guard
- 2" Heat Duct Into Underbelly
- Heated and Enclosed Water Lines, Dump Valves and Tanks
- Welded Steel Cross Members
- Woven Moisture and Vapor Barrier
- Hi-Density Block Foam Insulation (R-9)
- Beauflor Flooring





X-Lite travel trailers have a stylish painted front cap that offers both style and convenience with E-Z access LP, wide cavity battery access and LED docking lights.



# COUGAR X-LITE FEATURES

## CORRECT TRACK ALIGNMENT SYSTEM:

- With Correct Track, the trailer tows with the tow vehicle, not against it
- Tires run smoother and cooler
- Improves fuel economy
- Helps preserve the life of the RVs equipment, appliances, etc
- Dramatically improves tire life





# X-LITE TRAVEL TRAILER FLOORPLANS

COUGAR X-LITE TRAVEL TRAILERS

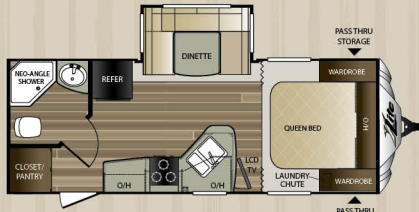

**21RBS**

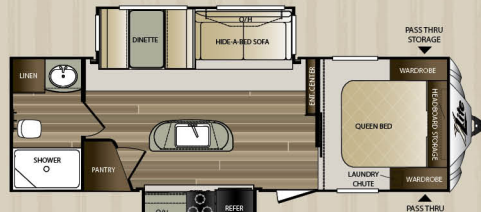

**26RBI**



**28RLS**

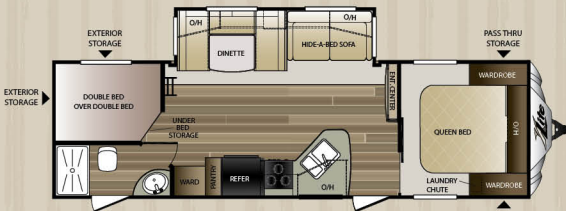

**28RBS**

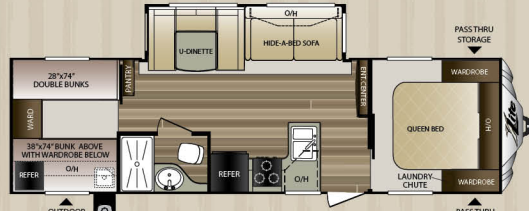

**29RBK**

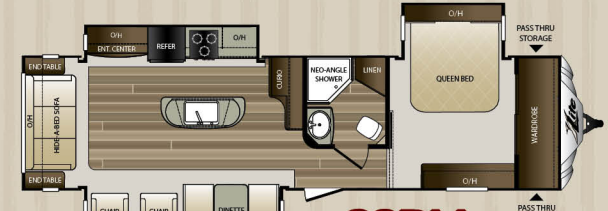

**30RLI**

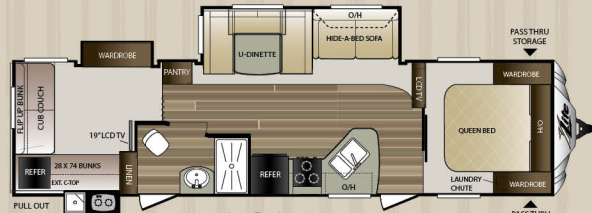

**31SQB**

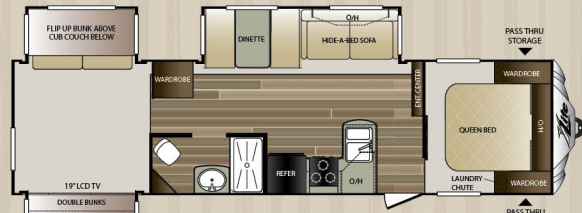

**32ROB**

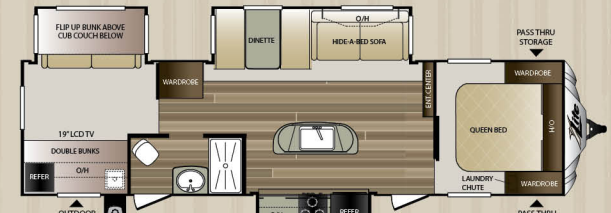

**33RBI**

## SPECIFICATIONS

MODEL	21RBS	26RBI	28RLS	28RBS	29RBK	30RLI	31SQB	32ROB	33RBI	33RES
SHIPPING WEIGHT	5276	6030	6396	6369	6618	7715	7290	TBD	7892	7900
CARRYING CAPACITY	1924	1770	1404	1831	1582	1785	1710	TBD	1608	1600
HITCH WEIGHT	580	710	780	955	835	1055	935	TBD	1065	970
EXTERIOR LENGTH	25' 9"	30' 2"	31'	32' 2"	33'	36'	35' 11"	36'	36'	36'
EXTERIOR WIDTH	8'	8'	8'	8'	8'	8'	8'	8'	8'	8'
EXT. HEIGHT - A/C TOP	11' 4"	11' 4"	11' 4"	11' 4"	11' 4"	11' 4"	11' 4"	11' 4"	11' 4"	11' 4"
FRESH WATER (GAL.)	43	43	43	43	43	43	43	43	43	43
WASTE WATER (GAL.)	28	28	28	28	28	28	28	28	28	28
GRAY WATER (GAL.)	28	56	56	56	28	56	56	56	56	56
LP CAPACITY (LBS.)	60	60	60	60	60	60	60	60	60	60
AWNING LENGTH	16'	19'	20'	19'	17'	12'	19'	19'	19'	14'

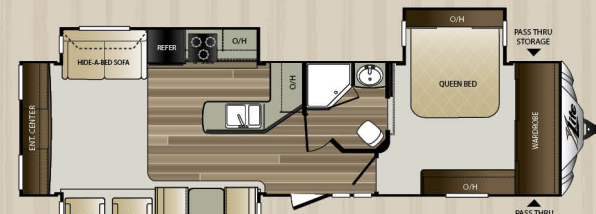

**33RES**

Product information is as accurate as possible as of the date of publication of this brochure. Features, floor plans, and specifications are subject to change without notice. Please also consult Keystone's web site at [keystonerv.com](http://keystonerv.com) for more current product information and specifications. Tow Vehicle Disclaimer. CAUTION: Owners of Keystone recreational vehicles are solely responsible for the selection and proper use of tow vehicles. All customers should consult with a motor vehicle manufacturer or their dealer concerning the purchase and use of suitable tow vehicles for Keystone products. Keystone disclaims any liability or damages suffered as a result of the selection, operation, use or misuse of a tow vehicle. KEYSTONE'S LIMITED WARRANTY DOES NOT COVER DAMAGE TO THE RECREATIONAL VEHICLE OR THE TOW VEHICLE AS A RESULT OF THE SELECTION, OPERATION, USE OR MISUSE OF THE TOW VEHICLE.



# X-LITE TRAVEL TRAILER STANDARDS, OPTIONS AND DECORS

## CAMPING-IN-STYLE PACKAGE\*

- Pleated shades throughout
- Laundry chute (most models TT only)
- Black trim safety glass windows
- Stainless steel microwave oven with turn style
- Aluminum framed sidewalls, floors, front, rear and slide rooms
- 5" Fabricated stamped steel roof trusses
- 13,500 BTU air conditioner
- Raised panel cabinet doors
- XL Folding grab handle

## VALUE PACKAGE\*

- True home CD/DVD system with speakers and separate zones (12-Volt compatible); MP3 player hookup on stereo with Bluetooth
- All weather outside speakers
- Gas/electric water heater with quick recovery
- Residential shower/tub surround
- TV antenna
- Laminated fiberglass sidewalls
- 32" LCD TV
- 19" LCD TV in bunk room (31SQB, 33RBI)

## CONVENIENCE PACKAGE\*

- Painted front cap with LED docking lights
- Bowed roof rafters (vaulted ceiling- TT only)
- Outside shower
- Residential raised panel refrigerator front
- Spare Tire
- Slam baggage doors
- Pop-up dinette table (TT only)
- Step light
- Battery disconnect
- LP quick connect

## X-LITE PACKAGE\*

- Black tank flush
- LED electric awning
- Radial tires
- Carbon monoxide detector

## MANDATORY OPTIONS\*

- Polar package
- Aluminum wheels

## X-LITE OPTIONS

- "Smart Slide" free-standing dinette
- 15,000 BTU ducted A/C
- Fireplace (30RLI, 33RES)

## DRY CAMPING FEATURES

- 12 Volt stereo
- Large fresh, gray and black tanks (all models)
- All slide-out lights are 12 Volt
- Space for dual batteries
- Entire underbelly enclosed to keep debris off tanks, water lines, etc.
- Fully enclosed and heated dump valves

## SAFETY FEATURES

- Manual backup on all main slide-outs
- LP sensor
- Smoke detector
- Fire extinguisher
- Carbon monoxide detector

## X-LITE NOTABLE FEATURES

- Executive chef kitchen (most models)
- Hand glazed hardwood cabinet doors throughout
- Oversized pots and pans drawer (most models)
- Deep oversized kitchen basin with sink cover
- Residential full-extension - steel ball bearings drawer guides
- Residential porcelain toilet with foot pedal
- E-Z lube hubs on axles (all models)
- 30,000 BTU furnace
- One-piece seamless tan T.P.O. roof
- All windows in main slide-out open
- Cable/satellite prep
- 32" TV (N/A on 21RBS)
- 40" TV (33RES)
- Cougar camp remote
- Correct track
- Power stabilizers
- Power tongue jack
- 8 cu. ft. refrigerator on all floor plans

\*Mandatory option

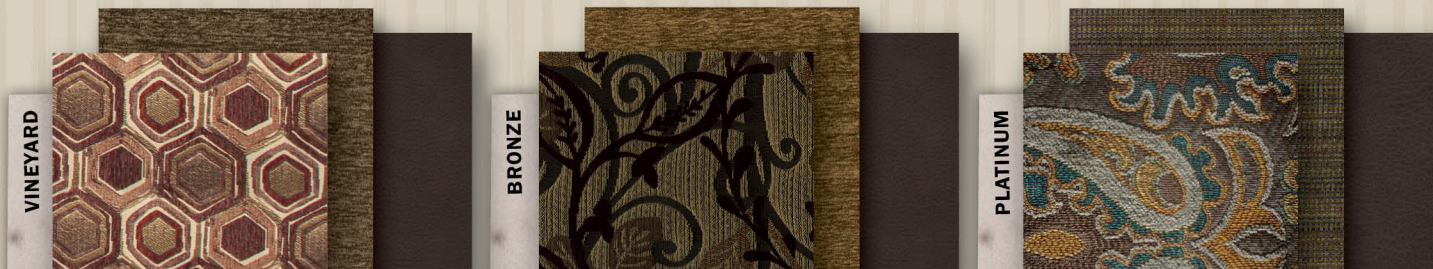

## DARE TO COMPARE



- Highest trade-in and resale value in the industry on average
- Enclosed, underbelly with heated and enclosed dump valves
- 16.2 Gallons per hour - quick recovery water heater (great for bunkhouses)
- Slide-out seal is mounted in a "T" track (no sticky tape to hold slide seals on)

- Cougar executive chef kitchen (see Cougar Standards for details)
- Easy access laundry chute (most models)
- Porcelain foot flush toilets
- Pleated shades standard on all models
- Five side welded aluminum super structure
- 5" Fabricated stamped steel-truss roof rafters on 16" centers
- Bowed roof rafters (vaulted ceiling)

- Best in class LED electric awning
- Battery disconnect switch
- Painted front cap with docking lights
- R-9 sidewall insulation, R-9 floor, R-14 ceiling insulation and R-15 astro-foil in the slide-out
- Fully ducted air conditioning featuring triple insulated, foil-wrapped, light-weight ducts
- 12 Volt compatible for dry camping
- LED lights throughout





29ROB SHOWN IN PLATINUM DECOR



## FIFTH WHEELS

Taking the quality of a Cougar and matching it with the size and weight your vehicle can tow! X-Lite Cougar offers multiple 1/2 ton towable fifth wheel floorplans.



29ROB BEDROOM SHOWN IN PLATINUM DECOR





**29ROB BUNK ROOM**



**26RLS BATHROOM  
with 30" x 60" SHOWER**



**29ROB KITCHEN SHOWN IN PLATINUM DECOR**



**26RLS SHOWN IN PLATINUM DECOR**



Cougar  
by Keystone

# Lite

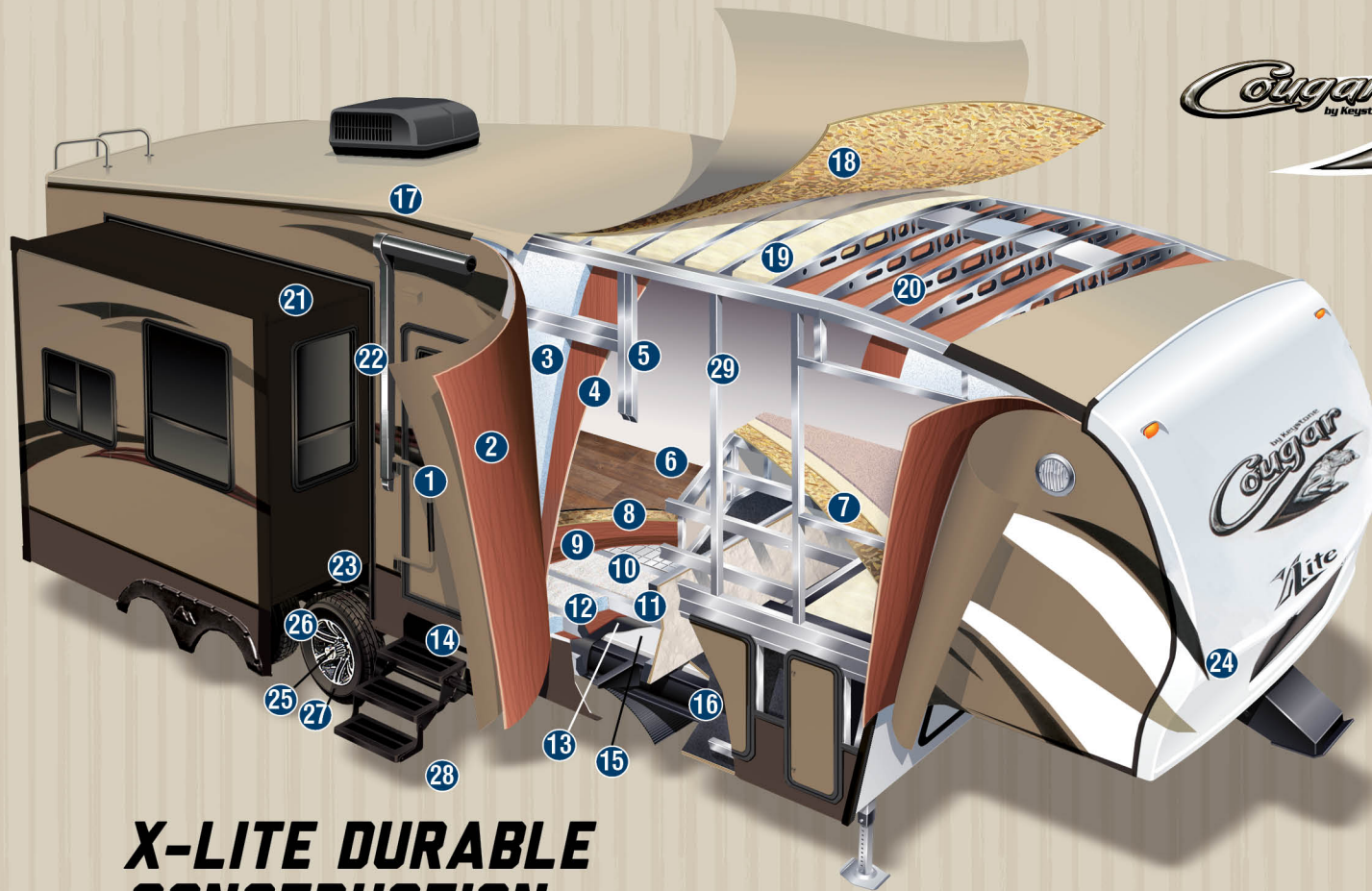

## X-LITE DURABLE CONSTRUCTION

- |   |                                      |
|---|--------------------------------------|
| 1 Gel Coated Filon Exterior                       | 14 Step Light on Frame               |
| 2 Luan Layer                                      | 15 Underbelly Heat Duct              |
| 3 Hi-Density Block Foam Insulation (Sidewall R-9) | 16 PACO I-Beam Frame                 |
| 4 Interior Wallboard                              | 17 One Piece T.P.O. Roof             |
| 5 5 Side Welded Aluminum Super Structure          | 18 Roof Decking                      |
| 6 BeauFlor® Flooring                              | 19 R-14 Fiberglass Batten Insulation |
| 7 Carpet Padding                                  | 20 5" Crowned / Stamped Roof Trusses |
| 8 1st Layer Floor Decking                         | 21 Sloped Slide Roof                 |
| 9 2nd Layer Floor Decking with Staggered Seams    | 22 Wiper Seals                       |
| 10 Hi-Density Block Foam Insulation (Floor R-9)   | 23 Bulb Seal in T-Track              |
| 11 Aluminum Floor Studs                           | 24 Max Turn Aerodynamic Front Cap    |
| 12 3rd Layer Floor Decking                        | 25 EZ Lube Axles                     |
| 13 Moisture Barrier Wrap                          | 26 MOR/ryde Suspension System        |
|   | 27 Radial Tires                      |
|   | 28 Radius Entry Steps                |
|   | 29 2" Welded Aluminum Wall Framing   |

## FLOOR (R-9)

- Aluminum Studded Laminated Floor
- 3" Large Capacity Insulated Heat within Floor
- Heated and Enclosed Underbelly
- 1/4 Polypropylene Underbelly Guard
- 2" Heat Duct Into Underbelly
- Heated and Enclosed Water Lines, Dump Valves and Tanks
- Welded Steel Cross Members
- Woven Moisture and Vapor Barrier
- Hi-Density Block Foam Insulation (R-9)
- Beauflor Flooring





## MOR/RyDE SUSPENSION

What does “Best-In-Class” mean for a suspension system?

It means that all suspensions are not created equal. Like all other products, there are unique product segments relative to price and quality demands.

### CRE/3000 RUBBER EQUALIZER

**FOR SUSPENSIONS, IT LOOKS LIKE THIS:**

UPGRADED EQUALIZER = IMPROVED SUSPENSION TRAVEL OVER STOCK STANDARD, STOCK STEEL ROCKER ARM & LEAF SPRINGS

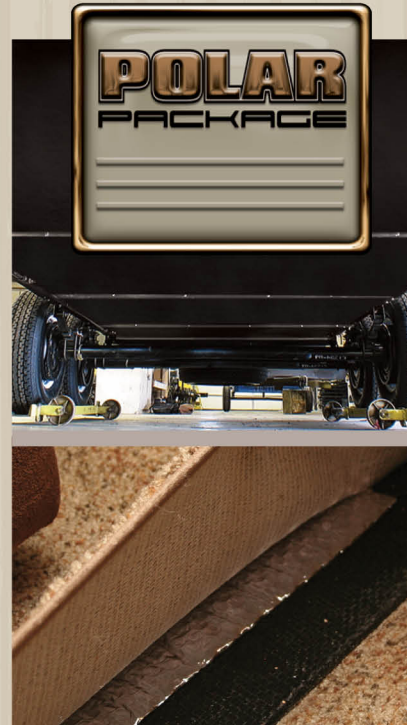

## POLAR PACKAGE

The Cougar X-Lite Polar Package expands your camping season with an enclosed and heated underbelly. Not only will you have improved aerodynamics, but your valves, tanks and water lines are all protected.

We also add upgraded insulation to our slide-out floors to control the hot and cold exchange.



## PATENTED COUGAR HITCH VISION

Hitch Vision moves the dial forward in what customers expect from an RV. There's no looking back!

Hitch Vision gives the fifth wheel user complete confidence to back up and align their truck to Cougar's extended hitch pin using only the built-in mirror for guidance. Automotive LED docking lights, which can be controlled by the E-Z Camp Cougar Remote, allow you to load or unload camping gear day or night. (Hitch Vision also comes in handy when using the E-Z Camp Cougar Remote to raise and lower landing gear.) Once you've used Hitch Vision, “there's no looking back” to the inconvenience of turning or straining to see your fifth wheel.

## MAX TURN FRONT CAP

Combining focused design and unique product specifications, Max Turn Technology is the leader in optimum turn radius.

Unlike the competition, Cougar uses continuous contoured tubular steel for optimum strength and support behind the engineered tapered fiberglass front cap.

Also, Cougar is equipped with a heavy duty extended hitch. Combined – Max Turn Technology makes turning and maneuvering a breeze.

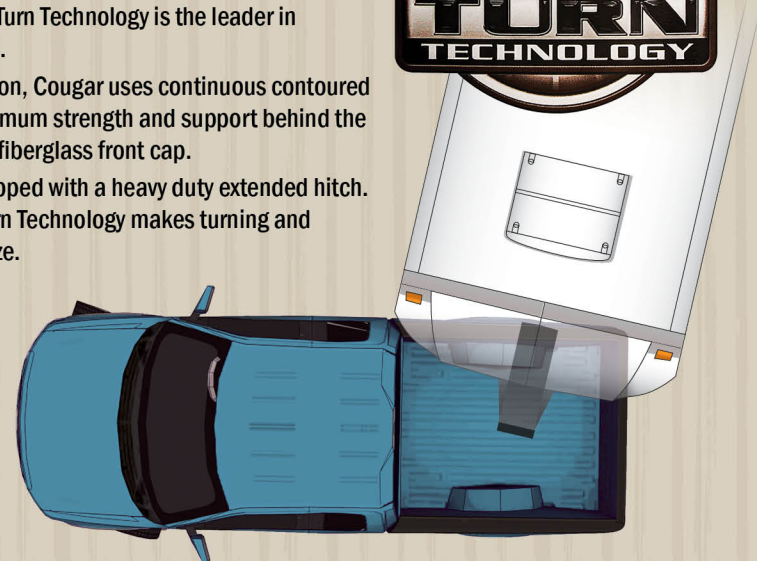





# Quick Camp™

Set up & take down camp outside or inside

**Slide Rooms**  
Press slide room button then press right arrow to bring slide out, press left arrow to bring slide in

**Power Awning**  
Press awning button then press right arrow to awning out, press left arrow to bring awning in

**Tight Spaces?**  
Set up camp quickly and easily with Quick Camp™!

**Rear Stabilizer Jacks**  
Press rear stabilizer button then press down arrow to bring jacks down, press up arrow to bring jacks up

**Awning Light**  
Press light button to turn light on and off

**Can't See?**  
Activate your lights with Quick Camp™!

Using Lippert Components™ **linc**™ WIRELESS TECHNOLOGY

TOUCH SCREEN REMOTE is standard in all Cougar X-Lite fifth wheels

## Stay in Touch



Cougar is always just a touch away. You'll find 360 virtual tours, location of your nearest dealer, photos, videos and all of the latest information about Cougar on our easy to navigate website. Everything you need can be accessed anytime, day or night, from home or on the road. You can also find us on the Keystone RV facebook.

[www.keystonerv.com/Cougar](http://www.keystonerv.com/Cougar)



4 pt. level up system is available on Cougar X-Lite fifth wheels (N/A 25RKS, 26SAB, 26RLS)





X-Lite interiors feature stainless steel range, microwave and kitchen sink.

# COUGAR X-LITE FEATURES



## CORRECT TRACK ALIGNMENT SYSTEM:

- With Correct Track, the trailer tows with the tow vehicle, not against it
- Tires run smoother and cooler
- Improves fuel economy
- Helps preserve the life of the RVs equipment, appliances, etc
- Dramatically improves tire life



# X-LITE FIFTH WHEEL FLOORPLANS

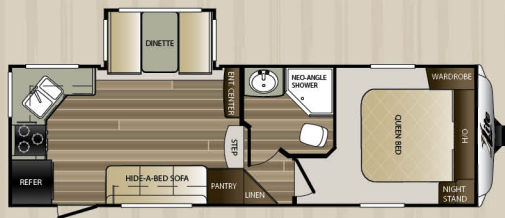

**25RKS**

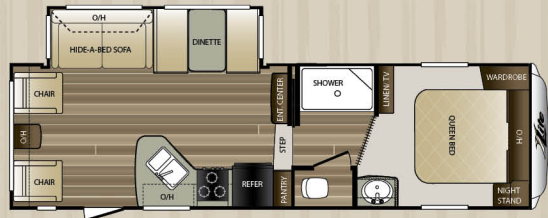

**26RLS**

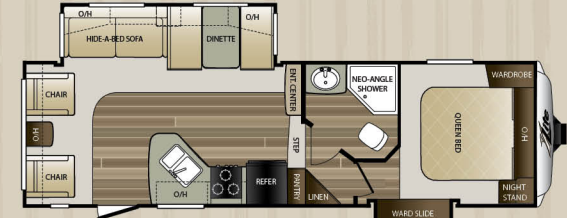

**26SAB**

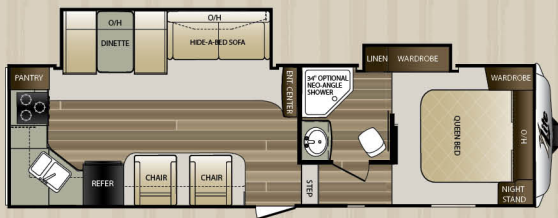

**27RKS**



**28RDB**



**28SGS**

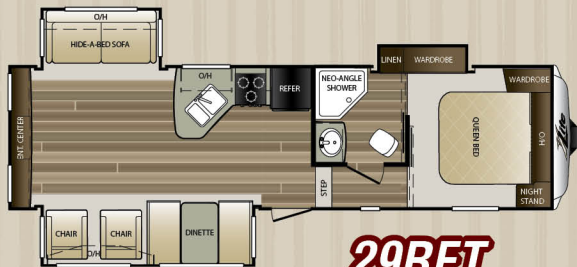

**29RET**



**29RLI**

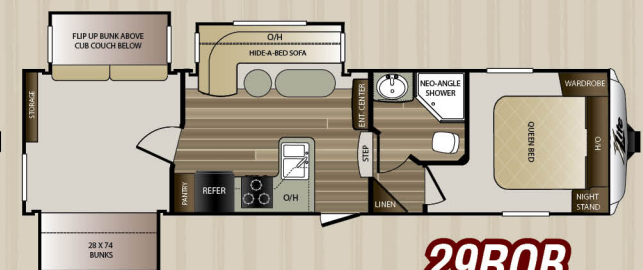

**29ROB**

## SPECIFICATIONS

MODEL	25RKS	26RLS	26SAB	27RKS	28RDB	28SGS	29RET	29RLI	29ROB	29RBS
SHIPPING WEIGHT	6404	6885	7060	7217	7734	7654	7757	7708	7860	7670
CARRYING CAPACITY	3516	3070	2925	2783	2266	2346	2243	2292	2140	2330
HITCH WEIGHT	1120	1155	1165	1230	1435	1410	1275	1535	1245	1475
EXTERIOR LENGTH	27' 2"	29' 4"	29' 4"	30' 5"	32' 11"	30' 10"	31' 1"	32' 7"	32' 11"	32' 11"
EXTERIOR WIDTH	8'	8'	8'	8'	8'	8'	8'	8'	8'	8'
EXT. HEIGHT - A/C TOP	11' 11"	11' 11"	11' 11"	11' 11"	11' 11"	11' 11"	11' 11"	11' 11"	11' 11"	11' 11"
FRESH WATER (GAL.)	43	43	43	43	43	43	43	43	43	43
WASTE WATER (GAL.)	28	28	28	28	28	28	28	28	28	28
GRAY WATER (GAL.)	56	56	56	56	56	56	56	56	56	56
LP CAPACITY (LBS.)	60	60	60	60	60	60	60	60	60	60
AWNING LENGTH	13'	13'	13'	16'	16'	10'	10'	10'	16'	16'

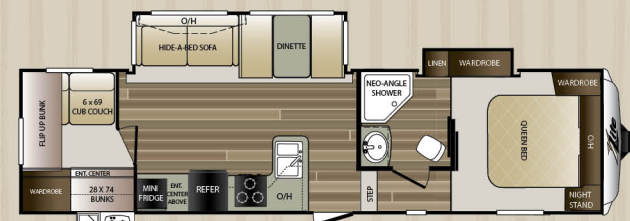

**29RBS**

Product information is as accurate as possible as of the date of publication of this brochure. Features, floor plans, and specifications are subject to change without notice. Please also consult Keystone's web site at [keystonerv.com](http://keystonerv.com) for more current product information and specifications. Tow Vehicle Disclaimer. CAUTION: Owners of Keystone recreational vehicles are solely responsible for the selection and proper use of tow vehicles. All customers should consult with a motor vehicle manufacturer or their dealer concerning the purchase and use of suitable tow vehicles for Keystone products. Keystone disclaims any liability or damages suffered as a result of the selection, operation, use or misuse of a tow vehicle. KEYSTONE'S LIMITED WARRANTY DOES NOT COVER DAMAGE TO THE RECREATIONAL VEHICLE OR THE TOW VEHICLE AS A RESULT OF THE SELECTION, OPERATION, USE OR MISUSE OF THE TOW VEHICLE.



# X-LITE FIFTH WHEEL STANDARDS, OPTIONS AND DECORS

## CAMPING-IN-STYLE PACKAGE\*

- Pleated shades throughout
- Black trim safety glass windows
- Microwave oven with turn style
- Aluminum framed sidewalls, floors, front , rear and slide rooms
- 5" Fabricated stamped steel roof trusses
- 13,500 BTU air conditioner
- Raised panel upper & lower cabinet doors throughout
- XL Folding grab handle

## VALUE PACKAGE\*

- True home CD/DVD system with speakers and separate zones (12-Volt compatible); MP3 player hookup on stereo with Bluetooth
- All weather outside speakers
- Gas/electric water heater with quick recovery
- Residential shower/tub surround
- TV antenna
- Laminated fiberglass sidewalls
- 32" LCD TV
- 19" LCD TV in bunk room (29ROB)

## CONVENIENCE PACKAGE\*

- Patented front cap with docking lights
- Outside shower
- Residential raised panel refrigerator front
- Spare Tire
- MOR/ryde suspension
- Slam baggage doors
- Step light
- Battery disconnect
- LP quick connect

## X-LITE PACKAGE\*

- Black tank flush
- Electric awning
- Radial tires
- Carbon monoxide detector

## MANDATORY OPTIONS\*

- Polar package
- Cougar camp remote
- Aluminum wheels

## X-LITE OPTIONS

- "Smart Slide" free-standing dinette
- 15,000 BTU ducted A/C
- Two chairs in place of sofa (25RKS)

## DRY CAMPING FEATURES

- 12 Volt stereo
- Large fresh, gray and black tanks (all models)
- All slide-out lights are 12 Volt
- Space for dual batteries
- Entire underbelly enclosed to keep debris off tanks, water lines, etc.
- Fully enclosed and heated dump valves

## SAFETY FEATURES

- Manual backup on all main slide-outs
- LP sensor
- Smoke detector
- Fire extinguisher
- Carbon monoxide detector

## X-LITE NOTABLE FEATURES

- Executive chef kitchen (most models)
- Hand glazed maple raised panel cabinet doors throughout
- Oversized pots and pans drawer (most models)
- Deep oversized kitchen basin with sink cover

- Residential full-extension - steel ball bearings drawer guides
- Residential porcelain toilet with foot pedal
- E-Z lube hubs on axles (all models)
- 30,000 BTU furnace
- One-piece seamless T.P.O. roof
- All windows in main slide-out open
- Cable/satellite prep
- 32" TV (N/A on 21RBS)
- 40" TV (29RLI, 29RET)
- Cougar camp remote
- Correct track

\*Mandatory option

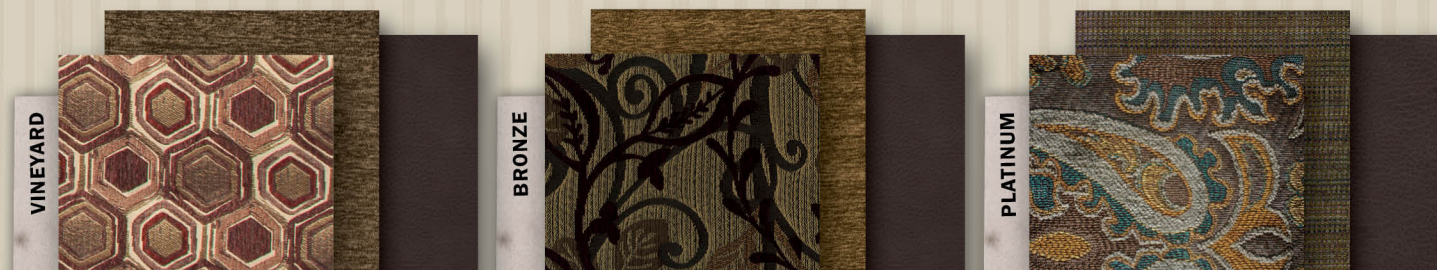

## DARE TO COMPARE



- Highest trade-in and resale value in the industry on average
- Enclosed, underbelly with heated and enclosed dump valves
- 16.2 Gallons per hour - quick recovery water heater (great for bunkhouses)
- Slide-out seal is mounted in a "T" track (no sticky tape to hold slide seals on)

- Cougar executive chef kitchen
- Easy access laundry chute (most models)
- Porcelain foot flush toilets
- Pleated shades standard on all models
- Five side welded aluminum super structure
- 5" Fabricated stamped steel-truss roof rafters on 16" centers
- Best in class electric awning
- Battery disconnect switch

- Exclusive MOR/ryde upgraded suspension
- Patented front cap with docking lights
- R-9 sidewall insulation, R-9 floor, R-14 ceiling insulation and R-15 astro-foil in the slide-out
- Fully ducted air conditioning featuring triple insulated, foil-wrapped, light-weight ducts
- 12 Volt compatible for dry camping





# Cougar *by Keystone* **Lite**



**WWW.KEYSTONERV.COM/COUGAR**



CONNECT WITH KEYSTONE RV AND STAY UP TO DATE WITH PRODUCT NEWS AND INFORMATION



Go RVing  
Life's A Trip

2642 Hackberry Drive  
PO Box 2000  
Goshen, IN 46527-2000  
(574) 535-2100



[www.keystonerv.com](http://www.keystonerv.com)

YOUR LOCAL DEALER:

## BUY LOCALLY PURCHASING YOUR RV LOCALLY

SEPTEMBER 2014

It's up to you where you purchase your new Cougar, but may we suggest your local dealer? Not only does it help your local economy and provide jobs, but it will also give you an opportunity to develop a service relationship with someone that will come to know you and your coach. Congratulations on finding the best built, best equipped, best value in the industry, and happy travels!