

Passport

GT SERIES TRAVEL TRAILERS  
SL SERIES TRAVEL TRAILERS

GO  
EVERYWHERE



FALL PREVIEW





# The ultimate ownership experience.

The goal of Keystone RV Company is to surprise and delight our owners at each and every touchpoint. We're happy when our campers are happy, and we are committed to providing the very best ownership experience in the industry.



**Keystone RV  
Company**

## 1 EASIER SHOPPING.

At Keystone, we make choosing an RV as easy as finding the Big Dipper on a dark summer night. With comprehensive online product information, Key Connect™ product advisors, and an unparalleled dealer network, we will help you select the perfect RV for your family's adventure.

## 2 INNOVATIVE THINKING.

The road's a nicer place when you have the industry's smartest features behind you. Keystone leads the pack in patented innovations that make our RVs safer, more comfortable, and easier to operate.

## 3 LONG HAUL QUALITY.

To keep you on the road, there are certain things we just won't build a Keystone RV without. Game-changing features like our Unified Wiring Standard, Tru-Fit™ five-point slide construction, and no-fail Tuf-Lok™ A/C duct joiners combined with exhaustive testing and inspections are some of the reasons why Keystone is able to offer our owners the industry's best 3-year limited structural warranty.

## 4 WORRY-FREE CUSTOMER SERVICE.

Wherever the road takes you, you're never too far from an authorized Keystone service center. We also offer live service assistance, ultra-fast parts shipping, online maintenance tips and tricks, and a single-point warranty claims policy. *That's* peace of mind.

## 5 KEYSTONE NATION.

When you choose Keystone, you become one of the largest camping families in the country. We're Keystone Nation. A friendly community where people share photos, travel tips and amazing stories – all in the spirit of camaraderie and adventure. Come join us.

Experience the Passport lifestyle by visiting [#keystonePassport](#)





# PASSPORT



SL SERIES TRAVEL TRAILERS | GT SERIES TRAVEL TRAILERS

## Less AND More: The All-New Passport®

Redefining expectations for ultra-lightweight travel trailers, the redesigned Passport GT and SL Series offers less weight and more of everything—more style, more comfort, more technology, and more ways to maximize your camping adventures.

For more information, please visit [keystone.com/Passport](http://keystone.com/Passport)



more product detail at  
[www.keystonerv.com/Passport](http://www.keystonerv.com/Passport)

## Passport GT Series

### ULTRA-LITE TRAVEL TRAILERS

- Automotive painted fiberglass front cap
- MORryde® Step Above™ entry steps
- Exceptional 45 cu. ft. pass-through storage with magnetic door hold
- Exterior television hookup
- Exterior hot and cold shower
- Load equalization axles (stability and weight equalization)
- Service light near termination valves
- EXCLUSIVE KeyTV™ multisource controller for satellite, cable, and over-the-air feeds
- 4G LTE and WiFi prep
- Solar prep
- Backup camera prep
- Black tank flush
- Heated and enclosed underbelly and valves
- Vaulted ceiling
- 60" x 80" queen bed
- USB ports (10)
- Seamless, one-piece upgraded countertops
- Furrion® glass-top range with gas oven
- Deep-seated stainless steel sink with cover and residential pull-down faucet
- High performance in-floor heat duct system
- Motion activated lighting at main entrance and pass-through storage
- Power tongue jack
- 8 cu. ft. refrigerator



**MORryde® Step Above™**  
Total control over HVAC, awnings, lights and monitoring system from your smartphone



**Furrion® Kitchen Appliances**  
Modern aesthetics and precise performance



**EXCLUSIVE KeyTV™**  
Game-changing single-point control of over-the-air, cable and satellite feeds



**Automotive-grade painted caps**  
KeyGuard chip and rock protection



# Passport GT Series

## FLOOR PLANS

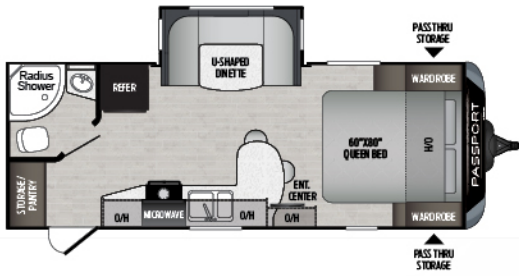

**2210RB** | Super slide w/ oversized bathroom  
Weight: 4790 LBS. | Length: 25' 11"

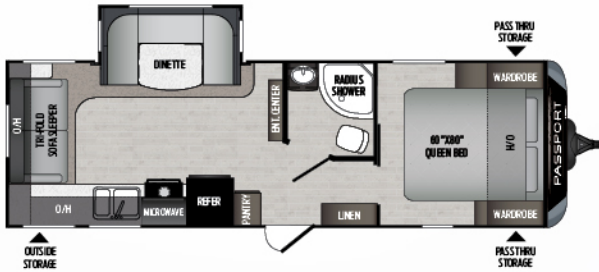

**2521RL** | Single slide, ultimate couples coach  
Weight: 3865 LBS. | Length: 23' 11"

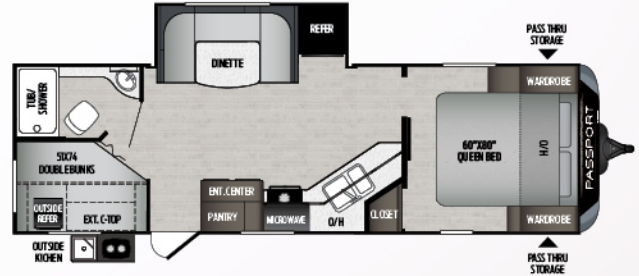

**2600BH** | DBL/DBL bunk w/outside Kitchen  
Weight: 3865 LBS. | Length: 23' 11"

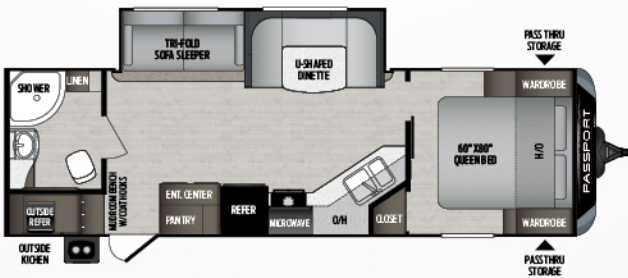

**2710RB** | Mud room bench w/coat hooks  
Weight: TBD | Length: 31' 6"

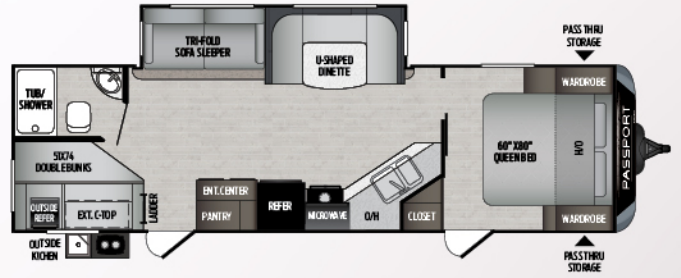

**2820BH** | Multi-purpose bunkhouse w/ outdoor kitchen  
Weight: TBD | Length: 31' 6"

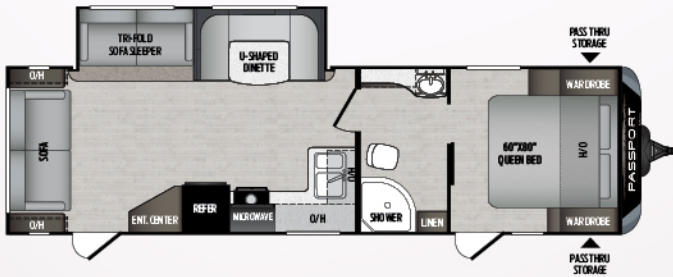

**2900RL** | Super slide /rear Living  
Weight: 4140 LBS. | Length: 25' 5"

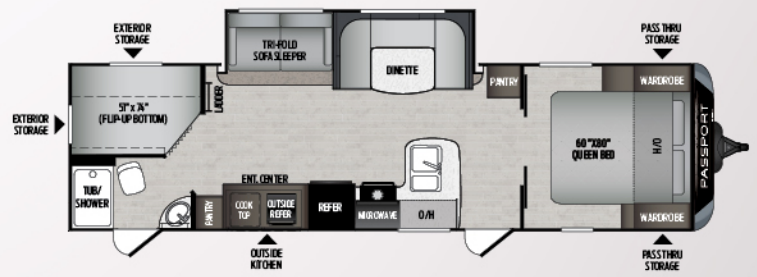

**2950BH** | Multi-purpose bunkhouse w/ outdoor kitchen  
Weight: 6105 LBS. | Length: 33' 9"

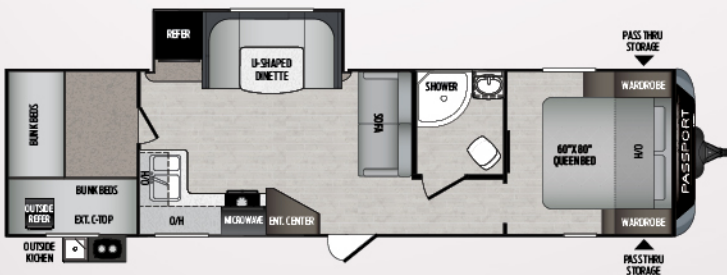

**3100QB** | Quad bunk w/ outdoor kitchen  
Weight: 4140 LBS. | Length: 25' 5"

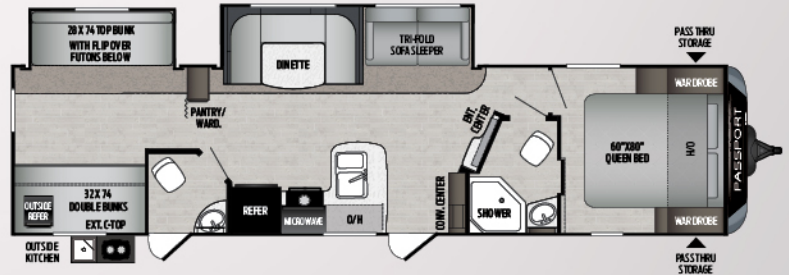

**3351RL** | Bath-N-Half bunkhouse  
Weight: 4140 LBS. | Length: 25' 5"



more product detail at  
[www.keystonerv.com/Passport](http://www.keystonerv.com/Passport)

## Passport SL Series

### ULTRA-LITE TRAVEL TRAILERS

- Exceptional 45 cu. ft. pass-through storage with magnetic door holds
- Exterior television mount
- Exterior hot and cold shower
- Service light near termination valves
- EXCLUSIVE KeyTV™ multisource controller for satellite, cable, and over-the-air feeds
- 4G LTE and Wi-Fi prep
- Solar prep
- Blank tank flush
- 60" x 80" queen bed
- USB ports (10)
- Furrion® glass-top range with gas oven
- Seamless, one-piece countertops
- Deep-seated stainless steel sink with cover
- Residential pull-down faucet
- Motion activated lighting at main entrance and pass-through storage
- 6 cu. ft. refrigerator
- High performance in-floor heat duct system
- Heated and enclosed underbelly and valves



**EXCLUSIVE KeyTV™**  
Game-changing single-point control of over-the-air, cable and satellite feeds



**Furrion® Kitchen Appliances**  
Modern aesthetics and precise performance



**EXCLUSIVE Tru-fit™ slide construction**  
A more durable slide room design that minimizes functional motor and structural stress, resists leaking

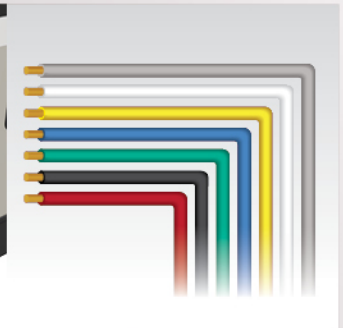

**EXCLUSIVE color-coded Unified Wiring Standard**  
Easy-to-trace circuits simplifies and expedites electrical and entertainment system troubleshooting

# Passport SL Series

## ULTRA-LIGHTWEIGHT TRAVEL TRAILER FLOOR PLANS

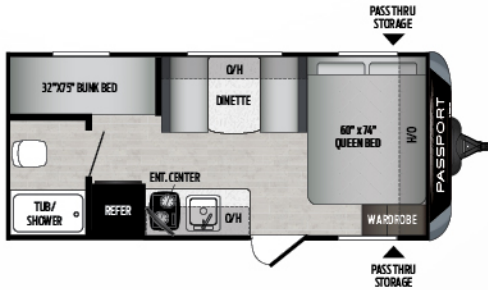

**175BH** | Single-axle bunkhouse w/ queen bed  
Weight: 3325 LBS. | Length: 21' 3"

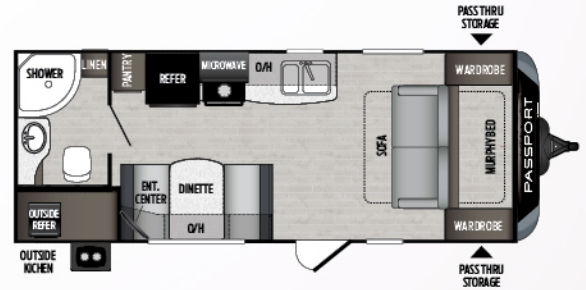

**197RB** | Double-axle couple's coach  
Weight: 3865 LBS. | Length: 23' 11"

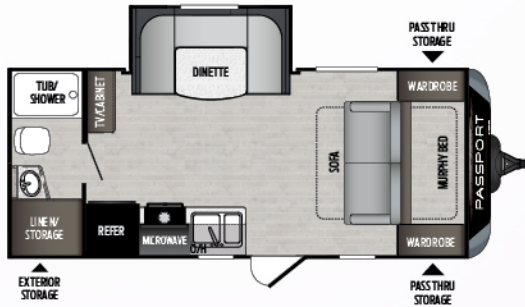

**199ML** | Single-slide couple's coach  
Weight: 3904 LBS. | Length: 22' 9"



**216RD** | Couple's coach w/ oversized dinette  
Weight: TBD | Length: 22' 9"

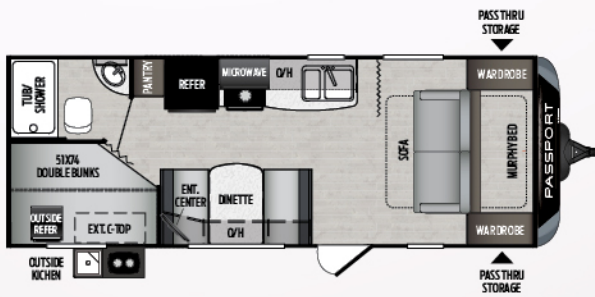

**239ML** | Murphy bed, bunkhouse  
Weight: 4140 LBS. | Length: 25' 5"

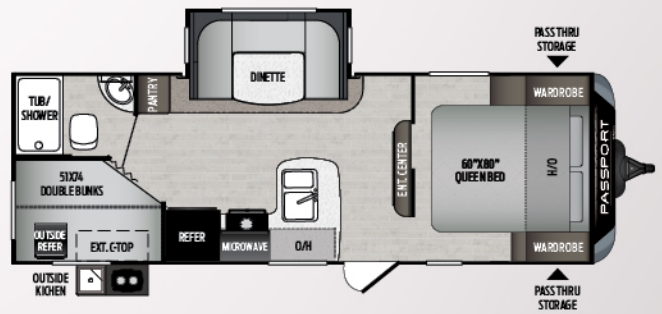

**240BH** | Super slide, bunkhouse w/ 60" x 80" queen bed  
Weight: 4960 LBS. | Length: 27' 4"

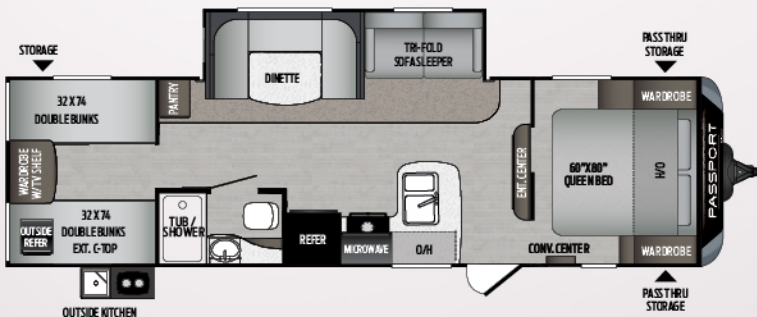

**292BH** | Quad bunkhouse w/ pack-n-play door  
Weight: 5760 LBS. | Length: 32' 4"





more product detail at  
[www.keystonerv.com/Passport](http://www.keystonerv.com/Passport)

# Passport Western | ULTRA-LITE TRAVEL TRAILERS

- Automotive Fiberglass front cap
- MORryde® Step Above™ entry steps
- Exceptional 45 cu. ft. pass-through storage with magnetic door hold
- Exterior television mount
- Exterior hot and cold shower
- Load equalization axles (stability and weight equalization)
- Service light near termination valves
- EXCLUSIVE KeyTV™ multisource controller for satellite, cable, and over-the-air feeds
- 4G LTE and WiFi prep
- Solar prep
- Backup camera prep
- Black tank flush
- Heated and enclosed underbelly and valves
- Vaulted ceiling
- 60" x 80" queen bed
- USB ports (10)
- Seamless, one-piece upgraded countertops
- Furrion® glass-top range with gas oven
- Deep-seated stainless steel sink with cover and residential pull-down faucet
- High performance in-floor heat duct system
- Motion activated lighting at main entrance and pass-through storage
- Power tongue jack
- 8 cu. ft. refrigerator



**MORryde® Step Above™**  
 Total control over HVAC, awnings, lights and monitoring system from your smartphone

**Furrion® Kitchen Appliances**  
 Modern aesthetics and precise performance

**EXCLUSIVE KeyTV™**  
 Game-changing single-point control of over-the-air, cable and satellite feeds

**EXCLUSIVE color-coded Unified Wiring Standard**  
 Easy-to-trace circuits simplifies and expedites electrical and entertainment system troubleshooting



**197RBWE** | Single-axle bunkhouse w/ queen bed  
 SL SERIES | Weight: 3325 LBS. | Length: 21' 3"

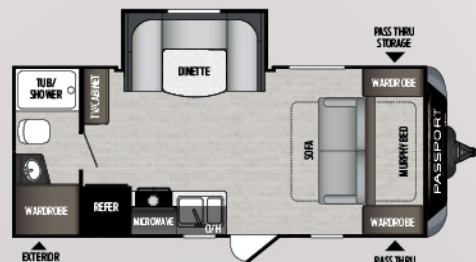

**199MLWE** | Double-axle couple's coach  
 SL SERIES | Weight: 3865 LBS. | Length: 23' 11"



# Passport Western

## ULTRA-LIGHTWEIGHT TRAVEL TRAILER FLOOR PLANS

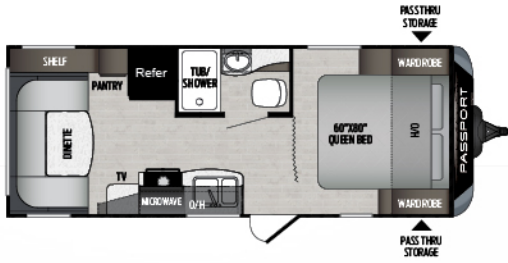

**216RDWE**  
SL SERIES

Single-slide couple's coach  
Weight: 3904 LBS. | Length: 22' 9"

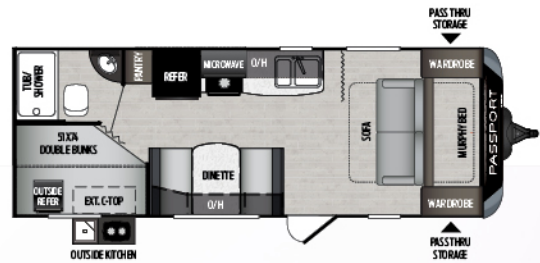

**239MLWE**  
SL SERIES

Murphy bed, bunkhouse  
Weight: TBD | Length: 22' 9"

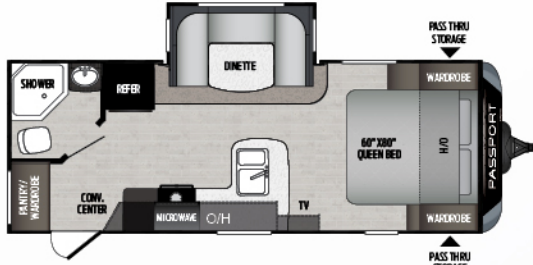

**2210RBWE**  
GT SERIES

Couple's coach w/ oversized dinette  
Weight: 4140 LBS. | Length: 25' 5"

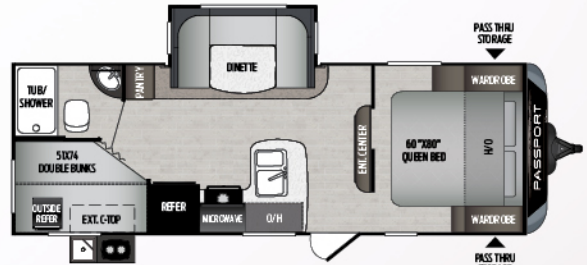

**240BHWE**  
SL SERIES

Super slide, bunkhouse w/ queen bed  
Weight: 4960 LBS. | Length: 27' 4"

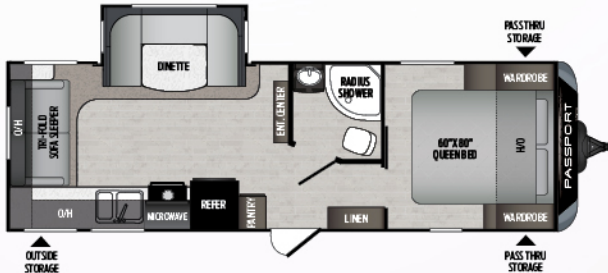

**2521RLWE**  
GT SERIES

Single slide, ultimate couples coach  
Weight: 3904 LBS. | Length: 22' 9"

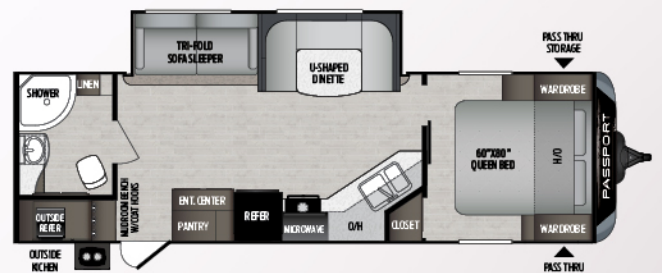

**2710RBWE**  
GT SERIES

Mud room bench w/ coat hooks  
Weight: TBD | Length: 31' 6"

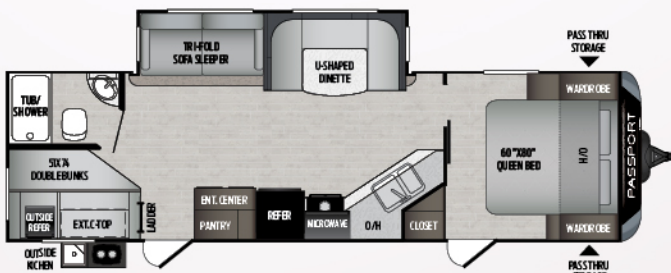

**2820BHWE**  
GT SERIES

Multi-purpose bunkhouse w/ outdoor kitchen  
Weight: TBD | Length: 31' 6"

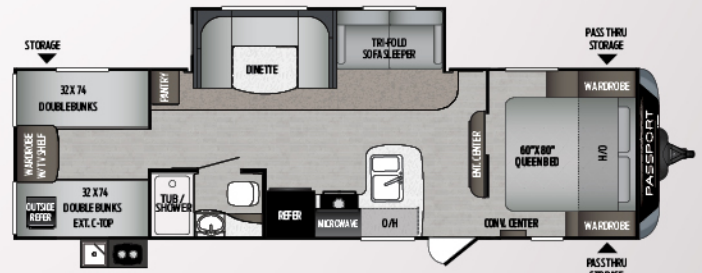

**292BHWE**  
GT SERIES

Couple's coach w/ oversized dinette  
Weight: TBD | Length: 22' 9"

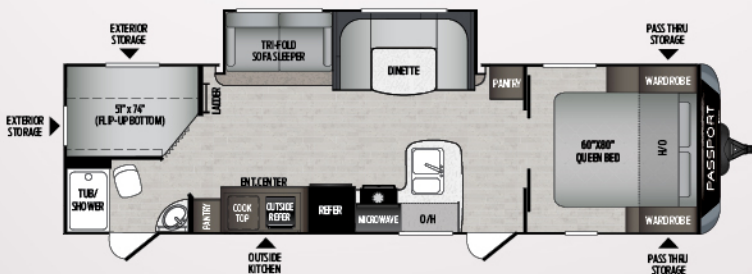

**2950BHWE**  
GT SERIES

Murphy bed, bunkhouse  
Weight: 4140 LBS. | Length: 25' 5"

### GT SERIES ULTRA-LIGHTWEIGHT TRAVEL TRAILERS

| MODEL  | WEIGHT | CARRYING CAPACITY | HITCH WEIGHT | FRESH WATER | WASTE WATER | GRAY WATER | LPG | LENGTH* | WIDTH | HEIGHT  | AWNING |
|--------|--------|-------------------|--------------|-------------|-------------|------------|-----|---------|-------|---------|--------|
| 2210RB | 4790   | 2210              | 555          | 43          | 38          | 38         | 40  | 25' 11" | 8'    | 11' 0"  | 15'    |
| 2521RL | 4994   | 2006              | 550          | 43          | 38          | 76         | 40  | 29' 10" | 8'    | 10' 8"  | 15'    |
| 2600BH | TBD    | TBD               | TBD          | TBD         | TBD         | TBD        | TBD | TBD     | TBD   | TBD     | TBD    |
| 2710RB | TBD    | TBD               | TBD          | 43          | 38          | 76         | 40  | 30' 11" | 8'    | 10' 8"  | 20'    |
| 2820BH | TBD    | TBD               | TBD          | 43          | 38          | 76         | 40  | 31' 6"  | 8'    | 10' 8"  | 19'    |
| 2900RL | TBD    | TBD               | TBD          | TBD         | TBD         | TBD        | TBD | TBD     | TBD   | TBD     | TBD    |
| 2950BH | 6145   | 1655              | 705          | 43          | 38          | 76         | 40  | 33' 9"  | 8'    | 11' 2"  | 21'    |
| 3100QB | TBD    | TBD               | TBD          | TBD         | TBD         | TBD        | TBD | TBD     | TBD   | TBD     | TBD    |
| 3351RL | 6819   | 2661              | 680          | 43          | 76          | 76         | 40  | 37' 7"  | 8'    | 10' 11" | 20'    |

### SL SERIES ULTRA-LIGHTWEIGHT TRAVEL TRAILERS

| MODEL | WEIGHT | CARRYING CAPACITY | HITCH WEIGHT | FRESH WATER | WASTE WATER | GRAY WATER | LPG | LENGTH* | WIDTH | HEIGHT | AWNING |
|-------|--------|-------------------|--------------|-------------|-------------|------------|-----|---------|-------|--------|--------|
| 175BH | 3325   | 1175              | 390          | 43          | 38          | 38         | 40  | 21' 3"  | 8'    | 10' 5" | 10'    |
| 197RB | 3865   | 1735              | 460          | 43          | 38          | 38         | 40  | 23' 11" | 8'    | 10' 4" | 14'    |
| 199ML | 3904   | 1496              | 425          | 43          | 38          | 38         | 40  | 22' 9"  | 8'    | 10' 4" | 14'    |
| 216RD | TBD    | TBD               | TBD          | 43          | 30          | 30         | 40  | 22' 9"  | 8'    | 10' 4" | 15'    |
| 239ML | 4140   | 1260              | 425          | 43          | 38          | 38         | 40  | 25' 5"  | 8'    | 10' 4" | 15'    |
| 240BH | 4960   | 2040              | 535          | 43          | 30          | 30         | 40  | 27' 4"  | 8'    | 10' 8" | 19'    |
| 292BH | 5760   | 1440              | 755          | 43          | 30          | 30         | 40  | 32' 4"  | 8'    | 10' 8" | 15'    |

### WESTERN ULTRA-LIGHTWEIGHT TRAVEL TRAILERS

|                      | MODEL    | WEIGHT | CARRYING CAPACITY | HITCH WEIGHT | FRESH WATER | WASTE WATER | GRAY WATER | LPG | LENGTH* | WIDTH | HEIGHT | AWNING |
|----------------------|----------|--------|-------------------|--------------|-------------|-------------|------------|-----|---------|-------|--------|--------|
| SL SERIES<br>WESTERN | 197RBWE  | 4116   | 1484              | 442          | 43          | 30          | 30         | 40  | 24' 6"  | 8'    | 10' 4" | 14'    |
|                      | 199MLWE  | 4090   | 1310              | 458          | 43          | 30          | 30         | 40  | 22' 9"  | 8'    | 10' 2" | 12'    |
|                      | 216RDWE  | TBD    | TBD               | TBD          | 43          | 30          | 30         | 40  | 22' 9"  | 8'    | 10' 4" | 15'    |
|                      | 239MLWE  | 4232   | 1168              | 440          | 43          | 30          | 30         | 40  | 25' 5"  | 8'    | 10' 2" | 10'    |
|                      | 240BHWE  | 4873   | 2127              | 500          | 43          | 30          | 30         | 40  | 27' 10" | 8'    | 10' 7" | 19'    |
| GT SERIES<br>WESTERN | 292BHWE  | 5717   | 1483              | 670          | 43          | 30          | 30         | 40  | 32' 10" | 8'    | 10' 9" | 15'    |
|                      | 2210RBWE | 4395   | 2105              | 452          | 43          | 30          | 30         | 40  | 25' 10" | 8'    | 10' 7" | 15'    |
|                      | 2520RLWE | 5025   | 1975              | 616          | 43          | 30          | 60         | 40  | 29' 10" | 8'    | 10' 7" | 15'    |
|                      | 2950BHWE | 6024   | 1776              | 660          | 43          | 38          | 76         | 40  | 33' 9"  | 8'    | 11' 2" | 20'    |

DISCLAIMER: Product information is as accurate as possible as of the date of publication of this brochure. All features, floor plans, and specifications in this brochure are subject to change without notice. Please also consult Keystone's web site at [www.keystonerv.com](http://www.keystonerv.com) for more current product information and specifications. Tow Vehicle Disclaimer. CAUTION: Owners of Keystone recreational vehicles are solely responsible for the selection and proper use of tow vehicles. All customers should consult with a motor vehicle manufacturer or their dealer concerning the purchase and use of suitable tow vehicles for Keystone products. Keystone disclaims any liability or damages suffered as a result of the selection, operation, use or misuse of a tow vehicle. KEYSTONE'S LIMITED WARRANTY DOES NOT COVER DAMAGE TO THE RECREATIONAL VEHICLE OR THE TOW VEHICLE AS A RESULT OF THE SELECTION, OPERATION, USE OR MISUSE OF THE TOW VEHICLE. \*Length is defined as the distance from the centerline of hitch pin/coupler to rear bumper of trailer.



more product detail at  
[www.keystonerv.com/Passport](http://www.keystonerv.com/Passport)



## STANDARDS AND OPTIONS

|   |  |   |
|---|--|---|
| <b>CHASSIS</b>  | <b>INTERIOR FEATURES</b>   | <b>SAFETY (CONTINUED)</b>                         |
| Engineered specifically for each floor plan                           | Residential-style furniture with premium fabric  | GFI receptacles                                   |
| Tube-style bumper w/sewer hose storage (GT Series only)               | Convenience center with slide, lights, awning, water system controls, and 110V receptacle                | Carbon monoxide detector                          |
| Fully-welded outriggers   | 13,500 BTU A/C standard  | Smoke alarm                                       |
| Cambered for added structural support                                 | 30,000 BTU furnace   | Fire extinguisher                                 |
| Extra support cross members   | Ducted, in-floor heating (GT Series only)  | Propane gas leak detector                         |
| Electric slide-out system   | 6-gallon gas/electric DSI water heater (17.8 gal/hr)   | Deadbolt lock on entrance doors                   |
| Enclosed, sealed and heated underbelly                                | Winterization-ready water system   | Manual override on slide system                   |
| <b>CONSTRUCTION</b>   | Residential durable Armstrong® vinyl flooring  | Spare tire kit                                    |
| Welded aluminum framed sidewalls                                      | 12 v DVD/CD/AM/FM stereo, AUX input, bluetooth and quality sound speakers (CD/DVD player N/A in Express) | <b>WESTERN EDITION FEATURES</b>                   |
| Seamless, laminated gel-coated filon exterior walls                   | LED, flat-screen HDTV, standard  | Snow load roofs                                   |
| High-density block foam insulation in sidewalls (R-7 insulation)      | Residential light fixtures in slide room   | Enclosed underbelly                               |
| Laminated aluminum framed floor 2" thick                              | Upgraded residential window treatments and valances  | <b>OPTIONS</b>                                    |
| One-piece, breathable Darco protective wrap                           | Residential-style interior doors   | 15,000 BTU A/C-option                             |
| R-11 high density block floor insulation                              | Upgraded leather furniture w/tri-fold sofa   | Aluminum Wheels (SL Series only)                  |
| Stamped galvanized 5" thick crowned rafters                           | LED interior lights  | 50 AMP 2nd A/C Prep (For models longer than 30')* |
| One piece seamless Alpha Superflex TPO roof                           | Vaulted ceiling (GT Series only)   |   |
| R-11 ceiling rolled fiberglass insulation                             | (10) USB charging ports  |   |
| <b>EXTERIOR FEATURES</b>  | <b>KITCHEN</b>   |   |
| Insulated lockable radius baggage doors with hold backs               | 6 cu. ft. double-door RV refrigerator (SL Series only)   |   |
| Insulated radius entrance door with screen door                       | 8 cu. ft. refrigerator (GT Series only)  |   |
| Double entry steps at main door (SL Series only)                      | Glass-top stove  |   |
| MORryde® Step Above™ entry steps (GT Series only)                     | Metal high-rise faucet   |   |
| Heavy-duty front mechanical jack (Power tongue jack on the GT Series) | Microwave with carousel  |   |
| Four (4) scissor-style stabilizer jacks                               | 3-burner, high output range  |   |
| Two(2), 20lb. propane bottles with flip-top cover                     | Range hood   |   |
| Dual battery rack over A-frame  | Shaker style wood cabinets   |   |
| Rain gutters with extended downspouts                                 | Gas oven (N/A 153ML, 175BH)  |   |
| Electric adjustable awning  | Seamless Countertops   |   |
| Lighted exterior pass through storage compartment w/motion light*     | Stainless steel sink w/pull-down faucet  |   |
| Portable outside grill (select models) Not all outdoor kitchen models | Trash can storage (select models)  |   |
| Patio entrance light  | <b>BEDROOM (MAIN)</b>  |   |
| Exterior shower w/ hot and cold taps                                  | 60"x 80" queen size bed with quilted bedspread (GT Series only)  |   |
| Front diamond plate   | Oversized wardrobes  |   |
| Molded fiberglass front cap w/KeyShield™ rock guard (GT Series only)  | Nighttime reading lights   |   |
| Fold-away exterior grab handle (main door, GT Series only)            | Under-bed storage  |   |
| Load equalization axles (spread axle design)                          | Bedside power outlets w/USB ports  |   |
| Dexter® E-Z lube axles  | <b>BATHROOM</b>  |   |
| Exterior speakers   | Solid wood, custom-built medicine cabinet w/mirror   |   |
| Exterior light at dump valves   | Tub surround with built-in shelves   |   |
| 15" aluminum wheels   | Radius shower curtain  |   |
| 15" radial tires  | Pedestal foot flush toilet   |   |
| Aluminum step   | 12v power exhaust fan  |   |
| Upgraded graphics package   | <b>SAFETY</b>  |   |
| Electric power tongue jack  | Four-wheel electric brakes   |   |
| LED awning lights   | Breakaway switch   |   |
| Black tank flush  | Heavy duty safety chains with clasp  |   |
| Satellite prep  | Tinted safety glass windows  |   |
| Solar prep  | Multiple emergency egress windows  |   |
| Backup camera prep (GT series only)                                   |  |   |

# BUILT FOR THE LONG HAUL



PRINT 3 2018

