

FREEDOM TO EXPLORE

# FREEDOM *Express*



ULTRA LITE TRAVEL TRAILERS ■ DEEP SLIDES ■ EXPANDABLES ■ TOY HAULERS

 **Coachmen**  
Recreational Vehicles  
A division of Forest River, Inc.



# FREEDOM *Express*

## Freedom to Explore / Freedom to Choose

Freedom Express Ultra Lite laminated travel trailers are an escape from everyday life for fun, hassle-free adventures. These ultra lites are value-packed with industry leading features, and are specifically designed for towing with today's popular half-ton pick-up trucks and SUVs. All models are built with durable, lightweight Azdel composite panels that withstand rot, mold and water damage for years of worry-free use. Our floor plans incorporate customer input to accommodate families and empty nesters in comfort. Freedom Express has repeatedly won the prestigious DSI Award, by constantly innovating and blending today's technology and style. There's no better way to enjoy a good old fashioned campfire!

**Explore our selection for the ultimate in safety and reliability:**

**Liberty and Maple Leaf Editions** – include high end amenities usually reserved for travel trailers and fifth wheels costing thousands of dollars more.

**Freedom Express Ultra Lites** – Packed with industry leading features

**Pilots** – Single axle towables, loaded with amenities

**Blast Toy Haulers** – Versatile half-ton towables for active lifestyles

**Select** – Value added lite weights



## Stable-Ryd® Suspension

- Spread axle improves weight distribution.
- Wide track axles provide a wider, more secure stance on the road.
- Spread axle design allows us to reduce the tongue weight for optimum performance.
- Spread axle design reduces sway caused by crosswinds.

## Lightweight

- Laminated sidewalls and floor
- Azdel behind the fiberglass
- Bow trusses aluminum and wood
- Rod and angle crossmembers in frame
- All tanks mounted under floor to lower center of gravity and improve interior storage.

## Aerodynamic

- Aerodynamic front profile (Cuts through the air)
- Enclosed underbelly reduces turbulence/drag. (Select models)

## Construction Features

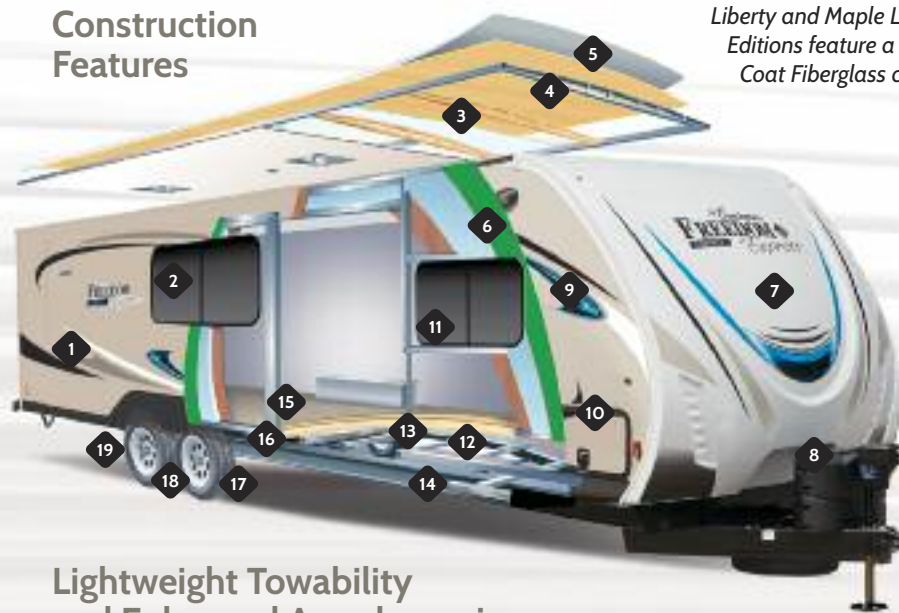

*Liberty and Maple Leaf Editions feature a Gel Coat Fiberglass cap.*

1. 3M breathable graphics
2. Tinted, safety glass windows
3. Crowned trusses
4. Aluminum reinforced with 3/8" roof decking
5. EPDM bright white rubber roofing
6. Azdel composite panels
7. Aerodynamic front profile
8. Dual 20 lb. LP gas tanks
9. Welded aluminum structure, vacuum-bonded sidewalls and flooring
10. Smooth exterior fiberglass skin
11. Aluminum framed openings
12. Fully enclosed, heated underbelly (N/A Expandables)
13. Fully welded tubular aluminum floor structure
14. Happijac SureTrac™, rack and pinion, and Schwintek slide systems
15. Congoleum Designer Carefree Resilient Flooring
16. Powder E-coated, welded I-beam frame
17. Super-Lube® axle hubs
18. Stable-Ryd® spread axle design (25' and above)
19. Nitrogen filled radial tires

## Lightweight Towability and Enhanced Aerodynamics

Freedom Express Ultra-Light travel trailers are ideal for half-ton tow vehicles and optimized fuel efficiency. Designed with fully laminated, aluminum framed walls and floor, these travel trailers and hybrid expandables are incredibly lightweight and durable.

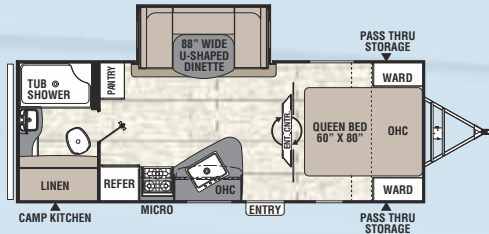
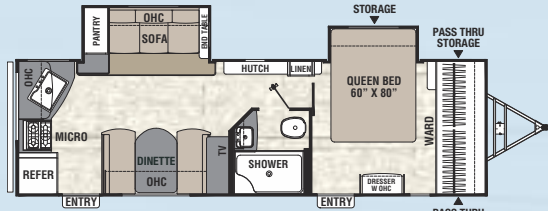
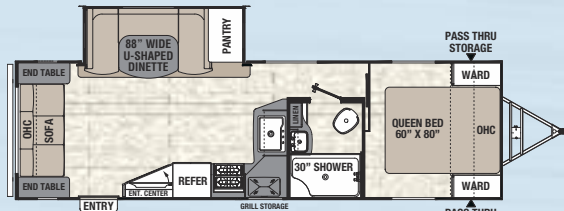
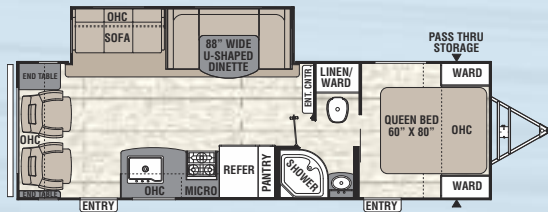
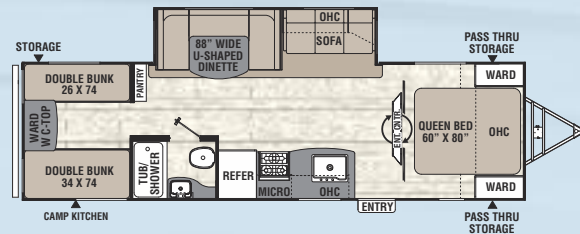
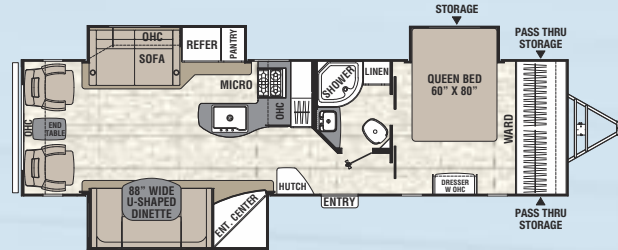
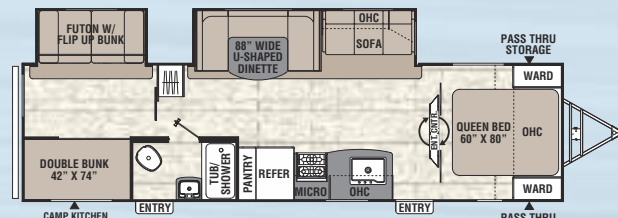
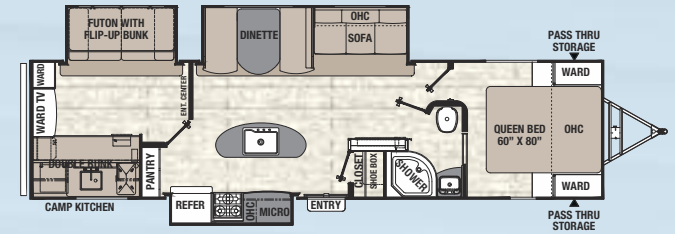
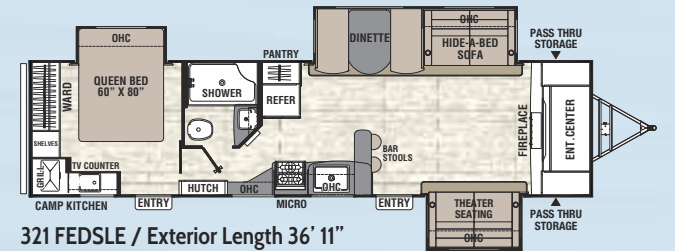
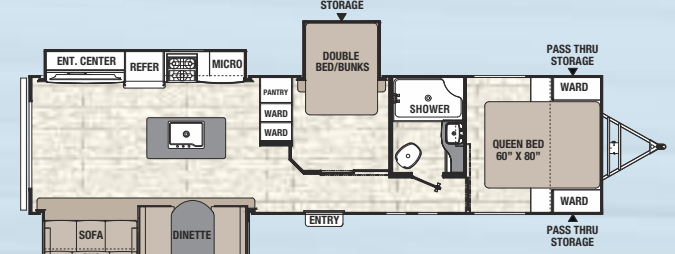

**231 RBSLE / Exterior Length 26' 10"**

**276 RKDSLE / Exterior Length 31' 6"**

**279 RLSLE / Exterior Length 31' 11"**

**281 RLSLE / Exterior Length 31' 8"**

**292 BHDSLE / Exterior Length 33' 5"**

**293 RLSLE / Exterior Length 35' 11"**

**310 BHDSLE / Exterior Length 35' 7"**

**320 BHDSLE / Exterior Length 36' 11"**

**321 FEDSLE / Exterior Length 36' 11"**

**323 BHDSLE / Exterior Length 36' 11"**
**FREEDOM TO EXPLORE**

Deep Slides	231 RBSLE	276 RKDSLE	279RLDSLE	281 RLSLE	292 BHDSLE	293 RLSLE	310 BHDSLE	320 BHDSLE	321 FEDSLE	323 BHDSLE
UVW*	5,436	6,400	5,929	6,369	6,384	7,851	7,454	7,961	7,906	7,878
Hitch Weight	645	791	741	821	747	985	937	879	1,071	1,126
Carrying Capacity	2,064	1,200	1,671	1,495	1,216	2,049	2,446	2,539	2,594	2,622
Exterior Length (Bumper to Hitch)	26' 10"	31' 6"	31' 11"	31' 8"	33' 5"	35' 11"	35' 7"	36' 11"	36' 11"	36' 11"
Exterior Height (Includes A/C)	10' 9"	10' 9"	10' 9"	10' 9"	10' 7"	11' 2"	11'	11' 2"	11' 2"	11' 2"
Interior Height (Coach)	81"	81"	81"	81"	81"	81"	81"	81"	81"	81"
Awning Length	14'	20'	20'	18'	18'	12' and 10'	18'	20'	17'	15'
Fresh/Grey/Waste Water Cap. (gal.)	49/33/33	49/66/33	49/33/33	49/33/33	49/33/33	49/33/33	49/33/33	49/66/33	49/66/33	49/66/33
Tire Size	ST205/75R14C	ST205/75R14C	ST205/75R14C	ST205/75R14C	ST205/75R14C	ST225/75R15D	ST225/75R15D	ST225/75R15D	ST225/75R15D	ST225/75R15E

\*Unloaded vehicle weights do not include options. Please refer to back cover for definitions of chart descriptions.



Freedom Express is TRA gold level rated. As a certified green RV, Freedom Express utilizes effective production techniques in combination with healthy materials, plus efficient usage of energy and water to produce a high quality RV with less environmental impact.





The 293 RLDSE has many windows and includes an L-shaped kitchen, a large bath with an oversized vanity and plenty of storage. It's the perfect size to tow with a half-ton truck. Shown in Walnut decor.



The 321 FEDSE's private rear slide master suite has amazing wardrobe storage. This floorplan includes a handy cordless rechargeable Dyson® vacuum.



Experience game day action in style on this 55" Smart TV. The front living room in the 321 FEDSE is so expansive, there's enough room to jump up and dance with every home run! There's not a bad seat in the house with theatre seating, plus an opposing Hide-a-Bed sofa and convenient service bar with stools. Shown in Sienna decor.



This bath has a spacious, super-size 30" x 50" shower with a glass enclosure and abundant linen storage.



FREEDOM  
TO EXPLORE



# FREEDOM Express

**LIBERTY**  
**MAPLE LEAF**



*Liberty and Maple Leaf Editions Include the Freedom Value Package (Page 9), PLUS these Upgrades:*

## Liberty/Maple Leaf Edition Package (Upgrade)

- Gel Coated Fiberglass Cap with LED Hitch and Marker Lights
- Front Rock Guard Graphics on Cap
- Special Liberty/Maple Leaf Edition Graphics
- Slam Latch Baggage Doors on Pass-through Storage
- Enclosed and Heated Gate Valves
- RG6 TV Hook-up Camp Side
- Camp Side Security Light
- Central Control Panel for Switches and Gauges
- Raised Panel Glazed Independence Maple Doors (Uppers)
- Solid Surface Kitchen Countertop
- Under mount Stonecast Sink with Sink Cover
- Tile Backsplash
- Contemporary Sprayer Faucet
- Decorative Light over Dinette and Matching Wall Sconce
- Hide-A-Bed Sofa
- Two Slider Pots and Pans Drawer Under Dinette
- Designer Bedspread with matching Pillows
- Three Upgrade Décors - Walnut, Sienna, Shadow
- Electric Fireplace (NA 276 RKDS)
- Large 8 Cu. Ft. Refrigerator
- Five Point Stabilizing System with Power Tongue Jack
- Aluminum Steps

## Additional Options

- 15,000 BTU A/C
- 50 Amp Service with Second A/C Prep
- Coleman High Output Grill (Standard on camp kitchens and 293 RLDSE)
- Frameless Windows
- Radiant Barrier Pack
- Ladder
- Free Standing Dinette with 4 chairs
- RV Eye Camera
- 12 Volt 10.7 Cu. Ft. Refrigerator
- Winegard WIFI and 4G LTE Extender
- Canadian Compliance

DECOR



**SHADOW**



**SIENNA**

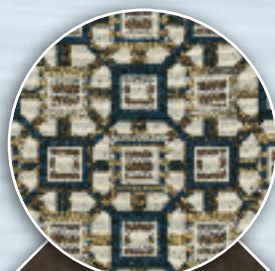

**WALNUT**



*This popular 320 BHDSE outdoor kitchen comes complete with a refrigerator, Coleman grill, TV outlet, storage, plus a sink with hot and cold running water!*

*The 320 BHDSE bunkhouse model is loaded with storage. Kids enjoy climbing the Rock Blocks to the upper bunk. The large entry closet provides plenty of shelving for shoes, extra gear and a waste basket.*





# FREEDOM *Express*

**LIBERTY**  
**MAPLE LEAF**  
**ULTRA LITE**

## STANDARD FEATURES & OPTIONS



Elegant LED Accent Lighting throughout.



Full-size Pull-out Drawers for easy access dinette storage on all Liberty models.



Exclusive Utensil Drawer for convenient storage of camping's basic necessities.



This Stone Cast Sink fits large pots and pans. Made in the U.S.A. with a lifetime guarantee.



Seamless Edge Countertops are standard on Freedom Express. Solid surface countertops are standard on Liberty.



Stable Ryde Spread Axles provide better weight distribution, handling and improved towing.



Power Stabilizers extend and retract in record time.



All Freedom Express Travel Trailers have 60" x 80" Queen Beds.



Hardwood Butcher Block Range Cover works as a cutting board, added counter space or a serving tray



Foldable Dinette Table can be used indoors or outdoors and converts to a sleeping area

Freedom Express' Fully Walkable Roof makes trailer maintenance and inspections safe and easy.



Sink Cover adds counter space - standard in both Liberty and Ultra Lite.



Centralized Control Panel indicates tanks, battery levels and operating components.

*Features and Options listed above may not be available on all models.*



# FREEDOM TO EXPLORE



The Power Tongue Jack is the safe, easy way to raise and lower your hitch, optional on Ultra Lites.



5-point stabilizing Power Tongue Jack system, is standard on Liberty and Maple Leaf Editions.



Stay connected with the all new Wifi Extender and 4G LTE Antenna.



Custom-made Medicine Cabinet with added Shelf and Deluxe Robe Holder.



81"

The 81" Interior Height creates an open feeling with plenty of large storage space in overheads and slide rooms. Bunk rock climbing blocks make bedtime fun.



The LED Step Light, Awning Light and Scare Light will keep you safe and secure.



Fully Lighted Pass-thru Storage with a 24" x 48" outdoor resin table stored above.



Porcelain Foot Flush Toilet.



40" LED HD Television.



Vacuum Bonded Walls with Azdel.



- 50% Lighter than wood
- No rot, mold or water damage
- R-2 thermal insulation
- Odorless, no formaldehyde
- Sound and energy absorbing
- Impact and puncture resistant
- Made in USA



# FREEDOM

## Express

### ULTRA LITE

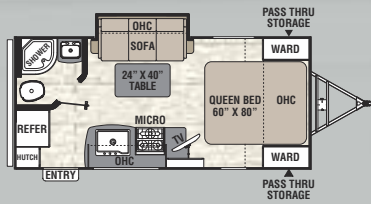

192 RBS / Exterior Length 22' 6"

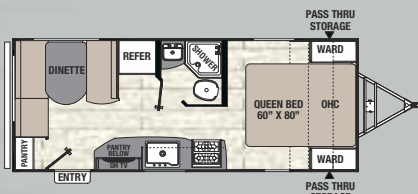

204 RD / Exterior Length 24' 7"

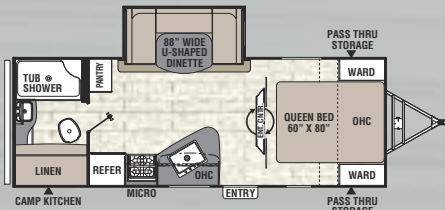

231 RBDS / Exterior Length 26' 10"

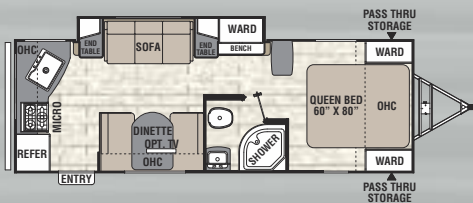

246 RKS / Exterior Length 28' 3"

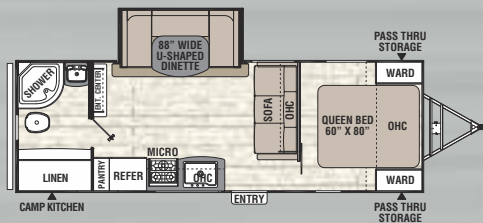

248 RBS / Exterior Length 28' 11"

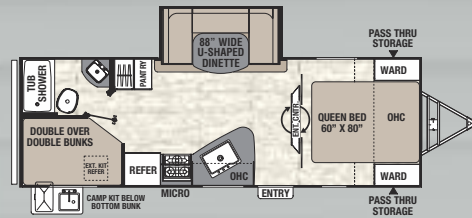

257 BHS / Exterior Length 28' 7"

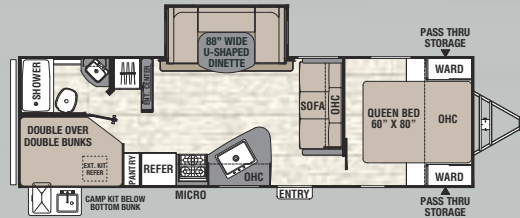

275 BHS / Exterior Length 31' 8"

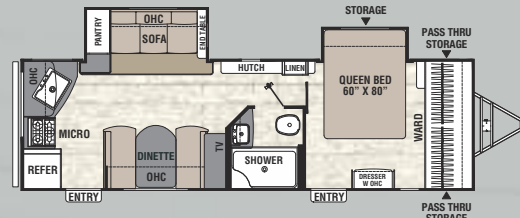

276 RKDS / Exterior Length 31' 6"

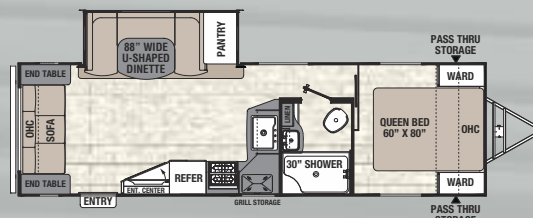

279 RLDS / Exterior Length 31' 11"

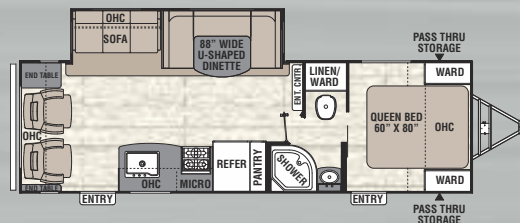

281 RLDS / Exterior Length 31' 8"

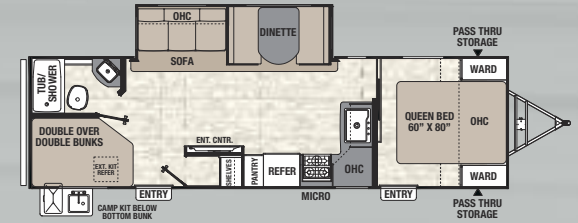

287 BHDS / Exterior Length 32' 11"

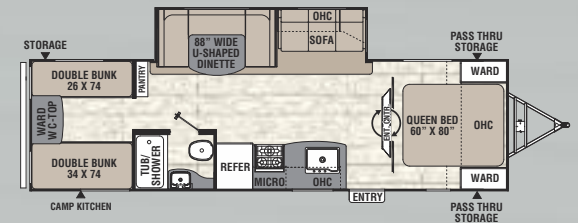

292 BHDS / Exterior Length 33' 5"

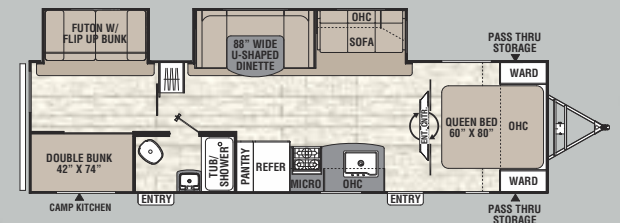

310 BHDS / Exterior Length 35' 7"

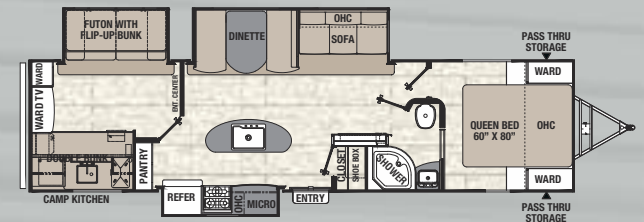

320 BHDS / Exterior Length 36' 11"

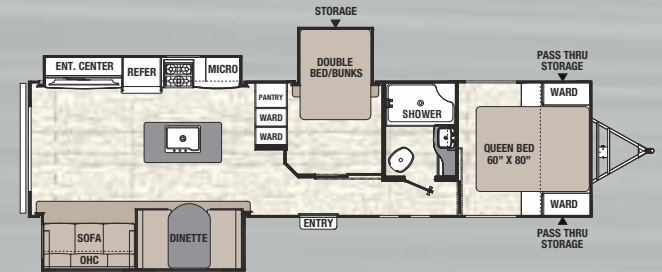

323 BHDSLE / Exterior Length 36' 11"





## Find Your Freedom - Ultra Lite Towability and Convenience

Freedom Express Ultra Lites have been designed for easy towing with today's half ton trucks, cross overs and mid-sized SUVs. All tanks are located under the floor to lower the center of gravity for increased storage capacity and improved handling.



### Freedom Value Package (Required)

- ¾ Gel Coated Fiberglass Front Cap with LED Lights
- Aluminum Wheels
- Spare Tire Kit
- Detachable Power Cord
- Power Awning with LED Rope Light
- Magnetic Catches for Compartment Doors
- Tinted Safety Glass Windows
- Front Diamond Plate
- TV & Radio Antenna with Booster
- E-Z Lube® Axles
- Spread Axle Design\*
- Heated Enclosed Underbelly\*\*
- Solar Port
- Folding Entry Assist Handle
- Exterior Shower Station
- Winterize Ready Kit
- Black Tank Flush
- 2 Exterior Speakers, 4 Interior Speakers
- Ducted Furnace\*
- Ducted Ceiling Air Conditioning\*
- AM/FM/CD/DVD/Bluetooth
- LED TVs
- Satellite Ready
- LED Interior Lighting
- Night Shades
- Congoleum Designer Carefree Flooring
- Mortise and Tenon Cabinet Doors
- Stonecast Sink

- Sink Cover
- Microwave
- Oven with 3-Burner Cooktop
- Butcher Block Stove Cover
- 6 Cu. Ft. Two Door Refrigerator
- Silverware Drawer (Most models)
- 60" x 80" Queen Bed
- Skylight in Bath
- RVIA
- 12" LED Step Light
- LED Light Strip in Pass-through Storage
- 24" x 48" Resin Outdoor Table
- Multiple USB Locations
- Porcelain Toilet with Foot Flush

\*Not available in 25' and below \*\*Not available on Expandables

### Options

- 15,000 BTU A/C
- 50 Amp Service with Second A/C Prep
- Push-button Power Stabilizer Jacks (25' and above)
- Power Tongue Jack
- Coleman High Output Grill (Most models)
- Hide-A-Bed (Deep slides only)
- RV Eye Wi-Fi Cameras
- Frameless Windows
- Ladder
- 8 Cu. Ft. Refrigerator
- Radiant Barrier Pack
- Free Standing Dinette with 4 Chairs
- Canadian Compliance
- Winegard WIFI and 4G LTE Extender

Freedom Express	192 RBS	204 RD	231 RBDS	246 RKS	248 RBS	257 BHS	275 BHS	276 RKDS	279 RLDS	281 RLDS	287 BHDS	292 BHDS	310 BHDS	320 BHDS	323 BHDS
UVW*	3,850	3,991	5,101	4,891	5,380	5,300	5,881	6,154	5,802	5,974	6,185	6,098	7,245	7,748	7,878
Hitch Weight	392	561	585	500	705	671	715	730	700	737	615	740	865	820	1,126
Carrying Capacity	2,050	2,009	2,399	2,109	2,120	2,200	1,719	1,446	1,798	1,626	1,415	1,502	2,655	2,752	2,622
Exterior Length (Bumper to Hitch)	22' 6"	24' 7"	26' 10"	28' 3"	28' 11"	28' 7"	31' 9"	31' 6"	31' 11"	31' 8"	32' 11"	33' 5"	35' 7"	36' 11"	36' 11"
Exterior Height (Includes A/C)	10' 3"	10' 9"	10' 9"	10' 4"	10' 9"	10' 9"	10' 9"	10' 9"	10' 9"	10' 9"	10' 9"	10' 9"	11'	11' 2"	11' 2"
Interior Height (Coach)	81"	81"	81"	81"	81"	81"	81"	81"	81"	81"	81"	81"	81"	81"	81"
Awning Length	14'	16'	14'	18'	16'	20'	16'	20'	18'	18'	18'	18'	18'	20'	15'
Fresh/Grey/Waste Water Cap. (gal.)	36/30/30	49/33/33	49/33/33	49/33/33	49/33/33	49/33/33	49/33/33	49/66/33	49/33/33	49/33/33	49/33/33	49/33/33	49/33/33	49/66/33	49/66/33
Tire Size	ST205/75R14C	ST205/75R14C	ST205/75R14C	ST205/75R14C	ST205/75R14C	ST205/75R14C	ST205/75R14C	ST205/75R14C	ST205/75R14C	ST205/75R14C	ST205/75R14C	ST205/75R14C	ST225/75R15D	ST225/75R15D	ST225/75R15E

\*Unloaded vehicle weights do not include options. Please refer to back cover for definitions of chart descriptions.





Friends and family appreciate this private master suite and double-over-double bunks. It's great for entertaining with large counters, an extended butcher block stove cover, an 88" dinette and an outside kitchen. Shown in Russet decor.



There's plenty of room for all your gear, food, coats, shoes, or whatever your adventure requires, with the expansive walk-in closet located at the entry of the 287 BHDS.



FREEDOM  
TO EXPLORE



# FREEDOM

ULTRA LITE

## Express

DECOR



RUSSET

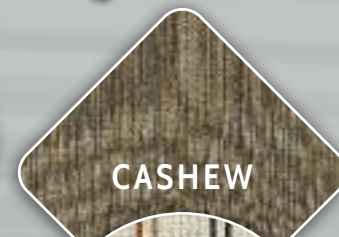

CASHEW





## FREEDOM EXPRESS ULTRA LITE EXPANDABLES



### *Freedom Express Expandables sleep up to 10 people – under 5,000 lbs. to tow*

Pack all the livability of a 28'-33' travel trailer into the towability (and price) of a 21'-23' trailer. Freedom Express Expandables are easy to tow and come with the Secure-Lok tent system which eliminates the hassle of Velcro or bungs, making set-up and tear-down a snap – even for one person.

Open space is abundant in the 23 TQX with the king U-shape dinette slide. Bring everyone along on the trip with sleeping for 10 and plenty of room for the extras. All of our expandable floorplans maximize living and seating with style and efficiency only found in Freedom Express.

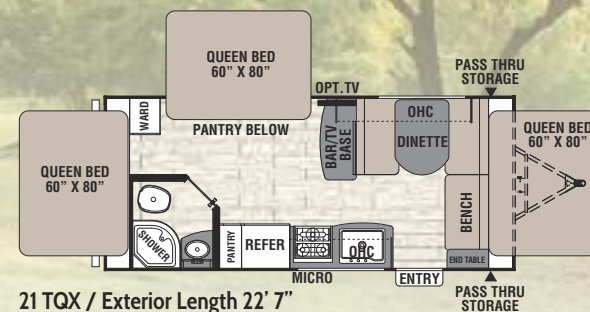

21 TQX / Exterior Length 22' 7"

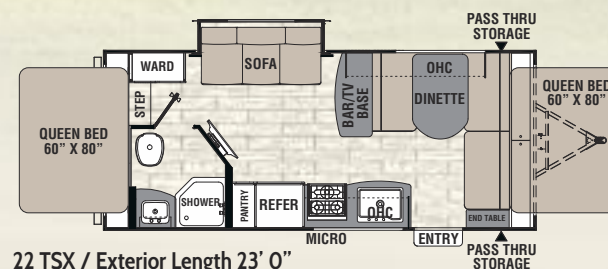

22 TSX / Exterior Length 23' 0"

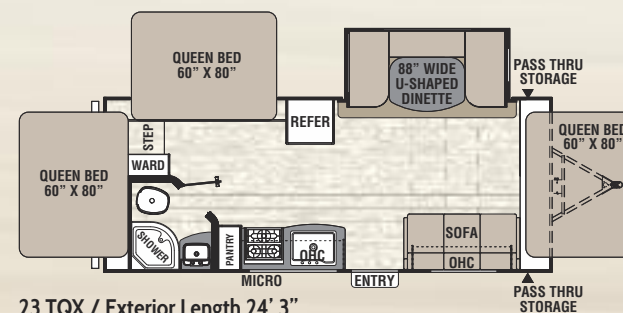

23 TQX / Exterior Length 24' 3"

Freedom Express Expandables	21 TQX	22 TSX	23 TQX
UVW*	3,650	4,450	4,705
Hitch Weight	430	550	635
Carrying Capacity	2,150	2,550	2,295
Exterior Length (Bumper to Hitch)	22' 7"	23' 0"	24' 3"
Interior Height (Includes A/C)	10' 3"	10' 9"	10' 9"
Interior Height (Coach)	81"	81"	81"
Awning Length	14'	16'	18'
Fresh/Grey/Waste Water Cap. (gal.)	36/30/30	36/30/30	36/30/30
Tire Size	ST205/75R14C	ST205/75R14C	ST205/75R14C

\*Unloaded vehicle weights do not include options.

Please refer to back cover for definitions of chart descriptions.



# FREEDOM Express

FREEDOM TO EXPLORE



JBIG3 BAI7 IG3K7B IG3AB7GH

■ DEEP SLIDES ■ EXPANDABLES ■ TOY HAULERS

Find out why Freedom Express has become one of the most demanded ultra lite towable RV brands on the market today!



Freedom Express has Won the Annual DSI Quality Circle Award!

## Coachmen Interactive Mobile Manuals

Download your Coachmen mobile app or visit our dynamic online manual to enhance your ownership experience.

These interactive options provide incredible ease and insight into use, maintenance and enjoyment of your Coachmen product.

Ranging from "How-To" videos, pictures

and illustrations of various components, systems and features to fully searchable content and downloadable PDFs for individual component owner's manuals, answers are always just a click away.



**Travel Easy™ Roadside Assistance**  
RVing is easier with Coachmen's Travel Easy™ Roadside Assistance provided FREE the first year of ownership to those who purchase a New Coachmen RV. Administered by

Coach-Net, this service provides you with 24/7 operational, technical and emergency road service coverage. Also included is towing, fuel delivery, jump starts, lockout service, tire changes, mobile mechanic and unlimited technical assistance. Anywhere. Anytime. Travel Easy™ is the security of knowing that help is an easy phone call away.



**Learn More**  
Scan this barcode using a QR Reader on your smart phone to learn more about Forest River.



All information contained in this brochure is believed to be accurate at the time of publication. However, during the model year, it may be necessary to make revisions and Forest River, Inc., reserves the right to make all such changes without notice, including prices, colors, materials, equipment and specifications as well as the addition of new models and the discontinuance of models shown in this brochure. Therefore, please consult with your Forest River dealer and confirm the existence of any materials, design or specifications that are material to your purchase decision. ©2017 Freedom Express by Coachmen, a Division of Forest River, Inc., a Berkshire Hathaway company. All Rights Reserved. 9/17

**GVWR (Gross Vehicle Weight Rating)** - is the maximum permissible weight of the unit when fully loaded. It includes all weights, inclusive of all fluids, cargo, optional equipment and accessories. For safety and product performance do NOT exceed the GVWR.

**GAWR (Gross Axle Weight Rating)** - is the maximum permissible weight, including cargo, fluids, optional equipment and accessories that can be safely supported by a combination of all axles.

**UVW (Unloaded Vehicle Weight)\*** - is the typical weight of the unit as manufactured at the factory. It includes all weight at the unit's axle(s) and tongue or pin and LP Gas. The UVW does not include cargo, fresh potable water, additional optional equipment or dealer installed accessories.

\*Estimated Average based on standard build optional equipment.

**CCC (Cargo Carrying Capacity)\*\*** - is the amount of weight available for fresh potable water, cargo, additional optional equipment and accessories. CCC is equal to GVWR minus UVW. Available CCC should accommodate fresh potable water (8.3 lbs per gallon). Before filling the fresh water tank, empty the black and gray tanks to provide for more cargo capacity.

\*\*Estimated average based on standard build optional equipment.

Each Forest River RV is weighed at the manufacturing facility prior to shipping. A label identifying the unloaded vehicle weight of the actual unit and the cargo carrying capacity is applied to every Forest River RV prior to leaving our facilities.

The load capacity of your unit is designated by weight, not by volume, so you cannot necessarily use all available space when loading your unit.

Your Freedom Express Dealer



423 N. Main Street ♦ P.O. Box 30 ♦ Middlebury, IN 46540

To learn more about Coachmen RV and our products and see how Coachmen is making the easy life easier, visit [www.coachmenrv.com](http://www.coachmenrv.com) or call 1.800.353.7383.

505-292-7800