



# Range Lite



Serial #: 58TBM0BN4S3ED3077  
 Model: 241BH RANGE LITE TT

Model Year: 2025 Dealer Name: Recreation USA  
 1801 Hwy 9  
 Longs, SC 29568  
 USA

**Manufacturer's Suggested Retail Price \$42,286.00**

TOTAL AMOUNT DOES NOT INCLUDE STATE AND LOCAL TAXES OR LICENSE FEES. THE PRICE SHOWN ABOVE MAY OR MAY NOT BE REPRESENTATIVE OF THE ACTUAL SELLING PRICE OF SIMILAR RECREATIONAL VEHICLES IN YOUR AREA.

## Standard Equipment

THE FOLLOWING ITEMS ARE STANDARD ON THIS MODEL

- EXTERIOR**
- 5/8" main floor decking
  - Door side spray port
  - Exterior grill/griddle quick connect port
  - Flexible LP lines
  - Foldable grab handle
  - Fully-walkable roof
  - In-frame battery rack
  - Magnetic baggage door catches
  - Oversized pass-through storage with motion lighting
  - PVC roofing membrane (limited lifetime warranty)
  - Rain guttering with molded drip spouts
  - Rear observation camera prep
  - Safety bumper with drain hose carrier and end caps
  - Seamless fiberglass front wall
  - Self-adjusting electric brakes
  - Side camera prep marker lights
  - Solid swing-down entry steps
  - Thermal Seal- enclosed, insulated and heated underbelly with fully insulated roof with a PVC roofing membrane
  - Tinted safety-glass windows throughout
  - TuffShell™ - vacuum bonded laminated construction, reinforced with heavy-duty fiberglass and welded aluminum frames
  - Xtend Solar I Package (200 watt solar panel with 30 amp solar controller)

- INTERIOR**
- 10 cu. ft. 12V refrigerator
  - 5G antenna
  - 60" x 80" residential queen bed with storage below
  - 75 lb. ball bearing drawer guides
  - 81" interior height
  - Cable and satellite prep
  - Electrical outlets and USB ports in master bedroom
  - Flush floor slides with residential vinyl flooring
  - Hardwood cabinet doors
  - Hidden hinge cabinet door hinges
  - Kitchen sink covers
  - LED interior lighting
  - Magnetic cabinet door catches
  - Medicine cabinet
  - Powered 12V bathroom vent
  - Range hood
  - Residential high-rise faucet
  - Roller blackout night shades
  - Soft closing foot flush toilet
  - Stainless steel single basin under-mount kitchen sink
  - Tri-fold sofa (select models)

- CUSTOMER CONVENIENCE PACKAGE (Mandatory)**
- 15,000 BTU roof mounted A/C
  - 2-30 lb. LP bottles
  - 3-burner range with 17" oven and flush mount glass cover
  - Dome style digital TV antenna with Wi-Fi prep
  - Enclosed exterior docking station with black tank flush
  - EZ-store detachable cord
  - Friction hinge entrance door with window and shade prep
  - Gas/electric water heater
  - Microwave
  - Nitrogen filled radial tires with aluminum rims
  - Pop up wireless and USB charger in bedroom
  - Power awning with LED lighting
  - Power tongue jack
  - Pressed membrane countertops
  - Rear roof access ladder
  - Smart entertainment HDTV with Bluetooth®, soundbar and built in stereo

## Optional Equipment

OPTIONAL EQUIPMENT INSTALLED ON THIS VEHICLE BY MANUFACTURER

Base price	37,493.00
CSA STANDARDS	293.00
CUSTOMER CONVENIENCE PACKAGE	4,500.00
XTEND SOLAR I PACKAGE	n/c
MANUAL STAB JACKS	n/c
DINETTE	n/c

UNIT TOTAL **42,286.00**

DEALER INSTALLED OPTIONS

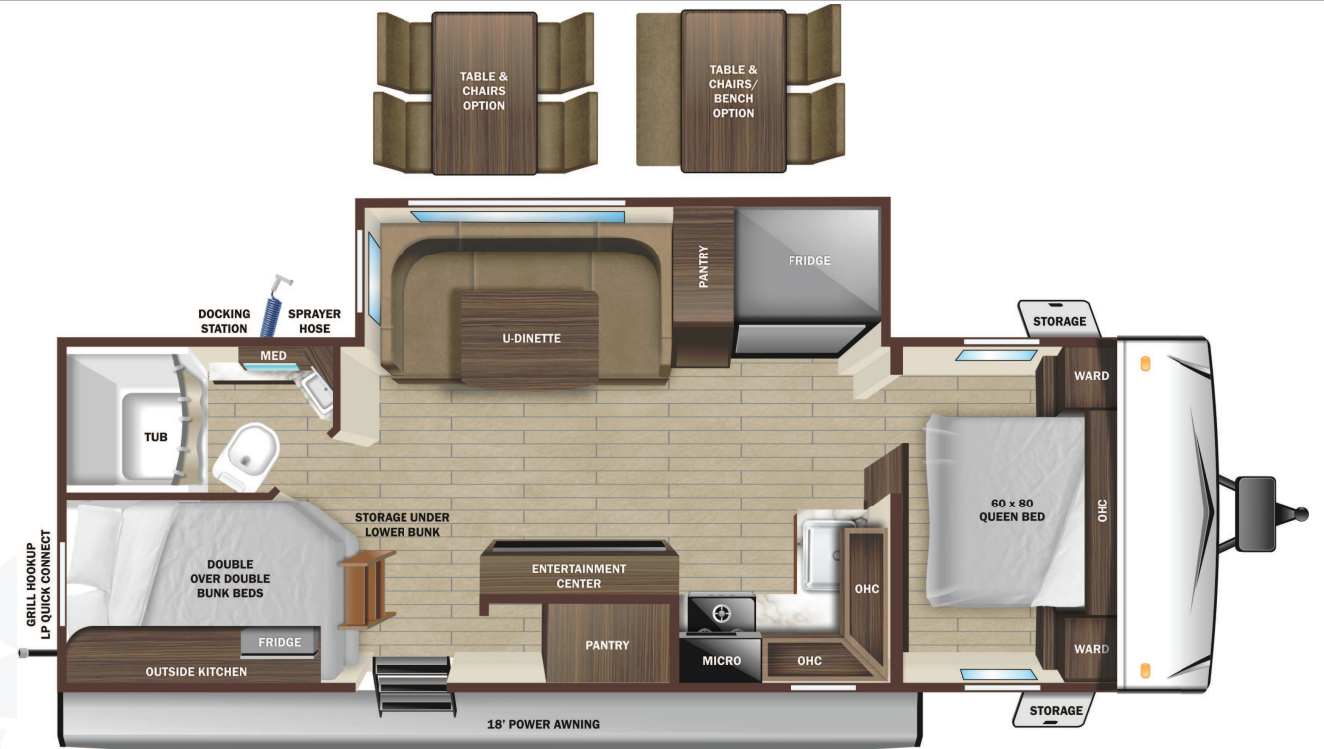

**UVW**  
6472 lbs



**Sleeps**



**Length**  
29' 7.63"

### DIMENSIONS

Exterior height:.....132.25"

Exterior width:.....96.88"

### WEIGHTS

GVWR:.....7500

GAWR (front):.....3500

GAWR (rear):.....3500

Approx. Gross Cargo Carrying Capacity (GCCC):.....1028

### TIRES

Tire size (front):.....ST205/75R14D

Tire size (mid):.....

Tire size (rear):.....ST205/75R14D

### CAPACITIES

Fresh water tank (gals.):...45.00

Gray water tank (gals.):...58.00

Black water/toilet tank (gals.):.....29.00

Propane (lbs.):.....60

Propane (gals.):.....14

Water heater (gals.):.....6.00

### SEATING & SLEEPING

\*\*\*Some dimensions may be rounded and may vary from the actual dimensions\*\*\*

\*\*\*Weights may be estimated calculations and may vary from the actual weight

- refer to the vehicle weight labels for actual weights\*\*\*

Floorplans, features and specifications are subject to change without notice.

