



# Open Range Roamer Light Duty



Serial #: 58TCM0BN8S3DD3066  
 Model: 244RLS OPEN RANGE ROAMER LIGHT DUTY FW

Model Year: 2025 Dealer Name: Recreation USA  
 1801 Hwy 9  
 Longs, SC 29568  
 USA

**Manufacturer's Suggested Retail Price \$70,351.00**

TOTAL AMOUNT DOES NOT INCLUDE STATE AND LOCAL TAXES OR LICENSE FEES. THE PRICE SHOWN ABOVE MAY OR MAY NOT BE REPRESENTATIVE OF THE ACTUAL SELLING PRICE OF SIMILAR RECREATIONAL VEHICLES IN YOUR AREA.

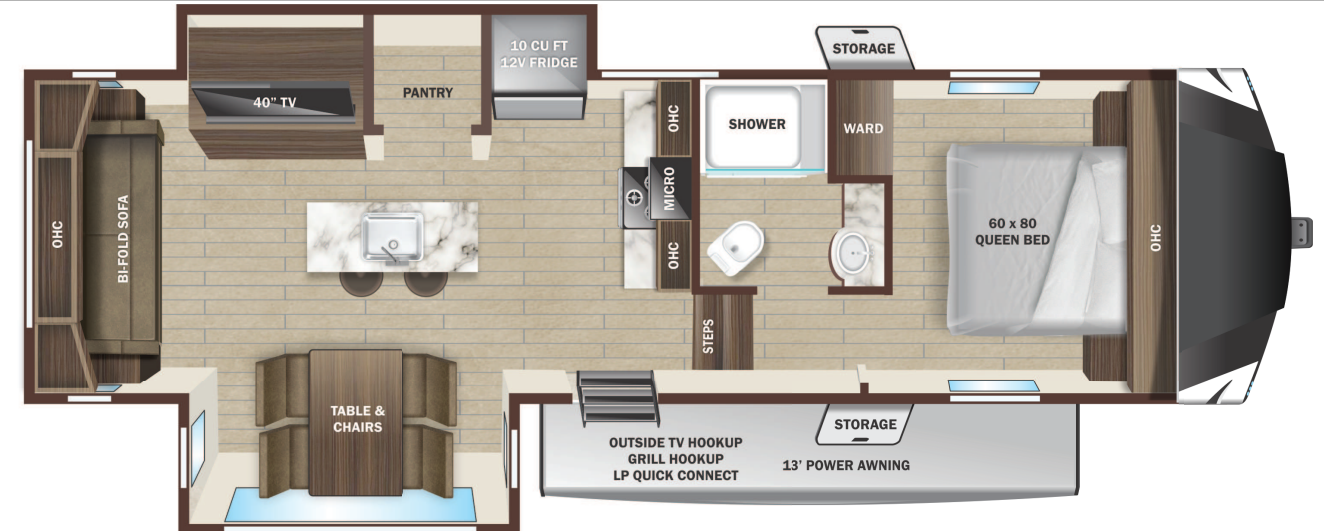

## Standard Equipment

THE FOLLOWING ITEMS ARE STANDARD ON THIS MODEL AT NO EXTRA CHARGE

- EXTERIOR**
- 100" wide body frame
  - 2" receiver hitch
  - 16" Tires and Wheels
  - 3-20 lb. LP bottles
  - 50 amp service
  - ACCU-SLIDE™ slide system (4-corner compression)
  - Battery disconnect switch
  - Brass hanger bushings with wet bolts
  - Equa-Flex® axle suspension
  - Exterior grill/griddle quick connect port
  - Laminated block foam floor
  - LevelLoc™ - 4 point automatic leveling with JT's Strong Arms®
  - PVC roofing membrane (limited lifetime warranty)
  - Rear roof access ladder prep
  - Self-adjusting electric brakes
  - Spare tire
  - TuffShell™ -vacuum bonded laminated construction, reinforced with heavy-duty fiberglass and welded aluminum frames
  - Xtend Solar I Package (1-200 watt solar panel with 30 amp controller)
- FOUR SEASON PACKAGE (Mandatory)**
- Double insulated baggage doors
  - Ducted heat to underbelly with cold air return
  - Enclosed cable operated gate valves
  - Enclosed exterior docking station with black tank flush
  - Heated and enclosed underbelly
  - High performance furnace
  - R-38 reflective foil insulation in ceiling and underbelly
  - R-9 block foam insulation in sidewalls

- INTERIOR**
- 9 cu. ft. Microwave
  - 10 cu. ft. 12V refrigerator
  - 60" x 80" residential queen bed
  - 75 lb. ball bearing drawer guides
  - Cable and satellite prep
  - Flush floor slides with residential vinyl flooring
  - Hardwood cabinet doors
  - Hardwood slideout fascia
  - LED interior lighting
  - Observation camera prep
  - Oven and 3-burner range with flush mount glass cover
  - Pet/Child Screen Guard on Screen Door
  - Roller blackout night shades
- EXECUTIVE PACKAGE (Mandatory)**
- 15,000 BTU roof mounted A/C
  - Cutting board and sink strainer
  - Dome style digital TV antenna with 5G Wi-Fi prep
  - Interior convenience center light
  - Keyed-Alike® entry and baggage doors
  - Painted fiberglass front cap with LED lighting
  - Power awning with LED lighting
  - Quick recovery gas/electric water heater
  - Quick release fresh water drain
  - Residential high-rise faucet with pull-down sprayer
  - Single basin stainless steel under-mount kitchen sink
  - Smart Entertainment HDTV with Bluetooth®, Soundbar and Built in Stereo
  - Solid swing-down entry steps
  - Stainless steel appliances
  - TravelLINK® - Smart RV system that allows for Bluetooth® control of awnings, lighting, slideouts, heating, cooling and more
  - USB/12V charging port

## Optional Equipment

OPTIONAL EQUIPMENT INSTALLED ON THIS VEHICLE BY MANUFACTURER

Base price	61,770.00
USA STANDARDS	n/c
EXECUTIVE PACKAGE	6,000.00
FOUR SEASONS PROTECTION PACKAGE	750.00
NON-POWERED VENT BEDROOM	n/c
POWER FAN VENT BATHROOM	n/c
6 GAL GAS ELECTRIC WATER HEATER	n/c
32" BEDROOM TV	488.00
WINDOWS STANDARD	n/c
THEATER SEATS	1,343.00

UNIT TOTAL **70,351.00**

DEALER INSTALLED OPTIONS

**UVW** 8002 lbs **Sleeps** **Length** 28' 6.75"

### DIMENSIONS

Exterior height:.....157.75"  
 Exterior width:.....100.00"

### WEIGHTS

GVWR:.....9600  
 GAWR (front):.....4400  
 GAWR (rear):.....4400  
 Approx. Gross Cargo Carrying Capacity (GCCC):.....1598

### TIRES

Tire size (front):.....ST235/80R16E  
 Tire size (mid):.....  
 Tire size (rear):.....ST235/80R16E

### CAPACITIES

Fresh water tank (gals.):...55.00  
 Gray water tank (gals.):...60.00  
 Black water/toilet tank (gals.):.....30.00  
 Propane (lbs.):.....60  
 Propane (gals.):.....14  
 Water heater (gals.):.....6.00

### SEATING & SLEEPING

\*\*\*Some dimensions may be rounded and may vary from the actual dimensions\*\*\*  
 \*\*\*Weights may be estimated calculations and may vary from the actual weight - refer to the vehicle weight labels for actual weights\*\*\*  
 Floorplans, features and specifications are subject to change without notice.

