

# PASSPORT

GT SERIES TRAVEL TRAILERS • SL SERIES TRAVEL TRAILERS



BEST IN CLASS  
STORAGE  
ULTRA-LITE SEGMENT



LIVE IT OUT.

# PASSPORT



SL SERIES TRAVEL TRAILERS | GT SERIES TRAVEL TRAILERS

## THE SWISS ARMY KNIFE OF RVs

Passport delivers ultra-lightweight RV camping loaded with multi-functional features and best-in-class storage. Sleek, all-new interior design, an automotive-grade painted front cap and aluminum wheels amp up your style factor.

For more information, please visit [keystonerv.com/Passport](http://keystonerv.com/Passport)

# KEYSTONE EXCLUSIVE INNOVATIONS

Year after year, Keystone RV's experienced team delivers "Built For The Long Haul" quality you expect and exclusive innovations you won't find anywhere else.



## 3-YEAR LIMITED STRUCTURAL WARRANTY, 1-YEAR LIMITED BASE WARRANTY

Every new Keystone RV comes with the industry's best three-year limited structural warranty AND a one-year limited base warranty. Ask your dealer, visit [keystonerv.com](http://keystonerv.com), or call Keystone Owner Relations for details.



### KeyTV™

No more connection guesswork or poor reception. KeyTV offers a game-changing, single point of control of over-the-air, cable, and satellite feeds.

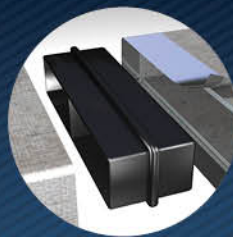

### Tuf-Lok Thermoplastic Duct Joiners

Tuf-lok thermoplastic duct joiners form a permanent, crush-resistant seal in your air-conditioning duct.



### Color-Coded Unified Wiring Standard

Easy-to-trace circuits simplify electrical and entertainment system troubleshooting.



### In-floor Heating Ducts

Distributes heat evenly through your coach for superior comfort.



### HyperDeck™ High-Performance, Water-Resistant RV Floor

The HyperDeck RV floor is more resilient, stronger and lighter than traditional laminated wood construction – and it resists water and water damages.



### Tru-fit™ Slide Construction

A more durable slide room design that minimizes functional motor and structural stress and resists leaking.



more product detail at  
[www.keystonerv.com/Passport](http://www.keystonerv.com/Passport)



# LIGHT & LIVELY

Everything about Passport has been transformed inside and out. With careful planning and material selection, the Passport design team has added residential upgrades including custom cabinetry specific to each floorplan, wood-panel doors, pressed countertops and high arc kitchen faucets, all while keeping these units at an oh-so-towable weight and giving you best-in-class storage.





### A STUDY IN CONTRASTS

Light flooring, countertops, and wall coverings are a modern complement to the clean lines of Passport's arctic teal wood cabinetry.



### SHOW-STOPPING TOUCHES

Passport's NEW interior features a modern and sleek look highlighted by the arctic teal cabinetry and each floorplan is now carpet free.



# blade

HIGH-PERFORMANCE AIR FLOW SYSTEM



## BLADE™ HIGH PERFORMANCE AIR HANDLING SYSTEMS

Engineered to maximize the output from today's high-performance RV air conditioners, Keystone's NEW patented air handling system delivers an average of 20% more cooling power and is built to withstand the rigors of the road. The Blade™ system is designed to accelerate air flow, eliminate leakage and failure points, deliver 360° circulation in the cabin, and withstand environmental and road stressors that lead to reduced performance.

## ZAMP SOLAR PREP

Passport units now feature quality ZAMP solar prep with outlets for solar panels on the roof and on side of the coach. Optional Solar Package (170 solar panel, 30 AMP 5-stage charge controller with omni-mounting feet).



OTG SOLAR

# MODERN AMENITIES

From USB ports to convertible furniture, Passport brings more function and convenience to camping.



1



2



3



4



5



6



7



8



9

#### 1. GLASS-TOP RANGE AND OVEN

Cook in style with a Furrion glass-top range and oven. Glass cover folds to become a backsplash when in use.

#### 2. BUILT-IN USB PORTS

Keep devices charged for the next adventure with multiple USB charging ports featured in every Passport floorplan.

#### 3. PIVOT™ MULTI-FUNCTION SLIDE ROOM FURNITURE

Levered dinette seatback shifts to create an expansive I-shaped sofa, now large enough for lounging or to seat the entire family. Includes storage beneath seats.

#### 4. RESIDENTIAL-SIZE QUEEN BED

All Passports feature a 60" x 80" bed that uses standard queen size bedding (N/A 176BH).

#### 5. NEW & IMPROVED MURPHY BED

The new 60" x 80" mattress lifts and folds easily into a sofa for extra daytime seating and has three huge storage drawers underneath for extra linen storage.

#### 6. TERMINATION VALVE SERVICE LIGHT

Standard on all models, this light allows adjustments to be made with two hands, no flashlight required.

#### 7. INDUSTRY LEADING STORAGE

Passport gives you more storage than any other travel trailer in the industry.

#### 8. ELECTRIC STABILIZER JACKS

All units now standard with electric stabilizers.

#### 9. DEEP-SEATED STAINLESS STEEL SINK

Includes cover and residential pull-down faucet



more product detail at  
[www.keystonerv.com/Passport](http://www.keystonerv.com/Passport)

## PASSPORT GT SERIES | TOP FEATURES

- Automotive painted fiberglass front cap
- Lippert® Solid Step® for safe and secure entry
- Exceptional 45 cu. ft. pass-through storage with magnetic door hold
- Exterior television hookup and backer
- Exterior hot and cold shower
- Service light near termination valves
- Exclusive KeyTV™ multisource controller for satellite, cable, and over-the-air feeds
- 4G LTE and Wi-Fi prep
- Roof and suitcase style solar prep standard
- Backup camera prep
- Black tank flush
- Heated and enclosed underbelly and valves
- 82.5" Vaulted ceiling
- LED 40" TV standard
- Roof ladder
- Walkable roof
- 60" x 80" queen bed
- Multiple USB ports
- Aluminum wheels standard
- Seamless, one-piece upgraded countertops
- Glass-top range with gas oven
- Deep-seated stainless steel sink with cover and residential pull-down faucet
- High performance in-floor heat duct system
- Motion activated lighting at main entrance and pass-through storage
- Power tongue jack
- 10.7 cu. ft. 12V refrigerator (8 cu. ft. gas/electric refrigerator optional)
- Electric stabilizer jacks



**REAR CARGO DOOR ON ALL DOUBLE-OVER-DOUBLE BUNKS**  
Convenient added storage (219BH, 221BH, 268BH, 2401BH and 2951BH)



**SOLID STEP®**  
Safe and secure main entry with extendable legs and feet for maximum stability



**OUTSIDE KITCHEN**  
Prepare meals campside with outdoor cooktops, refrigerators and spray ports on select models.



**KEYSHIELD™**  
Automotive grade painted fiberglass front cap with chip and rock guard protection.



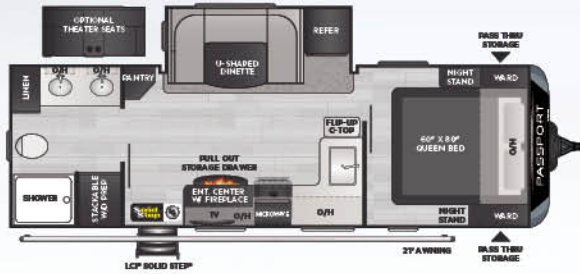

**NEW!** 2400RB | Rear bath, 60 x 80 queen bed, double vanity, W/D prep

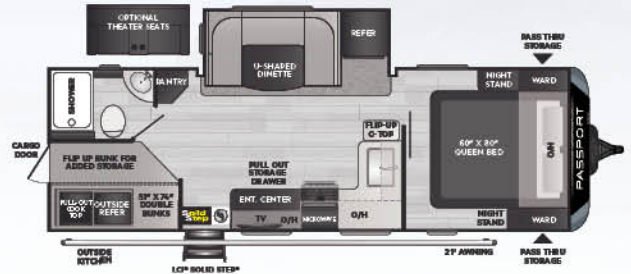

**2401BH** | Mid-dinette bunkhouse, rear bath, STOW-N-GO cargo door

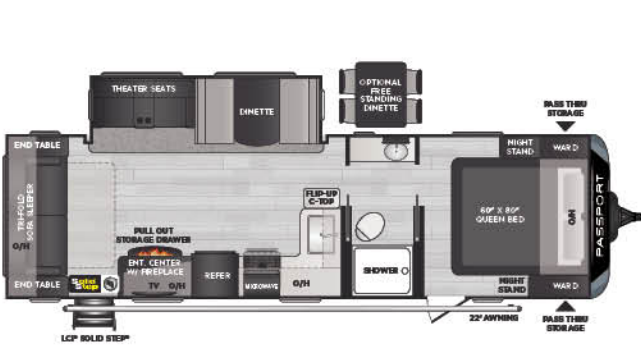

**2700RL** | Rear living, 60 x 80 queen bed

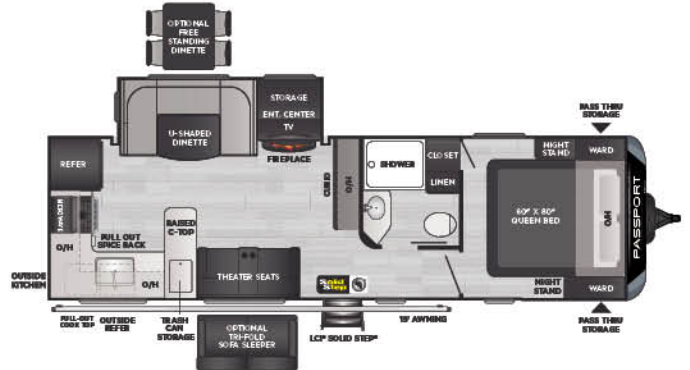

**NEW!** 2704RK | Rear kitchen w/ dinette side

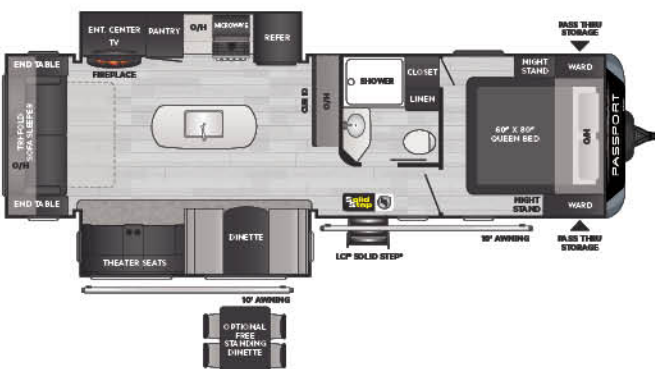

**NEW!** 2870RL | Rear living, pantry, 60" x 80" queen bed

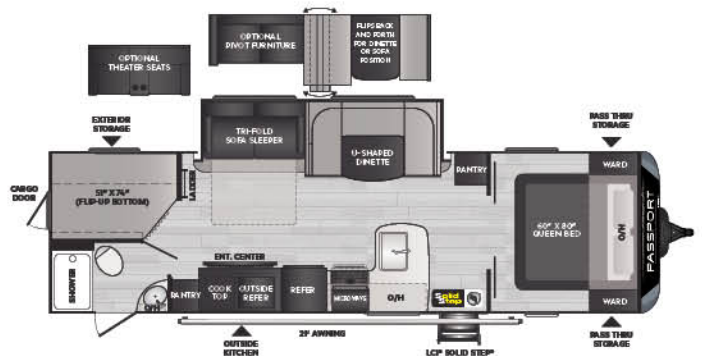

**2951BH** | Multi-purpose bunkhouse w/ outside kitchen

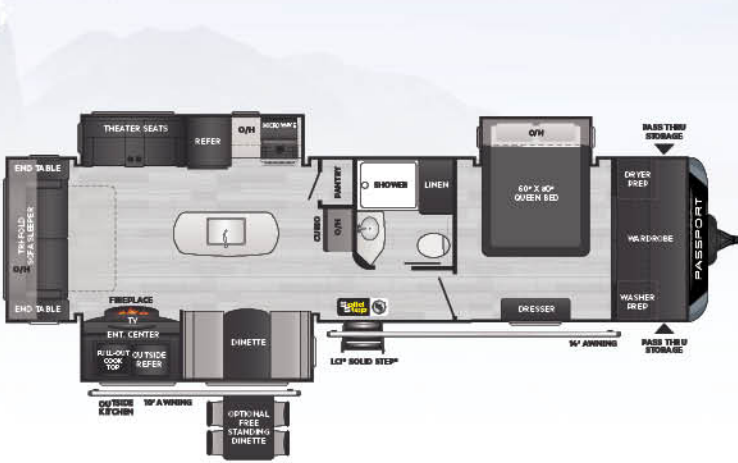

**NEW! 3200RL** | Rear living, 60 x 80 queen bed, outside kitchen, W/D prep

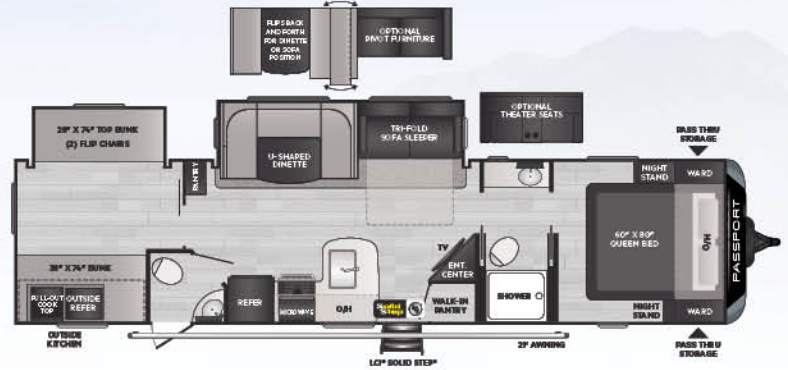

**3352BH** | Rear bunkhouse w/ 1 1/2 bath, dual entry w/ large pantry

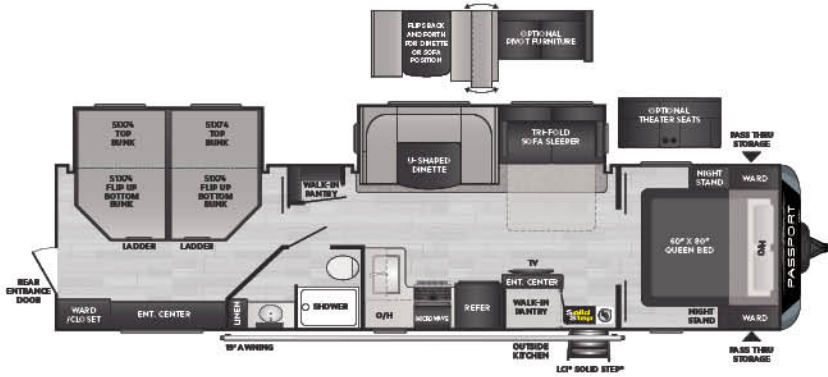

**3401QD** | Private quad bunk w/ dual entrance, walk-in pantry



more product detail at [www.keystonerv.com/Passport](http://www.keystonerv.com/Passport)

# PASSPORT SL SERIES | TOP FEATURES

- Exceptional 45 cu. ft. pass-through storage with magnetic door holds
- Electric stabilizer jacks
- Exterior hot and cold shower
- Service light near termination valves
- Exclusive KeyTV™ multisource controller for satellite, cable, and over-the-air feeds
- 4G LTE and Wi-Fi prep
- Solar prep
- Blank tank flush
- 60" x 80" queen bed (N/A 176BH)
- USB ports throughout
- LED TV standard
- Slam latch baggage doors
- Roof ladder
- Furrion® glass-top range with gas oven
- Seamless, one-piece kitchen countertops
- Deep-seated stainless steel sink with cover
- Residential pull-down faucet
- Motion activated lighting at main entrance and pass-through storage
- 6 cu. ft. gas/electric refrigerator (12V 7 cu. ft. refrigerator optional)
- High performance in-floor heat duct system (standard in models 221BH, 268BH and 282BH)
- Heated and enclosed underbelly and valves
- Power tongue jack



**REAR CARGO DOOR ON ALL DOUBLE-OVER-DOUBLE BUNKS**  
Convenient added storage (219BH, 221BH, 268BH, 2401BH and 2951BH)



**KITCHEN APPLIANCES**  
Chef-inspired appliances that give you the perfect blend of performance, precision and style.



**PASS-THROUGH STORAGE WITH OVERSIZED BAGGAGE DOORS**  
There is plenty of room to take all of your family's supplies with you on your adventure.



**SEAMLESS, ONE-PIECE COUNTERTOPS**  
Sturdy and water-resistant, these beautiful countertops are a Passport standard.



**176BH** | Single-axle bunkhouse w/ queen bed

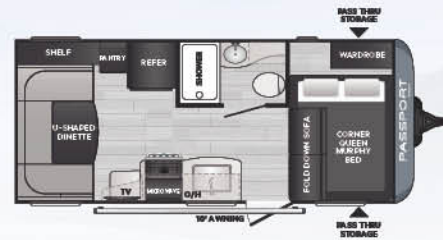

**NEW!** **178RD** | Single axle couple's coach w/ oversized dinette

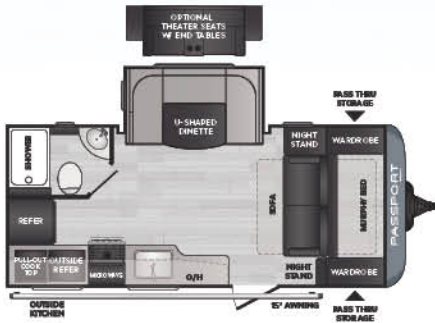

**NEW!** **181MK** | Single axle couple's coach, single-slide, outside kitchen



more product detail at [www.keystonerv.com/Passport](http://www.keystonerv.com/Passport)

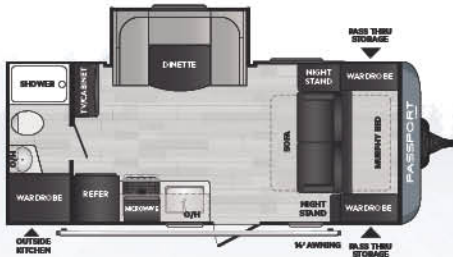

**189RB** | Rear bath, single-slide, couple's coach w/ outside kitchen

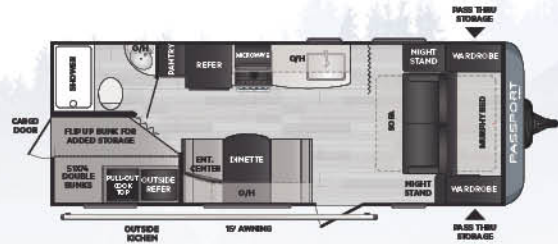

**219BH** | Bunkhouse w/ Murphy bed, outside kitchen

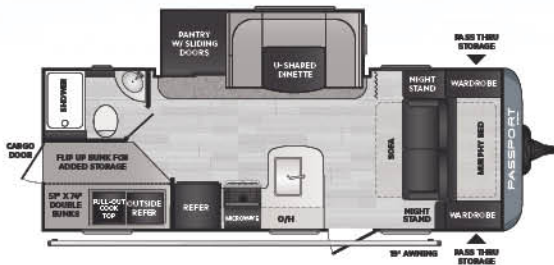

**221BH** | Bunkhouse w/ Murphy bed, dinette slide and outdoor kitchen

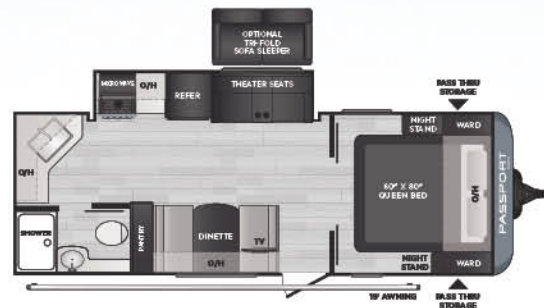

**NEW!** **229RK** | Rear kitchen w/ 60" x 80" queen bed, private bedroom

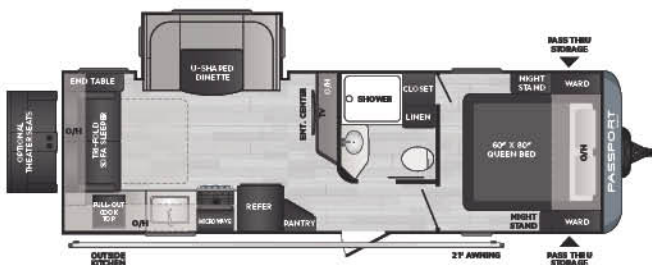

**252RL** | Rear living, outside kitchen w/ 60" x 80" queen bed

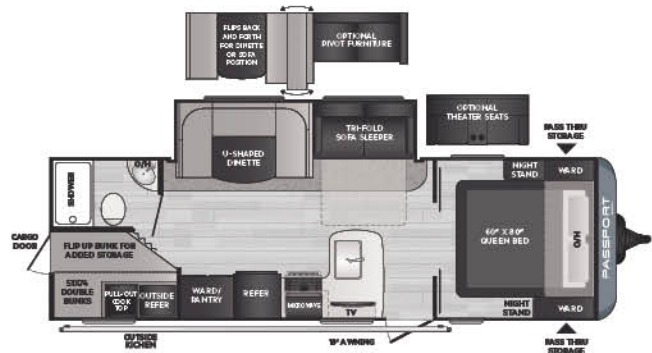

**268BH** | Super-slide, bunkhouse w/ 60" x 80" queen bed

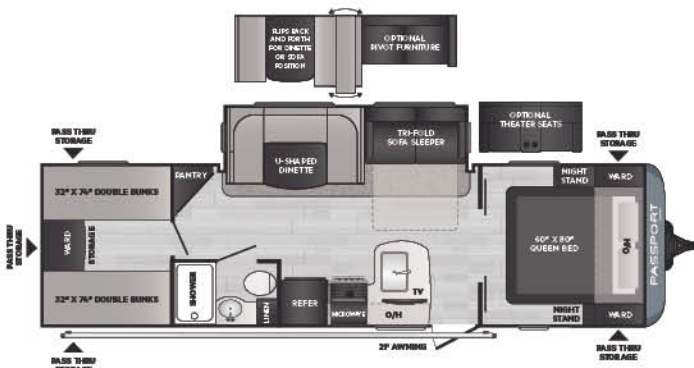

**282QB** | Quad bunkhouse w/ u-shaped basement storage



more product detail at  
[www.keystonerv.com/Passport](http://www.keystonerv.com/Passport)

# WESTERN GT-SERIES | TOP FEATURES

BUILT FOR THE WESTERN REGION OF NORTH AMERICA

- Automotive painted fiberglass front cap
- Lippert® Solid Step® for safe and secure entry
- Exceptional 45 cu. ft. pass-through storage with magnetic door hold
- Exterior television hookup and backer
- Exterior hot and cold shower
- Load equalization axles (stability and weight equalization)
- Service light near termination valves
- Exclusive KeyTV™ multisource controller for satellite, cable, and over-the-air feeds
- 4G LTE and Wi-Fi prep
- Roof and suitcase style solar prep standard
- Backup camera prep
- Black tank flush
- Heated and enclosed underbelly and valves
- 82.5" Vaulted ceiling
- 60" x 80" queen bed (N/A 176BH, 3352BH, 3410QD)
- Multiple USB ports
- Walkable roof
- Aluminum wheels standard
- Seamless, one-piece upgraded countertops
- Furrion® glass-top range with gas oven
- Deep-seated stainless steel sink with cover and residential pull-down faucet
- High performance in-floor heat duct system
- Motion activated lighting at main entrance and pass-through storage
- Power tongue jack
- 8 cu ft refrigerator
- Electric stabilizer jacks



**REAR CARGO DOOR ON ALL DOUBLE-OVER-DOUBLE BUNKS**  
Convenient added storage (219BH, 221BH, 268BH, 2401BH and 2951BH)



**LIPPERT® SOLID STEP®**  
Safe and secure main entry with extendable legs and feet for maximum stability



**OUTSIDE KITCHEN**  
Prepare meals campside with outdoor cooktops, refrigerators and spray ports on select models.



**KEYSHIELD™**  
Automotive grade painted fiberglass front cap with chip and rock guard protection.

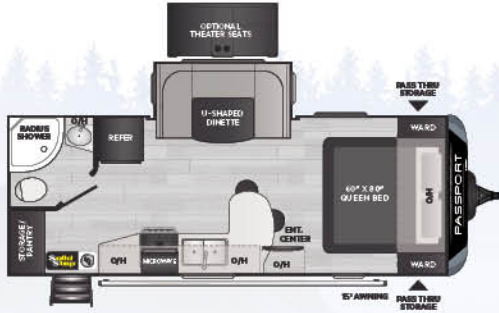

**2210RBWE** | Single-slide couple's coach

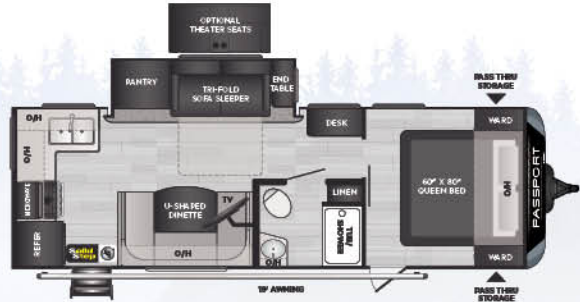

**2500RKWE** | Single slide, ultimate couple's coach w/desk

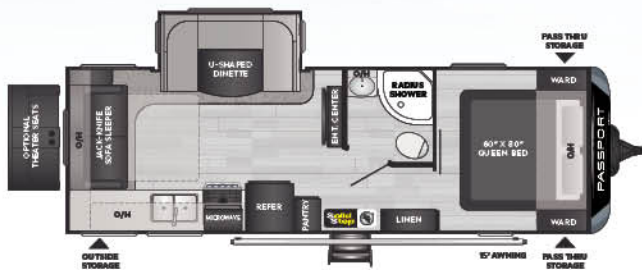

**2521RLWE** | Single-slide, ultimate couples coach

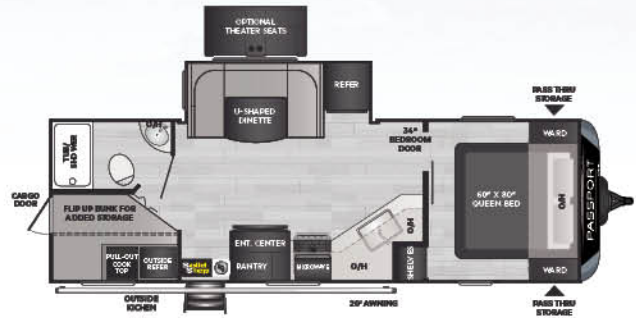

**2600BHWE** | Double over double bunkhouse, with outside kitchen

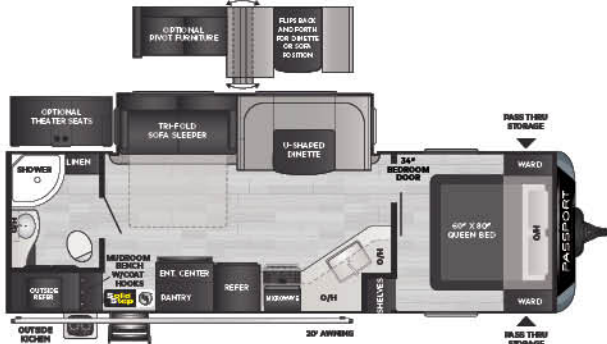

**2710RBWE** | Mud room bench w/ coat hooks, walk-in pantry

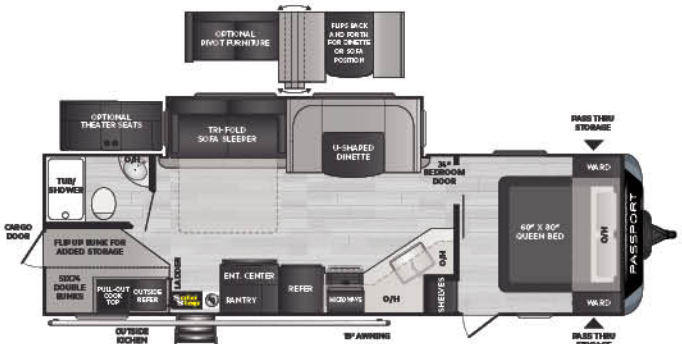

**2820BHWE** | Multi-purpose bunkhouse w/ outside kitchen

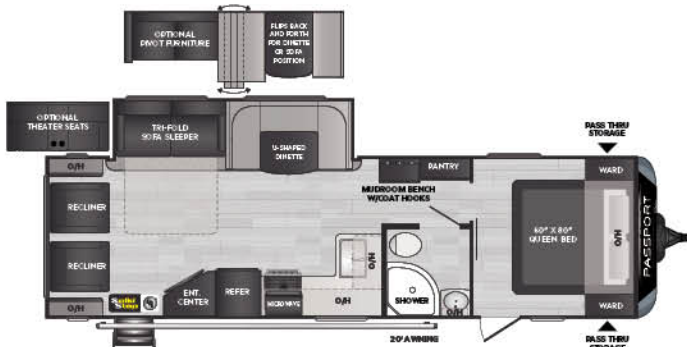

**2900RLWE** | Super-slide/rear living

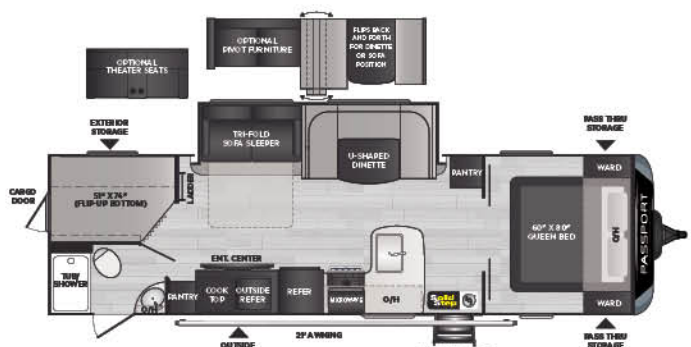

**2950BHWE** | Multi-purpose bunkhouse w/ outside kitchen



more product detail at  
[www.keystonerv.com/Passport](http://www.keystonerv.com/Passport)

# WESTERN SL-SERIES | TOP FEATURES

BUILT FOR THE WESTERN REGION OF NORTH AMERICA

- Exceptional 45 cu. ft. pass-through storage with magnetic door holds
- Electric stabilizer jacks
- Exterior hot and cold shower
- Service light near termination valves
- Exclusive KeyTV™ multisource controller for satellite, cable, and over-the-air feeds
- 4G LTE and Wi-Fi prep
- Solar prep
- Blank tank flush
- 60" x 80" queen bed (N/A 176BH)
- USB ports throughout
- Furrion® glass-top range with gas oven
- Seamless, one-piece kitchen countertops
- Deep-seated stainless steel sink with cover
- Residential pull-down faucet
- Motion activated lighting at main entrance and pass-through storage
- 6 cu. ft. refrigerator
- High performance in-floor heat duct system (standard in models 221BH, 258BH and 282BH)
- Heated and enclosed underbelly and valves
- Power tongue jack



**REAR CARGO DOOR ON ALL DOUBLE-OVER-DOUBLE BUNKS**  
Convenient added storage (239ML, 240BH, 267BH, 2600BH, 2820BH and 2950BH)



**SOLID STEP®**  
Safe and secure main entry with extendable legs and feet for maximum stability



**OUTSIDE KITCHEN**  
Prepare meals campside with outdoor cooktops, refrigerators and spray ports on select models.



**SEAMLESS, ONE-PIECE COUNTERTOPS**  
Sturdy and water-resistant, these beautiful countertops are a Passport standard.



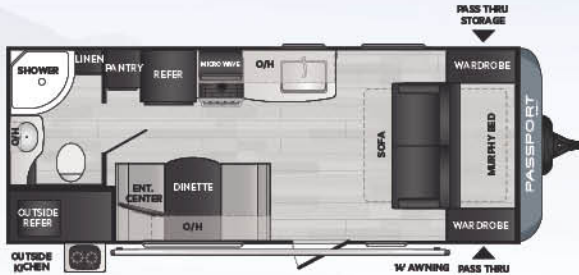

**197RBWE** | Double-axle couples coach

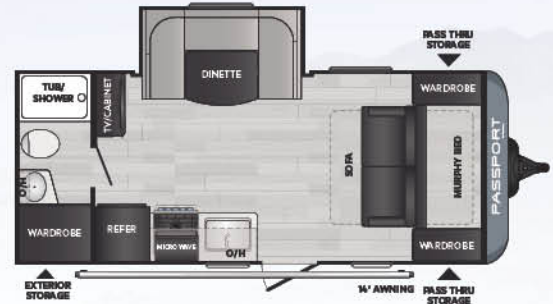

**199MLWE** | Double-axle couple's coach w/ u-shaped dinette slideout

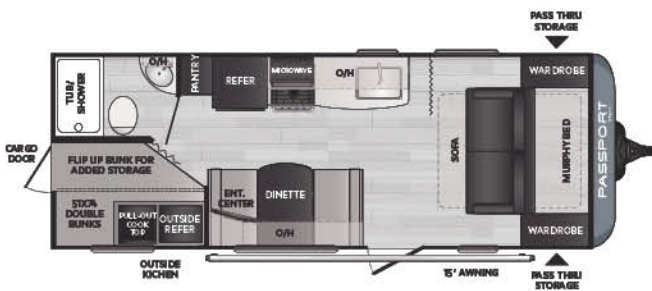

**239MLWE** | Murphy bed, bunkhouse w/ outside kitchen

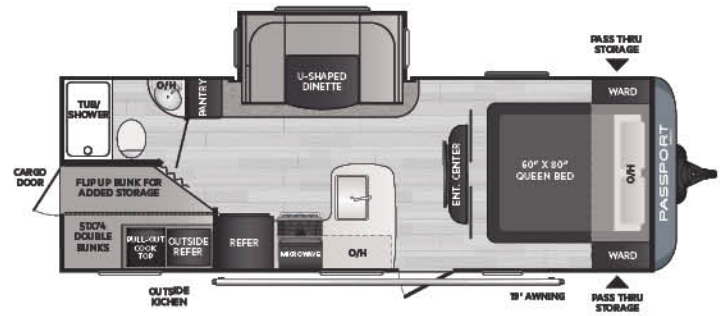

**240BHWE** | Bunkhouse w/ queen bed

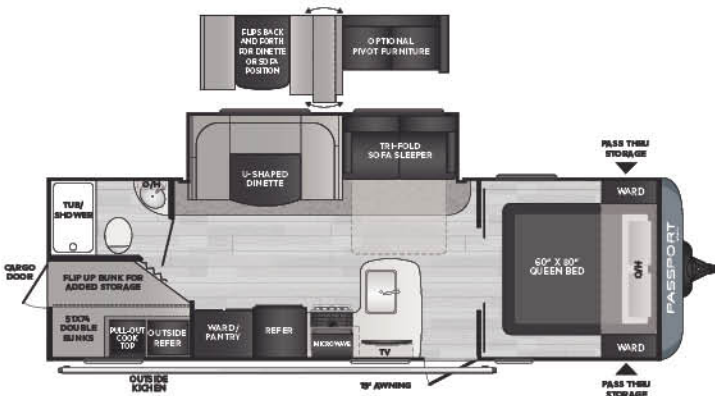

**267BHWE** | Super-slide, bunkhouse w/ 60" x 80" queen bed

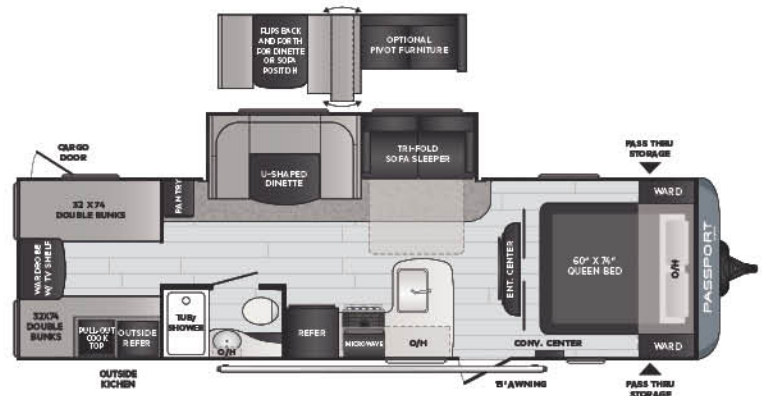

**292BHWE** | Couple's coach w/ oversized dinette

### SL-SERIES TRAVEL TRAILERS

MODEL	WEIGHT	CARRYING CAPACITY	HITCH WEIGHT	FRESH WATER	WASTE WATER	GRAY WATER	LPG	LENGTH*	WIDTH	HEIGHT	AWNING
176BH	TBD	TBD	TBD	TBD	TBD	TBD	TBD	TBD	TBD	TBD	TBD
178RD	TBD	TBD	TBD	TBD	TBD	TBD	TBD	TBD	TBD	TBD	TBD
181MK	TBD	TBD	TBD	TBD	TBD	TBD	TBD	TBD	TBD	TBD	TBD
189RB	4147	1253	425	43	30	30	40	22' 9"	8'	10' 4"	14'
219BH	4430	2000	475	43	38	38	40	25' 5"	8'	10' 4"	15'
221BH	5175	1825	685	43	38	38	40	26'	8'	10' 8"	15'
229RK	TBD	TBD	TBD	43	30	30	40	26' 10"	8'	10' 8"	19'
252RL	5359	1641	635	43	38	76	40	29' 10"	8'	10' 8"	15'
268BH	5550	1650	695	43	30	30	40	30' 6"	8'	10' 8"	19'
282QB	5743	1457	755	43	30	30	40	32' 4"	8'	10' 8"	15'

### GT-SERIES TRAVEL TRAILERS

MODEL	WEIGHT	CARRYING CAPACITY	HITCH WEIGHT	FRESH WATER	WASTE WATER	GRAY WATER	LPG	LENGTH*	WIDTH	HEIGHT	AWNING
2400RB	TBD	TBD	TBD	43	38	76	40	28' 10"	8'	10' 8"	21'
2401BH	TBD	TBD	TBD	TBD	TBD	TBD	TBD	TBD	TBD	TBD	TBD
2700RL	TBD	TBD	TBD	TBD	TBD	TBD	TBD	TBD	TBD	TBD	TBD
2704RK	TBD	TBD	TBD	43	38	76	40	31' 3"	8'	10' 8"	19'
2870RL	TBD	TBD	TBD	43	38	76	40	32' 8"	8'	11' 2"	10'/10'
2951BH	TBD	TBD	TBD	43	38	76	40	33' 4"	8'	11' 2"	21'
3200RL	TBD	TBD	TBD	TBD	TBD	TBD	TBD	TBD	TBD	TBD	TBD
3352BH	TBD	TBD	TBD	43	38	76	40	37' 11"	8'	11' 2"	21'
3401QD	TBD	TBD	TBD	TBD	TBD	TBD	TBD	TBD	TBD	TBD	TBD

### WESTERN TRAVEL TRAILERS

MODEL	WEIGHT	CARRYING CAPACITY	HITCH WEIGHT	FRESH WATER	WASTE WATER	GRAY WATER	LPG	LENGTH*	WIDTH	HEIGHT	AWNING
197RBWE	4269	1331	416	43	30	30	40	24' 6"	8'	10' 4"	14'
199MLWE	4210	1190	494	43	30	30	40	23' 4"	8'	10' 2"	14'
239MLWE	4430	2000	436	43	30	30	40	25' 5"	8'	10' 2"	15'
240BHWE	5069	1931	526	43	30	30	40	27' 10"	8'	10' 7"	19'
267BHWE	TBD	TBD	TBD	43	30	30	40	31' 0"	8'	10' 8"	19'
292BHWE	5878	1322	714	43	30	30	40	32' 10"	8'	10' 9"	15'
2210RBWE	4796	2704	560	43	30	30	40	26' 3"	8'	11' 0"	15'
2400RBWE	TBD	TBD	TBD	43	38	76	40	28' 10"	8'	10' 8"	21'
2500RKWE	5530	1470	730	43	30	60	40	29' 3"	8'	11' 2"	19'
2521RLWE	5450	1550	640	43	30	60	40	29' 10"	8'	10' 8"	15'
2600BHWE	5510	1690	650	43	30	60	40	30' 7"	8'	11' 2"	19'
2710RBWE	5770	1430	690	43	30	60	40	31' 5"	8'	10' 8"	15'
2820BHWE	6040	1160	740	43	30	60	40	32' 11"	8'	11' 2"	19'
2900RLWE	6115	1085	740	43	30	30	40	33' 6"	8'	11' 2"	19'
2950BHWE	5878	1322	714	43	30	30	40	32' 10"	8'	10' 9"	15'

DISCLAIMER: Product information is as accurate as possible as of the date of publication of this brochure. All features, floor plans, and specifications in this brochure are subject to change without notice. Please also consult Keystone's web site at [www.keystonerv.com](http://www.keystonerv.com) for more current product information and specifications. Tow Vehicle Disclaimer. CAUTION: Owners of Keystone recreational vehicles are solely responsible for the selection and proper use of tow vehicles. All customers should consult with a motor vehicle manufacturer or their dealer concerning the purchase and use of suitable tow vehicles for Keystone products. Keystone disclaims any liability or damages suffered as a result of the selection, operation, use or misuse of a tow vehicle. KEYSTONE'S LIMITED WARRANTY DOES NOT COVER DAMAGE TO THE RECREATIONAL VEHICLE OR THE TOW VEHICLE AS A RESULT OF THE SELECTION, OPERATION, USE OR MISUSE OF THE TOW VEHICLE. \*Length is defined as the distance from the centerline of hitch pin/coupler to rear bumper of trailer. Please review owner's manual prior to purchase for more information on service warranties, extended use, towing and maintenance. Owner's manuals can be found at [keystonerv.com](http://keystonerv.com).

**CHASSIS**

- Engineered specifically for each floor plan
- Tube-style bumper w/sewer hose storage (GT Series EAST Only) (Standard In West)
- Fully-welded outriggers
- Cambered for added structural support
- Extra support cross members
- Electric Cable slide-out system
- Enclosed, sealed and heated underbelly
- Welded aluminum framed sidewalls

**CONSTRUCTION**

- Seamless, laminated gel-coated filon exterior walls
- High-density block foam insulation in sidewalls (R-7 insulation)
- Laminated aluminum framed floor 2" thick
- R-11 high density block floor insulation
- 5 1/4" Crowned Roof Rafters (SL Series)
- Vaulted Ceiling Roof Rafters (GT Series)
- One piece seamless Alpha Superflex TPO roof
- Insulated lockable radius baggage doors with hold backs
- HyperDeck composite floor with R-13 high density block foam

**EXTERIOR FEATURES**

- Insulated radius entrance door with screen door
- Double entry steps at main door (SL Series only)
- Lippert® Solid Step® for safe and secure entry (GT Series only)
- Heavy-duty Electric Tongue Jack
- 4 Electric Stabilizer Jacks
- Two (2), 20 lb. propane bottles with flip-top cover
- Dual battery rack over A-frame
- Rain gutters with extended downspouts
- Electric adjustable awning
- Lighted exterior pass-through storage compartment w/motion light\*
- Portable outdoor grill (select models), not all outside kitchen models
- Patio entrance light
- Exterior shower w/ hot and cold taps
- Front diamond plate
- 2-Tone Painted Fiberglass front cap w/KeyShield™ rock guard (GT Series only)
- Fold-away exterior grab handle (main door, GT Series only)
- Load equalization axles (spread axle design). Excludes 197RB/199ML/239ML
- Dexter® E-Z lube axles
- Exterior speakers
- Exterior light at dump valves
- 15" aluminum wheels
- 15" radial tires
- Aluminum step
- Upgraded graphics package
- LED awning lights
- Black tank flush
- Satellite prep

**Solar prep**

- Backup camera prep (GT series only)
- Friction hinge door at main entrance
- Residential-style furniture with premium fabric
- Convenience center with slide, lights, awning, water system controls, and 110V receptacle
- Roof Mounted Solar Inverter Prep

**INTERIOR FEATURES**

- 13,500 BTU A/C standard (SL Series)
- 15,000 BTU A/C standard (GT Series)
- 30,000 BTU furnace
- Ducted, in-floor heating (GT Series & SL Series)
- 6-gallon gas/electric DSI water heater (17.8 gal/hr)
- Winterization-ready water system
- Residential durable Armstrong® vinyl flooring
- 12VAM/FM stereo, AUX input, Bluetooth and quality sound speakers
- LED, flat-screen HDTV, standard
- Upgraded residential window treatments and valances
- Residential-style interior doors
- Upgraded leather furniture w/tri-fold sofa
- LED interior lights
- Vaulted ceiling (GT Series only)
- USB charging ports throughout
- Heated and enclosed underbelly

**KITCHEN**

- 6 cu. ft. double-door RV refrigerator (SL Series only)
- 8 cu. ft. RV refrigerator (GT Series only)
- Glass-top stove
- Metal high-rise faucet
- Microwave with carousel
- 3-burner, high output range
- Range hood
- Shaker style wood cabinets
- Gas oven (N/A 175BH)
- Seamless countertops
- Stainless steel sink w/pull-down faucet
- Trash can storage (select models)
- 60" x 80" queen size bed (N/A 3351BH)
- Quilted bed sheets
- Oversized wardrobes

**BEDROOM (MAIN)**

- Nighttime reading lights
- Under-bed storage
- Bedside power outlets w/USB ports
- Solid wood, custom-built medicine cabinet w/mirror
- Tub surround with built-in shelves
- Radius shower curtain
- Pedestal foot flush toilet

**BATHROOM**

- 12V power exhaust fan

**SAFETY**

- Four-wheel electric brakes
- Breakaway switch
- Heavy duty safety chains with clasp
- 12V power exhaust fan
- Tinted safety glass windows
- Multiple emergency egress windows
- GFI receptacles
- Carbon monoxide detector
- Smoke alarm
- Fire extinguisher
- Propane gas leak detector
- Deadbolt lock on entrance doors
- Manual override on slide system
- Spare tire kit
- Snow load roofs

**WESTERN EDITION FEATURES**

- Snow load roofs

**OPTIONS**

- 15,000 BTU A/C (SL Series)
- 50 AMP Service w/2nd A/C prep (N/A on 2210RB, 2500RK, 2521RL, 2600BH or Western Edition Models)
- Theatre seating IPO tri-fold sofa (GT Series only)
- Pivot furniture (267BH, 292BH, 2710RB, 2820BH, 2900RL, 2950BH, 3221BH, 3351BH and 3400QD)
- 2nd 13,500 BTU A/C installed (Available on 3221BH, 3351BH, 3400QD)
- OTG Solar Pkg (Solar Panel, Inverter, Controller, Mounting Feet - Installed)
- 8 cu. ft. 12V refrigerator (GT Series only)
- 7 cu. ft. 12V refrigerator (SL Series only)

# BUILT FOR THE LONG HAUL



## 1 EASIER SHOPPING.

At Keystone, we make choosing an RV as easy as finding the Big Dipper on a dark summer night. With comprehensive online product information, Key Connect™ product advisors, and an unparalleled dealer network, we will help you select the perfect RV for your family's adventure.

## 2 INNOVATIVE THINKING.

The road's a nicer place when you have the industry's smartest features behind you. Keystone leads the pack in patented innovations that make our RVs safer, more comfortable, and easier to operate.

## 3 LONG HAUL QUALITY.

To keep you on the road, there are certain things we just won't build a Keystone RV without. Game-changing features like our Unified Wiring Standard, Tru-Fit™ five-point slide construction, and no-fail Tuf-Lok™ A/C duct joiners combined with exhaustive testing and inspections are some of the reasons why Keystone is able to offer our owners the industry's best 3-year limited structural warranty.

## 4 WORRY-FREE CUSTOMER SERVICE.

Wherever the road takes you, you're never too far from an authorized Keystone service center. We also offer live service assistance, ultra-fast parts shipping, online maintenance tips and tricks, and a single-point warranty claims policy. *That's* peace of mind.

## 5 KEYSTONE NATION.

When you choose Keystone, you become a part of one of the largest camping families in the country. We're Keystone Nation. A friendly community where people share photos, travel tips and amazing stories — all in the spirit of camaraderie and adventure. Come join us.