

FIFTH WHEELS & TRAVEL TRAILERS

REFLECTION[®]



GRAND DESIGN[®]
RECREATIONAL VEHICLES



REFLECTION



A CELEBRATION OF LUXURY, VALUE & TOWABILITY

Reflection's combination of luxury, value, and towability in one amazing package continues to exceed the expectations of our retail customers. Our industry leading pursuit of quality and commitment to building around the needs of our retail customers is what drives Reflection to the top of its class.



Travel Trailers



150 Series Fifth Wheels



Fifth Wheels

CONSTRUCTED TO A SUPERIOR STANDARD

ARCTIC 4-SEASONS PROTECTION PACKAGE

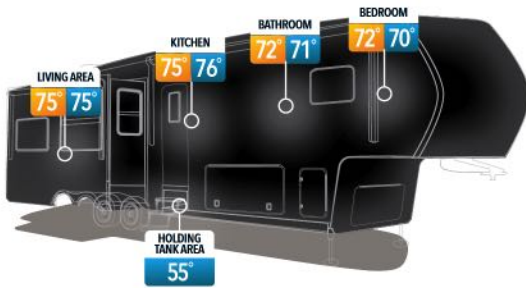

Reflection's design has been put to the test in extreme temperatures ranging from ZERO to 100+ degrees. Third party extreme cold testing showed that the Reflection remained functional and achieved very comfortable temperatures.

Note: Testing was performed in a temperature controlled chamber, with temperatures ranging from -6°F to +101°F, and does not account for variables such as wind, humidity, and altitude. Due to the number of potential variables, temperatures reported during testing may differ from temperatures achieved during actual use of the unit in nature.

MAXIMUM HEATING POWER

A high performance furnace and fireplace combine to deliver 40,000 BTU's or more of heating power.†

† (Model Specific)

MAXIMUM FUNCTION

- Heated Holding Tanks
- Heated & Enclosed Low Point Drains
- Heated Utility Center & Storage Bay (FW only)
- 12 Volt Heat Pads on all Holding Tanks
- Dual Attic Vents
- Enclosed Gate Valves



FULLY LAMINATED WALLS

Sidewalls, rear wall, slideroom endwalls, and slideroom roof are all laminated construction with rigid foam insulation. Many competitors use soft fiberglass insulation in the rear wall and sliderooms that can settle over time and leave uninsulated air gaps.

† R-11 on bed slide models



DOUBLE INSULATED ROOF & FRONT CAP

A layer of fiberglass insulation and a layer of radiant foil insulation covers the full length of the roof. Grand Design goes the extra mile by extending both the radiant foil and fiberglass insulation layers from the roof, and wraps them all the way around to the bottom of the front cap.



DOUBLE INSULATED FLOOR

The heated underbelly features a layer of radiant foil insulation and the main floor another layer of fiberglass insulation.

The slideroom floors are also insulated with radiant foil. (R-24)*



DOUBLE INSULATED FLOOR

The heated underbelly features a layer of radiant foil insulation and the main floor another layer of high density foam insulation.

The slideroom floors are also insulated with radiant foil. (R-24)*



INSULATED GOOSENECK

A layer of fiberglass insulation under the gooseneck is a place often forgotten by others.



HEAVY DUTY INSULATED BAGGAGE DOORS

*Equivalent R-Value

CONSTRUCTED TO A SUPERIOR STANDARD

RACETRACK DUCTING

True Racetrack Ducting extends past each AC unit to allow for uninterrupted airflow from the front to the back of the coach.



These end loops in the ducting are essential for true "racetrack" movement.



TYPICAL DUCTING

Typical ducting provides partial airflow with less cooling efficiency and creates airflow collision in the center.



MAGNETIC STORAGE DOOR CATCHES



6' COILED HOSE BREAKAWAY CABLE



MOTION SENSOR LED LIGHTING



OVERSIZED TANK CAPACITIES



MORE OUTLETS



USB PORTS (2)



EXTERIOR COAX SAT/CABLE

RAISING THE BAR IN CUSTOMER SERVICE & WARRANTY

COVERS EXTENDED STAY

Many of our competitors have fine print in their warranty excluding you from coverage if you are full-timing in your coach. You won't find fine print like that in Grand Design's warranty.

Every Grand Design RV is backed with a class leading 3-year limited structural warranty. By selecting suppliers with similar philosophies, many components used on our coaches also carry an extended warranty through the component manufacturer.

3 YEAR LIMITED STRUCTURAL WARRANTY

AXLES (5 Years)

CHASSIS (3 Years)
(Main Steel Frame, Steel Frame Outriggers and Cross Members)

EXTERIOR GRAPHICS (5 Years)

ROOF COVERING (12 Years)

TIRE WARRANTY
(5 Years w/12 Month no questions asked replacement for manufacturer defects)

TRAVEL TRAILERS

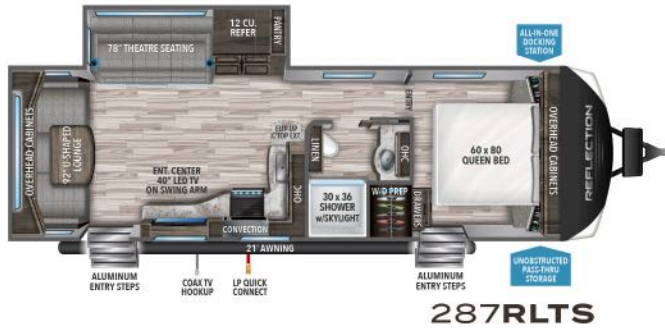

287RLTS



300RBTs



297RSTs

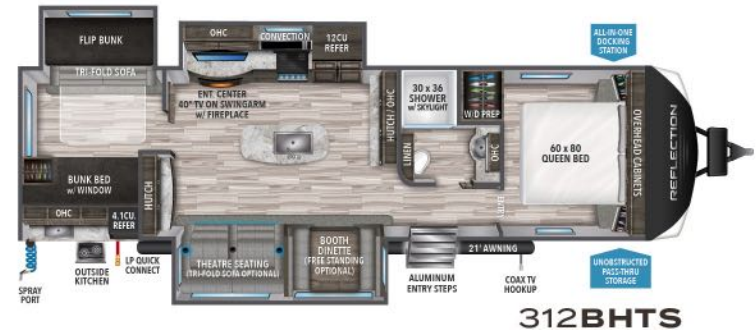

312BHTs

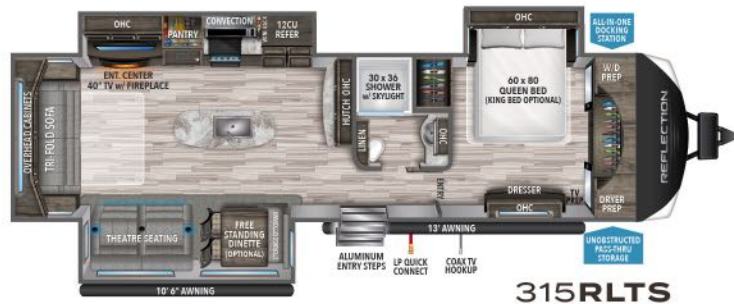

315RLTS



15,000 BTU
DUCTED AC



35,000 BTU
FURNACE



RECEIVER HITCH
FOR CARGO / BIKES



50 AMP
ELECT. SERVICE



UNOBSTRUCTED
PASS-THRU STORAGE



HEAVY DUTY
E-RATED TIRES



LIVING AREA 315RLTS



KITCHEN 312BHTS



LIVING AREA 287RLTS

EXTERIOR & CONSTRUCTION

Aerodynamic Front Cap w/ Max Turn Radius and Integrated LED Lights
 Aluminum Wheels with E-Rated Tires
 80% Tint Radius Safety Glass Windows
 Battery Kill Switch in Pass Thru Storage Area
 30# LP Bottles w/Cover (2)
 30" Radius Entry Door
 Outside Speakers
 Outside Shower (Utility Center)
 Factory Installed Roof Ladder
 Under Carriage Spare Tire and Carrier
 High-Capacity Water Pump with Interior and Exterior Switch
 Extra Large 2" Fresh Water Drain Valve
 Gel Coated Fiberglass Exterior
 Walk-on Roof Decking w/ Residential 5" Truss Rafters (16" O.C.)
 Fiberglass and Radiant Foil Roof and Front Cap Insulation
 One-Piece TPO Roof Membrane with 12-Year Warranty
 Easy Access Low Point Drain Valves
 Laminated Aluminum Framed Side Walls & Rear Wall (R-9)
 Laminated Aluminum Framed Roof and End Walls in Slide Rooms (R-9)
 Aluminum Framed Main Floor (R-30)
 Residential Wood Framed Roof (R-40*)

* Equivalent R-Value

KITCHEN & INTERIOR

Gunstock Fixtures and Hardware
 Deep Undermount Kitchen Sink
 Hardwood Galley Slide Trim Moldings & End Caps
 Hardwood Panel Refrigerator Fronts
 Hand Rubbed Maple Cabinet Doors
 Solid Hardwood Drawer Fronts & Solid Core Cabinet Stiles
 Pre-drilled and Screwed Cabinetry
 Ball Bearing Full Extension Drawer Glides
 Tri-Fold Hide-A-Bed Sofa
 Large Panoramic Slide Room Windows
 Premium Congoleum Flooring
 (Ductless Flooring Throughout Living Area)
 Residential Style Window Treatment
 LED Lighting Throughout with Motion Sensors (Key Areas)

BED & BATH

King Size Wardrobe
 Pillowtop Mattress w/ Residential Bedspread
 Oversized Underbed Storage
 Bedroom Heat Registers
 Closeable A/C Vents
 Cable/SAT Prep
 Spacious Shower with Glass Door & Wide View Skylight
 Power Vent Fan, Heat Duct and A/C Vents in Bathroom
 Extra Large Lav Top with Stainless Steel Sink
 Large Medicine Cabinet with Mirror

PEACE OF MIND PACKAGE

Mandatory

Residential Cabinetry
 Solid Surface Countertops & Sink Covers
 Aluminum Entry Steps
 Metal Slam Baggage Doors with Magna Latch
 8 cu.ft. Double Door Refrigerator
 17.8 Gal./Hr. Quick Recovery Water Heater
 Porcelain Toilet with Foot Pedal Flush
 High-Rise Faucet with Pullout Sprayer
 Universal All-In-One Docking Station
 Black Tank Flush
 Heated Theatre Seats w/ Massage & LED Lights (Most Models)
 Residential Booth Dinette
 LP Quick Connect
 2" Receiver Hitch
 Roller Shades

ULTIMATE POWER PACKAGE

Mandatory

One-Touch Electric Awning with LED Light
 Power Stabilizer Jacks
 HDMI/AM/FM/CD/DVD Bluetooth Stereo System
 High Definition LED Television w/Swing Arm (Living Area)
 50 AMP Service
 Wired and Framed for 2nd A/C in Bedroom
 30" Convection Microwave Oven
 15k BTU Ducted A/C
 Maxx Air Fan w/ Rain Sensor

ARCTIC 4-SEASONS PROTECTION PACKAGE

Mandatory

12V Heat Pads on Holding Tanks
 35k BTU High Capacity Furnace
 Thermofoil insulation under holding tanks
 Heated and Enclosed Underbelly w/Circulating Heat
 Heated and Enclosed Dump Valves
 Zero Degree Extended Season Enjoyment
 EZ Winterization Valve in Utility Center
 Insulated Slide-out Floors
 Dual Attic Vent | Double Insulated Roof and Front Cap

OPTIONS

Free Standing Table w/Storage Ottoman (NA 287RLTS, 300RBTS)
 Dual Pane Windows
 Tri-Fold Sofa IPO Theatre Seating (Model Specific)
 2nd A/C 15k BTU Ducted
 King Bed (Bedslide Models Only)
 2nd Awning (315RLTS only - Forced)
 12 cu. ft. Double Door Refrigerator (Forced / NA 297RSTS)
 78" Theatre Seating IPO Booth Dinette (300RBTS only)

	UVW†	HITCH‡	GVWR	LENGTH‡	HEIGHT	CAPACITY	WHEEL
287RLTS	7,224	727	9,495	32' 7"	11' 6"	60 86 43	15"
297RSTS	7,895	795	9,995	33' 11"	11' 6"	60 86 43	15"
300RBTS	7,897	791	9,995	34' 8"	11' 6"	60 75 43	15"
312BHTS	9,105	995	10,995	37' 4"	11' 8"	60 86 43	16"
315RLTS	9,137	1,065	10,995	37' 11"	11' 8"	60 118 43	16"

†Based on average weight in lbs. ‡Hitch to rear

FRESH GRAY BLACK (GALS)

Because of our commitment to continuous product improvement, Grand Design Recreational Vehicles reserves the right to change components, standards, options, specifications, and materials without notice and at any time. Photos may show optional equipment which may not be included in the standard purchase price of the featured unit. Be sure to review current product details with your local dealer before purchasing. Rev 10.21.19

HALF-TON TOWABLE FIFTH WHEELS



230RL

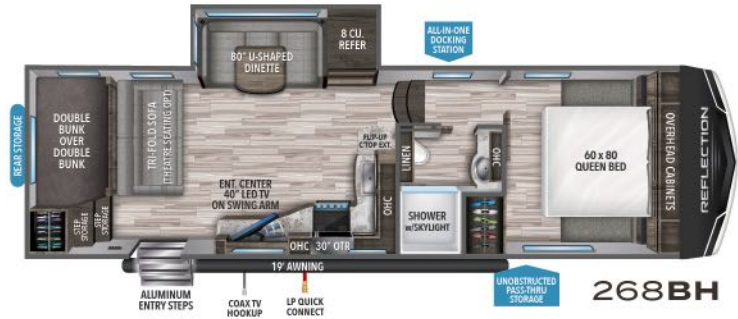

268BH

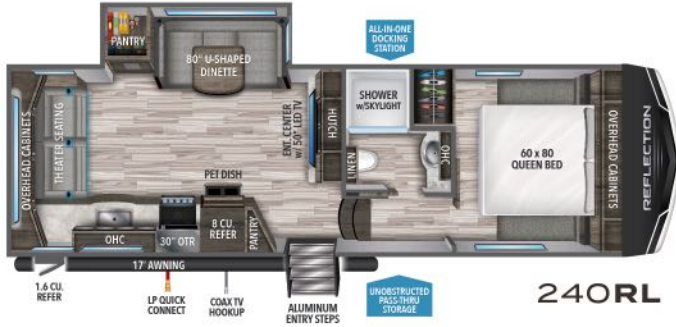

240RL

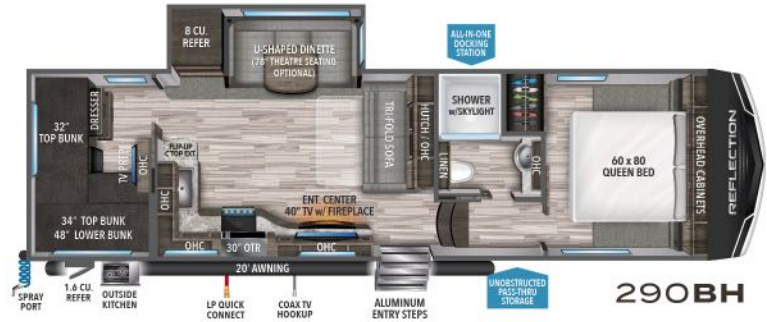

290BH

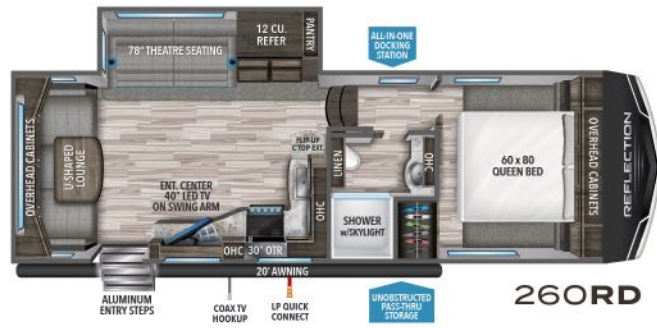

260RD

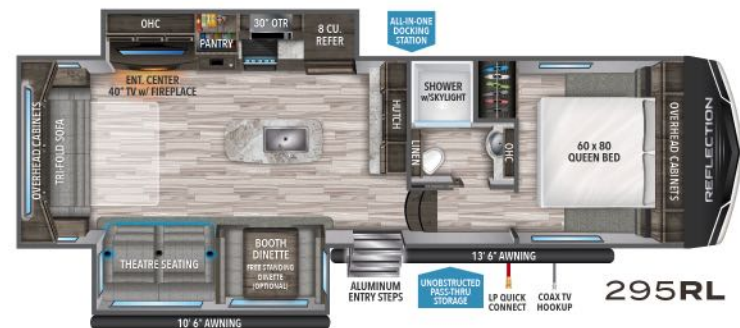

295RL

SHORT BED FRIENDLY!

TURNING POINT SWIVEL PIN BOX

90° TURNING RADIUS WITHOUT A SLIDER HITCH IN A 5.5 FT TRUCK BED





KITCHEN 290BH



90° TURN RADIUS
PIN BOX

35K

35,000 BTU
FURNACE



2" RECEIVER
HITCH UPGRADE



6' COILED
BREAKAWAY CABLE

NEW!



15,000 BTU
DUCTED AC



UNOBSTRUCTED
PASS-THRU STORAGE



50 AMP
ELECT. SERVICE



ONE-TOUCH
AUTO LEVELING

NEW!

	UVW [†]	HITCH [‡]	GVWR	LENGTH [‡]	HEIGHT	CAPACITY
23ORL	6,888	1,195	9,495	28' 1"	12' 0"	52 71 39
24ORL	7,691	1,272	9,495	29' 11"	12' 0"	52 71 39
26ORD	7,225	1,325	9,495	29' 9"	12' 0"	52 71 39
268BH	7,791	1,274	9,495	31' 11"	12' 0"	52 71 39
29OBH	8,194	1,280	10,195	34' 1"	12' 2"	52 78 39
295RL	8,496	1,391	10,195	32' 9"	12' 3"	52 78 39

[†]Based on average weight in lbs. [‡]Hitch to rear

FRESH GRAY BLACK (GALS)

HALF-TON TOWABLE REDEFINED

1/2 TON TRUCK
TOW RATING



1/2 TON TRUCK
PAYLOAD CAPACITY



FIFTH WHEEL DRY WEIGHT (UVW)

FIFTH WHEEL HITCH WEIGHT

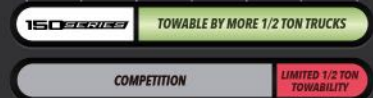

EXTERIOR & CONSTRUCTION

- Aerodynamic Front Cap with Max Turn Radius
- Marine Grade LED Hitch Light
- Rubberized Suspension Equalizer
- 15" Aluminum Wheels with E-Rated Tires
- 80% Tint Radius Safety Glass Windows
- Battery Kill Switch in Pass Thru Storage Area
- 30# LP Bottles (2)
- 30" Radius Entry Door
- Outside Speakers
- Outside Shower
- Under Carriage Spare Tire and Carrier
- High-Capacity Water Pump with Interior and Exterior Switch
- Extra Large 2" Fresh Water Drain Valve
- Gel Coated Ivory Fiberglass Exterior
- Residential 5" Truss Rafters (16" O.C.)
- Factory Installed Roof Ladder with Walk-on Roof Decking
- Fiberglass and Radiant Foil Roof and Front Cap Insulation
- One-Piece TPO Roof Membrane with 12-Year Warranty
- Easy Access Low Point Drain Valves
- Laminated Aluminum Framed Side Walls & Rear Wall (R-9)
- Laminated Aluminum Framed Roof & End Walls in Slide Rooms (R-9)
- Aluminum Framed Main Floor (R-30)
- Residential Wood Framed Roof (R-40*)

* Equivalent R-Value

KITCHEN & INTERIOR

- Gunstock Fixtures and Hardware
- Hardwood Galley Slide Trim Moldings & End Caps
- Residential Cabinet Doors
- Solid Hardwood Drawer Fronts
- Louvered Tread Steps to Bedroom
- Pre-drilled and Screwed Cabinetry w/ Solid Core Cabinet Stiles
- Ball Bearing Full Extension Drawer Glides
- Heated Wall Hugger Theatre Seats w/ Massage & LED Lights (Most Models)
- Large Panoramic Slide Room Windows
- Premium Congoleum Flooring
- Ductless Flooring Throughout Living Area
- Residential Style Window Treatment
- LED Lighting Throughout with Motion Sensors (Key Areas)
- Roller Shades

BED & BATH

- King Size Wardrobe
- 60 x 80 Mattress w/ Residential Bedspread
- Oversized Underbed Storage
- Heat Registers and Closeable A/C Vents in Bedroom
- Cable/SAT Prep
- 30 x 36 Residential Walk-in Shower
- Wide View Skylight Over Shower
- Heat Duct and A/C Vents in Bathroom
- Custom Designed Shower Pan and Surround
- Power Vent Fan
- Extra Large Lav Top with Stainless Steel Sink
- Large Medicine Cabinet with Mirror

Because of our commitment to continuous product improvement, Grand Design Recreational Vehicles reserves the right to change components, standards, options, specifications, and materials without notice and at any time. Photos may show optional equipment which may not be included in the standard purchase price of the featured unit. Be sure to review current product details with your local dealer before purchasing. Rev 10.21.19

PEACE OF MIND PACKAGE

Mandatory

- 90 Degree Turn Radius Pin Box (Turning Point)
- 6' Coiled Breakaway Cable
- Aluminum Entry Steps
- 8 cu.ft. Double Door Refrigerator
- Residential Pull-down Sprayer Faucet
- Deep-Seated Stainless-Steel Sink with Cover
- Residential Cabinetry
- Universal All-In-One Docking Station
- 17.8 Gal./Hr. Quick Recovery Water Heater
- Black Tank Flush
- Baggage Doors with Magna Latch
- Walk-on Roof
- Aluminum Rims with Nitrogen Filled Radial Tires
- Metal Slam Latch Front Cargo Doors
- Upgraded 2" Receiver Hitch w/ 4 Prong Connection

POWER PACKAGE

Mandatory

- One-Touch Automatic Leveling System
- HDMI/AM/FM/CD/DVD Bluetooth Stereo System
- High Definition LED Television w/Swing Arm (Living Area)
- Exterior Cable Hookup (Sidewall)
- 50 AMP Electrical Service
- Wired and Framed for 2nd A/C in Bedroom
- Detachable Power Cord with LED Light
- 15k BTU Ducted A/C
- Adjustable Power Awning w/ LED Lights
- LED Interior Lighting
- Motion Sensor Pass Thru / Entry Lighting (LED)
- Roof Mounted Solar Prep
- 30" Stainless Steel Microwave

ARCTIC 4-SEASONS PROTECTION PACKAGE

Mandatory

- 12v Heat Pads on Holding Tanks
- 35k BTU High Capacity Furnace
- Thermofoil Insulated Underbelly (Under Holding Tanks)
- Heated and Enclosed Underbelly w/Circulating Heat
- Heated Pass Thru Storage Area and Enclosed Dump Valves
- Zero Degree Extended Season Enjoyment
- EZ Winterization (Valve in Utility Center)
- Insulated Slide-out Floors
- Dual Attic Vents
- Double Insulated Roof and Front Cap

OPTIONS

- Free Standing Table w/Storage Ottoman (Model Specific)
- Dual Pane Windows
- Tri-Fold IPO Theatre Seating (Model Specific)
- 78" Theatre Seating IPO Dinette (Model Specific)
- 2nd Awning (295RL only - Forced)
- 2nd AC Low Profile 13.5k BTU
- 12 cu. ft. Refrigerator IPO 8 cu. ft Refer (26ORD - Forced)

150 SERIES FIFTH WHEELS

FIFTH WHEELS



28BH



29RS

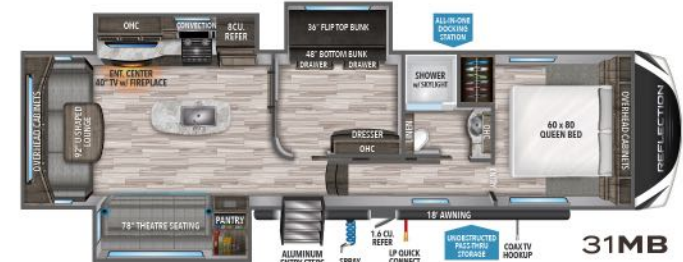

31MB



303RLS



311BHS



320MKS



337RLS

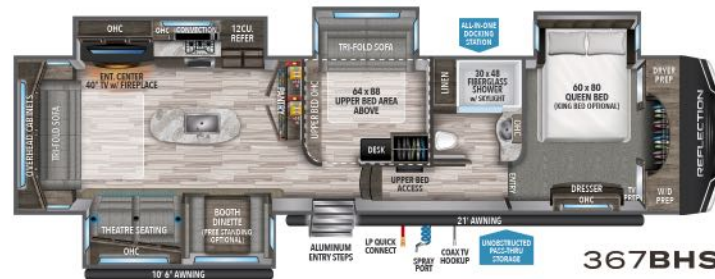

367BHS

VOTED BEST FIFTH WHEEL 2018!

REFLECTION



2018
TRAILERLIFE READERS'
GOLD AWARD WINNER



2018
DSI QUALITY CIRCLE
AWARD WINNER



KITCHEN 337RLS

EXTERIOR & CONSTRUCTION

- Aerodynamic Front Cap with Max Turn Radius
- Marine Grade LED Hitch Light
- LED "Night Lights" Under Bedroom Slide
- Rubberized Suspension Equalizer
- Aluminum Wheels with E-Rated Tires
- 80% Tint Radius Safety Glass Windows
- Battery Kill Switch in Pass Thru Storage Area
- Extended Pin Box
- 30# LP Bottles (2)
- 30" Radius Entry Door
- Outside Speakers
- Outside Shower
- Factory Installed Roof Ladder
- Under Carriage Spare Tire and Carrier
- High-Capacity Water Pump with Interior and Exterior Switch
- Extra Large 2" Fresh Water Drain Valve
- Gel Coated Ivory Fiberglass Exterior
- Residential 5" Truss Rafters (16" O.C.)
- Walk On Roof Decking
- Fiberglass and Radiant Foil Roof and Front Cap Insulation
- One-Piece TPO Roof Membrane with 12-Year Warranty
- Easy Access Low Point Drain Valves
- Laminated Aluminum Framed Side Walls & Rear Wall (R-9)
- Laminated Aluminum Framed Roof & End Walls in Slide Rooms (R-9)
- Aluminum Framed Main Floor (R-30)
- Residential Wood Framed Roof (R-40*)

* Equivalent R-Value

KITCHEN & INTERIOR

- Gunstock Fixtures and Hardware
- Deep, Undermount Kitchen Sink
- Hardwood Galley Slide Trim Moldings & End Caps
- Hardwood Panel Refrigerator Fronts
- Residential Cabinet Doors
- Solid Hardwood Drawer Fronts
- Louvered Tread Steps to Bedroom
- Solid Core Cabinet Stiles
- Pre-drilled and Screwed Cabinetry
- Ball Bearing Full Extension Drawer Glides
- Tri-Fold Hide-A-Bed Sofa (Model Specific)
- Large Panoramic Slide Room Windows
- Premium Congoleum Flooring
- Ductless Flooring Throughout Living Area
- Residential Style Window Treatment
- LED Lighting Throughout with Motion Sensors (Key Areas)
- Roller Shade Window Covering

BED & BATH

- King Size Wardrobe
- Pillowtop Mattress w/Residential Bedspread
- Oversized Underbed Storage
- Bedroom Heat Registers
- Closeable A/C Vents
- Cable/SAT Prep
- Spacious Shower with Glass Door
- Wide View Skylight Over Shower
- Heat Duct and A/C Vents in Bathroom
- Power Vent Fan
- Extra Large Lav Top with Stainless Steel Sink
- Large Medicine Cabinet with Mirror

PEACE OF MIND PACKAGE

Mandatory

- Residential Cabinetry
- Solid Surface Countertops and Sink Covers
- Universal All-in-One Docking Station
- Aluminum Entry Steps
- Metal Slam Latch Cargo Doors
- 8 cu.ft. Double Door Refrigerator
- 17.8 Gal./Hr. Quick Recovery Water Heater
- Porcelain Toilet with Foot Pedal Flush
- Residential Hi Rise Faucet with Pullout Sprayer
- Black Tank Flush
- Upgraded 2" Receiver Hitch w/ 4 Prong Connection
- Residential Fireplace
- Heated Wall Hugger Theatre Seats w/ Massage & LED Lights (Most Models)
- Residential Booth Dinette
- LP Quick Connect
- Neve-R-Adjust Brakes

ULTIMATE POWER PACKAGE

Mandatory

- One-Touch Automatic Leveling System
- HDMI/AM/FM/CD/DVD Bluetooth Stereo System
- High Definition LED Television w/Swing Arm (Living Area)
- Exterior Cable Hookup (Sidewall)
- 50 AMP Electrical Service
- Wired and Framed for 2nd A/C in Bedroom
- Detachable Power Cord with LED Light
- 15k BTU Ducted A/C
- Adjustable Power Awning w/ LED Lights
- LED Interior Lighting
- Motion Sensor Pass Thru / Entry Lighting (LED)
- Roof Mounted Solar Prep
- 30" Residential Convection Microwave Oven

ARCTIC 4-SEASONS PROTECTION PACKAGE

Mandatory

- 12v Heat Pads on Holding Tanks
- 35k BTU High Capacity Furnace
- Thermofoil Insulated Underbelly (Under Holding Tanks)
- Heated and Enclosed Underbelly w/Circulating Heat
- Heated Pass Thru Storage Area and Enclosed Dump Valves
- Zero Degree Extended Season Enjoyment
- EZ Winterization (Valve in Utility Center)
- Insulated Slide-out Floors
- Dual Attic Vents | Double Insulated Roof and Front Cap

OPTIONS

- Free Standing Table w/Storage Ottoman (NA 28BH and 31MB)
- 12 cu.ft. Refrigerator (Forced) (NA 29RS and 31MB)
- Dual Pane Windows
- 78" Theatre Seating IPO Booth (28BH only)
- 2nd A/C Low Profile 13.5k BTU Ducted
- King Bed (320MKS, 337RLS, 367BHS)
- 2nd Awning (Forced) (NA 28BH, 29RS and 31MB)
- 60" Tri-Fold Sofa IPO Theatre Seating (Forced) (28BH only)

Because of our commitment to continuous product improvement, Grand Design Recreational Vehicles reserves the right to change components, standards, options, specifications, and materials without notice and at any time. Photos may show optional equipment which may not be included in the standard purchase price of the featured unit. Be sure to review current product details with your local dealer before purchasing. Rev 10.21.19

FIFTH WHEELS



ONE-TOUCH
AUTO LEVELING



MAX TURN RADIUS
FRONT CAP



35,000 BTU
FURNACE



2" RECEIVER
HITCH UPGRADE



15,000 BTU
DUCTED AC



UNOBSTRUCTED
PASS-THRU STORAGE



50 AMP
ELECT. SERVICE



16" HEAVY DUTY
E-RATED TIRES

	UVW†	HITCH‡	GVWR	LENGTH‡	HEIGHT	CAPACITY
28BH	8,925	1,545	10,995	34' 8"	12' 3"	60 86 43
29RS	8,615	1,538	10,995	30' 11"	12' 3"	60 75 43
31MB	9,747	1,828	11,995	36' 2"	12' 3"	60 75 43
303RLS	9,395	1,725	11,995	32' 5"	12' 3"	60 87 47
311BHS	11,185	2,180	13,995	36' 10"	12' 3"	60 87 87
320MKS	10,495	1,960	13,995	34' 8"	12' 6"	60 94 43
337RLS	10,570	2,090	13,995	35' 6"	12' 6"	60 87 47
367BHS	12,474	2,509	14,995	41' 0"	12' 8"	60 94 47

†Based on average weight in lbs. ‡Hitch to rear

FRESH GRAY BLACK (GALS)

WE STRIVE FOR NOTHING LESS THAN CUSTOMERS FOR LIFE!



Thank you for taking the time to tour our coach.

We would like to share what sets Grand Design RV apart from all other RV manufacturers and why this difference is important to you.

My close friends and I were part of an ownership team at a travel trailer, fifth wheel company that grew to become one of the largest RV manufacturers in the world. While proud of this accomplishment, it became difficult to stay in touch with customers, employees, and ultimately the quality of the final product. It became obvious, there was a better way.

In 2012 we started with a mission to build a better RV company. A company with a culture that desires a long-term, personal connection with customers, employees and dealers – that company became Grand Design RV. Our business model of doing the right thing has led us to many years of unparalleled growth.

At Grand Design we are customer centered and everything we do daily revolves around you. Our goal is simple – continue to lead the industry with quality, innovative products while striving to improve our customers' RV experience before, during and after their purchase. We strive for nothing less than customers for life and I would be honored to personally welcome you to the Grand Design family.

Warmest Regards,

President / CEO / Co-Founder

LONG TERM VALUE

Everything we do at our company is designed to build long-term value in what we offer our customers, "More features and superior value for your dollar."

CUSTOMER CENTERED

Our focus, from the very first day we opened our doors, revolves around our customers. Your satisfaction is our future. GDRV4Life!

RAISING THE QUALITY BAR

We put every Grand Design RV through a series of quality inspection gates during the manufacturing process. Once completed, the unit undergoes a comprehensive "final finish" inspection. At this point, most manufacturers ship their coaches to the dealer for retail sale. We aren't most manufacturers. Every one of our coaches is moved to a PDI (Pre-Delivery Inspection) area where they are put through a rigorous 300+ point inspection checklist. It is only after this PDI that we certify a unit ready to ship to our dealers.

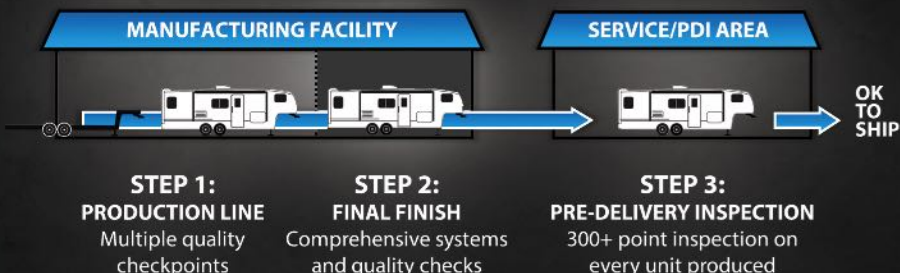

SUPERIOR SERVICE

Anything built by humans that travels down the open road is subject to issues. It's how those issues are addressed that makes Grand Design so special to our owners. Visit the independent owners page on Facebook (Grand Design RV Owners) and see for yourself. We take care of our customers after the sale. An informed customer will be a Grand Design customer!

CLASS LEADING WARRANTY

We back every one of our coaches with a 3-year limited structural warranty.



Grand Design RV was created in 2012 and founded by current CEO, Don Clark and brothers Ron and Bill Fenech (Representing over 80 combined years of experience in the RV industry).