

LIMITED
TT-FW

 **CAMPFIRE**
EDITION
TT-FW

SPRINTER

SPRINTER



**COLE
DAVIS**

Founder, Keystone RV Company
Started Keystone RV with 110 employees
and 1 production line in 1996.

OUR HISTORY

When Cole Davis founded Keystone RV in 1996 his vision was clear: Build a quality RV loaded with features priced thousands less than other RVs on the market. To accomplish his goal, Cole would recruit and build a strong team, focus on keeping overhead low, and empower the people closest to the customer to make decisions. Within a few short months after opening the doors, Keystone produced its very first camper—the wood framed, aluminum-skinned Sprinter. Delivering big on quality, features and value, the public fell in love with Sprinter and a star was born.

As customers appetite skyrocketed, new Keystone models were added to satisfy growing customer demand. Along with this tremendous growth came the need for expanded production. To meet this need, more manufacturing plants were built and staffed. By the beginning of 2000, Keystone was leading the industry in fifth wheel and trailer sales. Today, Keystone RV Company has grown to encompass over 1 million square feet of manufacturing space with facilities in Goshen, Indiana and Pendleton, Oregon. While Keystone is no longer the small “start up” we once were, our mission has remained true to Cole’s vision—“Do the job right and make sure we deliver a quality product every time.”

THE COMPLETE CHOICE

FOR MORE INFORMATION ON KEYSTONE RV VISIT
WWW.BIT.LY/10A00LK

SCAN ME

FOR MORE
INFORMATION
ON KEYSTONE RV
COMPANY



SPRINTER

by Keystone

OUR STORY

Sprinter was Introduced in 1996 as Keystone's first product line. Sprinter's goals remain simple; take the suggestions from our customers and make them the foundation for the Sprinter design. This philosophy has led to our slogan "Camping Made Easy" and has been the reason for our success for over 20 years. Let us show you how Sprinter offers a new level of affordable luxury.



LIMITED

TRAVEL TRAILERS / FIFTH WHEELS



CAMPFIRE

TRAVEL TRAILERS / FIFTH WHEELS

20 Years
AND STILL
GOING STRONG



LIMITED TRAVEL TRAILERS

LIMITED TT & LIMITED FW | 8



2-TONE PAINTED FRONT CAP



REAR CAMERA SETUP



OUTDOOR KITCHEN W/TV



SOLID SURFACE COUNTERTOPS



RESIDENTIAL SINK & FAUCET



SOLAR POWER PREP



21" OVEN



6'0" X 8'0" RESIDENTIAL QUEEN BED



KEYED ALIKE LOCKS



REMOTE SYSTEM



AUTO LEVEL UP SYSTEM



KING SIZE BED



SKY LIGHT



ROAD ARMOR SUSPENSION



LED LIGHTING



LIMITED | TT
LIMITED TRAVEL TRAILERS

FEELS LIKE HOME, SO RELAX,
WE MAKE IT EASY.

At Sprinter we understand that finding the time to relax is often hard to do. So for the time you find to slow down and enjoy North America's beauty, we want you to be able to enjoy every minute of it. Take a look at a Sprinter today and let us show you, how we "make camping easy".

312MLS

319MKS
 NEW

325BMK

333FKS
 NEW

SPECIFICATIONS

MODEL	SHIPPING WEIGHT	CARRYING CAPACITY	HITCH WEIGHT	EXT LENGTH*	EXT HEIGHT	FRESH WATER	WASTE WATER	GREY WATER	LPG
312MLS	8440	2560	1020	35' 2"	11' 3"	81	34	68	60
319MKS	8405	2995	1030	35' 11"	11' 3"	81	34	34	60
325BMK	8730	2770	1380	36' 11"	11' 3"	81	34	34	60
333FKS	9085	2415	1210	37' 9"	11' 3"	81	34	68	60

DISCLAIMER: Product information is as accurate as possible as of the date of publication of this brochure. All features, floor plans, and specifications in this brochure are subject to change without notice. Please also consult Keystone's web site at www.keystoneRV.com for more current product information and specifications. Tow Vehicle Disclaimer. CAUTION: Owners of Keystone recreational vehicles are solely responsible for the selection and proper use of tow vehicles. All customers should consult with a motor vehicle manufacturer or their dealer concerning the purchase and use of suitable tow vehicles for Keystone products. Keystone disclaims any liability or damages suffered as a result of the selection, operation, use or misuse of a tow vehicle. KEYSTONE'S LIMITED WARRANTY DOES NOT COVER DAMAGE TO THE RECREATIONAL VEHICLE OR THE TOW VEHICLE AS A RESULT OF THE SELECTION, OPERATION, USE OR MISUSE OF THE TOW VEHICLE. *REFERENCE KEYSTONE RV COMPANY OWNERS MANUAL FOR LIMITED WARRANTY DETAILS. *Length is defined as the distance from the centerline of hitch pin/coupler to rear bumper of trailer.



WIDE BODY DESIGN OFFERS MORE INTERIOR LIVING SPACE



PAINTED FRONT CAP WITH EXCLUSIVE KEY-SHIELD PAINT TECHNOLOGY

PREMIUM THERMAL PACKAGE

ASTROFOIL INSULATION

AN UPGRADED INSULATION PACKAGE USING SPACE AGE FOIL TECHNOLOGY THAT WAS INDEPENDENTLY TESTED TO PERFORM AT 0-DEGREES AND 100-DEGREES. STANDARD ON ALL TRAVEL TRAILERS AND FIFTH WHEELS. R-VALUES: WALLS (R9) - (ROOF) R-28 - (FLOOR) R-30 - (FRONT WALL) R-20

EXTERIOR FEATURES

- » KEYED ALIKE LOCK SYSTEM
- » FURRION SOLAR PREP QUICK CONNECT
- » FURRION BACK UP CAMERA PREP
- » INDUSTRY BEST, 100" WIDE BODY CONSTRUCTION
- » PREMIUM THERMAL PACKAGE W/ ASTROFOIL LAYER IN THE SUB FLOOR, ROOF, FRONT WALL, (R30 FLOOR; R28 ROOF; R20 FRONT WALL)
- » G4 CABLE SLIDE SYSTEM W/ 4 POINT SEAL
- » 100" WIDE-STANCE AXLES
- » CONTROL TT AUTO LEVELING JACKS
- » 30" FRICTION HINGE ENTRY DOOR
- » ELECTRIC AWNING, FRICTION-HINGE ADJUSTMENT, LED LIGHT STRIP, MANUAL OVERRIDE, AND SPEAKERS
- » REAR LADDER **NEW**
- » 2 BATTERY TRAY WITH BATTERY DISCONNECT
- » SPLASH GUARD UNDER SLIDE
- » BEST IN CLASS 2" LAMINATED ALUMINUM FRAMED SIDEWALLS
- » ENCLOSED UNDERBELLY WITH DIRECT VENT HEAT
- » E-Z LUBE AXLES
- » FIBERGLASS FRONT CAP W/ AUTOMOTIVE WINDSHIELD & ROCK GUARD **NEW**
- » TINTED SAFETY GLASS WINDOWS
- » LOCKABLE BAGGAGE DOORS
- » REAR BUMPER STORAGE W/ END CAPS
- » XL ENTRY DOOR GRAB HANDLE
- » TOUGH GUARD PAINTED SKIRT METAL
- » 4" EXTRA LONG RAIN SPOUTS
- » TWO 30LB. LP BOTTLES WITH AUTO CHANGE-OVER REGULATOR
- » BLOW MOLDED SEAMLESS HOLDING TANKS
- » BLACK TANK FLUSH SYSTEM
- » SPRAY PORT
- » 50 AMP DETACHABLE CORD STANDARD W/ 2ND AC PREP
- » CABLE AND SATELLITE HOOK-UP
- » ALUMINUM WHEELS
- » 100" WIDE STANCE AXLES
- » OUTSIDE TV HOOKUP WITH TV RECEPT, AND CABLE PREP IN PASS THRU
- » ALUMINUM TRIPLE STEP ENTRY
- » OUTSIDE ENTERTAINMENT CENTER MODELS INCLUDE:
 - » 32" LED TV, 17 CU. FT. 110V FRIDGE & STORAGE (333FKS)
- » REMOTE CONTROL SYSTEM (SLIDEOUTS, AUTO LEVEL SYSTEM & LED LIGHT STRIP, AWNING)
- » ROAD ARMOR SUSPENSION **NEW**
- » OUTDOOR KITCHEN MODEL INCLUDES: 32" TV, 2 BURNER COOKTOP STOVE, 4.3 CU. FT. 110V FRIDGE (325BMK, 312MLB)

LUXURY PACKAGE

- » SOLID SURFACE COUNTERTOPS
- » BACK UP CAMERA PREP
- » RESIDENTIAL SINK & FAUCET
- » LED AMBIENT LIGHTING
- » 21" FULL FEATURE OVEN W/UPGRADED COOK TOP
- » STAINLESS STEEL LAV SINK

INTERIOR FEATURES

- » FULL 96" INTERIOR WIDTH (ADDED SQUARE FOOTAGE)
- » 5/8" WATER RESISTANT DYNASPAN FLOORING WITH 25 YEAR WARRANTY
- » 80" INTERIOR HEIGHT
- » 12 VOLT, 55 AMP CONVERTER
- » 35,000 BTU AUTO-IGNITION FURNACE
- » 15K BTU DUCTED AIR CONDITIONER
- » WATER HEATER BYPASS FOR EASY WINTERIZATION
- » DIGITAL THERMOSTAT
- » RESIDENTIAL CABINET HARDWARE
- » LARGE PICTURE WINDOW AT THE DINETTE
- » INTERIOR ACCESS, MANUAL OVERRIDE FOR THE SLIDE ROOMS
- » IN-FLOOR HARD-DUCTED HEAT
- » LED OVERHEAD LIGHTING IN EVERY ROOM
- » CENTRAL COMMAND CENTER FOR MONITORING ALL TANKS AND BATTERY, AWNING, SLIDE-OUTS, LIGHTS
- » SCREWED CABINETRY WITH LUMBER-CORE STILES
- » BEAUFLOL LINOLEUM W/ 7 YEAR WARRANTY (2 YEAR COLD CRACK)
- » WIRED & FRAMED FOR 2ND A/C
- » MULTIMEDIA CHARGING STATION
- » SKY LIGHT

LIVING ROOM FEATURES

- » SOUND BAR ENTERTAINMENT SYSTEM WITH BLUETOOTH TECHNOLOGY, USB PORTS, AND DVD PLAYER
- » 32", 40", 55" HD LED TV (DEPENDING ON FLOORPLAN)
- » CABLE TV HOOK-UP WITH ANTENNA AND SIGNAL BOOSTER
- » SATELLITE PREP WITH RG-6 CABLE
- » HIGH GRADE CARPETING
- » THEATRE SEATING

BATH FEATURES

- » STAINLESS STEEL VANITY SINK
- » RESIDENTIAL MEDICINE CABINET WITH MIRROR
- » RADIUS GLASS SHOWER
- » SKYLIGHT OVER TUB/SHOWER
- » REINFORCED SHOWER SUPPORT
- » POWER ROOF VENT FAN
- » GFI RECEPTACLES IN THE BATHROOM
- » ILLUMINATED LIGHT SWITCH

KITCHEN FEATURES

- » CROWN MOLDING CABINETRY
- » SOLID SURFACE COUNTERTOPS
- » LED AMBIENT LIGHTING UNDER KITCHEN COUNTERTOP
- » 6 GALLON GAS/ELECTRIC DBI AUTO IGNITION WATER HEATER
- » 3 BURNER HIGH OUTPUT GAS RANGE
- » LARGE STAINLESS STEEL SINK
- » 22" DEEP DRAWERS
- » FULL EXTENSION BALL BEARING METAL DRAWER GUIDES
- » RESIDENTIAL PULL-DOWN SPRAYER FAUCET
- » LIGHTED RANGE HOOD WITH EXHAUST FAN
- » MICROWAVE WITH CAROUSEL
- » 21" OVEN
- » 7 CU. FT./8 CU. FT. DOUBLE DOOR, GAS/ELECTRIC FRIDGE (DEPENDING ON MODEL)

BEDROOM FEATURES

- » FULL, RESIDENTIAL 80"X80" DREAM COLLECTION BED (312MLS, 325BMK)
- » KING BED 70"X80" (318MKS, 333FKS)
- » HIGH GRADE CARPET IN MASTER BEDROOM
- » UNDER BED STORAGE W/ GAS STRUTS
- » COLOR MATCHED BEDSPREAD
- » LED READING LIGHTS
- » ROOF VENT
- » AMPLE CLOSET STORAGE

SAFETY FEATURES

- » DUAL HITCH SAFETY CHAINS
- » SAFETY GLASS WINDOWS
- » FIRE EXTINGUISHER
- » SMOKE DETECTOR
- » CARBON MONOXIDE DETECTOR
- » EGRESS WINDOWS
- » LP GAS LEAK DETECTOR
- » BREAK AWAY SAFETY BRAKE
- » 4 WHEEL ELECTRIC BRAKES

POPULAR OPTIONS

- » FREE-STANDING RESIDENTIAL DINETTE WITH FOUR CHAIRS
- » 2ND A/C (13.5K)

CAMPING MADE EASY PACKAGE

- » 30" FRICTION HINGE ENTRY DOOR
- » E-Z LUBE AXLES
- » XL ENTRY DOOR GRAB HANDLE
- » TOUGH GUARD PAINTED SKIRT METAL
- » 4" EXTRA LONG RAIN SPOUTS
- » BLACK TANK FLUSH SYSTEM
- » OUTSIDE TV HOOKUP WITH TV RECEPT, AND CABLE PREP IN PASS THRU
- » ALUMINUM STEPS

- » INTERIOR ACCESS, MANUAL OVERRIDE FOR THE SLIDE ROOMS
- » ILLUMINATED LIGHT SWITCH
- » 22" DEEP DRAWERS
- » UNDER BED STORAGE W/ GAS STRUTS
- » MULTIMEDIA CHARGING STATION
- » DUAL BATTERY TRAY W/BATTERY DISCONNECT
- » SOLAR PREP
- » LED INTERIOR LIGHTING



2 TONE PAINTED FRONT CAP



REAR CAMERA SETUP



OUTDOOR KITCHEN W/TV

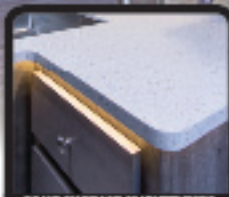

SOLID SURFACE COUNTER TOPS



RESIDENTIAL SINK & FAUCET



SOLAR POWER PREP



3RD OVEN



MAXX AIR FAN



keyed alike
Open lock matches all prior models

KEYED ALIKE LOCKS



REMOTE SYSTEM



AUTO LEVEL UP SYSTEM



KING SIZE BED



SKYLIGHT



ROAD ARMOR SUSPENSION

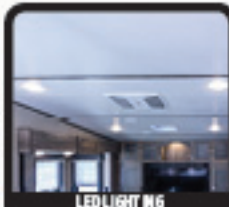

LED LIGHTING



LIMITED | FW

LIMITED FIFTH WHEELS

LUXURY YOU'LL LOVE, VALUE YOU CAN APPRECIATE.

Built upon the foundation of Keystone's first product line, Sprinter fifth wheels "Make Camping Easy" by combining luxury and value in one beautiful fifth wheel.



3150/51FWRLS
NEW



3340/41FWFLS
NEW



3530/31FWDEN
NEW



3570/71FWLFT
NEW



3550/51FWMLS
NEW

MODEL	SHIPING WEIGHT	CARRYING CAPACITY	HITCH WEIGHT	EXT LENGTH*	EXT HEIGHT	FRESH WATER	WASTE WATER	GREY WATER	LPG
3150/51FWRLS	9945	2955	2280	35' 3"	12' 8"	81	44	88	60
3340/41FWFLS	10380	3820	2190	37' 10"	12' 6"	81	34	68	60
3530/31FWDEN	10590	3470	2155	39' 0"	12' 6"	81	44	44	60
3550/51FWMLS	10890	3170	2240	39' 0"	12' 6"	81	44	78	60
3570/71FWLFT	TBD	TBD	1020	39' 6"	12' 6"	81	34	68	60

DISCLAIMER: Product information is as accurate as possible as of the date of publication of this brochure. All features, floor plans, and specifications in this brochure are subject to change without notice. Please also consult Keystone's website at www.keystoneriv.com for more current product information and specifications. Tow Vehicle Disclaimer: CAUTION: Owners of Keystone recreational vehicles are solely responsible for the selection and proper use of tow vehicles. All customers should consult with a motor vehicle manufacturer or their dealer concerning the purchase and use of suitable tow vehicles for Keystone products. Keystone disclaims any liability or damages suffered as a result of the selection, operation, use or misuse of a tow vehicle. KEYSTONE'S LIMITED WARRANTY DOES NOT COVER DAMAGE TO THE RECREATIONAL VEHICLE OR THE TOW VEHICLE AS A RESULT OF THE SELECTION, OPERATION, USE OR MISUSE OF THE TOW VEHICLE. *REFERENCE KEYSTONE RV COMPANY OWNERS MANUAL FOR LIMITED WARRANTY DETAILS. *Length is defined as the distance from the centerline of hitch pin/coupler to rear bumper of trailer.

LIMITED FIFTH WHEEL CONSTRUCTION

LIMITED TT & LIMITED FW | 18

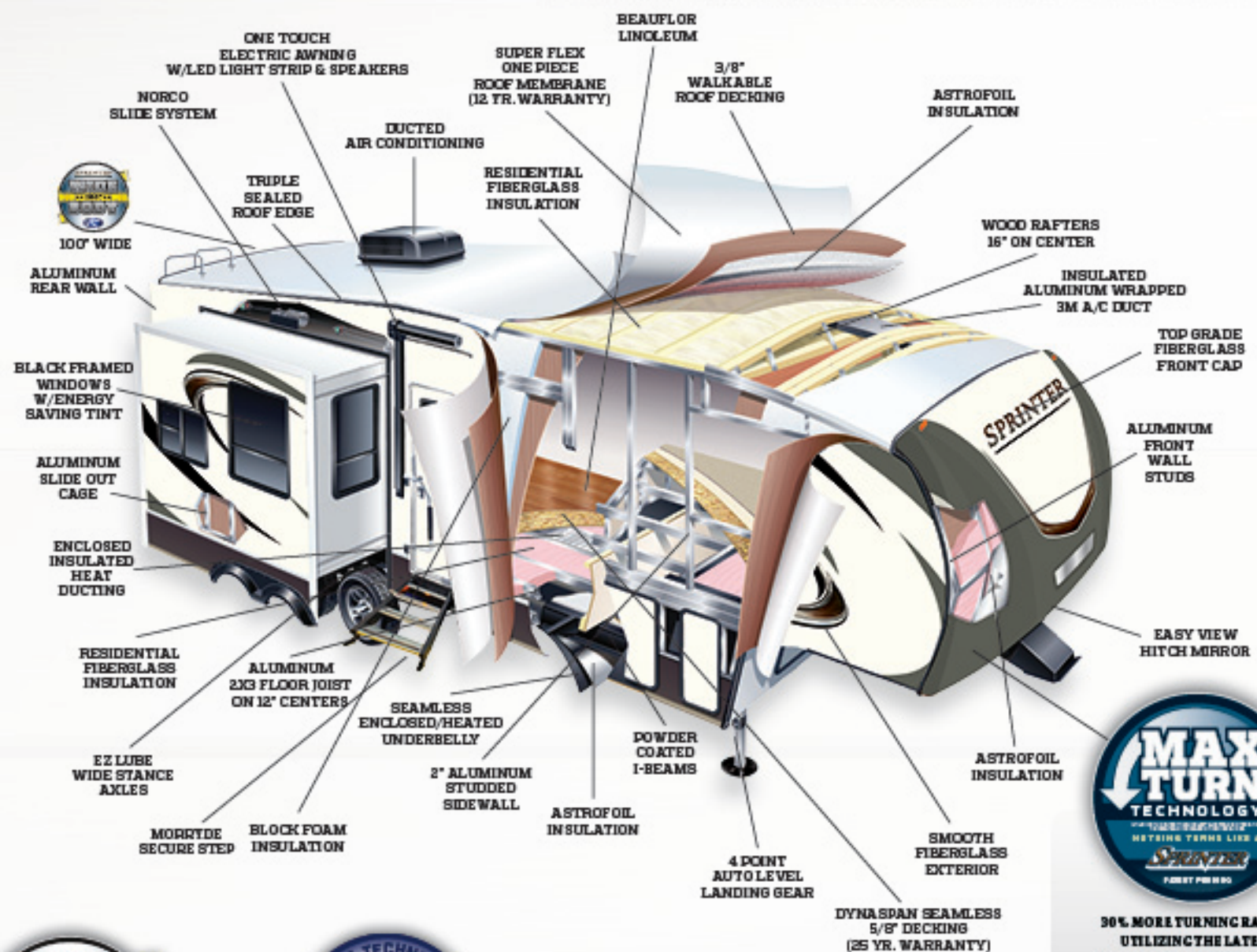

30% MORE TURNING RADIUS
UTILIZING THE LATEST TECHNOLOGY TO CREATE AN INCREASE IN TURNING RADIUS



WIDE BODY DESIGN OFFERS MORE INTERIOR LIVING SPACE



PAINTED FRONT CAP WITH EXCLUSIVE KEY-SHIELD PAINT TECHNOLOGY

PREMIUM THERMAL PACKAGE

ASTROFOIL INSULATION

A UPGRADED INSULATION PACKAGE USING SPACE ACE FOIL TECHNOLOGY THAT WAS INDEPENDENTLY TESTED TO PERFORM AT 0-DEGREES AND 100-DEGREES. STANDARD ON ALL TRAVEL TRAILERS AND FIFTH WHEELS. R-VALUES: WALLS (R9) - (ROOF) R-28 - (FLOOR) R-30 - (FRONT WALL) R-20

EXTERIOR FEATURES

- ▶ KEYED ALIKE LOCK SYSTEM
- ▶ FURRION SOLAR PREP QUICK CONNECT
- ▶ FURRION BACK UP CAMERA PREP
- ▶ INDUSTRY BEST, 100" WIDE BODY CONSTRUCTION
- ▶ PREMIUM THERMAL PACKAGE W/ ASTROFOIL LAYER IN THE SUBFLOOR, ROOF, FRONT WALL, (R30 FLOOR; R28 ROOF; R19 SLIDEOUT FLOOR; R20 FRONT WALL)
- ▶ G4 CABLE SLIDE SYSTEM W/ 4 POINT SEAL
- ▶ 100" WIDE-STANCE AXLES
- ▶ CONTROL TT AUTO LEVELING JACKS
- ▶ 30" FRICTION HINGE ENTRY DOOR
- ▶ ELECTRIC AWNING, FRICTION-HINGE ADJUSTMENT, LED LIGHT STRIP, MANUAL OVERRIDE, AND SPEAKERS
- ▶ REAR LADDER
- ▶ 2 BATTERY TRAY WITH BATTERY DISCONNECT
- ▶ SPLASH GUARD UNDER SLIDE
- ▶ BEST IN CLASS 2" LAMINATED ALUMINUM FRAMED SIDEWALLS
- ▶ ENCLOSED UNDERBELLY WITH DIRECT VENT HEAT
- ▶ E-Z LUBE AXLES
- ▶ 2-TONE PAINTED FRONT CAP
- ▶ TINTED SAFETY GLASS WINDOWS
- ▶ LOCKABLE BAGGAGE DOORS
- ▶ REAR BUMPER STORAGE W/ END CAPS
- ▶ XL ENTRY DOOR GRAB HANDLE
- ▶ TOUGH GUARD PAINTED SKIRT METAL
- ▶ 4" EXTRA LONG RAIN SPOUTS
- ▶ TWO 30LB. LP BOTTLES WITH AUTO CHANGE-OVER REGULATOR
- ▶ BLOW MOLDED SEAMLESS HOLDING TANKS
- ▶ BLACK TANK FLUSH SYSTEM
- ▶ SPRAY PORT
- ▶ 50 AMP SERVICE STANDARD W/2ND A/C (EXCEPT 3150/51)
- ▶ CABLE AND SATELLITE HOOK-UP
- ▶ ALUMINUM WHEELS
- ▶ 100" WIDE STANCE AXLES
- ▶ OUTSIDE TV HOOKUP WITH 110 RECEPT, AND CABLE PREP IN PASS THRU
- ▶ SECURE STEP ENTRY **NEW**
- ▶ OUTSIDE ENTERTAINMENT CENTER MODELS INCLUDE: 32" LED TV, 1.7 CU. FT. 110V FRIDGE & STORAGE
- ▶ REMOTE CONTROL SYSTEM (SLIDEOUTS, AUTO LEVEL SYSTEM & LED LIGHT STRIP, AWNING)
- ▶ ROAD ARMOR SUSPENSION **NEW**
- ▶ OUTDOOR KITCHEN MODEL INCLUDES: 32" TV, 2 BURNER COOKTOP STOVE, 4.3 CU. FT. 110V FRIDGE

INTERIOR FEATURES

- ▶ 8' 3" SLIDE ROOM HEIGHT
- ▶ 12 VOLT, 55 AMP CONVERTER
- ▶ 35,000 BTU AUTO-IGNITION FURNACE

- ▶ 15K BTU DUCTED AIR CONDITIONER
- ▶ 86" WIDE-BODY INTERIOR WIDTH, BEST IN CLASS!
- ▶ 50 AMP ELECTRICAL SERVICE
- ▶ 5/8" WATER RESISTANT DYWIDAG FLOORING WITH 25 YEAR WARRANTY
- ▶ WATER HEATER BYPASS FOR EASY WINTERIZATION
- ▶ DIGITAL THERMOSTAT
- ▶ XL PICTURE WINDOW AT THE DINETTE
- ▶ INDUSTRY BEST, IN-FLOOR DUCTED HEAT
- ▶ LED OVERHEAD LIGHTING IN EVERY ROOM
- ▶ CENTRAL COMMAND CENTER FOR MONITORING ALL TANKS AND BATTERY, AWNING, SLIDE-OUTS, LIGHTS, ETC.
- ▶ INDUSTRY BEST, 22" DEEP DRAWERS WITH FULL EXTENSION BALL BEARING DRAWER GUIDES
- ▶ SCREWED CABINETS WITH LUMBER-CORE STILES
- ▶ BEAUFLOL LINOLEUM WITH 7 YEAR WARRANTY (2 YEAR COLD CRACK)
- ▶ INTERIOR ACCESS, MANUAL OVERRIDE FOR THE SLIDE ROOMS
- ▶ WASHER/DRYER PREP (EXCEPT 3340/41)
- ▶ 2ND A/C 13.5K STANDARD (EXCEPT 3150/51)
- ▶ MULTIMEDIA CHARGING STATION

LIVING ROOM FEATURES

- ▶ 8' 3" SLIDE ROOM HEIGHT
- ▶ FIREPLACE
- ▶ MAX AIRFAN
- ▶ CABLE TV HOOK-UP WITH ANTENNA AND SIGNAL BOOSTER
- ▶ SATELLITE PREP WITH RG-6 CABLE
- ▶ RESIDENTIAL FABRIC-COVERED VALANCES W/REMOVABLE DRAPES
- ▶ TRI-FOLD SLEEPER SOFA W/STORAGE
- ▶ 55" HD LED TV
- ▶ SOUND BAR ENTERTAINMENT SYSTEM WITH BLUETOOTH TECHNOLOGY, USB PORTS, AND DVD PLAYER
- ▶ HIGH GRADE CARPETING

BATH FEATURES

- ▶ 30"x42" RESIDENTIAL SHOWER W/SEAT (EXCEPT 3340/41)
- ▶ FLOOR TO CEILING LINEN CLOSET (EXCEPT 3340/41)
- ▶ STAINLESS STEEL VANITY SINK
- ▶ PORCELAIN FOOT FLUSH TOILET
- ▶ RESIDENTIAL MEDICINE CABINET WITH MIRROR
- ▶ SKYLIGHT OVER TUB/SHOWER
- ▶ REINFORCED TUB SUPPORT
- ▶ POWER ROOF VENT FAN
- ▶ GR RECEPTACLES IN THE BATHROOM
- ▶ ILLUMINATED LIGHT SWITCH IN BATHROOM

- ▶ RADIUS GLASS SHOWER (3340/41 ONLY)

KITCHEN FEATURES

- ▶ LED AMBIENT LIGHTING UNDER KITCHEN COUNTERTOP
- ▶ ALL HARDWOOD DOORS AND DRAWER FRONTS
- ▶ CROWN MOLDING ON CABINETS
- ▶ 8 CU. FT. DOUBLE-DOOR REFR STANDARD (3150, 3340, 3530, 3570)
- ▶ 6 GALLON GAS/ELECTRIC DSI AUTO IGNITION WATER HEATER
- ▶ 3 BURNER HIGH OUTPUT GAS RANGE
- ▶ LARGE STAINLESS STEEL SINK
- ▶ 22" DEEP DRAWERS
- ▶ FULL EXTENSION BALL BEARING METAL DRAWER GUIDES
- ▶ RESIDENTIAL PULL-DOWN SPRAYER FAUCET
- ▶ WASTE BASKET STORAGE
- ▶ LIGHTED RANGE HOOD WITH EXHAUST FAN
- ▶ MICROWAVE WITH CAROUSEL
- ▶ 21" OVEN
- ▶ 18 CU FT STAINLESS STEEL, FRENCH-DOOR, 110 FRIDGE W/ 1000 WATT INDEPENDENT INVERTER & BATTERY DISCONNECT (STANDARD 3151, 3341, 3531, 3571, 3351)
- ▶ SKYLIGHT

BEDROOM FEATURES

- ▶ KING BED 70"x80"
- ▶ FLUSH FLOOR BATHROOM/BEDROOM SUITES (NO BEDSIDE STEP-UP)
- ▶ CABLE TV HOOK-UP WITH 110 OUTLET
- ▶ HIGH GRADE CARPET IN MASTER BEDROOM
- ▶ UNDER BED STORAGE W/ GAS STRUTS
- ▶ COLOR MATCHED BEDSPREAD
- ▶ LED READING LIGHTS
- ▶ WASHER/DRYER PREP (EXCEPT 3340/41)

SAFETY FEATURES

- ▶ SAFETY GLASS WINDOWS
- ▶ FIRE EXTINGUISHER
- ▶ SMOKE DETECTOR
- ▶ CARBON MONOXIDE DETECTOR
- ▶ EGRESS WINDOWS
- ▶ LP GAS LEAK DETECTOR
- ▶ BREAK AWAY SAFETY BRAKE
- ▶ 4 WHEEL ELECTRIC BRAKES

POPULAR OPTIONS

- ▶ FREE-STANDING RESIDENTIAL DINETTE WITH FOUR CHAIRS (3150/51, 3570/71 ONLY)
- ▶ 2ND A/C (13.5K) (3150/51 ONLY)

LUXURY PACKAGE

- ▶ SOLID SURFACE COUNTERTOPS
- ▶ BACK UP CAMERA PREP
- ▶ RESIDENTIAL SINK & FAUCET
- ▶ LED AMBIENT LIGHTING
- ▶ 21" FULL FEATURE OVEN W/UPGRADED COOK TOP
- ▶ STAINLESS STEEL LAV SINK

CAMPING MADE EASY PACKAGE

- ▶ 30" FRICTION HINGE ENTRY DOOR
- ▶ E-Z LUBE AXLES
- ▶ XL ENTRY DOOR GRAB HANDLE
- ▶ TOUGH GUARD PAINTED SKIRT METAL
- ▶ 4" EXTRA LONG RAIN SPOUTS
- ▶ BLACK TANK FLUSH SYSTEM
- ▶ OUTSIDE TV HOOKUP WITH 110 RECEPT, AND CABLE PREP IN PASS THRU

- ▶ INTERIOR ACCESS, MANUAL OVERRIDE FOR THE SLIDE ROOMS
- ▶ ILLUMINATED LIGHT SWITCH
- ▶ 22" DEEP DRAWERS
- ▶ UNDER BED STORAGE W/ GAS STRUTS
- ▶ MULTIMEDIA CHARGING STATION
- ▶ DUAL BATTERY TRAY W/BATTERY DISCONNECT
- ▶ SOLAR PREP
- ▶ MAX TURN TECHNOLOGY



ALUMINUM STEPS



RED & BLACK SETUP



OUTDOOR KITCHEN TV



REMOTE SYSTEM



RESIDENTIAL SINK & FAUCET



4-POINT LEVELUP SYSTEM



LED LIGHTING IN ALL ROOMS



SPRINTER
TRUE
RESIDENTIAL
QUEEN BED

60" X 80" QUEEN BEDS



keyed alike

One key works all your locks

KEYED ALIKE LOCKS



ROAD ARMOR BUSH SPRING



50 LBS POWER POLE



21" OVEN



CAMPFIRE | **TT**
EDITION
CAMPFIRE TRAVEL TRAILERS

CAMPING MADE AFFORDABLE.

The Sprinter Campfire edition offers you six travel trailer floorplans loaded with features like Wide-Body construction, power awning with LED lights and built-in speakers, residential queen bed, auto leveling jacks, full outdoor kitchen, and much more. All this at a price you'll find extremely pleasing.



25RK



26RB



29BH



29FK

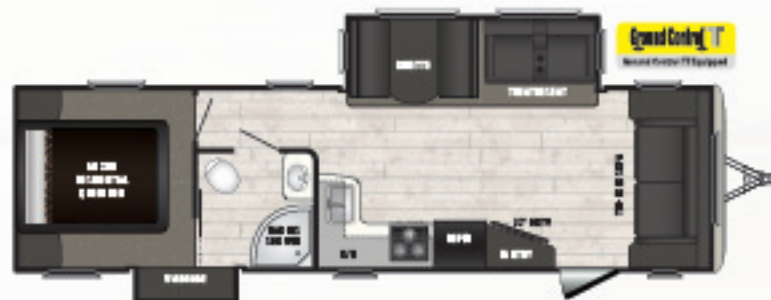

**30FL
NEW**



33BH

MODEL	SHIPPING WEIGHT	CARRYING CAPACITY	HITCH WEIGHT	EXT LENGTH*	EXT HEIGHT	FRESH WATER	WASTE WATER	GREY WATER	LPG
25RK	8445	2755	775	29' 6"	11' 1"	81	34	88	80
26RB	8848	2552	785	29' 6"	11' 1"	81	34	88	80
29BH	7737	2283	1020	33' 9"	11' 1"	81	34	88	80
29FK	7228	2774	875	32' 10"	11' 1"	81	34	88	80
30FL	7410	2590	895	34' 8"	11' 1"	81	34	34	80
33BH	8204	2958	1000	36' 8"	11' 3"	81	34	34	80

DISCLAIMER: Product information is as accurate as possible as of the date of publication of this brochure. All features, floor plans, and specifications in this brochure are subject to change without notice. Please also consult Keystone's web site at www.keystone.com for more current product information and specifications. Tow Vehicle Disclaimer: CAUTION: Owners of Keystone recreational vehicles are solely responsible for the selection and proper use of tow vehicles. All customers should consult with a motor vehicle manufacturer or their dealer concerning the purchase and use of suitable tow vehicles for Keystone products. Keystone disclaims any liability or damage suffered as a result of the selection, operation, use or misuse of a tow vehicle. KEYSTONE'S LIMITED WARRANTY DOES NOT COVER DAMAGE TO THE RECREATIONAL VEHICLE OR THE TOW VEHICLE AS A RESULT OF THE SELECTION, OPERATION, USE OR MISUSE OF THE TOW VEHICLE. *REFERENCE KEYSTONE RV COMPANY OWNERS MANUAL FOR LIMITED WARRANTY DETAILS. *Length is defined as the distance from the centerline of hitch pin/coupler to rear bumper of trailer.

CAMPFIRE TRAVEL TRAILER CONSTRUCTION

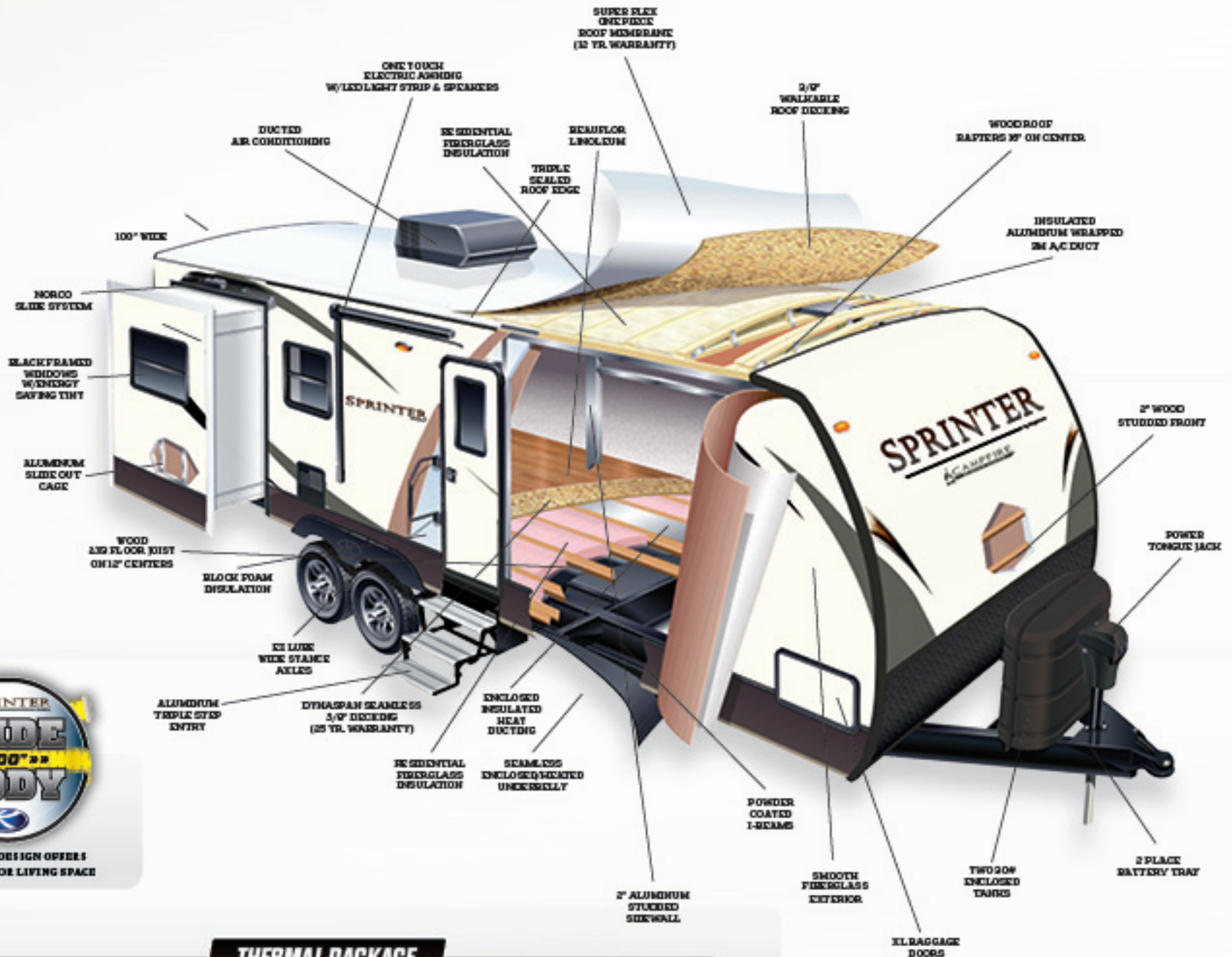

WIDERBODY DESIGN OFFERS MORE INTERIOR LIVING SPACE

THERMAL PACKAGE

HEATED & ENCLOSED UNDERBELLY \ 35K BTU FURNACE \ DOUBLE INSULATED ROOF

EXTERIOR FEATURES

- » KEYED ALIKE LOCK SYSTEM
- » FURRION SOLAR PREP QUICK CONNECT
- » FURRION BACK UP CAMERA PREP
- » INDUSTRY BEST, 100" WIDE BODY CONSTRUCTION
- » 100" WIDE-STANCE AXLES
- » CONTROL TT AUTO LEVELING JACKS
- » 30" FRICTION HINGE ENTRY DOOR
- » ELECTRIC AWNING WITH FRICTION-HINGE ADJUSTMENT, LED LIGHT STRIP, MANUAL OVERRIDE, AND SPEAKERS
- » BACKED FOR REAR LADDER
- » 2 BATTERY TRAY
- » SPLASH GUARD UNDER SLIDE
- » 64 CABLE SLIDE SYSTEM W/ 4 POINT SEAL
- » BEST IN CLASS 2" LAMINATED ALUMINUM FRAMED SIDEWALLS
- » ENCLOSED UNDERBELLY WITH DIRECT VENT HEAT
- » E-Z LUBE AXLES
- » TINTED SAFETY GLASS WINDOWS
- » ROAD ARMOR SUSPENSION **NEW**
- » REAR BUMPER STORAGE W/ END CAPS
- » ALUMINUM TRIPLE ENTRY STEP
- » XL ENTRY DOOR GRAB HANDLE
- » TOUGH GUARD PAINTED SKIRT METAL
- » 4" EXTRA LONG RAIN SPOUTS
- » TWO 30LB. LP BOTTLES WITH AUTO CHANGE-OVER REGULATOR
- » BLOW MOLDED SEAMLESS HOLDING TANKS
- » BLACK TANK FLUSH SYSTEM
- » SPRAY PORT
- » 30 AMP POWER CORD
- » CABLE AND SATELLITE HOOK-UP
- » ALUMINUM WHEELS
- » SPARE TIRE
- » OUTSIDE TV CABLE HOOKUP WITH 110 RECEPT IN PASS THRU
- » OUTSIDE KITCHEN MODELS W/ TV INCLUDE: TWO BURNER COOK-TOP, 32" LED TV, 4.3 CU. FT. 110V FRIDGE & STORAGE
- » REMOTE CONTROL SYSTEM (SLIDEOUTS, AUTO LEVEL SYSTEM & LED LIGHT STRIP, AWNING)

INTERIOR FEATURES

- » FULL 96" INTERIOR WIDTH (ADDED SQUARE FOOTAGE)
- » 5/8" WATER RESISTANT DYNASPAN FLOORING WITH 25 YEAR WARRANTY

- » 80" INTERIOR HEIGHT
- » 12 VOLT, 65 AMP CONVERTER
- » 35,000 BTU AUTO-IGNITION FURNACE
- » 15K BTU DUCTED AIR CONDITIONER WITH "QUICK COOL"
- » WINDOWS IN BOTH SLIDE-ROOM END WALLS
- » WATER HEATER BYPASS FOR EASY WINTERIZATION
- » DIGITAL THERMOSTAT
- » RESIDENTIAL CABINET HARDWARE
- » LARGE PICTURE WINDOW AT THE DINETTE & SOFA
- » INTERIOR ACCESS, MANUAL OVERRIDE FOR THE SLIDE ROOMS
- » IN-FLOOR HARD-DUCTED HEAT
- » LED OVERHEAD LIGHTING IN EVERY ROOM
- » CENTRAL COMMAND CENTER FOR MONITORING ALL TANKS AND BATTERY, AWNING, SLIDE-OUTS, LIGHTS
- » SCREWED CABINETS WITH LUMBER-CORE STILES
- » BEAUFLOIR LINOLEUM W/ 7 YEAR WARRANTY (2 YEAR COLD CRACK)

LIVING ROOM FEATURES

- » SOUND BAR ENTERTAINMENT SYSTEM WITH BLUETOOTH TECHNOLOGY, USB PORTS
- » 32" HD LED TV
- » CABLE TV HOOK-UP WITH ANTENNA AND SIGNAL BOOSTER
- » UNDER BOOTH DINETTE STORAGE
- » SATELLITE PREP WITH RG-6 CABLE
- » HIGH GRADE CARPETING
- » RESIDENTIAL FABRIC-COVERED VALANCE W/REMOVABLE DRAPES
- » TRI-FOLD SLEEPER SOFA W/STORAGE

BATH FEATURES

- » STAINLESS STEEL VANITY SINK
- » RESIDENTIAL MEDICINE CABINET WITH MIRROR
- » RADIAL GLASS SHOWER
- » SKYLIGHT OVER TUB/SHOWER
- » REINFORCED SHOWER SUPPORT
- » POWER ROOF VENT FAN
- » GFI RECEPTACLES IN THE BATHROOM
- » ILLUMINATED LIGHT SWITCH

KITCHEN FEATURES

- » LED AMBIENT LIGHTING UNDER KITCHEN COUNTERTOP

- » CROWN MOLDING CABINETS
- » 8 GALLON GAS/ELECTRIC DISA AUTO IGNITION WATER HEATER
- » 3 BURNER HIGH OUTPUT GAS RANGE
- » LARGE STAINLESS STEEL SINK
- » 22" DEEP DRAWERS
- » FULL EXTENSION BALL BEARING METAL DRAWER GUIDES
- » LIGHTED RANGE HOOD WITH EXHAUST FAN
- » MICROWAVE WITH CAROUSEL
- » 21" OVEN
- » 7 CU FT. DOUBLE DOOR, GAS/ELECTRIC FRIDGE
- » OVERHEAD CABINETS ABOVE THE SINK
- » STAINLESS STEEL APPLIANCES

BEDROOM FEATURES

- » FULL, RESIDENTIAL 80"X90" DREAM COLLECTION BED
- » HIGH GRADE CARPET IN MASTER BEDROOM
- » UNDER BED STORAGE
- » COLOR MATCHED BEDSPREAD
- » LED READING LIGHTS
- » ELECTRICAL OUTLET NEAR BED
- » ROOF VENT
- » AMPLE CLOSET STORAGE

SAFETY FEATURES

- » DUAL HITCH SAFETY CHAINS
- » SAFETY GLASS WINDOWS
- » FIRE EXTINGUISHER
- » SMOKE DETECTOR
- » CARBON MONOXIDE DETECTOR
- » EGRESS WINDOWS
- » LP GAS LEAK DETECTOR
- » BREAK AWAY SAFETY BRAKE
- » 4 WHEEL ELECTRIC BRAKES

POPULAR OPTIONS

- » FREE-STANDING RESIDENTIAL DINETTE WITH FOUR CHAIRS (EXCEPT 25RK)
- » 50 AMP ELECTRICAL SERVICE W/DETACHABLE CORD, AND 2ND AC PREP (EXCEPT 25RK, 26RB)

CAMPING MADE EASY PACKAGE

- » 30" FRICTION HINGE ENTRY DOOR
- » E-Z LUBE AXLES
- » XL ENTRY DOOR GRAB HANDLE
- » TOUGH GUARD PAINTED SKIRT METAL
- » 4" EXTRA LONG RAIN SPOUTS

- » BLACK TANK FLUSH SYSTEM
- » OUTSIDE TV HOOKUP WITH 110 RECEPT, AND CABLE PREP IN PASS THRU
- » ALUMINUM STEPS
- » INTERIOR ACCESS, MANUAL OVERRIDE FOR THE SLIDE ROOMS
- » ILLUMINATED LIGHT SWITCH

- » 22" DEEP DRAWERS
- » DUAL BATTERY TRAY W/BATTERY DISCONNECT
- » SOLAR PREP
- » LED INTERIOR LIGHTING



2-TONE PAINTED FRONT CAP



REAR CAMERA SETUP



OUTDOOR KITCHEN W/ TV



REMOTE SYSTEM



RESIDENTIAL SINK & FAUCET



4-POINT LEVELING SYSTEM



LED LIGHTING IN ALL ROOMS



SPRINGER
TRUE
RESIDENTIAL
QUEEN BED
60" X 80" QUEEN BEDS



KEYED ALIKE LOCKS



ROAD ARM OR SUSPENSION



SOLAR POWER PREP



21" OVEN



CAMPFIRE | **FW**
EDITION
CAMPFIRE FIFTH WHEELS

GREAT PRICE, AMAZING VALUE.

The new Springer Campfire edition fifth wheel offers you four floorplans loaded with features like Wide-Body construction, Road Arm or suspension, Key-Shield painted front cap, auto leveling jacks, full outdoor kitchen, and much more. All this at a price you'll find extremely pleasing.

CAMPFIRE FIFTH WHEEL CONSTRUCTION

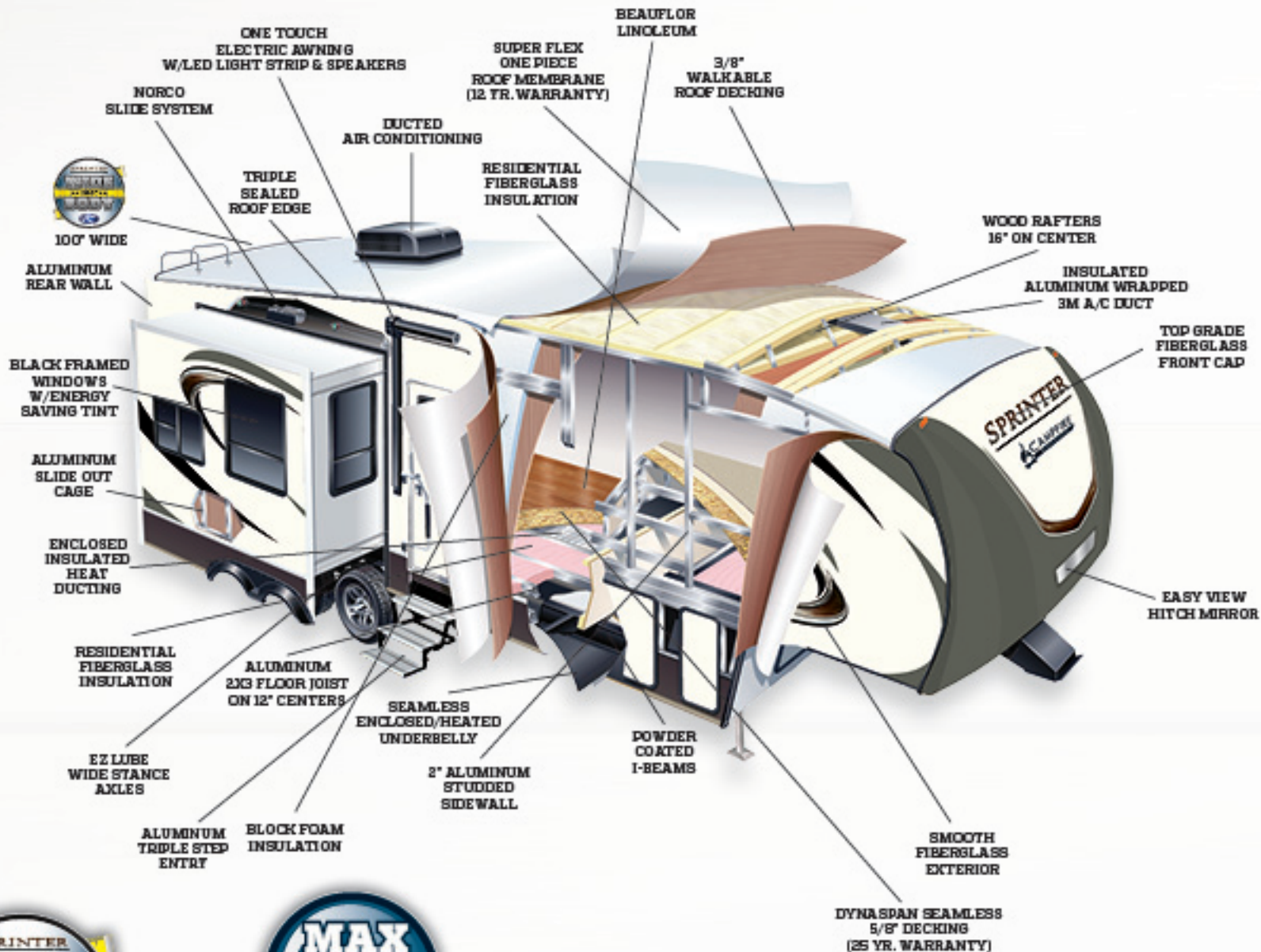

WIDEBODY DESIGN OFFERS MORE INTERIOR LIVING SPACE



30% MORE TURNING RADIUS UTILIZING THE LATEST TECHNOLOGY TO CREATE AN INCREASE IN TURNING RADIUS

THERMAL PACKAGE

HEATED & ENCLOSED UNDERBELLY \ 35K BTU FURNACE \ DOUBLE INSULATED ROOF

EXTERIOR FEATURES

- › KEyed ALIKE Lock SYSTEM
- › FURRIon SoLAR PREP QUICk cONNEct
- › FURRIon BAcK UP cAMERA PREP
- › INDUSTRY BESt, 100" WIDE BoDY cONSTRUctION
- › 100" WIDE-STANce AXLES
- › cONTRoL TT AUTO LEVELING JAcKS
- › 30" FRICtION HINGE ENTRy DoOR
- › ELEctRIC AWNING WITH FRICtION-HINGE ADJUSTMENT, LED LIGHT STRIP, MANUAL oVERRIDE, AND SPEAKERS
- › BAcKED FoR REAR LADDER
- › 2 BATTERY TRAY
- › SPLASH GUARD UNDER SLIDE
- › 64 cABLE SLIDE SYSTEM W/ 4 POINT SEAL
- › BESt IN cLASS 2" LAMINATED ALUMINUM FRAMED SIDEWALLS
- › ENcLoSEd UNDERBELLY WITH DIREct VENT HEAT
- › E-Z LUBE AXLES
- › TINTED SAFETY GLASS WINDoWS
- › RoAD ARMOR SUSPENSion **NEW**
- › REAR BUMPER STORAgE W/ END cAPS
- › ALUMINUM TRIPLE ENTRy STEP
- › XL ENTRy DoOR GRAB HANDLE
- › ToUGH GUARD PAINTED SKIRT METAL
- › 4" EXTRA LoNG RAIN SpOUTS
- › TwO 30LB. LP BoTTLES WITH AUTO cHANGE-oVER REGULATOR
- › 8LoW MoLDED SEAMLESS HoLDING TANKS
- › BLAcK TANK FLUSH SYSTEM
- › SPRAY PoRT
- › 50 AMP PoWER cORD-(EXcEPT 26FWRL-30AMP STANDARd)
- › cABLE AND SATELLITE HoOK-UP
- › ALUMINUM WHEELS
- › SPARE TIRE
- › oUTSIDE TV cABLE HoOKUP WITH 110 REcEP IN PASS THRU
- › oUTSIDE KITcHEN MoDELS W/ TV INcLUDE: TwO BURNER cOOK-ToP, 32" LED TV, 4.3 cu. FT. 110V FRIDGE & STORAgE
- › REMoTE cONTRoL SYSTEM (SLIDEoUTS, AUTO LEVEL SYSTEM & LED LIGHT STRIP, AWNING)

INTERIOR FEATURES

- › FULL 96" INTERIoR WIDTH (ADDED SQUARE FootAgE)
- › 5/8" WATER RESISTANT DYNASpAN FlooRING WITH 25 YEAR WARRANTY

- › 80" INTERIoR HEIGHT
- › 12 VoLT, 55 AMP cONVERTER
- › 35,000 BTU AUTO-IGNITION FURNAcE
- › 15K BTU DUCTED AIR cONDITIONER WITH "QUICk cOoL"
- › WINDoWS IN BoTH SLIDE-RoOM END WALLS
- › WATER HEATER BYPASS FoR EASY WINTERIZATIOn
- › DIGITAL THERMoSTAT
- › RESIDENTIAL CABINET HARDWARE
- › LARGE PICTURe WINDoW AT THE DINETTE & SoFA
- › INTERIoR ACCESS, MANUAL oVERRIDE FoR THE SLIDE RoOMS
- › IN-FLoOR HARD-DUCTED HEAT
- › LED oVERHEAD LIGHTING IN EVERY RoOM
- › cENTRAL cOMMAND cENTER FoR MoNIToRING ALL TANKS AND BATTERY, AWNING, SLIDE-oUTS, LIGHTS
- › ScREWED CABINETRY WITH LUMBER-cORE STILES
- › BEAUFLoR LINoLEUM W/ 7 YEAR WARRANTY (2 YEAR cOLD CRACK)

LIVING ROOM FEATURES

- › SoUND BAR ENTERTAINMENT SYSTEM WITH BLUETOOTH TEcHNoLoGY, USB PoRTS
- › 32" HD LED TV
- › cABLE TV HoOK-UP WITH ANTENNA AND SIGNAL BoOSTER
- › UNDER BoOTH DINETTE STORAgE
- › SATELLITE PREP WITH RG-6 cABLE
- › HIGH GRADE cARPETING
- › RESIDENTIAL FABRIC-cOVERED VALANcE W/REMoVABLE DRAPES
- › TRI-FoLD SLEEPER SoFA W/STORAgE

BATH FEATURES

- › STAINLESS STEEL VANITY SINK
- › RESIDENTIAL MEDICINE CABINET WITH MIRROR
- › RADIAL GLASS SHoWER
- › SKYLIGHT oVER TUB/SHoWER
- › REINFORCED SHoWER SUPPoRT
- › PoWER RoOF VENT FAN
- › GFI REcEPTAcLES IN THE BATHRoOM
- › ILLUMINATED LIGHT SWITcH

KITCHEN FEATURES

- › LED AMBIENT LIGHTING UNDER KITcHEN cOUNTERToP

- › cRoWN MoLDING CABINETRY
- › 6 GALLoN GAS/ELEctRIC DSIAUTO IGNITION WATER HEATER
- › 3 BURNER HIGH oUTPUT GAS RANGE
- › LARGE STAINLESS STEEL SINK
- › 22" DEEP DRAWERS
- › FULL EXTENSION BALL BEARING METAL DRAWER GUIDES
- › LIGHTED RANGE HoOD WITH EXHAUST FAN
- › MicRoWAVE WITH cARoUSEL
- › 21" oVEN
- › 7 cu FT, DoUBLE DoOR, GAS/ELEctRIC FRIDGE
- › oVERHEAD CABINETS ABovE THE SINK
- › STAINLESS STEEL APPLIANCES

BEDROOM FEATURES

- › FULL, RESIDENTIAL 60"X80" DREAM cOLLECTIoN BED
- › HIGH GRADE cARPET IN MASTER BEDRoOM
- › UNDER BED STORAgE
- › cOLOR MAtCHED BEDSPREAD
- › LED READING LIGHTS
- › ELEctRICAL oUTLET NEAR BED
- › RoOF VENT
- › AMPLE cLoSET STORAgE

SAFETY FEATURES

- › DUAL HITcH SAFETY CHAINS
- › SAFETY GLASS WINDoWS
- › FIRE EXTINGUISHER
- › SMOKE DETEcToR
- › CARBoN MoNoXIDE DETEcToR
- › EGRESS WINDoWS
- › LP GAS LEAK DETEcToR
- › BREAK AWAY SAFETY BRAKE
- › 4 WHEEL ELEctRIC BRAKES

POPULAR OPTIONS

- › FREE-STANDING RESIDENTIAL DINETTE WITH FoUR cHAIRS
- › 50 AMP ELEctRICAL SERVICe W/DETACHABLE cORD, AND 2ND Ac PREP (26FWRL)
- › 2ND 13.5 A/c (EXcEPT 26FWRL)

CAMPING MADE EASY PACKAGE

- › 30" FRICtION HINGE ENTRy DoOR
- › E-Z LUBE AXLES
- › XL ENTRy DoOR GRAB HANDLE
- › ToUGH GUARD PAINTED SKIRT METAL
- › 4" EXTRA LoNG RAIN SpOUTS

BLACK TANK FLUSH SYSTEM

- › oUTSIDE TV HoOKUP WITH 110 REcEP, AND cABLE PREP IN PASS THRU
- › ALUMINUM STEPS
- › INTERIoR ACCESS, MANUAL oVERRIDE FoR THE SLIDE RoOMS
- › ILLUMINATED LIGHT SWITcH

22" DEEP DRAWERS

- › DUAL BATTERY TRAY W/BATTERY DIScONNEct
- › SoLAR PREP
- › LED INTERIoR LIGHTING

Haier® 16 CU. FT. RESIDENTIAL FRENCH DOOR REFRIGERATOR

IT WORKS 2 WAYS!

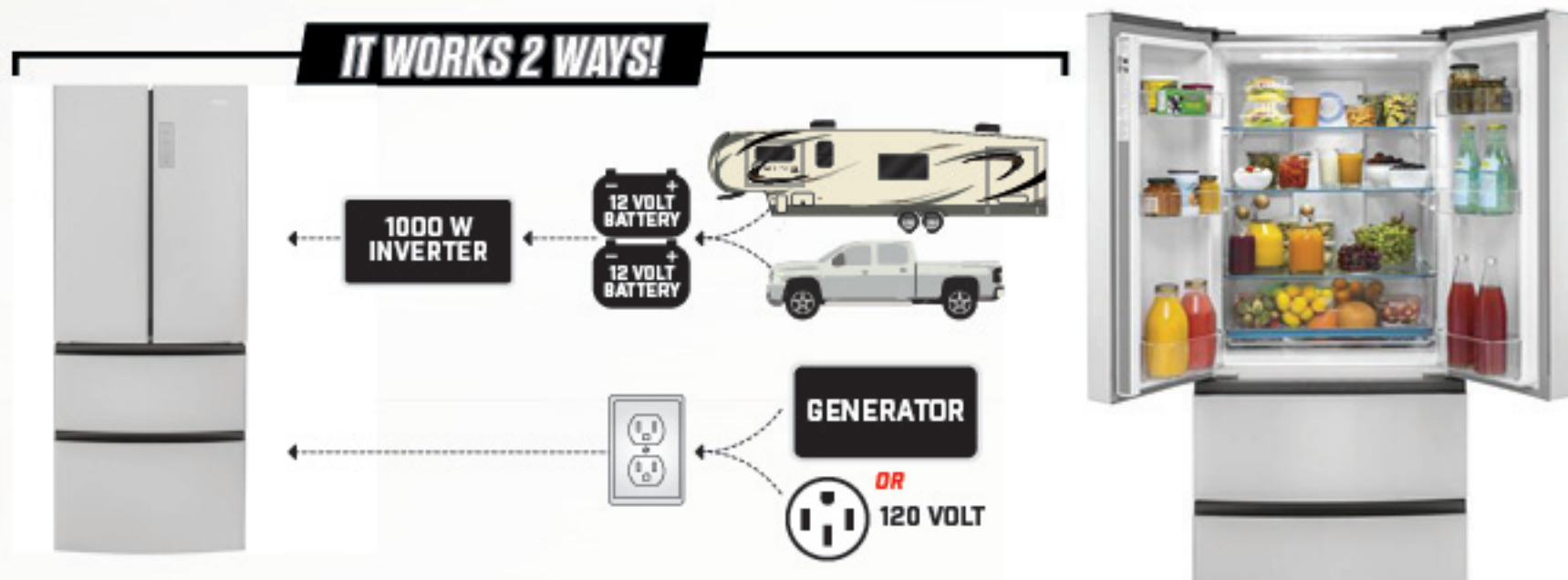

Stay in Touch



Sprinter is always just a touch away. You'll find 360 virtual tours, location of your nearest dealer, photos, videos and all of the latest information about Sprinter on our easy to navigate website. Everything you need can be accessed anytime, day or night, from home or on the road. You can also find us on the Keystone RV facebook.

KEYSTONERV.COM/SPRINTER-LIMITED

Our decors form the foundation for Sprinter's carefully coordinated interiors. Modern upholstery, drapery, fabrics, hardware, fashionable window treatments, walls & countertops in the latest colors and materials.



CASCADE DECOR



METRO DECOR



SPRINTER HAS EARNED THE RVDA DEALER SATISFACTION INDEX AWARD EIGHT TIMES!

RVDA is the national association representing RV retailers. The association's members include RV dealers, RV rental operators, and RV Aftermarket sales and service locations.

To qualify for the Quality Circle Award, brands/manufacturers must receive at least 15 dealer responses and score 80 percent or above in overall dealer satisfaction in the association's 18th Annual Dealer Satisfaction Index (DSI) survey.

RVDA asks dealers to express, confidentially, their level of satisfaction with their brands/manufacturers on eight core issues:

- Sales support
- Sales territory
- Vehicle design
- Vehicle reliability/quality
- Competitive price/value
- Parts support
- Dealership warranty support
- Overall dealer communications

****The DSI Quality Circle Award recognizes the high level of commitment these manufacturers show toward their dealer business partners," said RVDA Chairman of the Board Tim O'Brien of Circle K RVs in Lapeer, MI. "Their commitment to continuously improving products and processes ultimately helps dealers serve customers better."**

****RVDA.Org**

RV'S BUILT FOR THE LONG HAUL, WARRANTIES TOO!

1-YEAR LIMITED BASE WARRANTY

THE KEYSTONE LIMITED BASE WARRANTY COVERS YOUR RV FOR A PERIOD OF (1) YEAR FROM THE DATE OF PURCHASE BY THE ORIGINAL OWNER. THIS LIMITED WARRANTY COVERS DEFECTS IN MATERIALS & WORKMANSHIP SUPPLIED BY AND ATTRIBUTED TO KEYSTONE'S MANUFACTURING & ASSEMBLY OF THE RV.



3-YEARS

LIMITED STRUCTURAL WARRANTY

EFFECTIVE FOR KEYSTONE RECREATIONAL VEHICLES MANUFACTURED ON OR AFTER SEPTEMBER 1, 2017.

THE LIMITED STRUCTURAL WARRANTY COVERS YOUR RV FOR A PERIOD OF THREE (3) YEARS FROM THE DATE OF PURCHASE BY THE ORIGINAL OWNER. THIS STRUCTURAL WARRANTY COVERS THE WORKMANSHIP ATTRIBUTABLE TO KEYSTONE'S MANUFACTURING AND ASSEMBLY OF THE STRUCTURAL PORTIONS OF YOUR RV. STRUCTURAL COVERAGE INCLUDES:

- MAIN STEEL FRAME
- STEEL FRAME OUTRIGGERS & CROSS MEMBERS
- SKELETAL FRAMING (WALL STUDS, FLOOR JOISTS, ROOF RAFTERS)
- SIDEWALLS (LAMINATED & NON-LAMINATED)
- ROOF (LAMINATED & NON-LAMINATED)
- ROOF MATERIALS INSTALLATION
- FLOORS (LAMINATED & NON-LAMINATED)
- FRONT & REAR WALLS (LAMINATED & NON-LAMINATED)
- ALL SLIDE OUT BOXES & APPLICABLE STRUCTURAL COMPONENTS
- FIBERGLASS FRONT CAPS (PAINT FADE, CRACKING)
- FRONT CAP WINDSHIELD INSTALLATION
- FULLY TRANSFERABLE



EVEN MORE PROTECTION

SELECT COMPONENTS FROM SUPPLIERS THAT STAND BEHIND THEIR PRODUCTS

LIFETIME	TRED IT-ALUMINUM WHEELS (STEEL 2 YEARS)	
2.5 YEARS	DYNA SPAN-FLOOR DECKING	WESCO-FLEX PEX PIPING (FITTINGS 10 YEARS, EXCLUSIONS)
12 YEARS	ALPHA SYSTEMS-ROOFING MATERIAL	DICOR-ROOFING MATERIAL
7 YEARS	BEAU FLOOR-VINYL FLOORING	
6 YEARS	LIPPERT-AXLES	INTERVAC-CENTRAL VACUUM (ACCESSORIES 90 DAYS)
	DEXTER-AXLES	HP PRODUCTS-CENTRAL VACUUM
5 YEARS	SAMSUNG-REFRIGERATOR - SEALED SYSTEM AND LABOR ON DIGITAL INVERTER COMPRESSOR (10 YEARS ON COMPRESSOR PARTS)	
	WINEGARD RAZOR Z1-ANTENNA SYSTEM PARTS	WINEGARD ROASTA R-ANTENNA SYSTEM PARTS
	MOR/RYDE-RUBBER SUSPENSION SYSTEM (S SYSTEM 5 YEARS, CRE SYSTEM 2 YEARS)	ONAN-GENERATOR ENGINE (ELECTRICAL 2 YEARS)
3 YEARS	TREKK-FLOORING	STANDARD TECHNOLOGIES-FUEL PUMP SYSTEM
	BGS-GRAPHICS (5 YEAR LIMITED)	
	ASA ADVENT-AIR CONDITIONER	ATERRA-CONVERTER
	ATWOOD-STOVE/OVEN	CHENG-CONVERTER
	COLMAN-AIR CONDITIONER	CRANE-EXTERIOR FIBERGLASS
2 YEARS	DOMETIC-AIR CONDITIONER (PARTS AND FREIGHT YEARS)	DOMETIC-REFRIGERATOR (PARTS AND FREIGHT YEARS)
	FLO JET-WATER PUMP	FANTASTIC FAN-(DOME - LIFETIME)
	WFCO-WATER PUMP	PROGRESSIVE DYNAMICS-CONVERTER
	SUBURBAN-FURNACE (HEAT EXCHANGES YEARS)	ATWOOD-FURNACE
	SUBURBAN-WATER HEATER (TANK 3 YEARS)	SUBURBAN-OVEN
	WINEGARD-ANTENNA SYSTEM PARTS	VENTLINE-POWER FAN

THIS IS ONLY A SUMMARY. FOR DETAILS ON HOW EACH SUPPLIER'S WARRANTY IS ACTUALLY PROVIDED, PLEASE CONTACT THE SUPPLIER. WARRANTY COVERAGE IS SUBJECT TO THE SUPPLIER'S POLICY. WARRANTY COVERAGE IS LIMITED TO THE SUPPLIER'S MANUFACTURING AND ASSEMBLY OF THE SUPPLIER'S PRODUCTS. WARRANTY COVERAGE IS NOT TRANSFERABLE TO OTHER SUPPLIERS OR PRODUCTS.



WIRED FOR PERFORMANCE

THE ONLY TOWABLE MANUFACTURER TO INCORPORATE COLOR-CODED AND NUMBERED ELECTRICAL WIRING ON ALL PRODUCTS

- Create a clean, well-organized wiring layout
- Makes it easy to trace electrical circuits and save troubleshooting time

SUPERCHARGED A/C COOLING



TUF-LOK THERMOPLASTIC COUPLERS FORM A PERMANENT, CRUSH-RESISTANT SEAL IN YOUR AIR-CONDITIONING DUCT

- Securely joins ductwork and air conditioning units
- Crush-resistant design won't pull apart due to rough roads, heat and stress
- Dramatically reduces chilled-air leaks to boost cooling efficiency and comfort

IN-FLOOR RESIDENTIAL HEAT-DUCTS



Keystone RV

Competitor

RESIDENTIAL IN-FLOOR HEAT-DUCT SYSTEM JUST LIKE IN YOUR HOME

- In-floor, hot air vents speed for greatest comfort
- Distributes heat evenly and warm to the floor

BUILT FOR THE LONG HAUL



INNOVATION THAT STARTS WITH A SOLID FOUNDATION

WWW.KEYSTONERV.COM Keystone RV Company



110 RVDA QUALITY CIRCLE AWARDS
 • Keystone Brands have earned 110 DSI Quality Circle Awards since 2007



UP TO 7 LAYERS OF PROTECTION

MOST CAPS ARE FULLY PAINTED AND CLEAR-COATED IN OUR IN-HOUSE STATE OF THE ART PAINT FACILITY

- Backed by 2-year fade and chalk/indented warranty
- Keyboard chip and rock protectant applied to lower areas of travel trailer caps



MULTI TECHNOLOGY

TRU-FIT FIVE-POINT SLIDE ROOM CONSTRUCTION BACKED BY THE INDUSTRY'S BEST 3-YEAR LIMITED STRUCTURAL WARRANTY

- Rain channels direct rain away from the slide opening
- Exterior built-in locking track stays secure through extreme heat and cold
- Composite slide-room "glide" bar enables the room to move with no binding
- Reinforced roof, walls and floor
- Beefed-up aluminum header above slide room for greater strength

ENGINEERING



STEP 1:

1. ENGINEERING DESIGN
Multiple quality checkpoints

MANUFACTURING FACILITY



STEP 2:

2. MANUFACTURING DESIGN
Components are inspected by robots

BEST-IN-INDUSTRY 4 STAGE QUALITY PROCESS

INSPECTION



STEP 3:

3. INSPECTION
Final product inspection

OK TO SHIP



STEP 4:

4. DELIVERY
Final inspection on delivery to dealer

SPRINTER

by Keystone



PURCHASING YOUR RV LOCALLY

It's up to you where you purchase your new Sprinter, but may we suggest your local dealer? Not only does it help your local economy and provide jobs, but it will also give you an opportunity to develop a service relationship with someone that will come to know you and your coach. Congratulations on finding the best built, best equipped and best value in the industry. Happy travels!

// 20 YEARS AND STILL GOING STRONG //



YOUR LOCAL DEALER IS:

JANUARY 2018



**Keystone RV
Company**

WWW.KEYSTONERV.COM
574.535.2100 • 2642 HACKBERRY DRIVE
P.O. BOX 2000 • GOSHEN, IN 46527



Go RVing

DISCLAIMER: Product information is as accurate as possible as of the date of publication of this brochure. All features, floor plans, and specifications in this brochure are subject to change without notice. Please also consult Keystone's web site at www.keystonerv.com for more current product information and specifications. Tow Vehicle Disclaimer: CAUTION: Owners of Keystone recreational vehicles are solely responsible for the selection and proper use of tow vehicles. All customers should consult with a motor vehicle manufacturer or their dealer concerning the purchase and use of suitable tow vehicles for Keystone products. Keystone disclaims any liability or damages suffered as a result of the selection, operation, use or misuse of a tow vehicle. KEYSTONE'S LIMITED WARRANTY DOES NOT COVER DAMAGE TO THE RECREATIONAL VEHICLE OR THE TOW VEHICLE AS A RESULT OF THE SELECTION, OPERATION, USE OR MISUSE OF THE TOW VEHICLE.



CONNECT WITH KEYSTONE RV AND STAY UP TO DATE WITH PRODUCT NEWS AND INFORMATION

WWW.KEYSTONERV.COM/SPRINTER-LIMITED