



# FR3

BY FOREST RIVER

Cross Over Motorhome

## Specifications

**GVWR (Gross Vehicle Weight Rating)** is the maximum permissible weight of the unit when fully loaded. It includes all weights, inclusive of all fluids, occupants, cargo, optional equipment and accessories. For safety and product performance do NOT exceed the GVWR.

**GCWR (Gross Combined Weight Rating)** is the maximum permissible loaded weight of your motor home and any towed trailer or towed vehicle. Actual GCWR of this vehicle may be limited by the sum of the GVWR and the installed hitch receiver maximum capacity rating; see hitch rating label for detail.

**GAWR (Gross Axle Weight Rating)** is the maximum permissible weight, including cargo, fluids, optional equipment and accessories that can be safely supported by each axle.

**UVW (Unloaded Vehicle Weight)\*** is the typical weight of the unit as manufactured at the factory. It includes all weight at the unit's axle(s), including full fuel, all fluids and LP Gas. The UVW does not include cargo, fresh potable water, additional optional equipment or dealer installed accessories.

\*Estimated Average based on standard build optional equipment.

**CCC (Cargo Carrying Capacity)\*\*** is the amount of weight available for fresh potable water, cargo, passengers, additional optional equipment and accessories. CCC is equal to GVWR minus UVW. Available CCC should accommodate fresh potable water (8.3 lbs per gallon). Before filling the fresh water tank, empty the black and gray tanks to provide for more cargo capacity.

\*\* Estimated average based on standard build optional equipment.

Each Forest River RV is weighed at the manufacturing facility prior to shipping. A label identifying the unloaded vehicle weight of the actual unit and the cargo carrying capacity is applied to every Forest River RV prior to leaving our facilities.

The load capacity of your unit is designated by weight, not by volume, so you cannot necessarily use all available space when loading your unit.

Actual towing capacity is dependent upon your particular loading and towing circumstances, which includes the GVWR, GAWR and GCWR as well as adequate trailer brakes. Please refer to the Operator's Manual of your vehicle for further towing information.

	30DS	32DS	33DS
Chassis	Ford	Ford	Ford
Engine	V-10	V-10	V-10
Horsepower	320 HP	320 HP	320 HP
Torque	460 ft-lbs	460 ft-lbs	460 ft-lbs
Wheelbase	190"	228"	228"
Fuel Capacity	80 gal	80 gal	80 gal
Tire Size	245/70R19.5	245/70R19.5	245/70R19.5
GVWR	18,000 lbs	20,500 lbs	20,500 lbs
GCWR	23,000 lbs	26,000 lbs	26,000 lbs
CCC	2,530 lbs	1,978 lbs	1,978 lbs
GAWR Front	7,000 lbs	7,500 lbs	7,500 lbs
GAWR Rear	12,000 lbs	13,500 lbs	13,500 lbs
Exterior Storage	112 cu ft	116 cu ft	155 cu ft
Safety Belts	8	8	6
LP Tank	24.5 gal	24.5 gal	24.5 gal
Water Heater	6 gal	6 gal	6 gal
Furnace	35,000 BTU	35,000 BTU	35,000 BTU
Fresh Water	50 gal	50 gal	50 gal
Grey Tank	42 gal	42 gal	42 gal
Black Tank	42 gal	42 gal	42 gal
Length	31' 8"	33' 11"	34' 10"
Exterior Width	99.5"	99.5"	99.5"
Exterior Height w/A/C	12' 3"	12' 5"	12' 5"
Interior Width	95.5"	95.5"	95.5"
Interior Height	82"	82"	82"
Awning Length	16'	12'	19'

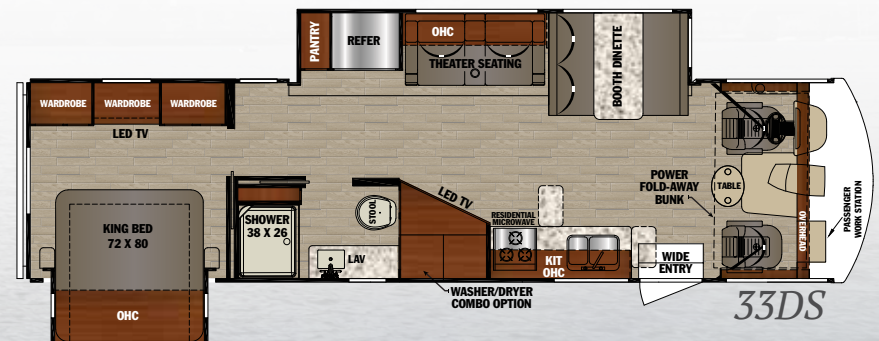
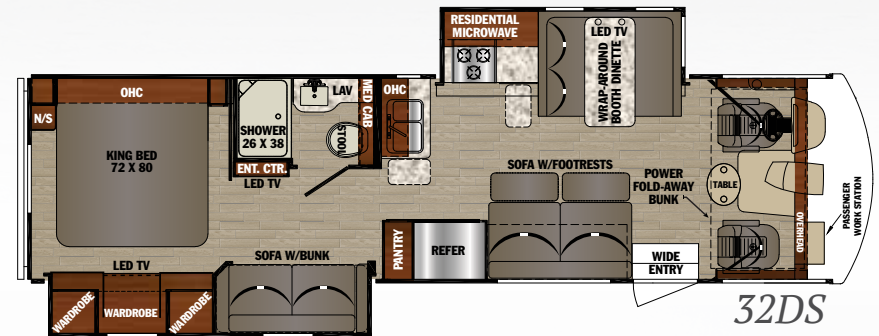
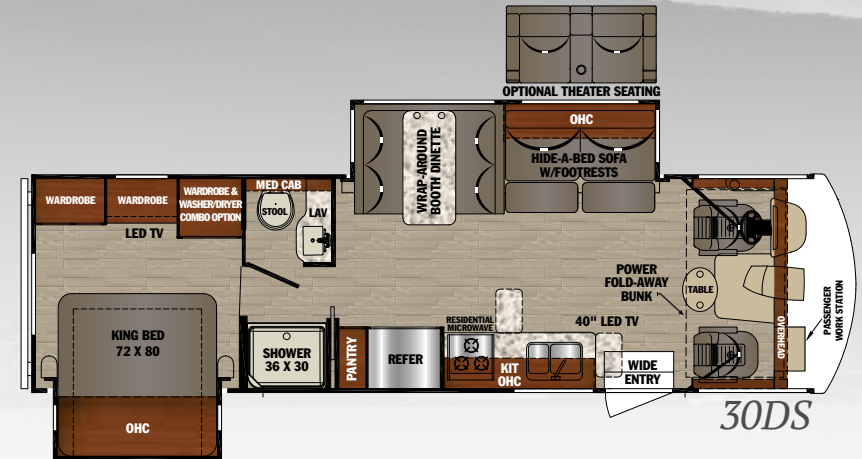

# FEATURES, STANDARDS & OPTIONS

## Construction & Exterior

White Diamond Pearl Gel-Coat Sidewalls w/Graphics  
One Piece Fiberglass Roof  
Fiberglass Front Cap  
Bi Hi/Lo Headlights  
LED Turn Signals  
Side-swing Front Grill w/Mesh Bug Shield  
Lower Fog Lights w/ LED Accents  
Color Side and Rear Camera Package  
"SUPER STORAGE" Pass-through Rear Cargo Compartment  
Grey Rotocast Storage Boxes w/Drains  
Rear Roof Ladder  
Power Patio Awning w/LED Light  
Slideout Room Awnings  
Rubber Tread Entry Steps  
Outside Shower  
Electric Entrance Step  
Rubberized Entry Assist Handle  
Vacuum Bonded Construction  
Steel Front Cockpit Cage  
Hydraulic 4-Point Leveling Jacks  
Outside Entertainment Center w/TV and Marine-Grade Speakers  
Quick Connect Exterior LP Fitting  
Solar Prep

## Chassis & Cockpit

Molded ABS Automotive Dash w/Laptop Console and 110V Outlet  
Power Front Sun Shade  
Ultra Leather Driver/Passenger Seating w/Double Stitching  
Low Profile Cockpit Engine Cover  
Pioneer Dash Entertainment System w/AM/FM/CD/DVD/Bluetooth/Backup Color Monitor/USB and Sound Selector (Mirror Link Navigation Available with Most Smart Phones)  
5,000 lb. Tow Hitch w/7-Way Plug  
Automotive Style Bonded One Piece Windshield w/Backlit Logo  
Power Heated Exterior Mirrors  
Driver/Passenger LED Map Lights  
Diamond Plate Rubber Floor Covering

## Interior

Entry Assist Handle  
Power Front Fold-Away Overhead Bunk w/Ladder

40" LED TV  
KING Jack™ Digital TV Antenna w/Built-in Signal Meter  
Radius Interior Ceiling  
Shaw Residential Vinyl Flooring  
Brushed Nickel Hardware  
Ultra Leather Sofa w/Dual Footrests (Hide-a-Bed 30DS, Jack Knife 32DS)  
Ultra Leather Wrap Around Dinette Booth w/Comfort Cushions  
Heavy Duty Full Extension Drawer Guides  
Night Shade Window Treatments  
LED Lighting Throughout  
Theatre Seating (33DS only)

## Galley

Four Door 12 cu. ft. Gas/Electric Refrigerator  
3-Burner Cooktop w/ Oven and Flush Mount Stove Cover  
Flip-up and Pullout Countertop Extensions  
Residential OTR Microwave Oven  
Large Double Bowl Stainless Steel Sink and Pullout Faucet  
Custom Countertops  
Trash Can Storage Area Below Sink  
12 Volt Charging Station  
Residential Kitchen Backsplash Tile

## Bedroom & Bathroom

72" x 80" Residential King Bed  
Bedroom Wardrobe  
Night Stands w/Charging Stations  
Toilet with Foot Flush  
Stainless Steel Lavatory Sink and Fixture  
Brushed Nickel Framed Glass Shower  
Washer Dryer Combo Prep (N/A 32DS)

## Safety & Convenience

Extra Wide Entry Door w/Deadbolt Lock  
Forest River Command Center  
Carbon Monoxide and LP Detectors  
Smoke Alarm  
Fire Extinguisher

## Electrical & Plumbing

5.5 KW Onan Generator  
(2) High Output Quiet Air Command™ Ducted Roof A/C w/Chill Construction and Heat Pump (Front A/C only)  
(2) Deep Cycle House Batteries  
Battery Disconnect Switch  
Emergency Start Switch  
6 Gallon Gas/Electric Water Heater

Arctic Pack System (Heated Holding Tanks)  
Black Tank Flush  
35,000 BTU Furnace  
50 Amp Service  
Progressive Dynamics Converter  
USB Charging Stations

## Decor

Oakley Seal  
Pebble

## Cabinetry

Landis Ash and Black Walnut Raised Panel Wood

## Options

Theatre Seating (in place of Hide-a-Bed on 30DS, Standard on 33DS)  
Combo Washer/Dryer (30DS, 33DS)

**FR3**  
BY FOREST RIVER

For more information visit  
[www.forestriverinc.com/fr3](http://www.forestriverinc.com/fr3)

Forest River, Inc.  
FR3 Division  
902 County Road 1  
Elkhart, IN 46515  
(574) 367.3285



YOUR FR3 DEALER

## CUSTOMER SATISFACTION



[www.ForestRiverBuyLocal.com](http://www.ForestRiverBuyLocal.com)

**FREE MEMBERSHIP**  
to Forest River Owners' Group  
[www.forestriverfrog.com](http://www.forestriverfrog.com)



For more information  
on the Ford F53 chassis,  
scan here.



**24/7 EMERGENCY ROADSIDE ASSISTANCE**

For a worry-free ownership experience Forest River includes one year of Coach-Net RV Technical & Roadside Assistance with each RV purchase. Whether new to the RV lifestyle or an experienced RV enthusiast, Forest River owners have 24/7 access to technical, operational and emergency road service coverage throughout the US & Canada. Coach-Net's fast, dependable service is just a phone call away.

**Coach-Net®**  
RV Technical & Roadside Assistance

For more information on  
Coach-Net, scan here.



**Learn More**  
Scan this barcode using  
a QR Reader on your  
smart phone to learn  
more about Forest River.



A Berkshire Hathaway company.

All information contained in this brochure is believed to be accurate at the time of publication. However, during the model year, it may be necessary to make revisions and Forest River, Inc., reserves the right to make all such changes without notice, including prices, colors, materials, equipment and specifications as well as the addition of new models and the discontinuance of models shown in this brochure. Therefore, please consult with your Forest River, Inc., dealer and confirm the existence of any materials, design or specifications that are material to your purchase decision. 11/18

©2018 FR3

a Division of Forest River, Inc., a Berkshire Hathaway company. All Rights Reserved.