

PRE-PRODUCTION PREVIEW

MODEL Z 3420

AVAILABLE STARTING IN JULY

Standard Run MSRP \$133,656

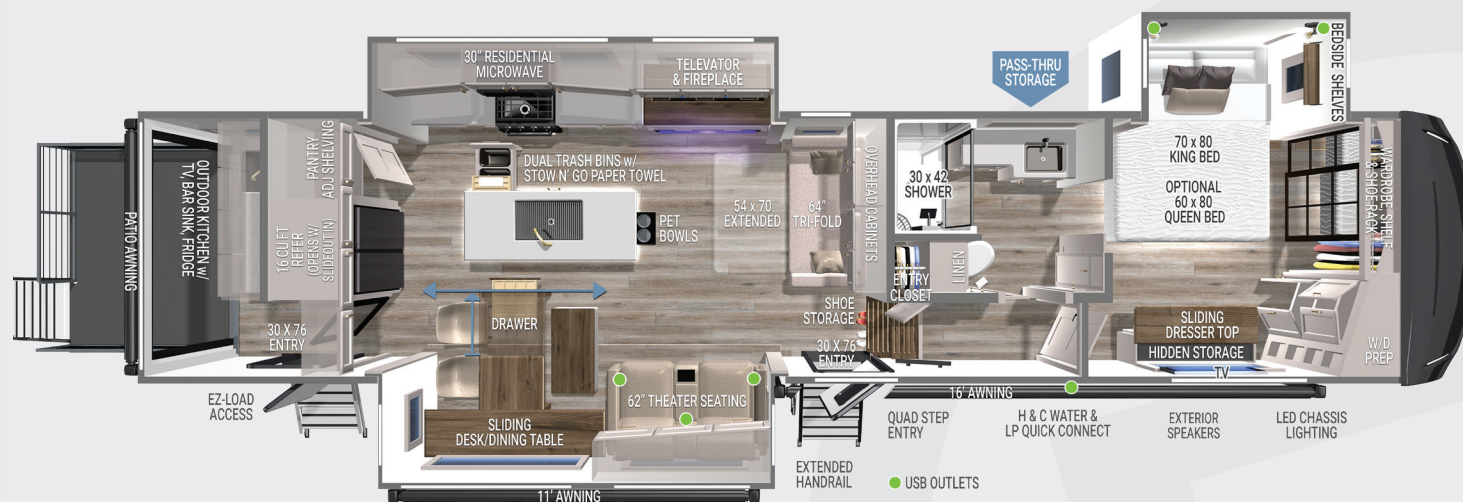

SPECIFICATIONS:

- UVW – 14,794 lbs.
- GVWR – 17,695 lbs.
- Hitch Weight – 2,612 lbs.
- Exterior Length – 39' 11"
- Overall Height w/ AC – 13'4"
- Width – 96"
- Bath & Bedroom Height - 79 ½"
- Slide Height - 76"
- Axles – Tandem 8,000 lbs.
- Wheels & Tires – 17.5" H-Rated (16 ply)
- Fresh Water Capacity – 75 gal.
- Gray Water Capacity – 90 True + 40 gal.
- Black Water Capacity – 45 gal.
- Insulation – Floors/Ceiling R40, Walls R11

FEATURES:

- Sliding Desk/Dining Table w/ Extending Leaf & Storage Drawer (Seats up to 4)
- Dual Pull-Out Trash Bins w/ Integrated Stow N' Go Paper Towel Holder
- 84" Pantry w/ Adjustable Shelves & Appliance Outlet
- Brinkley CraftSense™ Wood Trim Construction
- Premium Residential Cabinets & Drawers w/ Dovetail Joints
- Kitchen & Living/Dining Room Flush Floor Slides
- Bedside Shelves & Outlets w/ USB & USB-C
- Hidden Sliding Dresser Top Storage Compartment
- 24+ outlets and 6 outlets w/ USB & USB-C
- Pet Feeder w/ Removable Bowls
- Automotive Grade Front Cap, Lights, & Lens
- Square Euro Frameless Windows w/ 6" Openings (Dual Pane Optional)

- Rockford Stereo w/ App Control + Subwoofer Prep
- Integrated Window Screens & Insulated Blackout Blinds
- 370W Solar Panel w/ 50AMP MPPT Controller (Inverter Prep & Lithium Ready)
- 2 - Hot/Cold Outdoor Showers (BOTH sides of coach)
- Industry First Brass Plumbing Connections
- Large Exterior Storage w/ Tough Ply Liner
- Built-in Wire Conduit from Roof to Basement
- Industry First Low Maintenance Roof
- Electric Waste Valves w/ Indicator Light & Manual-Override
- One-Touch Automatic 6-Point Leveling System
- CURT Touring Coil Suspension System w/ ABS Brakes
- CURT Helux™ King Pin w/ Coil Spring & Shock-Absorber
- 13.5k Front AC w/ Heat Pump
- Furrion 18k Chill® Cube Rear AC

Outdoor Kitchen & Patio Highlights:

- Cabinet Storage, Work Surface, & Bar Sink
- Large 12V 3.3 Cu.Ft. Refrigerator (Travel Day Accessible)
- 50" Smart TV on Swivel Mount
- Zero-Gravity Rear Patio w/ Electric Top Latches
- Residential Style Wire Patio Railing, Power Awning w/ LED Lighting, & Steps
- Two-Sided MOLLE Panel w/ Prep Table & Cup Holders
- Patio Door w/ Tinted Glass
- Camp Side Second Entry Door

FACTORY OPTIONS:

- Queen Bed w/ Nightstands \$428
- Dual Pane Windows \$1,731
- Gen-Y® Executive Gooseneck w/ SnapLatch Torsion Flex \$1,876

Optional equipment & props may be shown.
All content is subject to change without notice.
Please consult with your dealer for current information.



For More Information, MSRP, Photos,
Videos & Why Brinkley go to **BrinkleyRV.com**



052225