

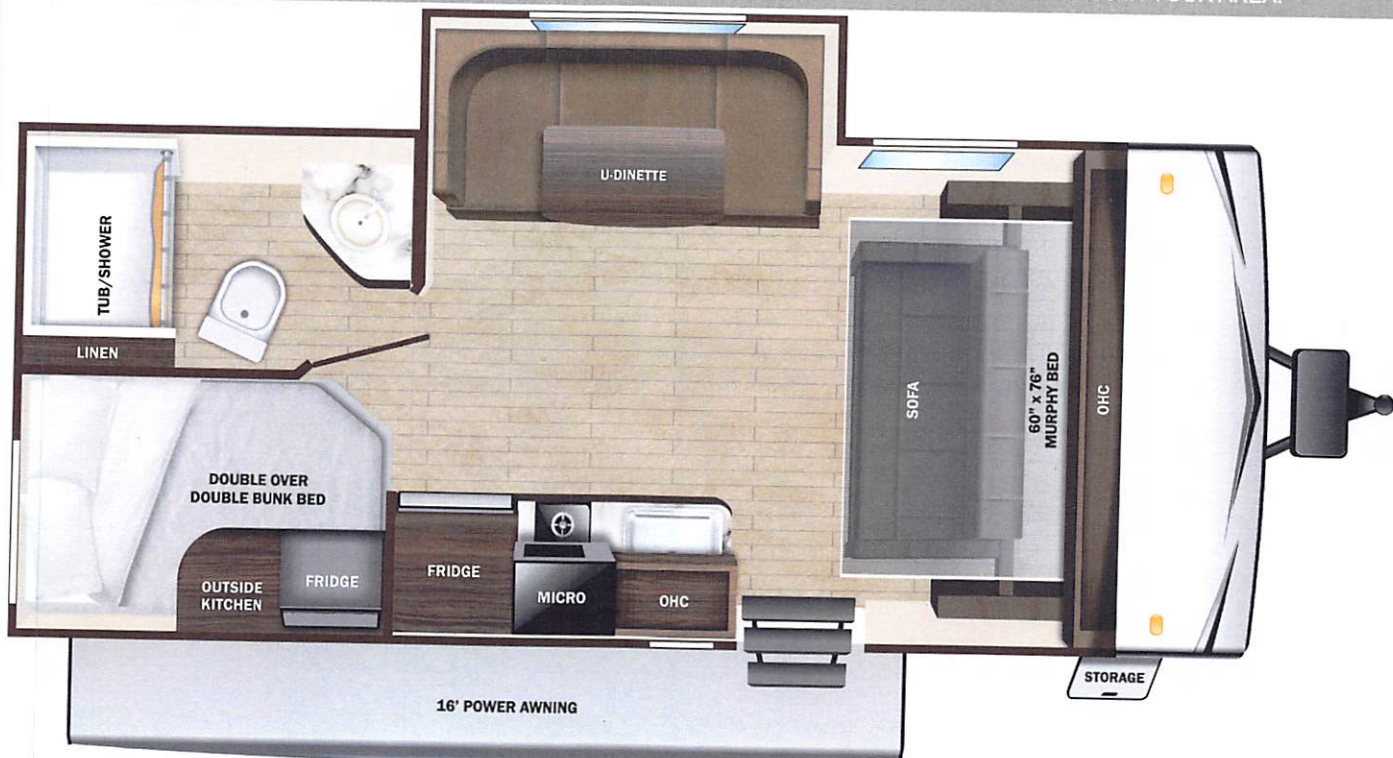

Manufacturer's Suggested Retail Price \$32,821.00

TOTAL AMOUNT DOES NOT INCLUDE STATE AND LOCAL TAXES OR LICENSE FEES. THE PRICE SHOWN ABOVE MAY OR MAY NOT BE REPRESENTATIVE OF THE ACTUAL SELLING PRICE OF SIMILAR RECREATIONAL VEHICLES IN YOUR AREA.



THIS VEHICLE

785.00
n/c

743.00
n/c
n/c
n/c
293.00
n/c



UVW

4412 lbs



Sleeps



Length

23' 9.75"

DIMENSIONS

Exterior height:.....126.00"
Exterior width:.....96.00"

WEIGHTS

GVWR:.....5675
GAWR (front):.....5145
GAWR (rear):.....0
Approx. Gross Cargo Carrying
Capacity (GCCC):.....1263

CAPACITIES

Fresh water tank (gals.):...42.00
Gray water tank (gals.):...40.00
Black water/toilet tank
(gals.):.....40.00
Propane (lbs.):.....20
Propane (gals.):.....4
Water heater (gals.):.....6.00

SEATING & SLEEPING

TIRES

Tire size (front):.....ST225/75R15E
Tire size (mid):.....
Tire size (rear):.....

1.00

Some dimensions may be rounded and may vary from the actual dimensions

***Weights may be estimated calculations and may vary from the actual weight

- refer to the vehicle weight labels for actual weights***

Floorplans, features and specifications are subject to change without notice.

3
YEAR
LIMITED
STRUCTURAL
WARRANTY



Highland

RIDGE RV

Open Range

Serial #: 58TBM0AK5T7533093
Model: 188BHS OPEN RANGE TT

Model Year: 2026 Dealer Name: PARRIS RV NORTH
4360 S. STATE STREET
MURRAY, UT 84107
USA



Standard Equipment

THE FOLLOWING ITEMS ARE STANDARD ON THIS MODEL

EXTERIOR

- 120 GFCI protected receptacle
- 5/8" main floor decking
- 96" exterior width
- Black front diamond plate protection
- Detachable power cords
- Exterior docking center (dual axle models)
- Fiberglass insulation
- Flexible LP lines
- Galvanized wheel wells
- Grab handle
- In-frame battery rack
- Magnetic baggage door catches
- Magnum Roof™ system
- PVC roofing membrane (limited lifetime warranty)
- Rain guttering with molded drip spouts
- Rear camera prep
- Safety bumper with drain hose carrier and end caps
- Self-adjusting electric brakes and E-Z Lube® axles
- Thermal Seal- enclosed, insulated, and heated underbelly and fully insulated roof with a PVC roofing membrane (dual axle models)
- Tinted safety-glass windows throughout

INTERIOR

- 75 lb. ball bearing drawer guides
- 81" interior height
- Flush floor slides with residential vinyl flooring (select models)
- Foot flush toilet
- Hidden hinge cabinet door hinges
- LED interior lighting
- Magnet cabinet catches
- Pleated blackout night shades
- Pocket-screwed lumbercore cabinet construction
- Pressed membrane kitchen countertops
- Range hood
- Residential high-rise kitchen faucet
- Single basin under-mount kitchen sink
- Solid hardwood cabinet doors
- Solid hardwood drawer fronts
- Storage below main bed

CUSTOMER CONVENIENCE PACKAGE (Mandatory)

- 13,500 BTU roof mounted A/C
- 17" oven (dual axle models)
- 2-burner range with glass cover (single axle models)
- 3-burner range with glass cover (dual axle models)
- Friction hinge entrance door with window and shade prep
- Gas/electric water heater
- Microwave
- Nitrogen filled radial tires
- Powered awning with LED lighting
- Powered bathroom vent
- Residential vinyl flooring throughout
- Solid swing down step (main)
- Stabilizer jacks (4-dual axle models, 2-single axle models)
- Water heater bypass
- Xtend Solar I Package (200 watt solar panel with 30 amp controller)

Optional Equipment

OPTIONAL EQUIPMENT INSTALLED ON T
BY MANUFACTURER

Base price
USA STANDARDS
CUSTOMER CONVENIENCE
PACKAGE
STANDARD PACKAGE
METAL SIDEWALL
STANDARD RIMS
SPARE TIRE & CARRIER
UPGRADED FRESH WATER TANK

2

UNIT TOTAL

32,8

DEALER INSTALLED OPTIONS