

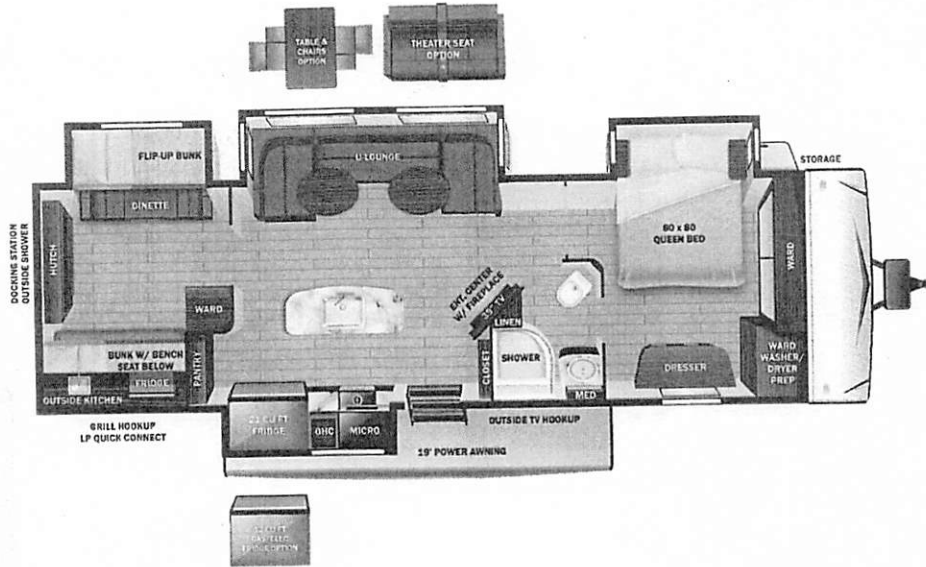

# Manufacturer's Suggested Retail Price \$88,914.00

TOTAL AMOUNT DOES NOT INCLUDE STATE AND LOCAL TAXES OR LICENSE FEES. THE PRICE SHOWN ABOVE MAY OR MAY NOT BE REPRESENTATIVE OF THE ACTUAL SELLING PRICE OF SIMILAR RECREATIONAL VEHICLES IN YOUR AREA.



THIS VEHICLE

793.00  
n/c  
000.00

750.00  
793.00  
n/c

n/c  
n/c

375.00  
203.00  
n/c

**UVW**  
10170 lbs

**Sleeps**

**Length**  
39' 4"

### DIMENSIONS

Exterior height:.....143.00"  
Exterior width:.....100.00"

### WEIGHTS

GVWR:.....11500  
GAWR (front):.....5200  
GAWR (rear):.....5200  
Approx. Gross Cargo Carrying Capacity (GCCC):.....1330

### TIRES

Tire size (front):.....ST235/80R16E  
Tire size (mid):.....  
Tire size (rear):.....ST235/80R16E

### CAPACITIES

Fresh water tank (gals.):...43.00  
Gray water tank (gals.):....84.00  
Black water/toilet tank (gals.):.....33.00  
Propane (lbs.):.....60  
Propane (gals.):.....14  
Water heater (gals.):.....6.00

### SEATING & SLEEPING

14.00

\*\*\*Some dimensions may be rounded and may vary from the actual dimensions\*\*\*  
\*\*\*Weights may be estimated calculations and may vary from the actual weight\*\*\*



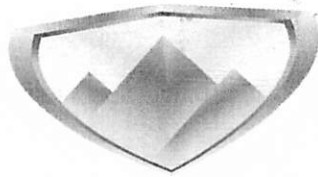

# Highland RIDGE RV

## Mesa Ridge

Serial #: 58TBW0BU4P3M13051  
Model: 330BHS MESA RIDGE TT

Model Year: 2023 Dealer Name: PARRIS RV INC.  
4360 SOUTH STATE STR  
MURRAY, UT 84107  
USA



### Standard Equipment

### Optional Equipment

THE FOLLOWING ITEMS ARE STANDARD ON THIS MODEL  
AT NO EXTRA CHARGE

OPTIONAL EQUIPMENT INSTALLED  
BY MANUFACTURER

#### EXTERIOR

- 100" wide body frame
- 2-30 lb. LP bottles
- 4" tube storage bumper
- 50 amp service
- ACCU-SLIDE™ slide system (42" deep 4-corner compression)
- Battery disconnect switch
- Brass hanger bushings with wet bolts
- Equa-Flex® axle suspension
- Exterior grill/griddle quick connect port
- Frameless windows
- Marine grade exterior speakers (2)
- Norco™ 5.1 stabilizer system with BAL™ lock arms
- PVC roofing membrane (limited lifetime warranty)
- Rear roof access ladder
- Self-adjusting electric brakes
- Spare tire
- TuffShell™ - vacuum bonded laminated construction, reinforced with heavy-duty fiberglass and welded aluminum frames

#### FOUR SEASON PACKAGE (Mandatory)

- Double insulated baggage doors
- Ducted heat to underbelly with cold air return
- Enclosed cable operated gate valves
- Enclosed exterior docking station with black tank flush
- Heated and enclosed underbelly
- High performance furnace
- R-38 reflective foil insulation in ceiling and underbelly
- R-9 block foam insulation in sidewalls

#### INTERIOR

- 21 cu. ft. residential refrigerator
- 60" x 80" residential queen bed with storage below
- 75 lb. ball bearing drawer guides
- Cable and satellite prep
- Flush floor slides with residential vinyl flooring
- Glass shower door
- Hardwood cabinet doors
- Large oven and 3-burner range with flush mount glass cover
- LED interior lighting
- Observation camera prep
- Residential microwave
- Roller blackout night shades
- USB ports in bedroom

#### EXECUTIVE PACKAGE (Mandatory)

- 13,500 BTU A/C with quiet residential return air-bedroom
- 15,000 BTU A/C with quiet residential return air-main living
- AM/FM/HDMI/USB/AUX Bluetooth® sound bar stereo with outdoor zoned speakers
- Cutting board and sink strainer
- Dome style digital TV antenna with Wi-Fi prep
- Interior convenience center light
- JBL® Aura Cube stereo with Bluetooth® and miZONE™ technology
- JBL® Premium indoor and outdoor multizone speakers
- Keyed-Alike® entry and baggage doors
- LED HDTV
- Painted fiberglass front cap with LED lighting
- Power awning with LED lighting
- Power tongue jack
- Quick recovery gas/electric water heater
- Quick release fresh water drain
- Residential high-rise faucet with pull-down sprayer
- Single basin stainless steel under-mount kitchen sink
- Solar prep
- Solid swing-down entry steps
- Solid-surface kitchen countertops
- Stainless steel appliances
- TravellINK® - Smart RV system that allows for Bluetooth® control of awnings, lighting, slides, heating, cooling and more
- USB/12V charging port

- Base price
- USA Standards
- Executive Package
- Four Seasons Protection Package
- Xtend Solar II Package
- No Heat Pump
- 21 Cu. Ft. 110 Volt Refrigerator
- Windows Standard
- Power Fan Vent Wall Control (Bathroom)
- BBQ Grill
- U-Lounge Sofa

UNIT TOTAL

DEALER INSTALLED