



Highland

RIDGE RV

Open Range

Serial #: 58TBMSBP0P7523051
Model: 263TH OPEN RANGE TT

Model Year: 2023 Dealer Name: PARRIS RV INC.

4360 SOUTH STATE ST
MURRAY, UT 84107
USA

Standard Equipment

Optional Equipment

THE FOLLOWING ITEMS ARE STANDARD ON THIS MODEL
AT NO EXTRA CHARGE

OPTIONAL EQUIPMENT INSTALLED
BY MANUFACTURER

EXTERIOR

- 120 GFCI protected receptacle
- 5/8" main floor decking
- 96" exterior width
- Black front diamond plate protection
- Exterior docking center (dual axle models)
- Detachable power cords
- Fiberglass insulation
- Flexible LP lines
- Galvanized wheel wells
- Grab handle
- In-frame battery rack
- Magnetic baggage door catches
- Magnum Roof™ system
- Marine grade exterior speakers (2)
- PVC roofing membrane (limited lifetime warranty)
- Rain guttering with molded drip spouts
- Rear camera prep
- Safety bumper with drain hose carrier and end caps
- Self-adjusting electric brakes and E-Z Lube® axles
- Thermal Seal- enclosed, insulated, and heated underbelly and fully insulated roof with a PVC roofing membrane (dual axle models)
- Tinted safety-glass windows throughout

INTERIOR

- 75 lb. ball bearing drawer guides
- 81" interior height
- AM/FM/Bluetooth® radio with indoor/outdoor zoned speakers
- Closeable A/C vents
- Flush floor slides with residential vinyl flooring
- Foot flush toilet
- Hardwood cabinet doors
- LED interior lighting
- Pleated blackout night shades
- Pocket-screwed lumbercore cabinet construction
- Pressed membrane kitchen countertops
- Range hood
- Residential high-rise kitchen faucet with pull-down sprayer
- Single basin under-mount kitchen sink
- Storage below main bed

CUSTOMER CONVENIENCE PACKAGE (Mandatory)

- 13,500 BTU roof mounted A/C
- 17" oven (dual axle models)
- 2-burner range with glass cover (single axle models)
- 3-burner range with glass cover (dual axle models)
- Dome style digital TV antenna
- Gas/electric water heater
- Microwave
- Powered awning with LED lighting
- Powered bathroom vent
- Nitrogen filled radial tires
- Residential vinyl flooring throughout
- Solar prep
- Stabilizer jacks (4)
- Solid swing down step (main)
- Entrance door with window and shade prep
- Water heater bypass

- Base price
- CSA Standards
- Customer Convenience Package
- Xtend Solar I Package
- 15,000 BTU AC
- 8 Cu. Ft. 12v Refrigerator
- Standard Rims
- Ramp Door
- Upgraded Fresh Water Tank

UNIT TOTAL

31

DEALER INSTALLED OPTIC

Manufacturer's Suggested Retail Price \$39,617.00

TOTAL AMOUNT DOES NOT INCLUDE STATE AND LOCAL TAXES OR LICENSE FEES. THE PRICE SHOWN ABOVE MAY OR MAY NOT BE REPRESENTATIVE OF THE ACTUAL SELLING PRICE OF SIMILAR RECREATIONAL VEHICLES IN YOUR AREA.

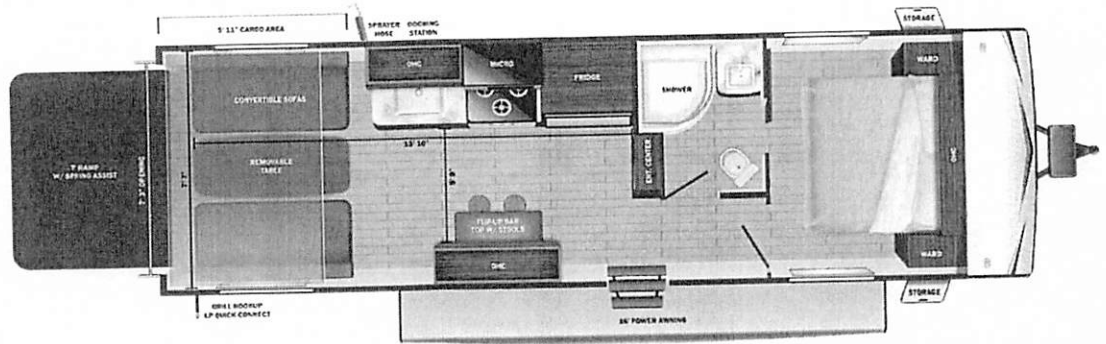

THIS VEHICLE

- 688.00
- 293.00
- 1,743.00
- 593.00
- 300.00

- n/c
- n/c
- n/c
- n/c



UVW
6200 lbs



Sleeps



Length
30' 4.38"

DIMENSIONS

Exterior height:.....126.25"
 Exterior width:.....96.00"

WEIGHTS

GVWR:.....7600
 GAWR (front):.....3500
 GAWR (rear):.....3500
 Approx. Gross Cargo Carrying Capacity (GCCC):.....1400

CAPACITIES

Fresh water tank (gals.):...84.00
 Gray water tank (gals.):...39.00
 Black water/toilet tank (gals.):.....39.00
 Propane (lbs.):.....60
 Propane (gals.):.....14
 Water heater (gals.):.....6.00

SEATING & SLEEPING

TIRES

Tire size (front):.....ST205/75R14D
 Tire size (mid):.....
 Tire size (rear):.....ST205/75R14D

