

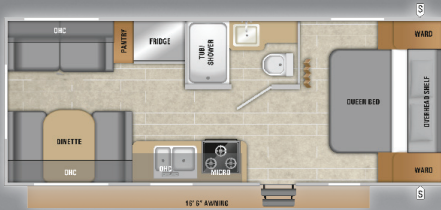

Highland
RIDGE RV

MesaRidge



MR21FB

Length (pin to rear): **25'8"** Ext. Height: **126"** Unloaded Wt. (lbs.): **4,260**



MR23RLS

Length (pin to rear): **29'1"** Ext. Height: **132"** Unloaded Wt. (lbs.): **5,295**

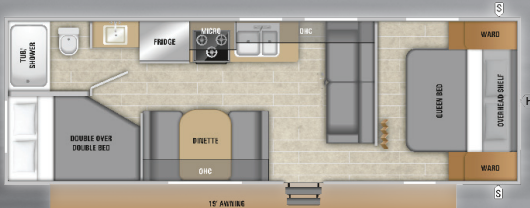

MR26BH

Length (pin to rear): **29'4"** Ext. Height: **125"** Unloaded Wt. (lbs.): **4,660**



MR26BHS

Length (pin to rear): **30'7"** Ext. Height: **134"** Unloaded Wt. (lbs.): **5,800**

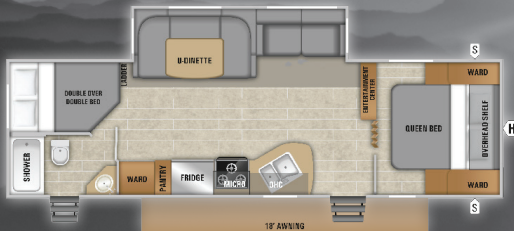

MR27BHS

Length (pin to rear): **31'9"** Ext. Height: **135"** Unloaded Wt. (lbs.): **6,265**

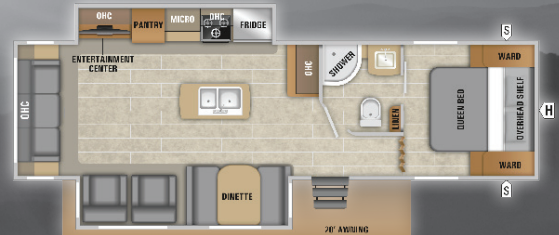

MR27RLI

Length (pin to rear): **33'10"** Ext. Height: **133"** Unloaded Wt. (lbs.): **7,145**

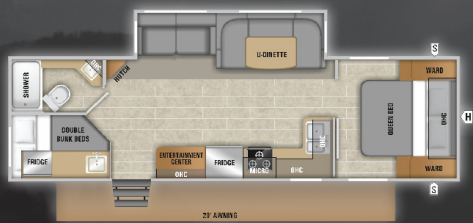

MR282BH

Length (pin to rear): **32'5"** Ext. Height: **134"** Unloaded Wt. (lbs.): **6,620**

TOP FEATURES

- EXTERIOR LADDER
- DUAL 30# LP BOTTLES
- LP BOTTLE COVER
- ALUMINUM WHEELS
- STAINLESS STEEL APPLIANCES
- ELECTRIC TONGUE JACK
- HEATED AND ENCLOSED UNDERBELLY
- MANY MORE ADDITIONAL FEATURES...

	MR21FB	MR23RLS	MR26BH	MR26BHS	MR27BHS	MR27RLI	MR282BHS
Unloaded Vehicle Weight	4260	5295	4660	5800	6265	7145	6620
Hitch Weight	487	630	547	687	717	1065	623
Length (Pin to Rear)	25'8"	29'1"	29'4"	30'7"	31'9"	33'10"	32'5"
Cargo (Gross)	1740	1655	1840	1700	2235	1850	1880

*Due to continual research and advances, manufacturer reserves the right to change specifications, design, price, and equipment without notice, and assumes no responsibility for any error in the literature. Some items shown are not included as standard or optional equipment.



CONSTRUCTION FEATURES

FULL WALKABLE ROOF

3/8" DECKING

16" ON CENTER RAFTERS

LARGE SMASH PLATES ON EITHER SIDE RAFTERS (MAGNUM TRUSS)

50% STRONGER (4,500LB CAPACITY)

DIFLEX II ROOFING SYSTEM (12 YEAR WARRANTY)

30% LIGHTER

EMBOSSED FINISH (Improves Walkability = less slipping)

917 ADHESIVE (Retacking Properties)

POLAR WHITE (Heat Reflectivity = less heat absorption)

FLEXIBILITY (More Maneuverable = easier installation)

FIBERGLASS ROOF INSULATION

FULLY DUCTED A/C W/ DIRECTIONAL VENTS

5/8" RESIDENTIAL MAIN FLOOR DECKING

HEAT AND ENCLOSED UNDERBELLY

STRUCTURAL STEEL I-BEAM FRAME

ELECTRIC BRAKES

WOOD AND ALUMINUM SIDEWALL CONSTRUCTION

S-LOCKING MESA METAL AND FIBERGLASS INSULATION



Highland
RIDGE RV

MesaRidge



EXTERIOR FEATURES

EXTERIOR HIGH FRONT DIAMOND PLATE/ ROCK GUARD
TINTED SAFETY GLASS WINDOWS
DUAL 30# LP BOTTLES
LP BOTTLE COVER
ELECTRIC AWNING W/ LED LIGHTS
EXTERIOR SPEAKERS
MOLDED RAIN GUTTERS W/ DOWN SPOUTS
SOLAR PREP
ALUMINUM WHEELS w/NITROGEN FILLED TIRES
SPARE TIRE W/ CARRIER
DOCKING STATION
TANK FLUSH
HOT/COLD WATER
EZ - STORE DETACHABLE POWER CORD
POWER TONGUE JACK
ROOF MOUNTED 13.5k A/C
EXTERIOR LADDER
BAGGAGE DOORS W/ MAGNETIC LATCHES
FULL WALKABLE ROOF
DIFLEX II ROOFING SYSTEM (12 YEAR WARRANTY)
OMNIDIRECTIONAL DIGITAL ANTENNA

*Due to continual research and advances, manufacturer reserves the right to change specifications, design, price, and equipment without notice, and assumes no responsibility for any error in the literature. Some items shown are not included as standard or optional equipment.



Highland
RIDGE RV

MesaRidge



INTERIOR FEATURES

TV PREP W/ CABLE & SATELLITE (MAIN LIVING & BEDROOM)

STEREO

LED LIGHTING W/ INDIVIDUAL ON/OFF SWITCHES

STAINLESS STEEL APPLIANCES

6 cuft REFRIGERATOR

3 BURNER RANGE W/ 17" OVEN

MICROWAVE

RANGE HOOD (VENTED OUT SIDEWALL)

FULL EXTENSION BALL BEARING DRAWER GUIDE (75lb CAPACITY)

RESIDENTIAL HIGH RISE KITCHEN FAUCET

BLACK PLEATED NIGHT SHADES

QUEEN COMFORTER IN MAIN BEDROOM

600lb DOUBLE BUNK CAPACITY (ALL DOUBLE BUNK MODELS)

300lb SINGLE BUNK CAPACITY (ALL SINGLE BUNK MODELS)

QUILTED DINETTE CUSHIONS

BOOTH DINETTES W/ UNDER STORAGE

FOOT FLUSH TOILET

BATHROOM VENT

GAS DSI WATER HEATER

CONGOLEUM - DESIGNER CAREFREE LINOLEUM

DURABLE COATING

EASIER TO CLEAN

IMPACT RESISTANT