

**MR21FB**

Length (pin to rear): **25'8"** Ext. Height: **126"** Unloaded Wt. (lbs.): **4,260**



**MR23RLS**

Length (pin to rear): **29'1"** Ext. Height: **132"** Unloaded Wt. (lbs.): **5,295**

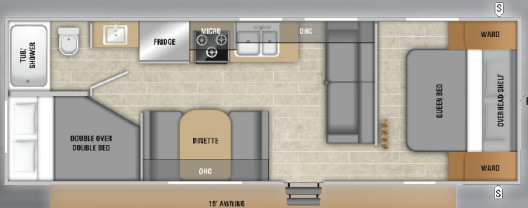

**MR26BH**

Length (pin to rear): **29'4"** Ext. Height: **125"** Unloaded Wt. (lbs.): **4,660**



**MR26BHS**

Length (pin to rear): **30'7"** Ext. Height: **134"** Unloaded Wt. (lbs.): **5,800**

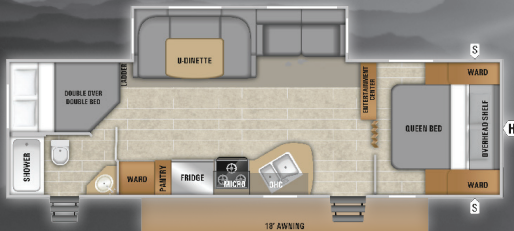

**MR27BHS**

Length (pin to rear): **31'9"** Ext. Height: **135"** Unloaded Wt. (lbs.): **6,265**

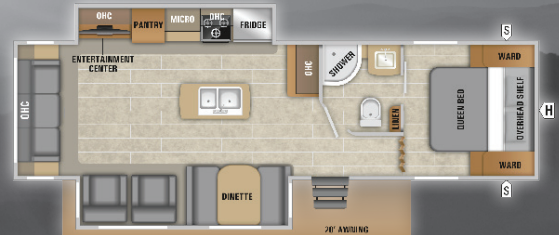

**MR27RLI**

Length (pin to rear): **33'10"** Ext. Height: **133"** Unloaded Wt. (lbs.): **7,145**

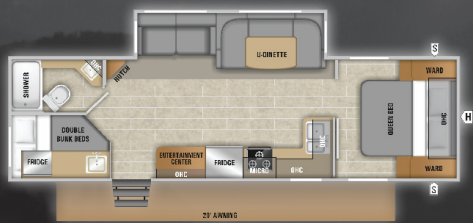

**MR282BH**

Length (pin to rear): **32'5"** Ext. Height: **134"** Unloaded Wt. (lbs.): **6,620**

## TOP FEATURES

- EXTERIOR LADDER
- DUAL 30# LP BOTTLES
- LP BOTTLE COVER
- ALUMINUM WHEELS
- STAINLESS STEEL APPLIANCES
- ELECTRIC TONGUE JACK
- HEATED AND ENCLOSED UNDERBELLY
- MANY MORE ADDITIONAL FEATURES...

	<b>MR21FB</b>	<b>MR23RLS</b>	<b>MR26BH</b>	<b>MR26BHS</b>	<b>MR27BHS</b>	<b>MR27RLI</b>	<b>MR282BHS</b>
Unloaded Vehicle Weight	4260	5295	4660	5800	6265	7145	6620
Hitch Weight	487	630	547	687	717	1065	623
Length (Pin to Rear)	25'8"	29'1"	29'4"	30'7"	31'9"	33'10"	32'5"
Cargo (Gross)	1740	1655	1840	1700	2235	1850	1880

\*Due to continual research and advances, manufacturer reserves the right to change specifications, design, price, and equipment without notice, and assumes no responsibility for any error in the literature. Some items shown are not included as standard or optional equipment.