

PUMA

XLE LITE

by Palomino - Since 1968

Travel Trailers



Toy Haulers



Weekend Getaway

PUMA

XLE LITE

by Palomino

Puma XLE Lite leads the industry with a broad selection of well-planned floorplans. Construction features include solid I-beam frames, one-piece 5/8" floor decking, one-piece rubber roofs and large fresh water tanks. Our tried and true, rack and pinion flush-floor slide system with superior sealing, is the most reliable on the market today. This system includes manual override. The available optional power awning features LED strip lighting. Molded ABS fender skirts and spoked rims add sleek styling! Interiors include durable Beauflor in woodgrain and efficient LED lighting throughout. Customize your camping experience even more with packages and options designed to maximize comfort and convenience!

This **27RBQC's** large, 84" U-dinette converts to additional sleeping accommodations. The sofa features a flip-down drink/storage tray and has a handy storage area below. The windows open to let in fresh air and plenty of natural light.



27RBQC's L-galley is loaded with storage and convenience features, including a built-in spice rack, a high-rise faucet and a large 50/50 sink. Turn up the tunes and jam with the CD/DVD/Bluetooth stereo. Shown with an optional microwave oven and 39" TV.



XLE Travel Trailers 2018

Model	12RBC	17QBC	18FBC	18 FLC	19RLC	20 RDC	21 FBC	22 RBC	23FBC	25 RBSC	25RSC	26 RLSC	27FQC	27 RBQC	28 DSBC	30 DBSC
Hitch Weight	295	403	382	474	425	430	519	435	600	590	529	712	572	687	648	754
Axle Weight	2432	3021	3046	3118	3786	3680	4327	3770	3899	5070	4216	5368	3965	5208	5513	5546
UWW	2756	3453	3457	3621	4240	4148	4884	4243	4537	5698	4784	6118	4575	5933	6199	6338
GVWR	3795	4803	4782	4874	6000	5800	6500	5800	6300	7300	6500	7712	6200	7687	7800	8000
CCC (Cargo Cap.)	1038	1349	1324	1252	1759	1652	1616	1557	1763	1602	1716	1594	1625	1754	1601	1662
Exterior Length	16'3"	22'	22'4"	22'4"	23'7"	25'0"	25'3"	25'10"	27'4"	29'6"	28'4"	31'3"	29'2"	33'0"	32'2"	33'5"
Exterior Height w/AC	10'2"	10'2"	10'2"	10'2"	10'2"	10'2"	11'1"	10'2"	10'2"	11'1"	10'2"	11'1"	10'2"	11'1"	11'1"	11'1"
Exterior Width	96"	96"	96"	96"	96"	96"	96"	96"	96"	96"	96"	96"	96"	96"	96"	96"
Fresh Water Cap. (Gal.)	51	51	51	51	51	51	51	51	51	51	51	51	51	51	51	51
Black Water Cap. (Gal.)	35	35	32	32	35	35	35	35	35	35	35	35	35	35	32	35
Grey Water Cap. (Gal.)	35	35	35	35	35	35	35	35	35	35	35	35	35	67	67	35
Tire Size (In.)	14"	15"	15"	15"	14"	14"	14"	14"	14"	15"	14"	15"	15"	15"	15"	15'0"
Awning Size (Ft.) OPT.	7'	13'	11'	11'	15'	12'	14'	10'	16'	18'	16'	17'	17'	21'	17'	18'

Travel Trailer Floorplans

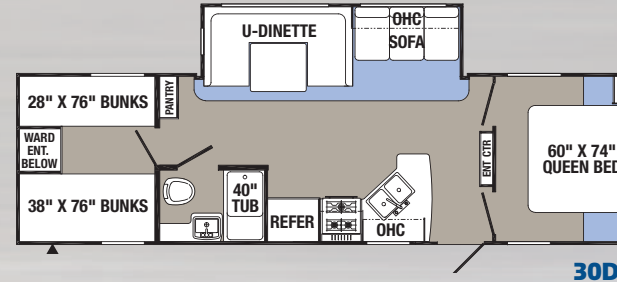
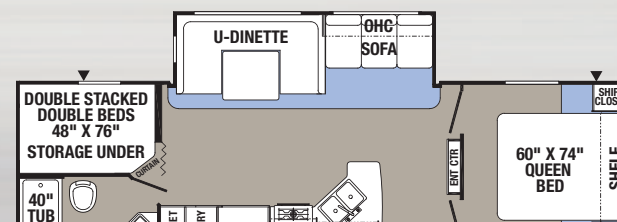
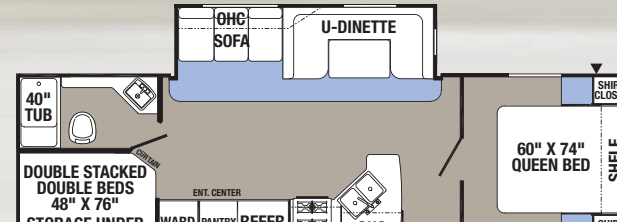
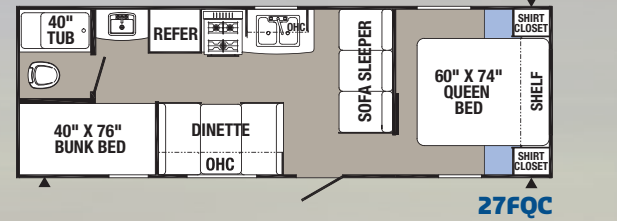
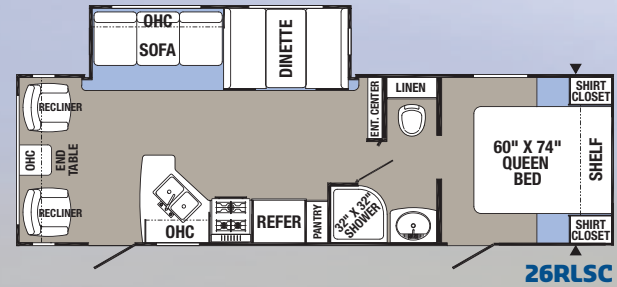
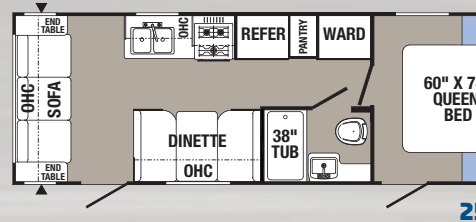
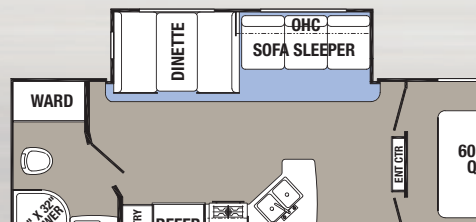
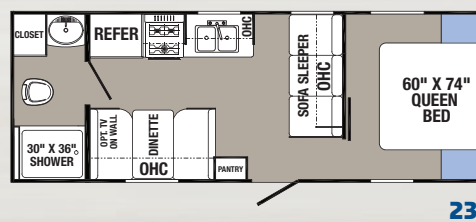
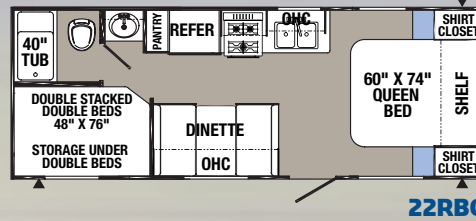
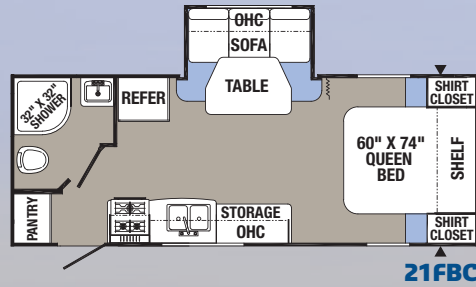
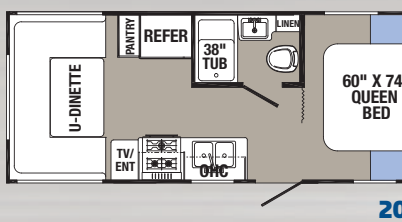
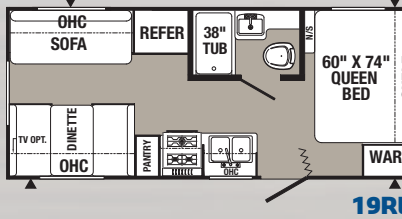
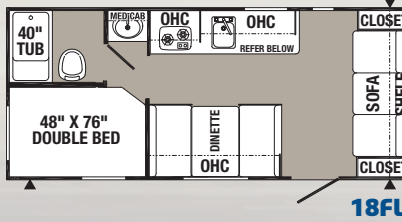
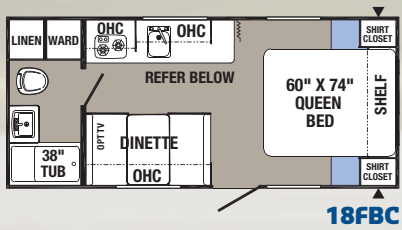
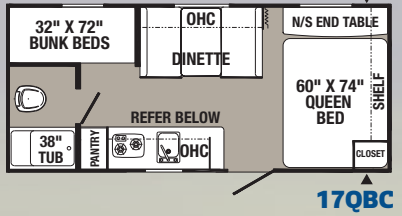
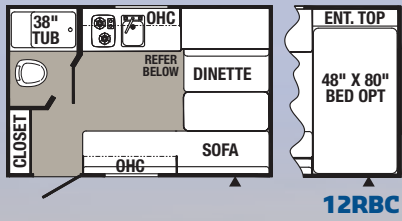

Travel Trailer & Toy Hauler Options



OUTSIDE KITCHEN OPTION W/ INDUCTION
30DBSC, 25TFC

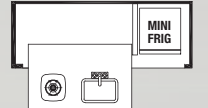

MINI CAMP KITCHEN OPTION W/ INDUCTION
22RBC, 27FQC, 27RBQC, 30DBSC



MINI CAMP KITCHEN OPTION W/ INDUCTION
18FLC

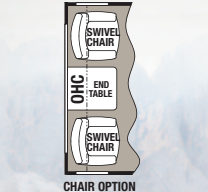

CHAIR OPTION
25RSC





PUMA

XLE LITE

by Palomino



Get the gang together and hit the trails! Load up your gear and plenty of groceries for a good time.

27QBC Toy Hauler comes equipped with these standards: roll-over sofas that convert to an additional sleeping area, heavy-duty, 5,000 lb. D-ring tie-downs, swivel recliners, a decorative backsplash and 3-burner cooktop. Shown with these optional features: an oven, microwave, 6 cu. ft. gas/electric refrigerator and dual electric queen beds.



Toy Hauler Floorplans

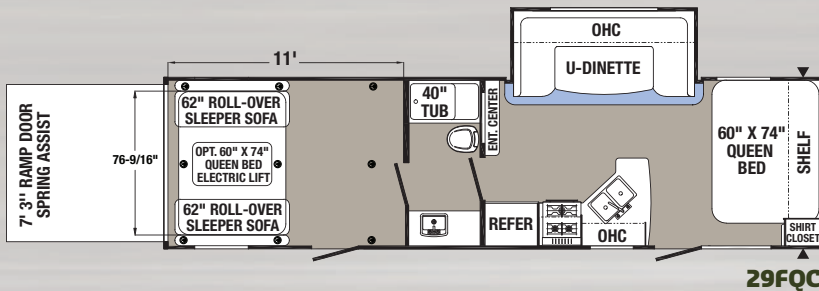
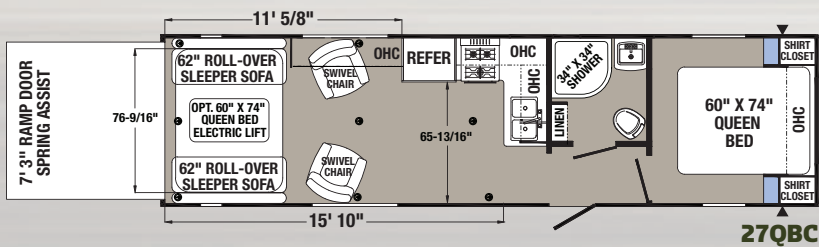
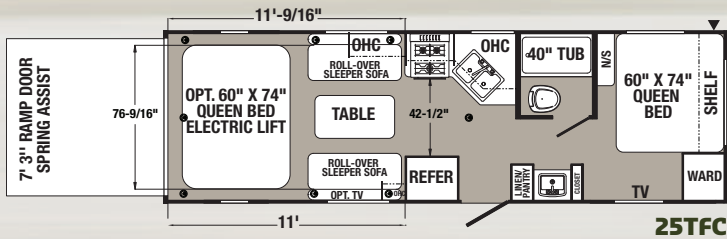
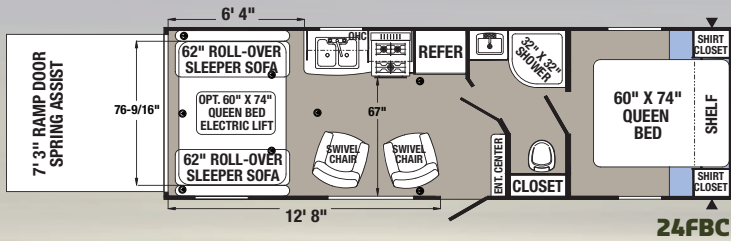
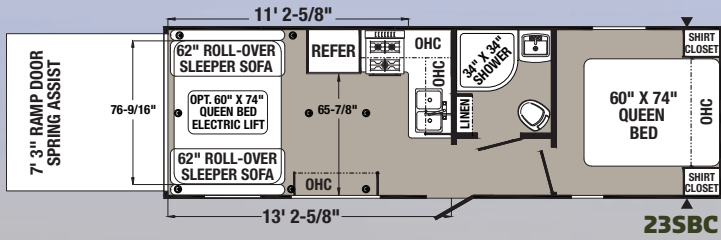

Puma XLE Toy Haulers Pack A Lot of Fun!

Good times are just around the corner with Puma XLE Toy Haulers. The versatile garage area in the **27QBC** features roll-over sofas that convert to an extra sleeping area. Optional dual electric queen beds are shown in the retracted position. The dinette table can be used indoors or out.

XLE Travel Trailer Toy Haulers 2018

Model	23 SBC	24 FBC	25TFC	27 QBC	29 FQC
Hitch Weight	773	775	745	892	1006
Axle Weight	4889	4615	5354	5716	5726
UVW	5700	5428	6137	6646	6770
GVWR	7773	7775	8800	9200	9300
CCC (Cargo Cap.)	2073	2347	2663	2554	2530
Exterior Length	28' 11"	29' 7"	29' 7"	33' 11"	34' 1"
Exterior Height w/AC	12' 2"	12' 2"	12' 2"	12' 2"	12' 2"
Exterior Width	96"	96"	96"	96"	96"
Fresh Water Cap. (Gal.)	51	51	51	51	51
Black Water Cap. (Gal.)	35	35	35	35	35
Grey Water Cap. (Gal.)	35	35	35	35	35
Tire Size (In.)	15"	15"	15"	15"	15"
Awning Size (Ft.) OPT.	18'	18'	14'	19'	21'

Puma XLE Lite Toy Haulers give you the versatility to play hard and rest easy. 27QBC shown.



PUMA

XLE LITE

by Palomino



This L-shaped galley extends workspace and has a 50/50 sink with a high rise faucet, sink cover and seamless countertops. Storage cabinets have both front and back access.



Entry door with window and kick plate



84" U-dinette converts to a large sleeping area, with storage and a 110V outlet underneath. The sofa has a flip-down drink tray and additional storage.



King Jack directional HDTV antenna with built-in, long-range signal finder



Bath skylight for natural light



Smooth, aerodynamic radius front metal. Radius compartment doors are silicone sealed to protect from the elements.



(2) 20 Lb. LP bottle and cover
(Optional lighted power jack shown)



Easy to lift under bed storage with finished edge trim is ideal for linens and large items



Beauflor® Wood grain linoleum with a 7-year cold crack warranty



Tinted windows add style and reduce interior fading



Walk-around queen bed with designer bedspread, night stands and large shirt wardrobes



Rear stabilizer jacks (Standard)
(Optional power stabilizer jack shown)



Grey steel wheel rims with Super Lube axles and ABS molded fender skirts



Reliable rack and pinion flush-floor slide system



Six gallon direct start ignition (DSI) water heater



14" Deep overhead cabinet storage



Bright, energy efficient LED interior lighting



Decorative backsplash with a 3-Burner cooktop

■ **Standard Value Leader Package (Required)**

- Rear Stab Jacks
- 45 Gal. Fresh Water Tank
- 2 Burner Cook Top
- Tinted Windows
- Super Lube Axles
- Refrigerator
- Overhead Cabinets
- Beauflor Linoleum
- Wood Drawers
- Bath Skylight
- 6 Gal. Gas DSI Water Heater
- Grab Handle
- 20# Bottle with Cover
- Molded Fender Skirts
- Upgrade Color Metal
- Range Hood
- L.E.D. Lighting

■ **Elite Package (Optional)**

- Electric Awning
- Bedspread with Pillows
- Oven
- Microwave
- Front Stab Jacks
- Tub Surround
- Outside Shower
- AM/FM/CD/DVD Stereo
- Spare Tire
- TV Antenna

■ **Electric Power Package**

- 4 Electric Stabilizer Jacks
- 3,500 Lb. Electric Tongue Jack

Travel Trailer Options

- 13,500 BTU Non-Duct A/C
- 3 Cu. Ft. Gas/Electric Refrigerator (4.1 Cu ft. 110V standard)
- Awning
- Electric Awning
- Outside Grill
- Spare Tire and Carrier
- AM/FM/CD/DVD Stereo
- 2 Exterior Speakers
- TV Antenna with Cable Hook-up
- Outside Shower
- Bedspread with Pillows
- Bedroom TV Hook-up (Where available)
- Diamond Plate
- Roof Ladder
- Carbon Monoxide Detector
- Z240
- State Seal
- 6 Gal. Gas/Electric DSI Hot Water Heater*
- 6 Cu. ft. Double Door Refrigerator* (5 Cu. ft. single door standard)
- Oven*
- 13,500 BTU Ducted A/C*
- 15,000 BTU Ducted A/C*

*19' Models and above

Toy Hauler Options

- Single Electric Trac Queen Bed
- Double Electric Trac Queen Bed
- HappiJac Sofas with Electric Bed (IPO Flip-up sofas)
- HappiJac Sofas with Electric Bed (25TFC)
- Colored Fiberglass Front Cap
- Mission Aluminum Rims
- Zip Screen
- Wash Down Kit
- 30 Gal. Fuel Puma Station



This convenient outside kitchen option includes a slide out induction cooktop, a 3.2 cu. ft. refrigerator, hot and cold running water, plenty of overhead cabinets, under counter drawers, cookware and utensils. (Select models)



This mini kitchen option includes a pull-out induction cooktop, a 1.6 cu. ft. refrigerator, a removable sink, plus cookware and utensils. (Select models)



Hot and cold outside shower reduces tracking dirt indoors



ABS radius shower with a skylight and glass shower doors (Most models)



Optional Dometic 6 cu. ft. gas/110V double door refrigerator/freezer (Most models)



PUMA

XLE LITE

by Palomino

Go Wild!



Puma XLE Lite by Palomino,
a Division of Forest River, Inc.
2551 Century Drive ■ Goshen, IN 46528
www.palominorv.com



Decor Choices

Smoke

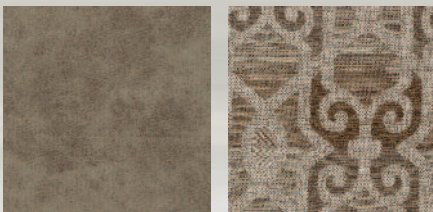

Stone

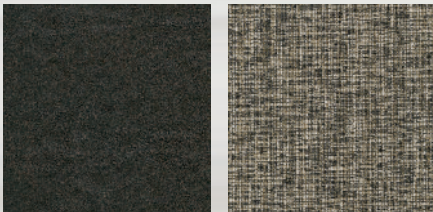

Latte

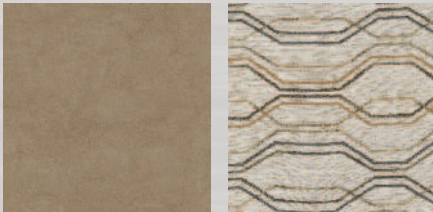

Taupe



Puma XLE Owner "Digital Kit" App

Now you can have your Owner's Manual with you wherever you are. Download our FREE App from the App Store or Google Play and you'll have the information right at your fingertips.

 Find us on Facebook

GVWR (Gross Vehicle Weight Rating) - is the maximum permissible weight of the unit when fully loaded. It includes all weights, inclusive of all fluids, cargo, optional equipment and accessories. For safety and product performance do NOT exceed the GVWR.

GAWR (Gross Axle Weight Rating) - is the maximum permissible weight, including cargo, fluids, optional equipment and accessories that can be safely supported by a combination of all axles.

UVW (Unloaded Vehicle Weight)* - is the typical weight of the unit as manufactured at the factory. It includes all weight at the unit's axle(s) and tongue or pin and LP Gas. The UVW does not include cargo, fresh potable water, additional optional equipment or dealer installed accessories.

*Estimated Average based on standard build optional equipment.

CCC (Cargo Carrying Capacity)** - is the amount of weight available for fresh potable water, cargo, additional optional equipment and accessories. CCC is equal to GVWR minus UVW. Available CCC should accommodate fresh potable water (8.3 lbs per gallon). Before filling the fresh water tank, empty the black and gray tanks to provide for more cargo capacity.

**Estimated average based on standard build optional equipment.

Each Forest River RV is weighed at the manufacturing facility prior to shipping. A label identifying the unloaded vehicle weight of the actual unit and the cargo carrying capacity is applied to every Forest River RV prior to leaving our facilities. The load capacity of your unit is designated by weight, not by volume, so you cannot necessarily use all available space when loading your unit.

All information contained in this brochure is believed to be accurate at the time of publication. However, during the model year, it may be necessary to make revisions and Forest River, Inc., reserves the right to make all such changes without notice, including prices, colors, materials, equipment and specifications as well as the addition of new models and the discontinuance of models shown in this brochure. Therefore, please consult with your Forest River dealer and confirm the existence of any materials, design or specifications that are material to your purchase decision. ©2017 Puma by Palomino a Division of Forest River, Inc., a Berkshire Hathaway company. All Rights Reserved. 1/18

Your PUMA XLE Dealer



PRE-DELIVERY INSPECTION FACILITY

20,000 square feet of quality assurance. The bare essentials for a premium product. This state-of-the-art facility gives immediate daily feedback to production for quality assurance in every unit built.

24/7 EMERGENCY ROADSIDE ASSISTANCE

For a worry-free ownership experience

Forest River includes one year of Coach-Net RV Technical & Roadside Assistance with each RV purchase. Whether new to the RV lifestyle or an experienced RV enthusiast, Forest River owners have 24/7 access to technical, operational and emergency road service coverage throughout the US & Canada. Coach-Net's fast, dependable service is just a phone call away.

Coach-Net®

RV Technical & Roadside Assistance

FREE MEMBERSHIP
to Forest River Owners' Group



www.forestriverfrog.com



Learn More

Scan this barcode using a QR Reader on your smart phone to learn more about Forest River.



A Berkshire Hathaway company.



www.ForestRiverBuyLocal.com