

SOLAIRE  
BY PALOMINO

1 9 6 8  
PALOMINO  
50  
ANNIVERSARY  
2 0 1 8



SINCE 1968  
**PALOMINO**  
*Recreational Vehicles*  
a Division of Forest River





185 X INTERIOR



Solaire ultra light travel trailers are swift and easy to tow, yet built to last with a sturdy aluminum framed superstructure for long lasting durability.



205 SS INTERIOR



312 TSQBK INTERIOR



**SOLAIRE**  
- PHANTOM  
**GT3**

Solaire ultra light travel trailers equipped with the GT3 package are designed with luxury in mind. The aluminum structure allows for easy towing and handling.



Slam Latch Baggage Doors



Power Front Jack



Awning Slide Topper (Optional)



Kitchen Skylight With Shade To Let Natural Light In



Stainless Steel Sink with Roll Cover

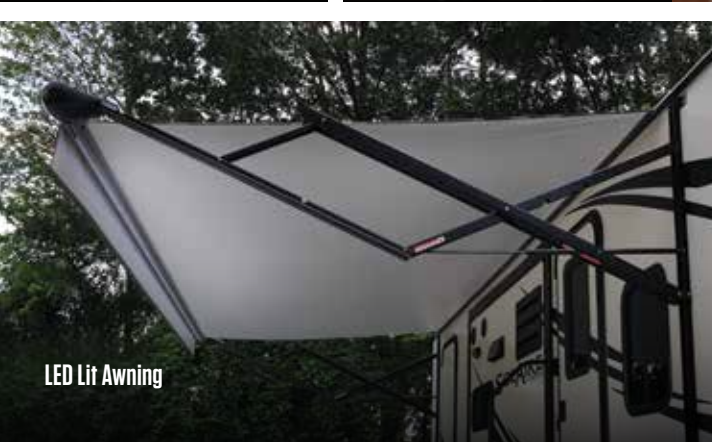

LED Lit Awning



Detail

LINE-X® Protective Coatings



## Protective Coatings Built to Go the Distance

### LINE-X Benefits:

- Protect your investment with reduced maintenance and repair costs
- Abrasion, impact, and scratch resistance for protection against rock or debris chips
- Rust, corrosion, and chemical protection
- Fade resistance with LINE-X ULTRA UV stable color formula





Two available interior color decor options. With fabric furniture option in place of leather, available in both decors

211 BH with Teakwood interior decor and Mesa Maple Cabinets



STERLING



TEAKWOOD



FURNITURE FABRIC OPTION



185X with Teakwood interior decor and Walnut Cabinets

## Hybrid Expandable. Best in Value.

Hybrid expandable bed ends and slide outs create a comfortable and spacious interior design for that residential feel. They include many popular features to deliver the very best value to the market.

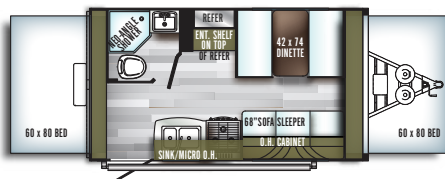

147 X

HITCH DRY WEIGHT	315	EXTERIOR WIDTH	8'
DRY AXLE WEIGHT	2720	TRAVEL LENGTH	18'6"
TOTAL DRY WEIGHT	3035	OPEN LENGTH	23'3"
GVWR	3815	FRESH WATER CAPACITY	30
UNLOADED VEHICLE WEIGHT	3069	GRAY WATER CAPACITY	30
INTERIOR HEIGHT	6' 8"	BLACK WATER CAPACITY	30
EXTERIOR HEIGHT W/ AC	9'3"	CARGO CARRYING CAPACITY	746

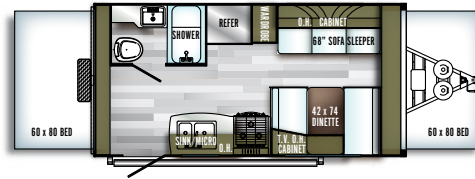

163 X

HITCH DRY WEIGHT	400	EXTERIOR WIDTH	8'
DRY AXLE WEIGHT	3169	TRAVEL LENGTH	20'2"
TOTAL DRY WEIGHT	3569	OPEN LENGTH	24'10"
GVWR	4996	FRESH WATER CAPACITY	30
UNLOADED VEHICLE WEIGHT	3603	GRAY WATER CAPACITY	30
INTERIOR HEIGHT	6' 8"	BLACK WATER CAPACITY	30
EXTERIOR HEIGHT W/ AC	9'3"	CARGO CARRYING CAPACITY	1393

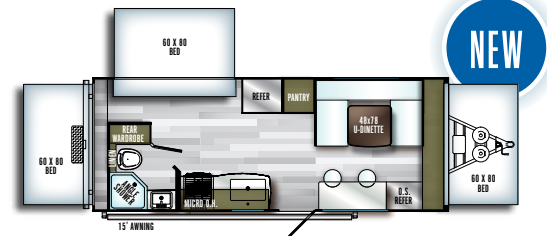

185 X

HITCH DRY WEIGHT	444	EXTERIOR WIDTH	8'
DRY AXLE WEIGHT	3652	TRAVEL LENGTH	25'11"
TOTAL DRY WEIGHT	4096	OPEN LENGTH	29'7"
GVWR	5630	FRESH WATER CAPACITY	50
UNLOADED VEHICLE WEIGHT	4134	GRAY WATER CAPACITY	38
INTERIOR HEIGHT	6'8"	BLACK WATER CAPACITY	30
EXTERIOR HEIGHT W/ AC	10'1"	CARGO CARRYING CAPACITY	1496

# SOLAIRE

BY PALOMINO

GT3



## Standards

- Power Awning w/LED Lights
- Dexter Tor-Flex Torsion Axles
- Furrion HDMI DVD/Bluetooth/HDMI Stereo
- Power Tongue Jack
- 13,500 BTU Ducted A/C
- Tub Surround w/Skylight
- Gel Coated Front Cap
- Ball Bearing Drawer Guides
- Microwave
- Slam Latch Baggage Doors w/ Magnets
- Black Tank Flush
- LED Interior Lights
- 8 Cu Ft Refrigerator
- White gel coat fiberglass exterior
- Solid surface counter tops
- Stainless Steel kitchen sink with roll cover
- Raised refrigerator panel
- Aluminum wheels

## GT3 Package

### Standards

Optional GT3 Package Includes All The Features From The Ultra Plus The Following:

- Roller Night Shades
- 9" Denver 60 X 80 Mattress
- Bedspread / Pillow Combo
- Solid Surface Counter Tops Throughout
- Stainless Steel Appliance Package (Microwave and Oven)
- Bonded Frameless Windows
- Power Stabilizer Jacks
- Heated Holding Tanks
- Roof ladder
- Fireplace (Std,in 312)

NOT AVAILABLE GT3 PACKAGE  
205 SS, 202 RB, 211 BH



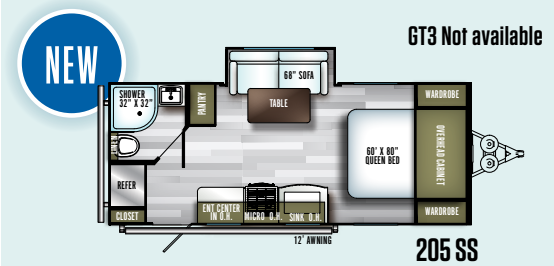

HITCH DRY WEIGHT	546	EXTERIOR WIDTH	8'
DRY AXLE WEIGHT	3800	TRAVEL LENGTH	23'4"
TOTAL DRY WEIGHT	4347	OPEN LENGTH	NA
GVWR	5400	FRESH WATER CAPACITY	50
UNLOADED VEHICLE WEIGHT	4385	GRAY WATER CAPACITY	38
INTERIOR HEIGHT	6'8"	BLACK WATER CAPACITY	30
EXTERIOR HEIGHT W/AC	10'11"	CARGO CARRYING CAPACITY	1245

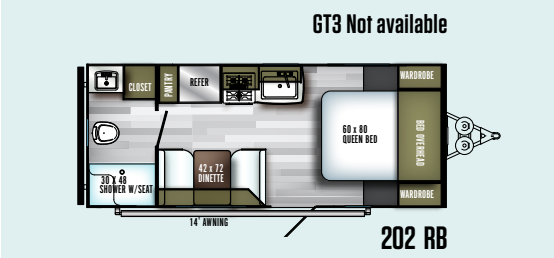

HITCH DRY WEIGHT	536	EXTERIOR WIDTH	8'
DRY AXLE WEIGHT	3239	TRAVEL LENGTH	23'5"
TOTAL DRY WEIGHT	3775	OPEN LENGTH	NA
GVWR	5125	FRESH WATER CAPACITY	50
UNLOADED VEHICLE WEIGHT	3813	GRAY WATER CAPACITY	38
INTERIOR HEIGHT	6'8"	BLACK WATER CAPACITY	38
EXTERIOR HEIGHT W/AC	10'11"	CARGO CARRYING CAPACITY	1312

NON-BUNK MODELS



HITCH DRY WEIGHT	560	EXTERIOR WIDTH	8'
DRY AXLE WEIGHT	4890	TRAVEL LENGTH	29'2"
TOTAL DRY WEIGHT	5450	OPEN LENGTH	NA
GVWR	7475	FRESH WATER CAPACITY	50
UNLOADED VEHICLE WEIGHT	5488	GRAY WATER CAPACITY	76
INTERIOR HEIGHT	6'8"	BLACK WATER CAPACITY	38
EXTERIOR HEIGHT W/AC	11'1"	CARGO CARRYING CAPACITY	1987

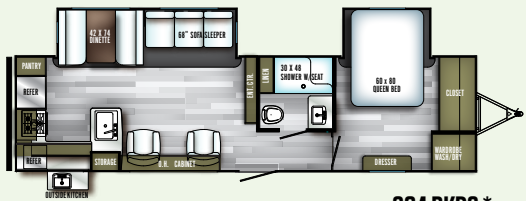

HITCH DRY WEIGHT	920	EXTERIOR WIDTH	8'
DRY AXLE WEIGHT	6333	TRAVEL LENGTH	35'6"
TOTAL DRY WEIGHT	7253	OPEN LENGTH	NA
GVWR	8920	FRESH WATER CAPACITY	50
UNLOADED VEHICLE WEIGHT	7291	GRAY WATER CAPACITY	106
INTERIOR HEIGHT	6'8"	BLACK WATER CAPACITY	38
EXTERIOR HEIGHT W/AC	11'1"	CARGO CARRYING CAPACITY	1629

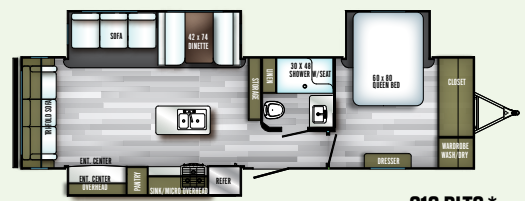

HITCH DRY WEIGHT	929	EXTERIOR WIDTH	8'
DRY AXLE WEIGHT	7239	TRAVEL LENGTH	35'6"
TOTAL DRY WEIGHT	8168	OPEN LENGTH	NA
GVWR	9995	FRESH WATER CAPACITY	50
UNLOADED VEHICLE WEIGHT	8206	GRAY WATER CAPACITY	106
INTERIOR HEIGHT	6'8"	BLACK WATER CAPACITY	38
EXTERIOR HEIGHT W/AC	11'1"	CARGO CARRYING CAPACITY	1789

\*Washer/Dryer prep standard in 304/316 Includes 50 AMP Service 7



Entertainment Center  
Fireplace



King Bed (Available on 304 & 316 only)



Roller Shades



Large Outside Camp Kitchen



Small Outside Camp Kitchen

**GT3 Not available**

**211 BH**

HITCH DRY WEIGHT	528	EXTERIOR WIDTH	8'
DRY AXLE WEIGHT	3568	TRAVEL LENGTH	25'5"
TOTAL DRY WEIGHT	4096	OPEN LENGTH	NA
GVWR	5630	FRESH WATER CAPACITY	50
UNLOADED VEHICLE WEIGHT	4134	GRAY WATER CAPACITY	30
INTERIOR HEIGHT	6'8"	BLACK WATER CAPACITY	38
EXTERIOR HEIGHT W/AC	10'1"	CARGO CARRYING CAPACITY	1496

**NEW**

**268 BHSK**

HITCH DRY WEIGHT	671	EXTERIOR WIDTH	8'
DRY AXLE WEIGHT	5307	TRAVEL LENGTH	30'11"
TOTAL DRY WEIGHT	5978	OPEN LENGTH	NA
GVWR	7759	FRESH WATER CAPACITY	50
UNLOADED VEHICLE WEIGHT	6016	GRAY WATER CAPACITY	76
INTERIOR HEIGHT	6'8"	BLACK WATER CAPACITY	38
EXTERIOR HEIGHT W/AC	11'1"	CARGO CARRYING CAPACITY	1655



Optional Theater Seating

**240 BHS**

HITCH DRY WEIGHT	566	EXTERIOR WIDTH	8'
DRY AXLE WEIGHT	4606	TRAVEL LENGTH	27'10"
TOTAL DRY WEIGHT	5172	OPEN LENGTH	NA
GVWR	6710	FRESH WATER CAPACITY	50
UNLOADED VEHICLE WEIGHT	5210	GRAY WATER CAPACITY	38
INTERIOR HEIGHT	6'8"	BLACK WATER CAPACITY	38
EXTERIOR HEIGHT W/AC	11'1"	CARGO CARRYING CAPACITY	1500



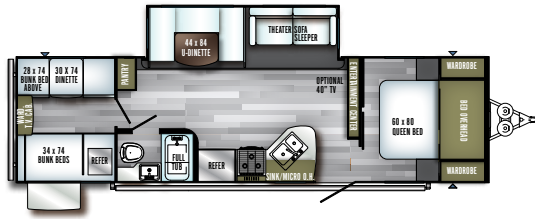

**292 QBSK**

HITCH DRY WEIGHT	885	EXTERIOR WIDTH	8'
DRY AXLE WEIGHT	4970	TRAVEL LENGTH	33'4"
TOTAL DRY WEIGHT	5855	OPEN LENGTH	NA
GVWR	7845	FRESH WATER CAPACITY	50
UNLOADED VEHICLE WEIGHT	5893	GRAY WATER CAPACITY	76
INTERIOR HEIGHT	6'8"	BLACK WATER CAPACITY	38
EXTERIOR HEIGHT W/AC	111"	CARGO CARRYING CAPACITY	1952



**312 TSQBK**

HITCH DRY WEIGHT	805	EXTERIOR WIDTH	8'
DRY AXLE WEIGHT	7055	TRAVEL LENGTH	35'1"
TOTAL DRY WEIGHT	7860	OPEN LENGTH	NA
GVWR	9700	FRESH WATER CAPACITY	50
UNLOADED VEHICLE WEIGHT	7898	GRAY WATER CAPACITY	76
INTERIOR HEIGHT	6'8"	BLACK WATER CAPACITY	38
EXTERIOR HEIGHT W/AC	111"	CARGO CARRYING CAPACITY	1802

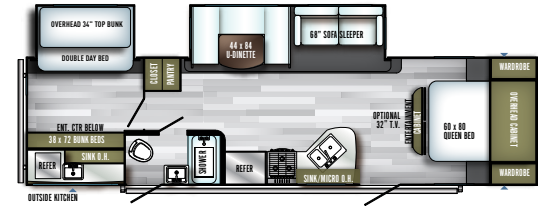

**317 BHSK**

HITCH DRY WEIGHT	705	EXTERIOR WIDTH	8'
DRY AXLE WEIGHT	6445	TRAVEL LENGTH	35'1"
TOTAL DRY WEIGHT	7070	OPEN LENGTH	NA
GVWR	8700	FRESH WATER CAPACITY	50
UNLOADED VEHICLE WEIGHT	7108	GRAY WATER CAPACITY	76
INTERIOR HEIGHT	6'8"	BLACK WATER CAPACITY	38
EXTERIOR HEIGHT W/AC	111"	CARGO CARRYING CAPACITY	1592



**312 TSQBK / 317 BHSK Rear Bunk Beds**



**268 BHSK with Teakwood Interior Decor and Walnut Cabinets**



SOLAIRE  
**SUPERIOR  
 CONSTRUCTION**

- A. Alpha Super Flex Membrane
- B. Luan Substrate
- C. Luan Substrate
- D. High density block foam insulation
- E. High density block foam insulation
- F. Luan substrate
- G. Fiberglass front cap w/ LED lights and Line X® Rock Guard
- H. Residential Style Carpeting
- I. Tile-look laminate floor
- J. Fully welded aluminum super structure
- K. High density block foam insulation
- L. Luan substrate - top
- M. Luan substrate - bottom
- N. Under floor holding tanks
- O. Dexter - Tor Flex Torsion Axle

## AVAILABLE OPTIONS

### SOLAIRE EXPANDABLES -

- Air conditioner upgrade - 15,000 BTU
- 24" LED TV
- Create A Breeze Fan
- Heated Holding Tanks
- RVQ Bumper Mount Grill
- Off Road Package (147 X Only) (includes 15" wheels, Off Road tires, and lift kit)
- Fabric Sofa
- Jack It® bike carrier
- 30 lb. LP tanks

### SOLAIRE ULTRA LITE -

- Air conditioner upgrade - 15,000 BTU
- TV (size varies per floorplan)
- 30 lb. LP tanks
- 9" Denver mattress
- Counter top extension
- Create a breeze fan
- Free standing table & chairs
- King bed option  
(available on 304 / 316 only)
- Power stabilizer jacks
- RVQ bumper mount grill
- Residential refrigerator - 11 cu ft.
- Roller night shades
- Roof ladder (N/A on 205 SS only)
- Slide topper awnings
- Stainless steel appliances
- 68" theater seating
- Tri-fold sofa upgrade
- 50 AMP Service (Std in 304 & 316)
- Jack It® bike carrier
- Self Leveling / Stabilizing System

## SOLAIRE

# DARE TO COMPARE CHALLENGE

	SOLAIRE	BRAND X
<b>CONSTRUCTION:</b>		
Aluminum cage laminated construction	✓	
Vacuum bonded lamination: Roof, sidewalls, rear wall slide out box	✓	
Barreled walk on roof – block foam insulation for the most rigid construction available	✓	
Rack and pinion thru-frame flush floor slide out with manual override	✓	
<b>EXTERIOR:</b>		
Fully enclosed underbelly	✓	
Gel coated high gloss white exterior	✓	
Slam latch exterior baggage doors with magnetic door catches	✓	
Dexter TORFLEX Torsion axles – independent suspension, rubber cushioning eliminates metal-to-metal contact	✓	
TV bracket and speakers	✓	
Power awning with LED patio lights	✓	
Powder coated exterior kitchen tops and base – designed for the exterior elements	✓	
Alpha Superflex roofing	✓	
<b>INTERIOR:</b>		
8 cubic foot Dometic refrigerator	✓	
Glass top flush mount range cover	✓	
LED interior lights	✓	
Solid surface countertops	✓	
Stainless steel kitchen sink with roll cover	✓	
Skylight in every kitchen and includes a night shade	✓	
Raised panel cabinet doors	✓	
Porcelain foot flush Dometic Toilet	✓	
USB charging station	✓	





### PRE-DELIVERY INSPECTION FACILITY

20,000 square feet of quality assurance. The bare essentials for a premium product. This state-of-the-art facility gives immediate daily feedback to production for quality assurance in every unit built.

### CUSTOMER SATISFACTION



[www.ForestRiverBuyLocal.com](http://www.ForestRiverBuyLocal.com)

### 24/7 EMERGENCY ROADSIDE ASSISTANCE

For a worry-free ownership experience

Forest River includes one

year of Coach-Net RV Technical & Roadside Assistance with each RV purchase. Whether new to the RV lifestyle or an experienced RV enthusiast, Forest River owners have 24/7 access to technical, operational and emergency road service coverage throughout the US & Canada.

Coach-Net's fast, dependable service is just a phone call away.

**Coach-Net**<sup>®</sup>  
RV Technical & Roadside Assistance

### Specification Definitions

**GVWR (Gross Vehicle Weight Rating)** - is the maximum permissible weight of the unit when fully loaded. It includes all weights, inclusive of all fluids, cargo, optional equipment and accessories. For safety and product performance do NOT exceed the GVWR.

**GAWR (Gross Axle Weight Rating)** - is the maximum permissible weight, including cargo, fluids, optional equipment and accessories that can be safely supported by a combination of all axles.

**UVW (Unloaded Vehicle Weight)\*** - is the typical weight of the unit as manufactured at the factory. It includes all weight at the unit's axle(s) and tongue or pin and LP Gas. The UVW does not include cargo, fresh potable water, additional optional equipment or dealer installed accessories.

\*Estimated average based on standard build optional equipment.

**CCC (Cargo Carrying Capacity)\*\*** - is the amount of weight available for fresh potable water, cargo, additional optional equipment and accessories. CCC is equal to GVWR minus UVW. Available CCC should accommodate fresh potable water (8.3 lbs per gallon). Before filling the fresh water tank, empty the black and gray tanks to provide for more cargo capacity.

\*\* Estimated average based on standard build optional equipment

Each Forest River RV is weighed at the manufacturing facility prior to shipping. A label identifying the unloaded vehicle weight of the actual unit and the cargo carrying capacity is applied to every Forest River RV prior to leaving our facilities.

The load capacity of your unit is designated by weight, not by volume, so you cannot necessarily use all available space when loading your unit.

# Palomino Warranty

Palomino will stand behind our products 100%. For complete details on our warranty program, please see your Palomino dealer.

- 1 2-year fiberglass warranty
- 2 10-year axle warranty
- 3 12-year Alpha Super Flex roof warranty
- 4 2-3 year warranty on appliances (see manual for details)
- 5 1 year bumper to bumper warranty
- 6 An additional 1 year warranty available



### Learn More

Scan this barcode using a QR Reader on your smart phone to learn more about Forest River.



A Berkshire Hathaway company.

SINCE 1968  
**PALOMINO**

*Recreational Vehicles*

a Division of Forest River

1047 EAST M-86 | COLON, MI 49040

P: 269.432.3271 | F: 269.432.2516

[www.palomino.com](http://www.palomino.com)

YOUR SOLAIRE DEALER

All information contained in this brochure is believed to be accurate at the time of publication. However, during the model year, it may be necessary to make revisions and Forest River, Inc., reserves the right to make all such changes without notice, including prices, colors, materials, equipment and specifications as well as the addition of new models and the discontinuance of models shown in this brochure. Therefore, please consult with your Forest River, Inc., dealer and confirm the existence of any materials, design or specifications that are material to your purchase decision. Litho. U.S.A FOR 1499 P/W: 2018.01.18